

SAFETY / PARTS

TOWING VEHICLE AND TOWING SAFELY ...continued

- Use counterweights or wheel weights as described in the towing vehicle operator's manual.
- Do not shift to neutral and coast downhill.
- Do not allow children to operate the towing vehicle. Do not allow adults to operate the towing vehicle without proper instruction or without having read the owner's manual.

PROTECT THOSE AROUND YOU

- Before you operate any feature of this attachment or towing vehicle, observe your surroundings and look for bystanders.
- Keep children, bystanders and pets at a safe distance away while operating this or any attachment.
- Use care when reversing. Before you back up, look carefully behind for bystanders.

KEEP RIDERS OFF TOWED ATTACHMENT AND TOWING VEHICLE

- Do not carry passengers.
- Do not let anyone, especially children, ride in/on this attachment, the towing vehicle or hitch bracket. Riders are subject to injury such as being struck by foreign object and/or being thrown off during sudden starts, stops and turns.
- Riders may also obstruct the operator's view resulting in this attachment being operated in an unsafe manner.

PARTS

Installation Questions?
Missing Parts?
Replacement Parts?



**DON'T GO BACK
TO THE STORE!**

Please call our Customer
Service Department,
Toll Free: 877-728-8224 or
customerservice@brinly.com

PART #s
(vary by model)

Ref.	Description	Qty.	SAT-401BH	SAT-401BH-A
1	End Plate	2	B-4892-10	B-4892-10
2	Axle Assembly	1	B-5832-10	B-5832-10
3	Drawbar, with Decals	1	B-3593-1	1020062 *
4	Tray, with Decals	1	B-5453-1	1020081
5	Tine	11	1018833-SER	1018833-SER
6	Bearing	22	B-5425	B-5425
7	Handle Assembly	1	B-4888-10	B-4888-10
8	Wheel	2	R-891	R-891

* The SAT-401BH-A drawbar (3) has a slightly
different appearance, illustrated here:

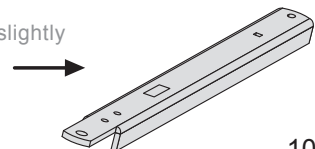

PARTS

Detail 1

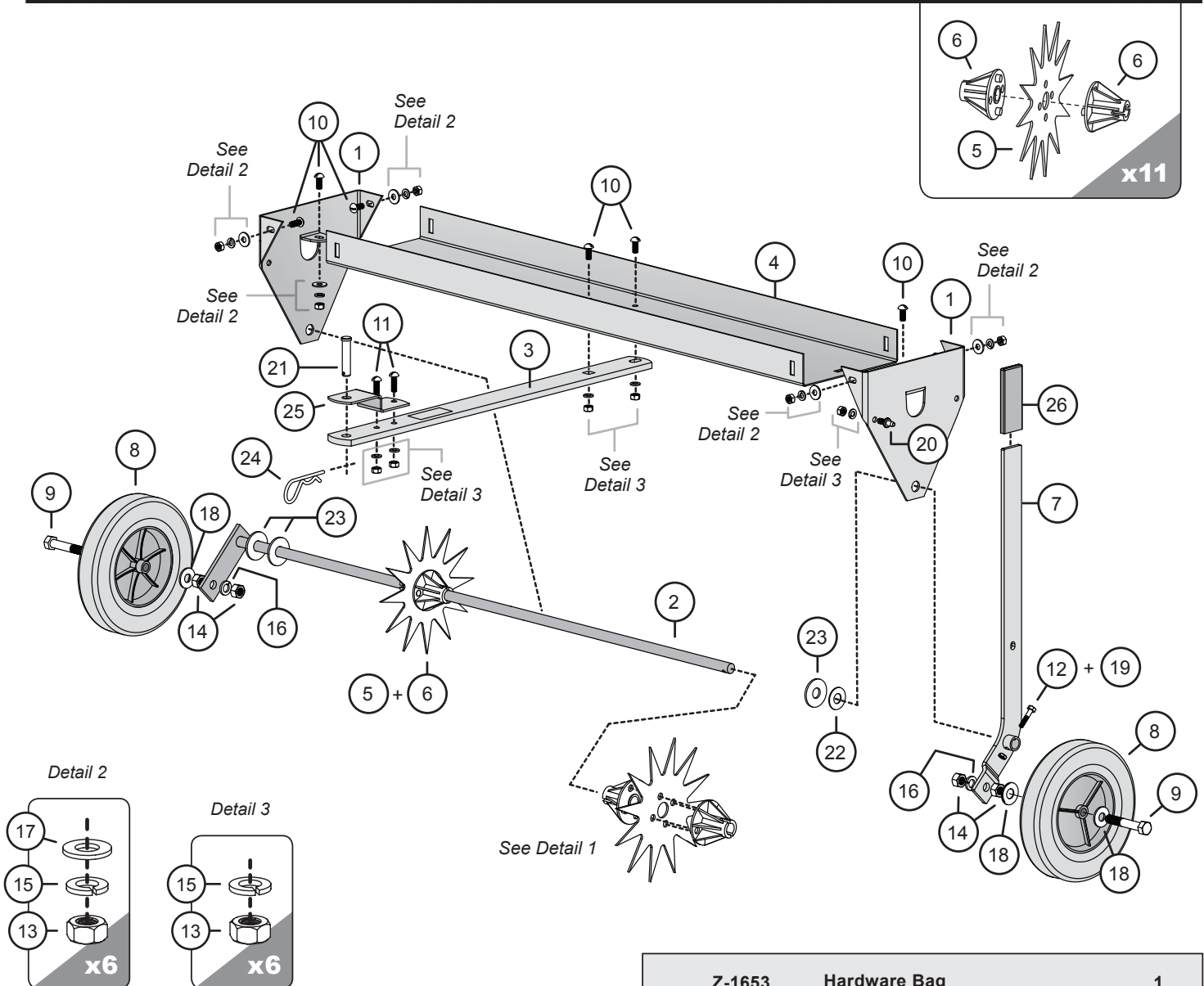

Z-1653	Hardware Bag		1
9	1M1648P	Bolt; Hex Head, 1/2 x 3"	2
10	20M1012P	Screw; Round Head, 5/16"-18 x 3/4"	8
11	20M1016P	Screw; Round Head, 5/16" x 1"	2
12	2M0820P	Bolt; Hex Head, 1/4 x 1-1/4"	1
13	30M1000P	Nut; Hex, 5/16"-18	11
14	30M1600P	Nut; Hex, 1/2"-13	4
15	40M1000P	Washer; Lock, 5/16"	11
16	40M1600P	Washer; Lock, 1/2"	2

Z-1653	Hardware Bag		1
17	45M1111P	Washer; Flat, 5/16"	6
18	45M1717P	Washer; Flat, 1/2"	4
19	B-1673P	Nut; Hex Lock, 1/4"-20	1
20	B-3307-S	Pin; Transport Lock	1
21	B-3861	Pin; Hitch, 1/2" x 2-1/2"	1
22	B-4768	Bushing; Machine, 5/8" ID x 0.74"	2
23	B-5456	Bushing; Machine, 5/8" ID x 0.134"	5
24	D-146P	Cotter; Hairpin, 1/8" - #211	1
25	R-821-10	DrawBar, Clevis	1
26	B-4867	Grip	1

HARDWARE IDENTIFIER

Illustrations on this page are to scale for faster identification of hardware during assembly.

DO NOT RETURN PRODUCT IF YOU ARE MISSING PARTS.
Please Call: 1 (877) 728-8224

13 Nut; Hex
5/16"-18 (x11)
30M1000P



14 Nut; Hex
1/2" -13 (x4)
30M1600P

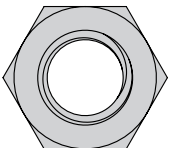

19 Nut; Hex Lock
1/4" -20 (x1)
B-1673P



15 Washer; Lock
5/16" (x11)
40M1000P

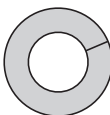

16 Washer; Lock
1/2" (x2)
40M1600P

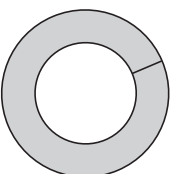

17 Washer; Flat
5/16" (x6)
45M1111P

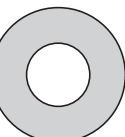

18 Washer; Flat
1/2" (x4)
45M1717P

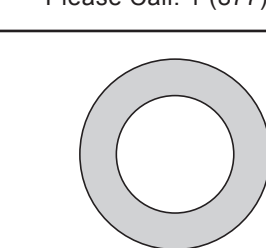
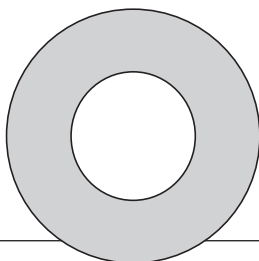

22 Machine Bushing; 5/8"
0.074" thick (x2)
B-4768

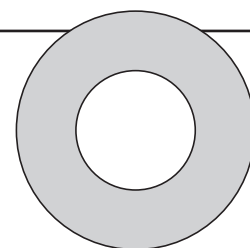

23 Machine Bushing; 5/8"
0.13" thick (x5)
B-5456



9 Bolt; Hex Head, 1/2" x 3" (x2)
1M1648P

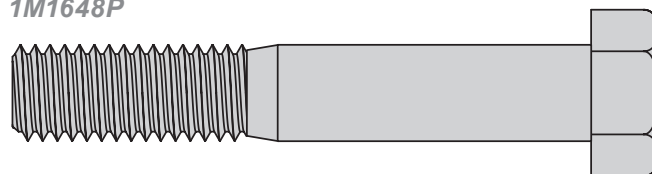

10 Screw: Round Head
5/16"-18 x 3/4" (x8)
20M1012P

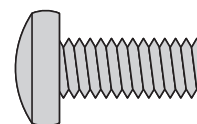

11 Screw: Round Head
5/16 x 1" (x2)
20M1016P

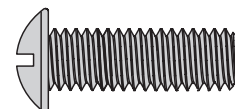

12 Screw: Hex Head
1/4" x 1-1/4" (x1)
2M0820P

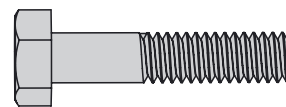

20 Transport
Locking Pin (x1)
B-3307-S

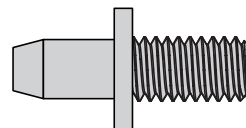

21 Hitch Pin; Drawbar, 1/2" x 2-1/2" (x1)
B-3861

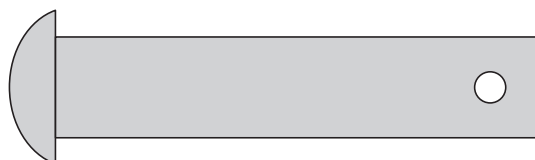

24 Hairpin Cotter, 1/8" (x1)
D-146P

