



**Damask®**  
One-light lacemaker sconce  
**K-22546-SC01**

**Features**

- Derived from historical references this lighting collection is intricate and modern at the same time
- Suitable for living, dining, and kitchen spaces, allowing you to create a cohesive design aesthetic throughout your home
- Candelabra base (E12) socket, works best with type G or T light bulbs (sold separately)
- Includes installation hardware
- Suitable for damp locations, per UL 1598

**Material**

- Manufactured with quality materials and complemented with a meticulous finishing process
- Durable finishes engineered to last and designed to coordinate with KOHLER faucet finishes

**Recommended Products/Accessories**

K-23723 Faucet cleaner



**Codes/Standards**

UL 1598  
CSA C22.2 No. 250.0  
cETL Listed  
ETL Listed

**KOHLER® Indoor Lighting Fixtures  
Limited Warranty**

See website for detailed warranty information.



**Damask®**  
One-light lacemaker sconce  
**K-22546-SC01**

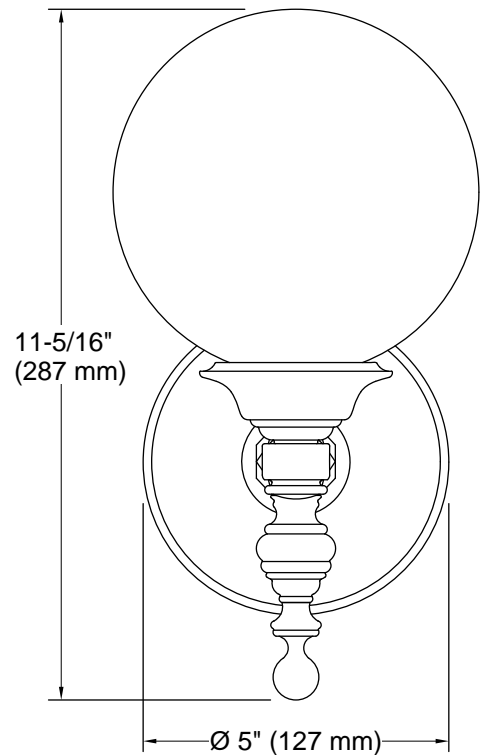
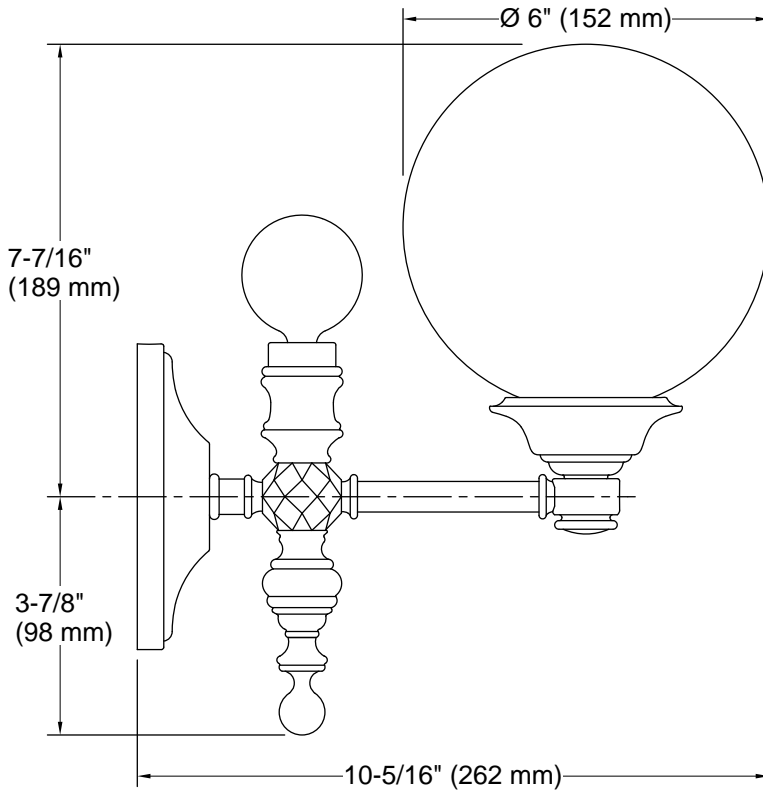

**Required Electrical Service**

One circuit required.

Lights: 120 V, 0.5 A, 60 Hz

**Technical Information**

All product dimensions are nominal.

Material:	Brass
Number of Lights:	1
Lighting Type:	Socket-based
Socket Type:	E-12 Candelabra
Number of Shades:	1
Shade Type:	Glass - clear
Hanging Type:	Non-hanging
Downrod Detail:	0 x
Electrical component rating:	Socket Rating: 60 Hz, 60 W, 450 Lumens, 2300K

1-800-4KOHLER (1-800-456-4537)

Kohler Co. reserves the right to make revisions without notice to product specifications.

For the most current Specification Sheet, go to [www.kohler.com](http://www.kohler.com) USA or [www.kohler.ca](http://www.kohler.ca) Canada

1-1-2025 21:15 - US/CA

THE BOLD LOOK  
OF **KOHLER®**