



MERCER II

60" x 36" Drop-In Acrylic Air Bath

Model Number
3660MAH-WH
Drop-In White Air Bath
3660MAH-BI
Drop-In Biscuit Air Bath

Features

- 20+ high output lateral air jets
- 12 Amp variable speed blower
- Constructed of high-gloss durable acrylic
- Pre-leveled base for easy installation
- Automatic purge cycle with timer
- Maintenance water heater included
- Can be installed as an undermount
- Made in the USA



All dimensions are +/- 1/2" and subject to change without notice
Confirm specifications before installation

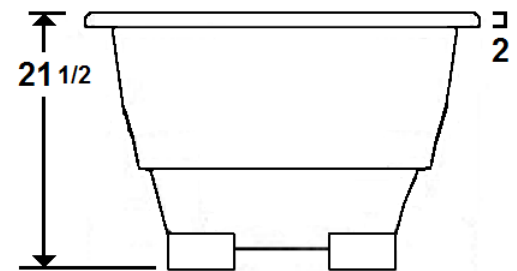
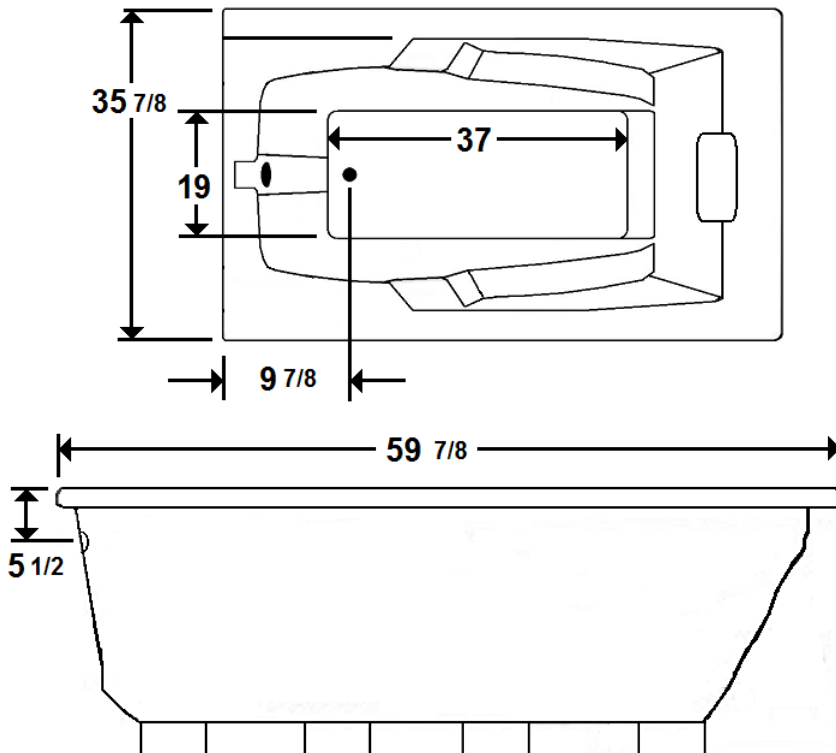

Standard (S) Blower
& Heater Location

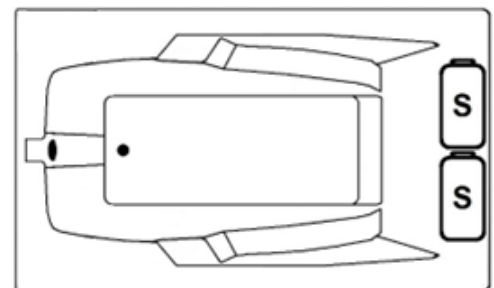

Technical Information

- Cut-Out Dimensions: 57 7/8" x 33 7/8"
- Weight: 135 lbs.
- Water Depth to Overflow: 15"
- Water Capacity: 58 gal.
- Sump Dimension: 37" x 19"

Electrical Requirements

- Standard Blower: 12 Amps
- Maintenance Heater: 12.5 Amps
- 2, 20 Amp Dedicated GFCI's required