



| Product Submittal | |
|-------------------|--|
| Name | |
| Date | |
| Architect/Owner | |
| Contractor | |
| Tag | |
| Notes | |

Compression Dual Outlet Stop Specification Sheet

Description

Control and shut off two fixtures or appliances from one stop valve. Ideal for maintenance and repair. 1/2 in. compression inlet connection makes for quick installation and quarter-turn, full-port brass ball valve makes for easy operation. Dual outlet stop valve allows for two fixtures to be controlled without affecting the water supply to the rest of the home.

Features And Benefits

- Sleek chrome finish for an attractive appearance.
- Quarter-turn, full-port brass ball valve prevents corrosion.
- Compatible with copper pipe.
- Can be installed in wet lines.

Specification Data

| Materials | |
|----------------|--------------|
| Valve body | DZR LF brass |
| Knurled Handle | ABS |
| Valve ball | DZR LF brass |
| Seat | PTFE |

Temperature Performance

- Minimum working temperature 33°F
- Maximum working temperature 160°F
- Maximum working pressure is 125 psi

Flow Rate

- 1/4" Compression 2.2 GPM at 20 psi
- 3/8" Compression 4.0 GPM at 20 psi



Part Listing

| | | |
|--------------------------|---------------|---|
| <input type="checkbox"/> | COMPDO123814Z | 1/2 in. Compression x 3/8 in. OD Compression x 1/4 in. OD Compression |
| <input type="checkbox"/> | COMPDO123838Z | 1/2 in. Compression x 3/8 in. OD Compression x 3/8 in. OD Compression |

Dimensions

| Part Number | DIM A (IN) | DIM B (IN) | DIM C (IN) |
|---------------|------------|------------|------------|
| COMPDO123814Z | 1.14 | 1.00 | 0.89 |
| COMPDO123838Z | 1.14 | 1.00 | 1.00 |

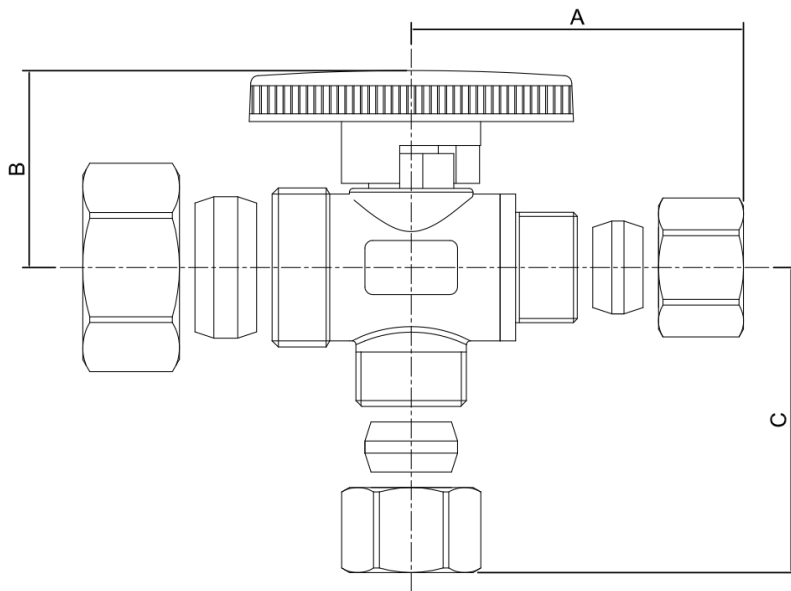

Codes and Listing

cUPC
 ASME A112.18.1
 CSA B125.1
 NSF/ANSI/CAN 61
 NSF/ANSI 372

