



HARBOR BREEZE and logo design are trademarks or registered trademarks of LF, LLC. All rights reserved.

ITEM #5127876/5190466

MODEL #42859/42860

# SHADWELL CEILING FAN

**Español p. 21**

**ATTACH YOUR RECEIPT HERE**

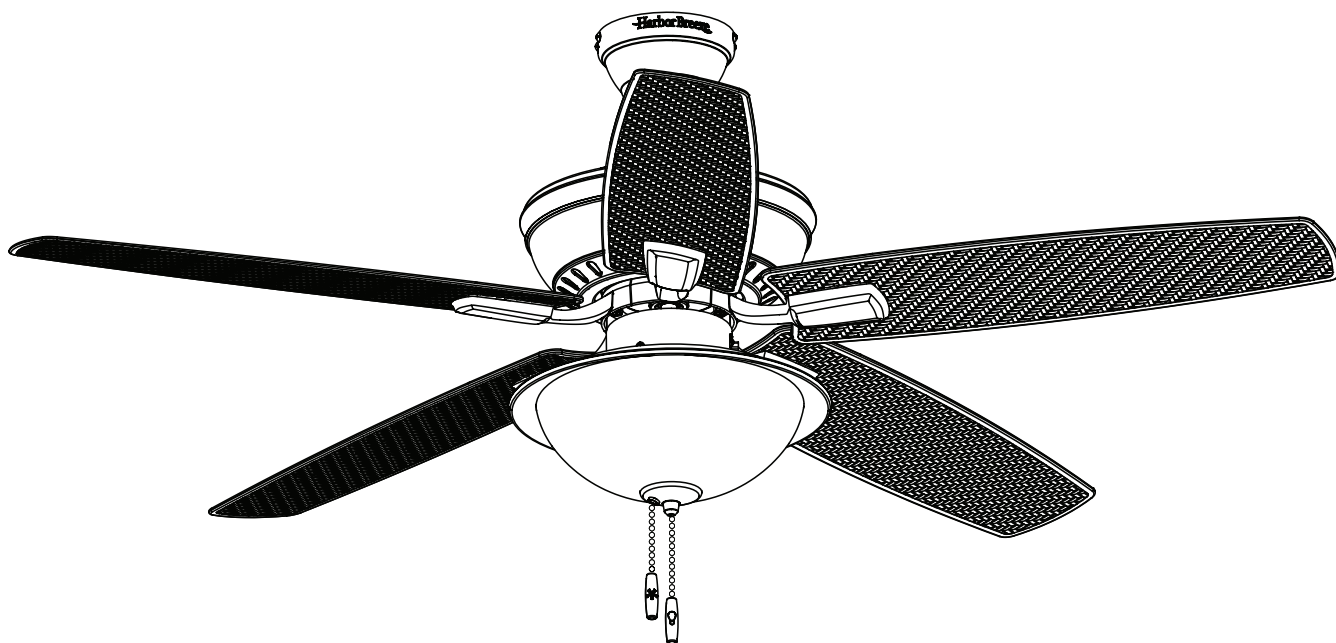

**Intertek**

**LISTED FOR  
WET LOCATION**

Purchase Date \_\_\_\_\_

Thank you for purchasing this HARBOR BREEZE product.  
Questions, problems, or missing parts?  
Before returning, contact us at:  
**888-251-1003**, 8 a.m. - 8 p.m., EST, Monday - Sunday or at **ascs@lowes.com**.

**TABLE OF CONTENTS**

---

Package Contents . . . . . 3

Hardware Contents . . . . . 4

Safety Information . . . . . 5

Preparation . . . . . 6

Initial Installation . . . . . 7

Standard or Angle Mounting Instructions. . . . . 9

Wiring . . . . . 11

Final Installation. . . . . 12

Operating Instructions . . . . . 16

Care and Maintenance . . . . . 17

Troubleshooting. . . . . 17

Limited Lifetime Warranty . . . . . 19

Replacement Parts List . . . . . 20

## PACKAGE CONTENTS

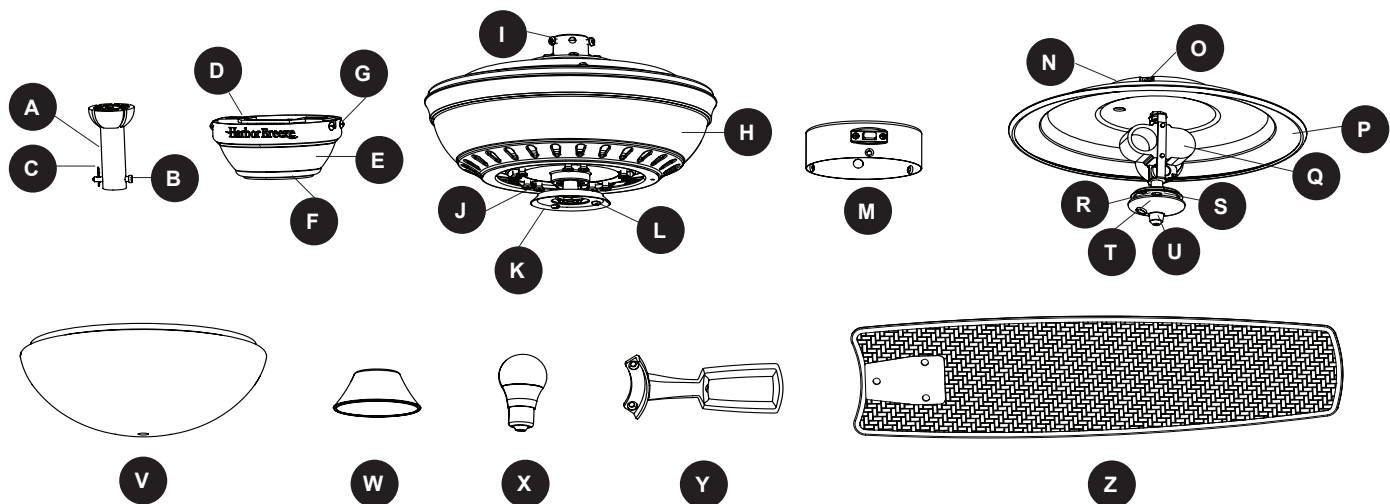

PART	DESCRIPTION	QUANTITY
A	Downrod	1
B	Downrod Pin (preassembled to Downrod [A])	1
C	Downrod Clip (preassembled to Downrod [A])	1
D	Mounting Bracket (preassembled to Canopy [E])	1
E	Canopy	1
F	Canopy Cover (preassembled to Canopy [E])	1
G	Mounting Bracket Screw (preassembled to Mounting Bracket [D])	4
H	Motor Assembly	1
I	Set Screw (preassembled to Motor Assembly [H])	2
J	Motor Screw (preassembled to Motor Assembly [H])	10
K	Fitter Plate (preassembled to Motor Assembly [H])	1
L	Fitter Plate Screw (preassembled to Fitter Plate [K])	3
M	Switch Housing	1
N	Switch Housing Cap (preassembled to Light Kit [Q])	1
O	Switch Housing Screw (preassembled to Switch Housing Cap (N))	3
P	Hood (preassembled to Light Kit [Q])	1
Q	Light Kit	1
R	Hex Nut (preassembled to Light Kit [Q])	1
S	Rubber Washer (preassembled to Light Kit [Q])	1
T	Finial Cap (preassembled to Light Kit [Q])	1
U	Finial (preassembled to Light Kit [Q])	1
V	Glass Bowl	1
W	Yoke Cover	1
X	Bulb	2
Y	Blade Arm	5
Z	Blade	5

**HARDWARE CONTENTS** (shown actual size)

---

**AA**



Wire Connector  
Qty. 3  
+ 1 extra

**BB**



Blade Screw  
Qty. 15  
+ 1 extra

**CC**

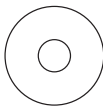

Blade Washer  
Qty. 15  
+ 1 extra

**DD**

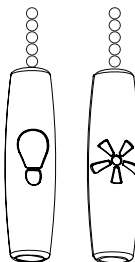

Pull Chain Extension  
Qty. 2

**GG**

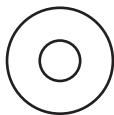

Rubber Washer  
Qty. 15  
+ 1 extra

**XX**

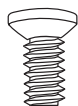

Motor Screw  
1 extra

## SAFETY INFORMATION

---

Please read and understand this entire manual before attempting to assemble, operate or install the product.

- Before you begin installing the fan, disconnect the power by removing fuses or turning off the circuit breakers.
- Make sure all electrical connections comply with local codes, ordinances, the National Electrical Code and ANSI/NFPA 70-199. Hire a qualified electrician or consult a do-it-yourself wiring handbook if you are unfamiliar with installing electrical wiring.
- Make sure the installation site you choose allows a minimum clearance of 7 ft. from the blades to the floor and at least 30 in. from the end of the blades to any obstruction.
- The net weight of this fan is: 19.56 lbs.

 **DANGER:** When using an existing outlet box, make sure the outlet box is securely attached to the building structure and can support the full weight of the fan. Failure to do this can result in serious injury or death. The stability of the outlet box is essential in minimizing wobble and noise in the fan after installation is complete.

 **WARNING:** To avoid personal injury, the use of gloves may be necessary while handling fan parts with sharp edges.

 **DANGER:** If using the fan in a wet location, the fan must be connected to a supply circuit that is protected by a Ground Fault Circuit Interrupter (GFCI) to reduce the risk of personal injury, electrical shock or death.

 **WARNING:** Using a full-range dimmer switch to control fan speed will cause a loud humming noise from the fan. To reduce the risk of fire or electric shock, do NOT use a full-range dimmer switch to control the fan speed.

 **WARNING:** To reduce the risk of fire, electric shock or personal injury, mount the fan to an outlet box marked “ACCEPTABLE FOR FAN SUPPORT” and use the mounting screws provided with the outlet box. Most outlet boxes commonly used for the support of lighting fixtures are not acceptable for fan support and may need to be replaced. Consult a qualified electrician if in doubt. Secure the outlet box directly to the building structure. The outlet box and its support must be able to support the moving weight of the fan (at least 35 lbs.).

 **WARNING:** To reduce the risk of fire, electric shock or personal injury, wire connectors provided with this fan are designed to accept only one 12-gauge house wire and two lead wires from the fan. If your house wire is larger than 12-gauge and/or there is more than one house wire to connect to the two fan lead wires, consult an electrician for the proper size wire connectors to use.

 **WARNING:** To reduce the risk of fire, electric shock or personal injury, do not bend the blade arms when installing them, balancing the blades or cleaning the fan. Do not insert objects between the rotating fan blades.

 **WARNING:** To reduce the risk of personal injury, use only parts provided with this fan. The use of parts OTHER than those provided with this fan will void the warranty.

## SAFETY INFORMATION

---

**CAUTION:** Read all instructions and safety information before installing your new fan. Review the accompanying assembly diagrams.

**CAUTION:** Be sure the outlet box is properly grounded or that a ground (green or bare) wire is present.

**CAUTION:** Carefully check all screws, bolts and nuts on the fan motor assembly to ensure they are secured.

**CAUTION:** This device complies with Part 15 of the FCC Rules. Operation is subject to the following two conditions: (1) this device may not cause interference, and (2) this device must accept any interference, including interference that may cause undesired operation of the device.

**CAUTION:** This equipment has been tested and found to comply with the limits for a Class B digital device, pursuant to Part 15 of the FCC Rules. These limits are designed to provide reasonable protection against harmful interference in a residential installation. This equipment generates, uses and can radiate radio frequency energy and, if not installed and used in accordance with the instructions, may cause harmful interference to radio communications. However, there is no guarantee that interference will not occur in a particular installation. If this equipment does cause harmful interference to radio or television reception, which can be determined by turning the equipment off and on, the user is encouraged to try to correct the interference by one or more of the following measures:

- Reorient or relocate the receiving antenna.
- Increase the separation between the equipment and receiver.
- Connect the equipment into an outlet on a circuit different from that to which the receiver is connected.
- Consult the dealer or an experienced radio/TV technician for help.

Please note changes or modifications not expressly approved by the party responsible for compliance could void the user's authority to operate the equipment.

HKC-US  
3350 Players Club Pkwy. #225  
Memphis, TN 38125  
888-251-1003

## PREPARATION

---

Before beginning the assembly of this product, ensure that all parts are present. Compare all parts with the package contents list and hardware contents list. If any part is missing or damaged, do not attempt to assemble the product.

**Estimated Assembly Time:** 120 minutes

Tools Required for Assembly (not included): Electrical Tape, Phillips Screwdriver, Pliers, Safety Glasses, Step Ladder, Wire Cutters and Wire Strippers

Helpful Tools (not included): AC Tester Light, Tape Measure and Wiring Handbook

## INITIAL INSTALLATION

1. Turn off the circuit breakers and the wall switch to the fan supply line leads.

**⚠ DANGER:** Failure to disconnect the power supply prior to installation may result in serious injury or death.

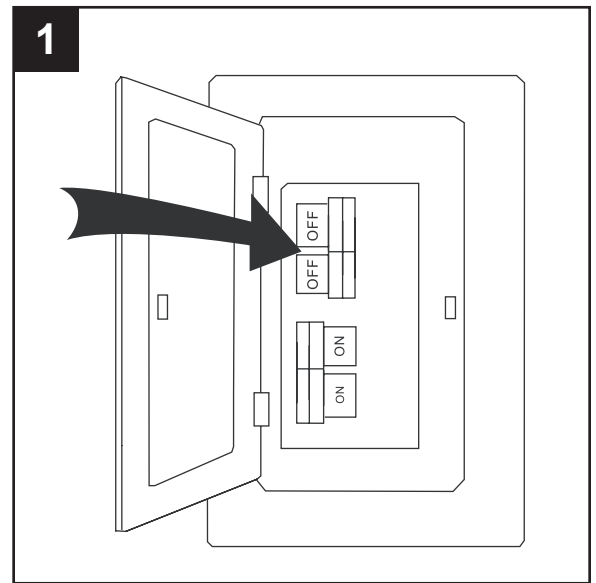

2. Determine the mounting method to use.

**Standard mounting** is best suited for ceilings 8 ft. or higher. For taller ceilings you may want to use a longer downrod (not included).

**Angle mounting** is best suited for angled or vaulted ceilings. A longer downrod is sometimes necessary to ensure proper blade clearance. **Note:** If using the angle mount, check to ensure the ceiling angle is not steeper than 16°.

**Closemount installation** is not available for this item.

**Flushmount installation** is not available for this item.

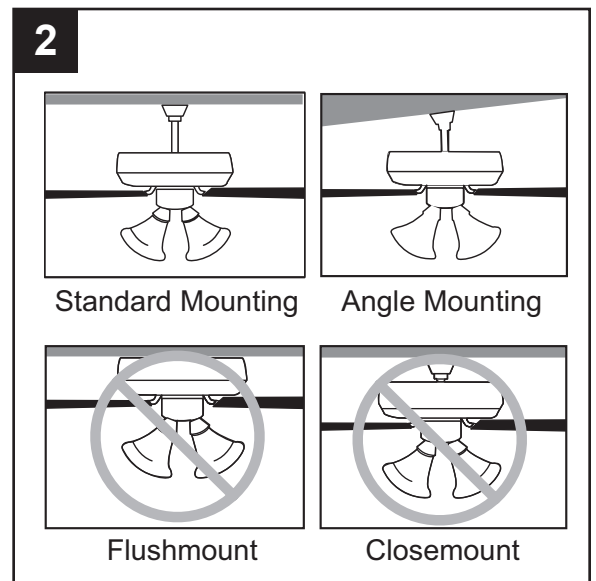

3. Ensure the blades (Z) will be at least 30 in. from any obstructions. Also check the downrod (A) length to ensure the blades (Z) will be at least 7 ft. above the floor.

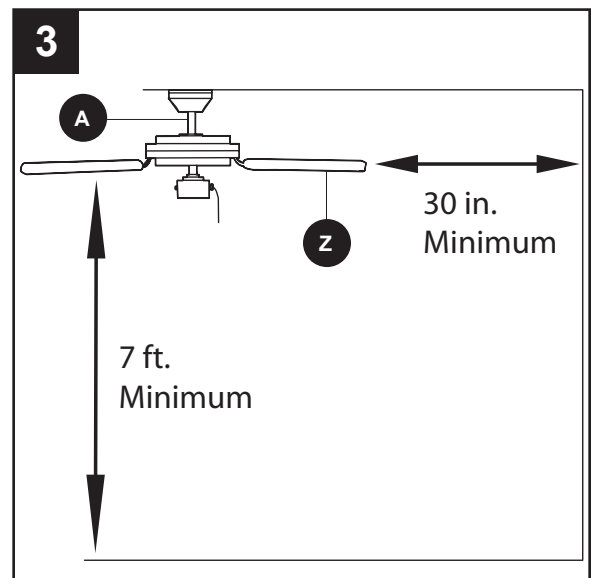

## INITIAL INSTALLATION

- Loosen all four preassembled mounting bracket screws (G), then completely remove the two mounting bracket screws (G) from the round holes of canopy (E). Set aside for later use.

Detach mounting bracket (D) from canopy (E).

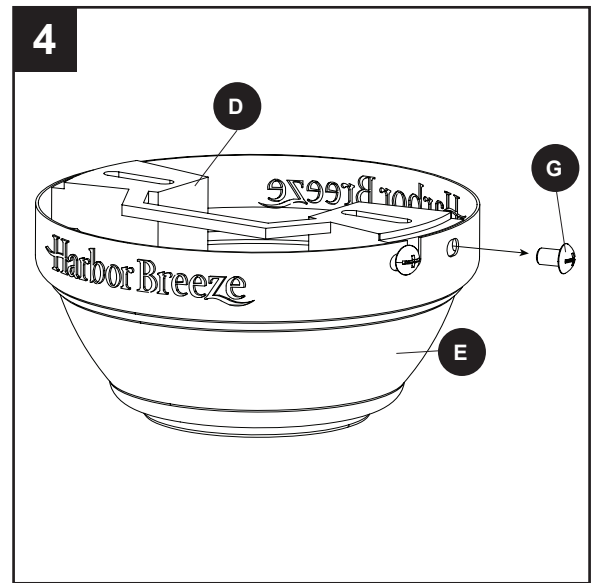

- Attach mounting bracket (D) to outlet box (not included) using screws and washers provided with the outlet box.

**CAUTION:** It is very important to use the proper hardware when installing the mounting bracket (D) as this will support the fan.

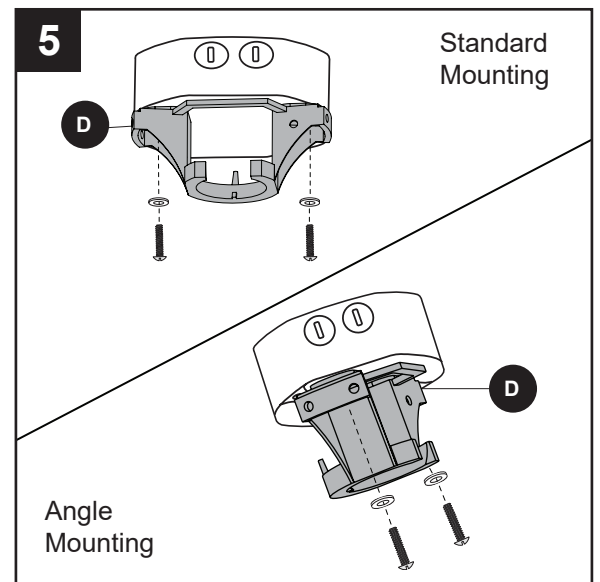

- Remove all 10 preassembled motor screws (J) and five preassembled plastic motor blocks from the underside of the motor assembly (H). Discard the motor blocks, but keep the motor screws (J) for later.

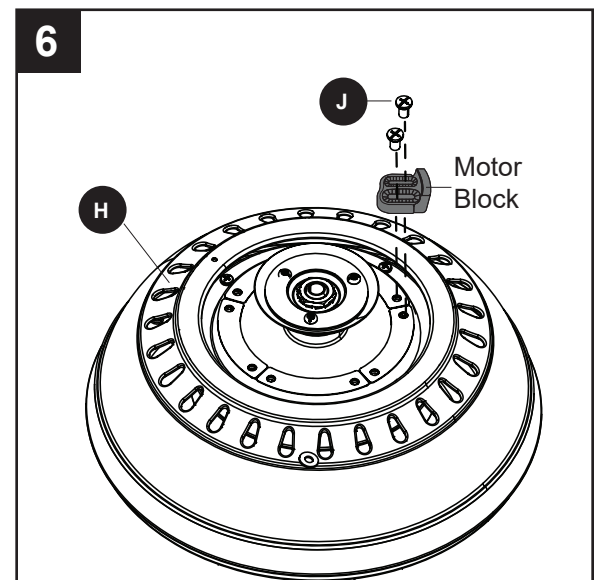

## STANDARD OR ANGLE MOUNTING INSTRUCTIONS

1. Remove the downrod clip (C) and downrod pin (B) from the downrod (A). Then partially loosen the set screws (I) in the yoke at the top of the motor assembly (H).

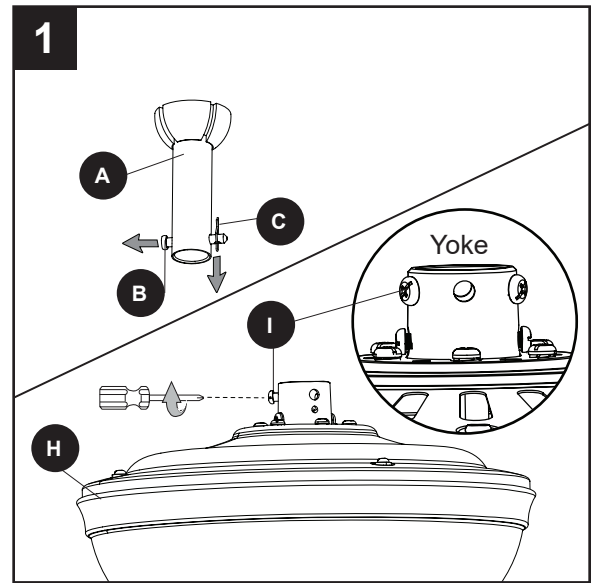

2. Insert the downrod (A) through the canopy (E) and yoke cover (W). Feed the wires from the motor assembly (H) through the downrod (A).

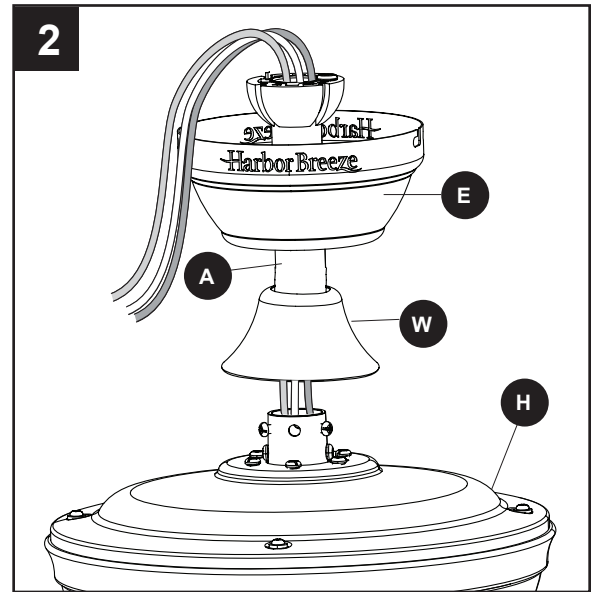

3. Slide the downrod (A) into the yoke of the motor assembly (H), align the holes, then re-install the downrod pin (B) and downrod clip (C). Secure with set screws (I).

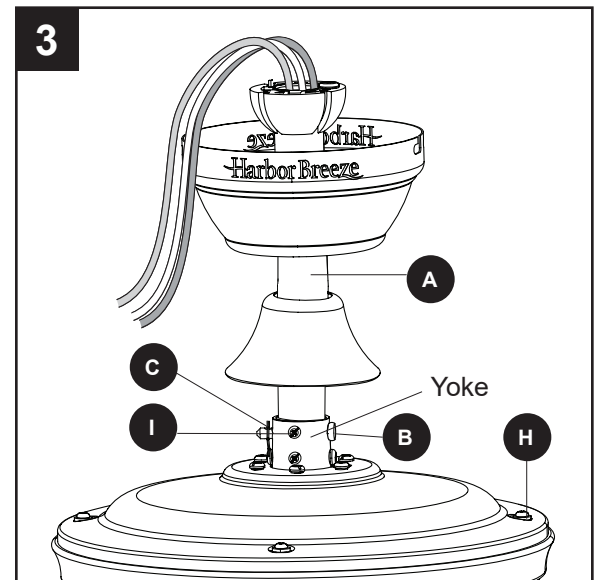

## STANDARD OR ANGLE MOUNTING INSTRUCTIONS

4. Depending on the length of downrod you use, you may need to cut the lead wires back to simplify the wiring. If you decide to cut back the lead wires, take the lead wires and make sure you have pulled them all the way through the top of the downrod. Measure at least 8 inches of lead wire, then cut the excess wire off with wire cutters (not included).

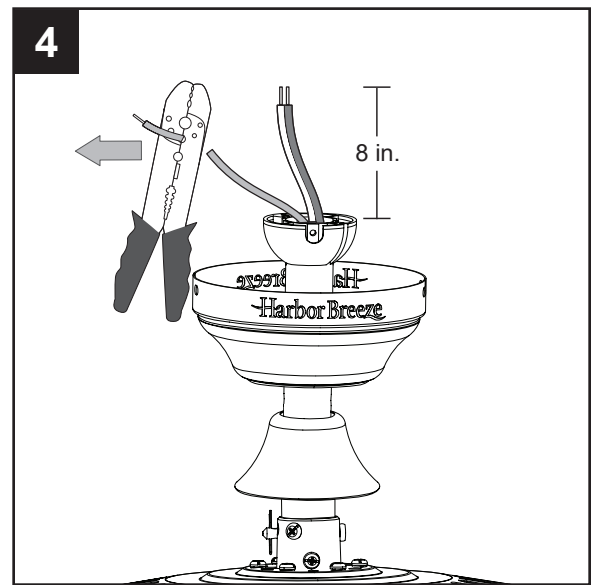

5. If you decided to cut back the lead wire in Step 4, strip 1/2 in. of insulation from the end of the white wire. Twist the stripped ends of each strand of wire within the insulation with pliers (not included). Repeat this step for black and blue wires.

**Note:** If you did not cut back the lead wires in Step 4, Step 5 is not necessary and you may proceed to Step 6.

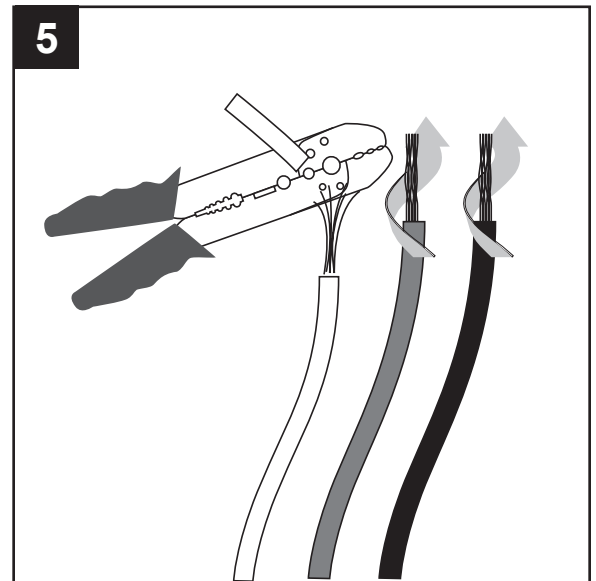

6. Install the ball end of the downrod (A) into the opening of mounting bracket (D). Align one of the four slots in the ball with the tab in the mounting bracket (D).

**Note:** The downrod (A) should not rotate if installed correctly.

**⚠ DANGER:** Failure to align the slot in the downrod (A) with the tab of the mounting bracket (D) may cause the fan to wobble or fall, which could result in serious injury or death.

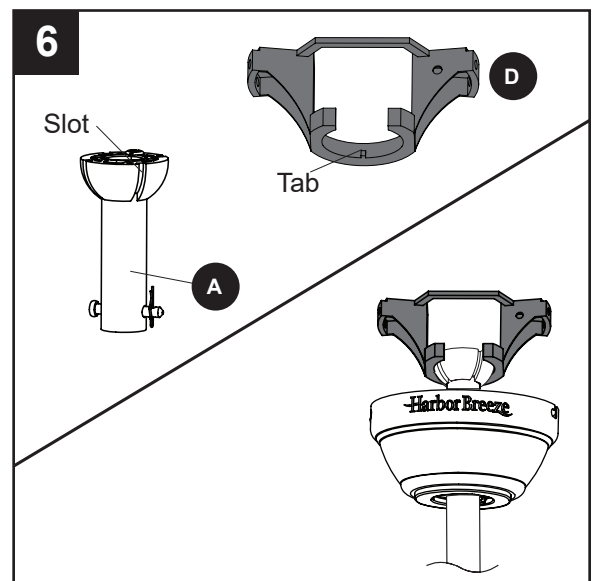

## WIRING

**⚠ WARNING:** To reduce the risk of fire, electrical shock or personal injury, wire connectors provided with this fan are designed to accept only one 12-gauge house wire and two lead wires from the fan. If your house wire is larger than 12-gauge and there is more than one house wire to connect to the two fan lead wires, consult an electrician for the proper size wire connectors to use.

**CAUTION:** Be sure the outlet box is properly grounded or that a ground (green or bare) wire is present.

1. Connect household supply and fan wires according to the diagram and these steps:

- Connect the Green wire from the downrod (A) and mounting bracket (D) to the Bare/Green (ground) supply wire.
- Connect the White wire from the fan to the White (neutral) supply wire.
- Connect the Black and Blue wires from the fan to the Black (hot) supply wire.
- Secure all wiring connections together with wire connectors (AA).

**Note:** If there is a second hot/power wire coming from the outlet box, connect it to the Blue (light power) fan wire for separate light and fan control.

**Note:** The Black wire is hot power for the fan. The White wire is common for the fan and light kit. The Blue wire is hot power for light. The Green wire is the ground wire. If household supply wires are different colors than referred to above, it is recommended a professional electrician determines the proper wiring.

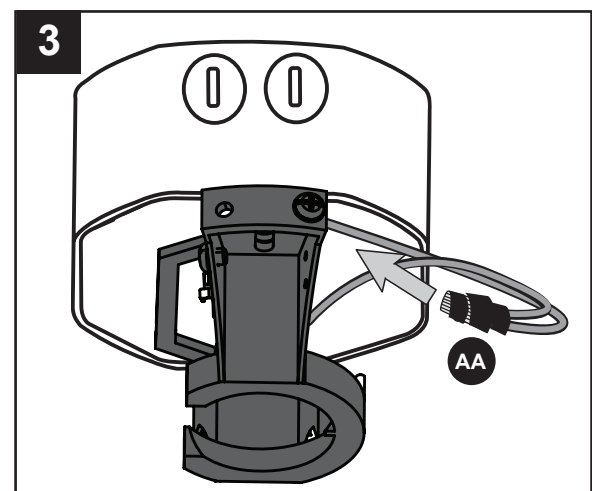
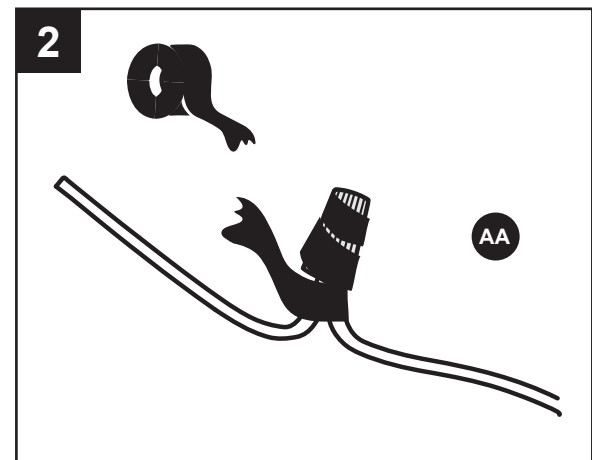
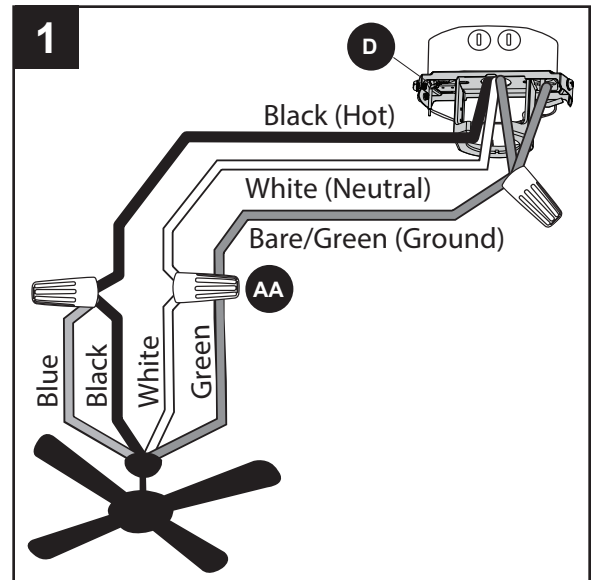

### Hardware Used

**AA** Wire Connector x 3

2. Wrap electrical tape (not included) around each individual wire connector (AA) down to the wire.
3. Turn the spliced/taped wires upward and gently push the wires and wire connectors (AA) into the outlet box.

**⚠ WARNING:** Ensure no bare wire or wire strands are visible after making connections. Place the Green and White wire connections on the opposite side of the outlet box from the Black and Blue wire connections.

## FINAL INSTALLATION

1. Align the canopy (E) over the loosened mounting bracket screws (G) preassembled on mounting bracket (D). Place the keyholes of the canopy (E) onto the mounting bracket screws (G) and rotate the canopy (E) clockwise.

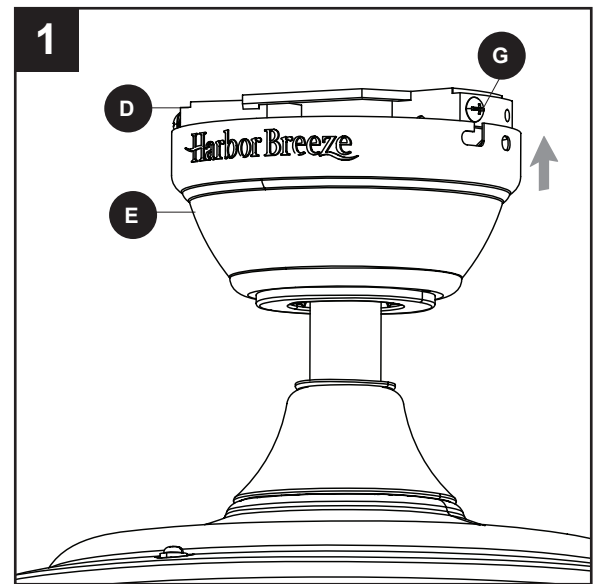

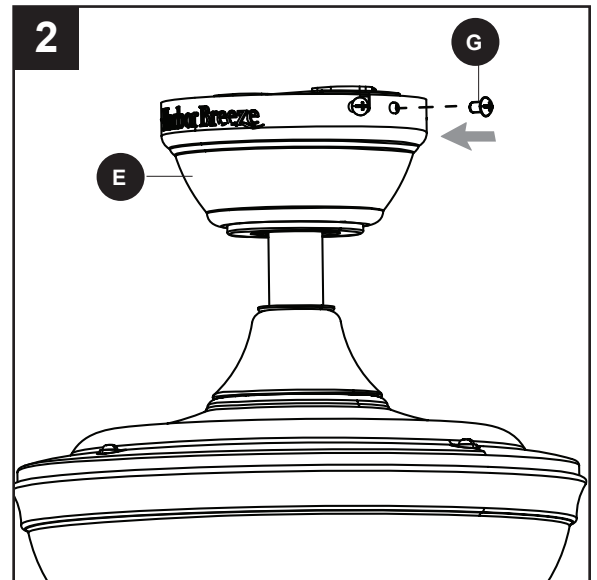

2. Secure the canopy (E) with the mounting bracket screws (G) previously removed (Step 4, page 8). Tighten all mounting bracket screws (G) securely.

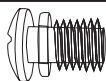

3. Partially insert the blade screws (BB) along with the blade washers (CC) and rubber washers (GG) through the blade (Z) and into the blade arm (Y). Tighten each blade screw (BB) with a Phillips screwdriver (not included), starting with the one in the middle. Repeat this step for the remaining blades (Z) and blade arms (Y).

### Hardware Used

<b>BB</b>	Blade Screw		x 15
<b>CC</b>	Blade Washer		x 15
<b>GG</b>	Rubber Washer		x 15

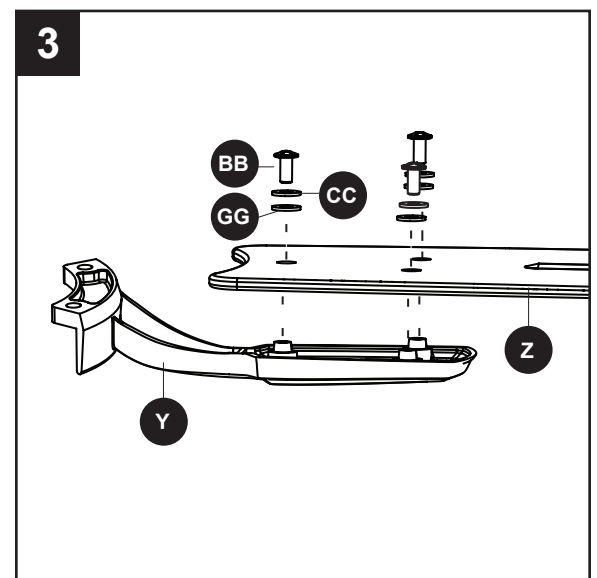

## FINAL INSTALLATION

4. Install the blade arm (Y) to the underside of the motor assembly (H) with motor screws (J) previously removed (Step 6, page 8). Tighten with Phillips screwdriver.  
Repeat for each blade arm (Y).

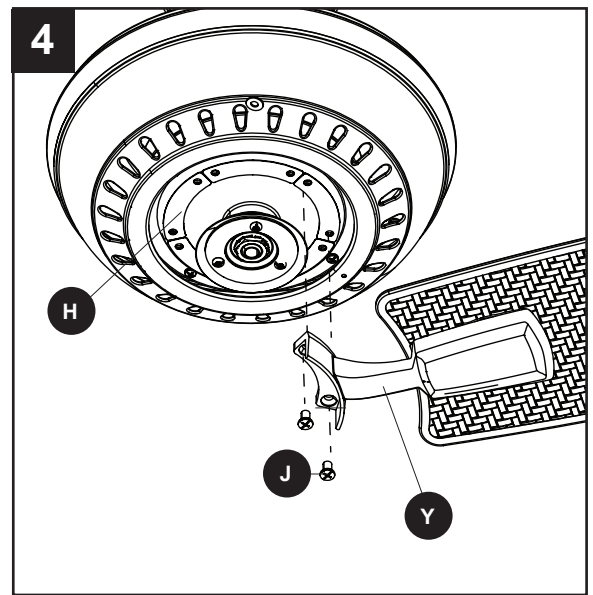

5. Remove one of the fitter plate screws (L) from the fitter plate (K), and loosen (do not remove) the other two screws.

Insert the 9-pin connector from fitter plate (K) through the hole in the switch housing (M). Then, attach the switch housing (M) to the fitter plate (K) by twisting the switch housing (M) until the loosened fitter plate screws (L) engage the keyholes on switch housing (M).

Re-install the third fitter plate screw (L) into the closed hole in the switch housing (M) and securely tighten all three fitter plate screws (L).

Connect the 9-pin connector from the fitter plate (K) to the 9-pin connector from the switch housing (M).

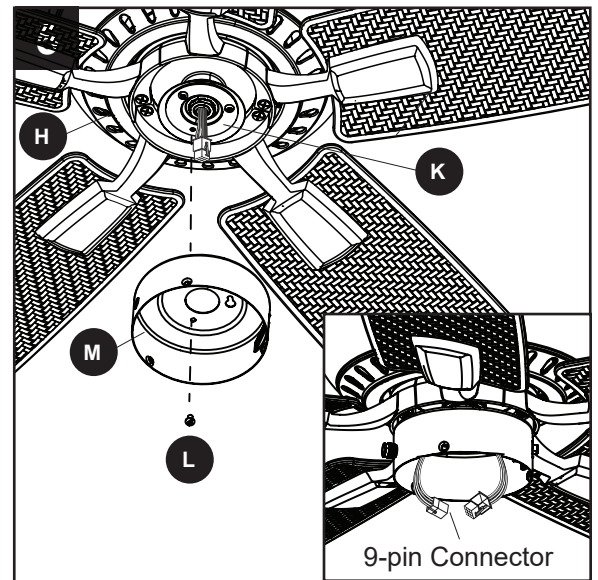

6. Remove the preassembled finial (U), finial cap (T), hex nut (R) and rubber washer (S) from the light kit (Q).

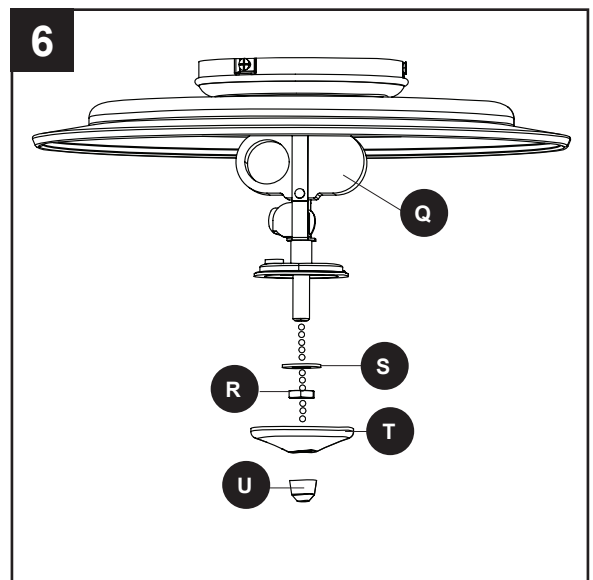

## FINAL INSTALLATION

7. Remove the three switch housing screws (O) from the switch housing cap (N). Then connect the single-pin connector from the switch housing (M) to the single-pin connector from the light kit (Q) -- Blue to Black and White to White. Feed the pull chain from the switch housing (M) through the hole in the switch housing cap (N) and down through the preassembled grommet on the lower part of the light kit (Q).

Then, secure the switch housing cap (N) with light kit (Q) to the switch housing (M) using the previously removed switch housing screws (O).

**IMPORTANT:** Ensure the hole for the pull chain, located in the switch housing cap (N), is aligned with the pull chain when installing the light kit (Q) to the switch housing (M).

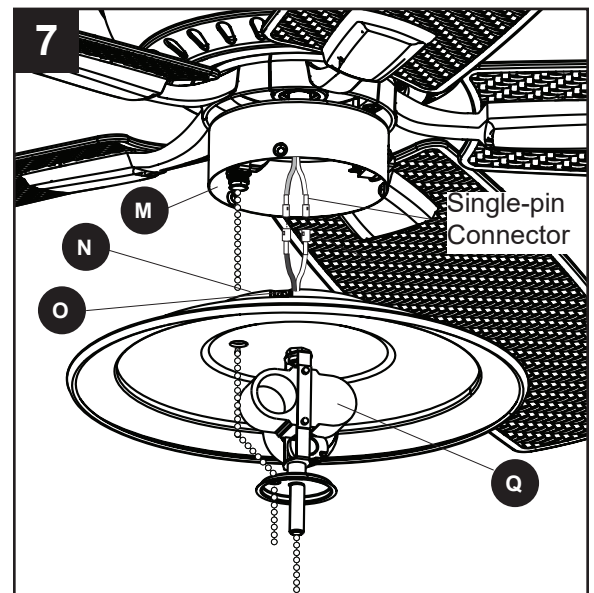

8. Install the bulbs (X) into the sockets on the light kit (Q).

**IMPORTANT:** Make sure you allow the bulbs (X) and light kit (Q) to cool before you replace the bulbs.

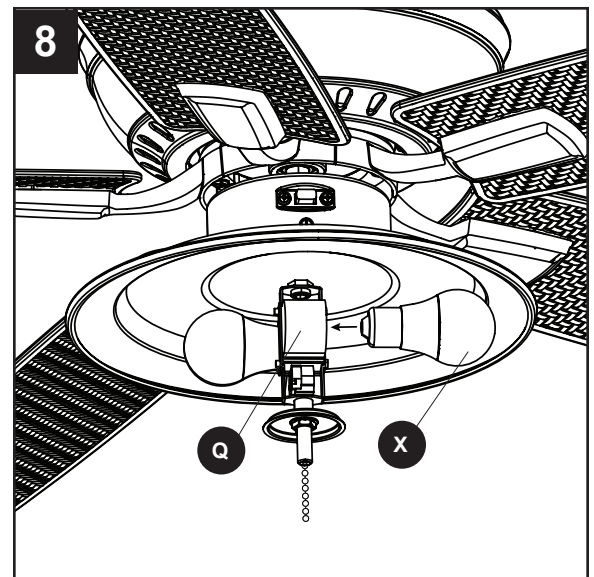

9. Feed pull chain coming from the center of the light kit (Q) through the center hole in the glass bowl (V). Feed the pull chain coming from the switch housing (M) through the off-center hole in the glass bowl (V). Re-install hex nut (R) and rubber washer (S). Feed the pull chains through the appropriate holes in the finial cap (T) and the hole in the finial (U), then lift the finial cap (T) up until it is flush with the glass bowl (V). Screw the finial (U) onto the threaded rod of the light kit (Q) to secure.

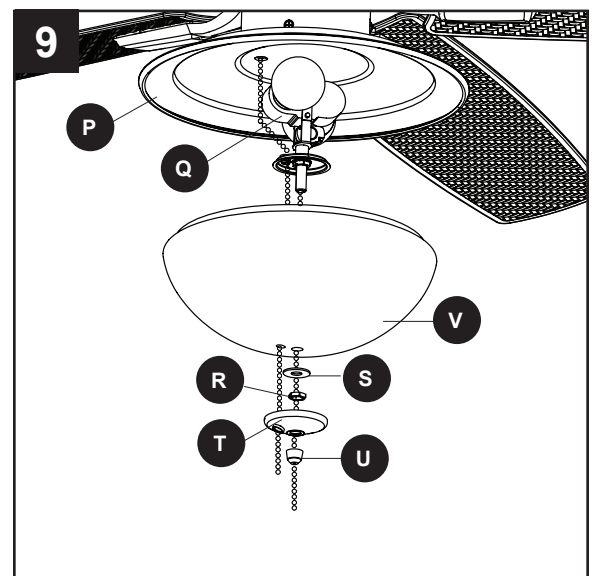

## FINAL INSTALLATION

10. Attach the pull chain extensions (DD) or custom pull chain extensions (not included) to the fan and light pull chains.

### Hardware Used



Pull Chain  
Extension

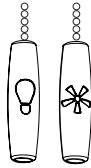

x 2

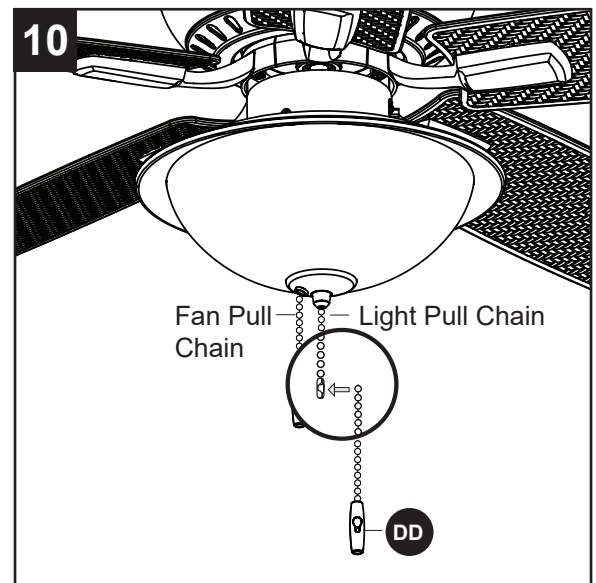

11. Turn on power supply to the fan.

**Assembly is complete.**

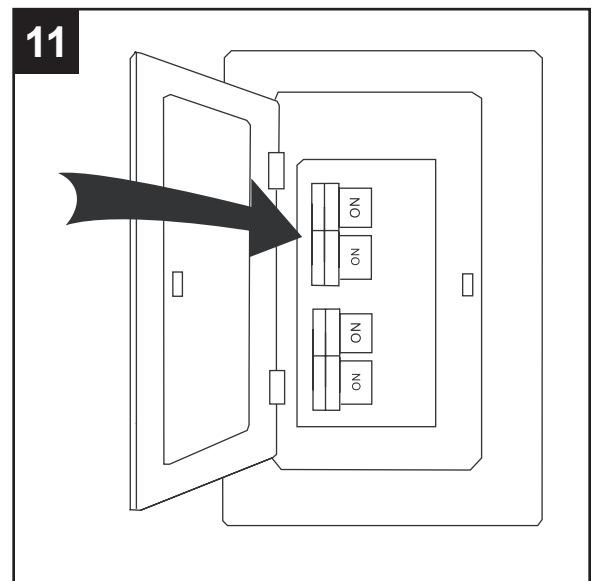

## OPERATING INSTRUCTIONS

1. The fan pull chain has four positions to control the fan speed. One pull is HIGH, two is MEDIUM, three is LOW, and four turns the fan OFF. The pull chain in the center of the light kit (Q), if applicable, turns the lights ON and OFF.

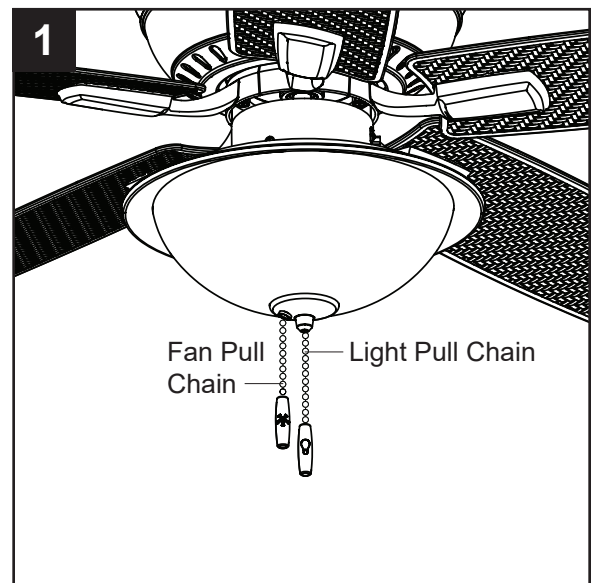

2. The reverse switch is located on the switch housing (M).

Using a ceiling fan will allow you to raise your thermostat setting in summer and lower your thermostat setting in winter without feeling a difference in your comfort.

**Note:** Wait for the fan to stop before moving the reverse switch.

2a. **In warmer weather**, push the reverse switch left, which will result in downward airflow creating a wind chill effect.

2b. **In cooler weather**, push the reverse switch right, which will result in upward airflow that can help move stagnant, hot air off the ceiling area.

**Important:** The reverse switch must be set either completely left or right in order for the fan to function correctly. If the reverse switch is set in the middle position, the fan will not operate (Fig. 2c).

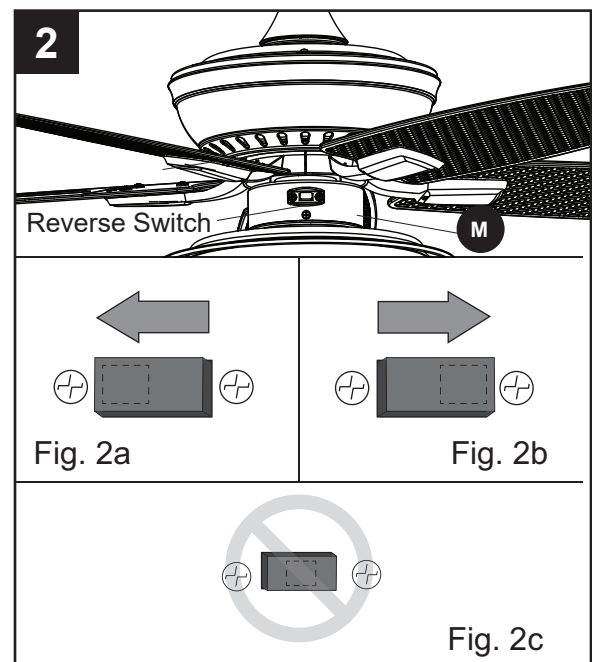

## CARE AND MAINTENANCE

At least twice each year, lower the canopy to check the downrod assembly, then tighten all screws on the fan. Clean the motor assembly with only a soft brush or lint-free cloth to avoid scratching the finish. Clean the blades with a lint-free cloth.

Bulb Replacement: Use 60-watt max. E26-base LED, CFL or incandescent bulbs. Halogen bulbs are not recommended for this item.

Shut off the main power supply before you begin any maintenance task. Do not use water or a damp cloth to clean the fan.

## TROUBLESHOOTING

PROBLEM	POSSIBLE CAUSE	CORRECTIVE ACTION
The fan does not move.	<ol style="list-style-type: none"><li>1. The reverse switch is not engaged.</li><li>2. The wall switch is turned off.</li><li>3. The power is off or the fuse (breaker) is blown.</li><li>4. There is a faulty wire connection.</li></ol>	<ol style="list-style-type: none"><li>1. Firmly push the reverse switch completely left or right.</li><li>2. Make sure the wall switch is turned on.</li><li>3. Turn the power on or check the fuse (breaker).</li><li>4. Turn the power off and check all connections at the ceiling outlet box.</li></ol>
The fan is noisy.	<ol style="list-style-type: none"><li>1. The blades are loose.</li><li>2. There is a cracked blade.</li><li>3. The wall control is not compatible with the fan.</li><li>4. The outlet box is not secure.</li><li>5. The mounting bracket is not secure.</li></ol>	<ol style="list-style-type: none"><li>1. Check and tighten all screws that hold the fan blades to the blade arms and the motor.</li><li>2. Replace the cracked blade.</li><li>3. Do not use a full range dimmer switch to control the fan speed.</li><li>4. Ensure the outlet box is secured to the building structure.</li><li>5. Ensure the mounting bracket is secured to the outlet box and that the screws are tight.</li></ol>

## TROUBLESHOOTING

PROBLEM	POSSIBLE CAUSE	CORRECTIVE ACTION
There is excessive wobbling.	<ol style="list-style-type: none"> <li>1. The blades and/or blade arms are loose.</li> <li>2. The blades are unbalanced.</li> <li>3. The fan mounting is not secure.</li> <li>4. The fan is too close to the vaulted ceiling.</li> <li>5. The set screws on the motor assembly yoke is loose.</li> </ol>	<ol style="list-style-type: none"> <li>1. Check and tighten all screws that hold the fan blades to the blade arms and the blade arms to the motor.</li> <li>2. Switch one blade with a blade from the opposite side. Or balance the fan using a blade balancing kit (sold separately).</li> <li>3. Turn off the power. Loosen the canopy and verify that the mounting bracket is secure to the electrical outlet box. The bracket must be flush without movement against the outlet box. Verify the outlet box is secure.</li> <li>4. Use a longer downrod (sold separately) or move the fan to another location.</li> <li>5. Lift up the yoke cover and tighten the set screws on the yoke until secure.</li> </ol>
The fan operates correctly, but the lights are not working.	<ol style="list-style-type: none"> <li>1. The bulbs are not installed correctly.</li> <li>2. The light kit wire plugs are not connected properly.</li> <li>3. There is a faulty wire connection.</li> </ol>	<ol style="list-style-type: none"> <li>1. Reinstall the bulb(s).</li> <li>2. Ensure the plugs in the switch housing are connected properly.</li> <li>3. Turn the power off and check all connections at the ceiling outlet box.</li> </ol>

## LIMITED LIFETIME WARRANTY

---

Set forth below, the manufacturer warrants the fan motor for this ceiling fan to be free from defects in workmanship and material for the life of the product. Also, subject to the limitations below, the manufacturer warrants all ceiling fan parts ("ceiling fan parts" excludes the motor and parts made in whole or in part with glass) to be free from defects in workmanship and material for a period of one year after the date of purchase by the original purchaser at retail.

All claims must be made by the original purchaser from an authorized dealer, whether such purchaser purchased the product through a store or contractor. Ceiling fan part defects must be reported within the first year from the date of purchase. Parts made in whole or in part with glass and the finishes of metal and other surfaces are not warranted.

Purchasers are responsible for all costs of removing and reinstalling the product. Any damage to any part caused by ordinary wear and tear, accident, misuse, or improper installation, is not covered by this warranty. The manufacturer assumes no responsibility whatsoever for fan installation. Any service performed by a non-licensed electrician will render the warranty invalid.

The manufacturer's sole responsibility shall be to repair or replace the motor, parts, or product within the terms stated above. The manufacturer shall not be liable for any loss or damage of any kind, including any incidental or consequential damages resulting directly or indirectly, from any breach of warranty, express or implied, or any other failure of this product. Some states do not allow the exclusion or limitation of incidental or consequential damages so this limitation may not apply to you.

If the original purchaser ceases to own the fan, this warranty is voided.

Should the purchaser encounter a problem with your fan related to defects in workmanship or materials within the warranty period associated with the defective part, the manufacturer agrees to replace the defective part without charge, or at its option, to replace the ceiling fan with a comparable or superior model.

The manufacturer's warranties are limited to the written warranties set out in this ceiling fan limited lifetime warranty. All other express and implied warranties, including, without limitation, the implied warranty of fitness for a particular purpose and the implied warranty of merchantability is disclaimed. Some states do not allow the disclaimer of implied warranties, so this disclaimer may not apply to you.

## REPLACEMENT PARTS LIST

For replacement parts, call the customer service department at **888-251-1003**, 8 a.m. - 8 p.m., EST, Monday - Sunday. You could also contact us at **ascs@lowes.com**.

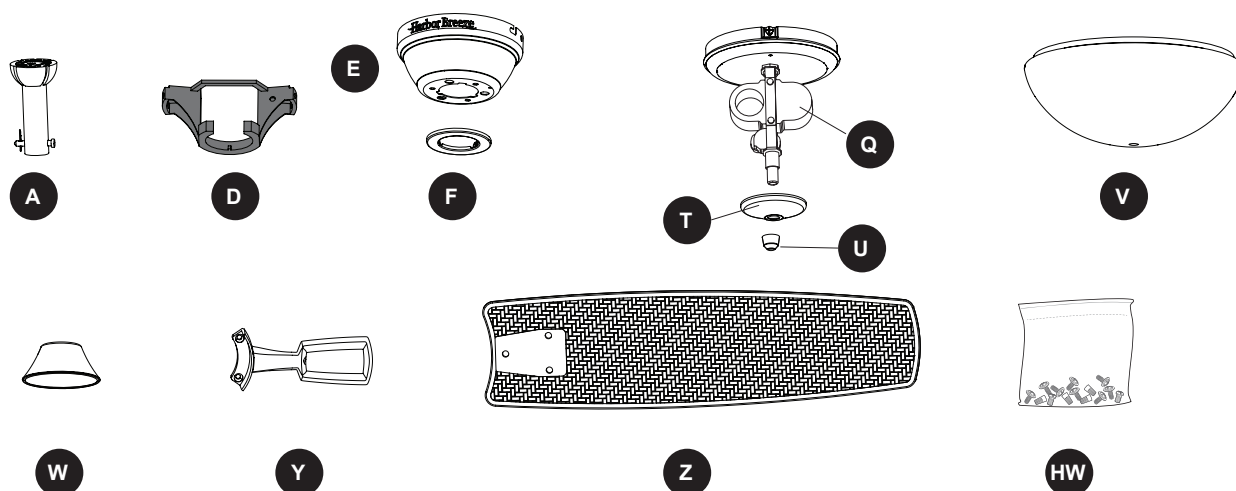

PART	DESCRIPTION	#5127876	#5190466	COVERED UNDER WARRANTY
A	Downrod	4L000016490	4L000016640	YES - 1 year
D	Mounting Bracket	4L000005310	4L000005310	YES - 1 year
E	Canopy	4L000016500	4L000016520	YES - 1 year
F	Canopy Cover	4L000016510	4L000016530	YES - 1 year
Q	Light Kit	4L000016560	4L000016570	YES - 1 year
T	Finial Cap	4L000016580	4L000016590	YES - 1 year
U	Finial	4L000016600	4L000016610	YES - 1 year
V	Glass Bowl	4L166350000	4L166350000	NO
W	Yoke Cover	4L000016540	4L000016550	YES - 1 year
Y	Blade Arm	4L073720005	4L073720006	YES - 1 year
Z	Blade	4L086290001	4L086290002	YES - 1 year
HW	Hardware Kit	4L000016620	4L000016630	NO