

ASSEMBLY INSTRUCTIONS



CAUTION

◆ Inspect the wire insulation for any cuts, abrasions, or exposed copper that may have resulted during shipping. If there is a defect in the wire, do not attempt installation.

◆ Before starting installation of this fixture or removal of a previous fixture, disconnect the power by turning off the circuit breaker or by removing the fuse at the fuse box.

✉ If you need further assistance, please contact us by Email: customersupport@superiordecorinc.com

TOOLS REQUIRED



Ladder



Safety glasses



Electrical tape



Phillips screwdriver



Flat blade screwdriver



Pliers

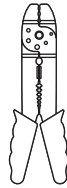

Wire strippers

HARDWARE INCLUDED

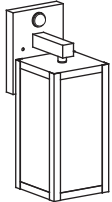

Fixture

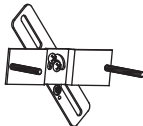

Mounting Unit



Ball Nuts



Rubber Rings



Mounting Screws



Wire Nuts

***PARTS SHOWN MAY DIFFER SLIGHTLY PER LIGHT FIXTURE**

EXPLODED PARTS

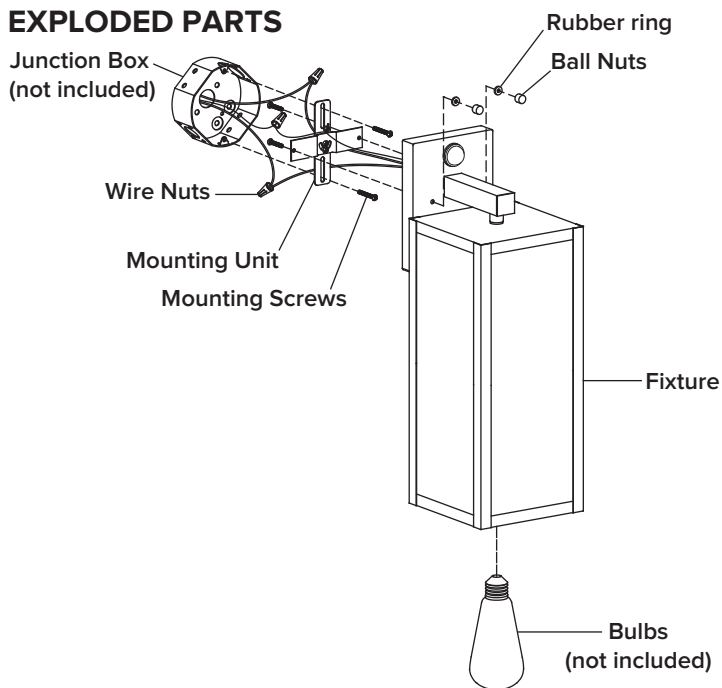

INSTALLATION

STEP 1

Unscrew the **rubber rings** and **ball nuts** from the **mounting unit**. Use the **mounting screws** to attach the **mounting unit** to the junction box (not included).

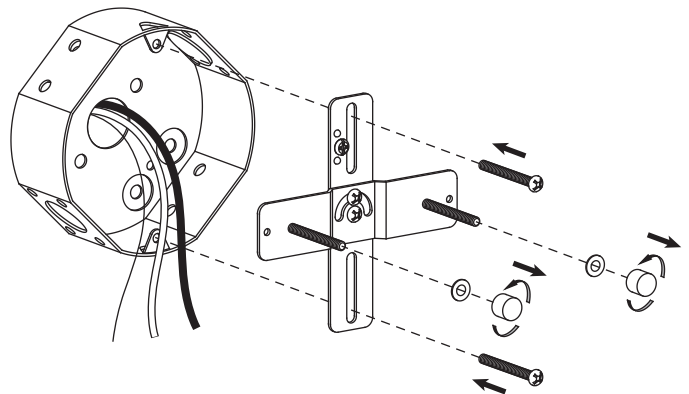

STEP 2

Make the electrical connection from the junction box (not included) to the **fixture**. Connect the ground wire to the **mounting unit** using the preinstalled green ground screw. Next, connect the live wire, neutral wire and ground wires with the supplied **wire nuts**. Secure with electrical tape.

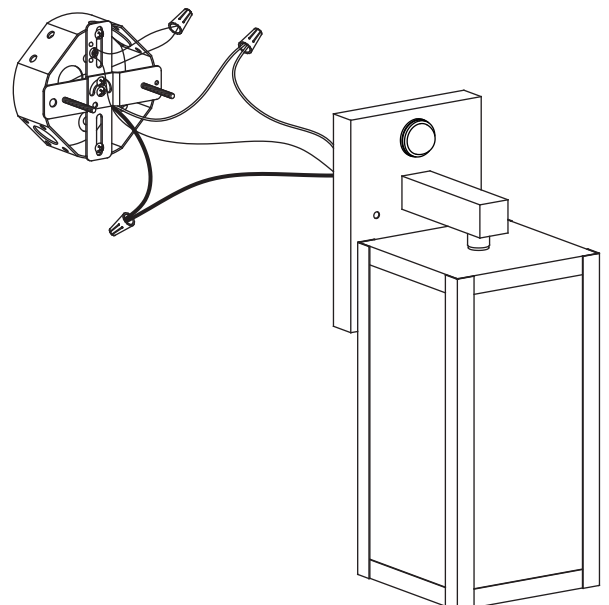

Black or Red wire
(live wire)
from the junction box

Black wire from
the fixture

White wire
(neutral wire)
from the junction box

White wire from
the fixture

Bare or Green ground wire
from the junction box

Ground wire from
the Fixture

*Green Ground Screw



*Sealing tape
(not included)

ASSEMBLY INSTRUCTIONS (INSTALLATION)

STEP 3

Attach the **fixture** to the **mounting unit** through screw holes as shown, and secure it with **rubber rings** and **ball nuts**.

NOTICE: Please use caulk in the back plate and wall mounting surface to prevent water from entering.

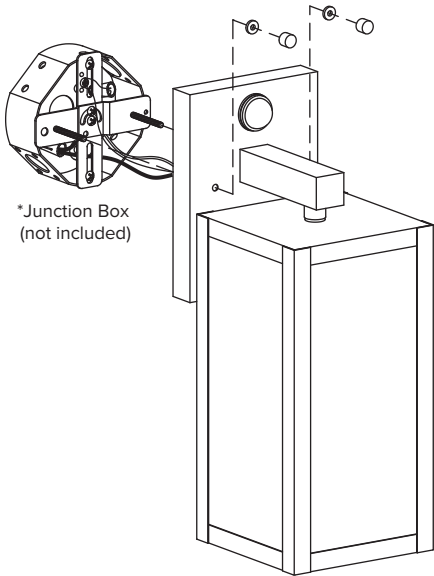

STEP 4

Install bulb (not included)

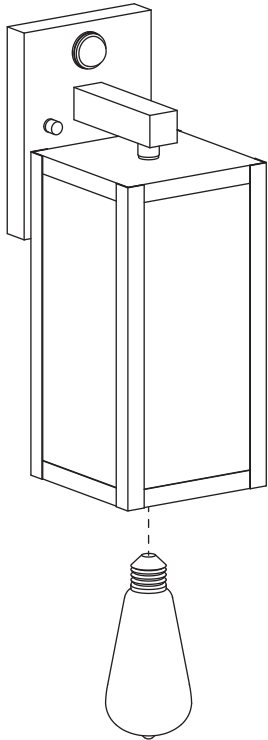

BASIC FUNCTION

- There will be **10** seconds of warm-up time after the product was powered on for the first time.
- This product does not light up during the daytime. When human activity was detected in the evening (ambient light $\leq 40\text{LUX}$), the light will be turned on. It will be off in a minute after the human body left the detection area.

ELECTRICAL PARAMETER

- Rated voltage: **120VAC/60Hz**.
- Load Rating : Max.**60W** Incandescent bulb or Max.**20W** LED light bulb.

DETECTION RANGE

- Motion sensor at full performance: **5ft-7ft** tall above the ground.
- Detection Angle Range: **110°**.
- Detection distance is MAX. **26.2ft (8 meters)**.
- Operating temperature range: **10°F-110°F**.

CAUTION

- Mounting the fixture above **7ft** or more may decrease the motion sensor's performance.
- Mounting the fixture in front of a sloped surface, such as an uphill Walkway, driveway, may decrease the motion sensor's performance.
- Walking out the **110°** range may cause less sensitive on motion sensor.
- Selecting locations near heat sources, such as heating vents, air conditioners, and heated swimming pools and hot tub may confuse sensor's accuracy rate.
- Selecting locations away from night time light sources, such as street lamps or other light fixtures. They may shine light into the fixture's dusk to dawn sensor causing confusion between daytime and nighttime.
- Selecting locations in daytime shadow area from any object may cause dusk to dawn sensor confused between daytime and nighttime.
- The detection range of the sensor should not be blocked by any objects.
- It has no dimmable function. It works for standard direct connection of input voltage only.**

ADDITIONAL NOTE

- Keep the surface of the PIR MOTION SENSOR clean to ensure proper operation.

TROUBLESHOOTING

PROBLEMS	POSSIBLE REASONS	SOLUTIONS
Bulb don't light on.	1. Wall switch or circuit breaker was off. 2. Light bulb may be dead. 3. Light bulb is loose. 4. Incorrect or loose wire connections. 5. Power is off.	1. Turn on switch or circuit breaker. 2. Test the light bulb in a known working lighting fixture. Replacing bulb if necessary. 3. Tighten the light bulb in socket. 4. Check the wire connections. 5. Ensure power supply is on.
The light does not turn on when there is motion from people or any other objects.	1. Too much sunlight is shining onto sensor in the early evening. 2. Too much light is shining onto sensor from other light source, such as a street lamp or other lighting fixtures. 3. Moving persons or other moving objects are below the view of the motion sensor.	1. Relocate fixture away from a west direction. 2. • Eliminate or turn on other light source. • Block other light source from shining onto sensor. • Relocate fixture. 3. Relocate fixture to a lower position or to a different location.
The light is on for no apparent reasons.	1. Street or sidewalk traffic is triggering the motion sensor. 2. False triggering caused by a heat source, such as a heater or dryer vent, or heated swimming pool, hottup.	1. Relocate fixture to a different location. 2. • Eliminate heat source. • Relocate lighting fixture.

