

# HOW TO MEASURE FOR MOULDING

## Measuring For Ceiling, Wall, and Floor Moulding

- Begin by making a sketch of your room.
- Measure the length of each wall.
- Round that number up to the nearest foot and record it on your sketch.
- Add those numbers together to achieve the lineal footage of moulding you will need.
- You will need to add 10% for waste, miter joints, etc.
- Be sure to deduct the width of any door ways or openings from your total to get an accurate footage for *wall* and *floor* moulding.

## Measuring For Window And Door Casing

- Begin by measuring the width and height for each of your window and door openings.
- Record those measurements on your sketch.
- The amount of casing for doors will be figured by the length of the legs or sides of the opening and a header across the top.
- \* *The amount of casing for windows will depend upon your decision to picture frame your windows or use a stool and apron. This decision is often based on the type of window you are casing (Picture Frame or Traditional Stool & Apron).*
- Total your measurements and remember to add 10% for waste, miter joints, etc.

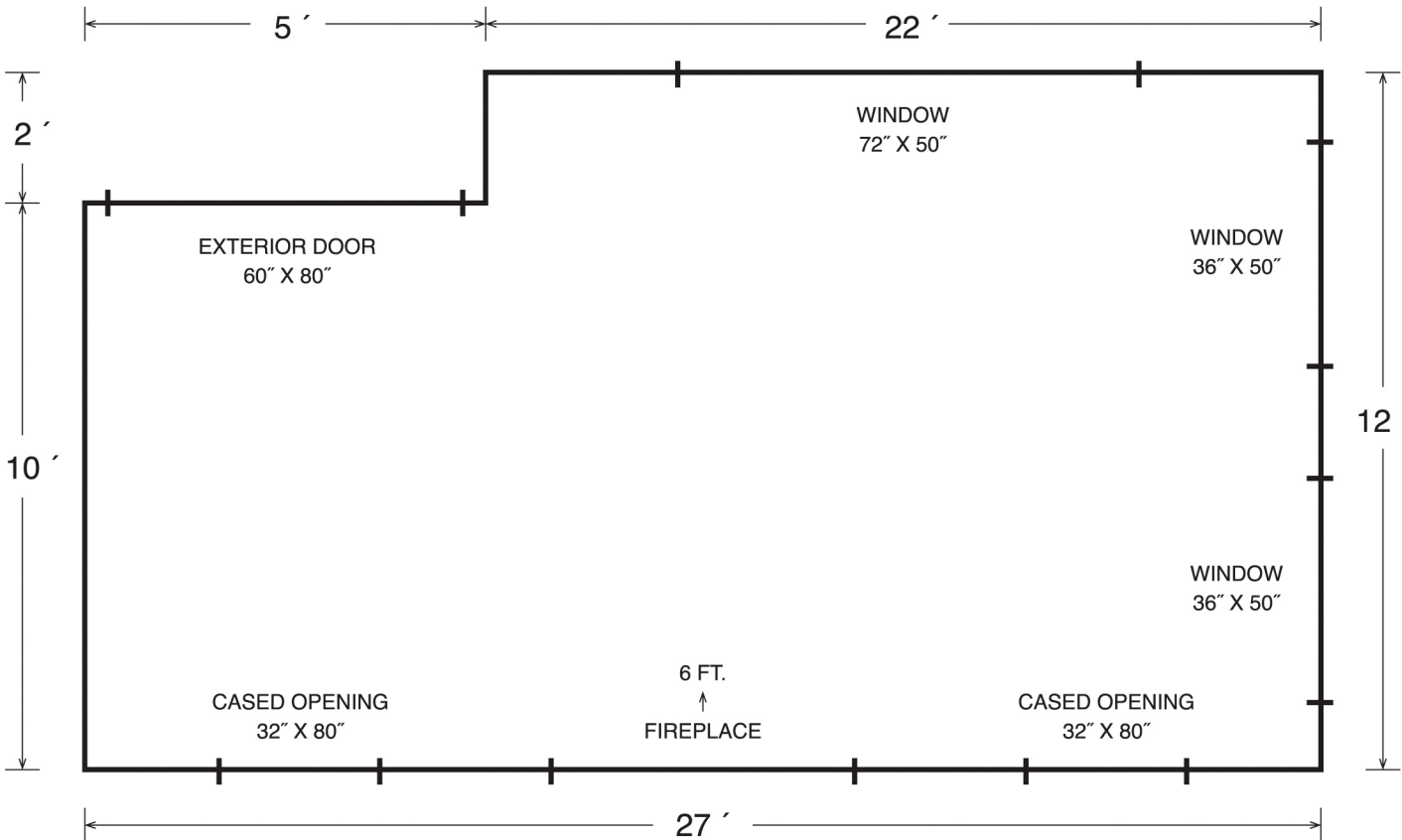

## \* Types of Window Casings

### Picture Frame

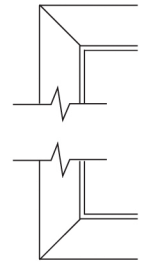

### Traditional Stool & Apron

