

ABOUT PRODUCT ASSEMBLY

Do not assemble the storage shed on severe cold or strong windy days.

We would advise 2 person to assist in the assembly of the storage shed to secure parts in place.

Please check your package according to the PARTS LIST in the instructions to ensure that there are no missing or damaged before you starting assembly, kindly contact us if you find any wrong.

Please read instructions thoroughly prior to assembly, assemble all the parts according to the directions in this instructions, do not skip and steps

Our company provides extra hardware for use as spare parts for customer convenience. **Please save the spare parts.**

We would kindly advise you to follow the instructions in the manual to install, wrong assembly methods can result in damage to the inside of the hole to create links between the panels loose or unable to assembled properly.

LEVEL THE GROUND SURFACE

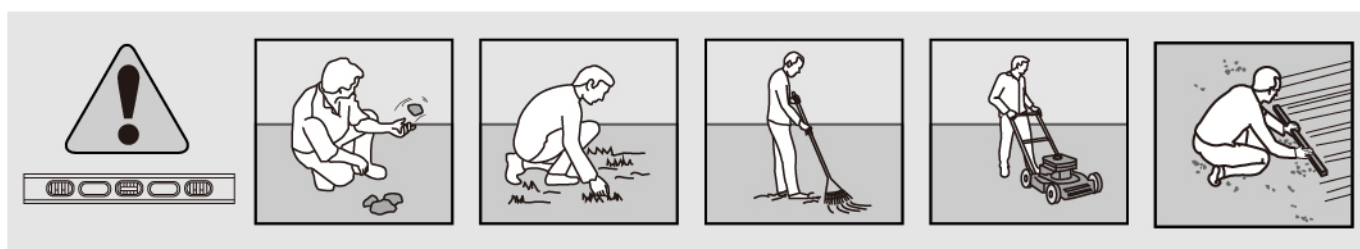

Level the ground surface before unpacking parts and beginning assembly.

REQUIRED TOOLS



Allen Key



Screwdriver

PARTS NUMBER POSITION

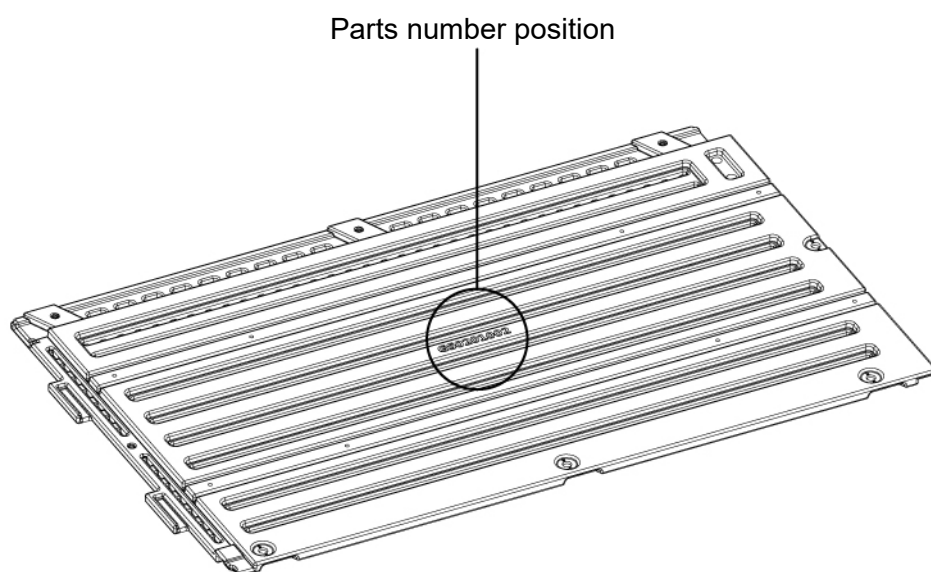

ABOUT PRODUCT MAINTENANCE

This storage shed should be far away from the open flame.

Do not use the storage shed in extreme weather conditions.

Do not stack more than 20 kg items on the storage shed roof all the time in case deformation of the roof.

At regular check the storage shed to ensure that it's stable and assembly integrity has been maintained.

Please keep doors closed and locked outdoor when the storage shed is not in use long time to prevent wind damaged or damaged by animals or bad people.

Do not store hot items(recently used grills, blowtorches etc.),flammable or caustic chemicals in the storage shed.

Wash the storage shed with a mild soap and water if there is any stain on the storage shed. Do not use a stiff brush,bleach,ammonia or any other caustic cleaners, as these may damage the storage shed or could result in permanent staining of the plastic.This is not manufacturing defect and is not covered under warranty.

If the environment permits, install the storage shed in a cool place, as prolonged exposure to direct sunlight may deform the panel and accelerate aging.

Parts List

A Carton

No.	Parts No.	Name	Material	Quantity	Specifications
1	GS0201001	Floor	HDPE	1	50.24*29.06*1.38 (inches)
2	GS0201008	Roof	HDPE	1	49.61*28.74*1.73 (inches)

B Carton

No.	Accessories No.	Name	Material	Quantity	Specifications
3	GS0201002	Left back panel	HDPE	1	40.16*23.74*0.98 (inches)
4	GS0201003	Right back panel	HDPE	1	40.16*21.78*0.98 (inches)
5	GS0201004	Left side panel	HDPE	1	40.16*27.32*4.53 (inches)
6	GS0201005	Right side panel	HDPE	1	40.16*27.32*4.5 (inches)
7	GS0201006	Left door	HDPE	1	38.86*23.43*1.5 (inches)
8	GS0201007	Right door	HDPE	1	38.86*22.56*1.5 (inches)
9	GS0201014	Hinge	Metal	6	70x38x25 (mm)
10	GS0201015	L hinge folding assembly	Metal	1	35x25x9 (mm)
11	GS0201016	L-1	Metal	1	37x20x16 (mm)
12	GS0201017	L-2	Metal	1	39x20x20 (mm)
13	GS0201018	Latch-1	Metal	1	61x40x15 (mm)
14	GS0201019	Latch-2	Metal	1	88x43x13 (mm)
15	GS0201020	Support rod	Metal	1	310x66x8 (mm)
16	GS0201021	Support rod fixing piece	Metal	1	38x16x1.5 (mm)
17	GS0201022	Plastic bolts	Plastic	6	M9.5x25.5 (mm)
18	GS0201023	Plastic bolts	Plastic	3	M9.5x18.5 (mm)
19	GS0201028	Strengthen the block	Metal	12	58x18x1.2 (mm)
20	Y202333	M4x10	Stainless steel	12	M4x10 (mm)
21	Y202338	M5.5x19	Stainless steel	24	M5.5x19 (mm)

22	AP27003-30	Instructions	/	1	/
23	AP27003-31	Spare parts	/	1	/

please save the spare parts.

Wall Panels and Floor

Left side panel
(GS0201004)

Left back panel
(GS0201002)

Right back panel
(GS0201003)

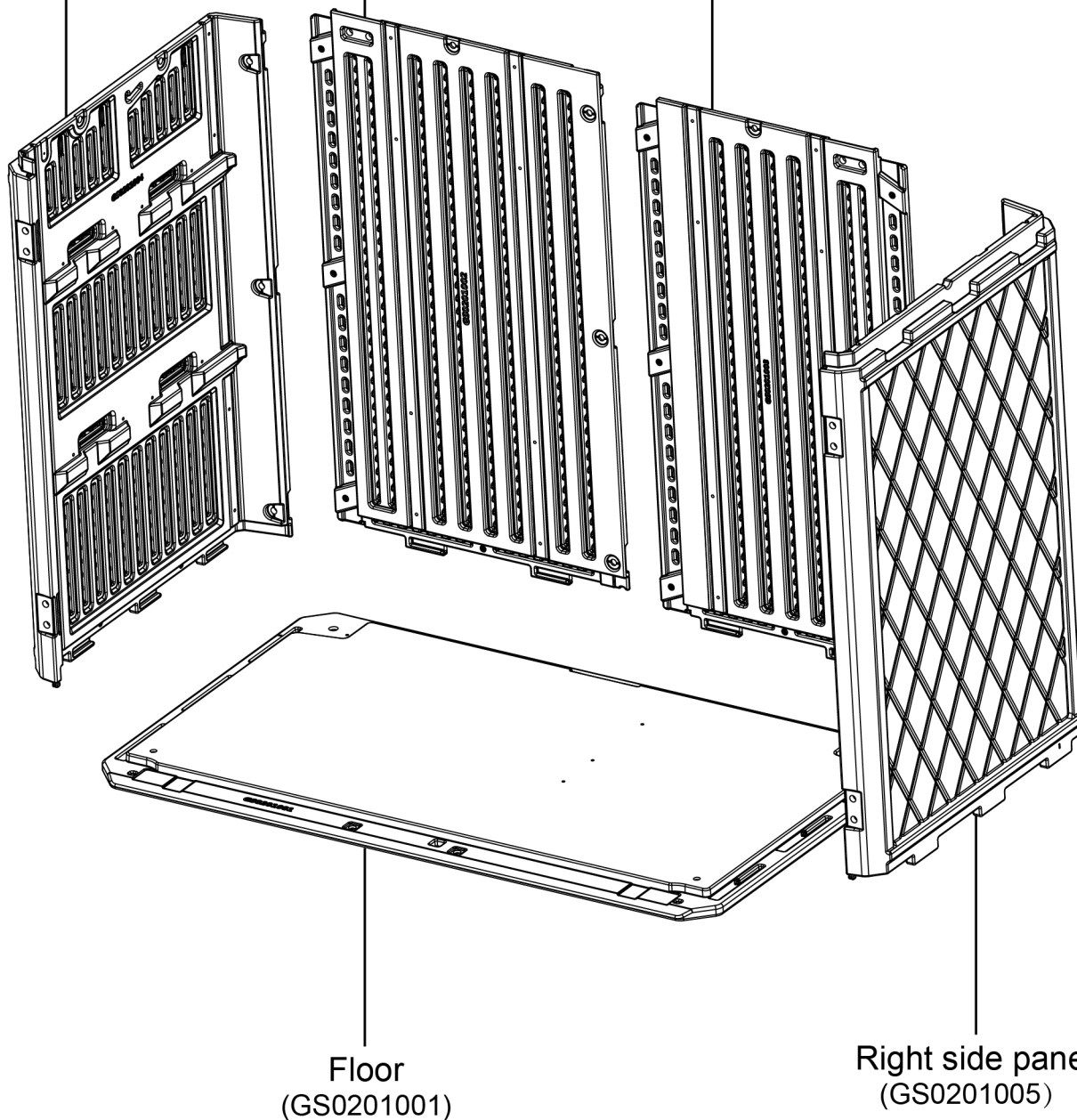
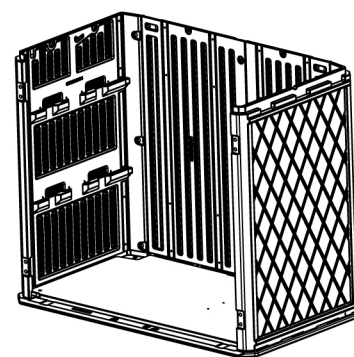

Floor
(GS0201001)

Right side panel
(GS0201005)

Doors and Roof

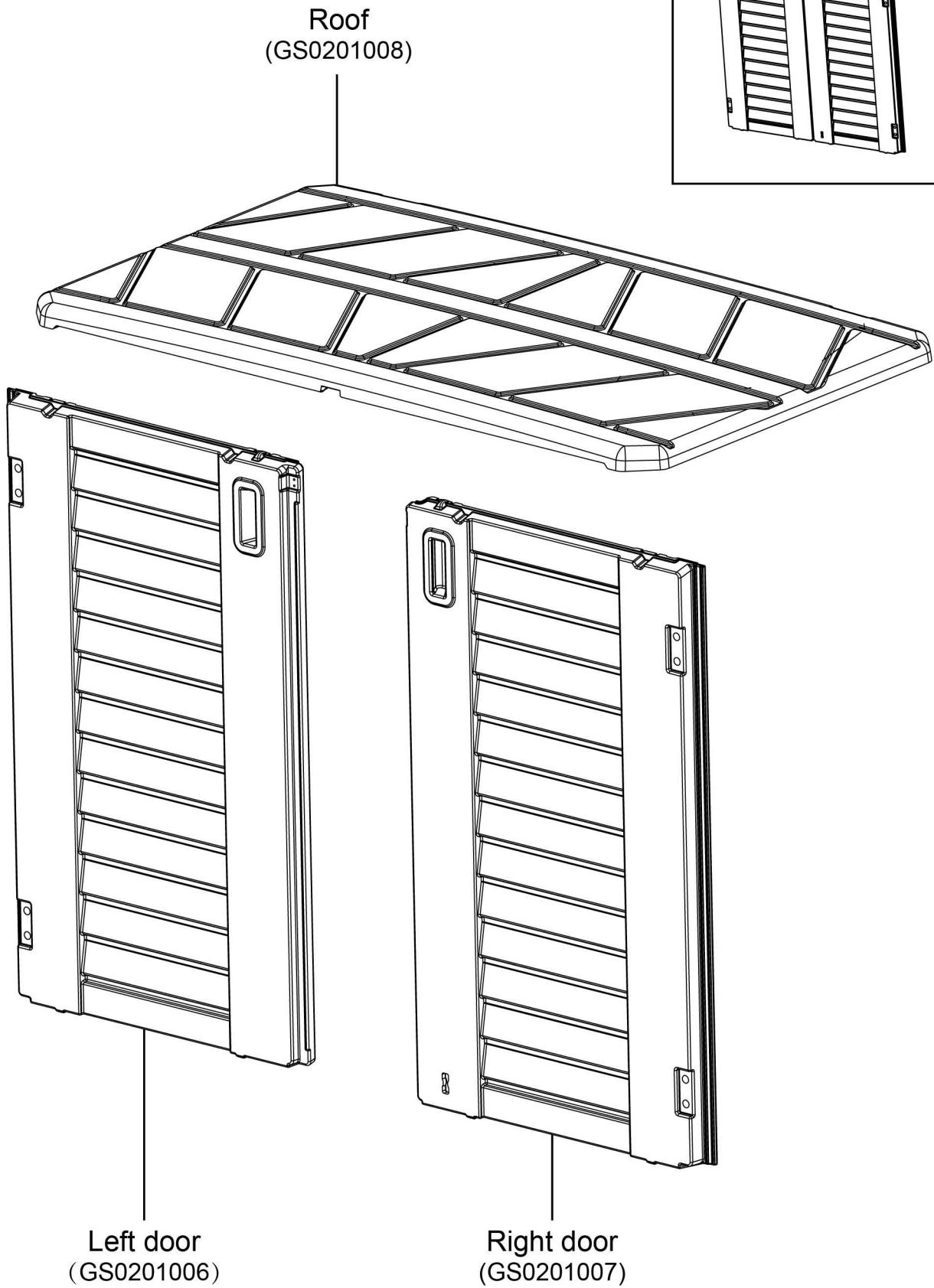

Hardware

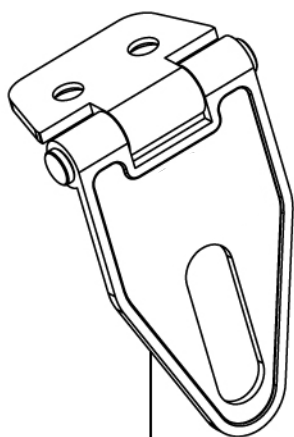

L hinge folding assembly
(GS0201015)x1pcs

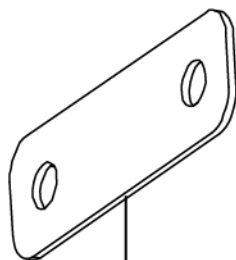

Strengthen the block
(GS0201028)x12pcs

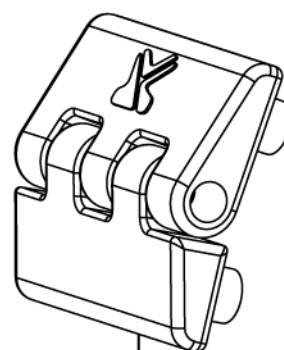

Hinge
(GS0201014)x6pcs

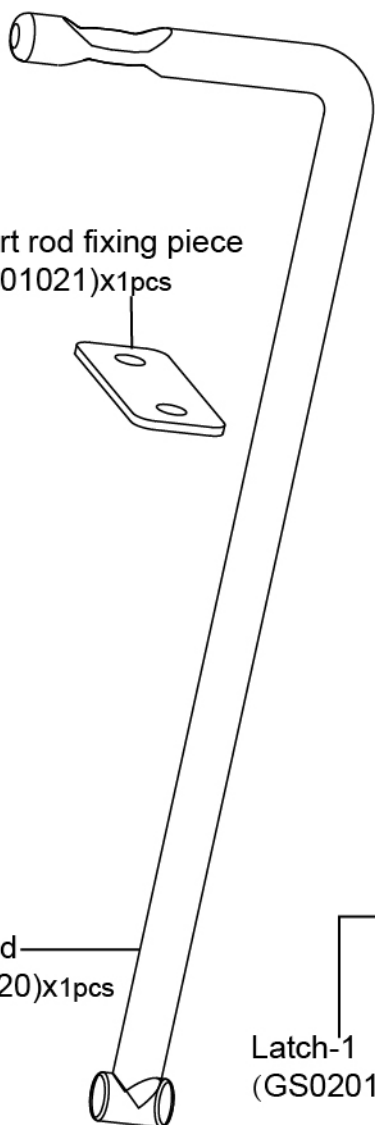

Support rod fixing piece
(GS0201021)x1pcs

Support rod
(GS0201020)x1pcs

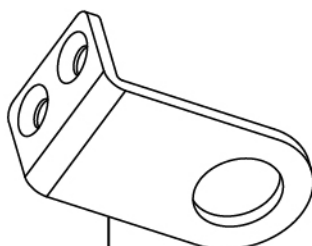

L-1
(GS0201016)x1pcs

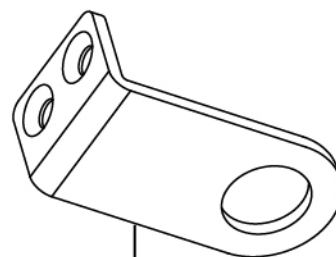

L-2
(GS0201017)x1pcs

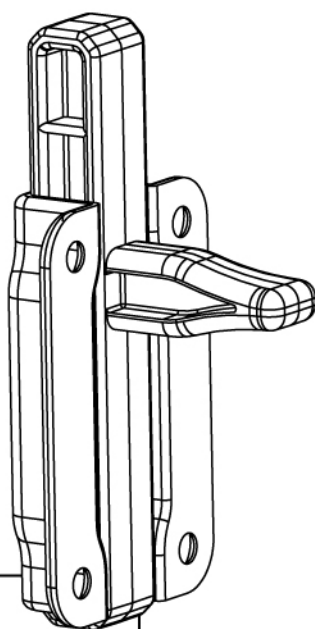

Latch-1
(GS0201018)x1pcs Latch-2
(GS0201019)x1pcs



Plastic bolts
GS0201023
M9.5*18.5x3pcs



Plastic bolts
GS0201022
M9.5*25.5x6pcs

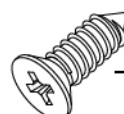

M4x10
Y202333
12pcs

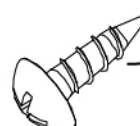

M5.5x19
Y202338
24pcs

1 Back panel to install

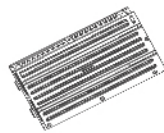

Left back panel
(GS0201002)



Right back panel
(GS0201003)



Plastic bolts
(GS0201023)
M9.5*18.5x3pcs

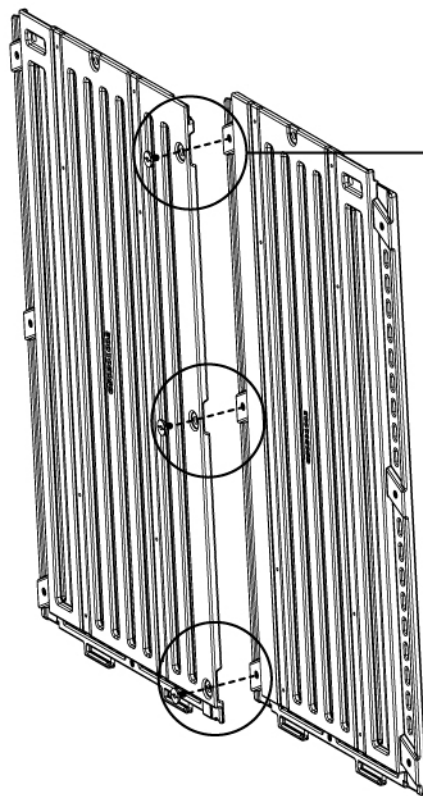

1

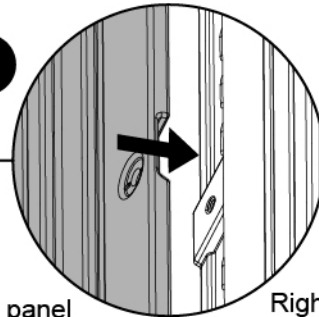

Left back panel
(GS0201002)

Right back panel
(GS0201003)

2

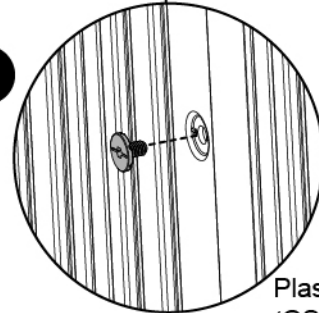

Plastic bolts
(GS0201023)
M9.5*18.5x3pcs

2 Floor panel to install

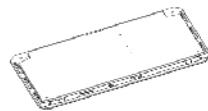

Floor
(GS0201001)

1

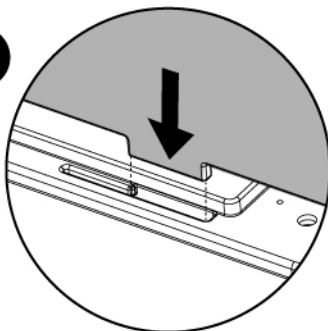

2

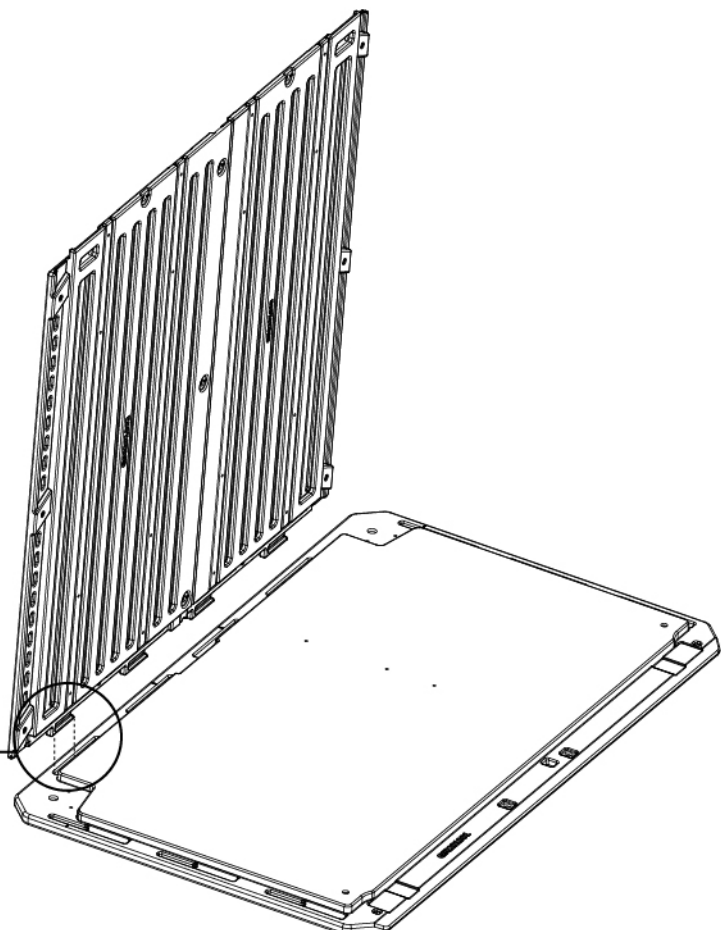
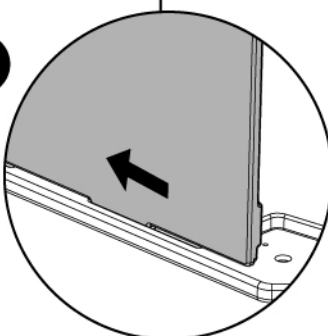

3 Side panel to install

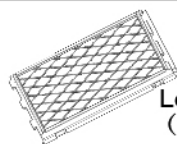

Left side panel
(GS0201004)

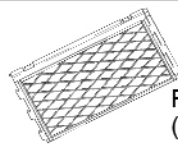

Right side panel
(GS0201005)

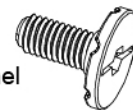

Plastic bolts
GS0201022
M9.5*25.5x6pcs

2

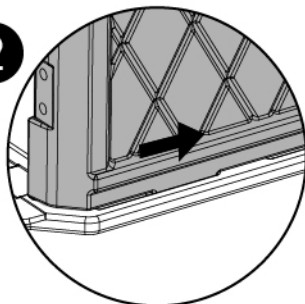

1

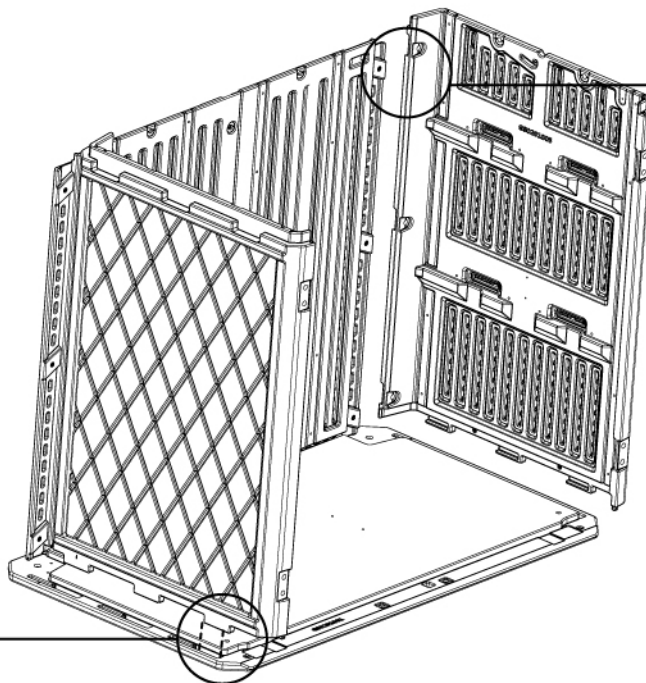
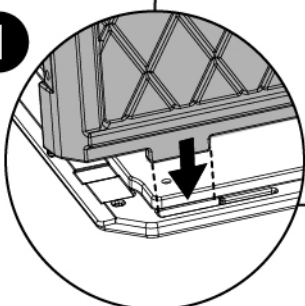

3

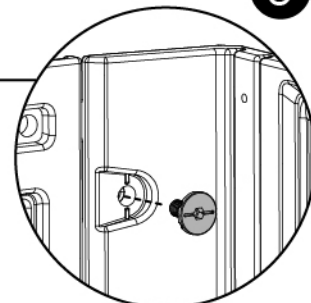

Plastic bolts
GS0201022
M9.5*25.5x6pcs

4 Right door accessories to install



Right door
(GS0201007)

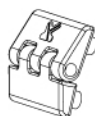

Hinge
(GS0201014)x2pcs



Strengthen the block
(GS0201028)x2pcs

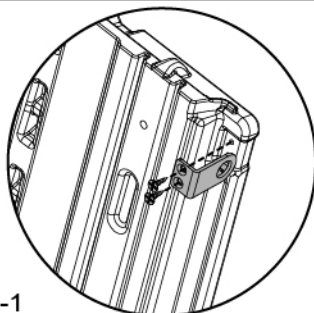

L-1
(GS0201016)
M4x10
Y202333
2pcs

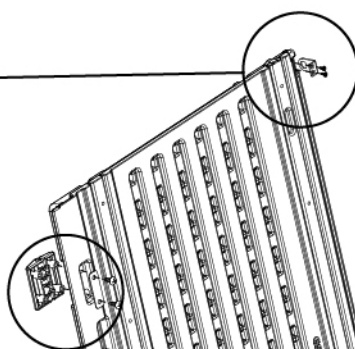

M5.5x19
Y202338
4pcs



L-1
(GS0201016)x1pcs



Latch-1
(GS0201018)x1pcs



Latch-2
(GS0201019)x1pcs



M4x10
Y202333
6pcs

Strengthen the
block
(GS0201028)
Hinge
(GS0201014)

M5.5x19
Y202338
4pcs

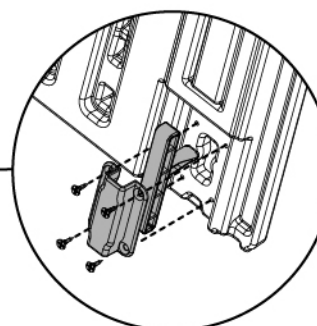
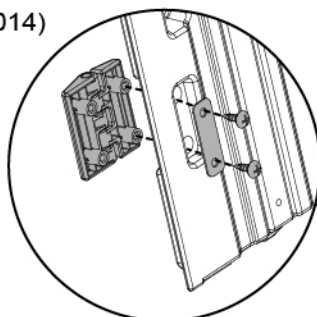

Latch-1
(GS0201018)x1pcs
Latch-2
(GS0201019)x1pcs

M4x10
Y202333
4pcs

5 Left door accessories to install

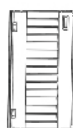

Left door
(GS0201006)

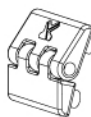

Hinge
(GS0201014)x2pcs



Strengthen the block
(GS0201028)x2pcs



M5.5x19
Y202338
4pcs



L-2
(GS0201017)x1pcs



M4x10
Y202333
2pcs

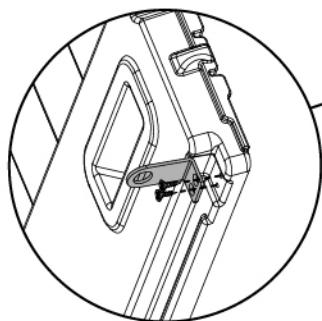

L-2
(GS0201017)

M4x10
Y202333
2pcs

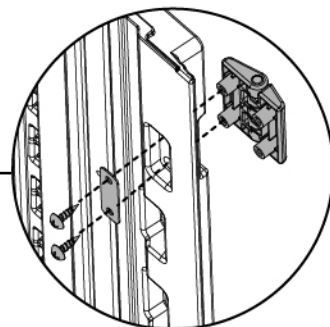
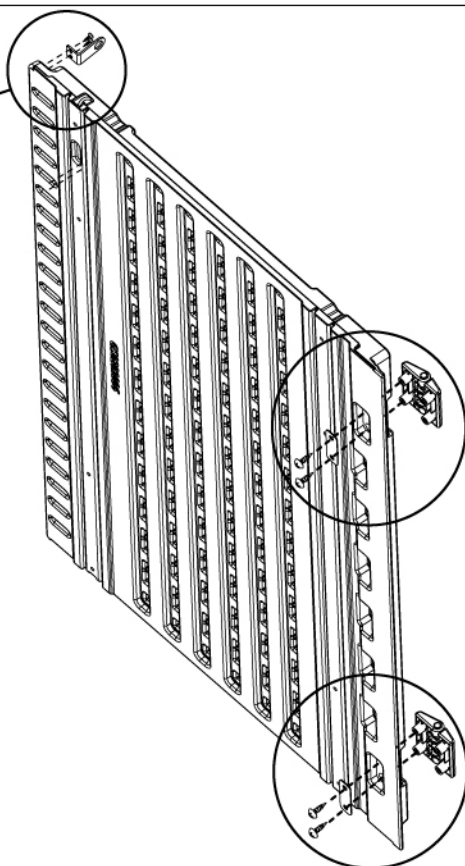

M5.5x19
Y202338
4pcs

Strengthen the block
(GS0201028)

Hinge
(GS0201014)

6 Door to install



M5.5x19
Y202338
8pcs



Strengthen the block
(GS0201028)x4pcs

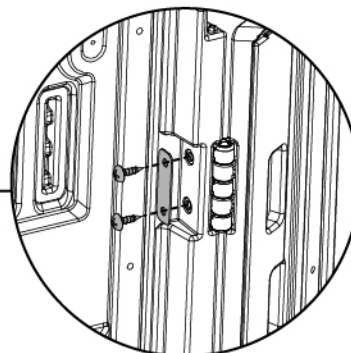
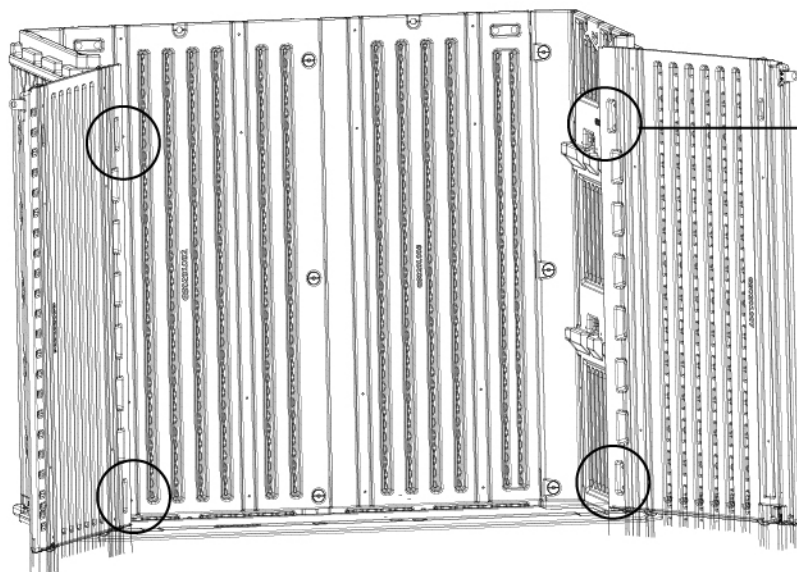

Strengthen the block
(GS0201028)x4pcs

M5.5x19
Y202338
8pcs

7 Roof accessories to install



Roof
(GS0201008)



Hinge
(GS0201014) x2pcs



Strengthen the block
(GS0201028) x2pcs

M4x10
Y202333
2pcs

L hinge folding
assembly
(GS0201015) x1pcs

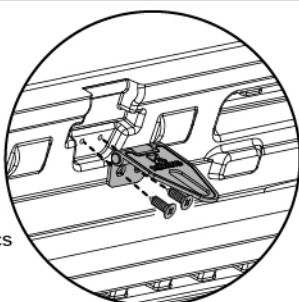

M5.5x19
Y202338
4pcs



L hinge folding
assembly
(GS0201015) x1pcs



Support rod
(GS0201020) x1pcs



Support rod fixing
piece
(GS0201021) x1pcs



M4x10
Y202333
4pcs

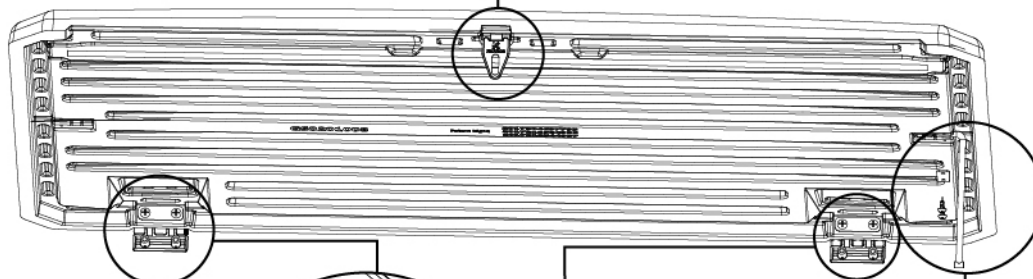

Hinge
(GS0201014) x2pcs

M5.5x19
Y202338
4pcs

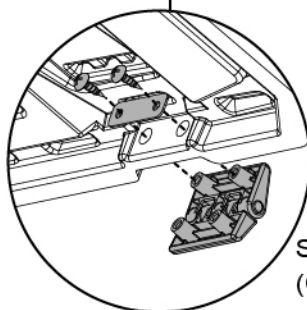

Strengthen the block
(GS0201028) x2pcs

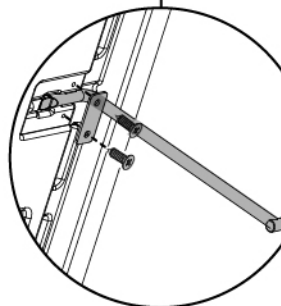

Support rod fixing
piece
(GS0201021) x1pcs

Support rod
(GS0201020) x1pcs

M4x10
Y202333
2pcs

8 Roof bolting machine

After installing the roof fitting,
connect the roof to the back panel



Strengthen the block
(GS0201028) x2pcs



M5.5x19
Y202338
4pcs

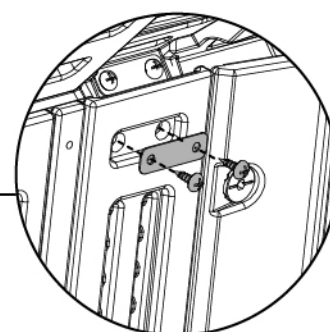
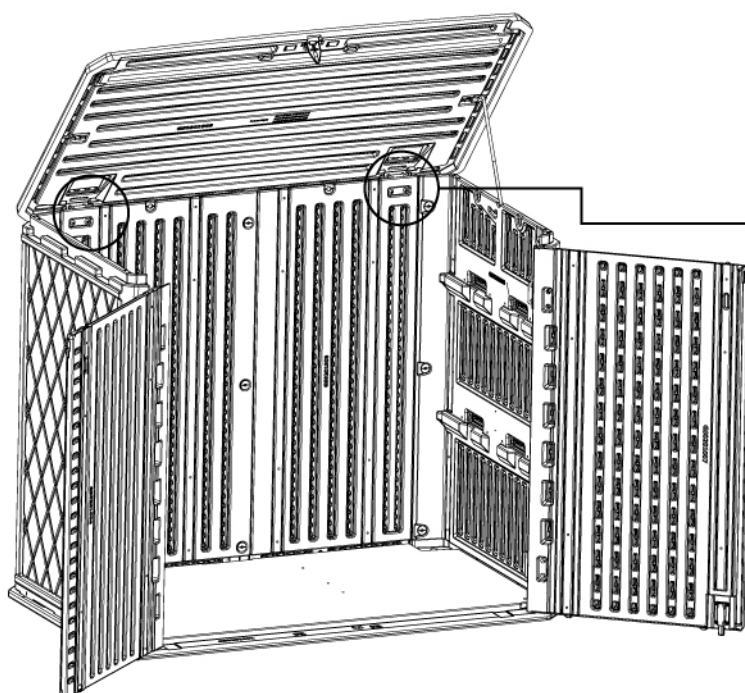

Strengthen the block
(GS0201028) x2pcs

M5.5x19
Y202338
4pcs

👏 Congratulations! you did it!! Awesome!!!

SUGGESTIONS AND SOLUTIONS FOR PRODUCT COMMON ISSUES

Our company sell brand new storage shed and using original packaging. When you receive the goods, if you find that the product part was lost or damaged, please take real photos and contact us to feedback the problem you encountered, we will try our best to solve it ASAP.

For assistance with assembly or request replacement parts, please contact us.

If need to purchase the laminate shelving, please enter our shop to order it (Note: this shelving only used for our storage sheds, we don't know if it suitable for other storage sheds or not)

If purchased shelf, please kindly noting that load-bearing of one shelf is 20 kg.

If the storage shed are installed in open and windy area outside, can use 6*60 mm expansion bolts to fixed 4 corners of the storage shed floor on the ground.

RETURN POLICY

For return and exchange orders:

If the storage sheds you received is damaged or defective and need to be returned or replaced with new one, please kindly send us real images (product itself or packages). We will check and deal with it quickly.

For product quality reason return and exchange orders: please take real images and contact us, we will provide prepaid return label for return or replace new product.

For these reasons (bought by mistake, no longer needed, does not meet expectation, size smaller or bigger than expectation) return and exchange orders: customer need to cover the return shipping costs.

For cancel order: customer need to pay for shipping fee and carrier handle fee if the item has been shipped out.

For change address: customer need to pay for extra shipping fee and carrier handle fee if the item has been shipped out.

RETURN PROCESS

1. Make a RETURN REQUEST on website.

2. Please ensure the integrity of the items and write the detailed information about return address, and then return the item.

3. Please inform us the tracking number of the returned package if you returned the item, this information is necessary for us. Otherwise, we don't know when you returned the item to the warehouse and can not refund in time.

4. Warehouse will check the return item within 3 business days after receiving it, and we will complete the refund within 2 days if the item is confirmed to have no problems.

Please note:

If returned defective, damaged or incorrect item and affects the re-sales, we will refund part of the money. The refund depends on the integrity of the package.

WARRANTY

If there have product quality problem or the STORAGE SHED INSTRUCTION is not clear, please contact us, we will deal with it quickly.

Due to defects resulting from normal wear and tear (scuffing, scratches caused during use, fading, abuse, unreasonable use, transporting or reassemble the product), natural disasters (storm, hail, flood and fire) and by animal types are not covered by the product warranty)

Our company reserves the right to modify the contents of this manual without notification.