



# Edge Bagger

## Operator's Manual Manuel du Utilisateur

**ARIENS**

### Models

815046 – 42" Edge Bagger  
(SN 000101 +)

815047 – 52" Edge Bagger  
(SN 000101 +)

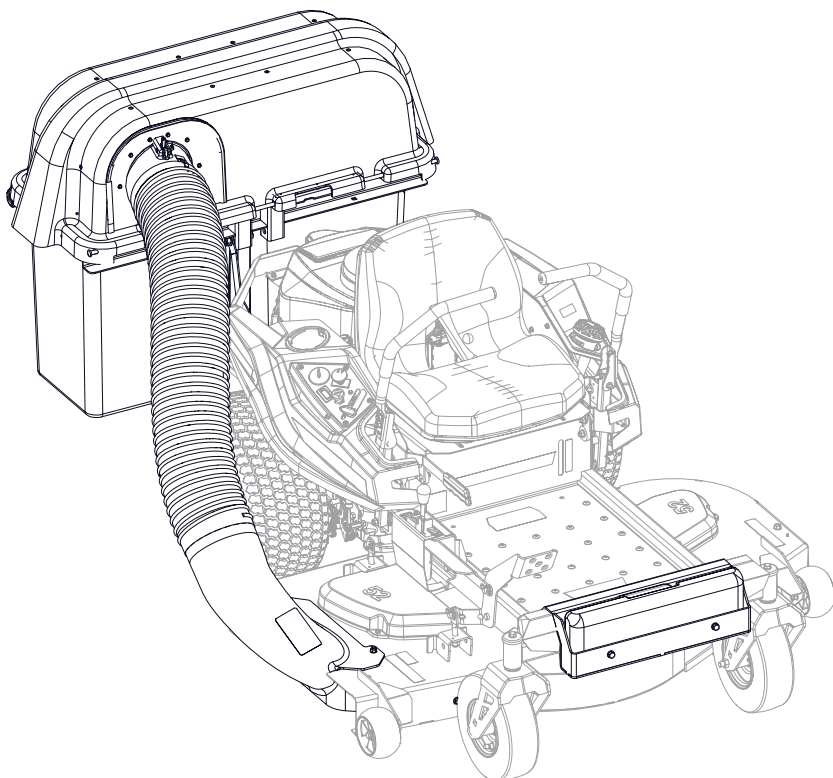

(EN)

ENGLISH

(FR)

FRANÇAIS

09171900 • 3/20

Printed in USA

# TABLE OF CONTENTS

---

|   |          |                                   |           |
|---|----------|-----------------------------------|-----------|
| <b>WELCOME</b> .....                                | <b>1</b> | Install Bagger Hose .....         | 14        |
| Register Your Product! .....                        | 1        | Assemble Mesh Bags .....          | 15        |
| <b>SAFETY</b> .....                                 | <b>2</b> | Install Mesh Bag Assemblies ..... | 15        |
| Practices & Laws .....                              | 2        | <b>REMOVAL</b> .....              | <b>16</b> |
| Required Operator Training .....                    | 2        | <b>OPERATION</b> .....            | <b>16</b> |
| Safety Alert Symbol .....                           | 2        | Before Each Use .....             | 16        |
| Signal Words .....                                  | 2        | Bagging .....                     | 16        |
| Safety Decals .....                                 | 3        | Airflow Indicator .....           | 17        |
| Safety Instructions .....                           | 4        | Emptying Mesh Bags .....          | 17        |
| <b>ASSEMBLY</b> .....                               | <b>7</b> | Unclogging Bagger .....           | 18        |
| Install Front Weight<br>Tray & Counterweight .....  | 8        | Operating Tips .....              | 18        |
| Removal .....                                       | 10       | <b>MAINTENANCE</b> .....          | <b>18</b> |
| Install Hi-Lift Mower Blade<br>(Model 815047) ..... | 11       | <b>STORAGE</b> .....              | <b>18</b> |
| Install Bagger Boot .....                           | 11       | <b>TROUBLESHOOTING</b> .....      | <b>19</b> |
| Install Mount Post .....                            | 12       | <b>SPECIFICATIONS</b> .....       | <b>19</b> |
| Install Hood Assembly .....                         | 13       | <b>WARRANTY</b> .....             | <b>20</b> |
| Install Support Strap .....                         | 13       |                                   |           |

# WELCOME

Congratulations on your purchase and welcome to the Ariens family! Every machine in the Ariens lineup is designed for long-lasting and unsurpassed performance. We are confident your machine will be part of your family for many years to come.

## Have Questions or Need Assistance?

[www.ariens.com](http://www.ariens.com)

A parts manual for your unit is available for free download or purchase at [www.ariens.com](http://www.ariens.com).

### REGISTER YOUR PRODUCT!

It is extremely important to register your product at time of purchase. Product registration activates the warranty and establishes a communication link from AriensCo.

Locate the model and serial number decal on your unit and register those numbers online at [www.ariens.com](http://www.ariens.com). See Figure 1 for decal location. Be aware that the original selling dealer may have already completed product registration on behalf of the original purchaser.

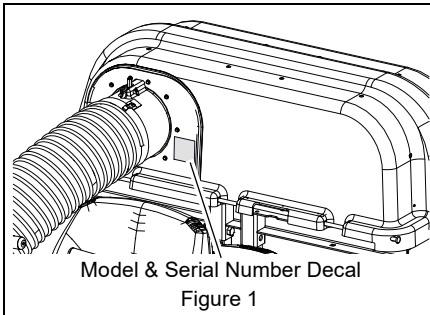

Record model number here.

Record serial number here.

### MANUALS

Before operating or servicing the unit, carefully and completely read the manuals provided with the unit. They contain safety instructions and important information about unit controls.

The engine on this unit is covered by a separate manual. Refer to the engine manual for engine service recommendations. Contact the engine manufacturer for a replacement manual if necessary.

Your dealer must review important information in this manual with you before or upon delivery of the unit. It is your responsibility to read and understand all safety precautions and instructions in the manuals. If you do not understand or have difficulty following the instructions, contact your Ariens dealer for assistance. To locate your nearest Ariens dealer, go to [www.ariens.com](http://www.ariens.com).

### DISCLAIMER

Ariens reserves the right to discontinue, make changes to, and add improvements upon its products at any time without public notice or obligation. The descriptions and specifications contained in this manual were in effect at printing. Equipment described in this manual may be optional. Some illustrations may not be applicable to your unit.

## SAFETY

Read these safety rules and follow them closely. Failure to follow these rules could lead to loss of control of unit, severe personal injury or death to you or bystanders, or result in damage to property or the machine.

### PRACTICES & LAWS

Practice usual and customary safe working precautions. Learn applicable rules and laws in your area. Always follow the practices set forth in this manual.

### REQUIRED OPERATOR TRAINING



Read and understand the Operator's Manual and decals on the unit. This information is for your safety and the proper use of your equipment.

Failure to follow these

instructions and warnings may cause death or serious injury. If you have purchased this product from an Ariens dealer, the dealer can provide you with training.

Familiarize yourself and any other operators with all controls and the safe use of the features of this unit. If you loan, rent or sell this product to others, provide them with all manuals.

If you have any questions, please call our customer support line at 920-756-4688 or contact us at [www.ariens.com](http://www.ariens.com). Do not use this equipment if, after reading the Operator's Manual and the on-board decals, you have any questions about the safe use of this product.



**WARNING: AVOID INJURY.** This cutting machine is capable of amputating hands and feet and throwing objects. Failure to observe the safety instructions in the manuals and on decals could result in serious injury or death.

## SAFETY ALERT SYMBOL



This is the safety alert symbol. It means:

- **ATTENTION!**
- **YOUR SAFETY IS INVOLVED!**

When you see this symbol:

- **BECOME ALERT!**
- **OBEY THE MESSAGE!**

## SIGNAL WORDS

The safety alert symbol above and signal words below are used on decals and in this manual. Read and understand all safety messages.

### 1. Danger



**DANGER:** Indicates an **IMMINENTLY HAZARDOUS SITUATION!** If not avoided, **WILL RESULT** in death or serious injury.

### 2. Warning



**WARNING:** Indicates a **POTENTIALLY HAZARDOUS SITUATION!** If not avoided, **COULD RESULT** in death or serious injury.

### 3. Caution



**CAUTION:** Indicates a **POTENTIALLY HAZARDOUS SITUATION!** If not avoided, **MAY RESULT** in minor or moderate injury. It may also be used to alert against unsafe practices.

### 4. Notice

**NOTICE:** Indicates information or procedures that are considered important but not hazard related. If not avoided property damage could result.

### 5. Important

**IMPORTANT:** Indicates general reference information worthy of special attention.

## SAFETY DECALS

The safety decals on your machine are visual reminders of the important safety information in this manual. All messages on your unit must be fully understood and carefully followed. Safety decals on the machine are explained below.

ALWAYS replace missing or damaged safety decals. Replacement decal part numbers are found in the parts manual for your machine and may be ordered from your dealer.

See Figure 2 for safety decal locations.

## Safety Decal Locations

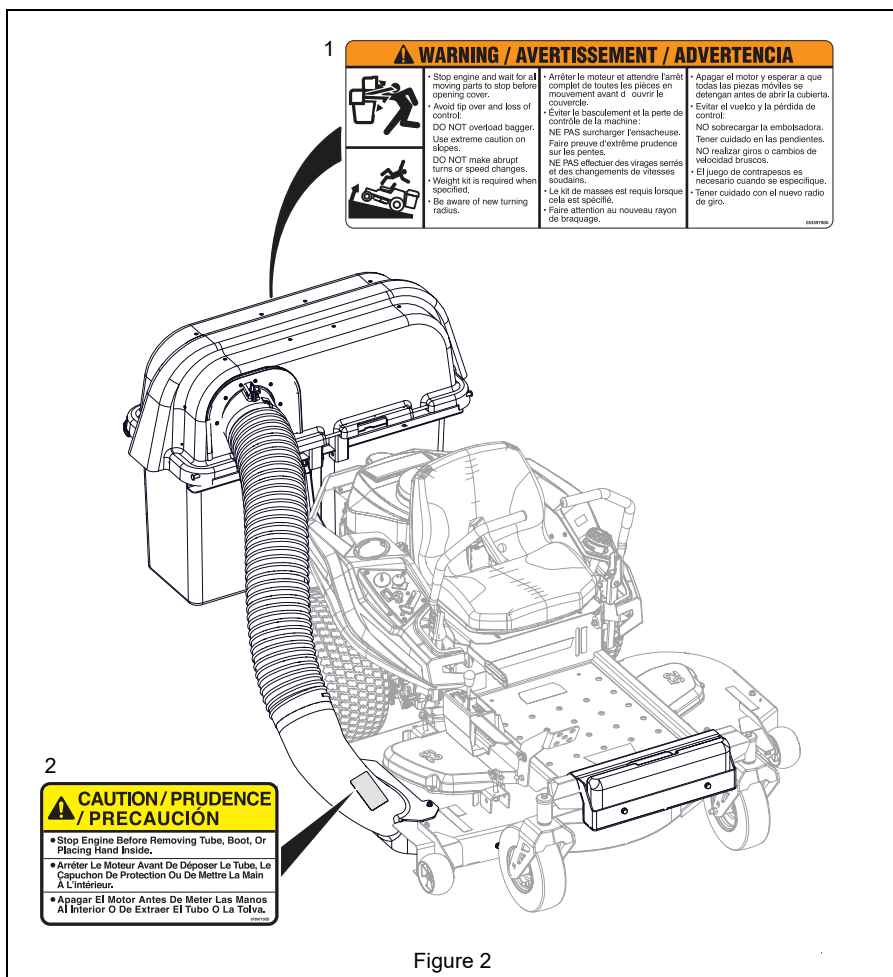

Figure 2

## Safety Decal Descriptions

### 1. WARNING!



Stop engine and wait for all moving parts to stop before opening cover.



Avoid tip over and loss of control:

DO NOT overload bagger.

Use extreme caution on slopes.

DO NOT make abrupt turns or speed changes.

- Weight kit is required when using bagger.
- Be aware of new turning radius.

### 2. CAUTION!

- Stop Engine Before Removing Tube, Boot, Or Placing Hand Inside.

## SAFETY INSTRUCTIONS

The following safety instructions are based on B71.1, B71.4 specifications of the American National Standards Institute and ISO 5395 in effect at the time of production.

### Safe Practices for Ride-On Mowers

If used improperly, this machine is capable of amputating hands and feet and throwing objects. Failure to observe the following safety instructions could result in serious injury or death. Use only for purposes intended as set forth in the Operator's Manual. Other use is improper and may cause serious injury or death.

#### General Information

Read, understand, and follow instructions and warnings in this manual and on the machine, engine and attachments.

Only allow operators, who are responsible, trained, familiar with the instructions, and physically capable to operate the machine.

DO NOT carry passengers and keep people or pets away from the mowing area.

DO NOT operate the machine while physically or mentally impaired, feeling tired, ill or under the influence of alcohol or drugs.

Follow the manufacturer's recommendation for wheel weights or counterweights.

DO NOT touch parts which are hot. Allow parts to cool.

#### Preparation Before Operating

Inspect unit before each use for missing or damaged decals and shields, correctly operating safety interlock system, ROPS and deterioration of grass catchers. Replace or repair as needed.

Clear the operating area of all objects which could be thrown by or interfere with operation of the machine.

Keep the area of operation clear of all bystanders, particularly small children. Stop the machine and attachment(s) if anyone enters the area

DO NOT operate the machine without the entire grass catcher, discharge chute, or other safety devices in place and functioning properly. Check frequently for signs of damage, wear or deterioration and replace as needed.

NEVER tamper with safety devices. Check their proper operation regularly. NEVER do anything to interfere with the intended function of a safety device or to reduce the protection provided by the safety device.

Check parking brake operation frequently. Adjust and service as required.

Wear appropriate personal protective equipment such as safety glasses, hearing protection, and substantial footwear. DO NOT mow barefoot or while wearing sandals.

## Operating

Improper use of power equipment can cause serious permanent injury or death to the operator or a bystander. Understand:

- How to operate all controls
- The functions of all controls
- How to STOP in an emergency
- Braking and steering characteristics
- Turning radius and clearances

If the operator or the mechanic cannot read the manual, it is the owner's responsibility to explain it to them. Manuals are available in other languages at [www.ariens.com](http://www.ariens.com).

Only run the engine in well ventilated areas. Exhaust gases contain carbon monoxide, an odorless deadly poison.

Only operate the machine in daylight or good artificial light.

Avoid holes, ruts, bumps, rocks and other hazards. Uneven terrain could overturn the machine, or cause operator to lose their balance, footing and/or control of the mower.

DO NOT put hands or feet near rotating parts or under the machine. Keep clear of the discharge opening at all times.

Avoid slippery surfaces. ALWAYS be sure of your footing.

Stop engine before removing grass catcher or unclogging chute.

DO NOT direct discharge material toward anyone. Avoid discharging material against a wall or obstruction. Material may ricochet back toward the operator. Stop the blade(s) when crossing gravel surfaces. DO NOT mow into roads or across sidewalks.

DO NOT leave a running machine unattended. ALWAYS park on level ground, disengage the attachment, set parking brake, stop engine and remove key (if applicable) before leaving the operator's position.

DO NOT mow in reverse unless absolutely necessary. ALWAYS look down and behind before and while backing.

Lightning can cause severe injury or death. If lightning is seen or thunder is heard in the area, DO NOT operate the machine; seek shelter.

If you strike a foreign object, stop and inspect the machine. Repair, if necessary, before restarting.

ALWAYS check overhead and side clearances carefully before operation. Keep in mind that your mower deck may be wider than your track width.

## Children Specific

Tragic accidents can occur if the operator is not alert to the presence of children. Children are often attracted to the machine and the mowing activity. NEVER assume that children will remain where you last saw them.

Keep children out of the operating area and under the watchful care of a responsible adult other than the operator.

Do not carry children, even with the blade(s) shut off. Children could fall off and be seriously injured or interfere with safe machine operation. Children who have been given rides in the past could suddenly appear in the mowing area for another ride and be run over or backed over.

DO NOT allow children under the age of 18 to operate any outdoor power equipment.

## Slope Specific

Slopes are a major factor related to accidents. Operation on slopes requires extra caution. If you feel uneasy on a slope DO NOT mow it. Use the parking brake for emergency stops.

DO NOT operate on slopes of more than 15°.

Do not mow within 1.2 M (4 feet) of a drop off. Do not mow within 1.2 M (4 feet) of a pond or other waterway.

The primary hazard of slope operation is loss of control and/or roll over.

Mow up and down slopes, NEVER across. Exercise caution when changing direction on slopes. Use caution while operating near dropoffs.

Avoid mowing wet grass. Wet surfaces can cause a loss of traction and control.

DO NOT operate machine under any condition where traction, steering, or stability is in question. Tires could slide even if the wheels are stopped.

Always keep the machine in gear when going down slopes. Do not coast downhill.

Avoid starting and stopping on slopes. Avoid making sudden changes in speed or direction. Make turns slowly and gradually.

Use extra care while operating machine with a grass catcher or other attachment(s). They can affect the stability of the machine.

### **Fire and Fuel Specific**

Extinguish all cigarettes, cigars, pipes and other sources of ignition.

Use only an approved fuel container.

DO NOT remove fuel cap or add fuel with the engine running or while hot.

DO NOT refuel indoors or in enclosed spaces.

DO NOT store the machine or fuel container, or refuel, where there is an open flame, spark, or pilot light such as on a water heater or other appliance.

If fuel is spilled, DO NOT attempt to start the engine and avoid creating any source of ignition until fuel vapors have dissipated.

To help prevent fires: keep machine free of grass, leaves, or other debris build up; clean up oil or fuel spillage and remove any fuel soaked debris; allow engine to cool before storing.

Use extra care in handling gasoline and other fuels. They are flammable and vapors are explosive.

### **Hauling**

Use a single full-width ramp for loading and unloading a machine for transport. Secure with appropriate straps.

### **Towing**

Follow the manufacturer's recommendation for weight limits for towed equipment and towing on slopes.

### **Service**

Keep machine in good working order. Replace worn or damaged parts.

Use caution when servicing blades. Wrap the blade(s) or wear gloves. Replace damaged blades. DO NOT repair or alter blade(s).

Disconnect spark plug wire(s) and the negative battery cable before making any repairs.

Use only attachments recommended by AriensCo that are appropriate to your use and can be used safely in your application.

The use of non-genuine replacement parts or accessories could adversely affect machine operation and safety.

DO NOT change engine governor setting or overspeed the engine.



## ASSEMBLY



**WARNING: AVOID INJURY.**  
Read and understand the entire  
*Safety* section before  
proceeding.

Remove contents from carton carefully. Place bagger hood and frame parts on a flat piece of cardboard to avoid scratching.

### Package Contents:

Check the contents of your kit for the parts listed below. See Figure 3.

| Item | Description                                  | Qty | Part Number |
|------|--|-----|-------------|
| 1    | Weldment Bagger Weight Tray                  | 1   | 04215451    |
| 2    | Mesh Bag                                     | 2   | 03862900    |
| 3    | Adhesive Grip                                | 1   | 03833800    |
| 4    | Cast Iron Weight                             | 1   | 00172000    |
| 5    | 3/8"-16 x 3" Hex Bolt                        | 2   | 05901814    |
| 6    | 3/8" x 3/32" Lock Washer                     | 2   | 06300116    |
| 7    | 1/2"-13 Nylon Locking Flange Nut             | 1   | 06500810    |
| 8    | 17/32" x 1 1/16" x 3/32" Flat Washer         | 1   | 06401015    |
| 9    | 13/32" x 13/16" x 1/16" Flat Washer          | 1   | 06401013    |
| 10   | Clevis Pin                                   | 1   | 06814800    |
| 11   | Bowtie Pin                                   | 1   | 06700220    |
| 12   | 5/16"-18 x 3/4" Round Head Square Neck Bolt  | 2   | 06200232    |
| 13   | 5/16"-18 Center Locking Flange Nut           | 3   | 06500840    |
| 14   | 18" Hi-Lift Mower Blade (Model 815047)       | 1   | 09166800    |
| 15   | 1/2"-13 x 2 3/4" Round Head Square Neck Bolt | 1   | 06200327    |
| 16   | 5/16"-18 x 1" Hex Bolt                       | 1   | 05901701    |
| 17   | 5/16" x 47/64" x 1/16" Flat Washer           | 1   | 06401124    |
| 18   | Wing Knob                                    | 1   | 07500225    |

| Item | Description                      | Qty | Part Number |
|------|----------------------------------|-----|-------------|
| 19   | Studded Wing Knob                | 1   | 07500226    |
| 20   | Bagger Boot – 42" (Model 815046) | 1   | 09154000    |
|      | Bagger Boot – 52" (Model 815047) | 1   | 09156900    |
| 21   | L Bracket                        | 1   | 04409751    |
| 22   | Support Strap                    | 1   | 09171251    |
| 23   | 47" Flexible Hose                | 1   | 04222900    |
| 24   | Hood Assembly                    | 1   | 61577800    |
| 25   | Receiver                         | 1   | 04409800    |
| 26   | 3/8" Nylon Locking Flange Nut    | 2   | 06500726    |
| 27   | 3/8"-16 x 1" Hex Bolt            | 2   | 05901711    |
| 28   | 1/2"-13 x 2 3/4" Hex Bolt        | 1   | 05901836    |
| 29   | Bag Frame                        | 2   | 00663200    |
| 30   | 3/8" x 1/2" x 3" Plastic Tube    | 2   | 00677000    |

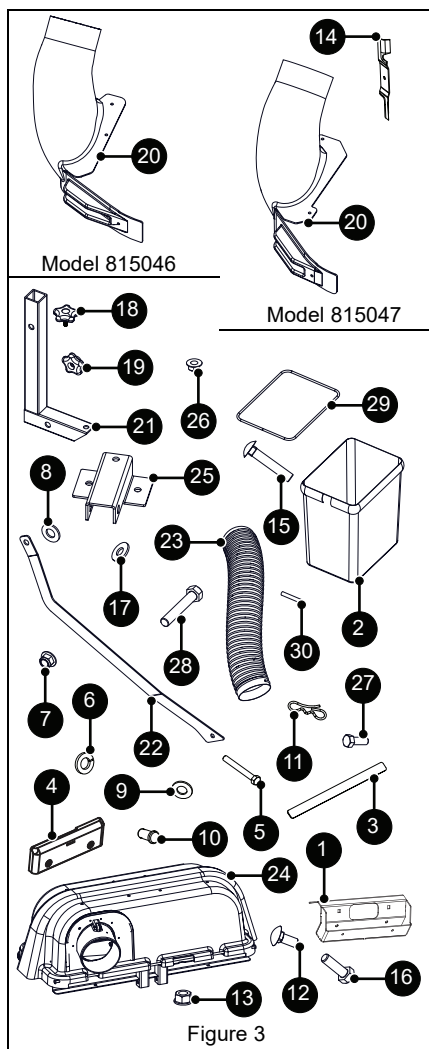

## INSTALL FRONT WEIGHT TRAY & COUNTERWEIGHT



**WARNING:** ALWAYS install counterweight before operating unit with bagger attached. ALWAYS remove counterweight when bagger is removed from unit.

See Figure 4.

1. Remove two 5/16" x 3/4" and 1/2" x 1 3/4" round head square neck bolts, two metal spacers, two 1/2" push nuts, and two 1/2" and 5/16" center locking flange nuts retaining footrest and remove footrest. Retain hardware for reinstallation.

**NOTICE:** It may be helpful to have the weight tray laying upside down on the ground when mating it to footrest.

2. Position footrest onto back of weight tray (item 1).
3. Install two 1/2" x 1 3/4" round head square neck bolts removed earlier through the front of the weight tray and footrest. Slide two spacers onto the bolts and secure weight tray to footrest with two 1/2" push nuts removed earlier. Ensure that push nuts are securely fastened.

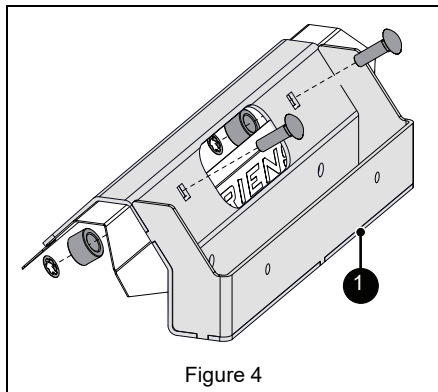

**IMPORTANT:** It may be necessary to tilt the assembly back slightly to align the bolts with the holes.

4. Secure the front of footrest/weight tray assembly to the chassis with hardware installed in step 3 and two 1/2" center locking flange nuts removed earlier. See Figure 5.

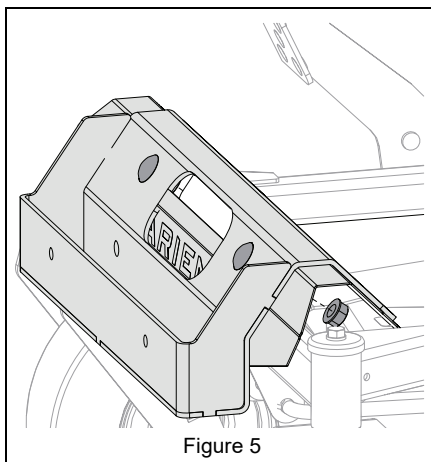

Figure 5

5. Install two 5/16" x 3/4" round head square neck bolts removed earlier through the two holes on the back of footrest/weight tray assembly. Secure assembly to chassis with two 5/16" center locking flange nuts removed earlier. See Figure 6.

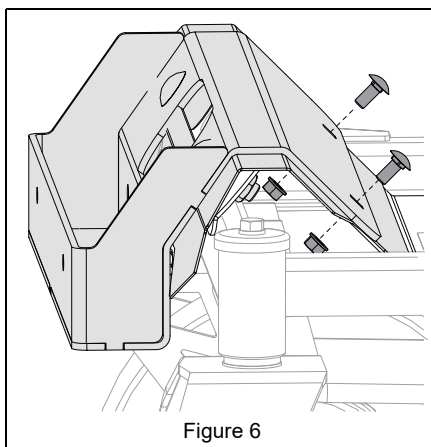

Figure 6

6. Adhere the grip adhesive (item 3) above the round head square neck bolts on the back of footrest. See Figure 7.

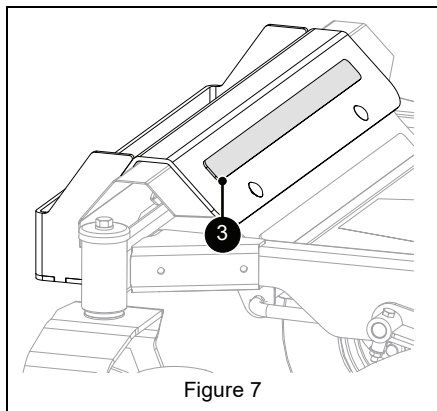

Figure 7

7. Place cast iron weight (item 4) into weight tray. Install two 3/8" x 3" hex bolts (item 5) and 3/8" lock washers (item 6) through the front of weight. Thread the bolts into the weld nuts located at the back of the tray and tighten until the lock washers engage. DO NOT overtighten bolts. See Figure 8.

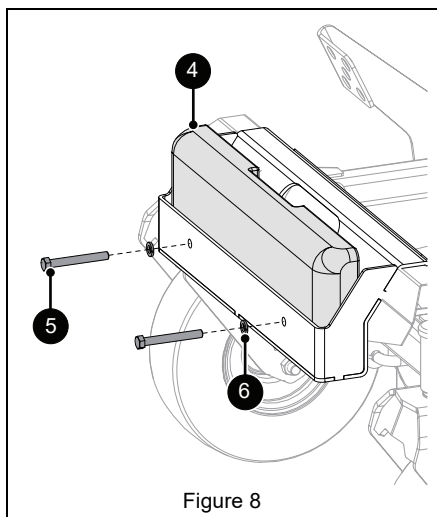

Figure 8

## REMOVAL

1. Stop engine, remove key and engage parking brake. Wait for moving parts to stop and for hot parts to cool.
2. Disconnect spark plug wires.



**WARNING:** Always chock wheel and know all jack stands are strong and secure and will hold weight of unit during maintenance.

3. Raise the front of the unit to gain access to the underside of deck. Securely support the unit.

### Model 815046

1. Remove four 5/16" round head square neck bolts and four 5/16" nuts securing discharge chute and plate to deck. Retain chute, plate and hardware for operation without bagger. See Figure 9.

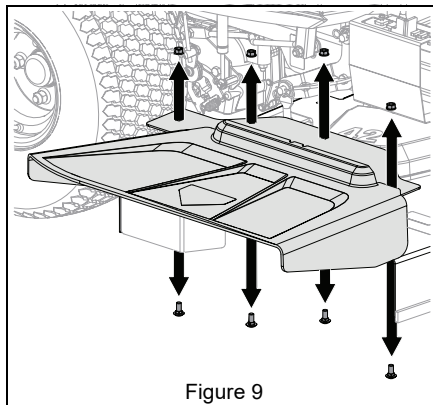

Figure 9

2. Remove 5/16" round head square neck bolt and 5/16" nut retaining deflector strip and remove strip. Retain hardware and strip for operation without bagger. See Figure 10.

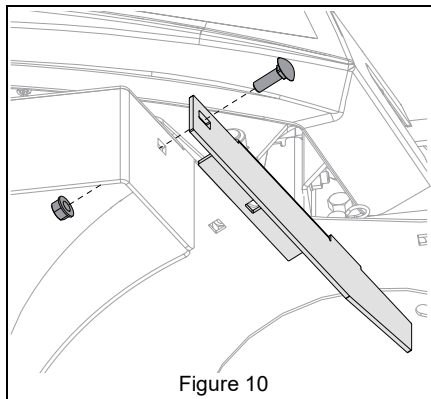

Figure 10

### Model 815047

1. Remove three 5/16" round head square neck bolts and three 5/16" nuts securing discharge chute and plate to deck. Retain chute, plate and hardware for operation without bagger. See Figure 11.

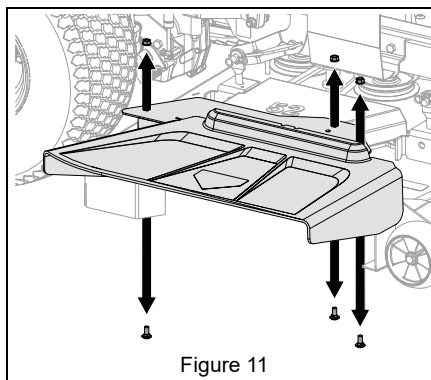

Figure 11



**WARNING:** On multi-blade mowers, rotation of one mower blade will cause all blades to rotate.



**WARNING:** Mower blades are sharp and can cut you. Wrap the blade(s) or wear gloves, and use extra caution when servicing them.

2. Remove 5/8" nut and 21/32" washer retaining right mower blade and remove blade. Retain hardware for reinstallation and blade for operation without bagger. See Figure 12.

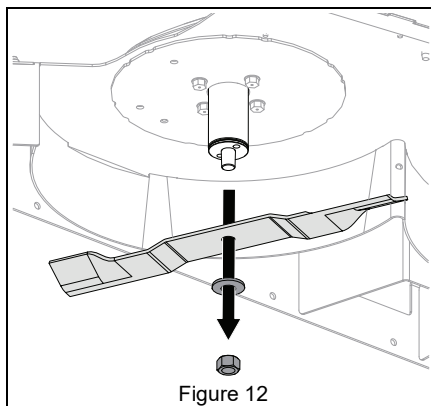

## INSTALL HI-LIFT MOWER BLADE (MODEL 815047)



**WARNING:** On multi-blade mowers, rotation of one mower blade will cause all blades to rotate.



**WARNING:** Mower blades are sharp and can cut you. Wrap the blade(s) or wear gloves, and use extra caution when servicing them.

1. Install 18" Hi-Lift mower blade (item 14) into right spindle with hardware removed earlier. Torque nut to 108.5 N•m – 122.0 N•m (80 lb-ft – 90 lb-ft). Ensure concave side of washer faces mower blade. See Figure 13.

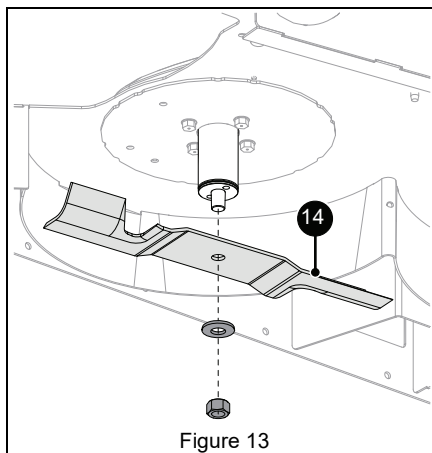

## INSTALL BAGGER BOOT

See Figures 14 and 15.

1. Install bagger boot (item 20) to deck with two 5/16" round square neck bolts (item 12) and 5/16" center locking flange nuts (item 13).
2. Secure boot to deck with 5/16" hex bolt (item 16), 5/16" flat washer (item 17) and 5/16" center locking flange nut (item 13).

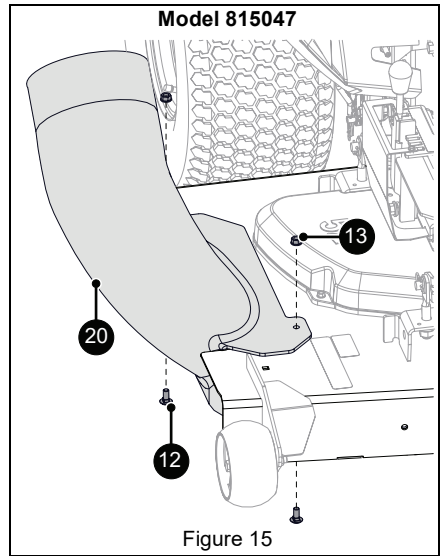
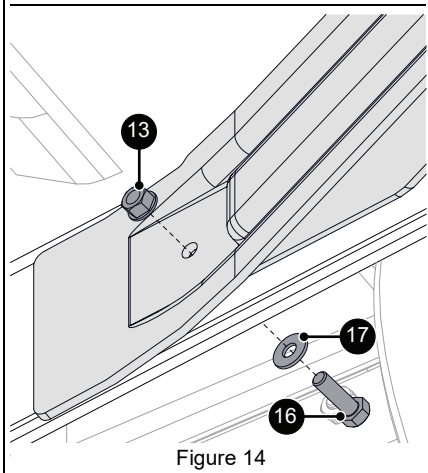
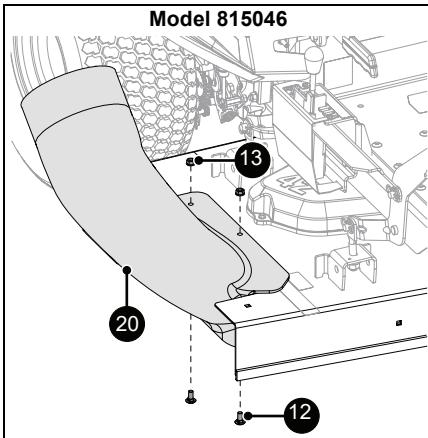

3. Return unit to operating position.

## INSTALL MOUNT POST

1. Install receiver (item 25) onto right rear frame with two  $\frac{3}{8}$ " x 1" hex bolts (item 27) and two  $\frac{3}{8}$ " locking nuts (item 26). Tighten hardware. See Figure 16.

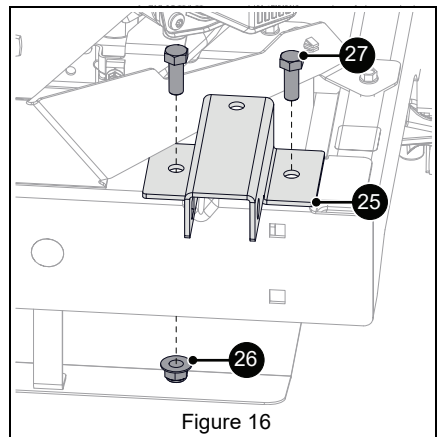

See Figure 17.

2. Insert L bracket (item 21) into receiver and secure with  $\frac{1}{2}$ " x  $2\frac{3}{4}$ " round head square neck bolt (item 15) and wing knob (item 18). Do not fully tighten.

- 

Figure 17

1. Install hood assembly (item 24) position 2 receiver onto L bracket. See Figure 18.

**NOTICE:** It may require two people to position hood assembly onto bracket.

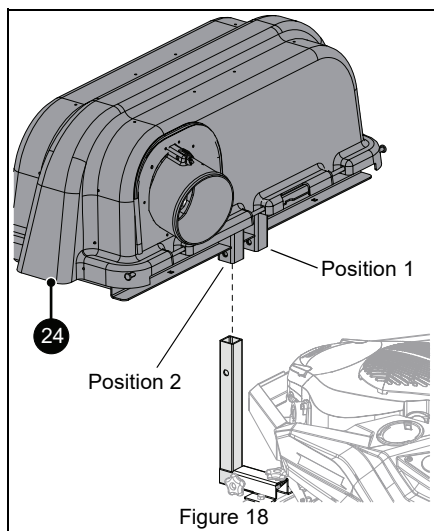

Figure 18

1. Attach support strap (item 22) to hood assembly receiver using 1/2" x 2 3/4" hex bolt (item 28), 17/32" flat washer (item 8) and 1/2" nylon locking flange nut (item 7). Position flat washer between support strap and hood assembly receiver. Do not fully tighten hardware. See Figure 19.

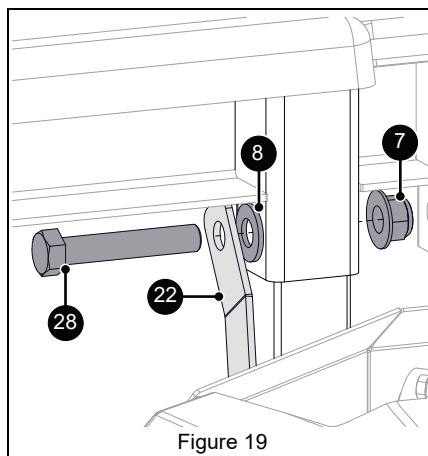
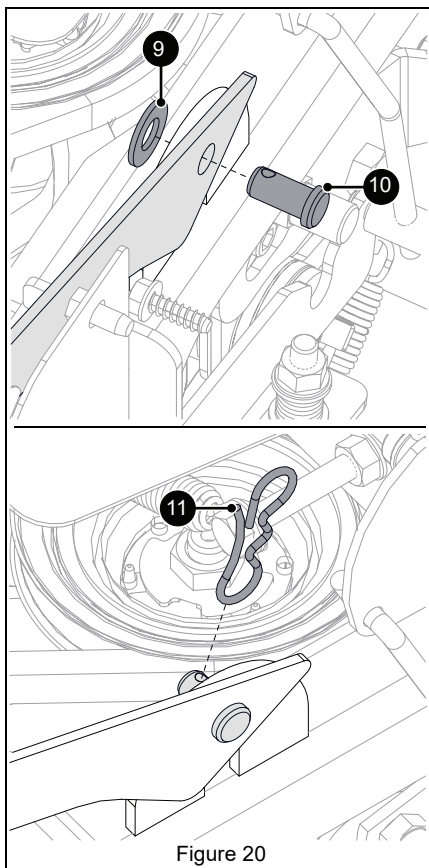

Figure 19

2. Secure support strap to mower frame with clevis pin (item 10), 13/32" flat washer (item 9), and bowtie pin (item 11). Tighten hardware installed in step 1. See Figure 20.



## INSTALL BAGGER HOSE

See Figure 21.

1. Install hose (item 23) fully on bagger boot.
2. Open latch on hood assembly inlet and install hose on inlet. Close latch, making sure that latch attaches to one rib of hose.

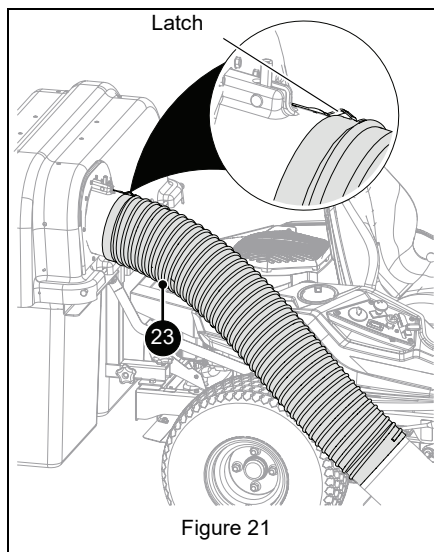



## ASSEMBLE MESH BAGS

See Figure 22.

1. Install two mesh bags (item 2) onto two bag frames (item 29) by routing the bag frames in the open end of the mesh bags.
2. Install plastic tube (item 30) on both ends of each bag frame and push ends together.



## INSTALL MESH BAG ASSEMBLIES

1. Install mesh bag assemblies to hood assembly frame. The smooth heat-resistance surfaces of the mesh bags must face the engine. Close the hood and connect rubber latch. See Figure 23.

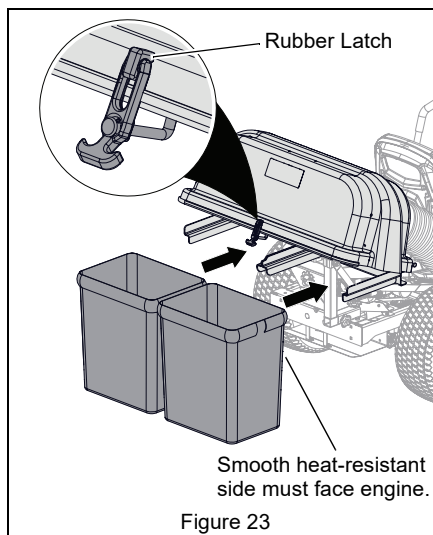

## REMOVAL



**WARNING: AVOID INJURY.**  
Read and understand the entire *Safety* section before proceeding.

1. Release thumb latch retaining hose to hood assembly and remove hose from hood assembly and bagger boot. See Figure 21.
2. Remove mesh bags from hood assembly. See Figure 25.
3. Remove hardware retaining support strap. See Figures 19 and 20.
4. Remove wing knob from bottom of mount post and remove hood assembly from unit. It is not necessary to remove receiver. See Figure 17.
5. Remove cast iron weight from the front weight tray. It is not necessary to remove weight tray.
6. Remove hardware retaining bagger boot and remove boot. See Figures 14 and 15.
7. *Model 815047 Only:* Remove hardware retaining 18" Hi-Lift mower blade and remove blade. Retain 18" Hi-Lift mower blade for operation with bagger. Reinstall original 18" mower blade. See Figures 12 and 13.
8. *Model 815046 Only:* Reinstall deflector strip. See Figure 10.
9. Reinstall discharge chute and plate with original hardware. See Figures 9 and 11.
10. Ensure that mesh bags are empty, clean and dry before storing.

## OPERATION



**WARNING: AVOID INJURY.**  
Read and understand the entire *Safety* section before proceeding.

### BEFORE EACH USE

1. Check bagger parts for wear, deterioration, or damage. Replace **ONLY** with Ariens original service parts before operating.
2. Ensure cast iron weight is installed.
3. Ensure all hardware is tight.
4. Remove any grass buildup from bagger parts.
5. Ensure hose is installed correctly.
6. Ensure mesh bags are installed and the bagger cover is closed and securely latched.

### BAGGING

#### Starting

1. Start engine and engage PTO according to unit owner's manual.
2. Set throttle to full speed.
3. Set mower deck height.
4. Choose a slow ground speed.

#### Stopping



**WARNING:** Lower attachment, stop engine, and remove key to prevent unauthorized use. DO NOT park on slopes.

1. Allow the mower blades to run for at least 30 seconds to clear boot and hose of debris.
2. Disengage PTO.
3. Stop unit according to unit Owner/Operator's Manual.

## AIRFLOW INDICATOR

See Figure 24.

When the airflow indicator is pointed straight up, the air is restricted which indicates one or more possible problems:

- The mesh bags are full and need to be emptied. See *Emptying Mesh Bags* on page 17.
- There is a clog in the bagger. See *Unclogging Bagger* on page 18.

When the airflow indicator is facing forward, the air is unrestricted, indicating that the mesh bags are not full and there are no clogs in the bagger.

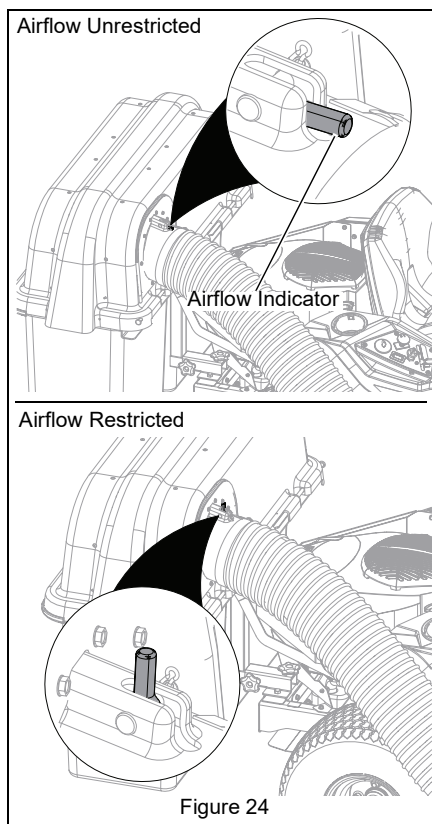

## EMPTYING MESH BAGS

If bagger stops picking up grass clippings, the mesh bags are likely full.



**WARNING:** NEVER open hood assembly while the engine is running and the PTO is engaged.  
ALWAYS shut off engine prior to emptying mesh bags.

To empty mesh bags:

1. Disengage PTO, stop engine and remove ignition key. Wait for all moving parts to stop before leaving operator's position.
2. Disconnect rubber latch and open hood.
3. Remove each mesh bag from hood assembly. See Figure 25.

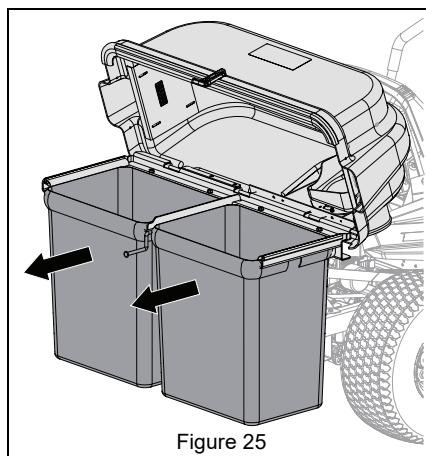

4. Empty the grass from each mesh bag.
5. Install mesh bag on hood assembly with the heat-resistant smooth surface of the bags facing the engine. See Figure 23.
6. Close and latch hood assembly.

## UNCLOGGING BAGGER



**WARNING: MOVING PARTS** can cut or amputate body parts. NEVER attempt to clear boot while engine is running.

ALWAYS stop engine, remove key, and wait for moving parts to stop.

Sharp edges can cut. Movement of parts can cut off fingers or a hand. Wrap blade(s), wear sturdy gloves and use extreme caution when working near blades.

If hose or bagger boot becomes clogged, stop forward motion and allow unit to clear itself. If unit will not clear itself, unclog the hose and/or bagger boot manually:

1. Stop engine and remove ignition key. Wait for all moving parts to stop.
2. Flip thumb latch and remove hose.
3. Remove grass from hose and boot.
4. Install hose and secure with thumb latch.

## OPERATING TIPS

**IMPORTANT:** DO NOT remove more than 3.2 cm (1 1/4") of grass when bagging.

- Cut grass when it is dry.
- Cut grass in two passes when cutting thick, long, or wet grass. Make the first cut higher than desired. Make the second cut at desired height.
- Always use full throttle when bagging.
- Adjust ground speed as necessary to allow the bagger to pick up clippings.

## MAINTENANCE

Your dealer will provide any service or adjustments which may be required to keep your unit operating at peak efficiency.



**WARNING: AVOID INJURY.** Read and understand the entire *Safety* section before proceeding.

### After each use:

- Ensure cast iron weight is installed and securely fastened.
- Ensure the hose is securely fastened to hood and boot.
- Ensure mesh bags are installed and hood assembly is closed and securely latched.
- Ensure all hardware is tight. Pay special attention to the guards and safety shields.
- Inspect bagger parts for holes, abrasions or structural damage. Replace any worn or damaged parts with Ariens service parts.
- Clear away debris in boot, hose or hood assembly.

## STORAGE



**WARNING: AVOID INJURY.** Read and understand the entire *Safety* section before proceeding.

**IMPORTANT :** NEVER spray unit with high-pressure water. DO NOT store unit outdoors.

- Clean plastic surfaces with sponge and mild detergent. Dry with a soft cloth.
- Clear away debris under belt cover, in boot, in hose, and in hood assembly before storing.
- Remove all dirt, grease, leaves, etc. from unit.
- Store in a clean, dry area.
- Ensure all fasteners are properly tightened. Inspect moving parts for damage and wear.
- Touch up all rusted or chipped painted surfaces.

## TROUBLESHOOTING

| Problem   | Probable Cause          | Correction  |
|---|-------------------------|---|
| <b>Airflow indicator points straight up.</b>    | Air flow is restricted. | Mesh bags are full. See <i>Emptying Mesh Bags</i> on page 17. |
|   |                         | Bagger is clogged. See <i>Unclogging Bagger</i> on page 18.   |
| <b>Bagger fails to pick up grass or leaves.</b> | The mesh bags are full. | Empty mesh bags. See <i>Emptying Mesh Bags</i> on page 17.    |
|   | Bagger is clogged.      | Unclog bagger. See <i>Unclogging Bagger</i> on page 18.       |

## SPECIFICATIONS

| Model Number                        | 815046          | 815047          |
|-------------------------------------|-----------------|-----------------|
| Description                         | 42" Edge Bagger | 52" Edge Bagger |
| Added Length to Unit – cm (in)      | 49.8 (19.6)     |                 |
| Added Width to Mower Deck – cm (in) | 15.2 (6.0)      | 15.9 (6.25)     |
| Added Weight to Mower – kg (lb)     | 58.5 (129.0)    |                 |
| Capacity – bu (ft <sup>3</sup> )    | 3.7 (4.6)       |                 |



# ARIENS®

## Outdoor Power Equipment Limited Warranty

AriensCo warrants to the **original purchaser** that Ariens brand products purchased on or after 9/1/2019 will be free from defects in material and workmanship for the time period noted in the chart below. Equipment put to personal use around a single household or residence is considered "Residential Use." Equipment put to any business use (agricultural, commercial, or industrial) or used at multiple locations is considered "Commercial Use." If any product is rented or leased, then the duration of these warranties shall be 90 days after the date of purchase.

An authorized Ariens dealer will repair any defect in material or workmanship, and repair or replace any defective part, subject to the conditions, limitations and exclusions set forth herein. Such repair or replacement will be free of charge (labor and parts) to the original purchaser; except as noted below. Pick-up and delivery are at the owner's expense.

The warranty code is found on the model and serial number identification label on the unit.

| Warranty Code | Product Group                                      | Warranty Period                                  |
|---------------|--|--|
| AA            | Serialized Attachments                             | 1 Year.  |
| CH            | Zenith Mowers (Non-European Models)                | 4 Years or 750 Hours.*                           |
| CQ            | Zenith Mowers (European Models)                    | 2 Years.   |
| HD            | LM-Series Walk-Behind Mowers                       | 3 Years Residential Use. 90 Days Commercial Use. |
| HE            | Edge Mowers  | 2 Years or 150 Hours.*                           |
| HF            | Ikon-XD Mowers                                     | 3 Years or 300 Hours.*                           |
| HH            | Apex Mowers  | 4 Years or 500 Hours.*                           |
| PA            | 921-Series Brushes                                 | 3 Years Residential Use. 90 Days Commercial Use. |
| PB            | 926-Series Brushes                                 | 3 Years Residential Use. 1 Year Commercial Use.  |
| SA            | Professional Sno-Thro                              | 3 Years Residential Use. 1 Year Commercial Use.  |
| SB            | Compact, Deluxe and Platinum Sno-Thro and Path-Pro | 3 Years Residential Use. 90 Days Commercial Use. |
| SD            | Deluxe and Platinum EFI Sno-Thro                   | 3 Years Residential Use. 90 Days Commercial Use. |
| SE            | 920-Series Classic Sno-Thro                        | 3 Years Residential Use. 90 Days Commercial Use. |

\* Whichever comes first.

### Special Extensions

The chart below details special **extensions** to warranty terms. Warranty terms are total time periods covered. If any product is rented or leased, there are no extensions to the 90-day warranty.

| Warranty Code | Warranty Term Extension   | Warranty Period                                    |
|---------------|---------------------------|--|
| SA            | Cast Iron Auger Gear Case | 5 Years.   |
| SB, SD        | Cast Iron Auger Gear Case | 5 Years Residential Use.<br>1 Year Commercial Use. |
| SE            | Aluminum Auger Gear Case  | 3 Years Residential Use. 90 Days Commercial Use.   |



## Exclusions and Limitations

The charts below detail special **exclusions and limitations** to this warranty.

| Warranty Term Exclusions  | Warranty Period                            |
|---|--|
| Air filters, auger paddles, brake arms, brake linings, brake shoes, brushes, cutters, fuel filters, headlights, knives, light bulbs, lubricants, mower blades, oil, oil filters, spark plugs, scraper blades, shear bolts and skid shoes. | Components are not covered under warranty. |

| Hydro-Gear Transaxle Limitation                                     |
|---|
| See Hydro-Gear warranty. The warranty is administrated by AriensCo. |

| Warranty Term Limitations   | Warranty Period  |
|---|--|
| Cloth, Plastic and Rubber Components.<br>Mufflers, Tires and Belts. | Components are covered for manufacturer's defect only, not wear. |

### Exclusions – Items Not Covered by This Warranty

- Parts that are not genuine Ariens service parts are not covered by this warranty and may void the warranty if the parts result in premature wear or damage to the product.
- Damages resulting from the installation or use of any part, accessory, or attachment which is not approved by AriensCo for use with product(s) identified herein are not covered by this warranty.
- Any misuse, alteration, improper assembly, improper adjustment, neglect, or accident which requires repair is not covered by this warranty.
- Repairs or adjustments required due to failure to use fresh fuel or failure to properly prepare the unit for periods of non-use.
- **Use of gasoline blends exceeding 10% ethanol voids any and all warranties.**
- **Any tampering with the hour meter voids any and all warranties.**
- Products are designed to the specifications in the area that the product was originally distributed. Different areas may have significantly different legal and design requirements. This warranty is limited to the requirements in the area in which the unit was originally distributed. AriensCo does not warrant this product to the requirements of any other area. Warranty service is limited to service within the area originally distributed.
- In countries other than the United States and Canada, contact the AriensCo dealer for warranty policies that govern within your country. Rights may vary from country to country and within any one country.

### Evaporative Emissions Control Warranty Exception

As required by the California Air Resources Board (CARB) and the US Environmental Protection Agency (EPA) the evaporative emissions control system is warranted to the ultimate purchaser, and any subsequent owner, for two years.

The CARB and EPA evaporative emissions control system warranty is described in a separate evaporative emission control warranty statement.

### Battery Warranty

Battery warranty is one year. Units used for rental or lease have no exceptions to the 90-day warranty. Total battery claim reimbursement will not exceed 45.00 USD.

## Engines

The chart below details engine warranty information. Engine warranty terms may vary from the specific terms of this warranty. If inconsistent, the terms of the engine warranty shall apply to the engine and its component parts.

| Engine Manufacturer                 | Detail   |
|-------------------------------------|--|
| Ariens AX                           | Ariens-branded engines are warranted by the manufacturer and the warranty is administered by AriensCo. Refer to the engine manual for warranty statements. |
| Briggs & Stratton, Kawasaki, Kohler | Covered by the engine manufacturer's warranty. Refer to the engine manufacturer's warranty statements.   |

## Parts and Accessories

Service replacement parts and non-serialized accessories are warranted for 90 days from date of purchase. Parts and accessories must be installed by an authorized Ariens dealer to be covered. Labor is not included.

## Customer Responsibilities

**Register the product immediately at the time of sale.** If the dealer does not register the product, the customer must register the unit on-line at [www.ariens.com](http://www.ariens.com).

To obtain warranty service, the **original purchaser** must:

- Ensure that the maintenance and adjustments explained in the Operator's Manual are routinely completed.
- Promptly notify AriensCo or an authorized Ariens service representative of the need for warranty service.
- Transport the product to and from the place of warranty service at owner's expense.
- Have the warranty service performed by an authorized Ariens service representative.

To find an authorized dealer use the dealer locator on our websites, or contact us by mail or phone.

| Globally (Except Australia or New Zealand):   | Australia:   | New Zealand:  |
|---|--|---|
| AriensCo<br>655 W. Ryan Street<br>Brillion, WI 54110<br>Phone: (920) 756 - 4688<br><a href="http://www.ariensco.com">www.ariensco.com</a> | Masport Australia Pty Ltd<br>27 Commercial Drive<br>Dandenong South<br>Victoria 3175<br>Australia<br>Phone: 1300 366 225<br><a href="http://www.masport.com.au">www.masport.com.au</a> | Masport Ltd<br>1-37 Mt. Wellington Highway,<br>Panmure,<br>Auckland 1060<br>New Zealand<br>Phone: 0800 627 7678<br><a href="http://www.masport.co.nz">www.masport.co.nz</a> |



### ***Disclaimer***

AriensCo may from time to time change the design of its products. Nothing contained in this warranty shall be construed as obligating the AriensCo to incorporate such design changes into previously manufactured products, nor shall such changes be construed as an admission that previous designs were defective.

### ***Limitation of Remedy and Damages***

AriensCo liability under this warranty, and under any implied warranty that may exist, is limited to repair of any defect in workmanship, and repair or replacement of any defective part. AriensCo shall not be liable for incidental, special, or consequential damages (including lost profits). Some states do not allow the exclusion of incidental or consequential damages, so the above limitation or exclusion may not apply to you.

### ***Australian Consumer Law***

The following applies solely to warranties subject to Subsection 102(1) of the Australian Consumer Law: Our goods come with guarantees that cannot be excluded by the Australian Consumer Law. You are entitled to a replacement or refund for a major failure and for compensation for any other reasonably foreseeable loss or damage. You are also entitled to have the goods repaired or replaced if the goods fail to be of acceptable quality and failure does not amount to a major failure.

### ***Disclaimer of Further Warranty***

AriensCo makes no warranty, express or implied, other than what is expressly made in this warranty. If the law of your state provides that an implied warranty of merchantability, or an implied warranty of fitness for particular purpose, or any other implied warranty, applies to AriensCo, then any such implied warranty is limited to the duration of this warranty. Some states do not allow limitations on how long an implied warranty lasts, so the above limitation may not apply to you.

*This warranty gives you specific legal rights, and you may also have other rights which vary from region to region.*



**ARIENS®**

655 West Ryan Street  
Brillion, WI 54110

[www.ariens.com](http://www.ariens.com)



[parts.ariens.com](http://parts.ariens.com)

**ARIENS|CO**

