

5. INSTALLING THE SCREEN IN THE GROUND

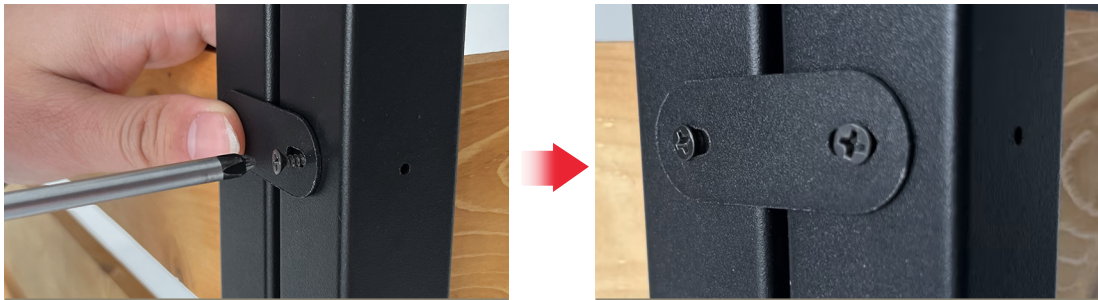

6. INSTALL POST CAPS

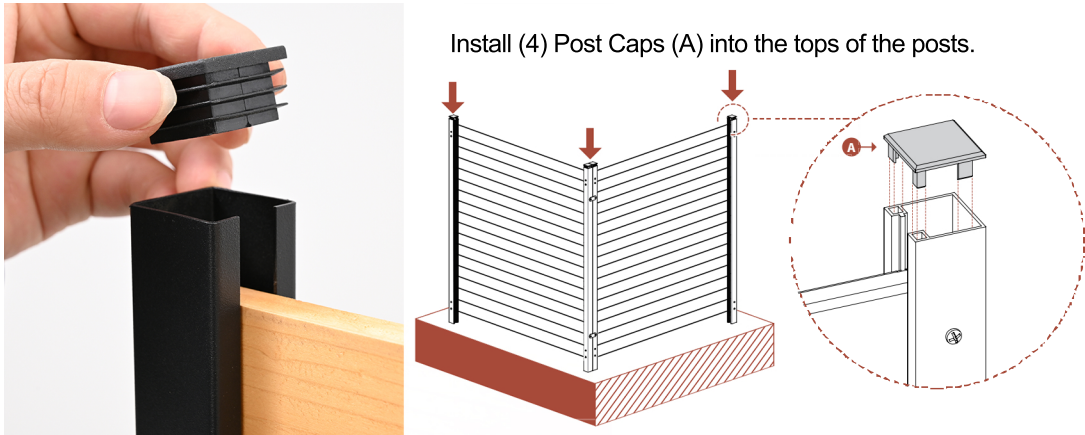

NOTE:

Check the inside of the larger pieces in your box for other materials packed inside.
When assembling components, place on a non-abrasive surface to avoid scratching.
We recommend an area approximately 5'x 8' for unobstructed assembling.
You should not need to use excessive force when assembling components.
If you are having problems with the assembly or installation of this product,
we are happy to assist you with the process,

Contact Mechod:Log in to your Amazon account>select
"your Orders"> find the order ID>click"Contact Seller"



**INSTRUCTION OF OPERATION &
USER MANUAL
OUTDOOR FENCE**

LAY OUT MATERIALS

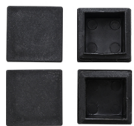

A: Post Cap*4



D: Screw B



B: Joiner Clip*2



C: Screw A



F: Post*4



G: Post Anchor *4



H: Board with holes*4



I: Board without holes

1. FASTEN POST ANCHORS



1. Insert (2) Post Anchors (G), into the posts until the pre-drilled holes in the anchors and posts align.
2. Drive (4) Stainless Steel Screws (C) into the pre-drilled holes in the posts to secure the board and post anchors.

2. INSERT BOARD



1. Insert the first Board with Holes (H)
2. Fix with screw (C)
3. Preliminary formation.

4



4. Insert the last Board with HOLES (I)

5



5. Preliminary formation.

3. INSERT BOARD

Repeat Steps in order to assemble the second screen.

4. INSTALLING THE SCREEN IN THE GROUND

1

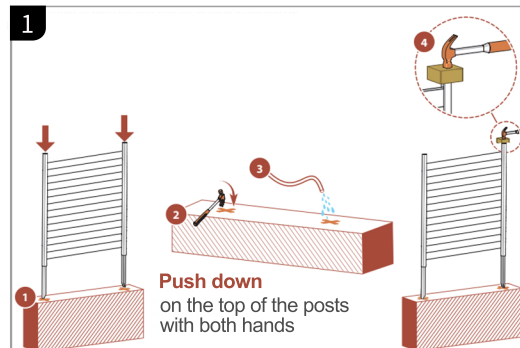

1. Move the screen to its final location and identify where the posts are located. Attempt to push the unit into the ground as illustrated.

(Optional)

2. If your ground is too hard, loosen the top 6" or 7" of the ground with a claw hammer as illustrated.
3. Add water to loosened soil.
4. Use a block of wood to protect the top of the post and gently hammer the post into the ground.

2

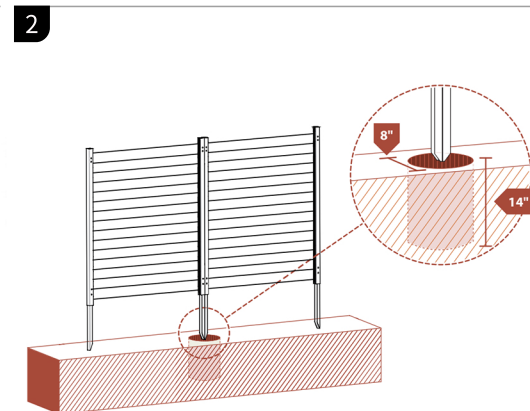

(Optional)

If your ground is too hard, dig a hole 8" in diameter and 14" deep to accommodate one post from each screen as shown below.

3

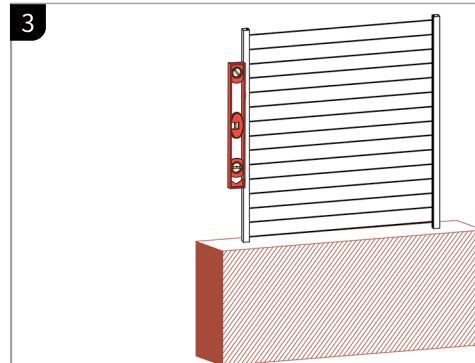

Level the screen, as necessary,
backfill excavated dirt,
and tamp if needed.