

# SHOWER SYSTEM FAUCET

Installation instruction

Boyet Living

## A3807

CH / BN / MB / BG / ORB

Website: www.boyelliving.com

Customer Service: : 323-982-8955

Email: service@boyelliving.com



### 1. INSTALLATION PRECAUTIONS

- When you open the product packaging, please check the product and accessories at first. If there are any discrepancies, please contact us promptly. We will provide you with a satisfactory solution.
- The hot and cold water supply pipe of the valve must be properly connected. When facing the front of the valve, the hot water supply is on the left and cold water supply is on the right. Incorrect connection will cause permanent damage to the cartridge.
- If the accessories to be changed without affecting the use, we will not make a prior notice.
- The impurities in the water supply pipe must be cleared before installation to avoid blockage.
- The water pressure of the faucet is 0.05MPa-1.0MPa (including cold water and hot water Pressure). Applicable water temperature range: 39°F-194°F.

### 2. PREPARATION BEFORE INSTALLATION

CONNECTION ADVICE

Tightly hand tighten the hose to the valve and add a quarter turn using the paper wedge. Tighten hose threaded.

Apply plumber's putty under the plastic cover deck plate to seal your installation. \*The model shown in the installation steps may differ from the one in box however connection type and installation steps are the same.

Plumber's putty

Included

Thread seal tape

### 3. CONCEALED FAUCET ACCESSORIES LIST

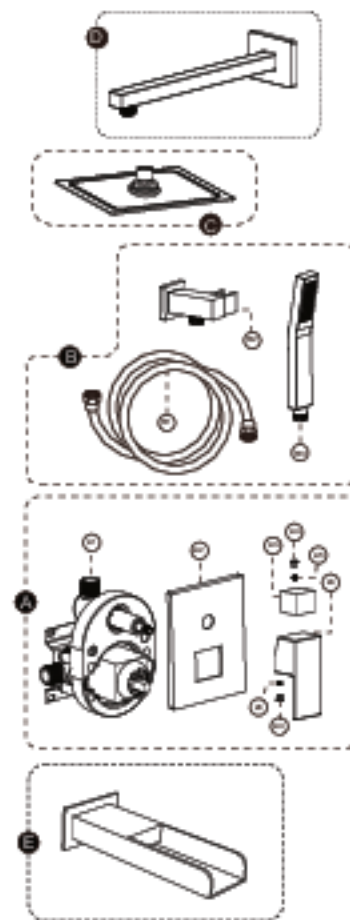

No.	Description
A	Pressure balanced diverter valve
A-1	Valve
A-2	Face plate with seal joint
A-3	Diverter knob kit
A-4	Trim cap
A-5	Allen screw
B	Handheld Shower Kit with Flexible Hose
B-1	Flexible hose
B-2	Hand shower holder
B-3	Hand shower
C	Shower head
D	Shower arm and flange kit
E	Bathtub spout waterfall

#### CARE INSTRUCTIONS

Rinse the product with clear water. Dry the product with a soft cloth.

#### DO NOT

Use abrasive cleansers, cloths, or paper towels. Use any cleaning agents containing acid, polish, wax, alcohol, ammonia, bleach, solvent or any other corrosive or harsh chemical cleansers.

### 4. TECHNICAL DRAWING OF DRILING SIZE

- The size of the valve that needs to be drilled is 5.3" x 6.7".
- The depth of the valve is 1.8"-2.2". It's better to drill the depth of 1.8" for blank wall.

