



5 YEAR
WARRANTY

PURE RELIEF

NECK & SHOULDER HEATING PAD



USER MANUAL
MODEL: PEHNECK

IMPORTANT SAFETY INSTRUCTIONS DO NOT DESTROY

DANGER: TO REDUCE THE RISK OF BURNS, ELECTRIC SHOCK, FIRE, AND PERSONAL INJURY, THIS PRODUCT MUST BE USED IN ACCORDANCE WITH THE FOLLOWING INSTRUCTIONS:

1. READ ALL INSTRUCTIONS.
2. DO NOT USE WHILE SLEEPING.
3. DO NOT USE ON AN INFANT OR ON AN ANIMAL.
4. THIS PRODUCT IS NOT TO BE USED ON OR BY AN INVALID, A SLEEPING OR UNCONSCIOUS PERSON, A PERSON WITH DIABETES, OR A PERSON WITH POOR BLOOD CIRCULATION UNLESS CAREFULLY ATTENDED.
5. DO NOT USE ON AREAS OF THE SKIN THAT ARE INSENSITIVE TO TOUCH OR HEAT.
6. BURNS CAN OCCUR REGARDLESS OF CONTROL SETTING. CHECK SKIN UNDER PRODUCT FREQUENTLY.
7. DO NOT USE IN AN OXYGEN-FILLED ATMOSPHERE.
8. DO NOT USE PINS OR OTHER METALLIC OBJECTS TO FASTEN THIS PRODUCT INTO PLACE.
9. DO NOT SIT ON OR AGAINST THE PRODUCT OR CRUSH IT. AVOID SHARP FOLDS IN THE FABRIC.
10. DO NOT USE THE CORD AS A HANDLE.
11. CHILDREN SHOULD NOT USE THIS UNIT WITHOUT ADULT SUPERVISION.

12. PLACE UNIT ON TOP OF AND NOT UNDER THE PART OF THE BODY THAT REQUIRES HEAT THERAPY.
13. ONLY USE THIS PRODUCT ON A 110-120V AC CIRCUIT.
14. UNPLUG WHEN NOT IN USE.
15. DO NOT USE WITH GENERATORS, POWER CONVERTERS, OR INVERTERS.
16. DO NOT TAMPER WITH THIS PRODUCT IN ANY WAY
17. THERE ARE NO USER-SERVICEABLE PARTS. IF FOR ANY REASON THIS PRODUCT DOES NOT FUNCTION PROPERLY, CONTACT PURE ENRICHMENT AT HELP@PUREENRICHMENT.COM
18. DO NOT USE THIS PRODUCT WITH LINIMENT, SALVE OR OINTMENT PREPARATIONS AS SKIN BURNS CAN RESULT.
19. NEVER PULL THIS PAD BY THE SUPPLY CORD.
20. DO NOT BEND OR PINCH THE CORD.
21. DO NOT USE PRODUCT IF THE CORD IS DAMAGED.
22. NEVER LEAVE THE PRODUCT UNATTENDED, ESPECIALLY IF CHILDREN ARE PRESENT.
23. LOOP CORD LOOSELY WHEN STORING. TIGHT WRAPPING CAN DAMAGE CORD & INTERNAL PARTS.
24. THIS PRODUCT HAS A POLARIZED PLUG (ONE BLADE IS WIDER THAN THE OTHER). TO REDUCE THE RISK OF ELECTRIC SHOCK, THIS PLUG IS INTENDED TO FIT IN A POLARIZED OUTLET ONLY ONE WAY. IF THE PLUG DOES NOT FIT FULLY IN THE OUTLET, REVERSE THE PLUG. IF IT STILL DOES NOT FIT, CONTACT A QUALIFIED ELECTRICIAN TO INSTALL THE PROPER OUTLET.

- DO NOT ATTEMPT TO MODIFY THE PLUG OR DISABLE THIS SAFETY FEATURE IN ANY WAY.
25. SAVE THESE INSTRUCTIONS.

INTRODUCTION

Thank you for purchasing PureRelief Neck & Shoulder Heating Pad. We designed this unit to fit your neck and shoulder area where most people experience the most tension and stress.

Wrap the product comfortably around your shoulders and neck, making sure the neck flap lays flat on your neck. To help maintain proper placement during use, PureRelief is manufactured with weighted edges and integrated magnets.

NOTE: Remove necklaces and other metal accessories during use to keep them from attaching to the magnets built into PureRelief.

USING PURERELIEF

Attach the Pad Connector to the Control Connector. Push both parts together securely to ensure a tight fit.

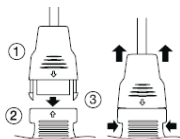

1. CONTROL CONNECTOR
2. PAD CONNECTOR
3. LOCKING CLIPS

NOTE: The Control Connector must be connected to the Pad Connector before plugging the unit into an electrical outlet.

1. After connecting the Pad Connector to the Control Connector, plug the unit into a 120V AC electrical outlet.
2. To turn PureRelief on, press the power button. Select the desired heat setting (warm, low, medium, or high) by continuing to press the power button until the heat indicator light turns on your desired setting.

USING PURERELIEF

NOTE: The "High" indicator light will blink red when an error occurs. If this happens, unplug PureRelief from the electrical outlet then check the physical condition of the cord, the wall outlet, and the connection between the Control Connector and the Pad Connector. If blinking persists even after you have confirmed a proper connection, contact Pure Enrichment at: help@pureenrichment.com

3. To turn PureRelief off, scroll through the remaining heat settings sequentially until the heat indicator lights turn off.

NOTE: If the heat level indicators do not light up or stay on, make sure the Control Connector is securely plugged into the Pad Connector.

AUTO-OFF FEATURE

To conserve energy and prevent skin burns caused by excessive use, PureRelief includes an auto-off feature. The unit will turn off automatically after two hours of continuous use. The red auto-off light will blink when this feature is activated.

NOTE: After a power outage, PureRelief automatically resets the timer on the auto-off feature.

USING MOIST HEAT THERAPY

In some cases, you may find that moist heat therapy provides more comfort and tension relief. When using moist heat therapy, you should protect furniture and clothing from becoming damp.

1. Dampen one side of PureRelief with water by patting the surface with a wet sponge or cloth or use a spray bottle to apply a fine mist. Do not thoroughly soak PureRelief.
2. Do not spray or dampen the connector.

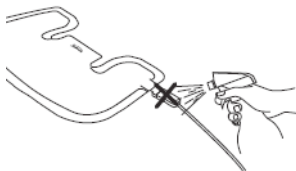

DANGER: Do not immerse any part of PureRelief in water or place under running water while plugged in. Doing so can damage PureRelief and cause serious personal injury.

NOTE: The Pad Connector and the Control Connector must be completely dry before establishing an electrical connection.

WASHING INSTRUCTIONS

DO NOT DRY CLEAN! DO NOT USE BLEACH! DO NOT USE WRINGER!

1. Disconnect PureRelief from the electrical outlet
2. Detach the Pad Connector from the Control Connector
3. Machine wash PureRelief in cold water on the gentle cycle, or hand wash. Tumble dry on low heat or line dry.
4. Do not plug in PureRelief until the Pad Connector is completely dry.

PRODUCT SPECIFICATIONS

Pad Size:	14" x 22"
Power Supply:	AC: 120V, 60Hz, 55W
Pad Material:	Micromink (both sides)
Auto Shut-Off Timer:	120 minutes
4 Heat Settings:	Warm—green light, temperature range (~110 F) Low—yellow light, temperature range (~120 F) Medium—orange light, temperature range (~130 F) High—red light, temperature range (~140 F)

WARRANTY

PureRelief comes with an industry-leading 5 Year Warranty that begins on the date of purchase.

The warranty applies to the heating pad and necessary parts and labor relating thereto. The warranty does not apply to damage resulting from failure to follow the operating instructions, accidents, abuse, alterations, or disassembly by unauthorized individuals.

PRODUCT REGISTRATION

To ensure your full warranty and to receive product updates and streamlined customer support, remember to register your product at:

www.pureenrichment.com/productregistration

ARE YOU 100% SATISFIED?

If you have product questions or concerns don't hesitate to contact us directly at:

help@pureenrichment.com

Pure Enrichment has an award-winning warranty, exchange, and customer service program that guarantees hassle-free solutions within 24 hours to any issue you might have!

FCC NOTICE

Model: PureRelief Neck & Shoulder Heating Pad (PEHNECK)

This device complies with part 15 of the FCC Rules. Operation is subject to the following two conditions: (1) This device may not cause harmful interference, and (2) this device must accept any interference received, including interference that may cause undesired operation.

Pure Enrichment
14505 Astronautics Lane
Huntington Beach, CA 92647
www.pureenrichment.com

The product is protected against unauthorized use. DO NOT modify it without the authorization of the manufacturer, or the user's authority to operate could be voided.

Note: This equipment has been tested and found to comply with the limits for a Class B digital device, pursuant to part 15 of the FCC Rules. These limits are designed to provide reasonable protection against harmful interference in a residential installation. This equipment generates, uses and can radiate radio frequency energy and, if not installed and used in accordance with the instructions, may cause harmful interference to radio communications. However, there is no guarantee that interference will not occur in a particular installation. If this equipment does cause harmful interference to radio or television reception, which can be determined by turning the equipment off and on, the user is encouraged to try to correct the interference by one or more of the following measures:

- Reorient or relocate the receiving antenna.
- Increase separation between equipment and receiver.
- Connect the equipment into an outlet on a circuit different from that to which the receiver is connected.
- Consult the dealer or an experienced radio/TV technician for help.



Huntington Beach, CA 92647
www.pureenrichment.com