

TALOYA

Ceiling Fan with Light

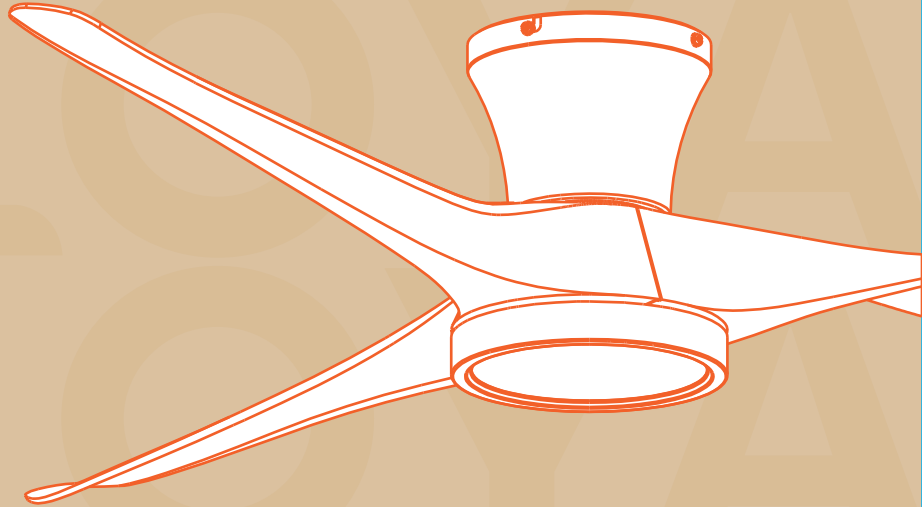

Technical specifications

Ceiling Fan Light

Model: TLY-52-BK-3X-R3
TLY-52-BW-3X-R3
TLY-52-WE-3X-R3

Input: AC100-240V 50/60Hz

Size: ϕ 52inch; H9inch

Power: 50W (Fan: 35W Light: 15W)

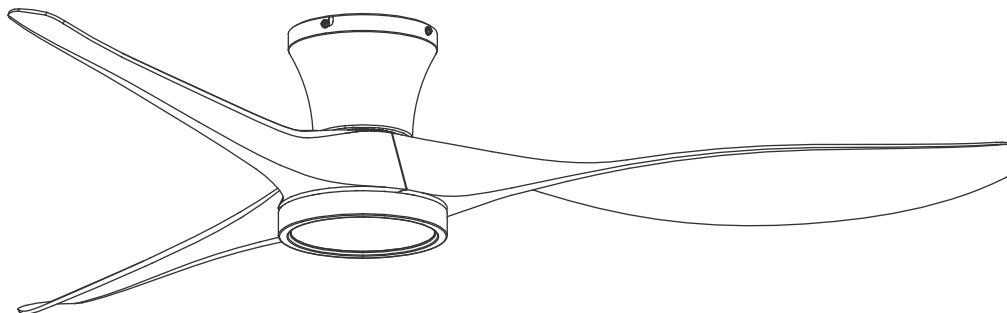

WARNING



✓ ON/OFF switch



✗ Dimmable switch

Disconnect power prior to installation, inspection, or removal
Do not touch when light is on or when it is hot
If there is any problem with the fixture, turn power off and do not attempt to repair unless you are a qualified technician
Do not expose to water or rain

Packing List



Mounting Bracket



Canopy Washer



Canopy



Fan Motor Assembly

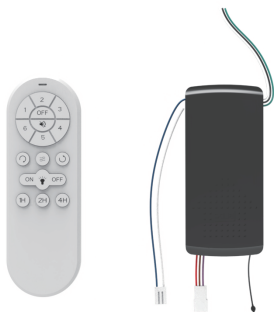

Remote Control

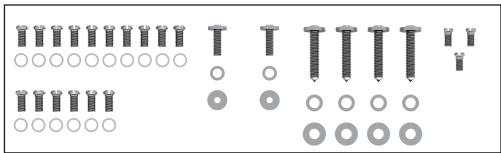

Screw Pack



Light Fixture



Blade

Installation Guide

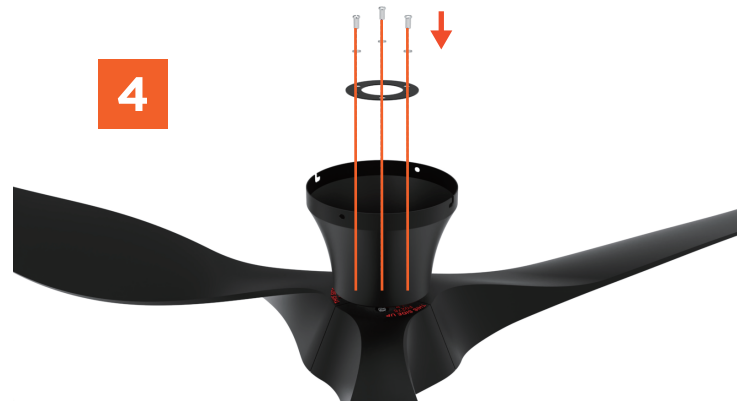
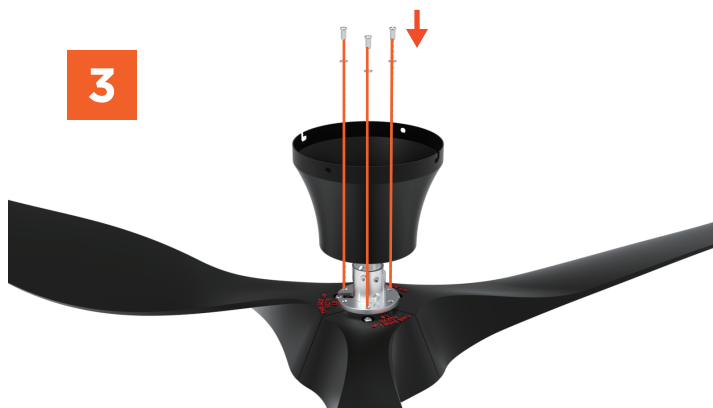
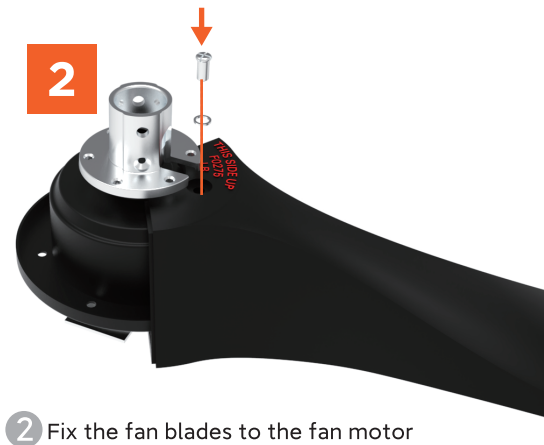
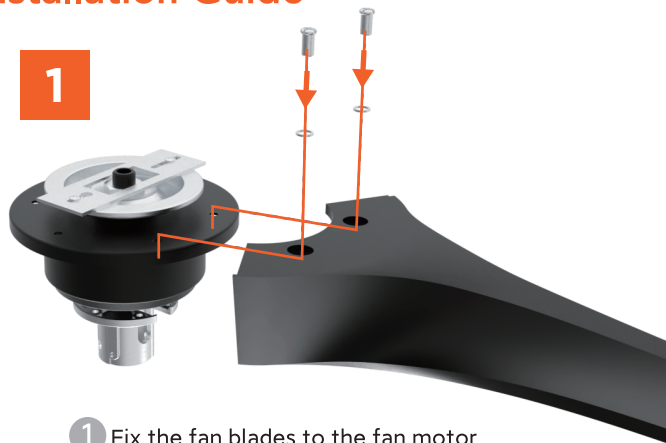

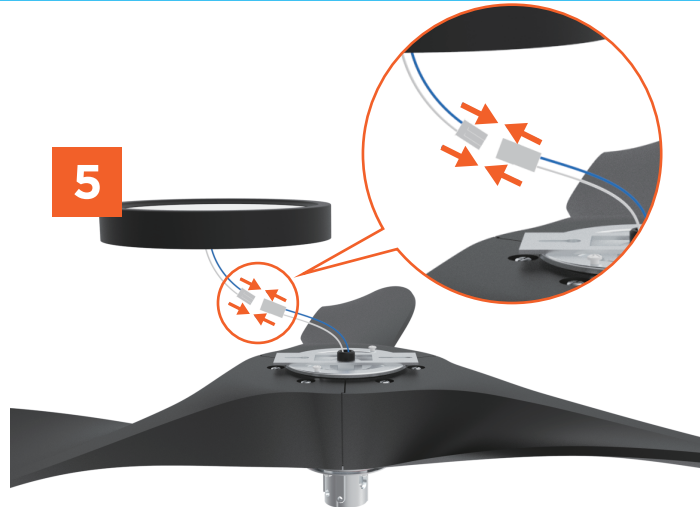

5 Connect the wires of the light fixture.

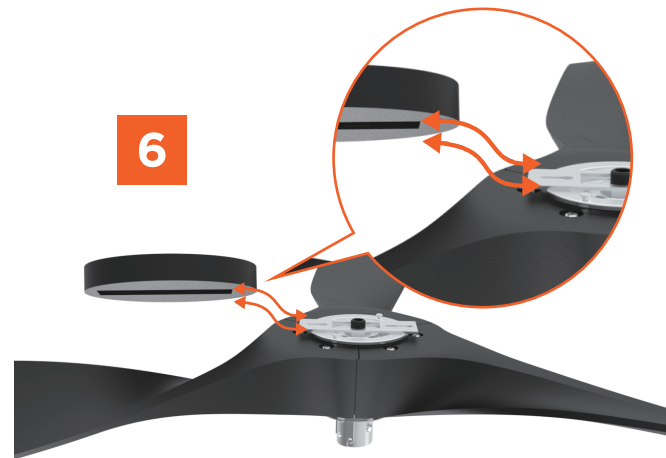

6 Install the light fixture onto the fan.

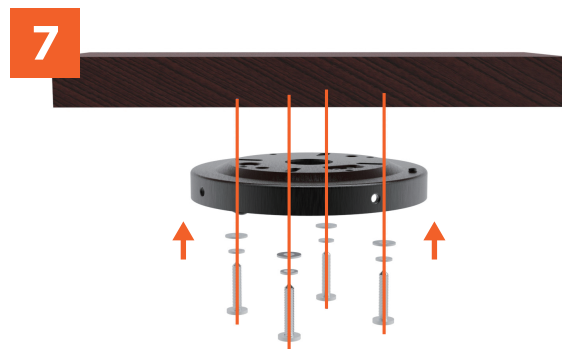

7 Fix the Mounting Bracket to the ceiling.



8 Hang the fan onto the mounting bracket on the ceiling.



- 9 Connect the fan controller's two wire sets (one for lighting, one for fan control) to their respective matching wires on the fan.

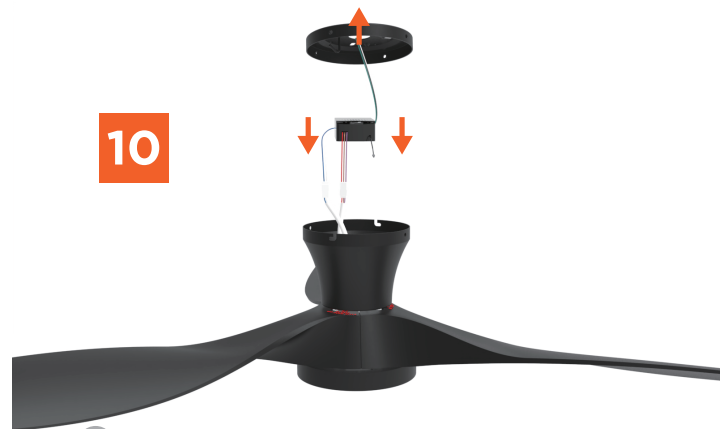

- 10 Connect the input of the controller to the ceiling power cord and place the controller inside the canopy.



- 11 Hang the fan onto the ceiling, secure it in place.



- 12 Installation is complete.

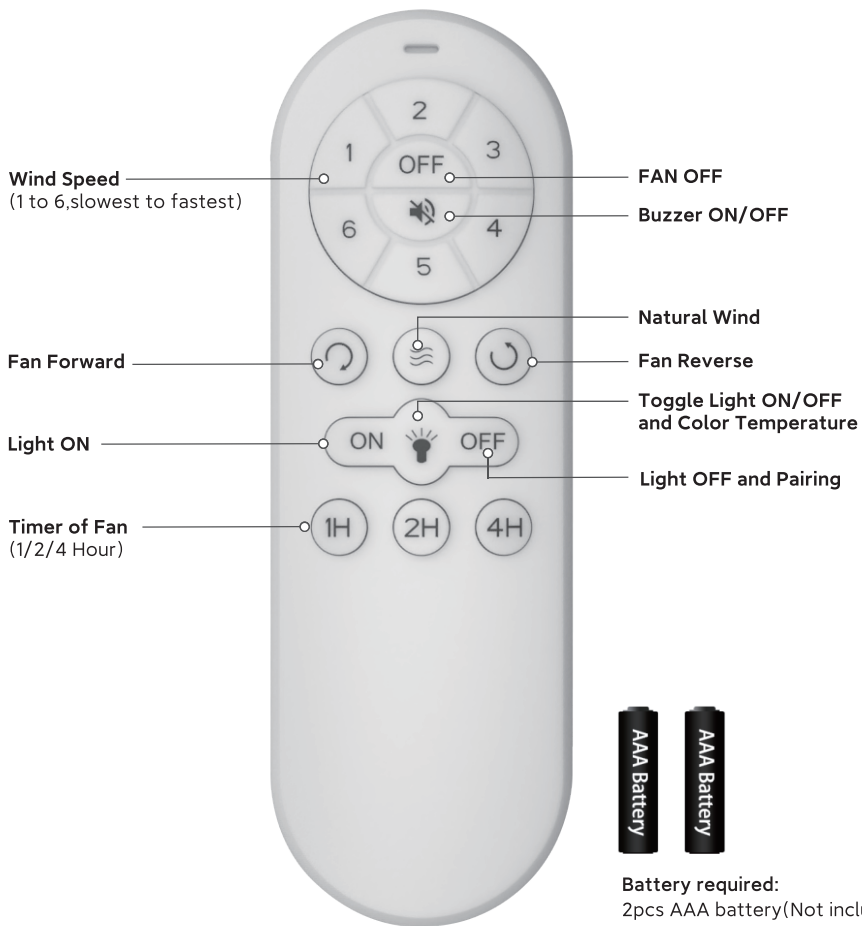

Battery required:
2pcs AAA battery(Not included)

PAIRING METHOD:

Within the first 30 seconds of powering on the fan, press and hold the 'Light OFF' button. A successful pairing is indicated by a beep sound.

TROUBLESHOOTING GUIDE:

If you find the remote control unable to operate the fan, please follow these steps to resolve the issue:

- 1, Check the remote control's battery for proper contact, correct placement, and sufficient charge.
- 2, Re-pair the remote control with the ceiling fan .

AFTER-SALES SERVICE:

Go to Your Orders – Find your order in the list–Select "Problem with order"–Choose your topic from the list displayed – Select Contact Seller.

Service Mailbox: info@taloya.com



info@taloya.com
www.taloya.com