

## ASSEMBLY INSTRUCTIONS



### CAUTION

◆ Inspect the wire insulation for any cuts, abrasions, or exposed copper that may have resulted during shipping. If there is a defect in the wire, do not attempt installation.

◆ Before starting installation of this fixture or removal of a previous fixture, disconnect the power by turning off the circuit breaker or by removing the fuse at the fuse box.



If you need further assistance, please contact us by Email: [customersupport@superiordecorinc.com](mailto:customersupport@superiordecorinc.com)

### TOOLS REQUIRED



Ladder



Safety glasses



Electrical tape



Phillips screwdriver



Flat blade screwdriver



Pliers

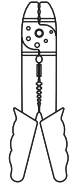

Wire strippers

### HARDWARE INCLUDED

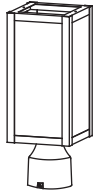

Fixture



Cover



Rubber Rings

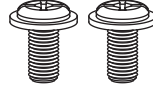

Fixture Screws



Wire Nuts

**\*PARTS SHOWN MAY DIFFER SLIGHTLY PER LIGHT FIXTURE**

### EXPLODED PARTS

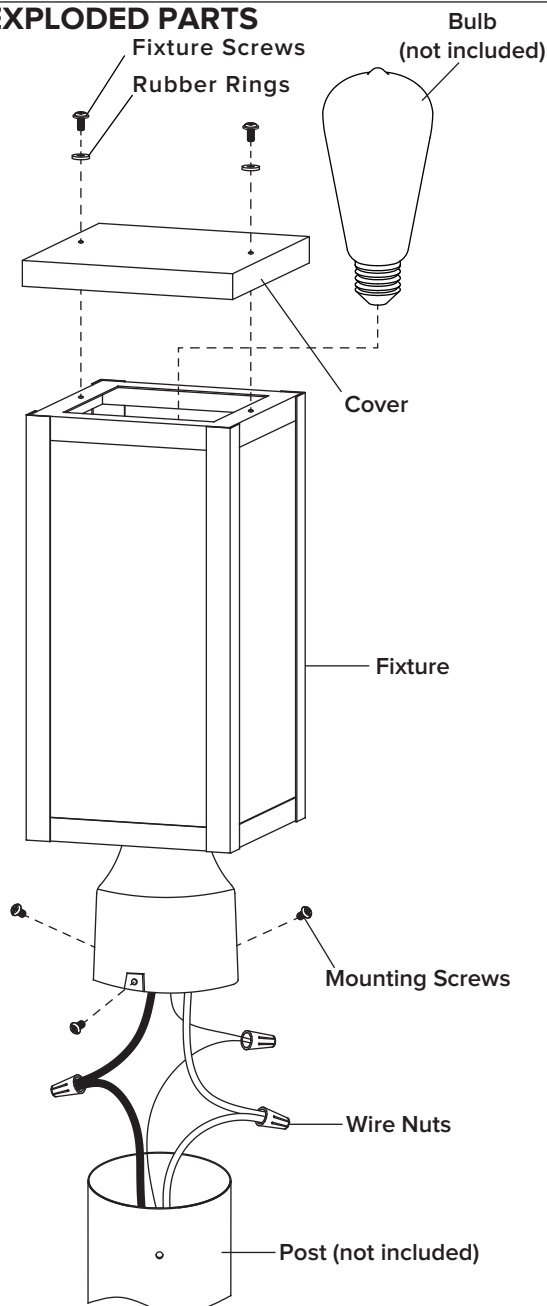

### INSTALLATION

#### STEP 1

Unscrew the **mounting screws** from the **fixture**.

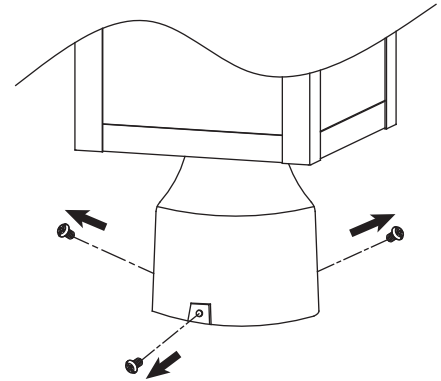

#### STEP 2

Make the electrical connection from the **post** (not included) to the **fixture**. Connect the live wire, neutral wire and ground wires with the supplied **wire nuts**. Secure with electrical tape.

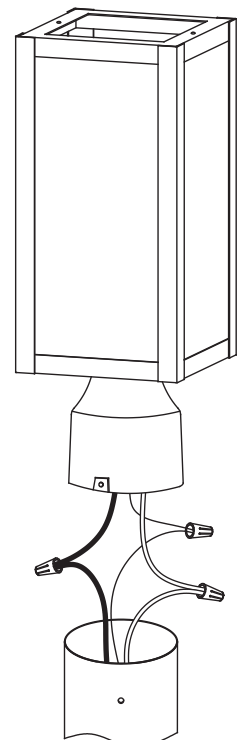
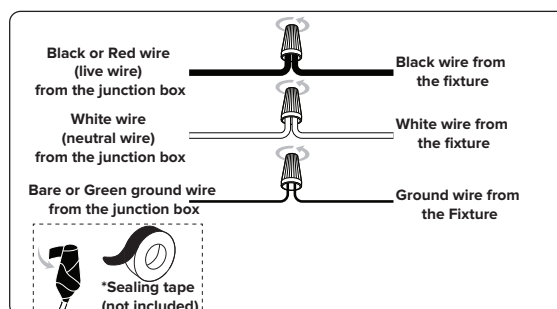

**\*Accommodates a 3 in. post (not included)**

## ASSEMBLY INSTRUCTIONS (INSTALLATION)

### STEP 3

Attach the **fixture** to the **post** (not included) through screw holes as shown, and secure it with **mounting screws**

\*Accommodates a 3 in. post (not included)

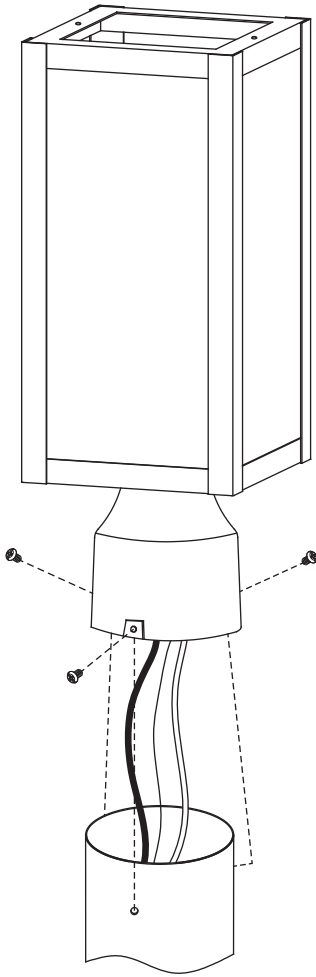

### STEP 4

Install bulb (not included).

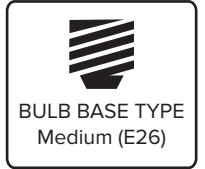

BULB BASE TYPE  
Medium (E26)

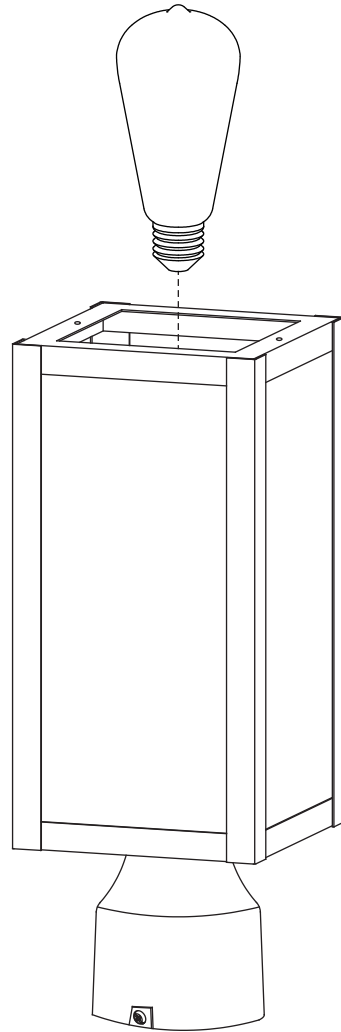

### STEP 5

Attach the **cover** onto **fixture** using **rubber rings** and **fixture screws**.

