



PROJECT SOURCE and logo design  
are trademarks or registered trademarks  
of LF, LLC. All rights reserved.

ITEM #5745380

MODEL #43085

# WALL LANTERN

**Español p. 10**

**ATTACH YOUR RECEIPT HERE**

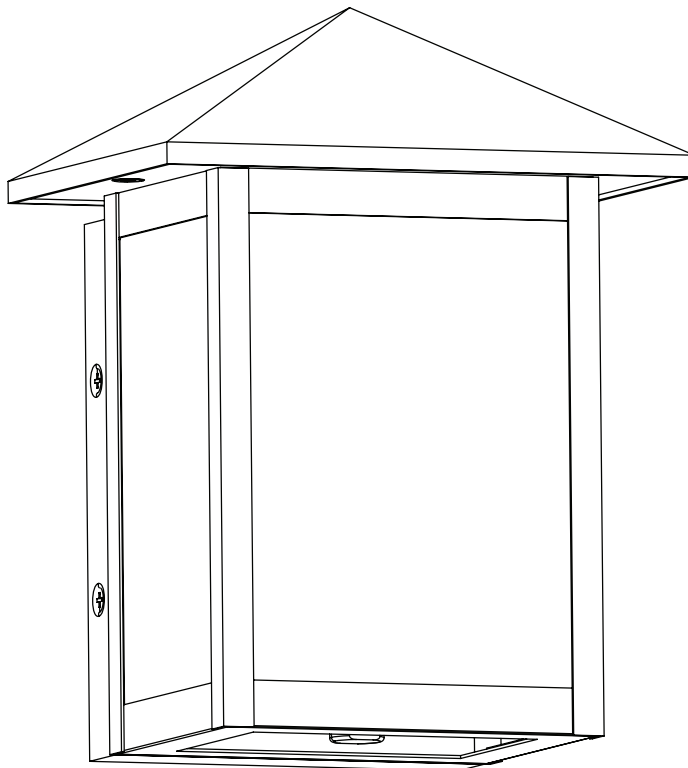

**RATED FOR  
WET  
LOCATIONS**

Purchase Date \_\_\_\_\_

Thank you for purchasing this PROJECT SOURCE product.  
Questions, problems or missing parts?  
Before returning, contact us at:  
**866-389-8827**, 8 a.m. - 8 p.m., EST, Monday - Sunday or **ascs@lowes.com**.

AK24034

**TABLE OF CONTENTS**

---

Package Contents. . . . . 3

Hardware Contents. . . . . 3

Preparation . . . . . 3

Safety Information. . . . . 4

Assembly Instructions. . . . . 5

Troubleshooting. . . . . 9

3-Year Limited Warranty. . . . . 9

PACKAGE CONTENTS

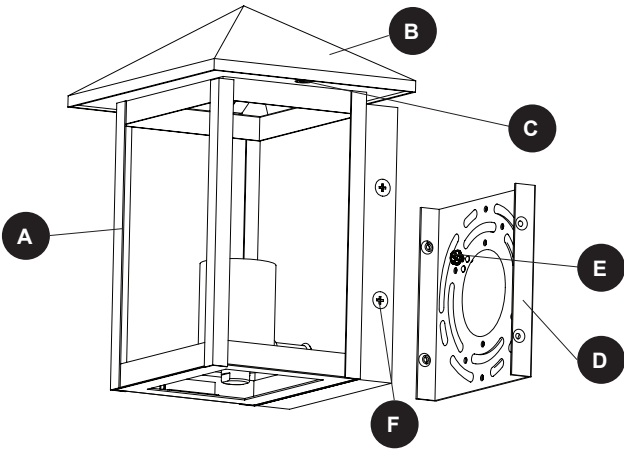

PART	DESCRIPTION	QUANTITY
A	Fixture	1
B	Fixture Cover (preassembled to Fixture [A])	1
C	Fixture Screw (preassembled to Fixture [A])	2
D	Mounting Bracket (preassembled to Fixture [A])	1
E	Ground Screw (preassembled to the Mounting Bracket [D])	1
F	Mounting Screw (preassembled to Fixture [A])	4

HARDWARE CONTENTS

AA



Wire Connector  
Qty. 3

RR



Bracket Screw  
Qty. 2

PREPARATION

Estimated Assembly Time: 60 minutes

Tools Required for Assembly (not included):

Helpful Tools (not included)

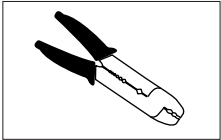
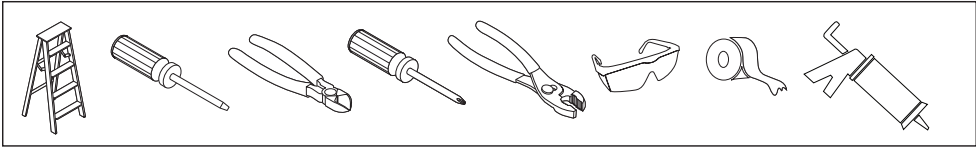

## **SAFETY INFORMATION**

---

Please read and understand this entire manual before attempting to assemble, operate or install the product. Failure to do so could lead to electrical shock, fire or other injuries that could be hazardous or even fatal.

- Before you begin installing the fixture, disconnect the power by removing fuses or turning off the circuit breakers.
- The net weight of the fixture is 2.09 lbs.
- **RATED FOR WET LOCATIONS.** This fixture is intended for indoor, damp, or outdoor use.



### **DANGER:**

- **DO NOT** connect this fixture to an electrical system that does not provide a means for equipment grounding. Never use a fixture in a two-wire system that is not grounded. Installing a fixture into an electrical system not having a proper grounding means could cause metal parts of the fixture to carry electrical currents if any of the fixture wires, wire connections or splices were to become broken, cut or loose during the mounting or normal operation of the fixture. Under this condition, anyone coming in contact with the fixture would be subject to electrical shock, which could cause serious injury or death.
- **DO NOT** connect the bare or green insulation fixture ground wire to the black (hot) current-carrying wire or the white neutral house wire. Connection of the bare or green fixture ground wire to the black or white house wires may cause metal parts of the fixture to carry electrical currents. Under this condition anyone coming in contact with the fixture will receive electrical shock, which could cause serious injury or death.
- **DO NOT** damage or cut the wire insulation (covering) during installation of the fixture. **DO NOT** permit wires to contact any surface having a sharp edge. To do so may damage or cut the wire insulation, which could cause serious injury or death from electrical shock.



### **WARNING:**

- All electrical connections must be in agreement with local codes and ordinances, the National Electric Code (NEC) and ANSI/NFPA 70-1999. Contact your municipal building department to learn about your local codes, permits and/or inspections. Risk of fire - most dwellings built before 1985 have supply wire rated for 140°F. Consult a qualified electrician before installation.
- To avoid personal injury, the use of gloves may be necessary while handling fixture parts with sharp edges.
- **DO NOT** suspend any fixture by the house wires. A fixture must always be mounted directly to a an outlet box. Wire connectors will not support the weight of a fixture. Suspending a fixture by the house wires and wire connectors will result in the fixture falling, with the possibility of personal injury and the danger of electrical shock or fire.
- To reduce the risk of fire, electrical shock, or personal injury, each wire connector used with this light kit should accept only one 18-gauge wire from the light fixture and one 18-gauge wire from the outlet box. If there are three or more wires to connect or any of the wires is larger than 18 gauges, consult an electrician for the proper size wire connectors to use.

## ASSEMBLY INSTRUCTIONS

1. Turn off the circuit breakers and the wall switch to the supply line leads.



**DANGER:** Failure to disconnect the power supply prior to installation may result in serious injury or death.

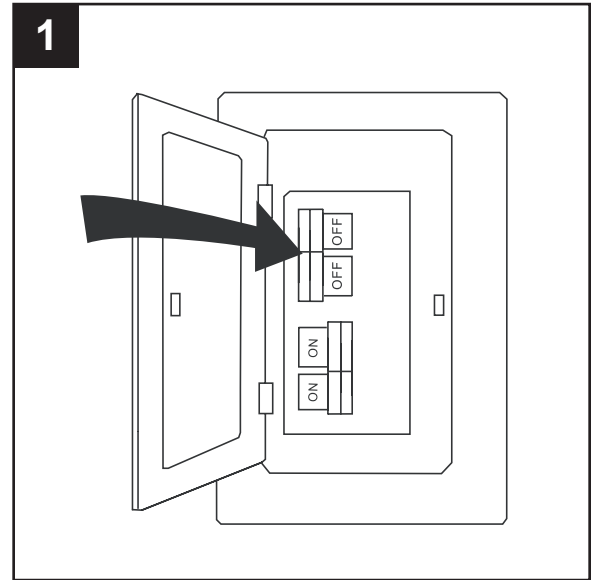

2. Remove the four mounting screws (F) from the sides of fixture (A). Then, remove the mounting bracket (D).

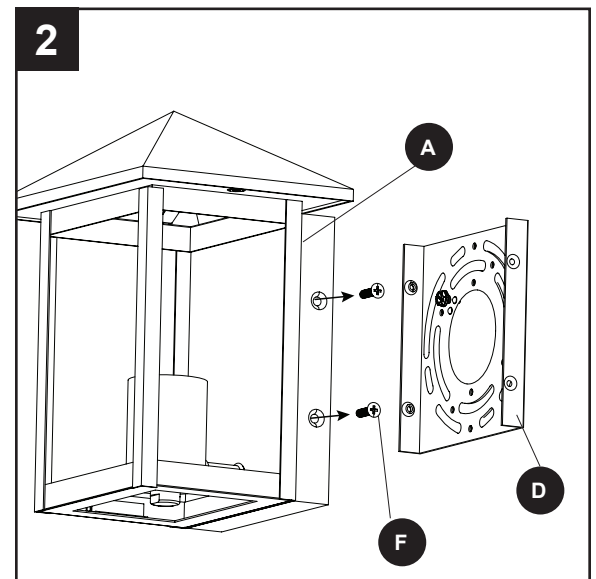

3. Remove the two fixture screws (C) preassembled to fixture (A). Then remove fixture cover (B).

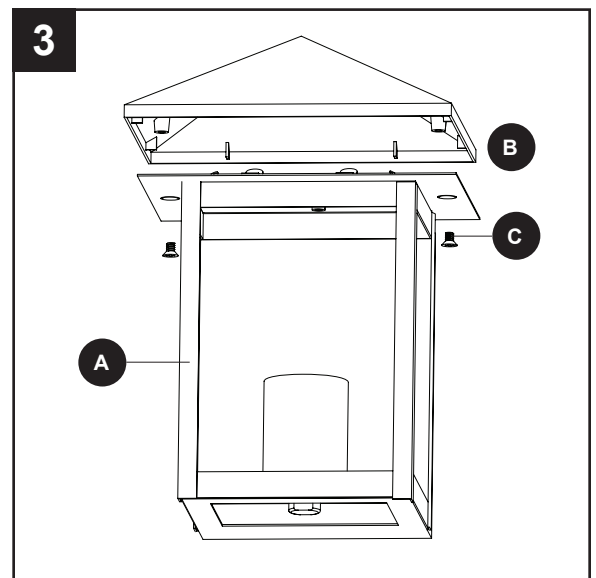

## ASSEMBLY INSTRUCTIONS

4. Install the E26-base bulb (sold separately) into the socket of fixture (A).

**Note:** Fixture is compatible with any E26-base LED, CFL, or incandescent bulb (60 watt max.).

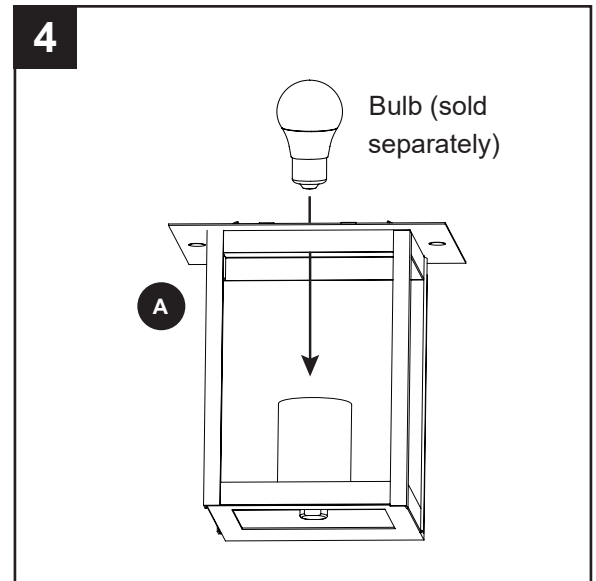

5. Lift fixture cover (B) back onto fixture (A). Then, use previously removed fixture screws (C) to attach fixture cover (B) to fixture (A).

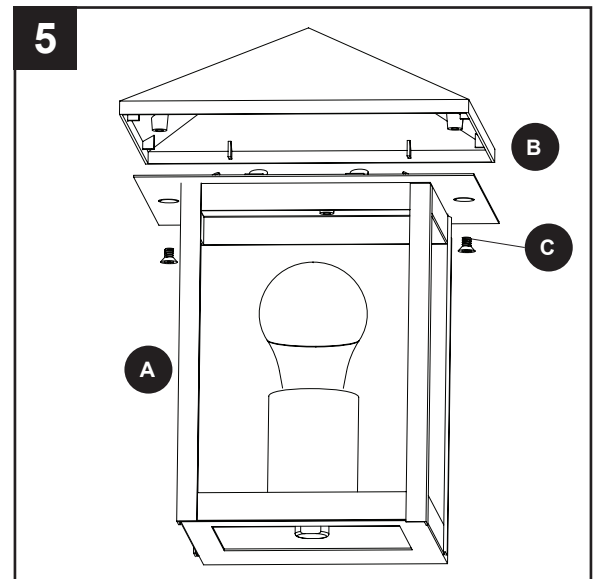

6. Use the bracket screws from the hardware bag to attach the mounting bracket securely to the outlet box.

**Note:** In order for fixture to be level, the mounting screws must be aligned exactly perpendicular to the horizon since they will determine the orientation of the fixture.

### Hardware Used

**RR** Bracket Screw  x 2

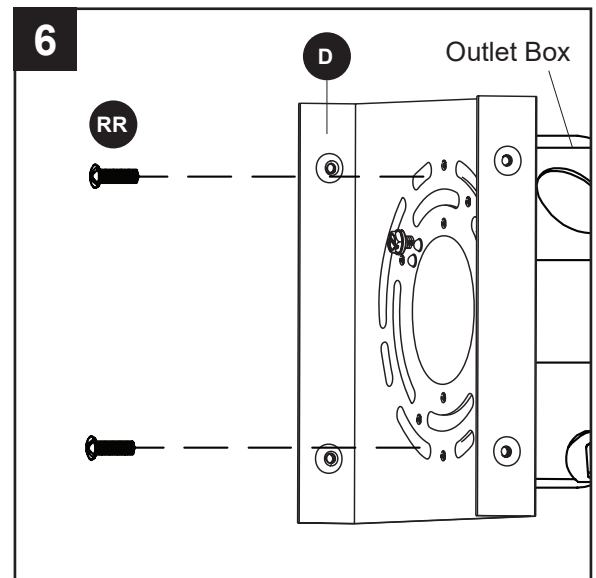

## ASSEMBLY INSTRUCTIONS

7. Loosen the ground screw on the mounting bracket (D) and wrap the bare wire from the fixture around the ground screw (G). Tighten the ground screw (G) to hold the bare wire in place. **Note:** Ensure there is enough of the bare wire extending from the ground screw (G) to connect to the ground wire from the outlet box using a wire connector (AA).

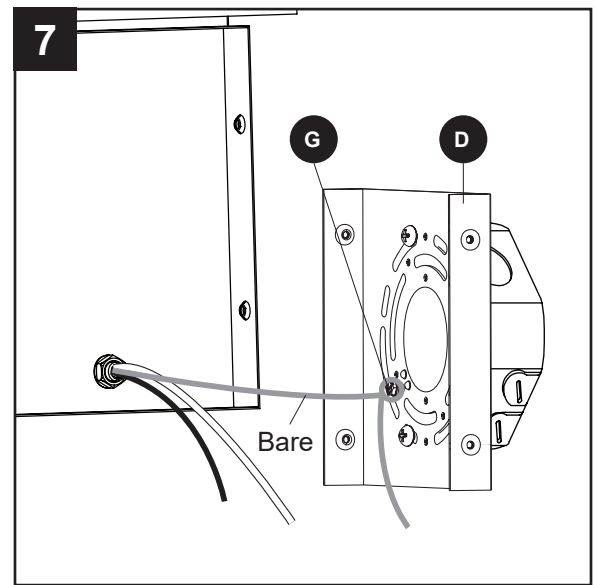

8. Use wire connectors (AA) to secure the household supply wires to the fixture wires according to the image and the following instructions:
- Connect the black (hot) supply wire to the black wire from the fixture.
  - Connect the white (neutral) supply wire to the white wire from the fixture.
  - Connect the bare/green (ground) supply wire to the bare wire from the fixture.

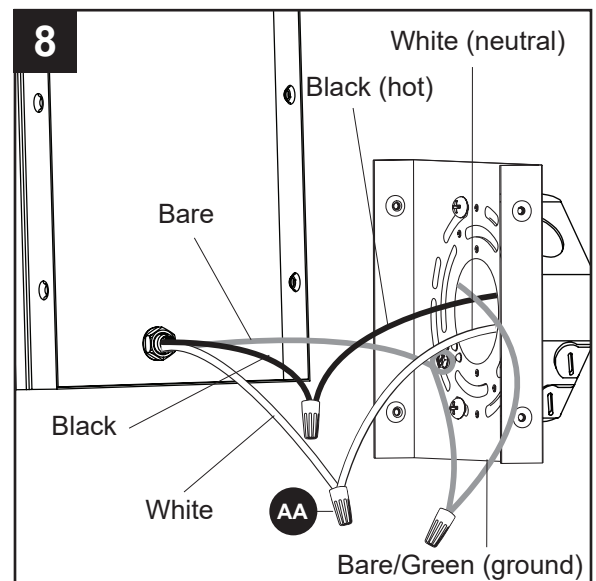

### Hardware Used

**AA** Wire Connector x 3



9. Wrap electrical tape (not included) around each individual wire connector (AA) down to the wire. Turn the spliced/taped wires upward and gently push the wires and wire connectors (AA) into the outlet box.

**WARNING:** Ensure no bare wire strands are visible after making connections. Place Green and White wire connections on opposite sides of outlet box from the Black.

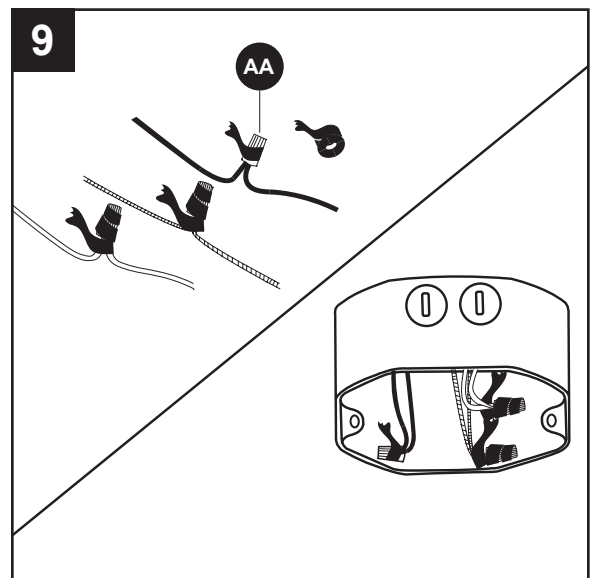

## ASSEMBLY INSTRUCTIONS

10. Hang fixture (A) on mounting bracket (D). Then use the mounting screws (F) to secure fixture (A) to the mounting bracket (D).

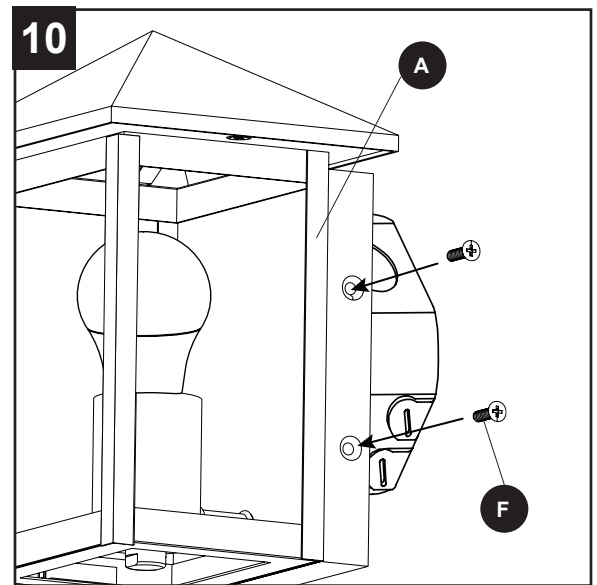

11. To prevent water, rain, or moisture from entering the back of fixture (A), use waterproof caulk (sold separately) to seal the perimeter.

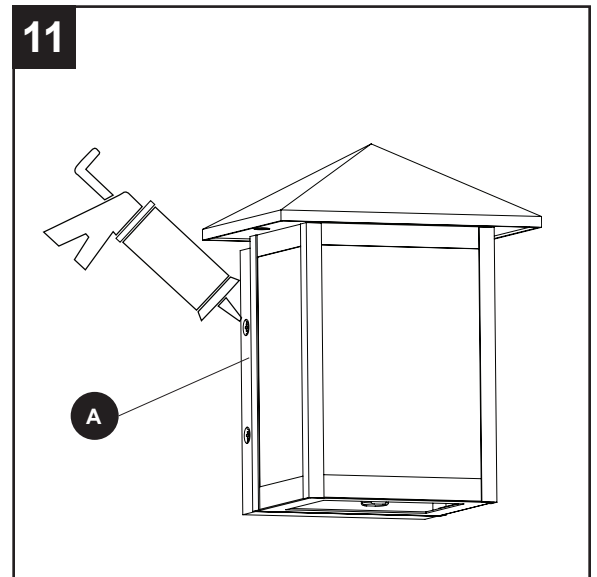

12. Restore the power at the main fuse or circuit breaker and wall switch.

Assembly is complete.

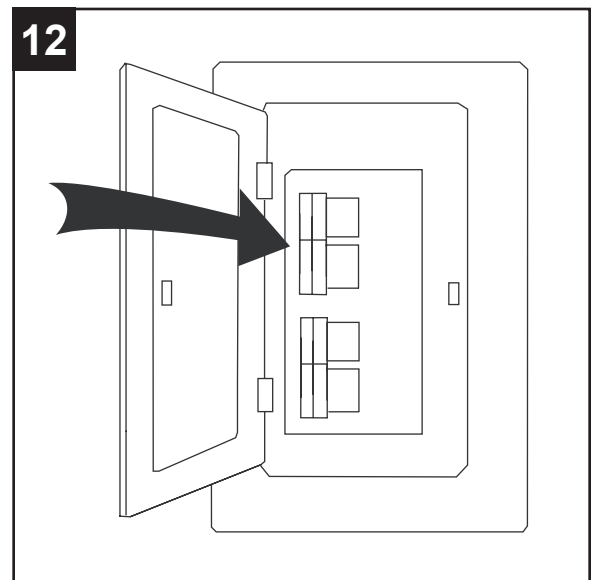



## TROUBLESHOOTING

---

PROBLEM	POSSIBLE CAUSE	CORRECTIVE ACTION
Bulb will not light.	1. Fixture may be wired incorrectly. 2. Worn or broken bulb.	1. Check wiring. 2. Replace bulb.

## THREE-YEAR LIMITED WARRANTY

---

The manufacturer warrants all of its lighting fixtures against defects in materials and workmanship for three (3) years from the date of purchase. If within this period the product is found to be defective, take a copy of the bill of sale as a proof of purchase and the product in its original carton to the place of purchase. The manufacturer will, at its option, repair, replace or refund the purchase price to the consumer. All costs of installation and removal of the fixture is the responsibility of the consumer. This warranty does not cover fixtures becoming defective due to misuse, accidental damage or improper handling and/or installation and specifically excludes liability for direct, incidental or consequential damages. As some states do not allow exclusions of limitations on an implied warranty, the above exclusion and limitation may not apply. This warranty gives you specific rights and you may also have other rights which may vary from state to state.