

Your new Leick Home table will give you years of trouble-free performance. Thank you for choosing our product for your home. **Please read carefully and save these instructions, as you may need them at a later date.**

## What's in the box

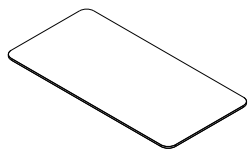

**A** Glass Top

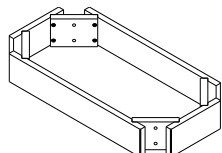

**B** Frame Assembly



**C** Leg N°1 x2

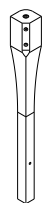

**D** Leg N°2 x2

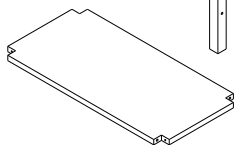

**E** Shelf



**F** Wooden Dowel x4



**G** Screw x4

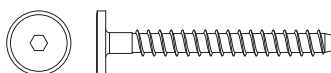

**H** Bolts x8

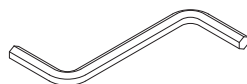

**I** Allen Wrench



**J** Suction cup x4

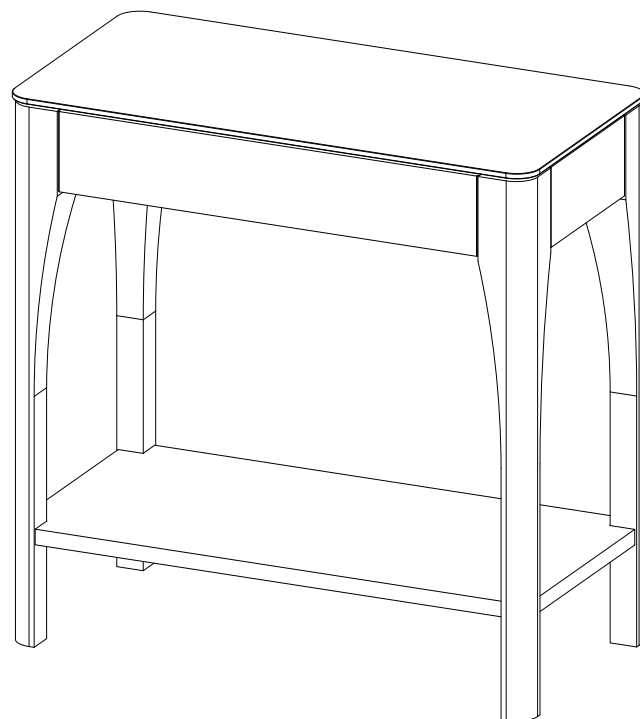

**Figure 1**

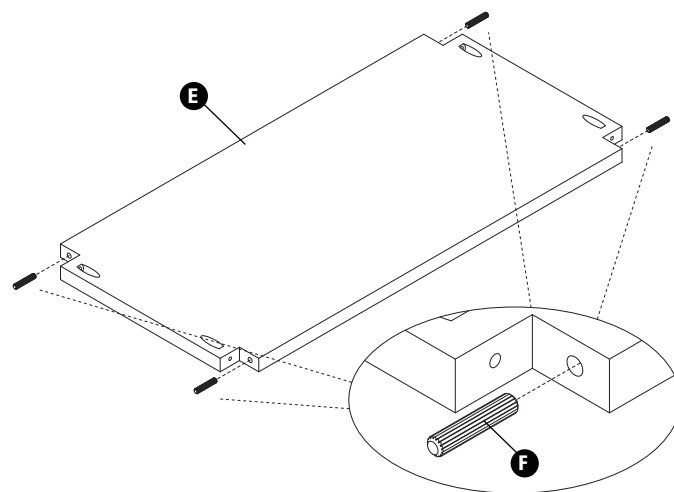

## Steps to Install

1. Before installation, carefully unpack and identify all parts.
2. Attach **wooden dowels (F)** to **shelf (E)**.  
(see figure 1).

Continued on next page

Figure 2

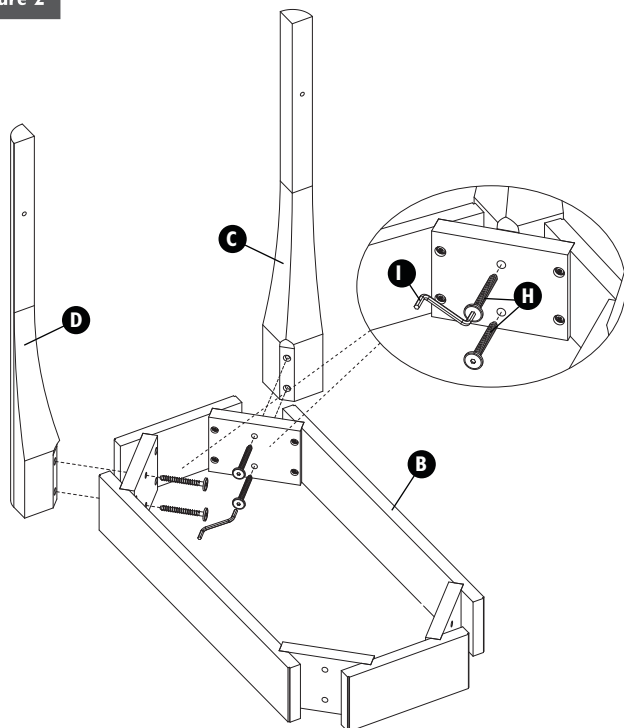

3. Attach **legs (C and D)** to **frame assembly (B)** with **bolts (H)** using **allen wrench (I)**. (see figure 2).

Figure 3

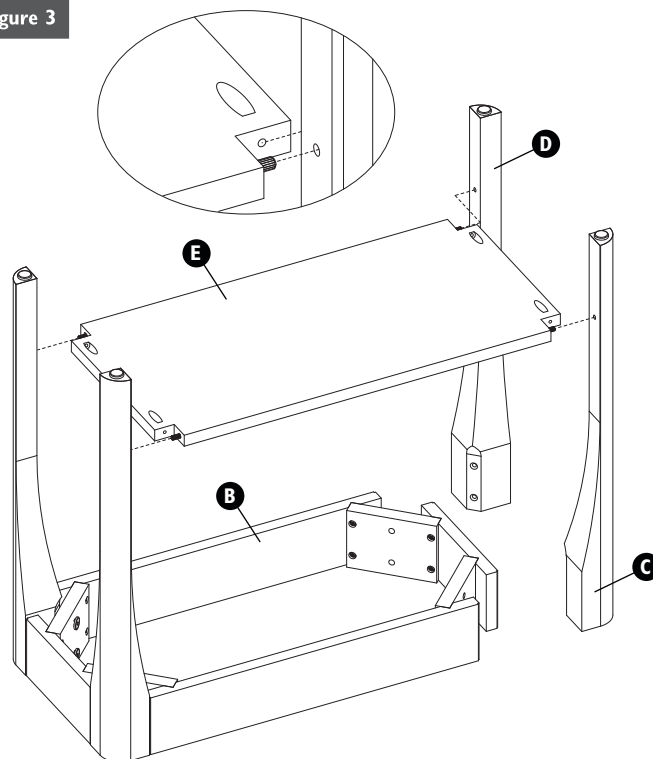

4. Attach **shelf (E)** to **legs (C and D)** and other **legs (C and D)** to **frame assembly (B)** and **shelf (E)** (see figure 3).

Figure 4

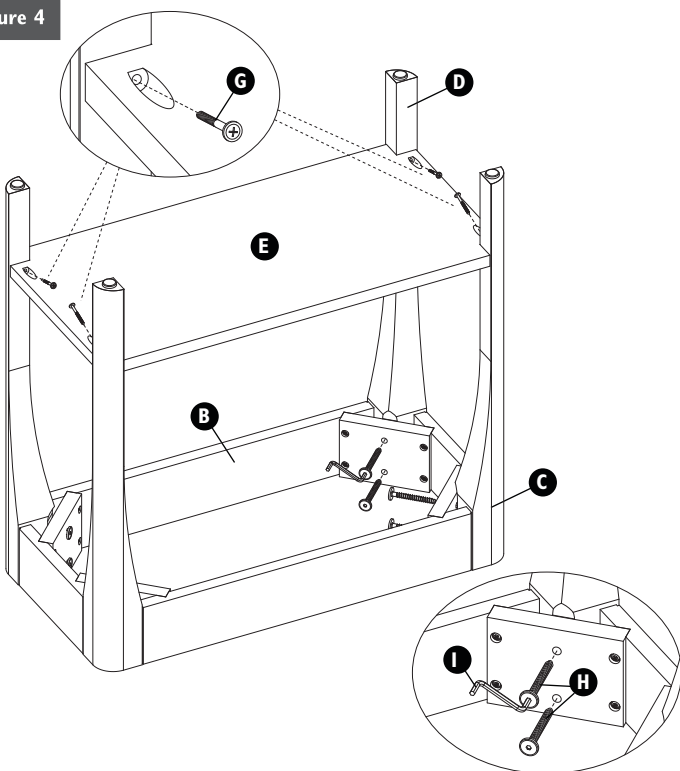

5. Fix **legs (C and D)** to **frame assembly (B)** with **bolts (H)** using **allen wrench (I)**.  
Fix **shelf (E)** to **legs (B and C)** with **screws (G)** using **phillips screwdriver**, (see figure 4).

Figure 5

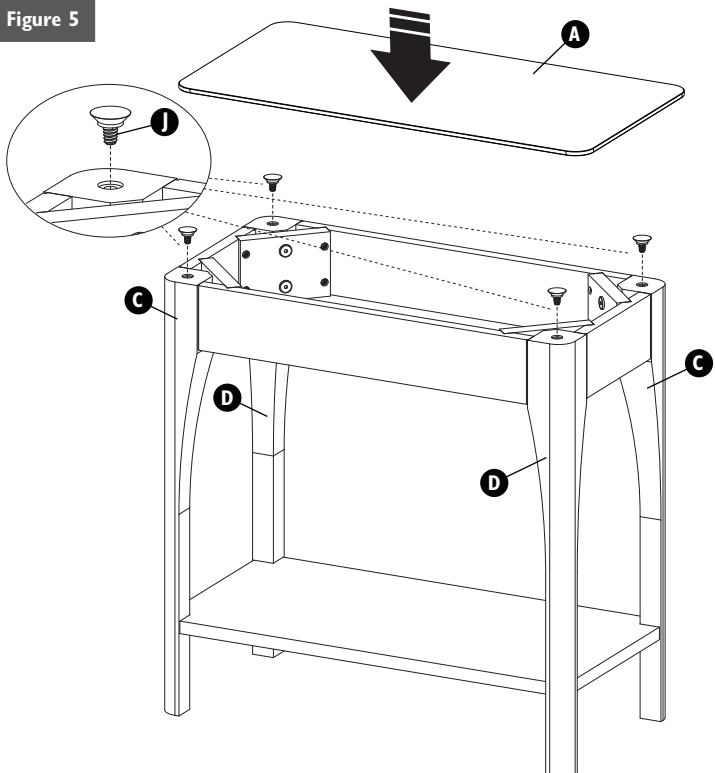

6. Insert **suction cup (J)** into holes to **legs (C and D)**.  
7. Attach the **glass top (A)** on **suction cups**. (see figure 5).