



EASY-TO-INSTALL RAISED BED
GARDEN WATERING KIT

MODEL ETIGRDNKT

Installation Instructions

Thank you for purchasing the Rain Bird Raised Bed Garden Watering Kit. This kit is partially preassembled to reduce installation time to a few easy steps. It includes everything you need to water a garden up to 4' x 8'.

To start your installation, determine which side of the garden your hose will be connected, then proceed to steps on pages 2 and 3 for your garden size.

TIP: For easiest installation, cut the tape holding the 1/4" coils and place in the sun for one hour to help unroll them for installation.

NOTE: If you have multiple gardens, please purchase additional watering kits.

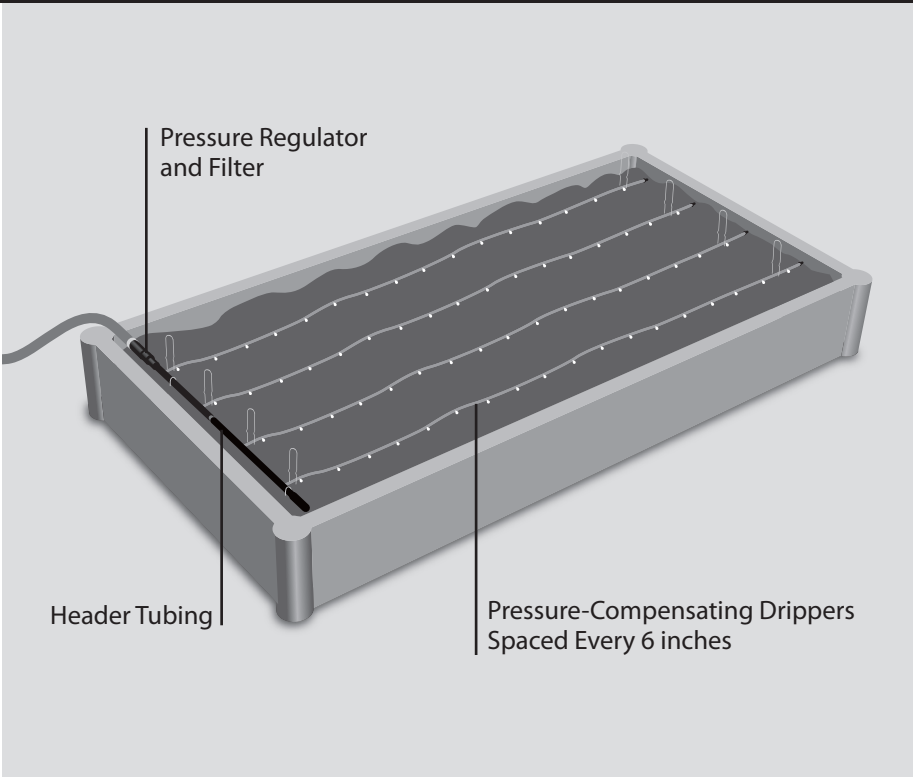

CONTENTS

A 	(1) 18" Header With Black End Plug and (2) 1/4" Drip Tubing Strips, each with pressure compensating drippers spaced every 6"
B 	(1) 18" Header With Brown Barbed Coupling and (2) 1/4" Drip Tubing Strips, each with pressure compensating drippers spaced every 6"
C 	(1) Threaded Tubing Connector
D 	(1) Pressure Regulator with Filter and Washer
E 	(10) Galvanized Stakes
F 	(10) 1/4" End Plugs

INSTALLATION FOR COMMON GARDEN SIZES

4' x 8' RAISED BED

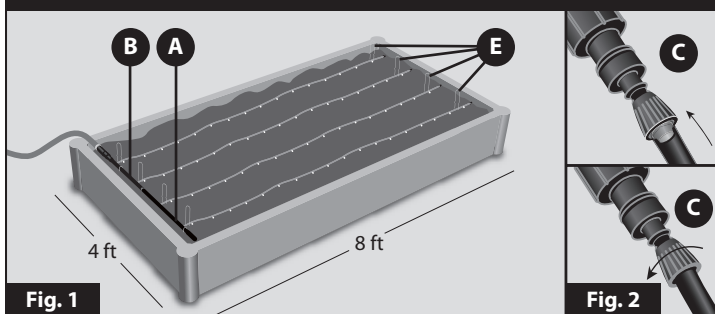

FULL HEADER ASSEMBLY FOR 4' WIDE BEDS (Use Both Header Tubing Sections)

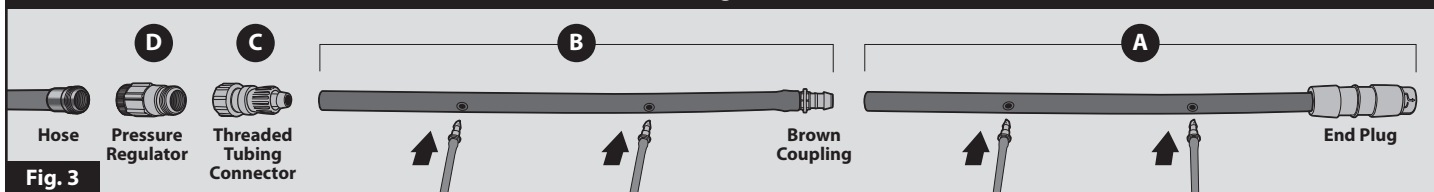

1. Attach both header tubes together by fully inserting the open end (A) with black end plug onto the brown barbed coupling (B). See figure 3. If having difficulty with this connection, soften the end of the header tubing by placing it in hot water for a few seconds. Attach the 1/4" drip tubing strips to the 18" headers by inserting the black barbed coupling into the pre-drilled holes. (Press firmly)
2. Attach threaded tubing connector (C) to open end of header tubing. Twist firmly to insert. Then tighten collar (hand tight). See figure 2.
3. Attach pressure regulator (D) to garden hose. See figure 3.
4. Attach other end of pressure regulator to threaded tubing connector.
5. Lay header in place and stake down. See figure 1.
6. Stake one drip tubing strip down by the header, and lay it out along a garden row, staking it down again at the end of the row. See figure 1.
7. Repeat step 6 for the other strips of drip tubing.
8. Turn on water and run your watering system.

4' x 4' RAISED BED

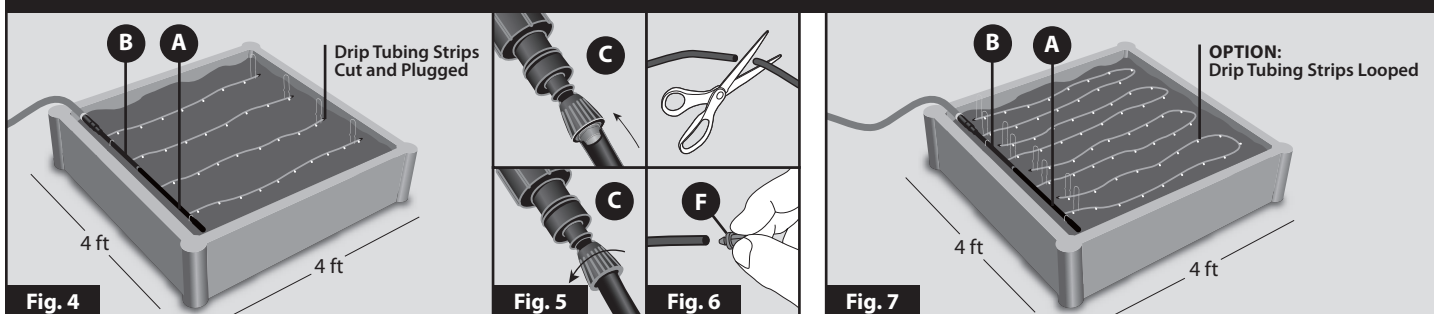

FULL HEADER ASSEMBLY FOR 4' WIDE BEDS (Use Both Header Tubing Sections)

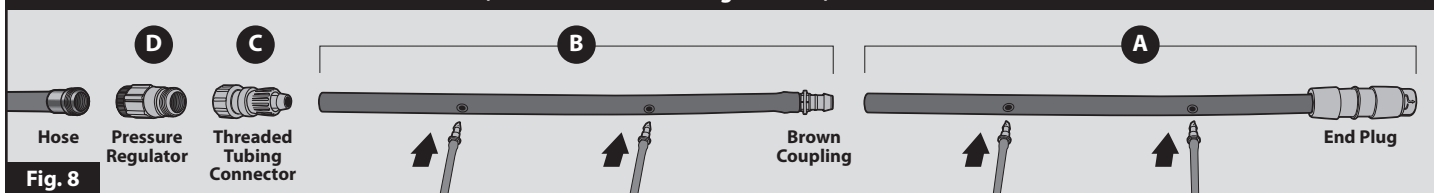

1. Attach both header tubes together by fully inserting the open end (A) with black end plug onto the brown barbed coupling (B). See figure 8. If having difficulty with this connection, soften the end of the header tubing by placing it in hot water for a few seconds. Attach the 1/4" drip tubing strips to the 18" headers by inserting the black barbed coupling into the pre-drilled holes. (Press firmly)
2. Attach threaded tubing connector (C) to open end of header tubing. Twist firmly to insert. Then tighten collar (hand tight). See figure 5.
3. Attach pressure regulator (D) to garden hose. See figure 8.
4. Attach other end of pressure regulator to threaded tubing connector.
5. Lay header in place and stake down. See figure 4.
6. Stake one drip tubing strip down by the header, and lay it out along a garden row. Stake it down again at the end. See figure 4.
7. Repeat step 6 for other strips of drip tubing.
8. To shorten the drip tubing strips to fit your garden length as shown in figure 4, cut the tubing in between two drippers with scissors. Then use the extra Plugs (F) to seal the ends as shown in figure 6. Caution: Cut at least 2" away from drippers.
OPTION: If you wish to deliver more water to each plant, loop the tubing back around as shown in figure 7.
9. Turn on water and run your watering system.

3' x 6', 2' x 6' AND OTHER RAISED BEDS 2' TO 3' WIDE

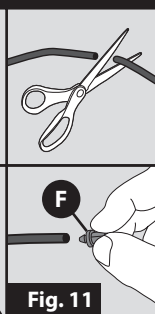
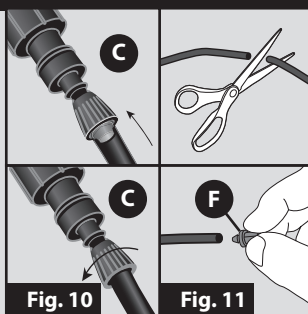
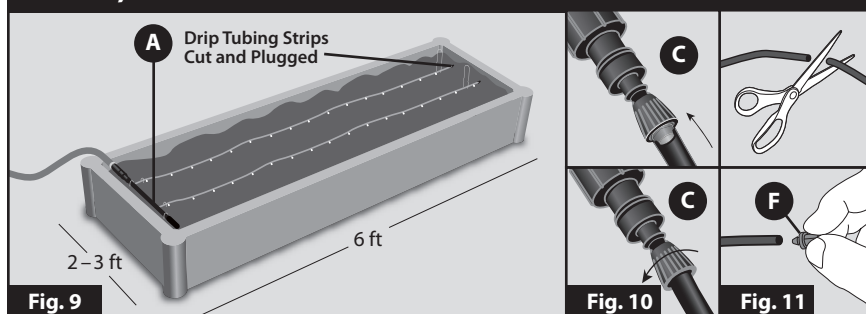

SINGLE HEADER ASSEMBLY FOR 2' - 3' WIDE BEDS (For 2 strips of drip tubing)

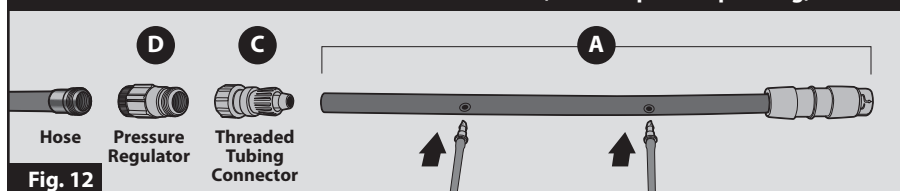

To use both headers in a narrow bed, see trimming option below.

1. Attach threaded tubing connector (C) to open end of header tubing (A) with black end plug. Twist firmly to insert. Then tighten collar (hand tight). See figure 10. Attach the 1/4" drip tubing strips to the 18" headers by inserting the black barbed coupling into the pre-drilled holes. (Press firmly)
2. Attach pressure regulator to garden hose. See figure 12.
3. Attach other end of pressure regulator to threaded tubing connector.
4. Lay header in place and stake down. See figure 9.

5. Stake one drip tubing strip down by the header, and lay it out along a garden row. Stake it down again at the end. See figure 9.
6. Repeat step 5 for the other strip of drip tubing.
7. To shorten the drip tubing strips to fit your garden length as shown in figure 9, cut the tubing in between two drippers with scissors. Then use the extra Plugs (F) to seal the ends as shown in figure 11. Caution: Cut at least 2" away from drippers.
8. Turn on water and run your watering system.

OPTIONAL USE OF BOTH HEADERS IN 2'-3' WIDE BEDS (For 3 or 4 strips of drip tubing)

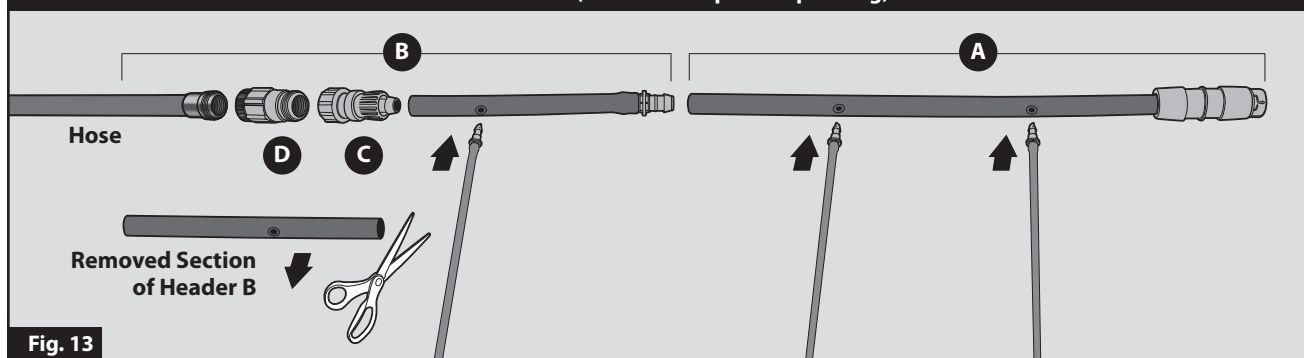

Cut header section B with scissors or utility knife. If you wish to use all 4 drip tubing strips in a narrow bed, you can also cut a little off of both header sections before assembly.

TIPS

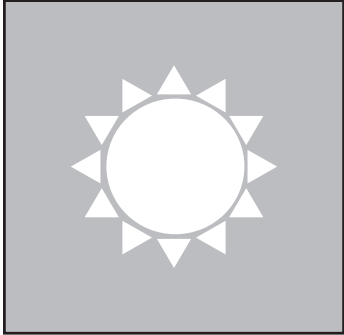

For easiest installation, cut the tape holding the 1/4" coils and place in the sun for one hour to help unroll them for installation.

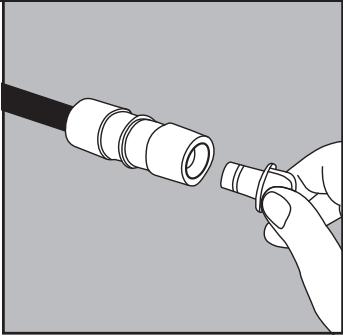

Flush tubing before first use and at beginning of each season to clear out debris.
Remove black plug on the end of header A. Reinsert after a few minutes of flushing.

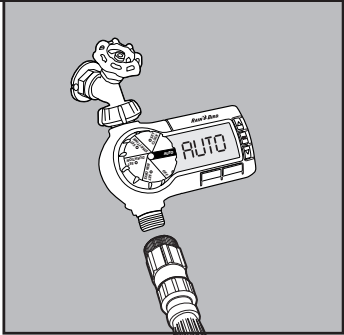

Add a Rain Bird® hose-end timer to water automatically (Model 1ZEHTMR sold separately).

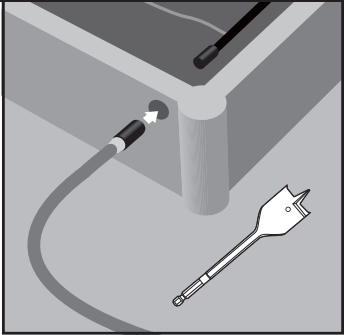

Optional: For a cleaner look and to avoid any potential kinking of the hose.
Drill a hole in the side board of your garden using a spade bit. Be sure to drill hole above dirt level. Insert the hose through that hole to enable a straighter connection to the watering header.

WATERING GUIDE

Suggested watering time per week	Cool Climate	Warm/Humid Climate	Hot/Arid Climate
Row Plants	20 minutes	40 minutes	75 minutes
Tomatoes, Squash, Other Widely Spaced Plants	30 minutes	60 minutes	90 minutes
Flower Bed	15 minutes	30 minutes	60 minutes

Note: These are starting guidelines only. Please adjust for your specific plants, climate, season and soil.

Questions?
1-800-RAINBIRD
www.rainbird.com