

KING WATER FILTRATION

AUTOMATIC CONTROL VALVE PROGRAMMING

Programming to Backwash and Regenerate using an Automatic Valve

(Refer to instructions for programming Automatic Control Valve)

A1



A2



Clock MUST be set to 12:01 PM to get into programming mode.

Step 1: Press and hold one of the up or down arrows until the clock moves. Set the time to 12:01 PM. Push the Recycle button to set.



(Recycle Button)

Step 2: Press and hold the up and down buttons at the same time to get into the Master Programming Mode. A pencil icon lets you know you are in programming mode.

The code in the upper left shows the portion of the program being changed.

The up and down buttons change the value on the right.

Step 3: Screen upper left reads DF. Set to GAL



Step 4: Push Recycle. Set VT to 5800

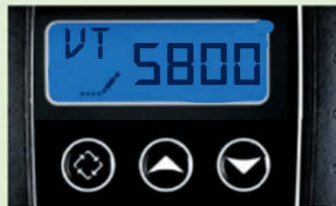

Step 5: Push Recycle. Set RF to FLtr



Step 6: Push Recycle. Set CT to tc.



Step 7: Push Recycle. Set DO to 14



Step 8: Push Recycle. Set RT to 2:00am



Step 9: Push Recycle. Set BW to 8



Step 10: Push Recycle. Set RR to 5



Step 11: Push Recycle. RF should be set to OFF



Step 12: Push Recycle. Wait for time to display...



Step 13: Press and hold up or down arrow. this gets time moving. Set TD to correct time. Push Recycle to complete the setup.

KING WATER FILTRATION ECO MUNICIPAL SERIES

TROUBLESHOOTING

PROBLEM	CORRECTION
No water flow	<ul style="list-style-type: none"> • Re-read the instructions to install the system properly. • Check the in and out arrows on the bypass valve to ensure the system is not piped backwards. • Make sure the bypass valve is in the "Service" position.
Media discharging during backwash	<ul style="list-style-type: none"> • Make sure top distributor has been installed properly.
System does not backwash	<ul style="list-style-type: none"> • Control valve not programmed properly. Check programming and re-program as needed.
Poor performance (filtration)	<ul style="list-style-type: none"> • Check the frequency and period of backwashing.
Leak in distributor tube	<ul style="list-style-type: none"> • Put the system in bypass position and depressurize* the unit by putting into "Backwash" position.

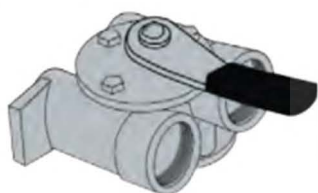

After prolonged periods of non-use (such as during a vacation), it is recommended that the system be flushed thoroughly.

1. First put the system in bypass by turning the bypass valve to the "BYPASS" position.
2. Let water run for 10 to 20 minutes by opening all faucets to flush all water supply lines.

3. Turn handle on bypass valve to "SERVICE" position to backwash* the system.

* To backwash or depressurize the system, refer to "Automatic Control Valve Programming" in this manual.

FILTRATION™