



OPERATOR'S MANUAL

MODEL: NV17FTG

17 in. FRONT TINE TILLER



REGISTER YOUR PRODUCT

<https://www.novuspowerequipment.com/product-registration>

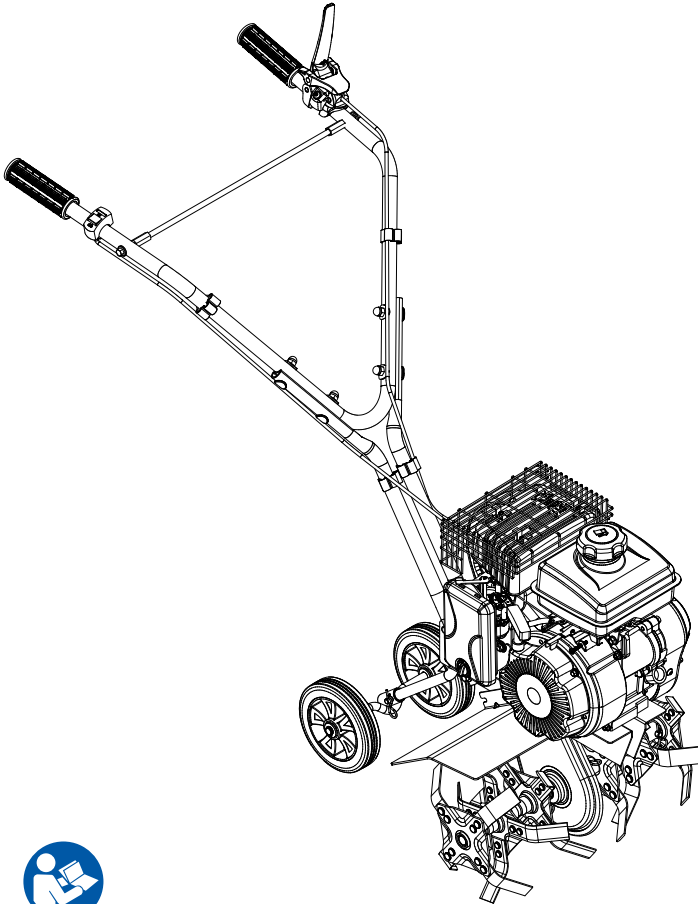

Have product questions or need technical support?

Contact Us:

🌐 Website: www.novuspowerequipment.com

☎ Toll free: 1-800-409-7802 Mon-Fri 8-4 CST

✉ Email: support@novuspowerequipment.com



EN

Vol. 2025-01

CONTENTS

Specifications 3

Introduction / Register Your Product / Safety Definitions 4

Important Safety instructions 5

Know your product 10

Assembly 11

Operation 13

Maintenance 16

Transportation and Storage 20

Troubleshooting 21

Basic Service Parts List 22

Warranty Statement 23

SPECIFICATIONS

Tiller Specifications

Model	NV17FTG
Tine Diameter (in.)	9
Tilling Width (in.)	17
Tilling Depth (in.)	5
Wheel Diameter (in.)	6
Length (in.)	44
Width (in.)	17
Height (in.)	41
Weight (lbs.)	86

Engine Specifications

Engine Model	W80F
Displacement	79cc
Type	4-Stroke, Air Cooled, Overhead Valve (OHV)
Fuel Capacity	0.37 Gallon
Fuel Type	Fresh, clean regular unleaded gasoline with a minimum octane rating of 87 and an ethanol content of no more than 10% by volume.
Oil Capacity	12 fl.oz (360 ml)
Oil Type	SAE 10W-30

INTRODUCTION

Congratulations on your purchase of a Novus branded product. This model is the result of Novus's vast experiences in the production of high-quality, cost-effective equipment.

It represents the high degree of reliability and innovation that Novus has dedicated itself to.

This manual will give you an understanding of the assembly, operation and basic maintenance of this unit. If you have any questions concerning the operation or maintenance, please contact us at support@novuspowerequipment.com or 800-409-7802.

We want you to continue to use and be satisfied with your Novus® product for years to come, therefore please fully familiarize yourself, and others who plan on operating the product, with the proper safety and operation procedures before each use.

Novus® continually seeks advancements in product design and quality. Therefore, while this manual contains the most current product information available at the time of printing, there may be minor discrepancies between your product and this manual.

When contacting Novus® about parts and/or service, you will need to supply the complete model and serial numbers of your product.

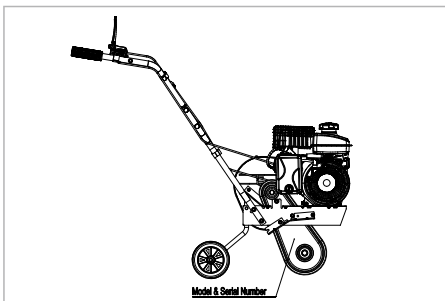

MODEL

SERIAL NUMBER

DATE OF PURCHASE

REGISTER YOUR PRODUCT

To ensure you receive important service information in the event of a product update or recall, please register your product. Your information will remain confidential. It will not be released to any other company or organization. Failure to register your product does not diminish your warranty rights.

SCAN QR CODE TO REGISTER



SAFETY DEFINITIONS

The purpose of safety symbols is to attract your attention to possible dangers. The safety symbols, and their explanations, deserve your careful attention and understanding. The safety warnings do not by themselves eliminate any danger. The instructions or warnings they give are not substitutes for proper accident prevention measures.

⚠ DANGER

DANGER indicates a hazardous situation which, if not avoided, will result in death or serious injury.

⚠ WARNING

WARNING indicates a hazardous situation which, if not avoided, could result in death or serious injury.

⚠ CAUTION

CAUTION indicates a hazardous situation which, if not avoided, could result in minor or moderate injury.

IMPORTANT SAFETY INSTRUCTIONS

⚠ DANGER

Engine exhaust contains carbon monoxide, a colorless, odorless, poisonous gas. Breathing carbon monoxide will cause nausea, dizziness, fainting or death. If you start to feel dizzy or weak, get fresh air immediately.

ALWAYS OPERATE EQUIPMENT OUTDOORS ONLY, IN A WELL VENTILATED AREA.

NEVER operate the Outdoor Power Equipment inside any building, including garages, basements, sheds or other confined spaces.

DO NOT allow exhaust fumes to enter a confined area through windows, doors, vents or other openings while operating the tiller.

⚠ DANGER

Using an engine indoors **CAN KILL YOU IN MINUTES**. Engine exhaust contains carbon monoxide. This is a poison you cannot see or smell.



⚠ DANGER

DO NOT allow untrained individuals or children to use this unit.

⚠ DANGER

Rotating parts can entangle hands, feet, hair, clothing and/or accessories. Traumatic amputation or severe laceration can result.

Keep hands and feet away from rotating parts.

Tie up long hair and remove jewelry.

Operate equipment with guards in place.

DO NOT wear loose-fitting clothing, dangling drawstrings or items that could become caught.

⚠ WARNING

Before operating your machine, carefully read and understand all safety, controls and operating instructions in this Operator's Manual.

Failure to follow these instructions can result in serious personal injury.

⚠ WARNING

Clear the work area before each use. Remove all objects such as rocks, broken glass, nails, wire, or string which can be thrown or become entangled in the machine.

Always wear eye protection with side shields marked to comply with ANSI Z87.1. Failure to do so could result in objects being thrown into your eyes and other possible serious injuries.

Keep all bystanders, children, and pets at least 50' (15m) away when operating the unit.

Always wear sound protection (ear muffers or ear plugs) to reduce the risk of hearing loss associated with long term engine sound level(s).

Always wear heavy long pants, boots, gloves, and a long sleeve shirt. Do not wear loose clothing, jewelry, short pants, sandals, or go barefoot. Secure long hair so it is above shoulder level to prevent entanglement in rotating parts while operating this unit.

Do not operate this unit when you are tired, ill, or under the influence of alcohol, drugs, or medication.

Do not operate in poor lighting.

Always wear a face filter mask in dusty conditions to reduce the risk of injury associated with the inhalation of dust.

Keep firm footing and balance. Maintain a firm grip on the handle with both hands while using the tiller.

Do not overreach. Overreaching can result in loss of balance or exposure to hot contact surfaces or rotating parts.

Always inspect the unit before each use for loose fasteners, fuel leaks, etc. Replace damaged parts.

Use only identical manufacturer's replacement parts and accessories. Use of any other replacement parts may create a hazard or cause product damage and void your warranty.

Maintain the equipment per maintenance instructions located in this Operator's Manual.

⚠ DANGER

Rotating blades can cause severe bodily injury. Stop the engine and ensure blades have stopped rotating before installing/ changing parts or performing maintenance.

⚠ WARNING

Never operate ground engaging equipment near underground electric cables, telephone lines, pipes or hoses.

It is recommended to contact your utility provider or diggers hotline in your area before tilling the ground.

Before performing any service to the unit:

The engine switch must be in the OFF position and the engine completely stopped.

Allow the engine to cool down, remove and ground the spark plug wire.

⚠ WARNING

Running engines produce heat. Severe burns can occur on contact. Combustible material can catch fire on contact.

DO NOT touch hot surfaces.

Avoid contact with hot exhaust gases.

Allow equipment to cool before touching.

Maintain at least 3 ft. (91.4 cm) of clearance on all sides to ensure adequate cooling.

Maintain at least 5 ft. (1.5 m) of clearance from combustible materials.

⚠ WARNING

Rapid retraction of the recoil cord will pull hand and arm towards the engine faster than you can let go. Broken bones, fractures, bruises or sprains could result. Unintentional startup can result in entanglement, traumatic amputation or laceration.

When starting the engine, pull the recoil cord slowly until resistance is felt and then pull rapidly to avoid kickback.

⚠ CAUTION

Prolonged exposure to vibrations, also known as vibration white finger, through use of gasoline-powered equipment, such as this tiller, could cause blood vessel or nerve damage in fingers, hands, and joints. If symptoms occur such as numbness, or loss of feeling in the fingers, hands, or joints, discontinue the use of this tiller and seek medical attention.

Fuel Safety**⚠ DANGER****GASOLINE AND GASOLINE VAPORS ARE HIGHLY FLAMMABLE AND EXPLOSIVE.**

Fire or explosion can cause severe burns or death.

Gasoline and gasoline vapors:

Gasoline is highly flammable and explosive.

Gasoline can cause a fire or explosion if ignited.

Gasoline is a liquid fuel, but its vapors can ignite.

Gasoline is a skin irritant and needs to be cleaned up immediately if spilled on skin or clothes.

Gasoline has a distinctive odor; this will help detect potential leaks quickly.

Gasoline expands or contracts with ambient temperatures. Never fill the gasoline tank to full capacity, as gasoline needs room to expand when temperatures rise.

In the case of any petroleum gasoline fire, flames should never be extinguished unless the fuel supply valve can be turned OFF. By not doing so, if a fire is extinguished and the supply of fuel is not turned OFF, an explosion hazard could be created.

When adding or removing gasoline:

DO NOT light or smoke cigarettes while handling gasoline.

Always store or transfer gasoline in an EPA/CARB compliant fuel tank.

Never pump gasoline directly into the tiller at the gas station.

Always drain gasoline outdoors in a well-ventilated area.

Always loosen fuel cap slowly to release vapor pressure and to keep fuel from escaping around the fuel cap.

Always replace and tighten the fuel cap securely after fueling.

Always stop the engine and allow it to cool for a minimum of two minutes before refueling.

Never remove the fuel cap or add fuel while the engine is running or when the engine is hot.

DO NOT overfill the gasoline tank.

DO NOT tip the tiller and allow fuel or oil to spill.

In the event of spilled fuel, wipe the fuel from the tiller and move 10 ft. (3m) away from refueling site before starting the engine to avoid potential ignition of fuel vapors.

Save these instructions. Refer to them frequently and use them to instruct others who may use this product. If you loan this equipment, provide these instructions also.

When starting the tiller:

DO NOT attempt to start a damaged tiller.

Always check that the gasoline cap, air filter, spark plug, fuel lines and the exhaust system are properly in place.

Always be certain that the tiller is resting firmly on level ground.

When operating the tiller:

DO NOT move or tip the tiller during operation.

When transporting or servicing the tiller:

Always check that the fuel valve is in the OFF position and the gasoline tank is empty.

Disconnect the spark plug wire.

When storing the tiller:

Always store tiller and gasoline in a cool, well-ventilated area, safely away from sparks, open flames, pilot lights, heat and other sources of ignition.

 WARNING

Never use a gasoline container, gasoline tank, or any other fuel item that is broken, cut, torn or damaged.

Safety Symbols

Some of the following symbols may be used on this product. Please study them and learn their meaning. Proper interpretation of these symbols will allow you to safely operate the product.

SYMBOL	MEANING
	Read Operator's Manual. To reduce the risk of injury, user must read and understand operator's manual before using this product.
	Eye and Ear Protection. Always wear safety goggles or safety glasses with side shields, and as necessary a full face-shield as well as full ear protection when operating this product. Always wear eye protection with side shields marked to comply with ANSI Z87.1.
	Footwear. Always wear safety shoes or heavy boots when operating the machine.
	Gloves. Always wear nonslip, heavy-duty protective gloves when operating this product.
	Safety Alert. This machine was built to be operated according to the safe operation practices in this manual. As with any type of power equipment, carelessness or error on the part of the operator can result in serious injury. This machine is capable of amputating fingers, hands, toes and feet and throwing foreign objects. Failure to observe the safety instructions could result in serious injury or death.
	Risk of Fire. Fuel and its vapors are extremely flammable and explosive. Fire can cause severe burns or death. Do not add fuel while the product is operating or still hot.
	Hot Surface. To reduce the risk of injury or damage, avoid contact with any hot surface.
	Open Flame Alert. Fuel and its vapors are extremely flammable and explosive. Keep fuel away from smoking, open flames, sparks, pilot lights, heat, and other ignition sources.
	Toxic Fumes. The engine exhaust from this product contains chemicals known to cause cancer, birth defects and other reproductive harm. Risk of Asphyxiation. This engine emits carbon monoxide, an odorless, colorless poison gas. Breathing carbon monoxide can cause nausea, fainting or death. Use only in a well-ventilated area.
	Clearance. Keep all objects including others at least 10 feet (3m) from this machine. Only one person should operate the tiller and load the logs.
	Rotating Tines. Avoid injury from rotating tines. Keep hands away.
	Rotating Tines. Avoid injury from rotating tines. Keep feet away.
	Thrown Objects. This machine may pick up and throw objects which can cause serious personal injury.

KNOW YOUR PRODUCT

Read this operator’s manual before operating your tiller. Familiarize yourself with the location and function of the controls and features.

Save this manual for future reference.

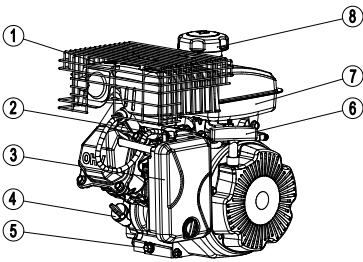

Engine

1	Muffler Guard
2	Choke Lever
3	Air Filter
4	Oil Fill Cap/Dipstick - Used to check and fill oil level
5	Oil Drain Bolt - Used to drain the oil
6	Recoil Starter Handle - Used to manually start the engine
7	Fuel Tank
8	Fuel Tank Cap

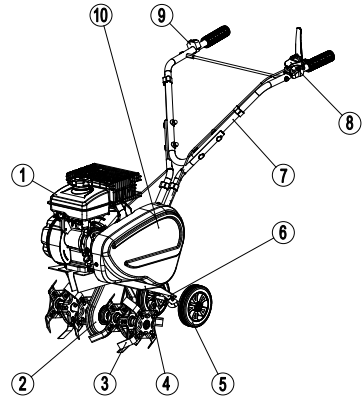

Tiller

1	Engine
2	Tine Gearbox
3	Tines
4	Tine Shield
5	Transport Wheels
6	Drag Stake
7	Upper Handle
8	Clutch Lever
9	ON / OFF Switch
10	Belt Cover

ASSEMBLY

Your tiller requires some assembly. This unit ships from our factory without oil. It must be properly serviced with fuel and oil before operation.

If you have any questions regarding the assembly of your tiller, call our Technical Support Team at 1-800-409-7802. Please have your serial number and model number available.

UNPACKING

1. Remove any banding and open carton from top.
2. Remove all loose packed items and packaging inserts.
3. With assistance, remove the tiller from the carton or carefully cut all 4 corners of carton to fully open.
4. Remove all additional loose items from packaging materials. Do not discard packaging until you have confirmed all components are present.

PARTS INCLUDED

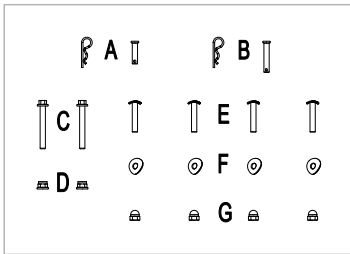

A	1 x Clevis & Cotter Pin (Installed in Transport Wheels Assy)
B	1 x Clevis & Cotter Pin (Installed in Drag Stake)
C	2 x M8 Hex Bolt (10mm wrench)
D	2 x M8 Lock Nut (13mm wrench)
E	4 x M8 Upper Handle Bolts - (Curved head)
F	4 x Wave Washers
G	4 x M8 Cap Nuts

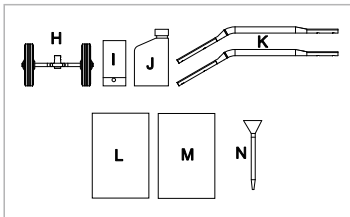

H	Transport Wheels Assembly (Clevis Pin Installed)
I	Tool Kit 2 x 10mm / 13mm wrench
J	Oil Bottle & Funnel (12oz 10W-30)
K	2 x Lower Handle Tube
L	Operator's Manual
M	Quick Start Guide

Tools Kit Content: Tools Required

- Allen Wrench - 4mm
- 13 mm / 10 mm Wrench
- 14 mm / 12 mm Wrench

Install the Wheels

Remove the clevis pin (item B) attaching the drag stake to the tiller frame, rotate drag stake 180 degrees and reattach (as shown) using the clevis and cotter pin. Install the transportation wheels assembly to the lower end of the drag stake using the supplied clevis and cotter pin (item A).

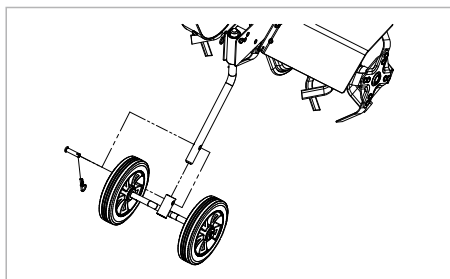
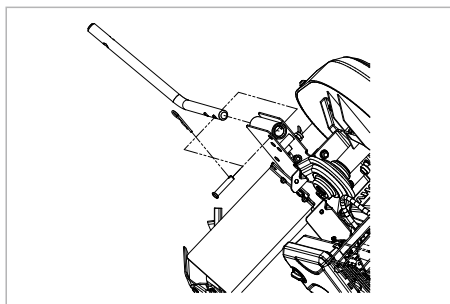

Attach Lower Handles

Attach left and right lower handle tubes (item K, qty 2) to the tiller frame with the M8 hex bolt (Item C) and M8 lock hex nut (item D).

DO NOT TIGHTEN THE NUTS AT THIS TIME.

NOTE

The lower handle tube with the wire retention clip should be installed on the right-hand side from the operator's position.

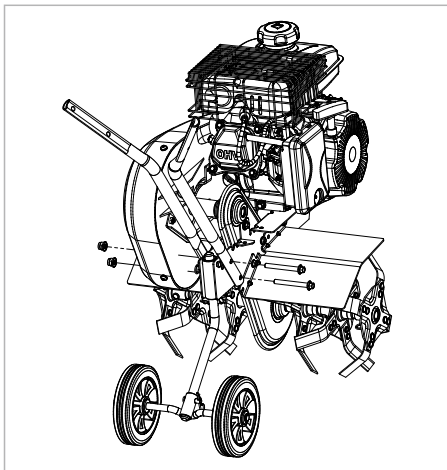

Attach Upper Handle

Attach upper handle to the lower handles using M8 upper handle bolts, wave washers, and M8 cap nuts, qty of 4 each. (Items E, F, G). Tighten all nuts and bolts for the lower and upper handle at this time.

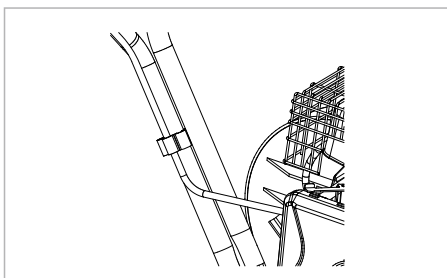
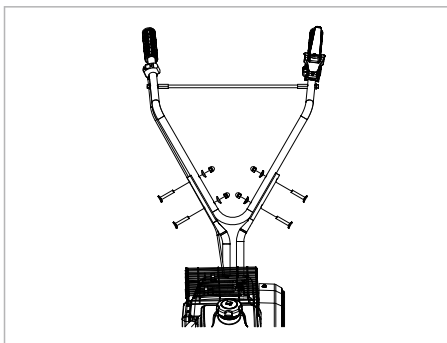

OPERATION

WARNING

Before operating your machine, carefully read and understand all safety, controls and operating instructions in this Operator's Manual.

Failure to follow these instructions can result in serious personal injury.

Introduction

Read this section before you start the engine. Then, take the time to familiarize yourself with the basic operation of the tiller before using it in the garden. Find an open, level area and practice using the tiller controls without the tines engaging the soil. Only after you've become completely familiar with the tiller should you begin using it in the soil.

Add Fuel

The engine was designed to operate on unleaded gasoline with an octane rating of 87 or higher and a maximum ethanol content of 10% by volume.

The use of fuels with a content of ethanol greater than 10% can cause starting and/or performance problems, damage to metal, rubber and plastic parts of the fuel system. Engine performance problems or damage caused by using fuel with a higher ethanol content will not be considered for warranty.

DANGER

Gasoline and gasoline vapors are highly flammable and extremely explosive.

Always keep fuel away from sparks, open flames, pilot lights, heat and other sources of ignition.

Always Stop the engine and allow it to cool before refueling.

Only fill or drain fuel outdoors in a well-ventilated area.

DO NOT pump gasoline directly into the

engine. Use an approved container to transfer the fuel to the engine.

Never use a gasoline container, gasoline tank, or any other fuel item that is broken, cut, torn or damaged.

DO NOT overfill the gasoline tank Wipe up spills immediately.

Use clean, fresh, regular unleaded gasoline with a minimum octane rating of 87 and an ethanol content of 10% or less by volume. **DO NOT** mix oil with gasoline.

WARNING

Pouring gasoline too fast through the fuel screen may result in blow back of gasoline at the operator while filling.

1. Remove the fuel tank cap.
2. Slowly add gasoline to the tank. DO NOT OVERFILL.

Gasoline can expand after filling. A minimum of ¼ in. (6.4 mm) of space left in the tank is required for gasoline expansion although more than ¼ in. (6.4 mm) is recommended. Gasoline can be forced out of the tank as a result of expansion if overfilled and can affect the stable running condition of the tiller.

3. Replace and tighten the fuel tank cap.
4. Immediately wipe up any spills.

NOTE

The engine works well with 10% or less ethanol blended gasoline. When using ethanol-gasoline blends there are some issues worth noting:

Ethanol-gasoline blends can absorb more water than gasoline alone.

These ethanol blends can eventually separate, leaving water or a watery good in the tank, fuel valve and carburetor. The compromised gasoline can be drawn into the carburetor and cause damage to the engine and/or create potential hazards.

If a fuel stabilizer is used, confirm that it is formulated to work with ethanol-gasoline blends.

Any damages or hazards caused by using ethanol blended gasoline higher than 10% by volume, improperly stored gasoline, and/or improperly formulated stabilizers, are not covered by manufacturer's warranty.

It is advisable to always shut off the gasoline supply and run the engine to starvation after each use. See Storage instructions for extended non-use.

Add Engine Oil**CAUTION**

This unit ships from our factory without oil.

It must be properly serviced with fuel and oil before operation. DO NOT attempt to crank or start the engine before it has been properly filled with the recommended type and amount of oil.

Damage to the engine as a result of failing to follow these instructions will void your warranty.

NOTE

The recommended oil type is 10W-30 automotive oil.

1. Place the tiller on a flat, level surface.
2. Remove oil fill cap/dipstick to add engine oil.
3. Using a funnel, add up to 12 fl. oz. (360 ml) of oil and replace oil fill cap/dipstick. DO NOT OVERFILL.
4. Check the engine oil level and add as needed.

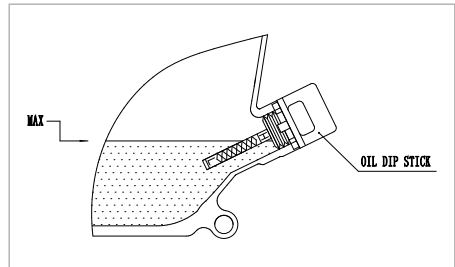
**NOTE**

Once oil has been added, a visual check should show oil about 1-2 threads from running out of the fill hole.

When using the dipstick to check oil level, DO NOT screw in the dipstick while checking.

Starting the Engine

To help prevent serious personal injury or damage to equipment.

WARNING

Do not attempt to engage the tines or wheels until you have read all the operating instructions.

Keep away from rotating tines. Rotating tines will cause injury.

1. Check the oil level and add oil if necessary
2. Make certain the tiller is on a flat, level surface.
3. Release all the controls on the tiller.
4. Turn engine ON / OFF switch to the "ON" position (located on right side upper handlebar).
5. Rotate the throttle lever clockwise until it stops in the high-speed position.
6. Slide the Choke lever on engine fully to the left (Full Choke position).
7. Slide Fuel Valve fully to the right (Open position).
8. Pull the starter handle slowly until resistance felt, then pull rapidly.
9. Once the engine starts, slide the choke lever to the off position.
10. Control engine speed with the throttle control located on the upper handle.
11. To engage forward rotation of tines, operate the left-hand tine engagement lever. Note the red safety lever must be lifted before the tines may be engaged. To stop tine rotation, release the left-hand lever.

Stopping the Engine and the Tiller

To shut the engine off, move the engine throttle lever counterclockwise to the idle position and press the "OFF" button on the right-hand control.

Under normal operation:

1. To stop the tines, release all control levers.
2. Let the engine run until fuel starvation has stopped the engine. This usually takes a few minutes.

CAUTION

Transport or store the tiller when the engine is cool to avoid getting burns or starting a fire.

MAINTENANCE

Proper maintenance of your unit is important for maximum performance and a long service life.

To help you properly care for your unit, the following section includes a maintenance schedule and simple maintenance procedures. We suggest working with an Authorized Dealer, professional or qualified mechanic for any service which you are unfamiliar with, not mechanically proficient with or possessing the proper tools.

The maintenance schedule provided applies to normal operating conditions. If your unit is operated under more severe conditions such as high-temperatures, sustained high-load or operation in dusty or unusually wet conditions, please inspect and service your unit more frequently.

⚠ DANGER

DO NOT use gasoline or low flash point solvents to clean the engine or any of its components. The possibility exists of fire or explosion which can damage the equipment and cause severe bodily harm or even DEATH.

⚠ WARNING

Some maintenance operations may require a running engine. ALWAYS make sure the maintenance area is well ventilated. Gasoline engine exhaust contains poisonous carbon monoxide gas that can result in unconsciousness and/or DEATH when inhaled.

⚠ CAUTION

ALWAYS allow the engine to cool before servicing. NEVER attempt to service a hot engine.

⚠ CAUTION

ALWAYS disconnect the spark plug wire from the spark plug and secure it away from the engine before performing maintenance or adjustments.

Failure to follow these instructions can result in serious personal injury or property damage.

NOTE: Maintenance, replacement, or repair of emission control devices and systems may be performed by any non-road engine repair establishment or individual.

RECOMMENDED MAINTENANCE SCHEDULE

Recommended Maintenance Schedule		Each Use	Every Month or 20 Hours	Every 3 Months or 50 Hours	Every 6 Months or 100 Hours	Before Storage
Engine Oil	Check Level	X				
	Replace		X			
Air Filter	Check			X		
	Clean			X		
Fuel	Check Level	X				
	Drain					X
Carburetor	Drain					X
Throttle Cable	Check	X				
Belt Tension	Check / Adjustment		X		X	

Check for Oil Leaks

Before each use, check the tiller for signs of an oil leak — usually a dirty, oily accumulation either on the unit or on the floor.

If a cover is leaking, check for loose screws. If the screws are tight, a new gasket or oil seal may be required.

Check Hardware

Check for loose or missing hardware after every 10 operating hours and tighten or replace (as needed) before reusing the tiller.

Be sure to check the screws underneath the tiller hood that secure the transmission cover and the Depth Drag stake to the transmission.

Tines

The tines will wear with use and should be inspected at the beginning of each tilling season and after every 30 operating hours. The tines can be replaced either individually or as a complete set. Refer to the parts list for tine identification and part numbers.

A. Tine Inspection:

With use, the tines will become shorter, narrower and pointed. Badly worn tines will result in a loss of tilling depth, and reduced effectiveness when chopping up and turning under organic matter.

B. Removing/Installing a Single Tine:

1. With the engine shut off and the spark plug wire disconnected, remove the M10×25 bolt, lock washer, flat washer and M10 nut that attach a single tine to a tine holder. If needed, use penetrating oil on the nuts.
2. When installing a single tine, be sure to position it so that its cutting edge (sharp) will enter the soil first as the tiller moves forward. Hand tightens completely.

C. Removing/Installing a Tine Assembly:

1. A tine assembly consists of eight tines mounted on a tine holder.
2. If removing both tine assemblies, mark them “left” and “right” before removal. Remove (2) pins and (2) cotter pins that secure the tine assembly to the tine shaft. If necessary, use a rubber mallet to tap the tine assembly outward off the shaft.
3. Before reinstalling the tine assembly, inspect the tine shaft for rust, rough spots or burrs. Lightly file or sand, as needed. Apply a thin coat of grease to the shaft.
4. Install each tine assembly so that the cutting (sharp) edge of the tines will enter the soil first when the tiller moves forward.

Engine Cleaning

Keeping the engine clean will help to ensure smooth operation and prevent damage from overheating. Be sure that the muffler is cool before servicing the engine.

Air Cleaner Service

The air cleaner filters dirt and dust out of the air before it enters the carburetor. Operating the engine with a dirty, clogged air filter can cause poor performance and damage to the engine. Never operate the engine without the air cleaner installed. Inspect and service the air cleaner more often if operating in very dusty or dirty conditions.

Engine Oil Service

Check the engine oil level before each use and after every five hours of continuous operation. Running an engine when its low on oil will cause severe internal damage.

It is recommended to change the engine oil after the first 20 hours of operation and even sooner when operating in extremely dirty or dusty conditions.

A. To Check the Engine Oil Level:

1. Move the unit to a flat, level surface and shut off the engine.
2. On engines with a dipstick, remove it and wipe it clean. Reinsert the dipstick and remove it. Add oil as needed to bring the level up to the FULL mark. Wipe dipstick clean each time oil level is checked. Do not overfill. Tighten dipstick securely

B. To Change the Engine Oil:

CAUTION

DO NOT attempt to crank or start the engine before it has been properly filled with the recommended type and amount of oil. Damage to the tiller as a result of failure to follow these instructions will void your warranty.

NOTE

The recommended oil type is 10W-30 automotive oil.

1. Place the tiller on a flat, level surface.
2. Tilt the engine and put a drain pan under the drain bolt.
3. Clean around the oil drain bolt to prevent dirt from entering the crankcase. Remove oil drain bolt.
4. Allow the engine oil to drain.
5. Replace oil drain bolt.
6. Refill the engine with the recommended oil through the dipstick port with funnel.

NOTE

Once oil has been added, a visual check should show oil about 1-2 threads from running out of the fill hole.

If using the dipstick to check oil level, DO NOT screw in the dipstick while checking.

Weather will affect engine oil and engine performance. Change the type of engine oil used based on weather conditions to suit the engine needs.

Air Cleaner Maintenance

A dirty air cleaner can restrict air flowing into the carburetor. To keep the carburetor in good working conditions, please service the air cleaner periodically. If operating the engine in an extremely dusty area, service should be done more often.

⚠ WARNING

Never clean the air cleaner element with gasoline or low flashpoint detergents, an explosion may happen.

💬 NOTE

Never run the engine without an air cleaner. Dirty air entering the engine can speed up engine wear.

1. Remove the wing nut and the air cleaner cover. Remove the elements and separate them. Carefully check both elements for holes or tears and replace them if damaged.
2. Foam element: Wash the element in a solution of household detergent and warm water, then rinse thoroughly. Allow the element to dry thoroughly.
3. Paper element: Tap the element lightly several times on a hard surface to remove excess dirt or blow compressed air at a low pressure through the filter from the inside out. Never try to brush the dirt off; brushing will force dirt into the fibers. Replace the paper element if it is excessively dirty.

Spark Plug Service

Spark plug type: F7TC/F7RTC

For normal engine operation, ensure the spark plug gap is correct and check for carbon deposits around it.

1. Remove the spark plug cap.
2. Clear away dirt around the spark plug base.
3. Use a spark plug wrench to remove the spark plug.
4. Visually check the spark plug. Clean with a steel brush. If the insulator is damaged, replace the spark plug.
5. Measure the plug gap with a suitable gauge. Correct the gap as needed by carefully bending the electrode. Plug Gap: 0.030 (0.7 - 0.8mm)
6. Thread the spark plug in by hand to prevent cross-threading, then tighten with a spark plug wrench. Reinstalling a used plug - tighten $\frac{1}{8}$ - $\frac{1}{4}$ turn after the spark plug seats to seal the washer. Installing new plug - Tighten $\frac{1}{2}$ turn after the spark plug seats to compress the washer.

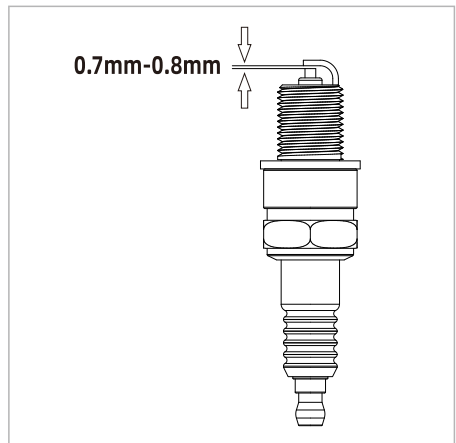
**💬 NOTE**

The spark plug must be tightened securely, or it may become very hot and damage the engine.

TRANSPORTATION AND STORAGE

⚠ CAUTION

When the tiller won't be used for an extended period, prepare it for storage as follows:

1. Select a well-ventilated dry storage area away from a source to open flames or spark producing products.
2. Clean the tiller and engine.
3. Check for loose parts and hardware.
4. Drain and change engine oil.
5. Remove the spark plug. Place about a tablespoon (5cc) of fresh engine oil into the cylinder. Pull the starter handle several times to distribute engine oil evenly.
6. Reinstall the spark plug.

⚠ WARNING

Fuel is extremely flammable and explosive under certain conditions. Keep smoking, fire and spark away from the operating site.

TROUBLESHOOTING

Problem	Cause	Solution
Engine does not start	Spark plug wire disconnected.	Reconnect wire.
	Engine Throttle Control Lever incorrectly set.	Move the throttle lever to the Fast position.
	Fuel tank is empty.	Refuel.
	Choke control in incorrect position.	Move lever to CHOKE position.
	Stale gasoline.	Drain the fuel tank and carburetor. Refuel with fresh gasoline.
	Dirty air filter.	Clean or replace filter.
	Switch is in "OFF" position.	Turn switch to "ON" position.
	Defective or incorrectly gapped spark plug.	Gap or replace spark plug.
Engine runs poorly	No spark.	Check engine switch is in ON position, Check oil level, Check / replace spark plug.
	Defective or incorrectly gapped spark plug.	Inspect spark plug gap or replace spark plug.
	Dirty air filter(s).	Clean or replace the air filter.
Engine overheats	Stale gasoline.	Drain the fuel tank and carburetor. Refuel with fresh gasoline.
	Engine cooling system clogged.	Clean cylinder cooling fins, recoil starter vents and behind engine shrouds.
Poor tilling performance	Oil level is low.	Add engine oil.
	Worn tines.	Replace worn or damaged tines.
	Incorrect throttle setting.	Adjust throttle on engine or speed control on handelbar to highest setting.
	Drive Belt slipping.	Adjust pulley tension or replace belt.
The engine starts, then shuts down after a short period	The soil is too wet.	Wait a day or two after the rain for the soil to dry out.
	Air vent in the fuel tank cap is clogged.	Replace the fuel tank cap.
	Fuel valve is not fully open or is clogged.	Open fuel valve and / or have carburetor cleaned.
	Low oil level.	Add engine oil.
	Float in carburetor is damaged or sticking.	Have the carburetor cleaned or rebuilt.
	Fuel is contaminated or deteriorated.	Drain & replace the fuel in the fuel tank and carburetor bowl.
	There is water in the fuel.	Drain & replace the fuel in the fuel tank and carburetor bowl.
Abnormal cylinder compression	Carbon deposit and buildup on spark plug electrode.	Clean and re-gap or replace spark plug.
	Valves are out of adjustment.	Have the valve lash set to proper values.
	Spark plug is not properly tightened, or gasket is missing.	Tighten with a gasket in.

If engine still doesn't start, contact our Technical Support Team at 1-800-409-7802 Mon-Fri 8-4 CST or Email: support@novuspowerequipment.com.

BASIC SERVICE PARTS LIST

Common Service Parts

Service Part	Part Number	Service Part	Part Number
Carburetor Assembly	1807900069-0001	Chain 06B-1-84	2100200013-0001
Starter Assembly	2000100042-0016	Walking Wheel	2803100002-0001
Spark Plug	2204700004-0001	Pin 8×32	361020072
Air Filter Foam Element	1903700041-0001	Pin 8×43	361020029
Carburetor Gasket	1900200004-0001	Jump Ring B	3402200004-0001
Exhaust pipe Gasket	1907100003-0001	Belt 13×945LW	2123600027-0001
Air Filter Gasket	1901000023-0001	Belt Cover Baseplate	2601500011-0013
Cylinder Head Gasket	1202000007-0001	Main Tines Comp	2702500005-0002
		Vice Tines Comp 1	2702600005-0002
		Vice Tines Comp 2	2702700005-0002

WARRANTY STATEMENT

2-Year Limited Warranty

Terms and Conditions

Novus products are warranted for two (2) years against defects in materials or workmanship when put to ordinary and normal consumer use; ninety (90) days for any other use.

For the purposes of all the above warranties, “ordinary and normal consumer use” refers to non-commercial residential use and does not include misuse, accidents or damage due to inadequate maintenance. Novus Performance Products LLC certifies that Novus Products are fit for ordinary purposes for which a product of this type is used. Novus Performance Products LLC, however, limits the implied warranties of merchantability and fitness in duration to a period of two (2) years in consumer use, ninety (90) days for any other use.

The 2-Year Limited Warranty on Novus Products starts on the purchase date. The 2-Year Limited Warranty is applicable only to the original owner.

The warranty holder is responsible for the performance of the required maintenance as defined by the manufacturer's owner's manuals. The warranty holder is responsible for replacement of normally wearing parts such as the Belt, Shear Pins, Spark Plug and Air Filter. Accessories to the machine are not covered by this warranty.

During the warranty period, the warranty holder is responsible for the machine transportation charges, if required.

During the warranty period, warranty parts will be shipped by standard method at no charge to the warranty holder. Expedited shipping of warranty parts is the responsibility of the warranty holder.

SOME STATES DO NOT ALLOW LIMITATIONS ON THE LENGTH OF IMPLIED WARRANTIES, SO THE ABOVE

LIMITATIONS MAY NOT APPLY TO YOU.

Novus Performance Products LLC shall not be liable under any circumstances for any incidental or consequential damages or expenses of any kind, including, but not limited to, cost of equipment rentals, loss of profit, or cost of hiring services to perform tasks normally performed by Novus Products.

SOME STATES DO NOT ALLOW THE EXCLUSION OR LIMITATION OF INCIDENTAL OR CONSEQUENTIAL DAMAGES, SO THE ABOVE LIMITATIONS MAY NOT APPLY TO YOU.

THIS WARRANTY GIVES YOU SPECIFIC LEGAL RIGHTS, AND YOU ALSO HAVE OTHER RIGHTS, WHICH VARY FROM STATE TO STATE.

Technical Support:

Toll free: 1-800-409-7802 Mon-Fri 8-4 CST

Email: support@novuspowerequipment.com

U.S. FEDERAL EMISSION CONTROL WARRANTY STATEMENT YOUR WARRANTY RIGHTS AND OBLIGATIONS

The United States Environmental Protection Agency and Novus Performance Products LLC (Novus) are pleased to explain the emissions control system warranty on your 2024-2025 small off-road engine/equipment (SORE). In the United States, new equipment that use small off-road engines must be designed, built, and equipped to meet the State's stringent anti-smog standards. Novus must warrant the emissions control system on your small off-road engine/equipment for the periods of time listed below there has been no abuse, neglect or improper maintenance of your small off-road engine or equipment leading to the failure of the emissions control system.

Your emissions control system may include parts such as the carburetor or fuel-injection system, the ignition system, catalytic converter, fuel tanks, fuel lines (for liquid fuel and fuel vapors), fuel caps, valves, canisters, filters, clamps and other associated components. Also included may be hoses, belts, connectors, and other emission-related assemblies.

Where a warrantable condition exists, Novus will repair your small off-road engine/equipment at no cost to you including diagnosis, parts and labor.

MANUFACTURER'S WARRANTY COVERAGE:

This emissions control system on your small off-road engine/equipment is warranted for two years. If any emission-related part on your small off-road engine/equipment is defective, the part will be repaired or replaced by Novus.

OWNER'S WARRANTY RESPONSIBILITIES:

As the small off-road engine/equipment owner, you are responsible for the performance of the required maintenance listed in your owner's manual. Novus recommends that you retain all receipts covering maintenance on your small off-road engine/equipment, but Novus cannot deny warranty coverage solely for the lack of receipts or for your failure to ensure the performance of all scheduled maintenance.

As the small off-road engine/equipment owner, you should however be aware that Novus may deny you warranty coverage if your small off-road engine/equipment or a part has failed due to abuse, neglect, or improper maintenance or unapproved modifications.

You are responsible for presenting your small off-road engine/equipment to a Novus distribution center or service center as soon as the problem exists. The warranty repairs shall be completed in a reasonable amount of time, not to exceed 30 days. If you have any questions regarding your warranty rights and responsibilities, you should contact:

Novus Performance Products LLC
customer service representative
1-800-409-7802
Email: Support@novuspowerequipment.com

DEFECTS WARRANTY REQUIREMENTS

(a) Applicability. This section applies to emissions control systems on small off-road engines or equipment that use small off- road engines subject to the emission standards in this Article. The warranty period begins on the date the engine or equipment is delivered to an ultimate purchaser and extends for a period of two years.

(b) General Emissions Warranty Coverage. The engine or equipment must be warranted to the ultimate purchaser and any subsequent owner that the emissions control system when installed was:

(1) Designed, built, and equipped so as to conform with all applicable regulations; and

(2) Free from defects in materials and workmanship that causes the failure of a warranted part for a period of two years.

(c) The warranty on emissions-related parts will be interpreted as follows:

(1) Any warranted part that is not scheduled for replacement as required maintenance in the written instructions required by subsection (e) must be warranted for the warranty period defined in subsection (b)(2). If any such part fail during the period of warranty coverage, it must be repaired or replaced by Novus or it's contracted warranty provider according to subsection (4) below. Any such part repaired or replaced under the warranty must be warranted for a time not less than the remaining warranty period.

(2) Any warranted part that is scheduled only for regular inspection in the written instructions required by subsection (e) must be warranted for the warranty period defined in subsection (b)(2). A statement in such written instructions to the effect of "repair or replace as necessary" shall advise owners of the warranty coverage for emissions related parts. Replacement within the warranty period is covered by the warranty and will not reduce the period of warranty coverage. Any such part repaired or replaced under warranty must be warranted for a time not less than the remaining warranty period.

(3) Any warranted part that is scheduled for replacement as required maintenance in the written instructions required by subsection (e) must be warranted for the period of time prior to the first scheduled replacement point for that part. If the part fails prior to the first scheduled replacement, the part must be repaired or replaced by Novus according to Subsection (4) below. Any such part repaired or replaced under warranty must be warranted for a

time not less than the remainder of the period prior to the first scheduled replacement point for the part.

(4) Repair or replacement of any warranted part under the warranty provisions of this article must be performed at no charge to the owner at a warranty station.

(5) Notwithstanding the provisions of subsection (4) above, warranty services or repairs must be provided at distribution centers that are franchised to service the subject small off-road engine/equipment.

(6) The small off-road engine/equipment owner must not be charged for diagnostic labor that leads to the determination that a warranted part is in fact defective, provided that such diagnostic work is performed at a warranty station.

(7) Throughout the emissions control system's warranty period set out in subsection (b)(2), Novus or it's contracted warranty provider must maintain a supply of warranted parts sufficient to meet the expected demand for such parts and must obtain additional parts if that supply is exhausted.

(8) Manufacturer-approved replacement parts that do not increase the exhaust or emissions of the engine or emissions control system must be used in the performance of any warranty maintenance or repairs and must be provided without charge to the owner. Such use will not reduce the warranty obligations of Novus or it's contracted warranty provider.

(9) The use of add-on or modified parts may be grounds for disallowing a warranty claim made in accordance with this Article. Novus or it's contracted warranty provider will not be liable under this Article to warrant failures of warranted parts caused by the use of an add-on or modified part.

(10) Novus shall provide any documents that describe that it's warranty procedures or policies within five working days of request by the Executive Officer.

(d) A list of all emissions warranty parts must be included with each new engine or equipment subject to this Article. The emissions warranty parts list shall include all parts whose failure would increase exhaust and evaporative emissions, and contains the following parts:

EMISSIONS PARTS LIST

Exhaust Emission

(1) Fuel Metering System

(A) Carburetor and internal parts (and/or pressure regulator or fuel injection system).

- (B) Air/fuel ratio feedback and control system.
- (C) Cold start enrichment system.
- (2) Air Induction System
- (A) Controlled hot air intake system.
- (B) Intake manifold.
- (C) Air filter.
- (3) Ignition System
- (A) Spark Plugs.
- (B) Magneto or electronic ignition system.
- (C) Spark advance/retard system.
- (4) Exhaust Gas Recirculation (EGR) System
- (A) EGR valve body, and carburetor spacer if applicable.
- (B) EGR rate feedback and control system.
- (5) Air injection System
- (A) Air pump or pulse valve.
- (B) Valves affecting distribution of flow.
- (C) Distribution manifold.
- (6) Catalyst or Thermal Reactor System
- (A) Catalytic converter.
- (B) Thermal reactor.
- (C) Exhaust manifold.
- (7) Particulate Controls
- (A) Traps, filters, precipitators, and any other device used to capture particulate emissions.
- (B) Miscellaneous items Used in Above Systems
- (A) Vacuum, temperature, and time sensitive valves and switches.
- (B) Electronic controls.
- (C) Hoses, belts, connectors, and assemblies.

Evaporative Emission

- (1) Fuel Tank
- (2) Fuel Cap
- (3) Fuel lines(for liquid fuel and fuel vapors)
- (4) Fuel Line Fittings
- (5) Clamps
- (6) Pressure Relief Valves
- (7) Control Valves
- (8) Control Solenoids
- (9) Electronic Controls

- (10) Vacuum Control Diaphragms
- (11) Control Cables
- (12) Control Linkages
- (13) Purge Valves
- (14) Gaskets
- (15) Liquid/Vapor Separator
- (16) Carbon Canister
- (17) Canister Mounting Brackets
- (18) Carburetor Purge Port Connector

Note: As they relate to the emissions control system.

(e)Written instructions for the maintenance and use of the emissions control system by the owner shall be furnished with each new engine or equipment subject to this Article. The instructions must be consistent with this Article and applicable regulations contained herein.

(f)The documents required by subsections (d) and (e) must be submitted with the application for emissions control system certification for approval by the Executive Officer. Approval by the Executive Officer of the documents required by subsections (d) and (e) is a condition of certification. The Executive Officer will approve or disapprove the documents required by subsections (d) and (e) within 90 days of the date such documents are received.

(g)The application for emissions control system certification must also include a statement regarding the maintenance of the emissions control system. The statement must include, but not be limited to, information on emissions control system maintenance, and a maintenance schedule.

(h)Any other warranty statements applicable to engines or equipment units must not imply a limitation on the emissions warranty period or its applicability to subsequent owners after the ultimate purchaser. If the warranty period for any warranty other than the emissions warranty is less than two years, the statement of such warranty must specifically state that it does not limit the emissions warranty period of two years from purchase. If any warranty other than the emissions warranty does not extend to subsequent owners after the ultimate purchaser, the statement of such warranty must specifically state that it does not affect the applicability of the emissions warranty to subsequent owners after the ultimate purchaser.