

KODA™

12" SQUARE LED CEILING LIGHT

Model: LM030366

CARE & USE INSTRUCTIONS

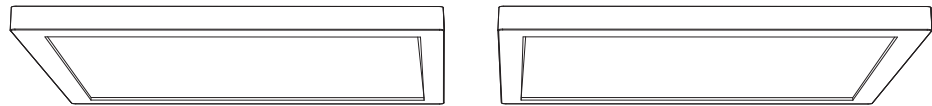

IMPORTANT INFORMATION.

PLEASE READ CAREFULLY AND RETAIN FOR FUTURE REFERENCE

For assistance with assembly, installation, parts or customer service, please contact us:

info@kodabuilt.com

1-866-294-9244, Monday to Friday, 8am to 5pm Pacific Time

2975 Red Hill Ave., Suite 100, Costa Mesa, CA 92626, USA

IMPORTANT SAFETY INSTRUCTIONS AND PRODUCT INFORMATION:

Please read the following safety information before use.

WARNING - To reduce risk of fire, electric shock, or personal injury:

- This light fixture is intended to be installed utilizing a NEC compliant junction box.
- **CAUTION:** Turn OFF the main power at the fuse or circuit breaker before installing the light fixture or making any electrical connection. Failure to do so may result in serious injury or death.
- Make sure this light fixture is adequately grounded. To ensure proper grounding, the ground wire provided must be connected between this light fixture indicated with a grounding mark and the ground connection to your main power supply panel. Do not connect the bare or green insulation fixture ground wire to the black (hot) current-carrying wire or the white (neutral) wire. Connection of the bare or green fixture ground wire to the black or white wires may cause metal parts of the fixture to carry electrical currents and could cause serious injury or death from electric shock.
- Do not connect this light fixture to an electrical system that does not provide a mean for equipment grounding. Never use a fixture in a two-wire system that is not grounded. Installing a fixture into an electrical system without a proper grounding could cause metal parts of the fixture to carry electrical currents if any of the fixture wires, wire connections, or splices were to be broken, cut, or loose during the mounting or normal operation of the fixture. Under this condition, anyone coming in contact with the fixture would be subject to electrical shock, which could cause serious injury or death.
- **CAUTION:** A loose wire increases the risk of fire; tighten all connections securely.
- Do not suspend any fixture by the house wires. Suspending a fixture by the house wires and wire connectors may result in the fixture falling, possibly causing personal injury and the danger of electrical shock or fire.
- It is recommended that a qualified electrician perform all wiring connections. All electrical connections must be in accordance with all national and local electrical codes.
- This light fixture is designed for use in a 120VAC, 60Hz fuse circuit.
- For indoor use only. Suitable for damp locations.

WARNING:

- LED light output is strong enough to injure human eyes. Precautions must be taken to prevent looking directly at the LEDs without installing the diffuser (cover) for more than a few seconds.
- If the light fixture is damaged, it shall be exclusively replaced by the manufacturer or the service agent or qualified person in order to avoid a hazard.
- Do not tamper with or attempt to repair the LED component or fixture. The light source is designed for this specific application and should not be serviced by untrained personnel. Contact the customer service department if any servicing is required.
- The warnings, precautions, and instructions discussed in this manual cannot cover all possible conditions and situations that may occur. The operator must understand that common sense and caution are factors which cannot be built into this product but must be managed by the operator.
- If using this light fixture in a damp location, this light fixture must be connected to a supply circuit that is protected by a Ground Fault Circuit Interrupter (GFCI) to reduce the risk of personal injury, electrical shock, or death.
- This device does not have a plug; rewiring is required. If you are unsure how to rewire this light, please contact a qualified electrician to install instead of attempting to rewire yourself.
- Power will still run to the light even after the LED lifespan runs out. Always shut the power from the fuse (breaker) when conducting any type of maintenance on the light.
- For indoor use only. Suitable for damp locations

CLEANING:

- Clean the surface of the fixture with a soft and dry or slightly dampened cloth. Never use a cleaner with chemicals, solvents, or harsh abrasives to clean the product.
- Do not spray cleaner directly onto any part of the fixture or LEDs as this may permanently damage the light or its functions.

PACKAGE CONTAINS:

Please lay out all parts and read the instructions prior to installation.

Square LED Ceiling Light:



2 x 12" Square LED Ceiling Light

Installation Kit:

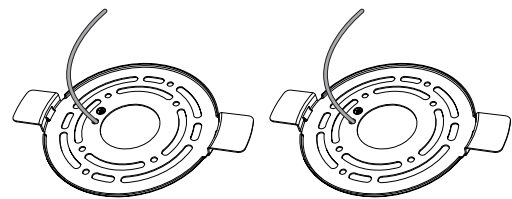

2 x Round Mounting Plate

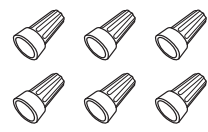

6 x Wire Nuts

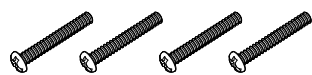

4 x Mounting Screws

Tools Needed (not included):



Philips Head Screwdriver

PREPARATION:

Carefully remove the light fixture and installation kit from the box, and check that all parts are included. Do not attempt to assemble the product if any part(s) are missing or damaged. Please contact KODA customer support if this is the case.

The outlet box described in this manual is not provided. A standard outlet box needs to be pre-installed in the ceiling, and the power supply wires running to the outlet box need to be rated 120Vac. If an outlet box does not exist, contact a qualified electrician for installation.

Turn OFF the main power at the fuse or circuit breaker before installing the light fixture or making any electrical connection. You may use a non-contact voltage tester to ensure there is no power running to the wires.

Warning: Failure to disconnect the power supply prior to installation may result in serious injury or death.

THIS PRODUCT MUST BE INSTALLED IN ACCORDANCE WITH THE APPLICABLE INSTALLATION CODE BY A PERSON FAMILIAR WITH THE CONSTRUCTION AND OPERATION OF THE PRODUCT AND THE HAZARDS INVOLVED.

INSTALLATION PROCEDURE:

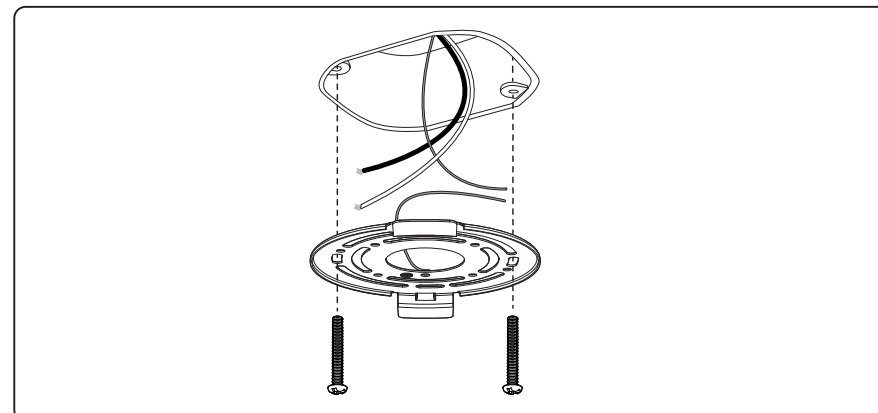

1. Install the Round Mounting Plate to the Outlet Box using the Mounting Screws. Adjust the orientation of the Round Mounting Plate to your desired angle.

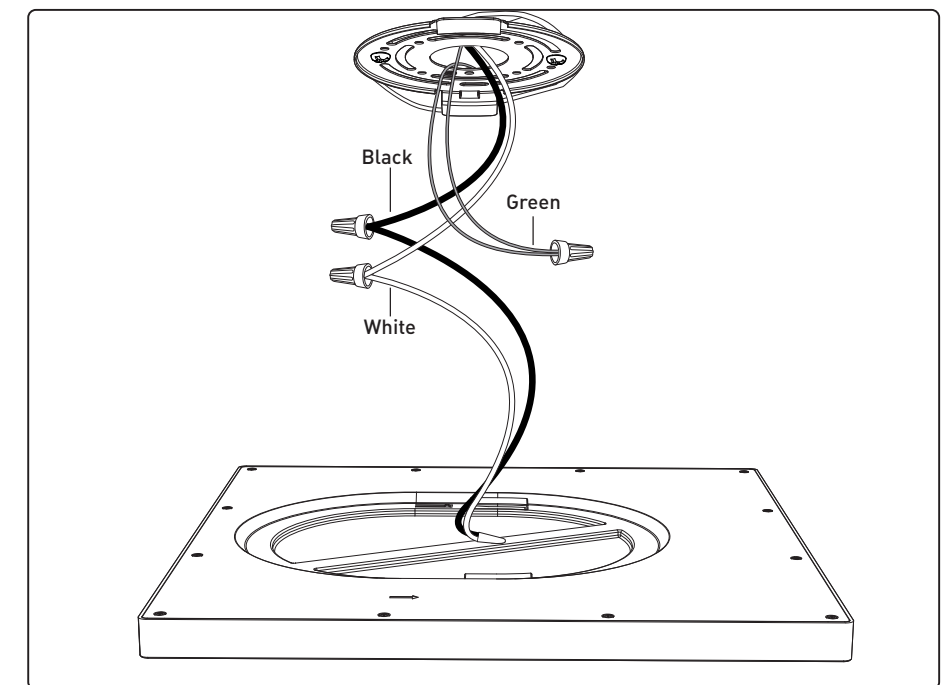

Warning: Never connect the ground wire to the hot or neutral power supply wires.

2. Make the following spliced wire connections using Wire Nuts:

- Black (hot) wire to the hot supply wire (most likely black or colored).
 - White (neutral) wire to the neutral supply wire (most likely white).
 - Green (ground) wire to the supply ground wire (most likely bare copper, green wire, or green and yellow wire), or wrap around the ground screw if ground wire does not exist.
- Screw the Wire Nuts in a clockwise direction until tight. Make sure no bare wire or wire strands are visible after making the connections. Check for tightness by pulling wires.

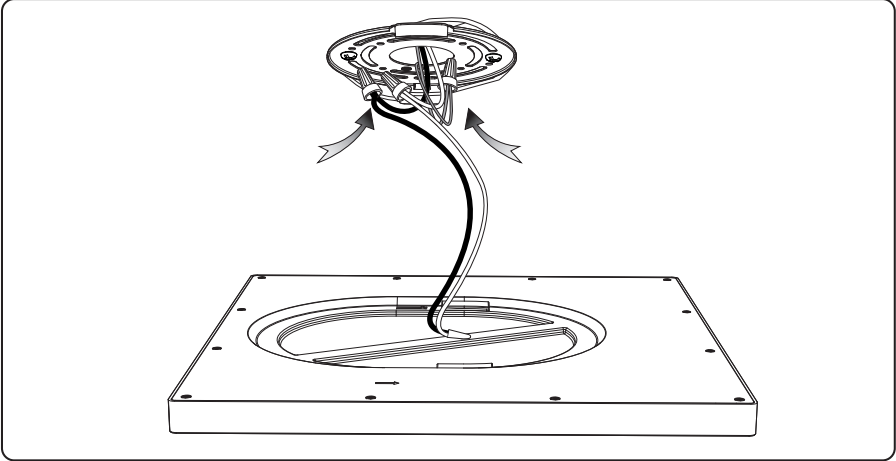

3. Carefully place all the wires and wire connections into the Outlet Box.

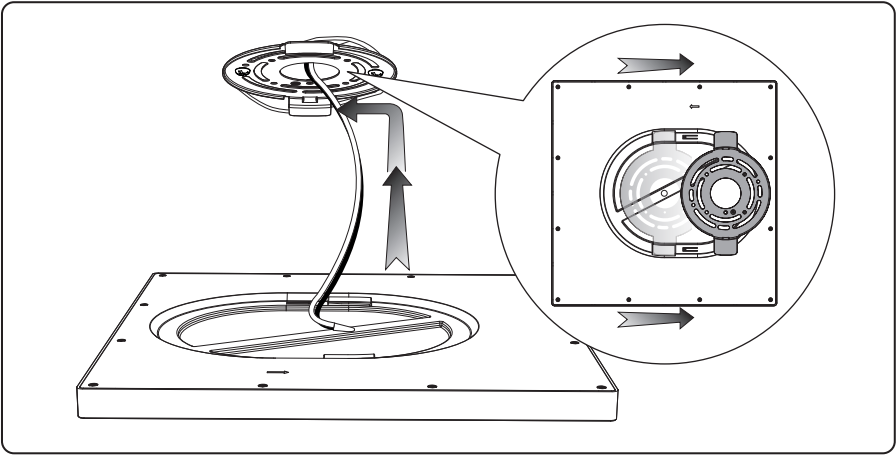

4. Align the Round Mounting Plate with the Fixture and slide it down into the slot.

WARRANTY:
This KODA product carries a 5-year warranty against defects in workmanship and materials subject to the conditions and additional warranty information available at: www.kodabuilt.com/warranty

DISCLAIMER OF WARRANTIES, INCLUDING WARRANTY OF MERCHANTABILITY AND WARRANTY OF FITNESS FOR PARTICULAR PURPOSE: EXCEPT AS SPECIFICALLY SET FORTH HEREIN, NO WARRANTY OR REPRESENTATION, EXPRESS OR IMPLIED, IS MADE AS TO THE LED CEILING LIGHT. KODA AND/OR ITS AFFILIATES EXPRESSLY DISCLAIMS, WITHOUT LIMITATION, ANY STATUTORY WARRANTIES AND ALL IMPLIED WARRANTIES, INCLUDING ANY IMPLIED WARRANTY OF MERCHANTABILITY OR FITNESS FOR A PARTICULAR PURPOSE.

PRODUCT SPECIFICATIONS:
Operating Voltage: 120 Vac, 60 Hz
Wattage: 18W
Light Output: 1350 lumens
Color Temperature: 2700K / 4000K
LED Life Cycles: up to 50,000 hours*
Color Accuracy / CRI: 80
Operating Temperature: 0°C to 40°C / 32°F to 104°F
*50,000-hour lifespan is for the LED only. Lifespan depends on operating temperature, environmental conditions, etc.



DIMMER SWITCH:
Most standard dimmers are compatible with this light.
For a complete list of compatible dimmers, please visit www.kodabuilt.com.

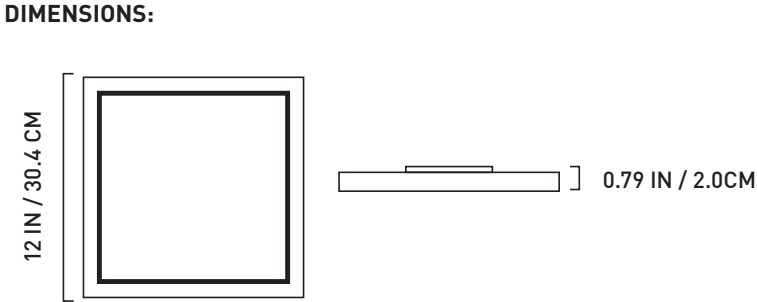

Problem	Possible Cause	Solution
The light does not illuminate. The light does not come on.	Power is off.	Ensure the power supply and circuit breaker are both set to the ON position.
	Faulty wire connection.	Check all wiring to ensure they are correctly and securely wired.
	Faulty switch.	Test and/or replace switch.
	End of life for the integrated LED.	Replace the light fixture.
Fuse blows or circuit breaker trips when the light is illuminated.	The wires are crossed (not wired properly) or the power wire is grounding out.	Turn power to the light OFF from the breaker. Check the wires to ensure the wires were properly connected. If everything looks correct, contact a qualified electrician to check your wires.
My junction box does not have a ground wire.	The junction box is already grounded.	Look for a ground screw inside the junction box. Wrap the ground wire from the light to that ground screw.

FCC / IC Compliance Statement:
12" Square LED Ceiling Light
Model: LM030366
Responsible Party:
Koda
Address: 2975 Red Hill Ave., Ste. 100, Costa Mesa, CA 92626, USA
Tel: 1-866-294-9244

This device complies with Part 15 of the FCC rules and Industry Canada license-exempt RSS standard(s). Operation is subject to the following two conditions: (1) this device may not cause harmful interference, and (2) this device must accept any interference received, including interference that may cause undesired operation.

Warning: Changes or modifications to this unit not expressly approved by the party responsible for compliance could void the user's authority to operate the equipment.

The manufacturer is not responsible for any radio or TV interference caused by unauthorized modifications or change to this equipment. Such modifications or change could void the user's authority to operate the equipment.

This equipment has been tested and found to comply with the limits for a Class B digital device, pursuant to part 15 of the FCC Rules. These limits are designed to provide reasonable protection against harmful interference in a residential installation. This equipment generates, uses and can radiate radio frequency energy and, if not installed and used in accordance with the instructions, may cause harmful interference to radio communications. However, there is no guarantee that interference will not occur in a particular installation. If this equipment does cause harmful interference to radio or television reception, which can be determined by turning the equipment off and on, the user is encouraged to try to correct the interference by one or more of the following measures:

- Reorient or relocate the receiving antenna.
- Increase the separation between the equipment and receiver.
- Connect the equipment into an outlet on a circuit different from that to which the receiver is connected.
- Consult the dealer or an experienced radio/TV technician for help.

CAN ICES-005(B) / NMB-005(B)

MADE IN CHINA

Have a comment or question? Email us at info@kodabuilt.com or visit us online at www.KodaBuilt.com

KODA™
A Horizon Brands Company
2975 Red Hill Ave., Ste. 100, Costa Mesa, CA 92626, USA | Tel: 1-866-294-9244
© 2022 Koda. All rights reserved.