



large hole WALL REPAIR KIT

Flat Fill,
PRO FINISH

Instructions



For a how-to video, visit
go.3M.com/LHWallRepairKit.

Construction and Home
Improvement Markets Division
3M Center, Building 223-4S-02
St. Paul, MN 55144-1000
1-800-494-3552

© 3M 2016. All rights reserved.
3M is a trademark of 3M.
Please recycle. Printed in U.S.A.
34-8718-7925-9

1



Clean damaged area by removing all dust and loose debris both inside and outside wall.

2



Thoroughly sand outside paper edge of hole, making sure surface is as smooth as possible.

3



Remove white backing from both strips of double-sided tape.

4



Curl back plate and place inside hole.

Note: paper surface behind repair must be intact for back plate to stick.

5



Carefully center back plate in damaged area. Pull strap to secure tape to inside of wall and hold for 30 seconds using firm pressure.

6

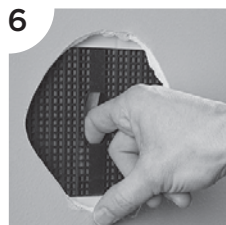

Use finger to apply additional pressure along back of tape line to confirm strong adhesion.

7

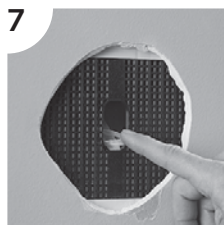

Once secured, push strap through center hole.

8

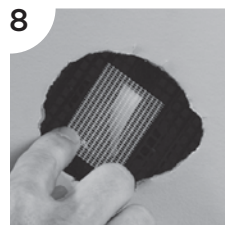

Lightly apply supplied tape over center hole. Trim if necessary.

9



Use putty knife to slightly overfill damaged area with wall repair compound — this allows for flat sanding.

10



Before each stroke, wet blade of knife. Slowly smooth compound with wet knife at a very low angle.

11

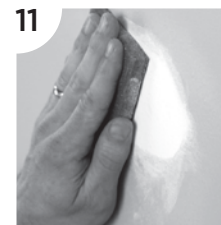

Once surface is completely dry, sand flat to finish. Repair should be allowed to dry overnight.

12

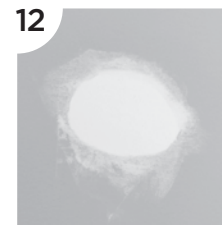

Apply a primer/sealer and paint according to manufacturer's instructions. If necessary, additional coats of compound can be applied before or after priming.