

05 : 00

estimated
installation time



1 or more

people required

Ok, let's
get started!



- Put on mood music!
- To prevent damage to product, use the clean side of package carton or rug as working surface for assembly.
- In the event of missing or damaged parts, delivery problems etc., please reach out to our team. We will be happy to fix the problem!

care guide

- Clean regularly with a soft and dry cloth.
- To protect finish, avoid use of abrasive cleaners.
- Wipe up spills immediately. Please!



product
parts



(A)
Shelf
x1

what's included

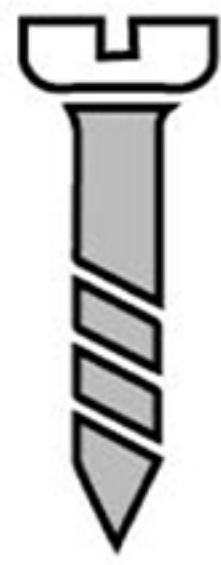

(B)- Screw
x2



(C)- Wall Plug
x2

installation instructions

Take a deep breath going in.
This is easy even if you are not
used to tools. Just follow these
steps to the T, and the
outcome will be
worth it!



step 1:

Place the shelf on the wall and put a spirit level on it to check alignment. Adjust if needed.

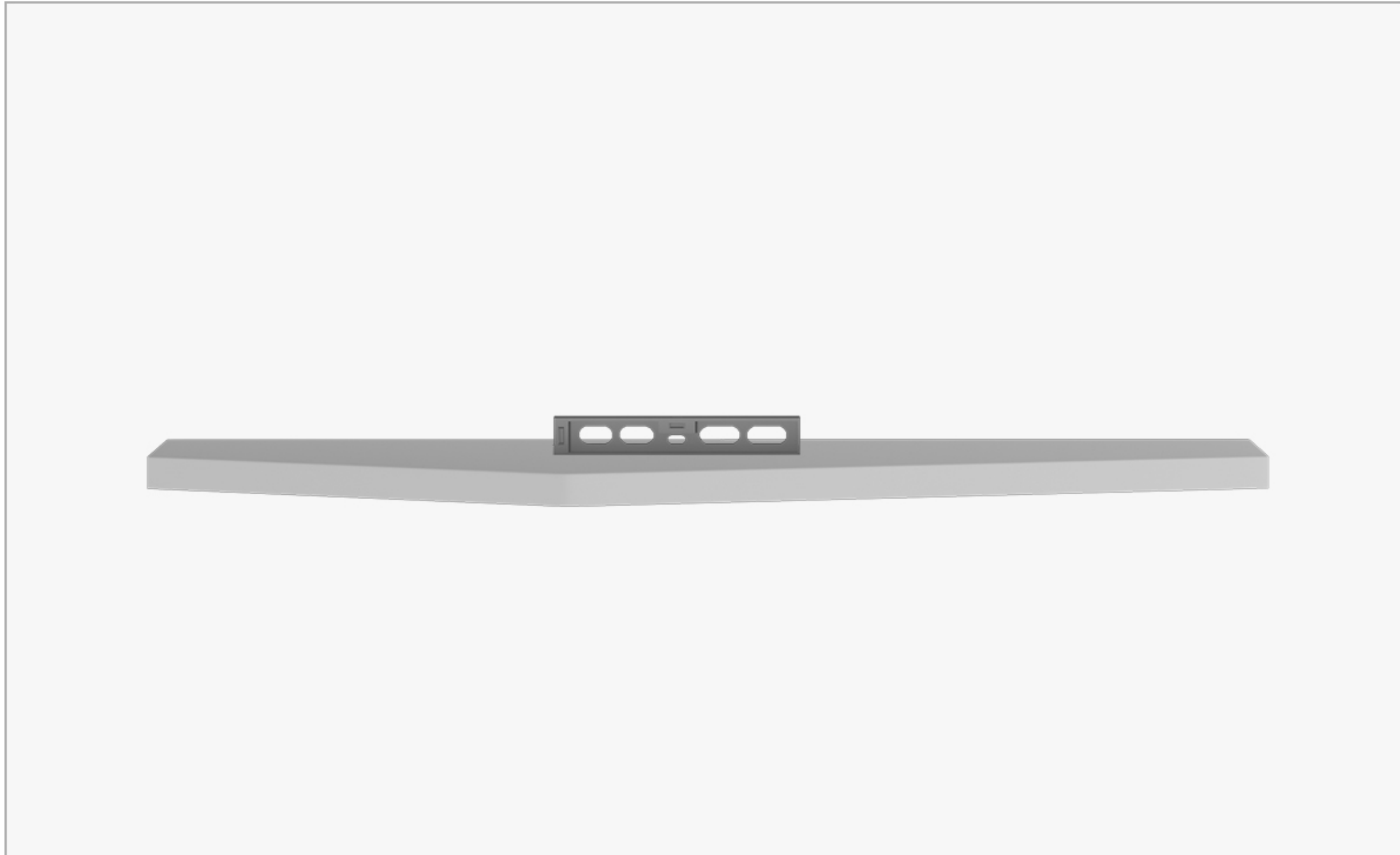

step 2:

Once the shelf is straight aligned to the wall, make a line running from its one end to the other using a pencil.

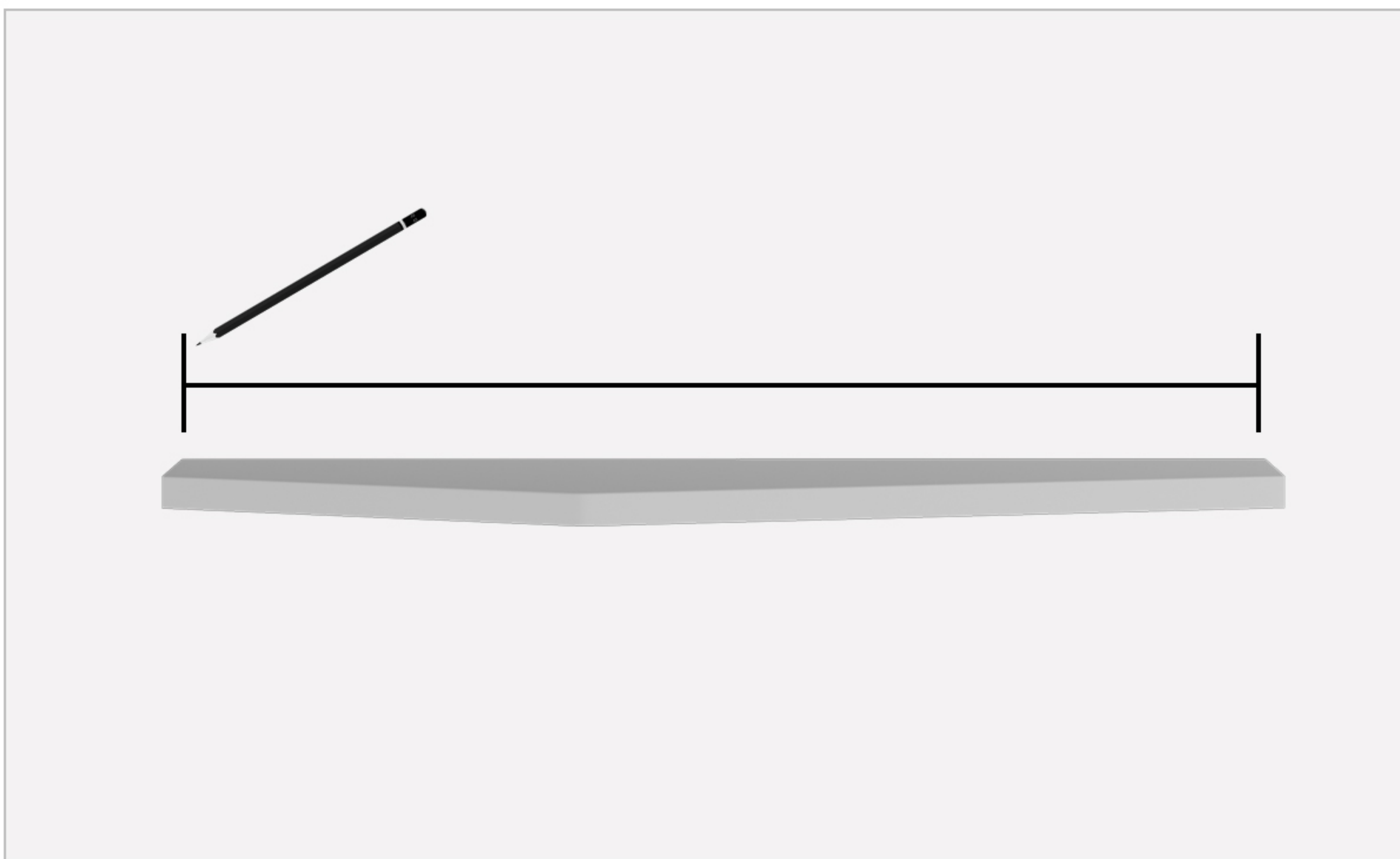

step 3:

Next, measure the distance between the two keyholes using a measuring tool.

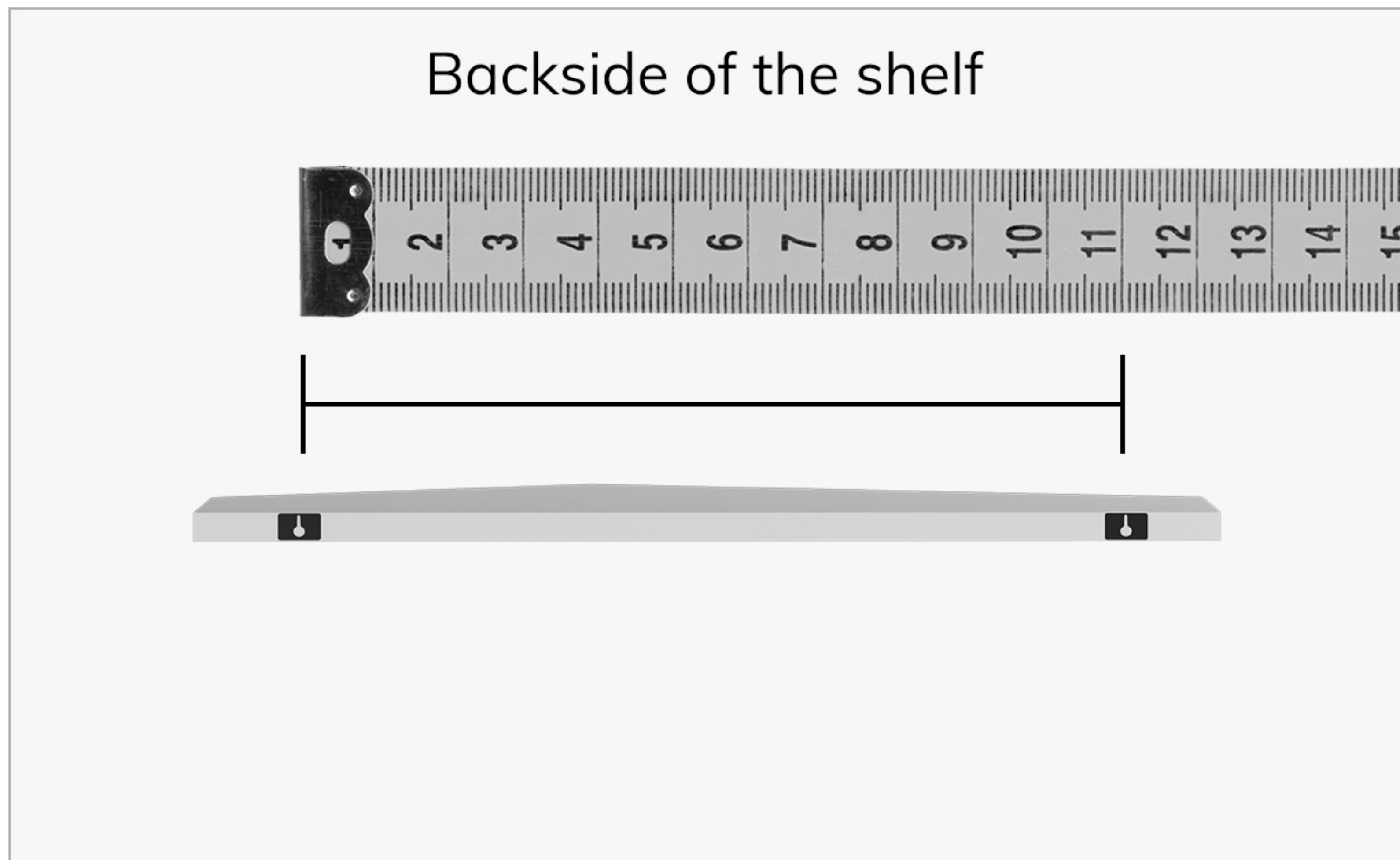

step 4:

Place the measuring tool against the parallel line on the wall and make two marks on it taking this image as reference.

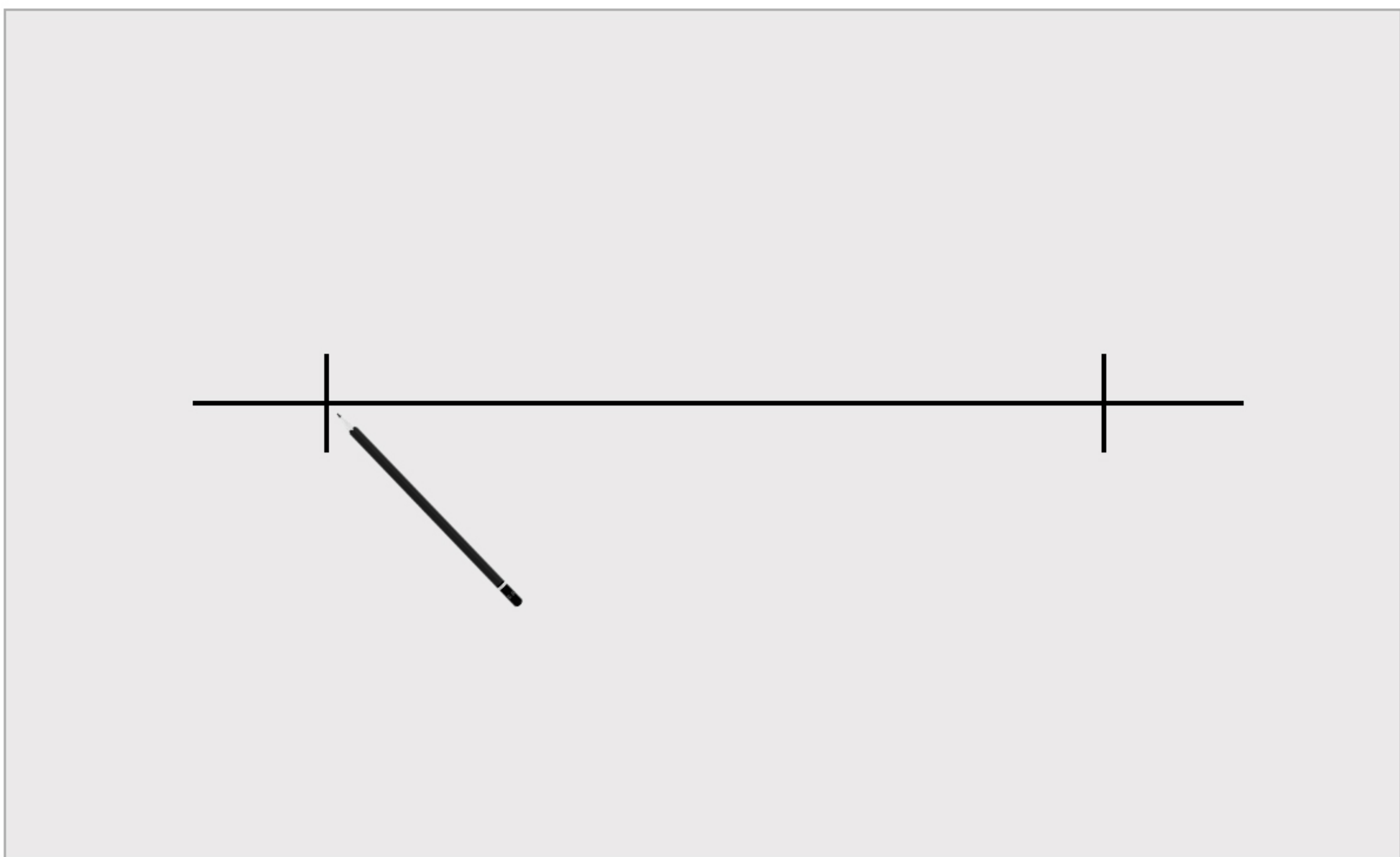

step 5:

Drill holes at the points you just marked.



step 6:

Now, insert the wall plugs (B) using a hammer.

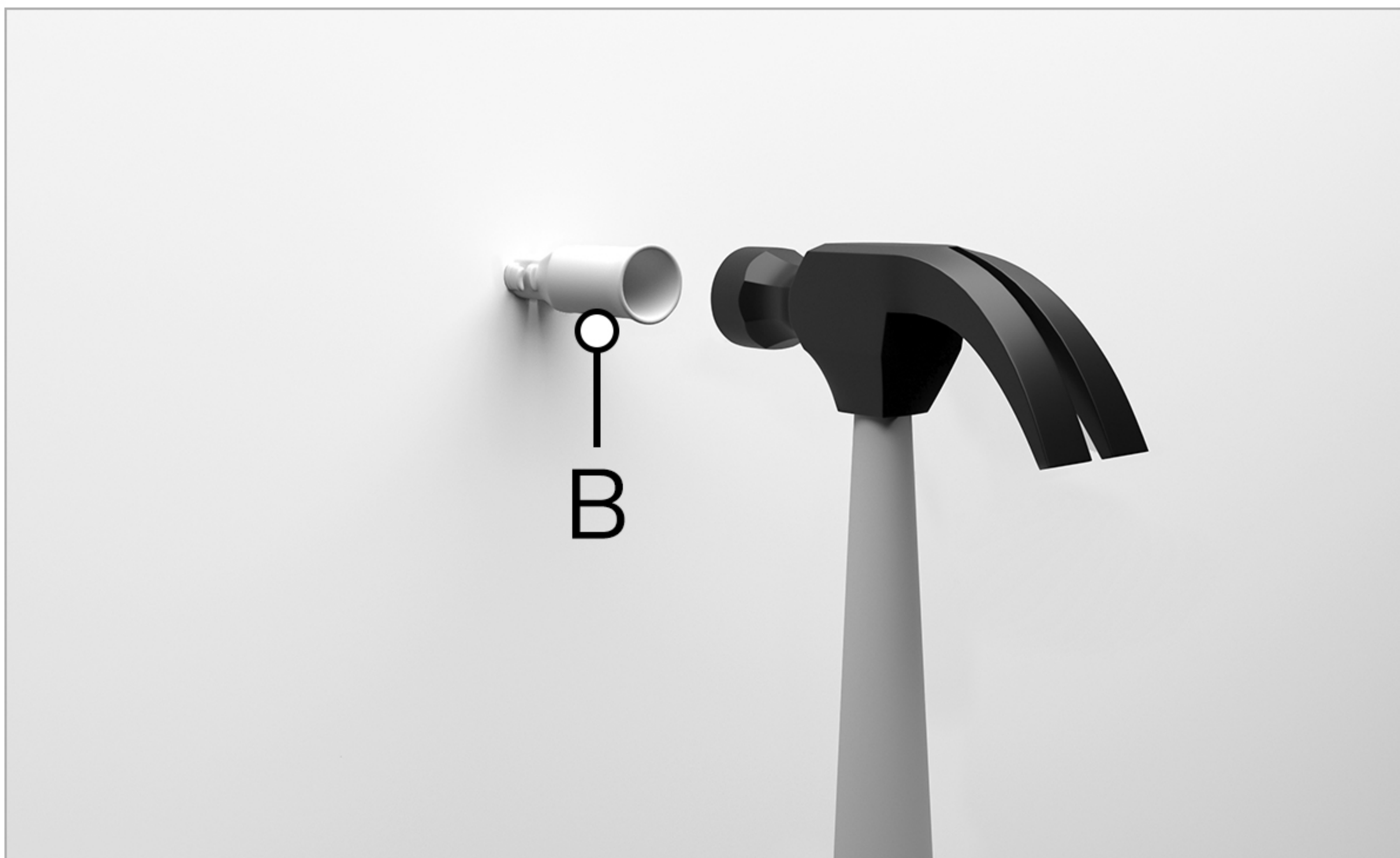

step 5:

Then, insert the screws (C) using a screwdriver.



step 6:

Place the keyhole slots over the screws.

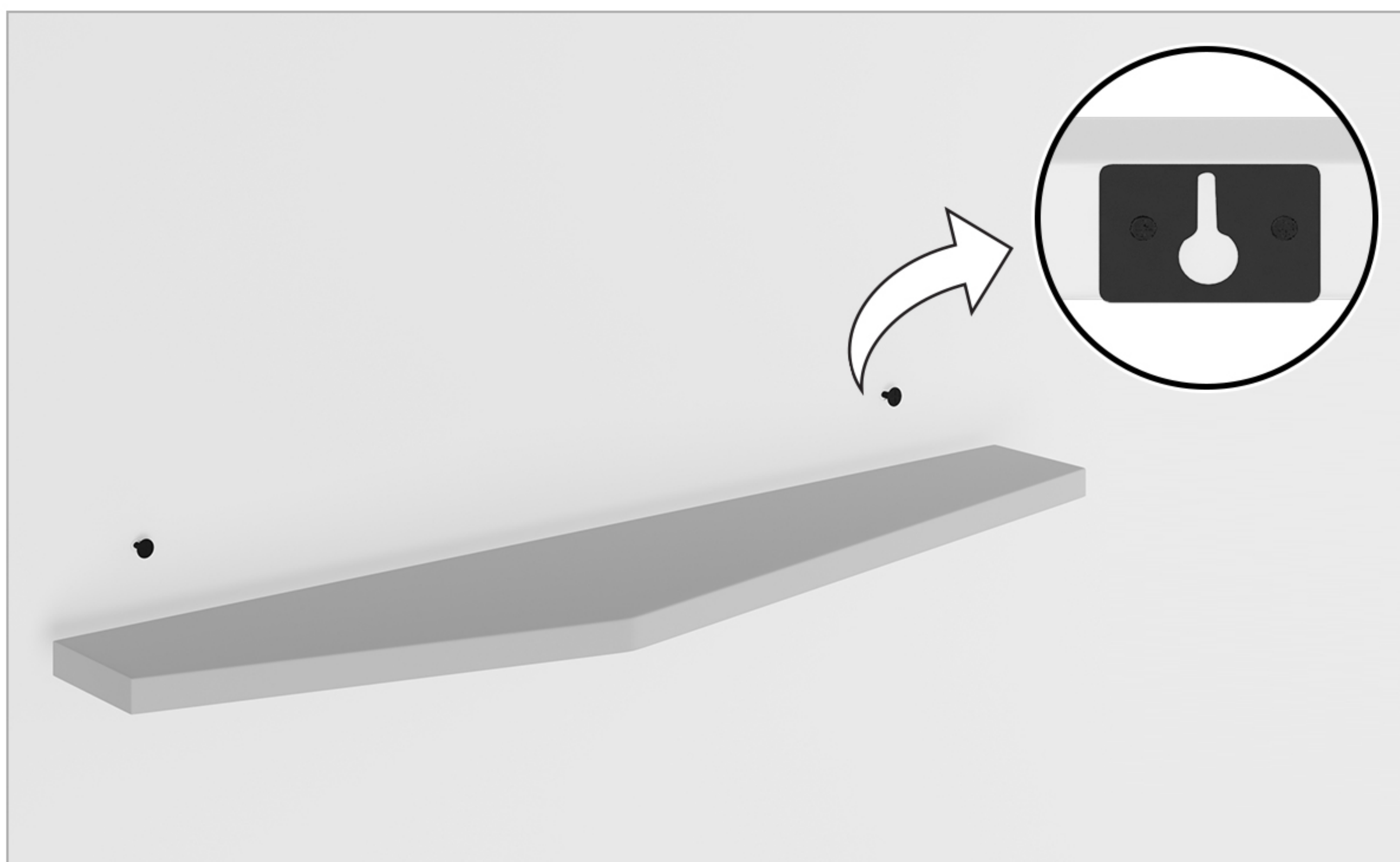

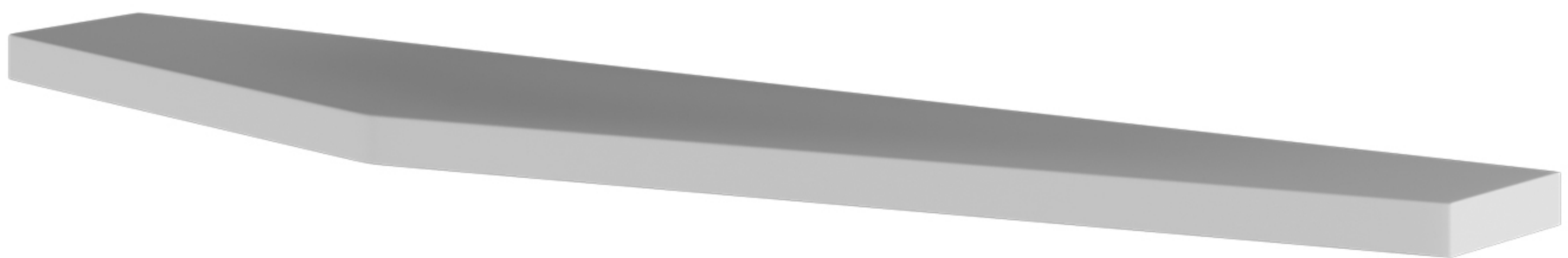

Voila! Your shelf is now installed and secure!

you've
got
a home
with us

