

# 10' (3.0m) LED PATIO UMBRELLA



## PLEASE READ CAREFULLY AND RETAIN FOR FUTURE REFERENCE

### SAFETY WARNING

Patio umbrellas are only designed to provide protection from the sun **NOT** the wind.

- **NEVER** open or operate this umbrella in wind conditions greater than **5mph (8kph)**.
- **NEVER** use the tilt function in any wind (even a light breeze).
- **NEVER** use excessive force on the crank handle to open or close the umbrella.
- **ALWAYS** close and secure the umbrella when not in use or during any strong wind event, especially gusting wind and rain.
- **ALWAYS** close the umbrella when unattended or not in use. If you are not sitting under it, the umbrella should be closed.
- **ALWAYS** use the Velcro straps to properly secure the canopy to the frame when the umbrella is closed.
- Umbrella bases are required (additional purchase) to secure this umbrella. **NEVER** open or operate a patio umbrella without a base. It is important to use a correctly weighted base; more weight is always better than less weight. This model requires a **MINIMUM** base weight of 31lb (14kg) if used through a table, or 78lb (35kg) if freestanding.

**FAILURE TO CAREFULLY OBSERVE THESE SAFETY WARNINGS CAN RESULT IN CATASTROPHIC DAMAGE TO YOUR UMBRELLA, POTENTIAL PERSONAL INJURY AND OR PROPERTY DAMAGE.**

### IMPORTANT INFORMATION

If the umbrella is showing ANY signs of stress, or IF the umbrella begins to move around excessively even when properly weighted it indicates the wind is too strong and the umbrella must be closed and secured immediately.

### CARE AND MAINTENANCE

- To help extend the life of the polyester fabric and reduce the effects of fading we strongly advise using a protective storage cover whenever the umbrella is not being used.
- During extended periods of bad weather (especially through winter months) your umbrella should be stored inside in a dry place.
- The polyester fabric has been treated to make it dirt and shower resistant (not waterproof), if your umbrella gets wet please allow it to fully dry before storing it away. The fabric can be cleaned with a soft brush then use a damp cloth and mild detergent to remove any stubborn stains.

### BEFORE YOU START

- Check you have all the listed parts before you start assembling.
- In the event of missing or damaged parts, contact our customer support team via your Amazon account.
- Assemble on a soft surface such as a drop sheet or rug to avoid scratching.

## WHAT'S IN THE BOX

Item	Part	Qty	Part Description
A		1	Umbrella Frame and Canopy
B		1	Lower Pole
C		1	Solar Panel
D		5	Spare LED Light Covers (if required)

## ASSEMBLY INSTRUCTIONS

### Step 1

Locate the plug at the top of the umbrella. Carefully insert the the plug into the socket located on the underside of the solar panel.

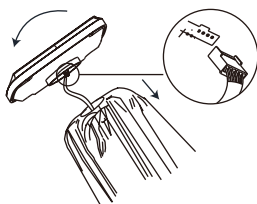

### Step 4

Stand and secure the umbrella in a suitable umbrella base (not included). Secure the umbrella pole firmly by tightening the locking nut as shown in the picture.

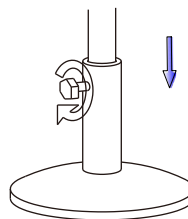

### Step 2

Place the solar panel on the top of the umbrella taking care to conceal the wires inside the gap at the top of the umbrella, then gently turn the solar panel in a clockwise direction to attach it to the umbrella. Take care not to over tighten as this may damage the umbrella and/or the solar panel.

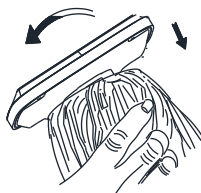

### Step 5

Locate the umbrella in direct sunlight to charge the batteries before first use. **IMPORTANT NOTE: Charge the batteries for at least 8 hours in direct sunlight before first use, failing to follow this step will shorten the lifespan of the re-chargeable batteries and decrease the performance of the lights. Make sure both the switches on the rib are set to the "OFF" 'O' position during charging.**

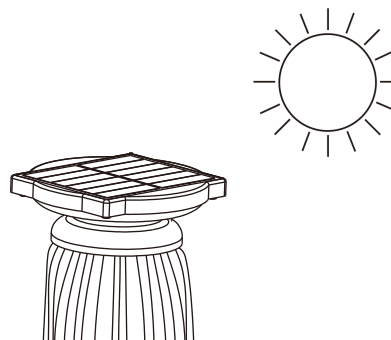

### Step 3

To assemble the umbrella frame to the lower pole: Locate and press in the spring-button on the umbrella frame until it clips into the hole located on the lower pole.

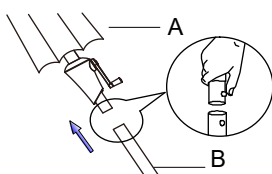

## OPERATING INSTRUCTIONS

### Step 1

To open the umbrella, unfasten the Velcro storage straps and gently pull out each of the umbrella ribs by hand, at the same time wind the crank handle gently in a clockwise direction.

**CAUTION: Take care not to wind the crank in a counter clockwise direction to open as damage may occur.**

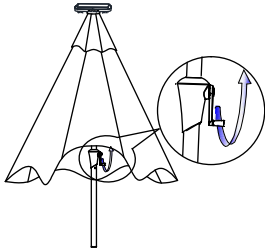

### Step 2

Continue to wind the crank handle until the umbrella canopy is fully open and taut. Take care as overwinding may damage the umbrella. Once the canopy is fully open insert the support pin into the hole located just below the runner hub.

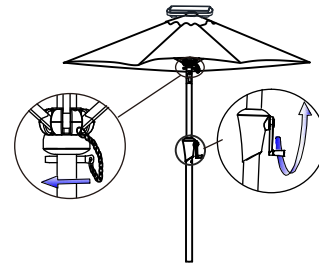

### Step 3

To tilt the canopy push the tilt button with one hand gently allow the canopy to tilt with the other hand. Release the button to lock in the position. **CAUTION: The tilt option should only be used on days with no wind, use of the tilt function even in a light breeze is not recommended.**

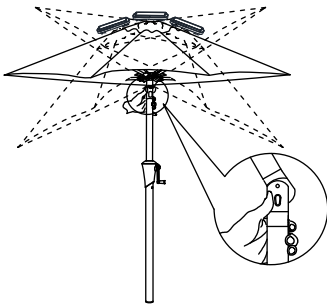

### Step 4

To close the umbrella, make sure the canopy is horizontal (**never close the umbrella in the tilted position**). Remove the support pin below the runner hub. Wind the crank handle in a counter clockwise direction until the canopy is fully closed.

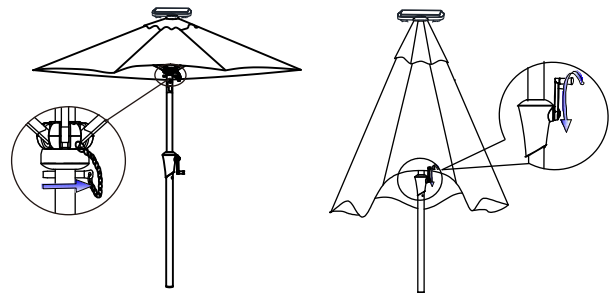

### Step 5

Use the Velcro storage straps to secure the umbrella when not in use.

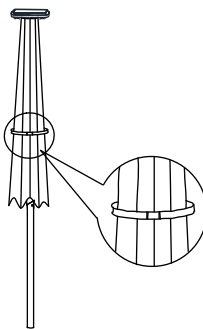

## OPERATING THE LIGHTS

To operate the lights, turn the switches (located on the end of one rib) to the ON ('I') position. Ensure **both** switches are set to the OFF ('O') position when the lights are not being used.

**IMPORTANT: If the lights are accidentally left on during the day the batteries will NOT charge and the lights will not operate at night.**

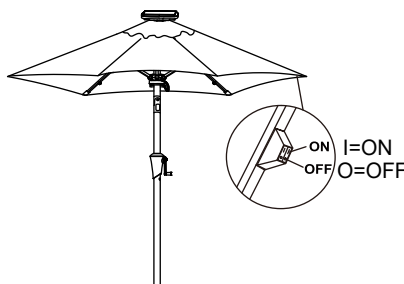

## REPLACING THE BATTERIES

The batteries in your LED umbrella must be replaced at least once every year (or when you feel that the light is fading more quickly). You can purchase replacement batteries at specialty retailers.

You will need 3 pieces AA size 1.2v 800mAh NIMH rechargeable batteries which are the same as have been supplied from new.

**Failure to insert batteries in the correct polarity, as indicated in the battery compartment, may shorten the life of the batteries or cause them to leak. NEVER dispose of batteries in fire. Batteries must be recycled or disposed of as per state and local guidelines. NEVER mix old and new batteries. NEVER mix Alkaline, Standard (Carbon-Zinc) or rechargeable (Nickel Cadmium) or (Lithium) batteries together in the solar panel.**

### Step 1

Twist the solar panel counter clockwise and remove it from the top of the umbrella.

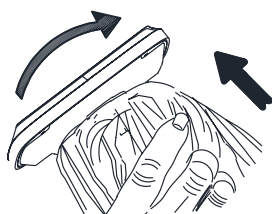

### Step 2

Carefully pull the plug out of the socket under the solar panel.

**IMPORTANT: Do not pull the wire to remove the plug.**

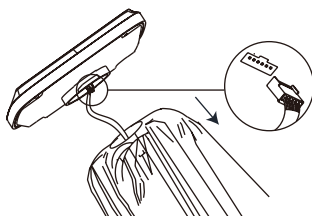

### Step 3

Set the solar panel upside down on a soft, clean surface to avoid scratching. Loosen all three screws on the bottom of the solar panel.

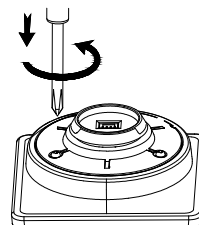

### Step 4

Carefully open the solar panel. Replace the batteries, matching the +/- on the battery with the +/- on the battery case.

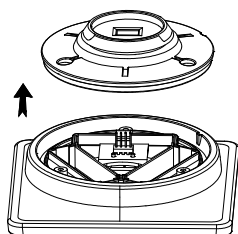

### Step 5

Make sure the O ring is correctly located before replacing the cover.

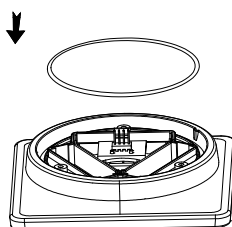

### Step 6

Re-assemble the solar panel. Do not over tighten the screws.

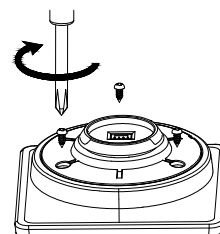

## CUSTOMER SUPPORT

**Please contact us via your Amazon account before leaving any negative review or feedback on Amazon.**

Your complete satisfaction matters to us, so if our product hasn't met or exceeded your expectations, or if you are having problems with assembly, missing or damaged parts, before you do anything else please email our support team directly, let us know the full details of the issue (attaching clear pictures to your email will always help us to better understand exactly what's gone wrong).

We promise to respond to your email within 24 hours, and we guarantee that we will fix the problem to your complete satisfaction.