



# GARBURATOR DISPOSAL ADAPTER

DA-01

## BEFORE YOU BEGIN YOUR INSTALLATION



Required tool



Installation by License  
Professional Plumber



Drawings are for  
reference only

## WARRANTY

For additional technical assistance or for any questions or concerns about your warranty, please contact us.

[www.stylishkb.com/warranty](http://www.stylishkb.com/warranty)



[www.stylishkb.com](http://www.stylishkb.com)



[care@stylishkb.com](mailto:care@stylishkb.com)



+1-855-789-5352

## COMPONENTS

This is a drain adapter to allow installation of a garburator on a sink with square drain hole

DA-01 components: (a) Sink flange, (b) Sink flange gasket and (c) Back up flange.

To complete installation of the DA-01 some components that comes with garburator are needed:  
(d) Mounting ring (ring with 3 screws) and (e) Snap ring (Wire ring)

**NOTE: These item are no provided with this kit**

## INSTALLATION STEPS

1

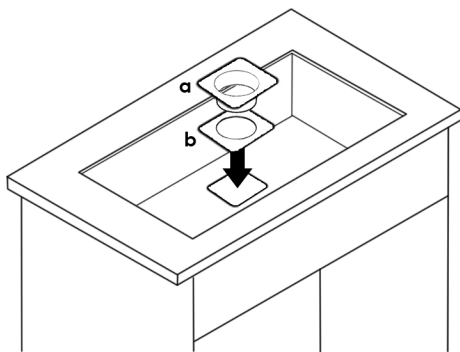

Place sink flange (a) and gasket (b) from the top side of the sink on the square drain opening

2

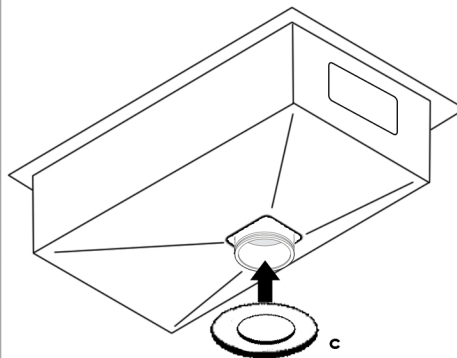

Underneath the sink, place the back up flange (c)

3

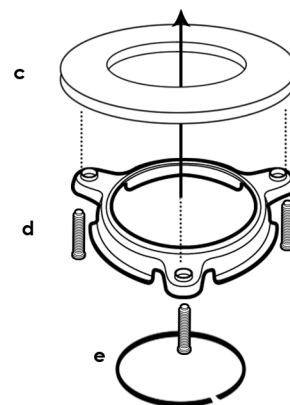

It is recommended to have the mounting ring (d) screws at the low position to make the installation of the snap ring (e) easier.

4

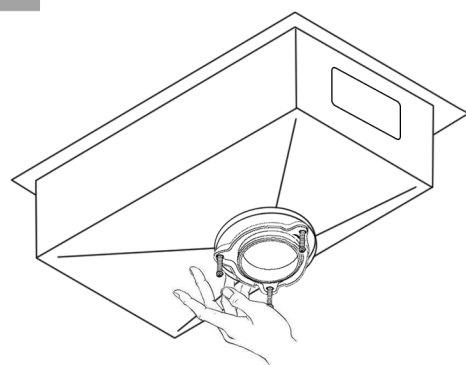

Place the mounting ring (d)

5

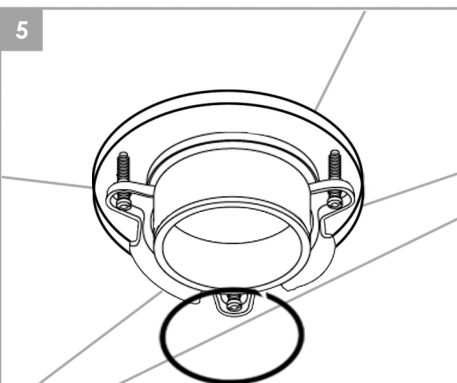

Insert the snap ring (e) ensure is over the hump of the sink flange cylinder.

6

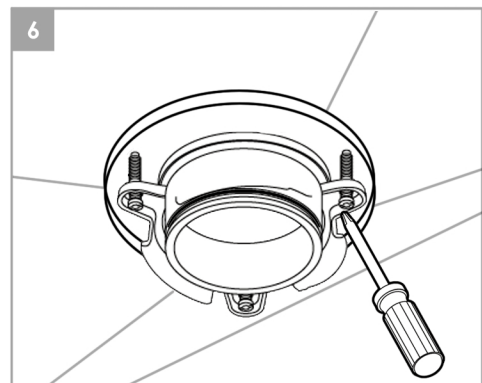

Tighten the screws from mounting ring (d) to get adapter tight and ready to continue garburator installation

Stylish International Inc

Follow us on Instagram! Check out and let us know your comments



[stylish.international.inc](https://www.instagram.com/stylish.international.inc)

Products and specifications shown are subject to change without notice. Please contact our technical support at [care@stylishkb.com](mailto:care@stylishkb.com) for any further queries, replacement parts requests, etc. ©2019 Stylish® all right reserved.