



Single Unit LG WashTower™ with Center Control™
5.0 cu. ft. Front Load Washer and 7.8 cu. ft. Electric
Ventless Heat Pump Dryer

- Mega Capacity 5.0 cu. ft. Washer and 7.8 cu. ft. Dryer
Single Unit Ventless WashTower™ Design
Advanced Washing: TurboWash® 360°
Built-In Intelligence: AI Fabric Sensor / Infrared Sensor / Smart Pairing™
Dual Inverter HeatPump™ Technology & Inverter Direct Drive Motor System

AVAILABLE COLORS

- WHITE
BLACK STEEL



Proactive Smart Alerts to Keep
Your Appliances Running Smoothly

ThinQ Care

- Preventative Alerts help you stay a step ahead of potential issues to find proactive solutions before problems arise.
- Avoid preventable repairs and service calls with real-time diagnostics for a hassle-free experience.
- Integrated within LG's ThinQ app—a smart home hub for managing your smart devices and appliances.



| SUMMARY | Washer | Dryer | FABRIC CARE FEATURES | Washer | Dryer | SMART FEATURES (ThinQ Technology) | Washer | Dryer |
|-----------------------------|---|--|--|---|-------|-----------------------------------|-----------------------------|--|
| Type | Single Unit Front Load Washer and Dryer | | AI DD® | Yes | - | Smart Diagnosis (v3.0) | Yes | Yes |
| Vent Type | - | Ventless | TurboWash® 360 Technology | Yes | - | Wi-Fi | Yes | Yes |
| Dryer Type | - | Heat Pump | Steam Technology | Yes | - | ThinQ Up | Yes | Yes |
| Capacity (cu. ft.) | Washer 5.0 cu. ft. / Dryer 7.8 cu. ft. | | Allergiene® Cycle | - | - | Remote Start/Cycle Monitor | Yes | Yes |
| Color | Black Steel (B), White (W) | | Sanitary Cycle | - | - | Energy Monitoring | Yes | Yes |
| ENERGY | | | AI Sensor Dry | - | Yes | Tub Clean Coach | Yes | - |
| ENERGY STAR® Most Efficient | | Yes | AI Sensor Dry 2.0 (with IR Sensor) | - | Yes | MOTOR AND AGITATOR | | |
| ENERGY STAR® Certified | Yes | Yes | 6 Motion Dry | - | Yes | Motor Type | Inverter Direct Drive Motor | |
| CEE Tier | Tier2 | - | Sensor Dry | - | Yes | Axis | Horizontal | |
| IMEF | 2.92 | - | Precise Temperature Control with Variable Compressor | - | Yes | MATERIALS AND FINISHES | | |
| IWF | 2.9 | - | APPEARANCE | | | NeveRust® Stainless Steel Drum | Yes | Yes |
| CEF | - | 9.0 | Touch Buttons | Yes | - | Aluminized Alloy Steel Drum | - | No |
| PROGRAMS | | | Full Touch Electronic Control Panel with LED Display | Yes | | Control Panel | Plastic | |
| No. of Programs | 6 | 6 | Center Control® | Yes | | Top Plate | Steel | |
| Wash Programs | Normal, Bedding, Delicates, Heavy Duty, Quick Wash, Downloaded | Normal, Bedding Delicates, Heavy Duty, Small Load, Downloaded | CONVENIENCE FEATURES | | | Cabinet | Painted Steel | |
| OPTIONS | | | TrueBalance® | Yes | - | Door / Rim | Large Circle Chrome Rim | |
| No. of Options | 9 | 8 | Anti-Vibration System | | | Door Cover | Tinted Round Tempered Glass | |
| Options | TurboWash®, Steam, Extra Rinse, Pre-wash, Tub Clean®, Drum Light®, Control Lock*, Signal*, Wi-Fi* / Remote Start* | Wrinkle Care, More Time, Less Time Condenser Care, Drum Light*, Control Lock*, Signal*, Wi-Fi* / Remote Start* | 4 Tray Dispenser | Prewash, Main Wash (with liquid detergent cup), Bleach, Fabric Softener | - | All Available Colors | Black Steel (B), White (W) | |
| DETAILS | | | End of Cycle Signal | Yes | - | CERTIFICATION | | |
| No. of Wash/Rinse Temps | 5 | - | LoadSense | Yes | - | AAFA | No | No |
| Wash/Rinse Temps | Hot, Very Warm, Warm, Cool, Cold | - | Control Lock | Yes | - | POWER SOURCE | | |
| No. of Spin Speeds | 5 | - | Auto Suds Removal | Yes | - | Ratings | CSA Listed | - |
| Spin Speeds | High, Medium/ High, Medium, Low, No Spin | - | Leveling Legs | 4 Adjustable Legs | - | Electrical Requirements | 120V, 10 Amps | 240V, 830W or 208V, 820W 15 Amp Circuit |
| Max RPM | 1300 | - | Drum Light | Yes | - | Type | Electric | Heat Pump |
| Water Levels | Load Sensing | - | Wrinkle Care Option | - | Yes | BTU Rating | - | Heat Pump : N/A |
| No. of Soil Levels | 5 | - | Control Lock | - | Yes | Plug | Yes | No |
| Drying Levels | - | Very, More, Normal, Less, Damp | Venting Option | - | - | Plug Type | 3 prong | 4-Wire or 3-Wire (Homes built after 1996 require 4-Wire) |
| Dry Mode | - | Energy Saver, Normal, Speed | 4 Adjustable Legs | - | Yes | OPTIONS/ACCESSORIES | | |
| Manual Dry Times | - | 30 - 70 mins. (10 min. increments) | Remaining Time Display/Status Indicator(s) | - | Yes | LP Conversion Kit | - | N/A |
| | | | Lint Filter | - | Yes | LIMITED WARRANTY | | |
| | | | Auto Cleaning Condensor | - | Yes | Parts and Labor | 1 Year | 1 Year |
| | | | | | | Direct Drive Motor | 10 Years | - |
| | | | | | | Drum | 3 Years | 3 Years |
| | | | | | | Inverter Compressor & Motor | - | 10 Years |
| | | | | | | UPC CODES | | |
| | | | | | | WKHC252HBA (Black Steel) | 195174072370 | |
| | | | | | | WKHC252HWA (White) | 195174072318 | |

DIMENSION / CLEARANCES

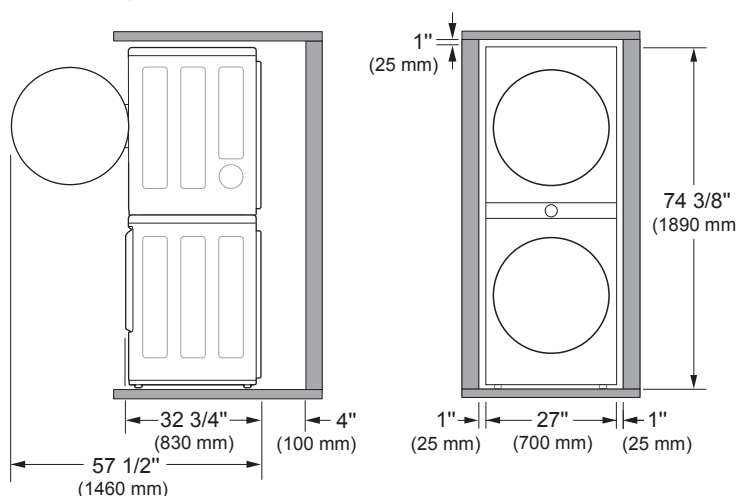

DIMENSIONS

| | |
|-----------------------------------|-----------------------------|
| Product (WxHxD) | 27" x 74 3/8" x 32 3/4" |
| Depth with Door Open | 57 1/2" |
| Carton Dimensions (WxHxD) | 29 1/4" x 77 1/2" x 33 1/4" |
| Approx. Weight (Product / Carton) | 353.0 lbs / 380.0 lbs |

DIMENSION / CLEARANCES

To ensure sufficient clearance for water inlet hoses, drain hose and airflow, allow minimum clearances of at least 1" (2.5 cm) at the sides and 4" (10 cm) behind the appliance. Be sure to allow for wall, door, or floor moldings that may increase the required clearances.

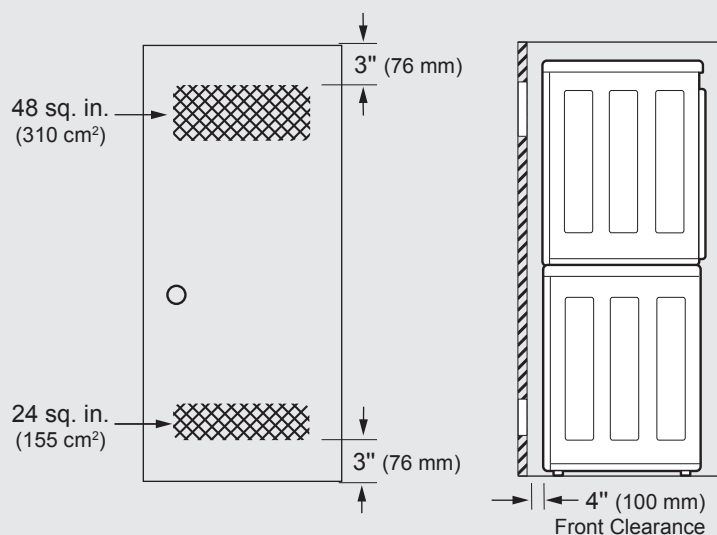

DIMENSION / CLEARANCES

Closet Ventilation Requirements

Closets with doors must have both an upper and lower vent to prevent heat and moisture buildup in the closet. One upper vent opening with a minimum opening of 48 sq. in. (310 cm²) must be installed no lower than 6 feet above the floor. One lower vent opening with a minimum opening of 24 sq. in. (155 cm²) must be installed no more than one foot above the floor. Install vent grills in the door or cut down the door at the top and bottom to form openings. Louvered doors with equivalent ventilation openings are also acceptable.

CONNECTING THE WATER INLET HOSE

- Check the fittings and seals. Inspect the threaded fitting on each hose and make sure there is a rubber seal ❶ in place in both ends of each hose to prevent leaking.
- Connect the water inlet hoses to the hot and cold water faucets tightly by hand and then tighten another 2/3 turn with pliers.
- Connect the blue hose to the cold water faucet and the red hose to the hot water faucet.

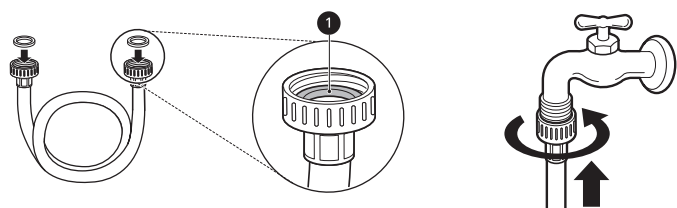

- ❶ Terminal Block Access Panel
- ❷ Dryer Drain Outlet (behind stacking bracket)
- ❸ Hot and Cold Water Inlets
- ❹ Shipping Bolts
- ❺ Drain Hose (for Washer)
- ❻ Power Cord (for Washer)

