

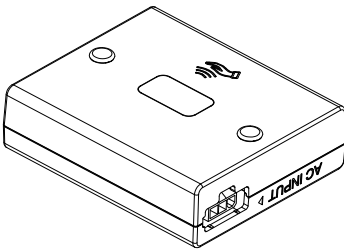

Installation Guide

Undercabinet Fixture Gesture Control Switch Accessory



www.gelighting.com
GE is a trademark of General Electric Company. Used under trademark license.
©2024 Savant Technologies LLC. Information provided is subject to change without notice.
All values are design or typical values when measured under laboratory conditions.

PRODUCT COVERED

Model	UNCAC-DW-WT-U
Input voltage	120VAC 60HZ
Output voltage	120VAC 60HZ
Max Output Current	LED 1.25A
Max Output Wattage	LED 150W

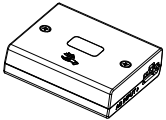

ON/OFF Gesture Control
Wave your hand within 1-inch of the Gesture Control sensor and the compatible GE Plug-In or Direct Wire Undercabinet Fixtures & Pucks will turn on or off.



BEFORE YOU BEGIN
Read these instructions completely and carefully.

WARNING

- Risk of fire or electric shock. Installation requires knowledge of luminaire electrical systems. If not qualified, do not attempt installation. Contact a qualified electrician.
- To prevent wiring damage or abrasion, do not expose wiring to edges of sheet metal or other sharp objects.
- Changes or modifications are not allowed by the manufacturer.
- These products are intended to be used in dry or damp locations.
- Do not operate with power on during installation.

PREPARE ELECTRICAL WIRING



Electrical Requirements
The LED fixture must be supplied with 120VAC 60Hz.



Grounding Instructions
The grounding and bonding of the overall system shall be done in accordance with National Electric Code (NEC) Article 600 and local codes.

PACKAGE CONTENTS

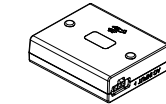

×1

×2
Screw Hole Cover



12" Linking Cable

×1

×2
Mounting Screw

COMPATIBILITY REQUIREMENTS

- Do not use with dimmer accessory or in-wall dimmer switch.
- **When connecting multiple fixtures to the Gesture Control Switch accessory the combined wattage should not exceed 150W. DO NOT EXCEED.**
- Make sure that the 5ft. power cable (included with your fixture) can reach the outlet and that the 12-inch linking cable (included with this package) can reach the UCF fixture.
- **COMPATIBLE WITH ONLY THE FOLLOWING GE BRANDED UNDERCABINET PRODUCTS & ACCESSORIES.**

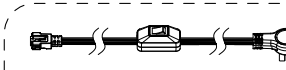

60" Grounded Power Cord with On/Off Button

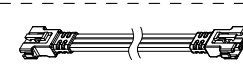

12", 24" & 36" Grounded Linking Cable Link dimmer switch or hand-wave switch and fixture together up to 24" or 36" apart.

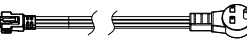

60" Grounded Power Cord



5CCT Puck
UNCPK03PJ030D95CWTLDS



Edge-lit 5CCT Bar
UNCBRXXPDXXD95CWTLDO

(SOLD SEPARATELY)

TOOLS REQUIRED



Drill



Screwdriver

FCC Compliance Statement: This equipment has been tested and found to comply with the limits for a Class B digital device, pursuant to part 15 of the FCC Rules. These limits are designed to provide reasonable protection against harmful interference in a residential installation. This equipment generates, uses and can radiate radio frequency energy and, if not installed and used in accordance with the instructions, may cause harmful interference to radio communications. However, there is no guarantee that interference will not occur in a particular installation. If this equipment does cause harmful interference to radio or television reception, which can be determined by turning the equipment off and on, the user is encouraged to try to correct the interference by one or more of the following measures. Reorient or relocate the receiving antenna. Increase the separation between the equipment and receiver. Connect the equipment into an outlet on a circuit different from that to which the receiver is connected. Consult the dealer or an experienced radio/TV technician for help.

Risk of Damage: Use UL approved conduit fittings for all enclosure box connections to prevent damage to the wire insulation by sharp edges and excessive strain on wiring.

INSTALLATION

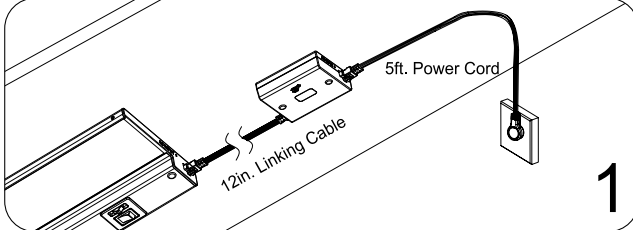

Place the product in the desired position. **Ensure the 5ft. Power Cord (included with your bar or puck) can reach the outlet and that the 12in. Linking Cable (included with this package) can reach the nearest bar or puck.** If your layout exceeds the distance between each fixture, swap the 12in. linking cable for longer versions (sold separately).

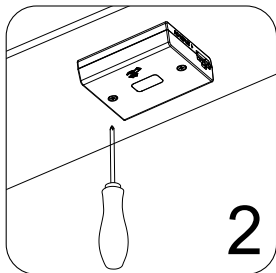

Pay attention to INPUT and OUTPUT direction. The Power Cord will connect to the INPUT side. Hold in place and insert mounting screws. Provided screws are suitable for cabinet bottoms 3/8in. or thicker. Pre-drill a pilot hole for the screws using a 3mm or 1/8in. size drill bit if needed.

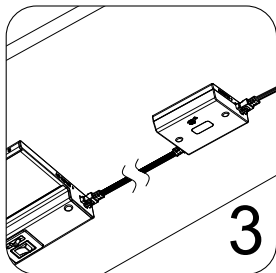

Insert the Linking Cable into the Dimmer Switch OUTPUT port and INPUT port of the adjacent bar or puck. **DO NOT USE EXCEED 150W/1.25A LED OUTPUT.**

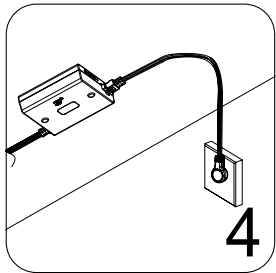

Make sure the on/off button is in the off position. Plug the power cord into an electrical outlet and insert the other terminal into INPUT port of the switch.

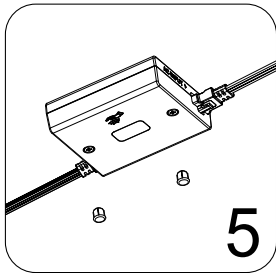

Insert the installation hole covers. Set all linked bars and pucks to the on position. Wave your hand within 1-in. of the **Gesture Control sensor** to turn all linked bars or pucks on or off.