

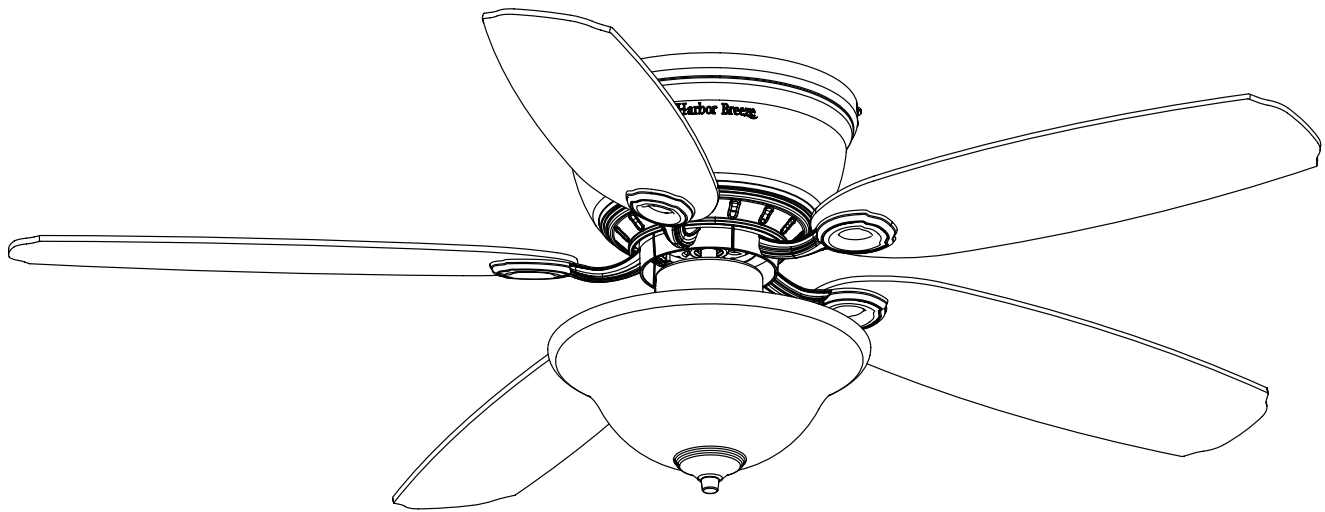

Harbor Breeze® is a registered trademark of LF, LLC. All Rights Reserved.

ITEM #0803775, 0721899, 0807427
PAWTUCKET CEILING FAN
MODEL #40958, 40959, 40305

Español p. 20



ATTACH YOUR RECEIPT HERE



Serial Number _____

Purchase Date _____



Questions, problems, missing parts? Before returning to your retailer, call our customer service department at 1-800-643-0067, 8 a.m. - 6 p.m., EST, Monday - Thursday, 8 a.m. - 5 p.m., EST, Friday.

AB17996

TABLE OF CONTENTS

Package Contents 3

Hardware Contents 4

Safety Information 5

Preparation 6

Initial Installation 7

Fan Wiring 10

Final Installation. 11

Operating Instructions 15

Care and Maintenance 16

Troubleshooting. 16

Limited Lifetime Warranty 18

Replacement Parts List 19

PACKAGE CONTENTS

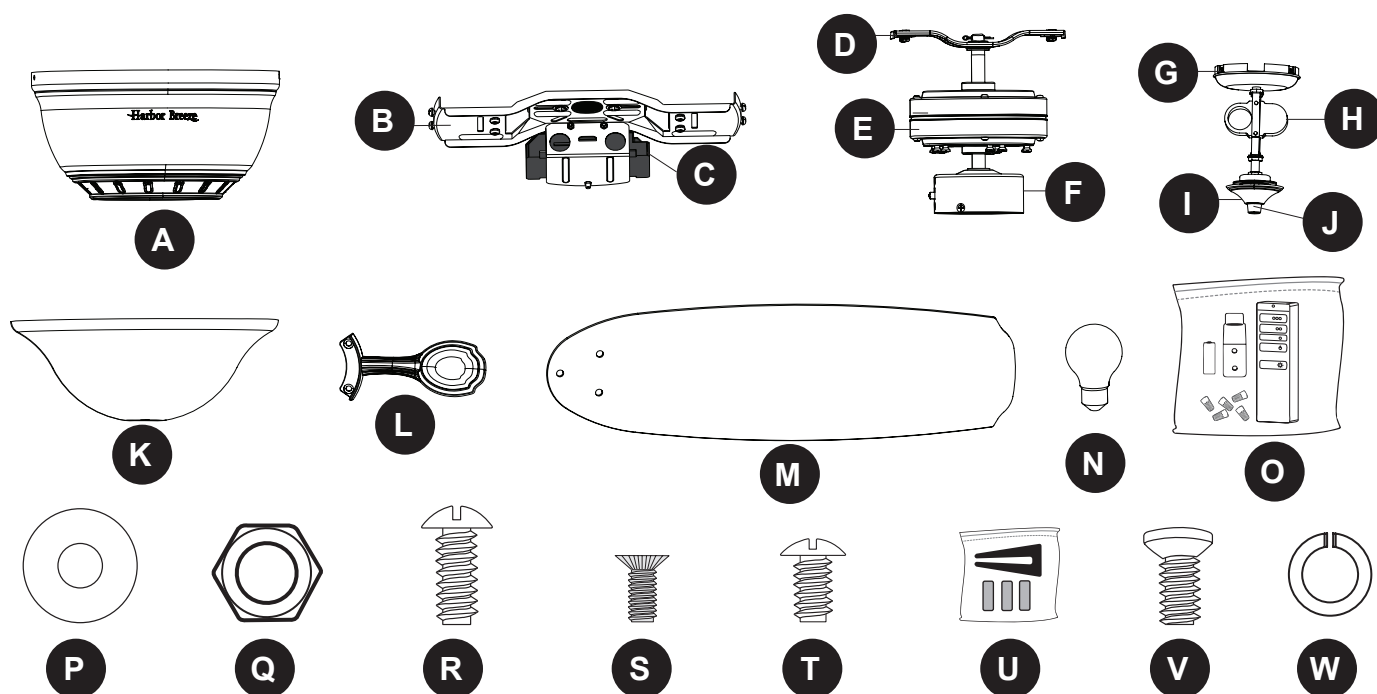

PART	DESCRIPTION	QUANTITY
A	Motor Housing	1
B	Upper Mounting Bracket	1
C	Receiver (preassembled to Upper Mounting Bracket [B])	1
D	Lower Mounting Bracket (preassembled to Motor [E])	1
E	Motor	1
F	Switch Housing (preassembled to Motor [E])	1
G	Switch Housing Cap (preassembled to Light Kit [H])	1
H	Light Kit	1
I	Finial Cap (preassembled to Light Kit [H])	1
J	Finial (preassembled to Light Kit [H])	1
K	Glass Shade	1
L	Blade Arm	5
M	Blade	5
N	Bulb	2
O	Remote Pack	1
P	Large Washer (preassembled to Light Kit [H])	1
Q	Hex Nut (preassembled to Light Kit [H])	1
R	Mounting Bracket Screw (preassembled to Lower Mounting Bracket [D])	4
S	Switch Housing Screw (preassembled to Switch Housing Cap [G])	3
T	Motor Housing Screw (preassembled to Upper Mounting Bracket [B])	4
U	Blade Balancing Kit	1
V	Motor Screw (preassembled to Motor [E])	10
W	Spring Washer (preassembled to Lower Mounting Bracket [D])	4

HARDWARE CONTENTS (shown actual size)

AA



Wire Connector
Qty. 2

BB



Blade Screw
Qty. 15
+ 1 extra

CC

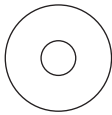

Blade Washer
Qty. 15
+ 1 extra

EE



Plug Button
Qty. 1

XX

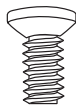

Motor Screw
1 extra



SAFETY INFORMATION

Please read and understand this entire manual before attempting to assemble, operate or install the product.

- Before you begin installing the fan, disconnect the power by removing fuses or turning off the circuit breakers.
- Make sure all electrical connections comply with local codes, ordinances, the National Electrical Code and ANSI/NFPA 70-199. Hire a qualified electrician or consult a do-it-yourself wiring handbook if you are unfamiliar with installing electrical wiring.
- Make sure the installation site you choose allows a minimum clearance of 7 ft. from the blades to the floor and at least 30 in. from the end of the blades to any obstruction.
- The net weight of this fan is: 14.55 lbs.



DANGER: When using an existing outlet box, make sure the outlet box is securely attached to the building structure and can support the full weight of the fan. Failure to do this can result in serious injury or death. The stability of the outlet box is essential in minimizing wobble and noise in the fan after installation is complete.



WARNING: To avoid personal injury, the use of gloves may be necessary while handling fan parts with sharp edges.



WARNING: Using a full-range dimmer switch to control fan speed will cause a loud humming noise from the fan. To reduce the risk of fire or electric shock, do NOT use a full-range dimmer switch to control the fan speed.



WARNING: To reduce the risk of fire, electric shock or personal injury, mount the fan to an outlet box marked “ACCEPTABLE FOR FAN SUPPORT” and use the mounting screws provided with the outlet box. Most outlet boxes commonly used for the support of lighting fixtures are not acceptable for fan support and may need to be replaced. Consult a qualified electrician if in doubt. Secure the outlet box directly to the building structure. The outlet box and its support must be able to support the moving weight of the fan (at least 35 lbs.).



WARNING: To reduce the risk of fire, electrical shock or personal injury, wire connectors provided with this fan are designed to accept only one 12-gauge house wire and two lead wires from the fan. If your house wire is larger than 12-gauge and there is more than one house wire to connect to the two fan lead wires, consult an electrician for the proper size wire connectors to use.



WARNING: To reduce the risk of fire, electric shock or personal injury, do not bend the blade arms when installing them, balancing the blades or cleaning the fan. Do not insert objects between the rotating fan blades.



WARNING: To reduce the risk of personal injury, use only parts provided with this fan. The use of parts OTHER than those provided with this fan will void the warranty.



SAFETY INFORMATION

CAUTION: Read all instructions and safety information before installing your new fan. Review the accompanying assembly diagrams.

CAUTION: Be sure the outlet box is properly grounded or that a ground (green or bare) wire is present.

CAUTION: Carefully check all screws, bolts and nuts on the fan motor assembly to ensure they are secured.

CAUTION: This equipment has been tested and found to comply with the limits for a Class B digital device, pursuant to Part 15 of the FCC Rules. These limits are designed to provide reasonable protection against harmful interference in a residential installation. This equipment generates, uses and can radiate radio frequency energy and, if not installed and used in accordance with the instructions, may cause harmful interference to radio communications. However, there is no guarantee that interference will not occur in a particular installation. If this equipment does cause harmful interference to radio or television reception, which can be determined by turning the equipment off and on. The user is encouraged to try to correct the interference by one or more of the following measures:

- Reorient or relocate the receiving antenna.
- Increase the separation between the equipment and receiver
- Connect the equipment into an outlet on a circuit different from that to which the receiver is connected.
- Consult the dealer or an experienced radio/TV technician for help.

Please note changes or modifications not expressly approved by the party responsible for compliance could void the user's authority to operate the equipment.

PREPARATION

Before beginning the assembly of this product, ensure all parts are present. Compare all parts with the package contents list and hardware contents list. If any part is missing or damaged, do not attempt to assemble the product.

Estimated Assembly Time: 120 minutes

Tools Required for Assembly (not included): Electrical Tape, Phillips Screwdriver, Pliers, Safety Glasses, Step Ladder, Wire Cutters and Wire Strippers

Helpful Tools (not included): AC Tester Light, Tape Measure and Wiring Handbook

INITIAL INSTALLATION

1. Turn off the circuit breakers and the wall switch to the fan supply line leads.

⚠ DANGER: Failure to disconnect the power supply prior to installation may result in serious injury or death.

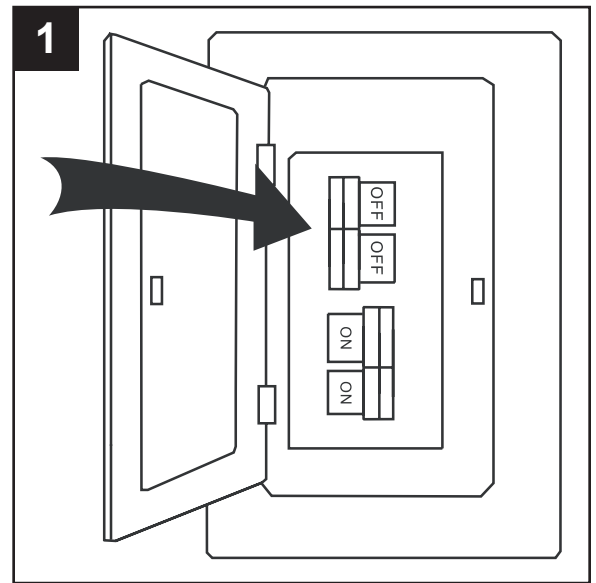

2. Ensure the blades (M) will be at least 30 in. from any obstructions and will be at least 7 ft. above the floor.

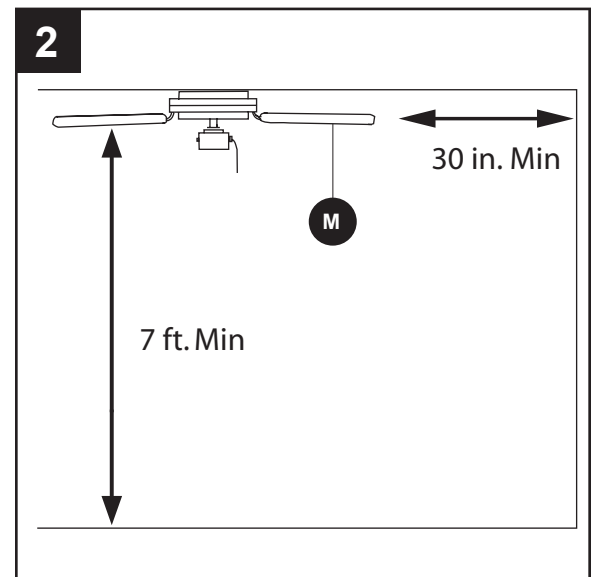

3. Secure the upper mounting bracket (B) to the outlet box (not included) using screws and washers provided with the outlet box.

CAUTION: It is very important that you use the proper hardware when installing the upper mounting bracket (B) as it will support the fan.

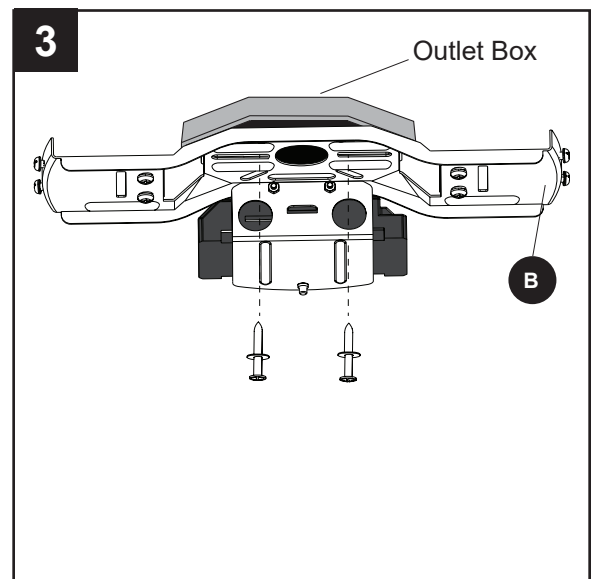

INITIAL INSTALLATION

⚠ WARNING: To reduce the risk of fire, electrical shock or personal injury, wire connectors provided with this fan are designed to accept only one 12-gauge house wire and two lead wires from the fan. If your house wire is larger than 12-gauge and/or there is more than one house wire to connect to the two fan lead wires, consult an electrician for the proper size wire connectors to use.

CAUTION: Be sure the outlet box is properly grounded or that a ground (green or bare) wire is present.

4. Using wire connectors (AA), connect wires from receiver (C) -- preassembled to upper mounting bracket (B) -- and house supply wires according to the diagram and these steps:

- Connect the red wire from receiver (C) to the black (hot) house supply wire.
- Connect the white wire with red label from the receiver (C) to the white (neutral) house supply wire.

Note: The remaining wires will be connected later in the installation process (page 10).

Hardware Used



Wire Connector



x 2

5. Wrap electrical tape (not included) around each individual wire connector (AA) down to the wire.

6. Turn the spliced/taped wires upward and gently push the wires and wire connectors (AA) into the outlet box.

WARNING: Ensure no bare wire or wire strands are visible after making connections.

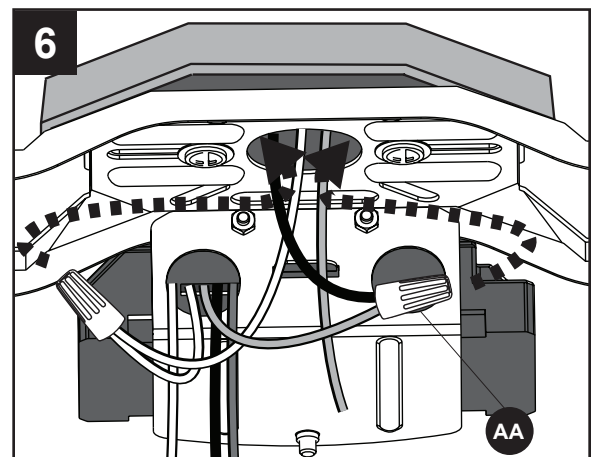
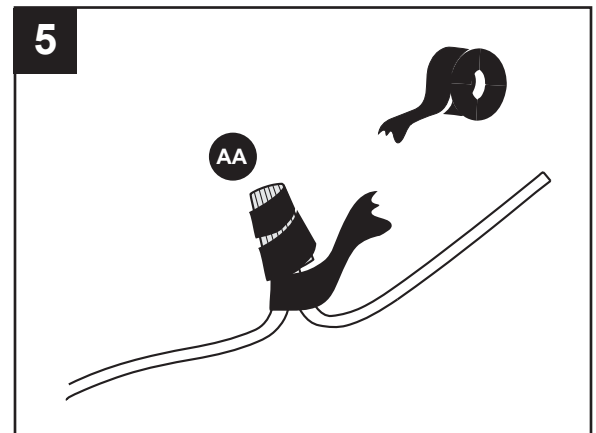
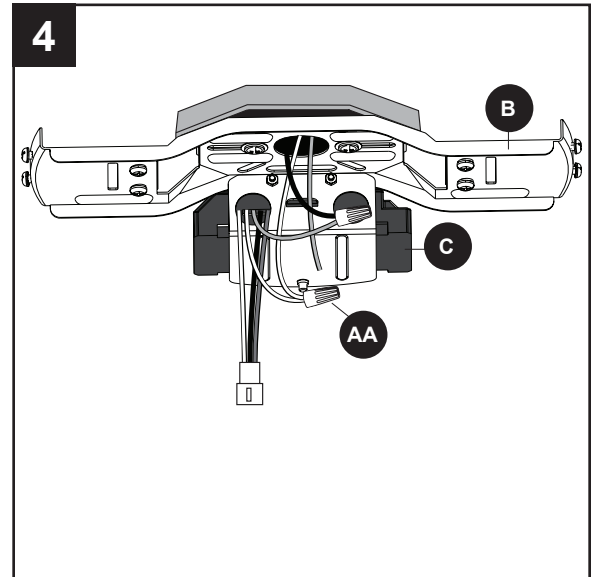

INITIAL INSTALLATION

7. Remove the mounting bracket screws (R) and spring washers (W) from underneath the lower mounting bracket (D). Also remove the motor screws (V) from the bottom of the motor (E). Retain for later use.

Note: Make sure to keep loose hardware separate to avoid confusion during installation.

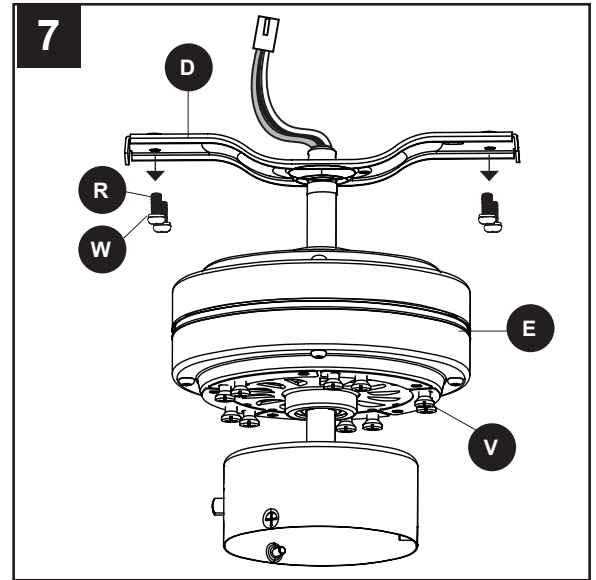

8. Place one tab of the lower mounting bracket (D) into a slot in the upper mounting bracket (B). Then slide the second tab of the lower mounting bracket (D) into the second slot on the upper mounting bracket (B) until all four holes are in alignment.

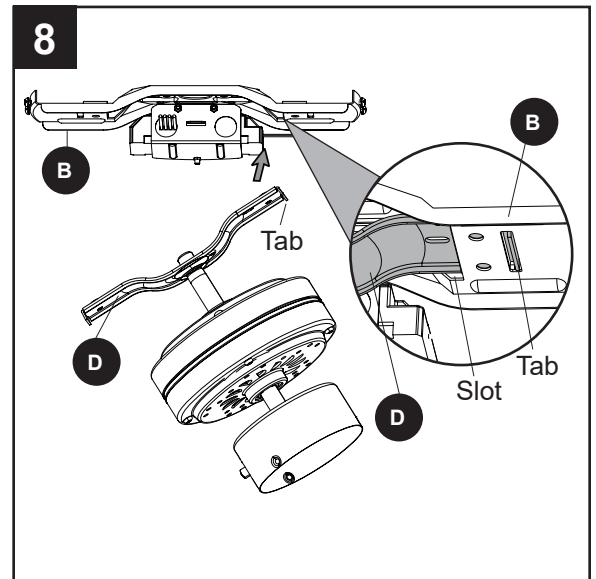

9. Re-install the previously removed mounting bracket screws (R) and spring washers (W) to secure the lower mounting bracket (D) and the upper mounting bracket (B).

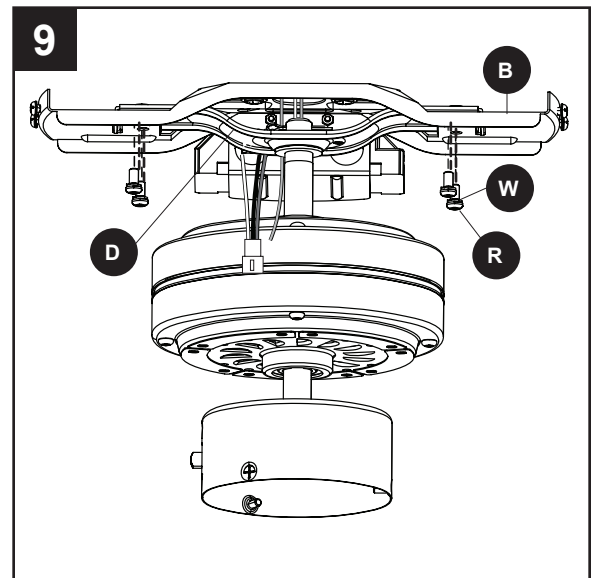

FAN WIRING

⚠ WARNING: To reduce the risk of fire, electrical shock or personal injury, wire connectors provided with this fan are designed to accept only one 12-gauge house wire and two lead wires from the fan. If your house wire is larger than 12-gauge and there is more than one house wire to connect to the two fan lead wires, consult an electrician for the proper size wire connectors to use.

CAUTION: Be sure the outlet box is properly grounded or that a ground (green or bare) wire is present.

1. Connect the remaining wires from the receiver (C), fan and house supply according to the diagram and these steps:

- Connect the green wire from the fan to the bare/green (ground) house supply wire using a wire connector from remote pack (O).
- Connect the wire harness from the receiver (C) to the wire harness from the fan.

Note: The green wire is the ground. If house wires are different colors than referred to above, it is recommended a professional electrician determines the proper wiring.

2. Wrap electrical tape around each individual wire connector from remote pack (O), down to the wire.

3. Turn the spliced/taped wires upward and gently push the wires and wire connectors into the outlet box. Then insert the connected wire harnesses in the space between the upper mounting bracket and the lower mounting bracket.

WARNING: Ensure no bare wire or wire strands are visible after making connections. Place the green and white wire connections on the opposite side of the outlet box from the black.

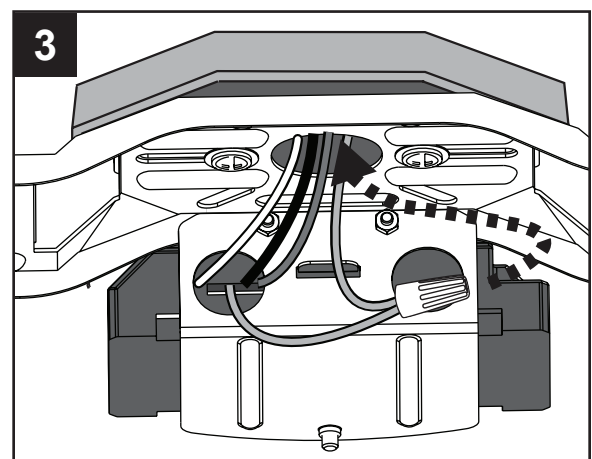
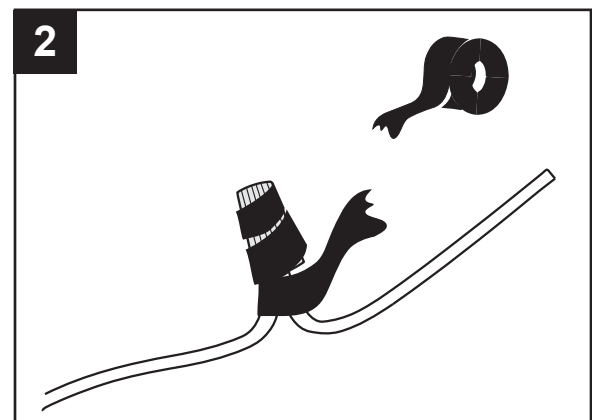
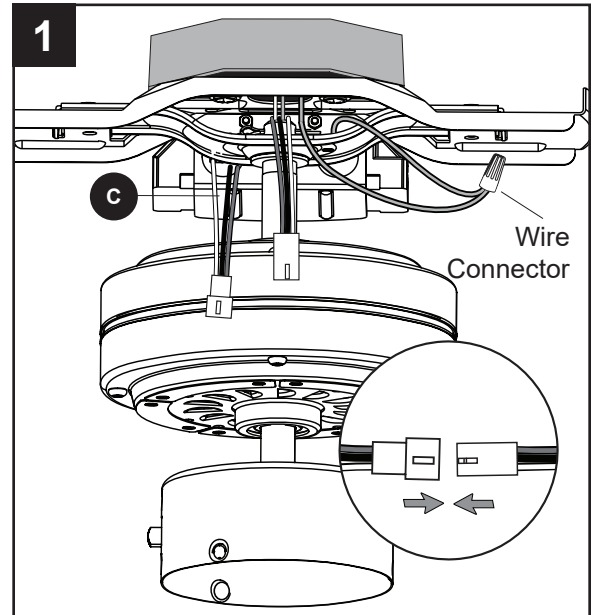

FINAL INSTALLATION

1. Temporarily lift the motor housing (A) to the upper mounting bracket (B) to determine which two motor housing screws (T) in the sides of the upper mounting bracket (B) align with the slotted holes in the top edge of the motor housing (A). Partially loosen the two motor housing screws (T) that align with the slotted holes. Remove the other two motor housing screws (T) from the upper mounting bracket (B).

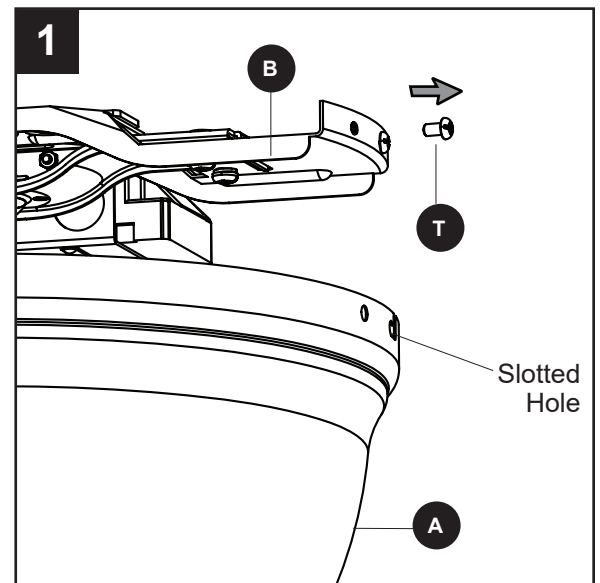

2. Slide the motor housing (A) over the motor (E), aligning the slotted holes in the motor housing (A) with the loosened motor housing screws (T) in the upper mounting bracket (B). Twist the motor housing (A) to lock. Then re-insert the two previously removed motor housing screws (T) and securely tighten all screws.

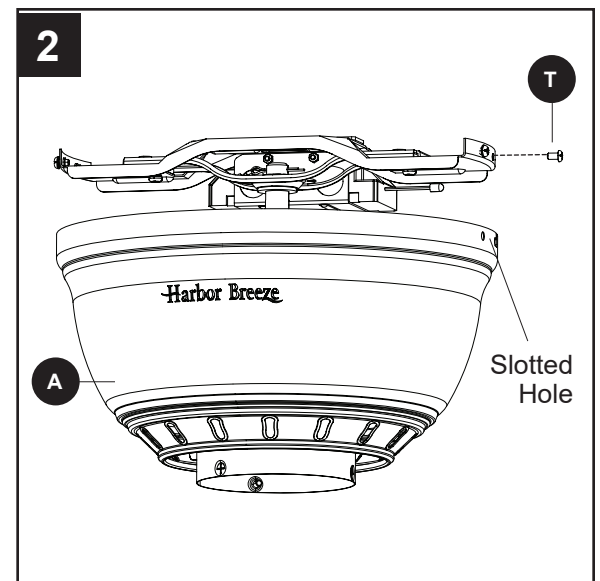

3. Partially insert the blade screws (BB) along with the blade washers (CC) through the blade (M) and into the blade arm (L). Tighten each blade screw (BB) with a Phillips screwdriver (not included), starting with the one in the middle. Repeat this step for the remaining blades (M) and blade arms (L).

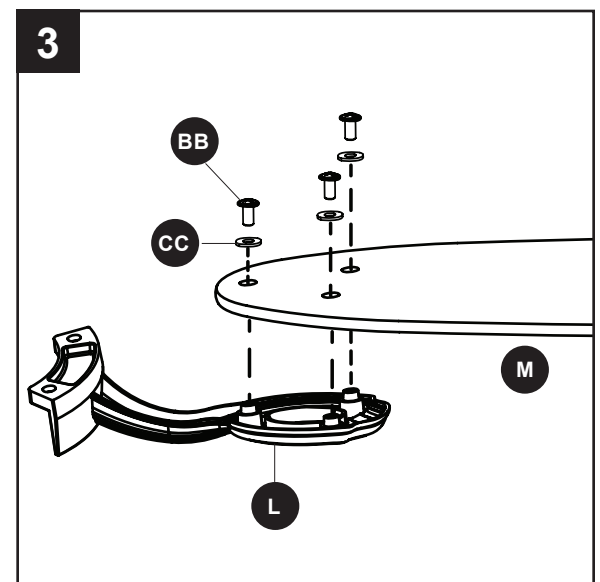

Hardware Used

BB	Blade Screw		x 15
CC	Blade Washer		x 15

FINAL INSTALLATION

4. Install the blade arm (L) to the underside of the motor (E) with motor screws (V) previously removed (Step 7, page 9). Tighten with Phillips screwdriver.
Repeat for each blade arm (L).

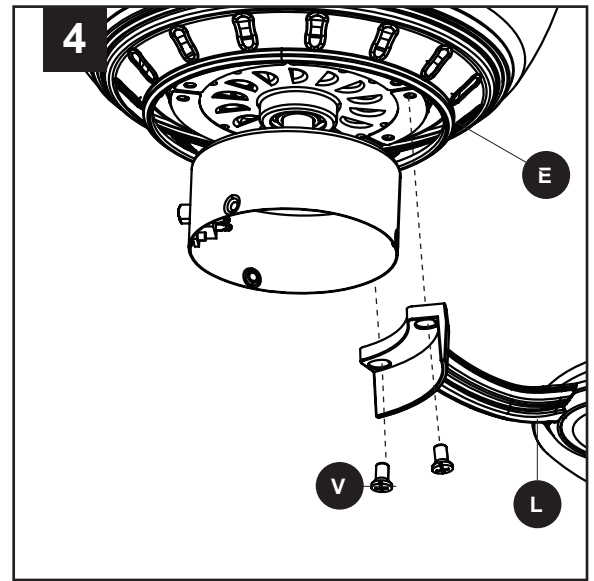

Note: If you wish to install the fan without the light kit, proceed to Step 10.

5. To install the light kit, first remove the switch housing screws (S) preassembled to the switch housing cap (G). Then, connect the single-pin connectors from the switch housing (F) and switch housing cap (G) -- blue to black and white to white.

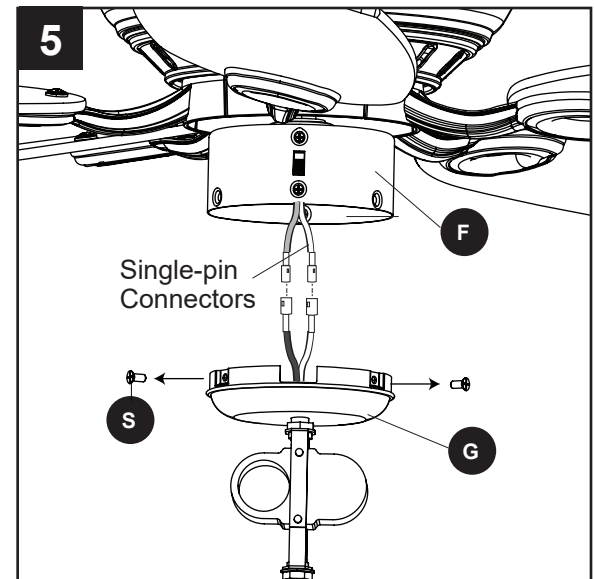

6. Align the notch in the switch housing cap (G) with the reverse switch located on switch housing (F). Then assemble the switch housing cap (G) with light kit (H) to the switch housing (F) using the previously removed switch housing screws (S).

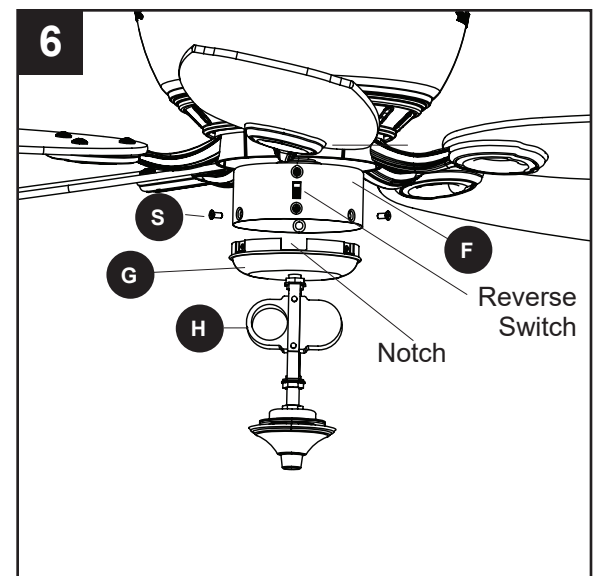

FINAL INSTALLATION

7. Install bulbs (N) into the sockets on the light kit (H).

Important: Make sure you allow the bulbs (N) and light kit (H) to cool before you replace the bulbs.

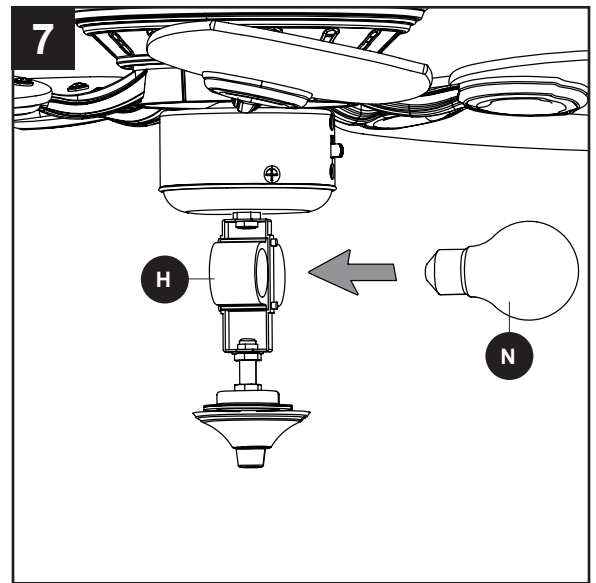

8. Remove the preassembled large washer (P), hex nut (Q), finial cap (I) and finial (J) from the light kit (H).

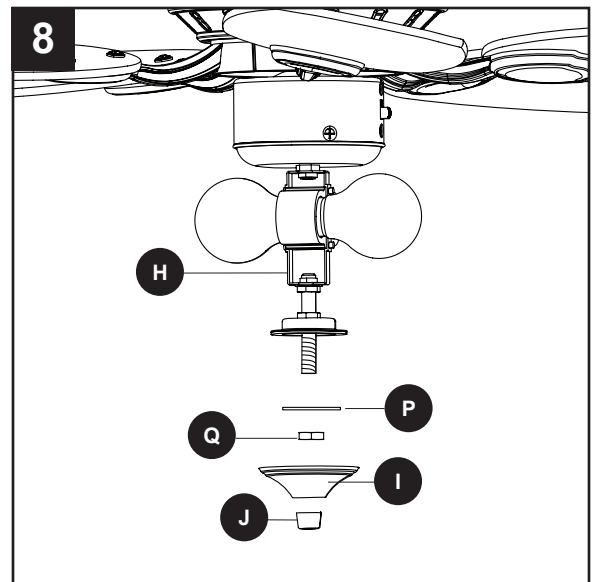

9. Lift the glass shade (K) onto the threaded rod at the bottom of the light kit (H). Re-install large washer (P) and secure with hex nut (Q). Lift the finial cap (I) onto the threaded rod and then screw the finial (J) onto the threaded rod to secure.

Proceed to Step 12.

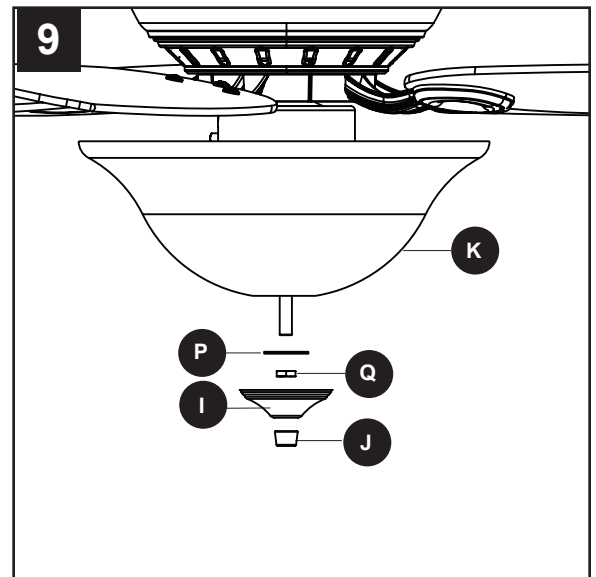

FINAL INSTALLATION

10. To install the fan without the light kit (H), remove the hex nut and lock washer from the rod on the inside of the switch housing cap (G). Remove light kit (H) from the switch housing cap (G) and discard, then install the plug button (EE) into the center hole of the switch housing cap (G).

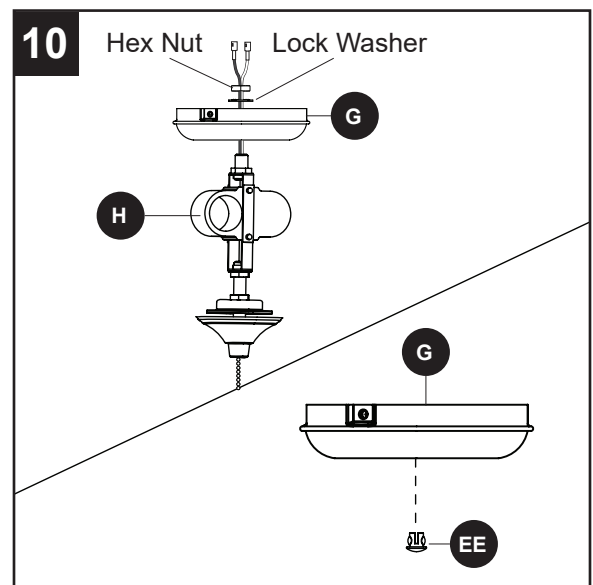

11. Remove the three switch housing screws (S) from the switch housing cap (G) and install the switch housing cap (G) onto the switch housing (F). Align the notch in the switch housing cap (G) with the reverse switch located on switch housing (F), then re-install the three switch housing screws (S).

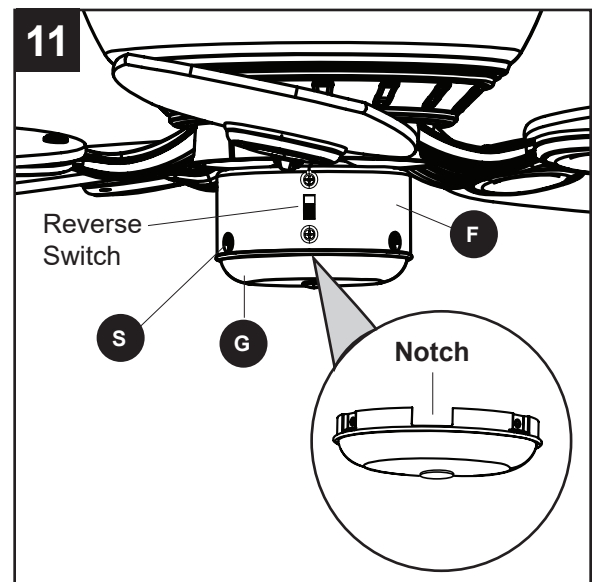

12. Turn on the power supply.

Assembly is complete.

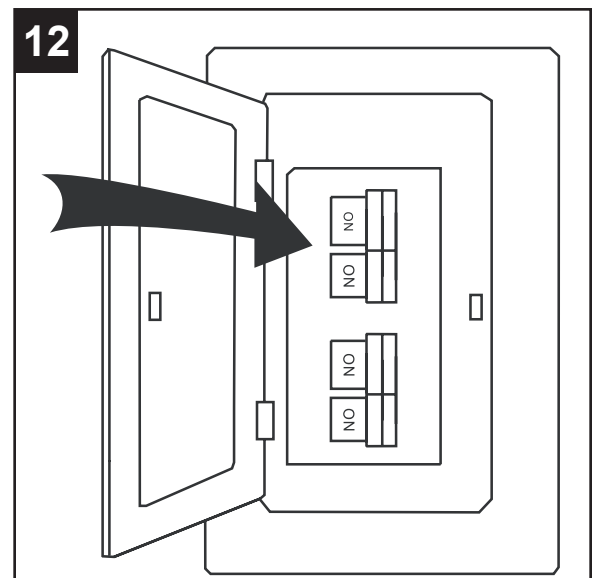

OPERATING INSTRUCTIONS

1. Remove the battery cover from the back of the remote found in remote pack (O). Insert the battery from remote pack (O) into the remote; ensure polarity of battery matches the polarity indicated in the battery compartment -- positive (+) to positive (+) and negative (-) to negative (-). Replace the battery cover and press the fan power button on the remote to ensure the LED indicator illuminates and the remote turns on the fan.

Note: If remote doesn't turn on the fan, see TROUBLESHOOTING (page 17).

2. To operate the fan using the remote, press and release the following buttons:

- 1 - High fan speed
- 2 - Medium fan speed
- 3 - Low fan speed
- 4 - Fan Power - Turns the fan off.

Light Delay Off mode - Press and hold the fan power button (4) for five seconds, which will turn off light after one minute. The LED indicator on the remote will flash four times to confirm mode setting.

- 5 - Light Control:

Incandescent Bulbs - Press light control to turn lights off and on. Press and hold light control to dim or brighten the lights.

CFL Bulbs - Turns the lights on and off. **Note:** The dimmer function does not work with CFL bulbs.

- 6 - D/CFL Switch: Switch should be set to "D" to correspond with the included LED, which will enable the dimming function. Flip to "CFL" if you change to corresponding bulbs.

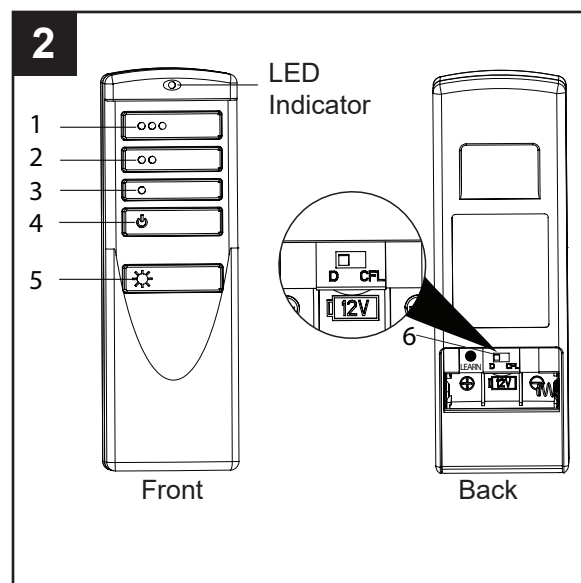
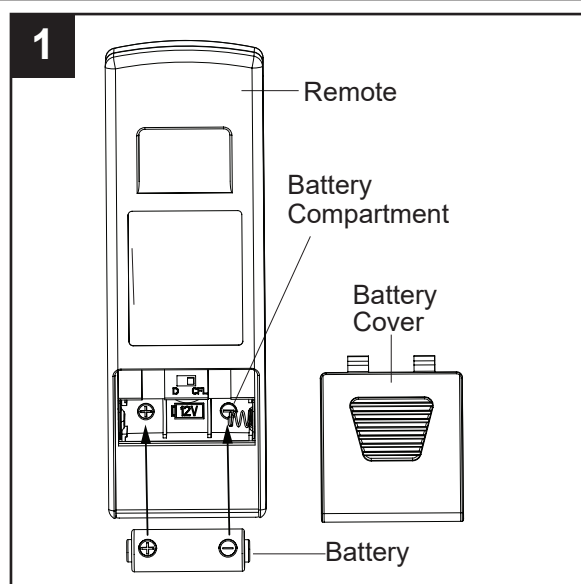

3. Using a ceiling fan will allow you to raise your thermostat setting in summer and lower your thermostat setting in winter without feeling a difference in your comfort. **Note:** Wait for the fan to stop before moving the reverse switch located on switch housing (F).

In warmer weather, push the reverse switch to the down to display a sun icon, which will result in downward airflow creating a wind chill effect (Fig. 3a).

In cooler weather, push the reverse switch to the up to display a snowflake icon, which will result in upward airflow that can help move hot air off the ceiling area (Fig. 3b).

Important: The reverse switch must be set either completely up or down in order for the fan to function correctly. If the reverse switch is set in the middle position, the fan will not operate (Fig. 3c).

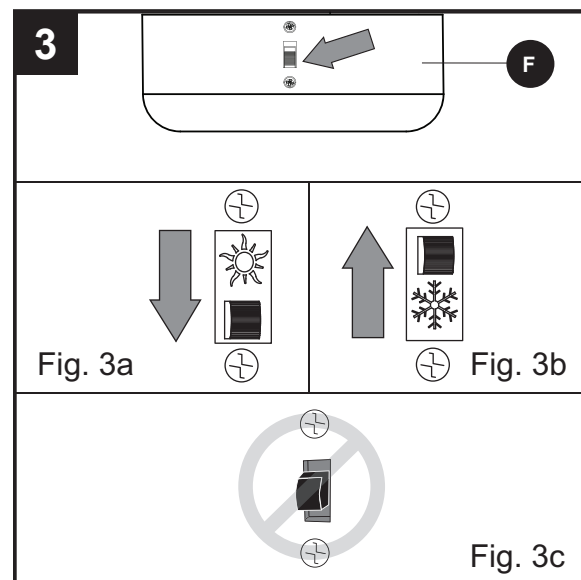

CARE AND MAINTENANCE

At least twice each year, tighten all screws on the fan. Clean the motor housing with only a soft brush or lint-free cloth to avoid scratching the finish.

Bulb Replacement: Use 60-watt max. E26-base LED, CFL or incandescent bulbs. Halogen bulbs are not recommended for this item.

Battery Replacement for Remote: Use A23 12-volt battery.

Important: Shut off the main power supply before you begin any maintenance tasks. Do not use water or a damp cloth to clean the ceiling fan.

TROUBLESHOOTING

PROBLEM	POSSIBLE CAUSE	CORRECTIVE ACTION
The fan does not move.	<ol style="list-style-type: none">1. The power is off or the fuse is blown.2. There is a faulty wire connection.3. The plugs are not connected properly.4. The reverse switch is not completely engaged.	<ol style="list-style-type: none">1. Turn the power on or check the fuse.2. Turn the power off. Loosen the canopy and check all connections.3. Check that the connectors from the light kit and fan are connected properly.4. Push the reverse switch completely to the left or right.
There is excessive wobbling.	<ol style="list-style-type: none">1. The blades and/or blade arms are loose.2. The blades are unbalanced.3. The fan mounting is not secure.	<ol style="list-style-type: none">1. Check and tighten all screws that hold the fan blades to the blade arms and the blade arms to the motor.2. Switch one blade with a blade from the opposite side. Or balance the fan using the blade balancing kit (U).3. Turn off the power. Loosen the motor housing and verify the upper mounting bracket is secure to the electrical outlet box. The bracket must be flush without movement against the outlet box.
The fan operates correctly, but the lights are not working.	<ol style="list-style-type: none">1. The bulbs are not installed correctly.2. The light kit wire plugs are not connected properly.3. There is a faulty wire connection.	<ol style="list-style-type: none">1. Re-install the bulb(s).2. Ensure the single-pin connectors in the light kit are connected properly.3. Turn the power off and check all connections at the ceiling outlet box.

TROUBLESHOOTING

PROBLEM	POSSIBLE CAUSE	CORRECTIVE ACTION
The fan is noisy.	<ol style="list-style-type: none">1. The blades are loose.2. There is a cracked blade.3. The outlet box is not secure.4. The mounting bracket is not secure.	<ol style="list-style-type: none">1. Check and tighten all screws that hold the fan blades to the blade arms and the motor.2. Replace the cracked blade.3. Ensure the outlet box is secured to the building structure.4. Ensure the mounting bracket is secured to the outlet box and that the screws are tight.
Remote doesn't work.	<ol style="list-style-type: none">1. LED indicator does not illuminate when remote button is pushed.2. The remote control is not synced with the fan's receiver.	<ol style="list-style-type: none">1. Replace the transmitter battery with a new 12-volt battery.2. Turn off the main power, then turn it back on. Within 30 seconds, press and hold the high and low speed buttons at the same time (or the LEARN button) on the remote for 5 seconds. Once complete, the fan will start on the low speed with the light (if applicable) off.

LIFETIME LIMITED WARRANTY

The manufacturer warrants this fan to be free from defects in workmanship and materials present at time of shipment from the factory for a lifetime from the date of purchase by the original purchaser. The retailer also warrants that all other fan parts, excluding any glass or plastic blades, to be free from defects in workmanship and material at the time of shipment from the factory for a period of one year after the date of purchase by the original purchaser. The manufacturer agrees to correct such defects without charge or at its option replace the ceiling fan with a comparable or superior model.

To obtain warranty service, present a copy of the receipt as proof of purchase. All costs of removing and reinstalling the product are your responsibility. Any damage to any part such as by accident or misuse or improper installation or by affixing any accessories, is not covered by this warranty. The manufacturer assumes no responsibility whatsoever for fan installation during the limited lifetime warranty. Any service performed by an unauthorized person will render the warranty invalid.

Due to varying climate conditions, this warranty does not cover any changes in brass finish, including rusting, pitting, corroding, tarnishing or peeling. Brass finishes of this type give their longest useful life when protected from varying weather conditions. Any glass provided with this fan is not covered by the warranty.

Any replacement of defective parts from the ceiling fan must be reported within the first year from the date of purchase. For the balance of the warranty, call our customer service department for return authorization and shipping instructions so that we may repair or replace the ceiling fan. Any fan or parts returned improperly is the sole responsibility of the purchaser. There is no other expressed warranty. The manufacturer disclaims any and all warranties. The duration of any implied warranty which cannot be disclaimed is limited to the time period as specified in the expressed warranty. The manufacturer shall not be liable for incidental, consequential, or special damages arising out of or in connection with product use or performance except as may otherwise be accorded by law. This warranty gives specific legal rights, and you may also have other rights which vary from state to state.

This warranty supersedes all prior warranties.

Note: A small amount of “wobble” is normal and should not be considered a defect.

REPLACEMENT PARTS LIST

For replacement parts, call the customer service department at 1-800-643-0067, 8 a.m. - 6 p.m., EST, Monday - Thursday, 8 a.m. - 5 p.m., EST, Friday.

PART	DESCRIPTION	#0803775	#0721899	#0807427
A	Motor Housing	4L000006910	4L000006890	4L000006900
B	Upper Mounting Bracket	4L000006930	4L000006940	4L000006920
G	Switch Housing Cap	4L000007050	4L000007040	4L000007060
H	Light Kit	4L000008930	4L000008930	4L000008930
I	Finial Cap	4L000007000	4L000006990	4L000004990
J	Finial	4L000007020	4L000007010	4L000005000
K	Glass Bowl	4L166190002	4L166190002	4L166190001
L	Blade Arm	4L073260002	4L073260001	4L073260000
M	Blade	4L084070002	4L084070001	4L084070000
O	Remote Pack	4L000007030	4L000007030	4L000007030
HW	Hardware Kit	4L000006980	4L000006970	4L000007080

