

Assembly Instruction

Item# 645-1X

Chamber Round End Table

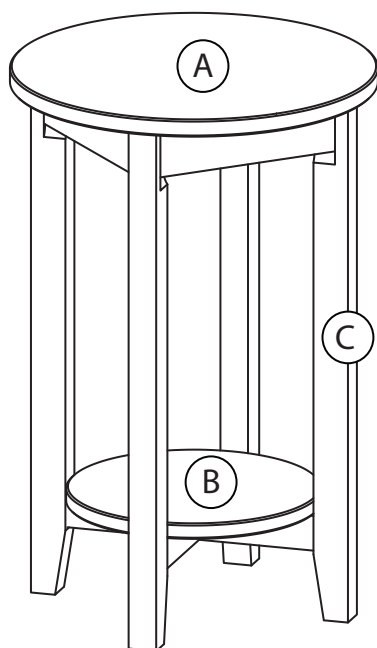

Parts List

No.	Description	Q'TY
A	Table Top	1 pc.
B	Shelf	1 pc.
C	Legs	4 pcs.

Hardware

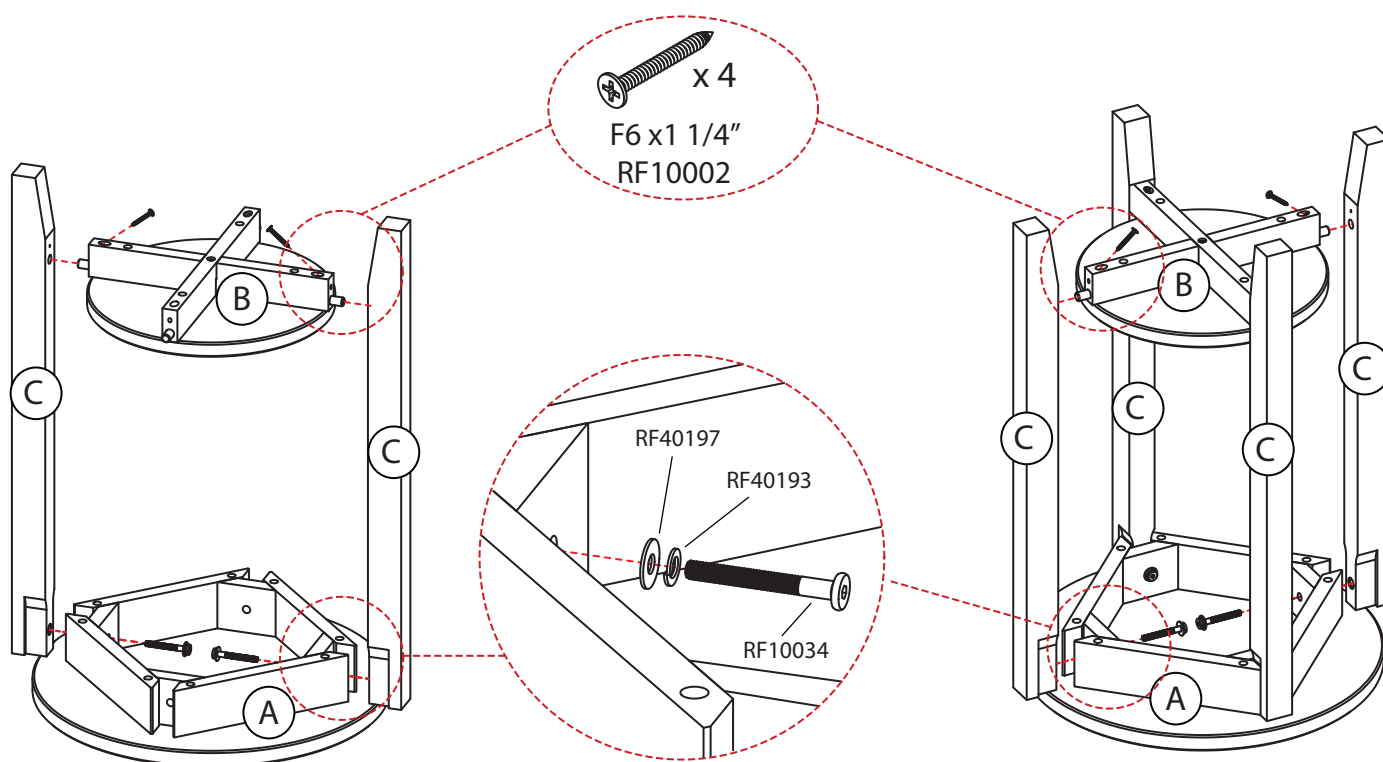
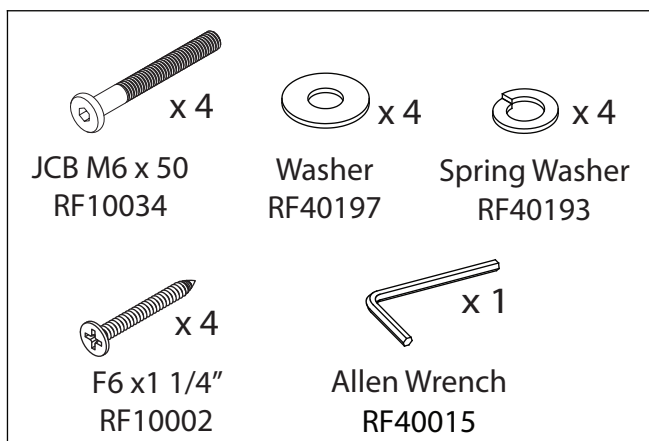

Tip: Pair legs facing each other in opposite directions when assembling.

Assemble the Table Top (A), Shelf (B), and legs (C) together.
 Connect (C) to (A) using screws (RF10034), washer (RF40197) and spring washer (RF40193).
 Connect (C) to (B) using screws (RF10002) as shown in the diagram.