

INSTRUCTION MANUAL

PREPARATION

Before installation, make sure all parts are present. If any part is missing or damaged, do not attempt to assemble, install or operate the product.

Estimated Assembly Time:10 Minutes

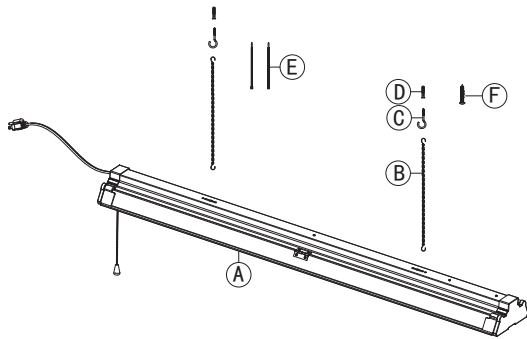

PACKAGE CONTENTS

PART	DESCRIPTION	QUANTITY
A	LED Shop light Fixture	1
B	Chains	2
C	Screw eye hook	2
D	Wall anchors	4
E	Cable ties	2
F	ST4*30 Screw	2

SAFETY INFORMATION

Please read and understand this entire manual before attempting to assemble, operate or install the product.

- ⚠️ A WARNING: RISK OF SHOCK**
House electrical current can cause painful shock or serious injury unless handled properly. For your safety, always remember to:
-Turn off the power at the fuse or circuit breaker box before you install the shop light.
- This shop light is designed for use in a circuit protected by a fuse or circuit breaker. This shop light is intended to be installed directly beneath a ceiling-mounted receptacle and any excess cord should be kept out of the workspace. It is also designed to be installed in accordance with local electrical codes. If you are unsure about your wiring, consult a qualified electrician or local electrical inspector, and consult your electrical code.
- Account for small parts and destroy packing material, as these may be hazardous to children.
- ⚠️ A WARNING: RISK OF INJURY**
Do not detach this product. No serviceable parts inside.
- A WARNING: RISK OF FIRE**
Most dwellings built before 1985 have a supply wire rated 60°C. Do not overload the circuit and wiring. Consult a qualified electrician.
- ⚠️ This device complies with part 15 of the FCC Rules. Operation is subject to the following 2 conditions:**
(1) This device may not cause harmful interference, and (2) this device must accept any interference received, including interference that may cause undesired operation. Note: This equipment has been tested and found to comply with the limits for a Class B digital device, pursuant to part 15 of the FCC Rules. These limits are designed to provide reasonable protection against harmful interference in a residential installation. This equipment generates, uses and can radiate radio frequency energy and, if not installed and used in accordance with the instructions, may cause harmful interference to radio communications. However, there is no guarantee that interference will not occur in a particular installation. If this equipment does cause harmful interference to radio or television reception, which can be determined by turning the equipment off and on, the user is encouraged to try to correct the interference by one or more of the following measures: Reorient or relocate the receiving antenna. Increase the separation between the equipment and receiver. Connect the equipment into an outlet on a circuit different from that to which the receiver is connected. Consult the dealer or an experienced radio/TV technician for help.

HANGING INSTALLATION

- Adjust both end covers so that the wings reach the appropriate lighting Angle (Max 150°) . **See Figure 1.**
- Install "J" hooks into ceiling (see warning below). (Recommend the 2 plastic wall anchors be used if mounting onto plaster board). **See Figure 2.**
⚠️ WARNING : "J" Hooks are for mounting onto wood ceiling or a plaster board surface(Recommend minimum 3/8" thick). Install each "J" hook (C) or other mounting/hook option exactly 21.5 inches apart. Check to make sure the hold is secure and appropriate for the weight of the shop light. Never hang on the shop light or hang any object from the shop light.
⚠️ WARNING: DO NOT INSTALL on radiant-heating ceilings.
⚠️ WARNING: These hooks are to engage the hanging chain only and not the electric cord.
- Slide the chain (B) through the openings on the top of the channel of the shop light assembly (A). With pliers crimp both ends of the hook at the end of a chain. Attach the chains (B) to the "J" hooks (C) or other hook type appropriate for your ceiling. After the shop light is hanging, check for secure mounting. **See Figures 3.**
- Plug shop light into 120V, 60Hz outlet using the grounded cord and plug. (The two cable ties can be used to secure excess cord to the hanging chain.)

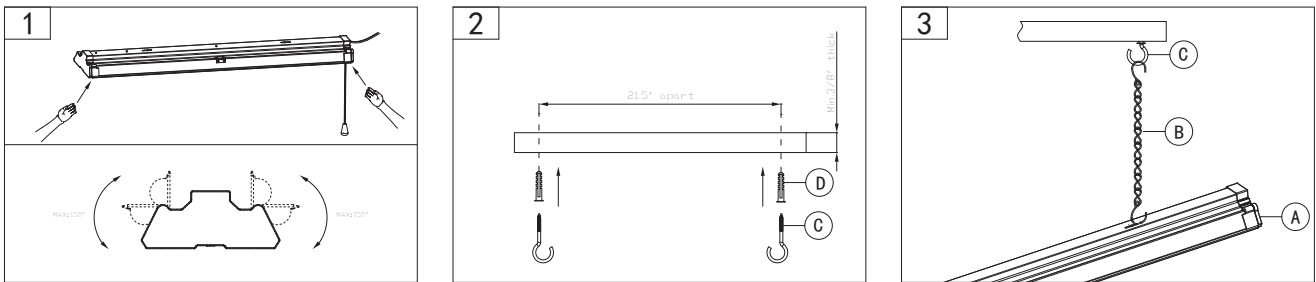

OPTIONAL FLUSH MOUNT INSTALLATION

- Adjust both end covers so that the wings reach the appropriate lighting Angle(Max 150°) . **See Figure 1.**
Install two screws (ST4*30 screws) on the mounting surface spaced 21.5 inches apart. Leave approximately 0.12" between the surface and screw. (Recommend the 2 plastic wall anchors be used if mounting onto plaster board). **See Figure 4.**
- Align shop light to the screws and slide to one side to secure it in place. The shop light should be firmly fixed against the screws. If not tight, continue to tighten the screws in the mounting shop light. **See Figure 5.**
- Plug shop light into 120V, 60Hz outlet using the grounded cord and plug.

