



Hinton

60" x 60" Skirted Acrylic Corner Air Bath

Model Number
6060HTA064
Skirted Air Bath in White

Features

- 20 high output later air jets
- Color-matched trim
- 12.0 Amp variable speed blower
- 2 Pillows included
- Constructed of high-gloss durable acrylic
- Integral skirt with built-in access panels
- Integral tile flange
- Automatic purge cycle with timer
- Slip resistant, textured floors
- Pre-leveled base for easy installation
- Made in the USA



All dimensions are +/- 1/2" and subject to change without notice
Confirm specifications before installation

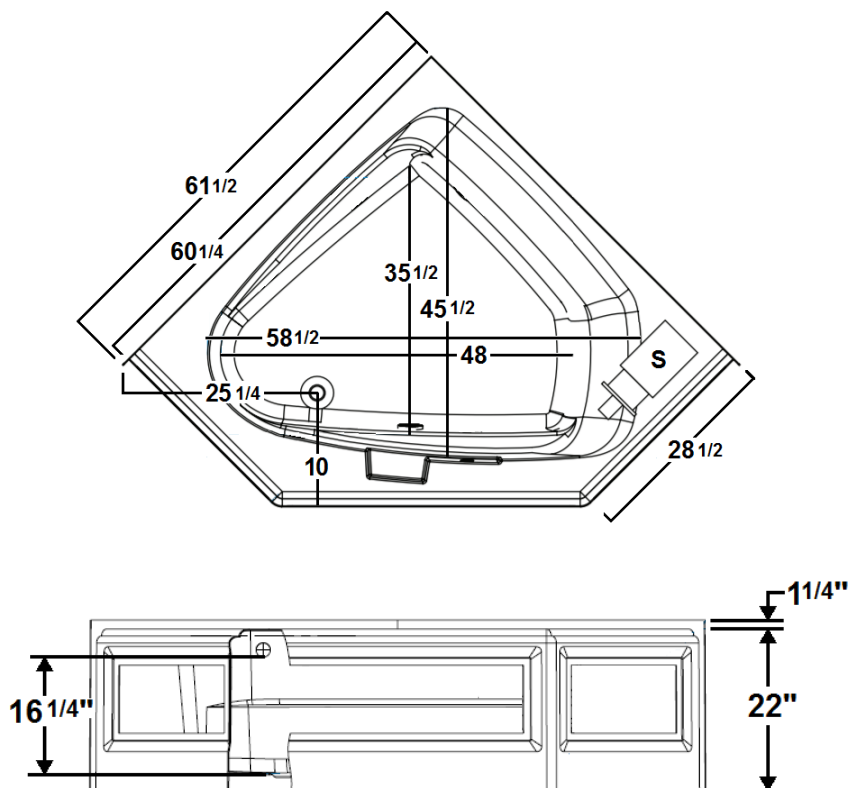

Technical Information

- Weight: 185 lbs.
- Water Depth to Overflow: 16 1/4"
- Operating Capacity: NA
- Water Capacity: 90 gal.
- Sump Dimension: 48" x 35 1/2"

Electrical Requirements.

- Standard Blower: 12 Amps
- 20amp, Dedicated GFCI's required