

5600 Modular Egress Window Well

Installs in a snap.

The 5600 offers many custom possibilities. You're not limited to a set height—make your well as short or as high as you need. A typical installation uses four sections and is made easy with simple, snap-together construction. The 5600 is designed for windows up to 4-foot wide. Each section weighs only 24 pounds and is easy to transport.

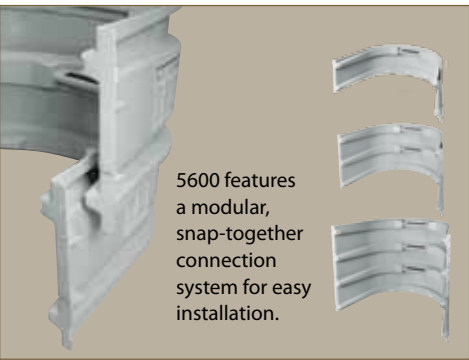

Sections	Total Height
1	20 $\frac{7}{8}$ "
2	34 $\frac{7}{8}$ "
3	48 $\frac{7}{8}$ "
4	62 $\frac{7}{8}$ "
5	76 $\frac{7}{8}$ "

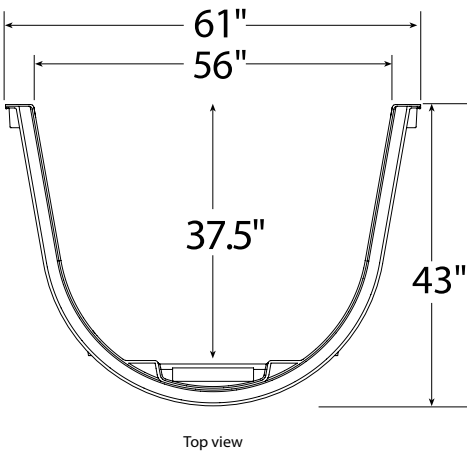
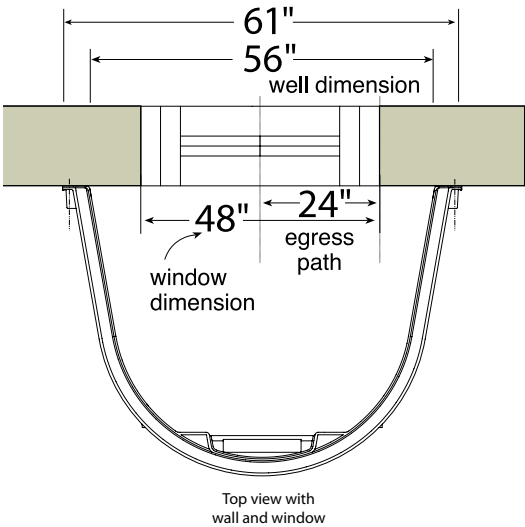
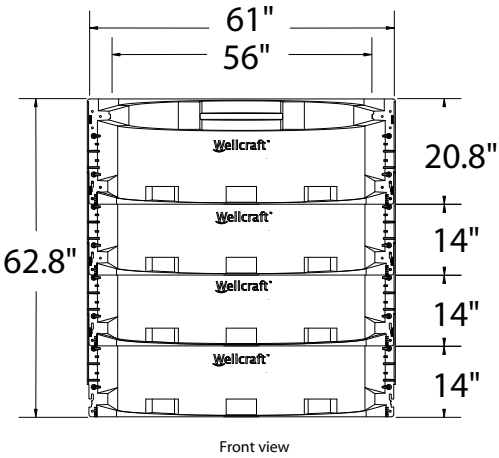

Wellcraft[®]
egress systems

888-812-9545
www.wellcraftwells.com

The Tapco[®]
GROUP
www.theTapcoGroup.com