

KOBALT®

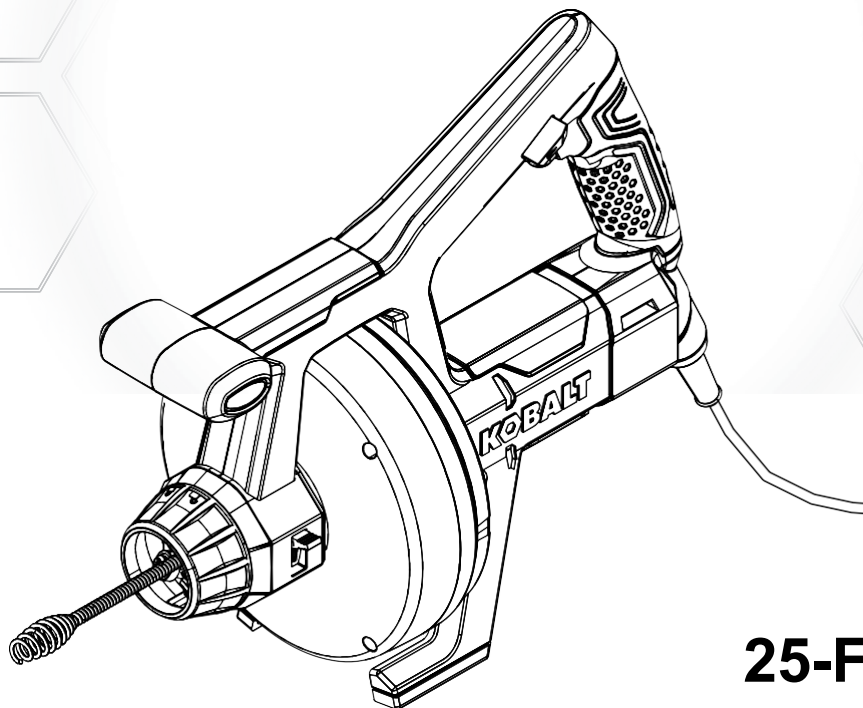

ITEM #4891703

KOBALT 25-FT CORDED AUTO-FEED DRAIN AUGER

MODEL #KDA100

KOBALT and logo design are trademarks
or registered trademarks of LF, LLC.
All rights reserved.

ATTACH YOUR RECEIPT HERE

Serial Number _____ Purchase Date _____



Questions, problems, missing parts? Before returning to your retailer, call our customer service department at 888-3KOBALT (888-356-2258), 8 a.m. - 8 p.m., EST, Monday - Sunday. You could also contact us at partsplus@lowes.com.

SC22422

TABLE OF CONTENTS

Product Specifications1

Package Contents1

Safety Information2

Preparation5

Operating Instructions.....6

Care And Maintenance9

PRODUCT SPECIFICATIONS

ITEM	VALUE
Minimum Pipe Diameter	¾ inch
Maximum Pipe Diameter	2 inches
Cable Length	25 ft. (22.5 ft. usable)
Cable Diameter	¼ inch
Rated Voltage (V)	120V, 60Hz
Rated Current (A)	3 Amp
Protection Class	Class II





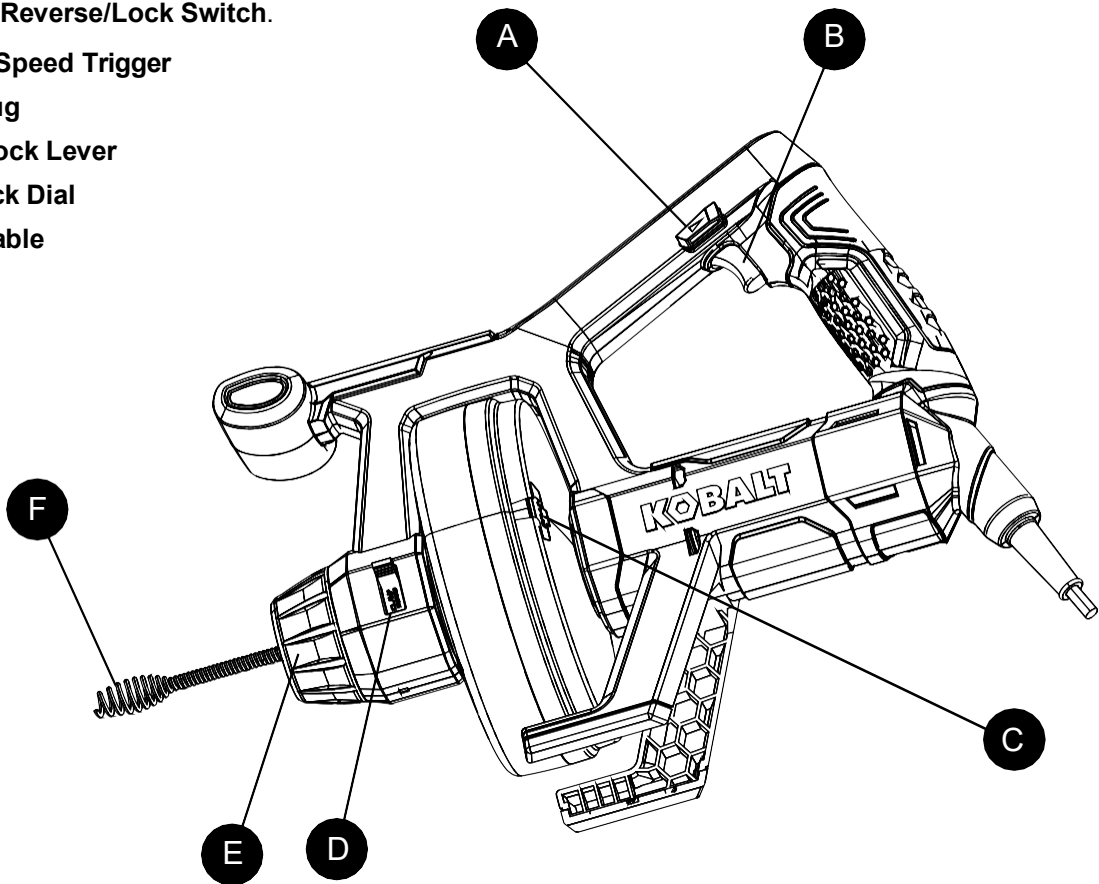

PACKAGE CONTENTS

Drain Auger Components

- A. Forward/Reverse/Lock Switch.
- B. Variable Speed Trigger
- C. Drain Plug
- D. Clamp Lock Lever
- E. Feed Lock Dial
- F. Auger Cable



SAFETY INFORMATION

SYMBOL	DEFINITION	SYMBOL	DEFINITION
	A danger, warning or caution, it means “Attention! Your safety is involved.”		To reduce risk of injury, user must read instruction manual.
	Keep hair and clothing away from rotating cable and drum.		Keep hands and body away from rotating drum.
	The product covered by this manual is a Class II tool.		Do not throw away electronic waste products. Such products must be delivered to a recycling center.

Please read and understand this entire manual before attempting to operate the product. Only use the Drain Auger in accordance with these instructions, for appropriate applications. Use of the Drain Auger for purposes other than those intended could result in a hazardous situation.

 **WARNING: Read all safety warnings, instructions, illustrations, and specifications provided with this power tool.** Failure to follow all instructions listed below may result in electric shock, fire and/or serious injury.

Save all warnings and instructions for future reference

The term “power tool” in the warnings refers to your mains-operated (corded) power tool.

Work Area Safety

- **Keep work area clean and well lit.** Cluttered or dark areas invite accidents.
- **Do not operate power tools in explosive atmospheres, such as in the presence of flammable liquids, gases, or dust.** Power tools create sparks, which may ignite the dust or fumes.
- **Keep children and bystanders away while operating a power tool.** Distractions can cause you to lose control.

Electrical Safety

- **Power tool plugs must match the outlet. Never modify the plug in any way. Do not use any adapter plugs with earthed (grounded) power tools.** Unmodified plugs and matching outlets will reduce the risk of electric shock.
- **Avoid body contact with earthed or grounded surfaces such as pipes, radiators, ranges and refrigerators.** There is an increased risk of electric shock if your body is earthed or grounded.
- **Do not expose power tools to rain or wet conditions.** Water entering a power tool will increase the risk of electric shock.
- **Do not abuse the cord. Never use the cord for carrying, pulling or unplugging the power tool. Keep cord away from heat, oil, sharp edges or moving parts.** Damaged or entangled cords increase the risk of electric shock.
- **When operating a power tool outdoors, use an extension cord suitable for outdoor use.** Use of a cord suitable for outdoor use reduces the risk of electric shock.



SAFETY INFORMATION

- **If operating a power tool in a damp location is unavoidable, use a residual current device (RCD) protected supply.** Use of an RCD reduces the risk of electric shock. The device must be operated via a residual current device (RCD) with a rated tripping current of no more than 10 mA in order to avoid hazards.

NOTE: The term “residual current device (RCD)” may be replaced by the term “ground fault circuit interrupter (GFCI)” or “earth leakage circuit breaker (ELCB)”.

Personal Safety

- **Stay alert, watch what you are doing and use common sense when operating a power tool. Do not use a power tool while you are tired or under the influence of drugs, alcohol or medication.** A moment of inattention while operating power tools may result in serious personal injury.
- **Use personal protective equipment. Always wear eye protection with side shields compliant with the requirements of ANSI Z87.1.** Protective equipment such as a dust mask, non-skid safety shoes, hard hat or hearing protection used for appropriate conditions will reduce personal injuries.
- **Prevent unintentional starting. Ensure the switch is in the off-position before connecting to power source and/or battery pack, picking up or carrying the tool.** Carrying power tools with your finger on the switch or energizing power tools that have the switch on invites accidents.
- **Remove any adjusting key or wrench before turning the power tool on.** A wrench or a key left attached to a rotating part of the power tool may result in personal injury.
- **Do not overreach. Keep proper footing and balance at all times.** This enables better control of the power tool in unexpected situations.
- **Dress properly. Do not wear loose clothing or jewelry. Keep your hair, clothing, and gloves away from moving parts.** Loose clothes, jewelry or long hair can be caught in moving parts.
- **If devices are provided for the connection of dust extraction and collection facilities, ensure that these are connected and properly used.** Use of dust collection can reduce dust-related hazards.
- **Do not let familiarity gained from frequent use of tools allow you to become complacent and ignore tool safety principles.** A careless action can cause severe injury within a fraction of a second.

Power tool use and care

- **Do not force the power tool. Use the correct power tool for your application.** The correct power tool will do the job better and safer at the rate for which it was designed.
- **Do not use the power tool if the switch does not turn it on and off.** Any power tool that cannot be controlled with the switch is dangerous and must be repaired.
- **Disconnect the plug from the power source and/or remove the battery pack, if detachable, from the power tool before making any adjustments, changing accessories, or storing power tools.** Such preventive safety measures reduce the risk of starting the power tool accidentally.
- **Store idle power tools out of the reach of children and do not allow persons unfamiliar with the power tool or these instructions to operate the power tool.** Power tools are dangerous in the hands of untrained users.
- **Keep cutting tools sharp and clean.** Properly maintained cutting tools with sharp cutting edges are less likely to bind and are easier to control.



SAFETY INFORMATION

- **Maintain power tools and accessories. Check for misalignment or binding of moving parts, breakage of parts and any other condition that may affect the power tool's operation. If damaged, have the power tool repaired before use.** Many accidents are caused by poorly maintained power tools.
- **Use the power tool, accessories, and tool bits, etc. in accordance with these instructions, taking into account the working conditions and the work to be performed.** Use of the power tool for operations different from those intended could result in a hazardous situation.
- **Keep handles and grasping surfaces dry, clean and free from oil and grease.** Slippery handles and grasping surfaces do not allow for safe handling and control of the tool in unexpected situations.

Drain Auger service

- **Have your power tool serviced by a qualified repair person using only identical replacement parts.** This will ensure that the safety of the power tool is maintained.

Drain Auger safety guidelines

- **Before using the tool, test the residual current device (RCD) provided with the supply cord to ensure it is operating properly.** A properly operating RCD reduces the risk of electrical shock.
- **Only use extension cords that are protected by an RCD.** The RCD on the machine power cord will not prevent electrical shock from the extension cord.

NOTE: It is possible to replace the term “residual current device (RCD) with the term “ground fault circuit interrupter (GFCI)” or “earth leakage current breaker (ELCB)”.

- **Only grasp the rotating cable with gloves recommended by the manufacturer.** Latex or loose-fitting gloves or rags can become wrapped around the cable and may result in serious personal injury.
- **Do not allow the cutter to stop turning while the cable is turning.** This can overstress the cable and may cause twisting, kinking, or breaking of the cable and may result in serious personal injury.
- **Use latex or rubber gloves inside the gloves recommended by the manufacturer. Goggles, face shields, protective clothing, and a respirator should be used when chemicals, bacteria, or other toxic or infectious substances are suspected to be in a drain line.** Drains may contain chemicals, bacteria, and other substances that may cause burns, be toxic or infectious, or may result in other serious personal injury.
- **Practice good hygiene. Do not eat or smoke while handling or operating the tool. After handling or operating drain cleaning equipment, use hot, soapy water to wash hands and other body parts exposed to drain contents.** This will help reduce the risk of health hazards due to exposure to toxic or infectious material.
- **Only use the drain cleaner for the recommended drain sizes.** Using the wrong size drain cleaner can lead to twisting, kinking, or breaking of the cable and may result in personal injury.
- **Use appropriate personal protective equipment (PPE) when using the Drain Auger including snug fitting leather gloves with latex or rubber gloves inside, non-skid protective footwear, and other PPE, as appropriate.**
- **Ensure that the power switch is OFF before connecting the power cord to a power source, picking up or carrying the tool.** Avoid inadvertently touching the power switch to avoid accidents.



SAFETY INFORMATION

- **Do not place your hand near the drum or the cable during operation.** Serious injuries can result from contact with the drum or cable.
- **Fluids inside clogged drains may be contaminated with cleaning solutions, drain cleaners, bacteria or other potentially harmful substances.** Avoid contact with these fluids by using appropriate PPE including gloves and eye protection. Clean your hands or any other parts of your body that may have been exposed to harmful fluids thoroughly with warm, soapy water once operations have been completed.
- **Exercise caution when withdrawing the end of the auger cable from the drain. Pulling the cable out of the drain too quickly can cause it to whip back toward the operator, possibly causing injury.** Remove the cable very slowly to avoid potential injury or possibly splashing the operator with contaminated water.
- **The drum may continue to rotate for a few seconds once the trigger is released.** Let the drum come to a complete stop before touching the drum, cable, or any of the actuators.
- **For safety, position the Drain Auger near the drain or inlet being cleared (typically 4 to 6 inches).** Operating the Drain Auger at a distance from the drain can result in the cable twisting or binding and create a safety hazard.
- **Avoid any actions or situations where the cable will twist, kink or build up tension. Over-stressing the cable can result in injuries due to unpredicted cable actions.** If you suspect the cable may be becoming overstressed, turn the Drain Auger off immediately. Take actions to eliminate stress on the cable until the twist or buckle has been eliminated.

Drain Auger Precautions

- Do not run the Drain Auger in reverse for long periods of time. Damage to the auger cable can result.
- When retracting the cable with the Feed Lock Dial in the locked position, release the trigger or slow the rotation of the drum well before the end of the cable bulb reaches the bearings (allow several inches) to ensure the bulb head is not accidentally fed into the bearings. Damage to the unit can occur.
- Running the tool in reverse with the Feed Lock Dial locked, while in a clog or with the cable bound can cause damage to the cable.
- Ensure the rubber drain plug is fully inserted in the drum, so that it is flush with the outside of the drum before use. If the tabs of the drain plug protrude from the drum housing, it could contact the Drain Auger housing during rotation and damage or dislodge the rubber tab.
- The Drain Auger is designed to clear common clogs from pipes. It is NOT intended to remove tree roots from pipes. Attempting to remove tree roots can result in injury and/or damage to the Drain Auger, and will void the warranty.
- Do not modify the Drain Auger for any use other than as described in this manual. Modifications or other improper use can result in injury and/or damage to the Drain Auger and will void the warranty.

PREPARATION

Before using the Drain Auger, make sure all parts are present. Inspect the unit for any damage that may have occurred during shipment. If any part is missing or damaged, do not use the unit and refer to the notice on the cover of this manual for instructions.

OPERATING INSTRUCTIONS

Forward/Reverse/Lock Switch

Toggles the direction that the cable feeds between forward and reverse. In the center position it locks the trigger to prevent inadvertent operation.

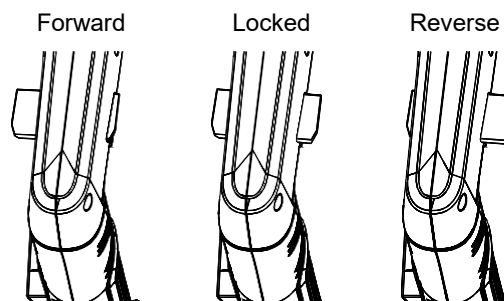

Variable Speed Trigger

Pull the Variable Speed Trigger (B) to rotate the cable and feed or retract the cable, depending on the position of Forward/Reverse/Lock switch. Pulling the trigger farther increases the speed of rotation. The action of the Drain Auger will vary depending on the setting of the Feed Lock Dial (E). If the Feed Lock Dial is locked, the cable will rotate and feed/retract simultaneously when the trigger is pulled. If the Feed Lock Dial is unlocked, the cable will rotate but it will not feed/retract when the trigger is pulled.

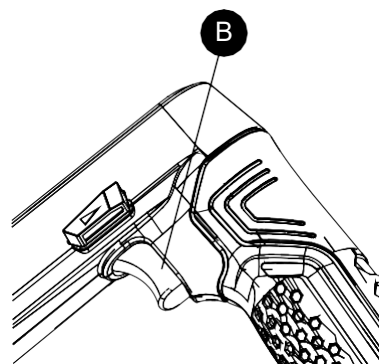

Clamp Lock Lever

The Clamp Lock Lever (D) Locks the cable, preventing it from feeding in or out of the drum. Viewing from the front of the unit, rotate the Clamp Lock Lever clockwise to unlock it, and counter-clockwise to lock it. When locked you can see the CLAMP ENGAGED text on the side of the lever.

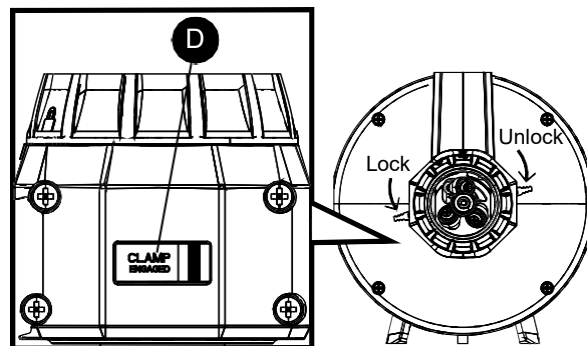

Feed Lock Dial

When the Feed Lock Dial (E) is locked, the auger rotates and the cable feeds or retracts when the trigger is activated. When unlocked the cable can be freely fed in and out of the drum by hand.

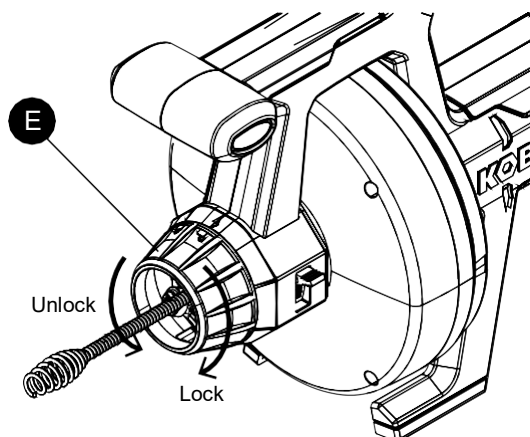

Auger Function Quick Reference Table

FUNCTION	FEED LOCK DIAL	CLAMP LOCK LEVER	FWD/REV/LOCK SWITCH	VAR. SPEED TRIGGER
Advance/Retract Cable Manually	Unlock	Unlock	Center lock	Off
Advance Cable with Auto-Feed	Lock	Unlock	Forward	Pulled
Clear Clog with cable locked	Unlock	Lock	Forward	Pulled
Retract Cable with Auto-Feed	Lock	Unlock	Reverse	Pulled

Before Use

- Ensure the tool is unplugged.
- Inspect the cable and plug to ensure they are not damaged.
- Check the Drain Plug to ensure it is properly installed in the drum and flush with the drum housing. If the Drain Plug is not flush with the drum housing, it may become dislodged during operation.
- Inspect the tool to ensure there are no damaged parts that may pose a safety threat.
- Clean and lubricate the cable between each use as specified in the Care and Maintenance section of this manual.
- Ensure handles and grasping surfaces are dry, clean and free from oil and grease.
- Inspect the Auger Cable to ensure it is not excessively worn, deformed, bent, corroded, or damaged in any way. Damaged cables should be immediately replaced. Replacement cables are available at lowes.com.
- Check to ensure the cable is securely connected to the tool to ensure the cable will not become damaged during use.
- Check the workplace to ensure there is sufficient lighting, no flammable liquid, gas or dust.
- Do not point the sharp end of the cable towards yourself or other people.
- Insert the plug into the outlet and confirm the drain auger can easily reach the pipe opening without placing tension on the cord. If needed, use an extension cord suitable for outdoor use per the Safety Information section of this manual.

NOTE: When using the tool outdoors, use an extension cord marked with “W-A” or “W” to ensure the wire insulation layer is of sufficient thickness.

CAUTION!

Never operate the Drain Auger with both the Clamp Lock Lever (D) and the Feed Lock Dial (E) both locked. This can damage the cable and/or the motor.

Operating Procedures

The following steps provide a guide for using the Drain Auger to clear a typical drain clog. Different situations may call for a different approach to a particular clog.

1. Make sure the Forward/Reverse/Lock Switch (A) is in the locked (center) position.
2. Place the Clamp Lock Lever (D) in the unlocked position. **NOTE:** The lever reads CLAMP ENGAGED when locked and there is no visible text when unlocked.
3. Plug the Drain Auger into a power outlet. Observe all safety precautions in this manual.
4. Position the Drain Auger near the drain opening.
5. Rotate the Feed Lock Dial (E) to the unlocked position.
6. Pull out enough cable by hand to place the auger end of the cable into the drain opening.
7. Rotate the Feed Lock Dial (E) to the locked position.
8. Push the Forward/Reverse/Lock switch (A) to the forward position (to the left as viewed from above).

CAUTION!

Proceed slowly and with caution when advancing the cable through a P-trap or other significant bend in the piping. Advancing the cable too fast can cause it to kink, twist, or bend and possibly damage the cable.

9. Pull the Variable Speed Trigger (B) back to begin feeding the auger cable into the drain.

NOTE: The farther you pull the trigger, the faster the auger will turn and feed into the drain.

NOTE: Alternately, the cable can be fed manually (by hand) by placing the Feed Lock Dial and Clamp Lock Lever in the unlocked positions and the Forward/Reverse/Lock switch in the locked (center) position. Reference the table above.

10. Continue to feed the cable until the clog is reached.

CAUTION: Do not allow the cable to build up tension as you reach and attempt to push through the clog. Force feeding the cable into a tough clog can cause the cable to kink, twist, bend, or break. If the cable becomes overstressed, slowly retract the cable until the tension is released.

11. If necessary, you can attempt to clear the clog by manually pushing and pulling as follows:

- a. Stop operation and set the Forward/Reverse/Lock switch (A) to the locked (center) position.

NOTE: It is important to set the Feed Lock Dial (E) to the unlocked position before engaging the Clamp Lock Lever (D) to prevent damage to the Drain Auger.

- b. Set the Feed Lock Dial (E) to the **unlocked** position.
 - c. Rotate the Clamp Lock Lever (D) to the CLAMP ENGAGED locked position.
 - d. Place the Forward/Reverse/Lock switch in the Forward position, pull the Variable Speed Trigger (B) then push and pull the Drain Auger and cable forward and back to dislodge the clog.
 - e. When you feel the clog dislodge, unlock the Clamp Lock Lever (D) and resume operation.
12. When the clog is freed, set the Forward/Reverse/Lock switch (A) to the reverse position (to the right as viewed from above), and pull the Variable Speed Trigger (B) to retract the cable and pull the clog out of the drain.

NOTE: Alternately, the cable can be retracted manually (by hand) by placing the Feed Lock Dial and Clamp Lock Lever in the unlocked positions and the Forward/Reverse/Lock switch in the locked (center) position. Reference the table above.

13. Repeat the process as necessary until the drain is cleared.
14. When finished, pull open the Drain Plug (C) and drain any water from the drum into the drain or a suitable container. Water, sediment, and debris can corrode the cable.
15. Refer to “NOTE: Cable is not attached to the inner drum. Use care to track the cable towards the end of the usable length to ensure it does not come out of the drum. If the cable is extended past the end of the usable length, it may be necessary to manually retract the cable by hand back into the drum a few inches before Auto-Feed can be used again. Refer to the Auger Function Quick Reference Table to ensure the Feed Lock Dial and Clamp Lock Lever are placed in the correct positions.” on page 9 and clean the Drain Auger and cable.

Cable Depth Markings

The Drain Auger has a unique feature that helps you determine the location of the clog. The cable has black marks at each 5-foot segment. These marks can be helpful for tracking how much cable you have extended into the drain.

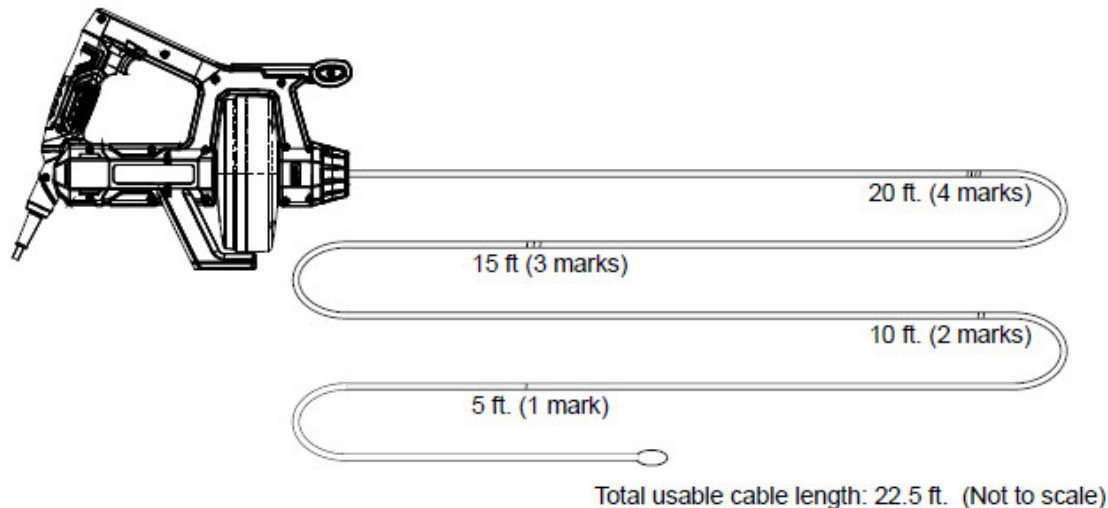

NOTE: Cable is not attached to the inner drum. Use care to track the cable towards the end of the usable length to ensure it does not come out of the drum. If the cable is extended past the end of the usable length, it may be necessary to manually retract the cable by hand back into the drum a few inches before Auto-Feed can be used again. Refer to the Auger Function Quick Reference Table to ensure the Feed Lock Dial and Clamp Lock Lever are placed in the correct positions.

CARE AND MAINTENANCE



WARNING

Fluids inside clogged drains may be contaminated with cleaning solutions, drain cleaners, bacteria, or other potentially harmful substances. When cleaning the Drain Auger, avoid contact with these fluids by using appropriate personal protective equipment (PPE) including gloves and eye protection.

Cleaning

Clean the exterior of the Drain Auger using any general purpose cleaning solution or a mild detergent and water solution. Wipe the exterior with a damp rag and remove any dirt or debris from the unit.

Cable Debris from Cable and Drum

After use, debris from the drain may be caught in the cable near the drum opening. For safety, unplug the power cord and carefully remove debris before next use. It may be necessary to extend some of the cable from the drum to remove the debris.

Cable Maintenance

Regularly inspect the auger cable for damage. Do not use if the cable is severely kinked or excessively worn. The cable should be thoroughly cleaned with water and lubricated after each use to prolong cable life and prevent unpleasant odors and avoid corrosion.

TROUBLESHOOTING

PROBLEM	POSSIBLE CAUSE	CORRECTIVE ACTION
Drain Auger will not turn on.	No AC power.	Ensure the power cable is plugged in. Check the GFCI and make sure it is not tripped. Check any circuit breakers to make sure they are not open.
Auger cable will not feed or retract.	<ul style="list-style-type: none">• Feed Lock Dial is unlocked.• Clamp Lock Lever is locked.• Cable is deformed or broken.	<ul style="list-style-type: none">• Rotate Feed Lock Dial to locked position.• Unlock the Clamp Lock Lever.• Replace the cable. Replacement cables are available from lowes.com.
Motor bogs down.	<ul style="list-style-type: none">• Feed Lock Dial and Clamp Lock Lever both locked.• Cable is overstressed	<ul style="list-style-type: none">• Unlock either device.• Slowly retract and remove the cable from the drain. Inspect for damage.

KOBALT DRUM AUGER WARRANTY STATEMENT

One Year Limited Warranty

This product is warranted for a period of one year from the date of purchase to be free from defects in material and workmanship. This warranty does not cover damage due to abuse, normal wear, improper maintenance, neglect, unauthorized repair or alteration, or wearable parts and accessories expected to become unusable after a reasonable period of use. This warranty will not apply to any product that was sold to the original purchaser as a reconditioned or refurbished product. This warranty will not apply if any part from another manufacturer is installed.

Subject to the conditions and limitations above, if returned with proof of purchase within the stated warranty period, and if covered under this warranty, this product will be repaired or replaced (with the same model or one of equal value or specifications) at our option.

Lowe's Home Centers LLC.

MOORESVILLE, NC 28117

Printed in China