

# SWIVEL RECLINER CHAIR ASSEMBLY INSTRUCTIONS

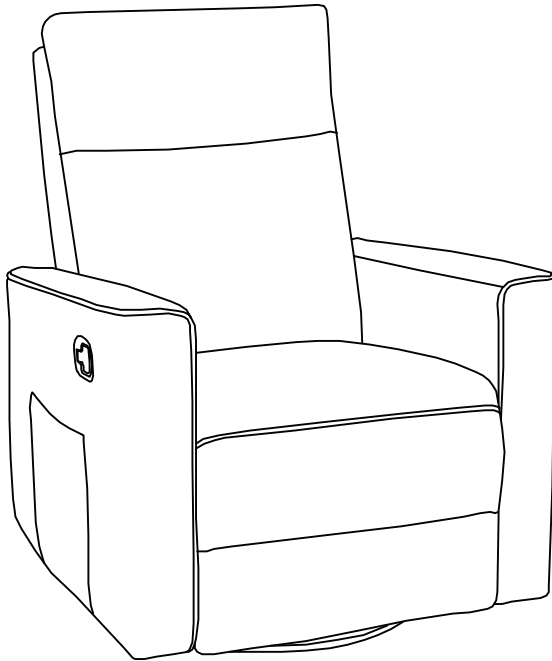

## PART LIST

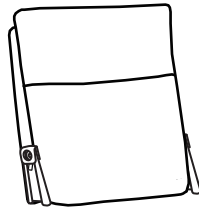

1

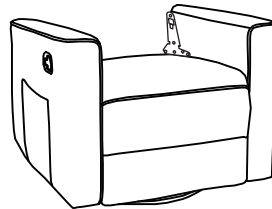

2

## WARNING

- This sofa is designed for one person weighing up to 275lbs(125kgs).
- Avoid exposing furniture directly to sunlight or heating and air conditioning outlets. Do not place your upholstery furniture too close to windows, radiators, or vents, and be sure to use window treatments to block the sun's rays.
- Do not use a rough cleaning tool or corrosive detergent to clean the sofa.
- Some of the parts are heavy and/or have sharp edges, please install them carefully to avoid hurt you and the people around you.
- If any parts are missing, broken, damaged or worn, stop using the sofa until repairs are made and factory replacement parts are installed.

STEP 1:

CUT THE TAPE OFF THE BASE, OTHERWISE THE PLATE WON'T ROTATE.

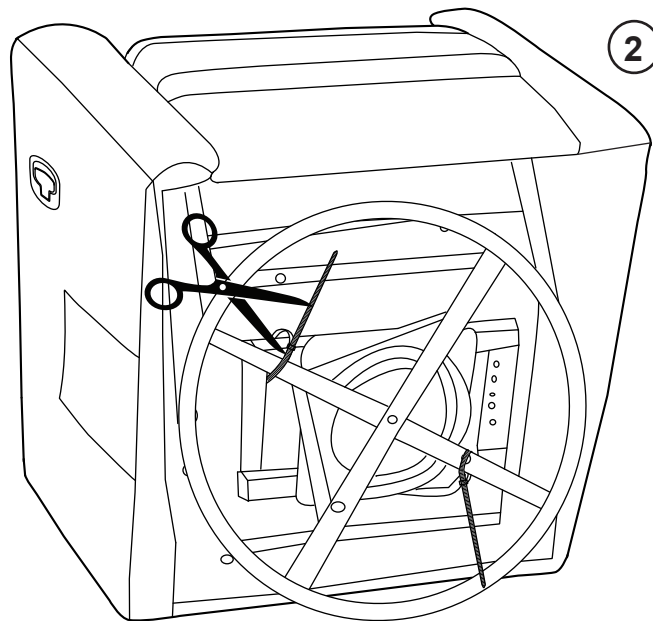

STEP 2:

MATCH BOTH SIE HOOK-LOOP BRACKET AND PUSH DOWN BACKREST TO ASSEMBLY. AFTER PRESSING THE BACK COVER IN PLACE, PULL IT UPWARDS TO ENSURE IT IS FULLY SECURED AND SECURE.

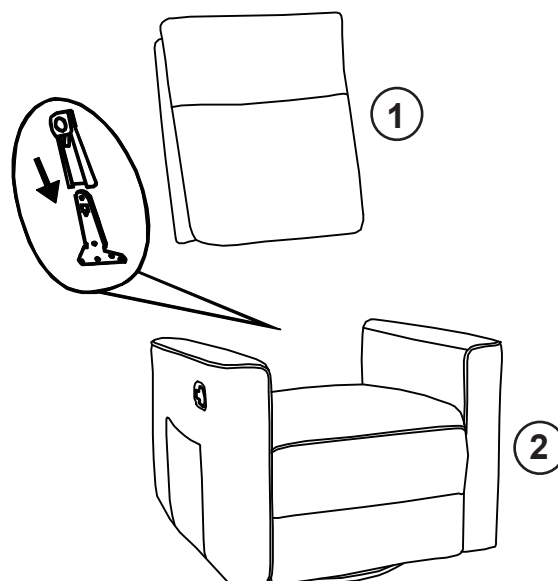

**STEP 3:**

IF YOU WANT TO LEAN BACK , PULL THE SWITCH ON THE RIGHT FOOTREST AND USE YOUR WEIGHT AND ARM TO PUSH DOWN ON THE BACKREST.

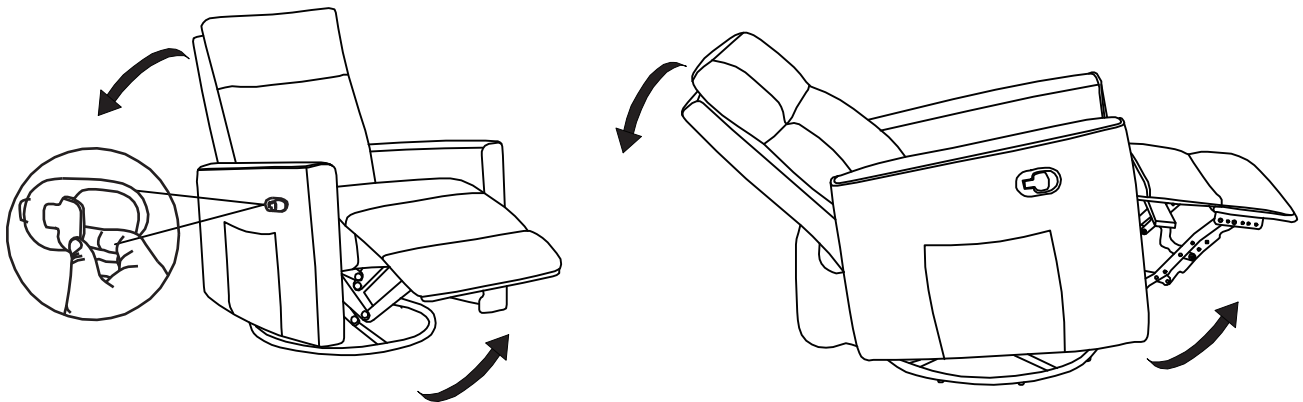

**STEP 4:**

CLOSE THE FOOTREST WITH LEGS THEN YOU CAN STAND UP.

