

## Concord Unassembled 2-Door 2-Drawer Vanity 36x30x21 White

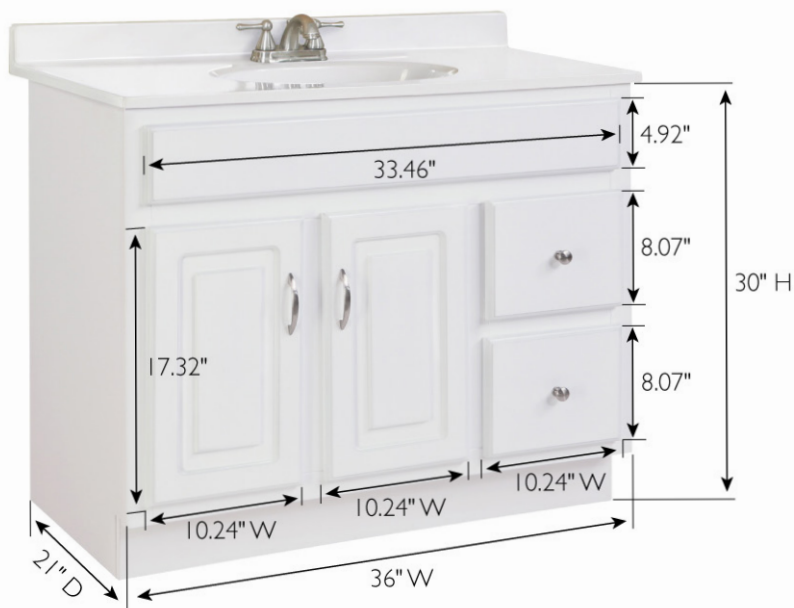

### SPECIFICATIONS

MATERIAL CONSTRUCTION:	Wood
ASSEMBLY REQUIRED:	Yes
TOOLS NEEDED FOR ASSEMBLY:	Screwdriver
ASSEMBLED DIMENSIONS:	30" H x 36" L x 21" D
ASSEMBLED WEIGHT:	49 lbs.
HINGE STYLE:	Concealed
DOOR STYLE:	2 Raised Panel Doors
DRAWER STYLE:	2 Drawers
GLIDE STYLE:	STD Easy Glide
FAKE DWR STYLE:	N/A
DWR DIMENSIONS:	5.71" H x 8.86" L x 14.25" D
DWR CONSTRUCTION:	Standard
SHELF STYLE:	N/A
SHELF ADJUSTABILITY INCREMENTS:	N/A
SHELF MAX WEIGHT CAPACITY:	N/A
SHELF DIMENSIONS:	N/A
SHELF THICKNESS:	N/A
SHELF MATERIAL:	N/A

FRAME STYLE:	Face Frame
FACE FRAME MATERIAL:	Pine
SIDES MATERIAL:	Plywood
BOTTOM MATERIAL:	Plywood
TOE KICK INSET WIDTH:	2.5"
BACK PANEL MATERIAL:	N/A
BACK BRACE MATERIAL:	Plywood



WARRANTY:	1-Year limited warranty
TITLE IV COMPLIANT:	Yes
PROP 65 HARMFUL MATERIAL:	Formaldehyde



TYPE:  
JOB:  
ORDER CODE:  
APPROVALS: