

Sideboard

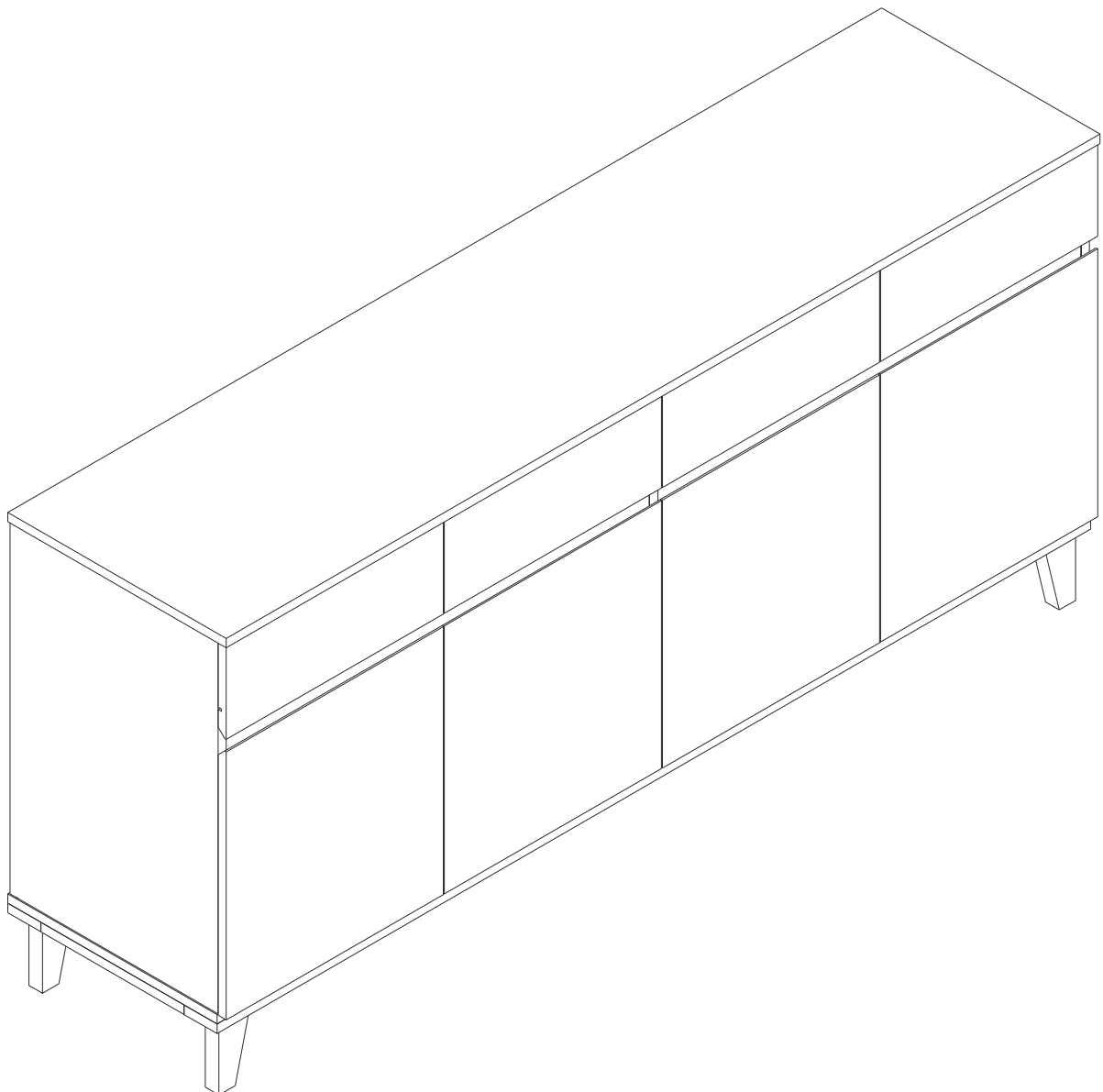

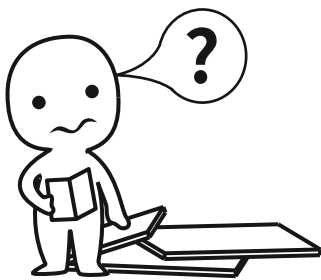

IMPORTANT INFORMATION!

please read the entire manual before starting to assemble and/or using this product. follow the manual thoroughly and keep it for further reference.

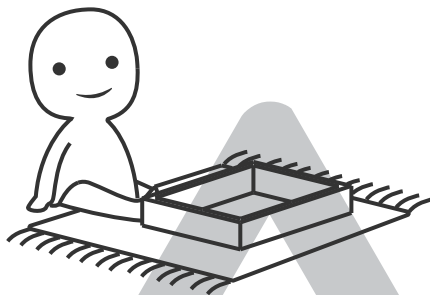
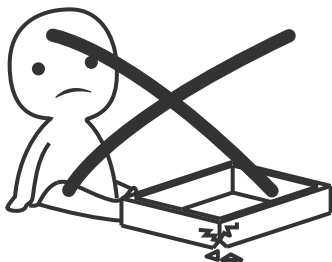

AVOID SCRATCHES!

In order to avoid scratching this furniture should be assembled on a soft layer-could be a rug.

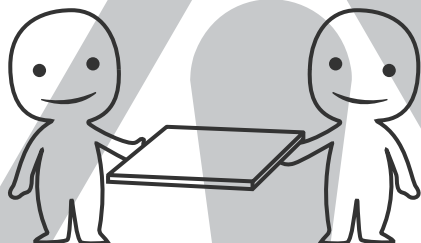

IMPROVE EFFICIENCY !

Try to find a partner to install with you, which can speed up the installation efficiency and shorten the time.

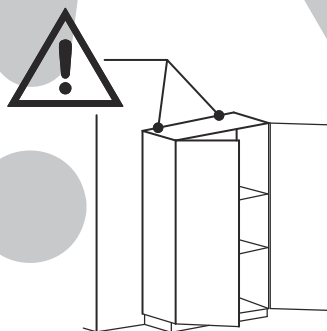
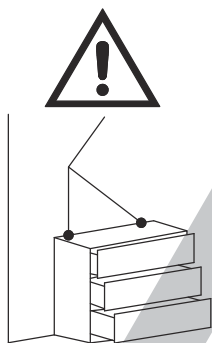

ANTI-TOPPLE WARNING !

Overturned furniture can cause serious or fatal crush injuries. To prevent tipping over, be sure to use the wall attachment, if not included with this product. Please purchase the wall attachment that fit your wall. If unsure, seek professional advice. Please read and follow each step of the instructions carefully.

IMPORTANT !

It is important that any product which is assembled using any kind of screw is re-tightened 2 weeks after assembly, and once every 3 months - in order to assure stability through-out the lifespan of the product.

For regular maintenance and cleaning of the product, for the frame, please use a rag dipped in neutral detergent to fully wipe it, and then dry it with a clean rag. For glass materials, wipe with a rag dampened with water glass cleaner, and then dry with a dry rag.

Do not use an electric screwdriver, and do not use too much force when installing, because the board is easy to break.

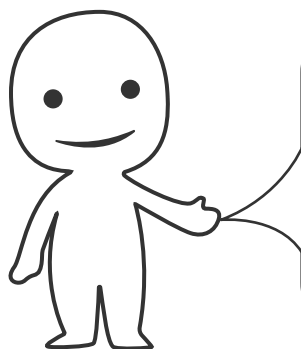

Please prepare the following tools

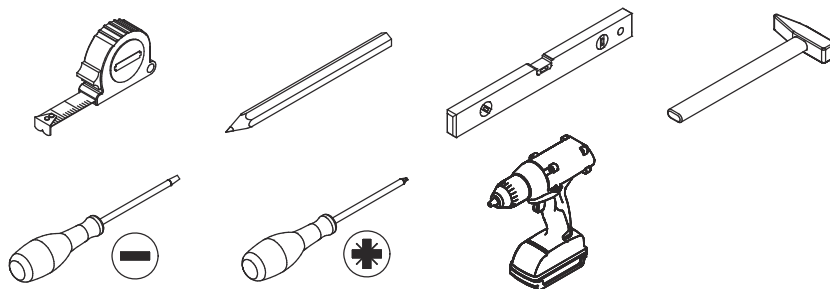

When installing, please carefully confirm whether each screw corresponds to the manual, accessories with similar shapes can be distinguished by size

<p>A x 40</p> <p>M5 x 42 mm</p>	<p>B x 40</p> <p>Ø 15 x 10 mm</p>	<p>C x 80</p> <p>M3.5 x 14 mm</p>	<p>D x 30</p> <p>M5 x 40 mm</p>	<p>E x 6</p> <p>M7 x 50 mm</p>
<p>F x 11</p> <p>Ø 8 x 40 mm</p>	<p>G x 14</p> <p>M6 x 25 mm</p>	<p>H x 8</p> <p>Ø 5 mm</p>	<p>I x 4</p> <p>QG</p>	<p>J x 4</p> <p>BG</p>
<p>K x 2 SETS</p>	<p>L x 16</p> <p>M3.5 x 12 mm</p>	<p>M x 16</p>	<p>N x 1</p> <p>M6 x H7 mm</p>	<p>x 1</p> <p>4 #</p>

28

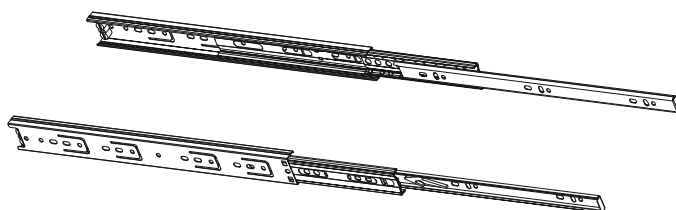

14" 3508 x4

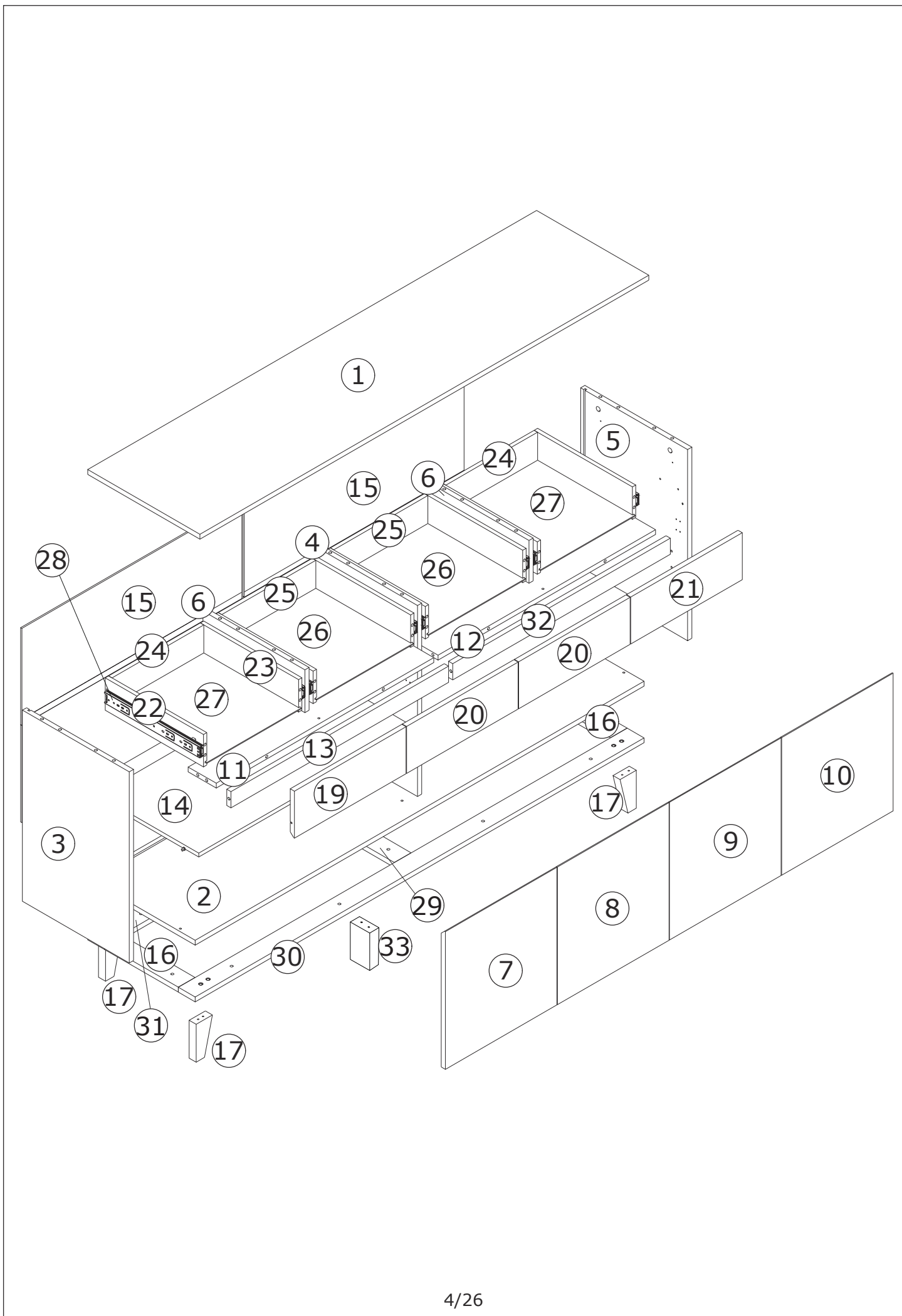

**Slides Must Be Separated Before Assembly.
After Separated, Set Aside Until Needed for Assembly.**

Las diapositivas deben separarse antes del montaje.
Después de la separación, déjelo a un lado hasta que sea necesario.

Les glissières doivent être séparées avant l'assemblage.
Après la séparation, mettez de côté jusqu'au moment de l'assemblage.

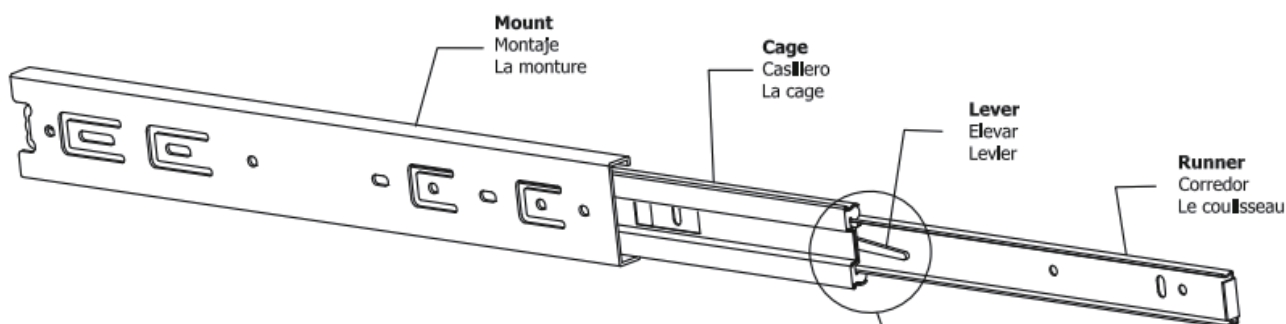

STEP 1: Extend Slide
Extender la diapositiva
Extendre la diapositive

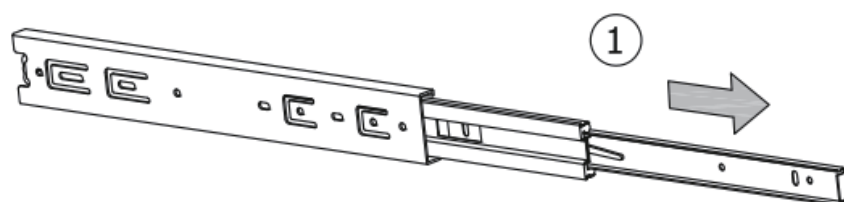

STEP 2: Push Lever UP
Empujar hacia arriba
Lever le levier

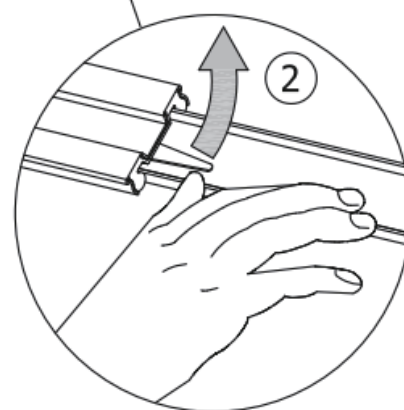

STEP 3: Remove Runner
Quitar el corredor
Enlever le coureur

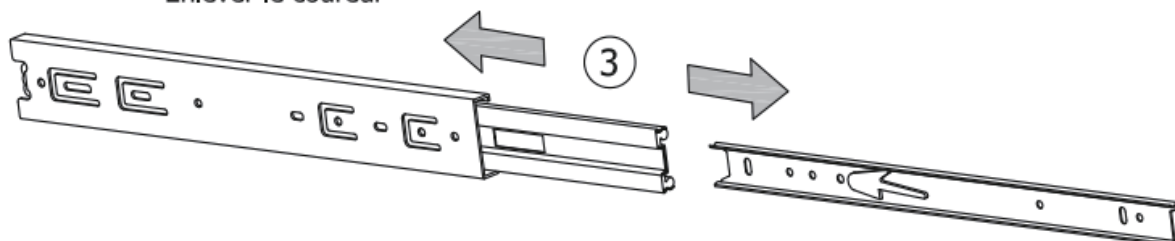

1

C x 2



M3.5 x 14 mm

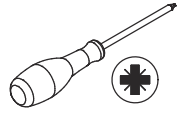

Separate the glide into two parts at first.
Fix slide rail 28 to plate 3 using screw(C)
as shown.

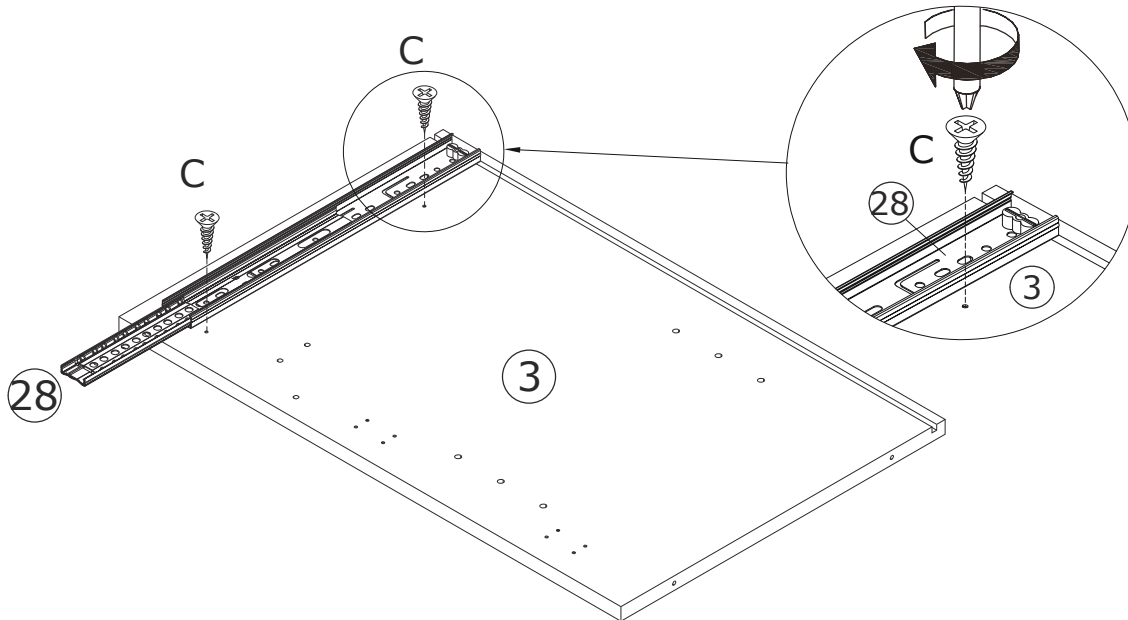
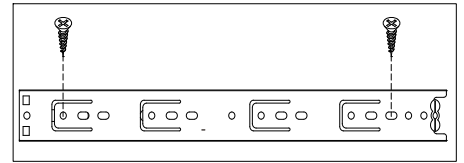

2

C x 2



M3.5 x 14 mm

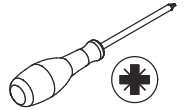

Fix slide rail 28 to plate 5 using screw(C)
as shown.

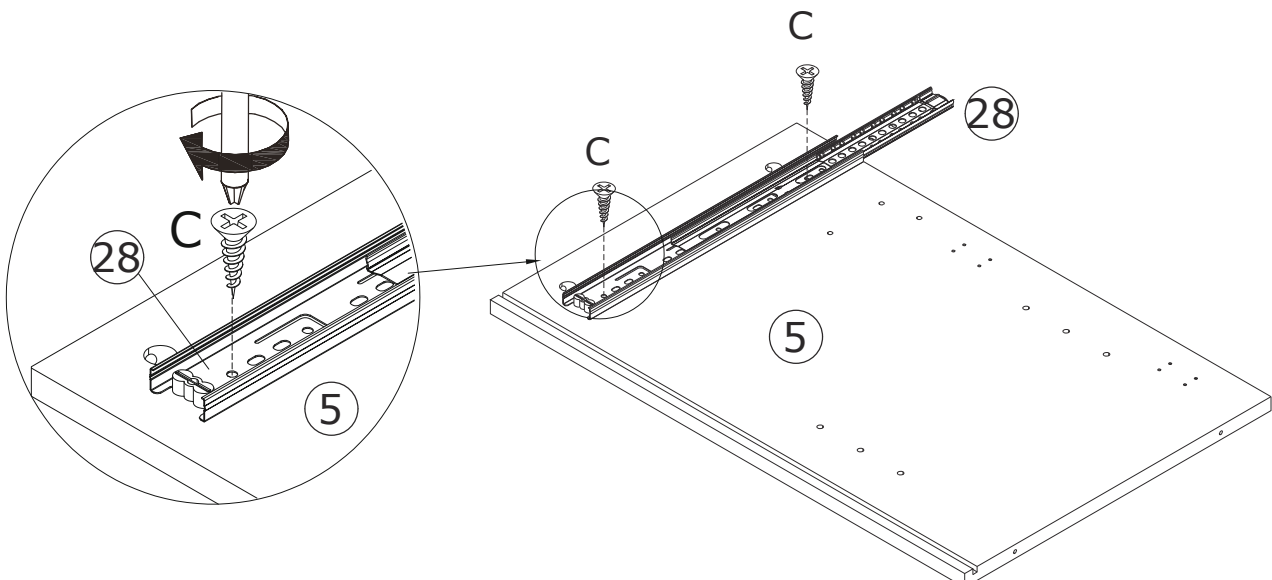
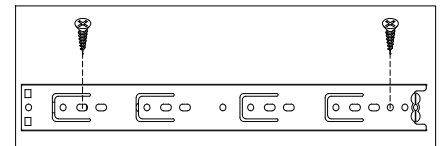

3

C x 4
M3.5 x 14 mm

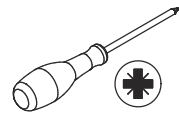

Fix slide rail 28 to plate 4 using screw(C)
at first.
Flip the plate, fix slide rail again.

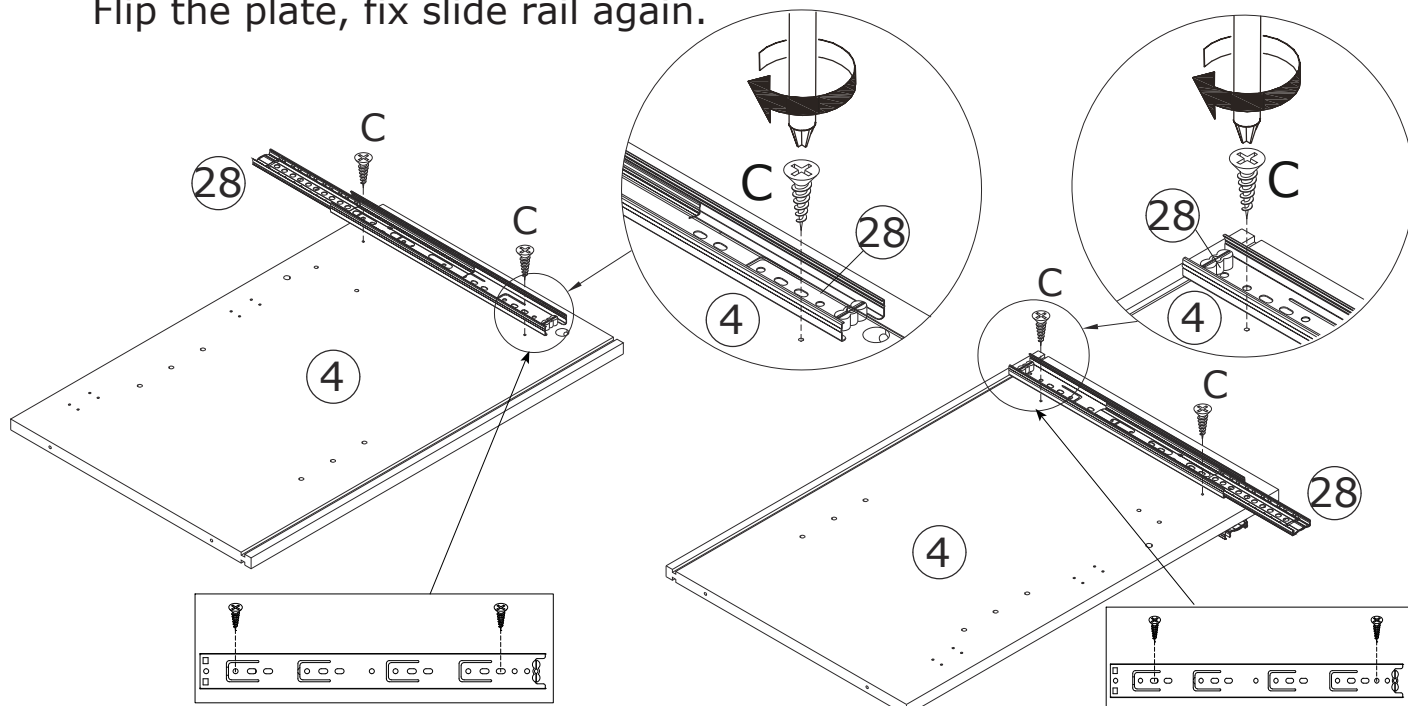

4

C x 4
M3.5 x 14 mm

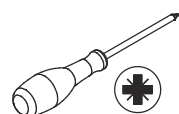

Fix slide rail 28 to plate 6 using screw(C) at first.
Filp the plate, fix another slide rail again.

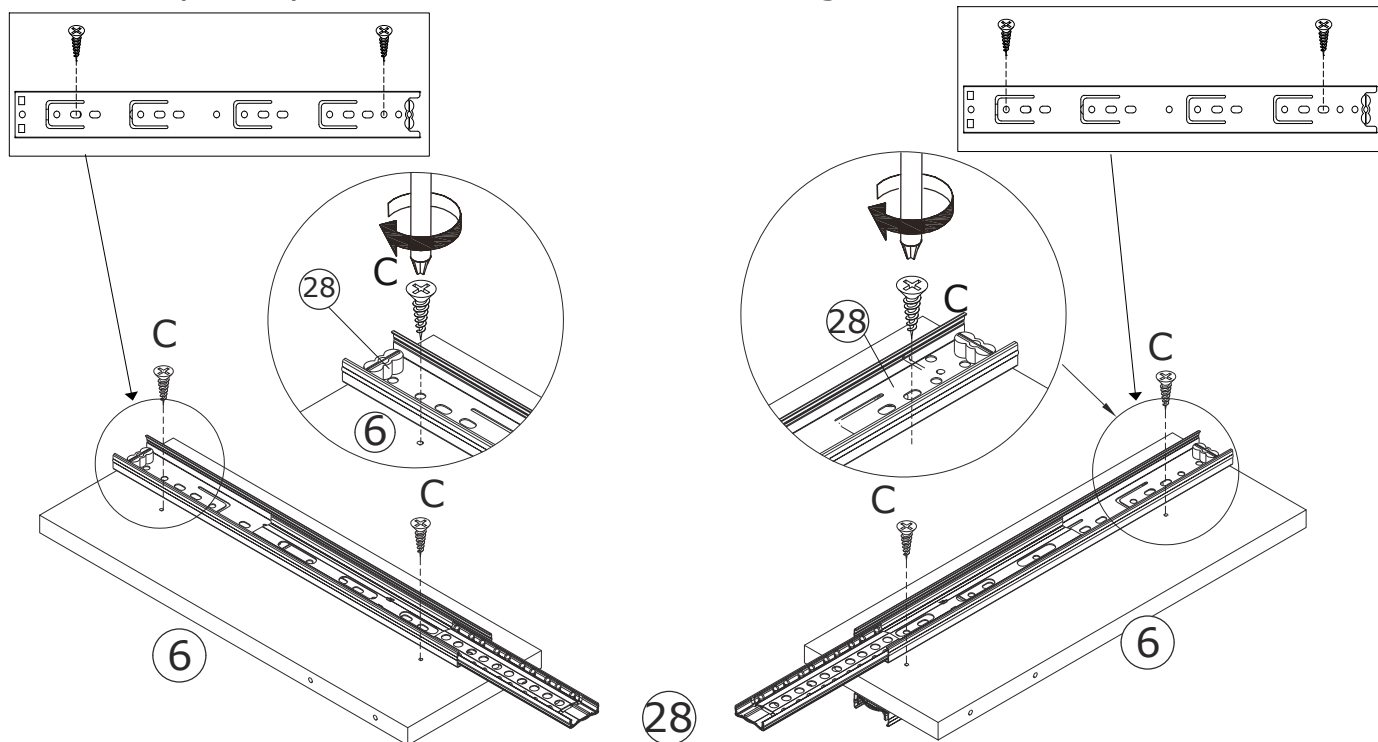

5

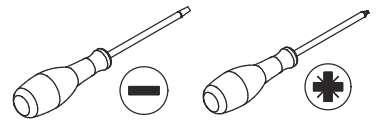
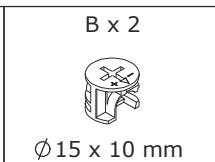
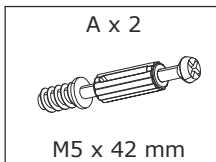

Insert quickfit screw(A) into plate 13 at first.
Cover plate 11 to plate 13 and turn cam lock(B) in plate 11 clockwise to tighten as shown.

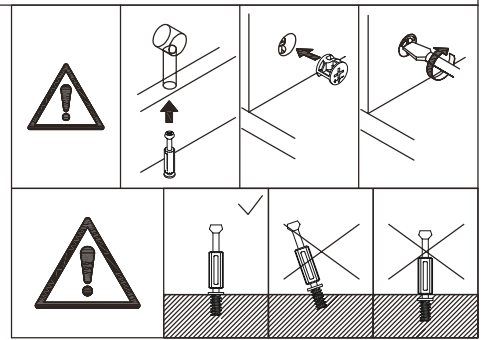
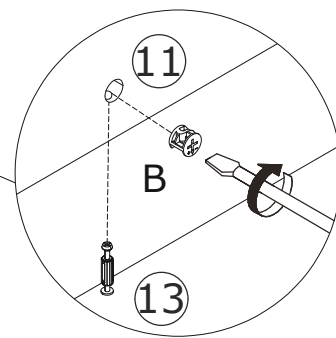
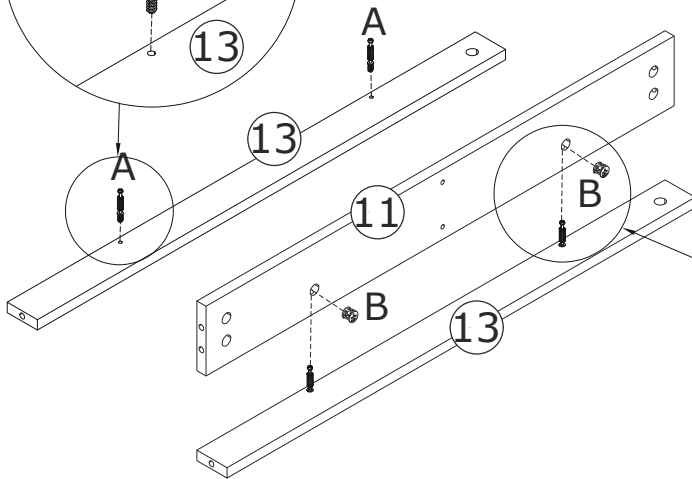
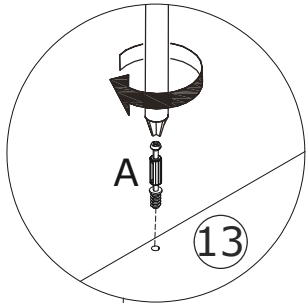

6

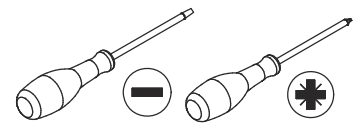
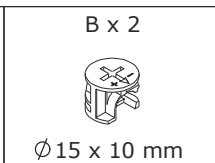
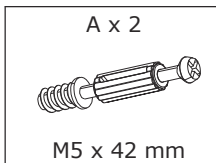

Insert quickfit screw(A) into plate 32 at first.
Cover plate 12 to plate 32 and turn cam lock(B) in plate 12 clockwise to tighten as shown.

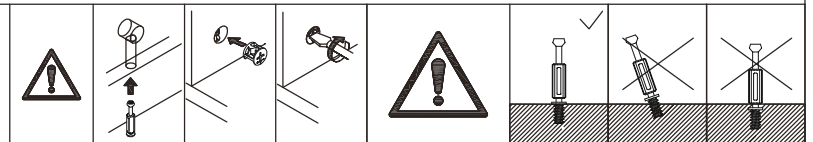
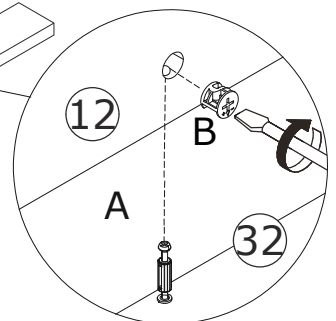
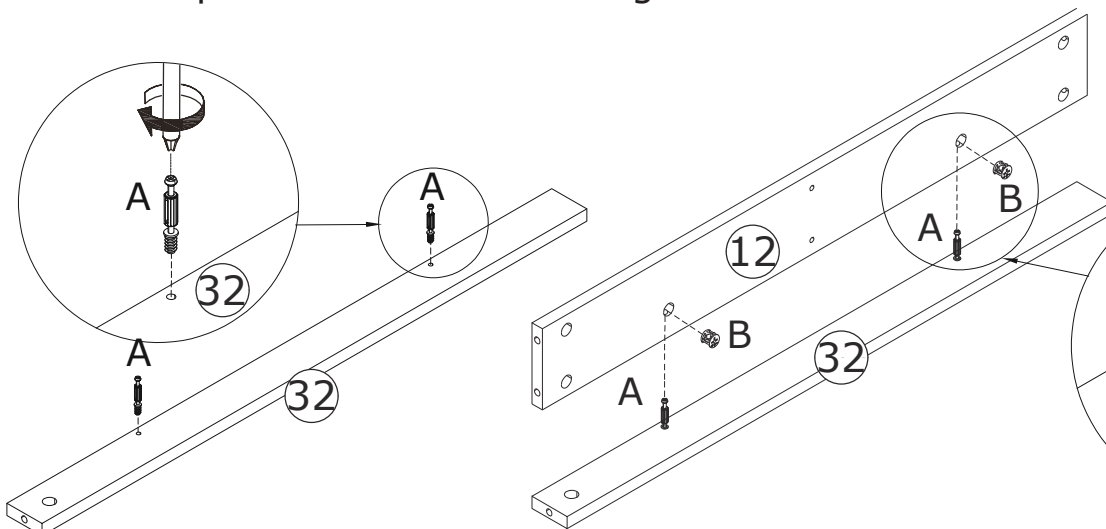
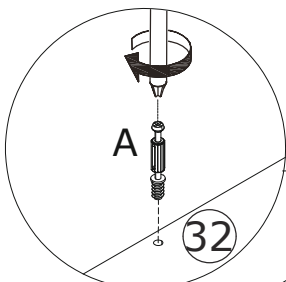

7

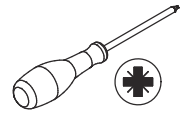
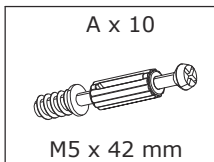

Insert quickfit screw(A) into plate 3, plate 5 and plate 4.

Please pay attention to the holes where the accessories are inserted and don't use an electric screwdriver which may cause boards crack.

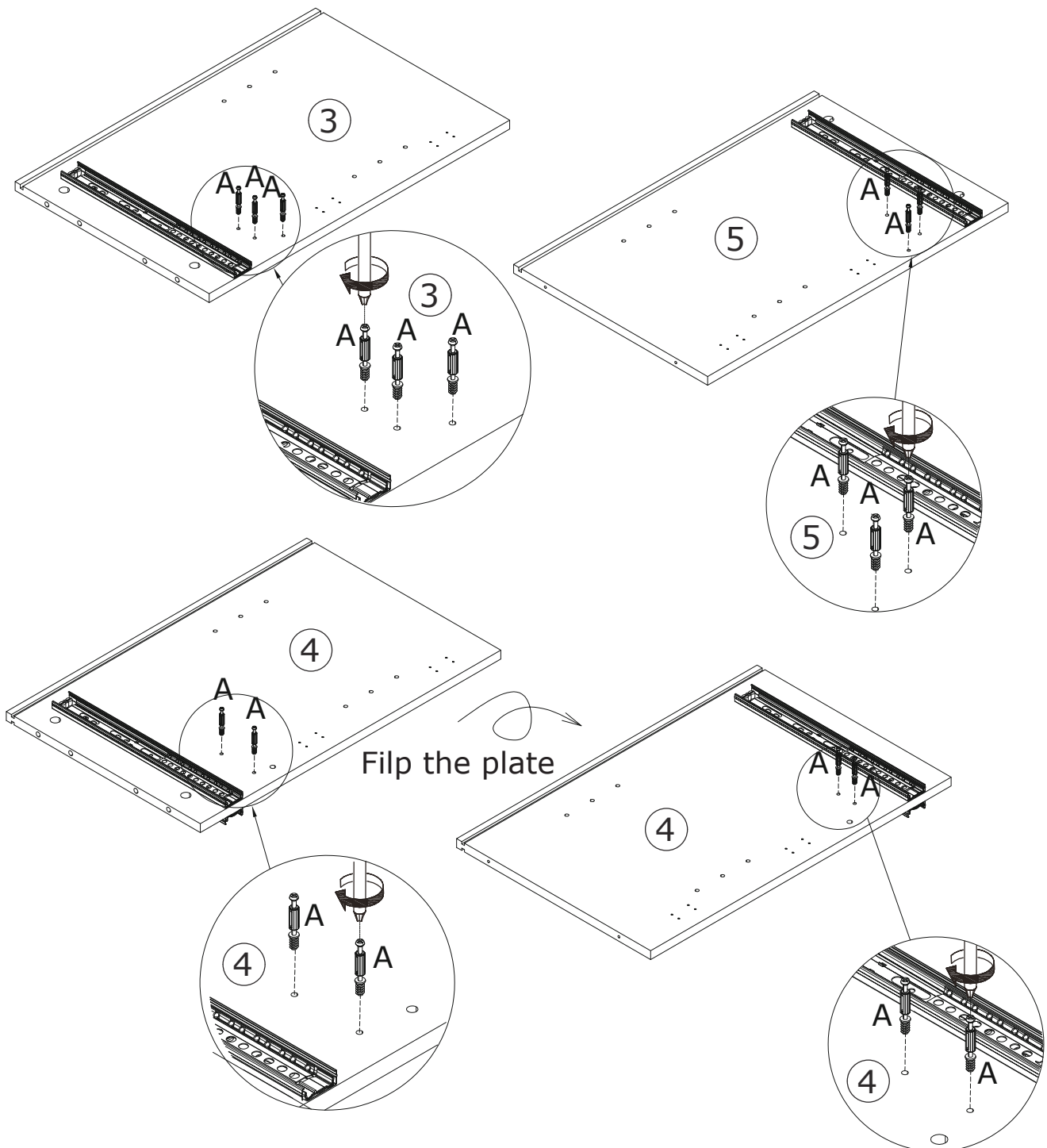
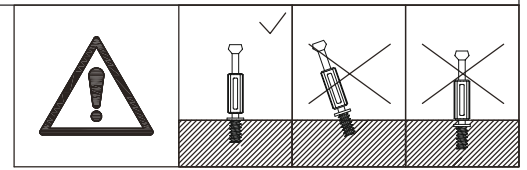

8

B x 10



Ø15 x 10 mm

F x 1



Ø8 x 40 mm

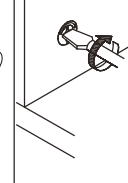
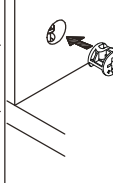
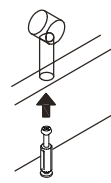
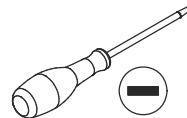

Insert long wooden dowel(F) into plate 4 at first.

Attach plate 3 and 4 to plate 11 and 13, turn cam lock(B) in plate 11, 13 clockwise to tighten as shown.

Attach plate 5 and 4 to plate 12 and 32, turn cam lock(B) in plate 12, 32 clockwise to tighten as shown.

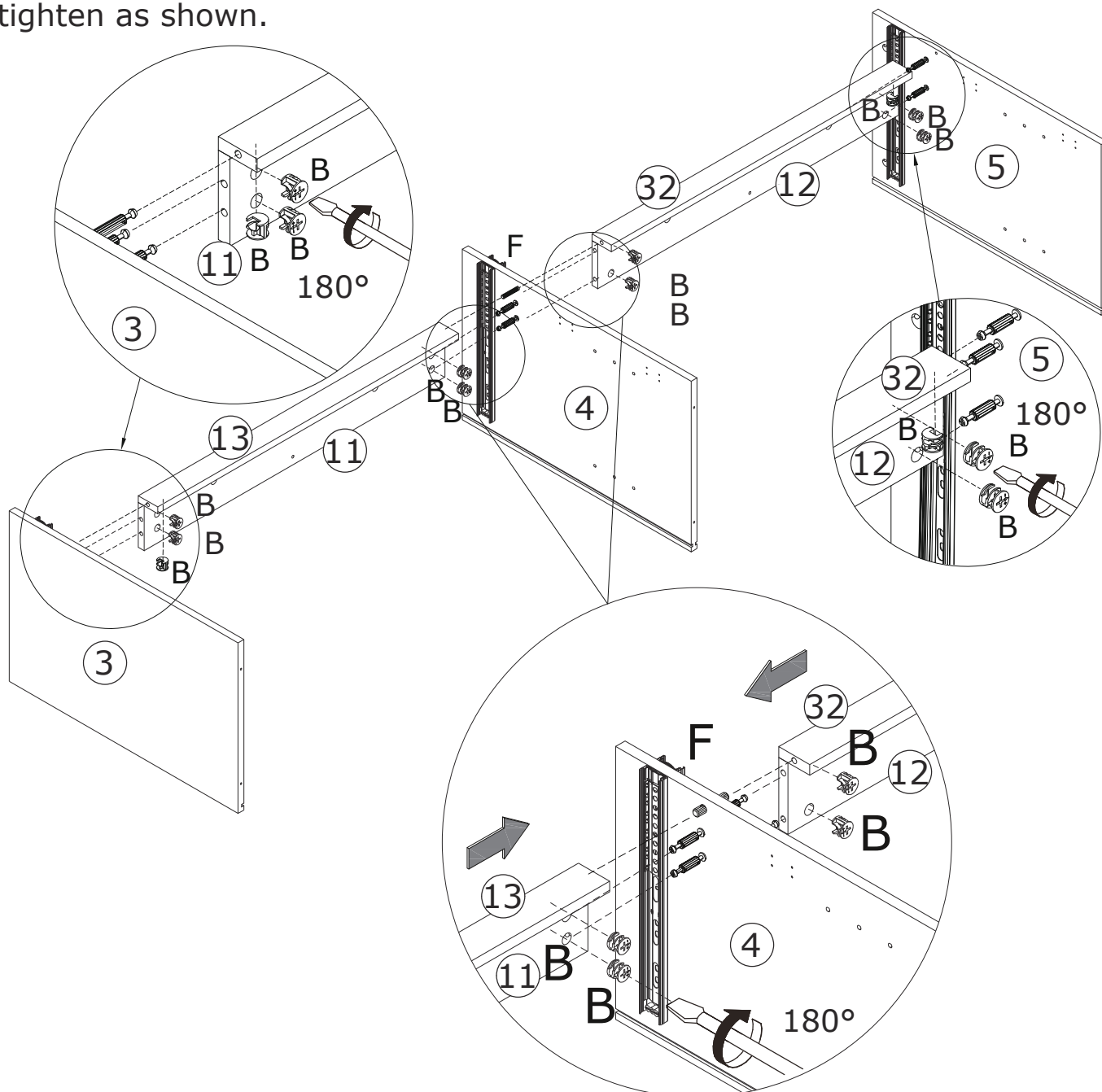

9

D x 4



M5 x 40 mm

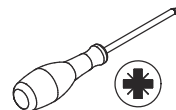

Fix two plate 6 to plate 11 and 12 respectively using screw(D) as shown.

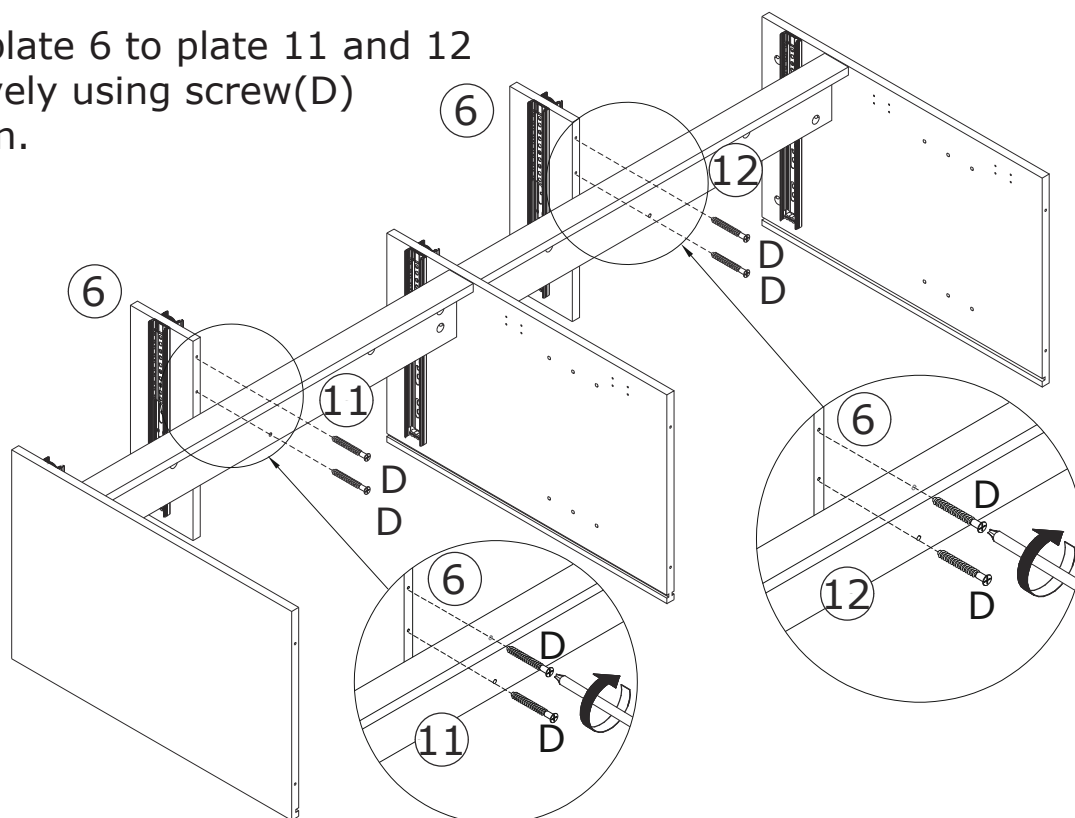

10

A x 10

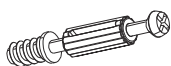

M5 x 42 mm

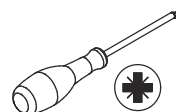

Insert quickfit screw(A) into plate 1, please don't use an electric screwdriver which may cause boards crack.

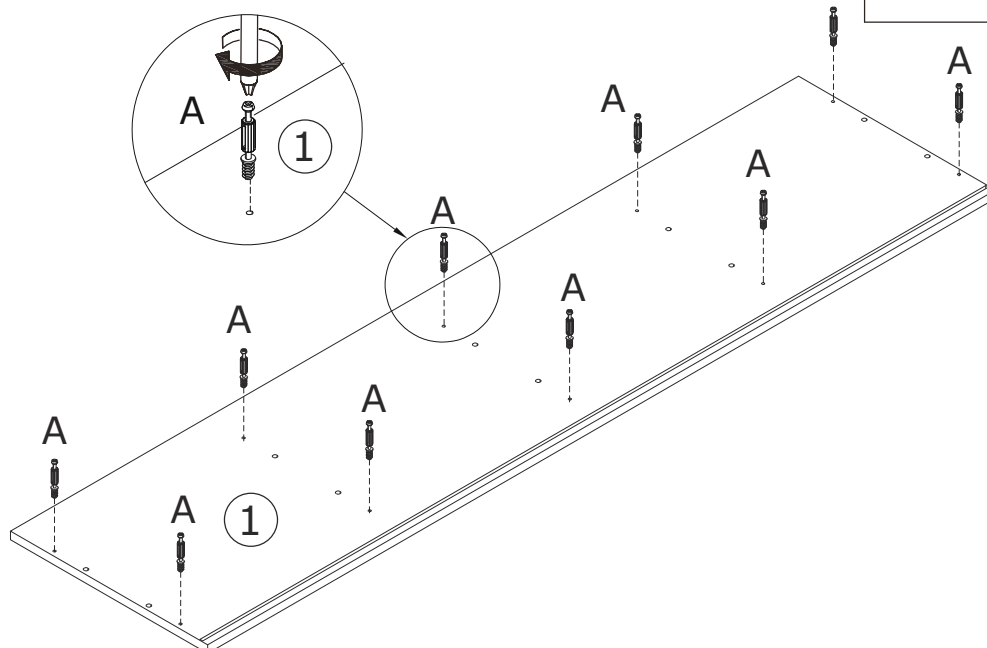
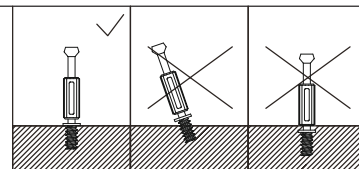

11

B x 10



Ø15 x 10 mm

F x 10



Ø8 x 40 mm

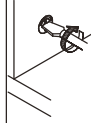
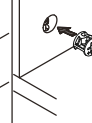
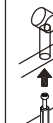
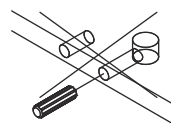
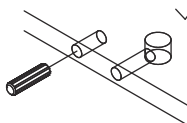
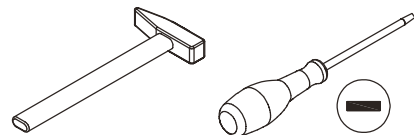

Knock wooden dowel(F) into plate 3,4,5,6 and cover plate 1 to them, turn cam lock(B) in plate 3,4,5,6 clockwise to tighten as shown.

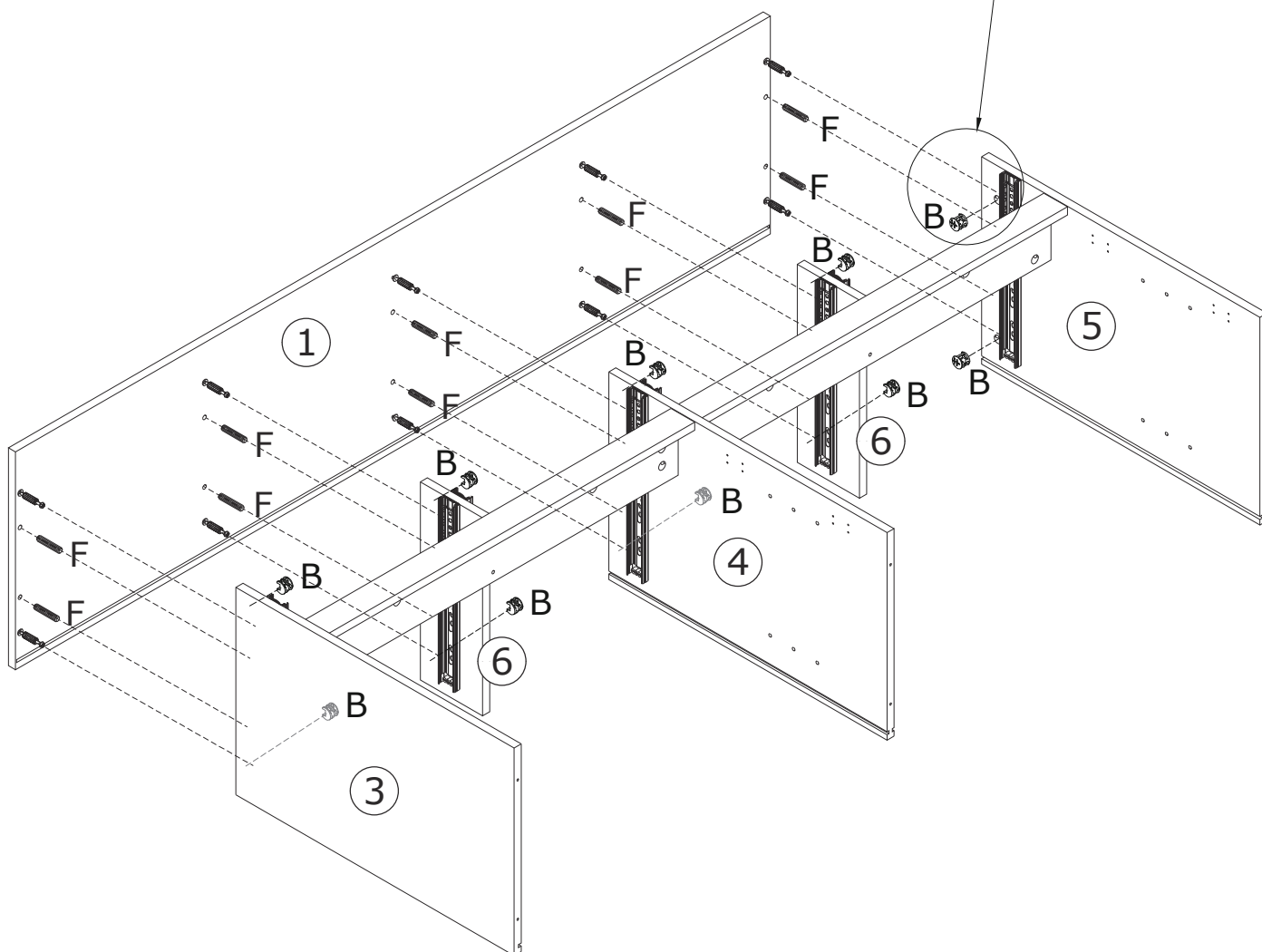
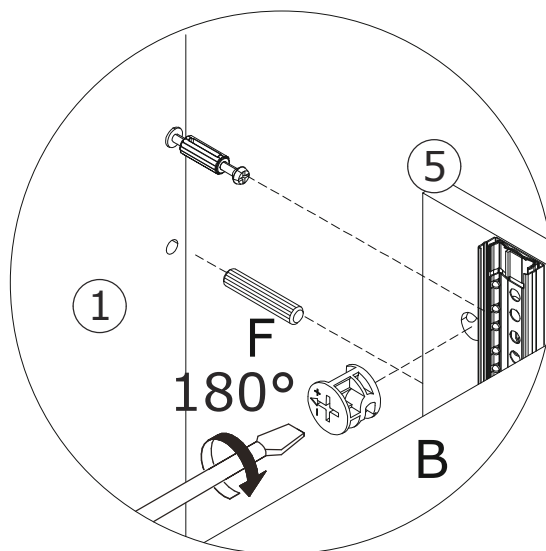

12

Slide plate 15 and 18 into available slots as shown.

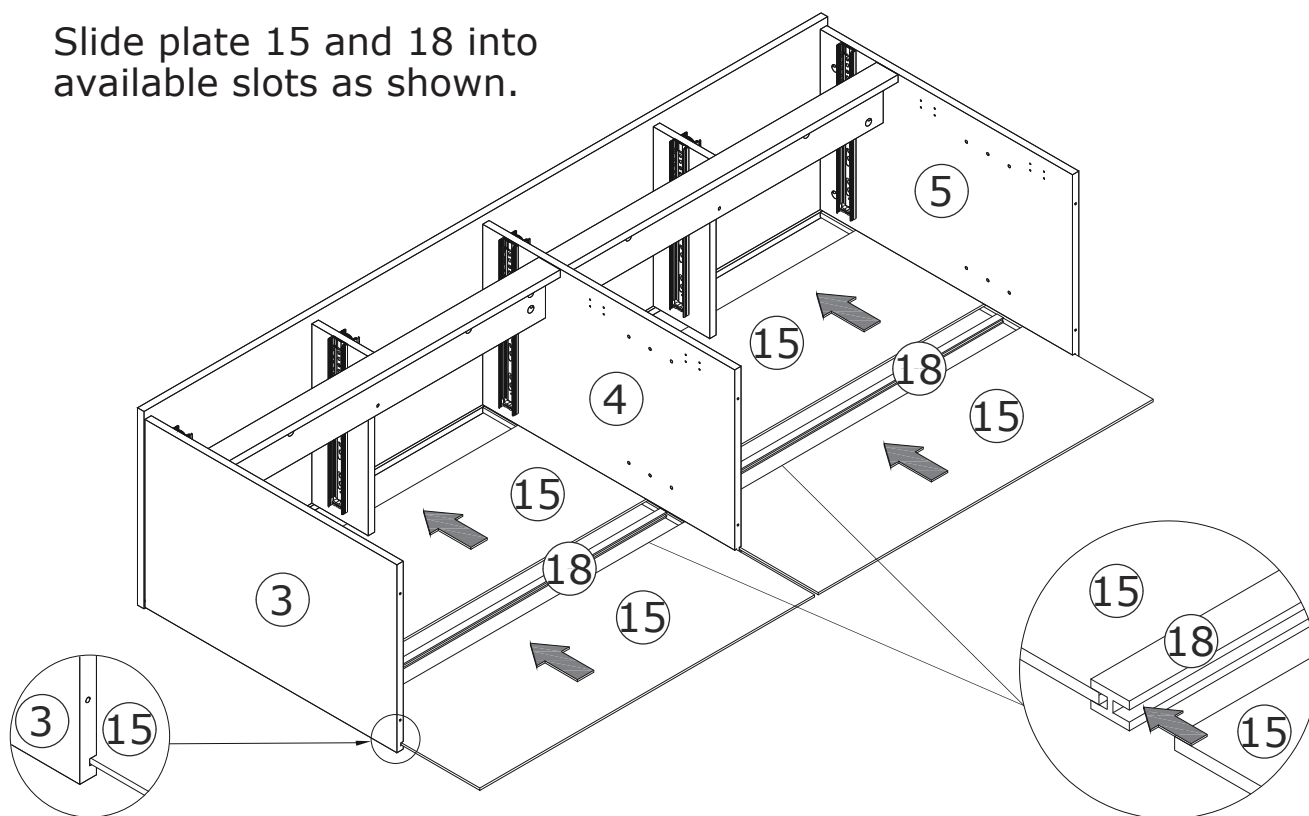

13

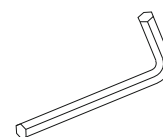
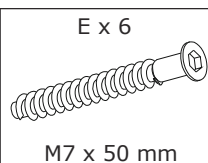

Cover plate 2 to plate 3,4,5 using screw(E).

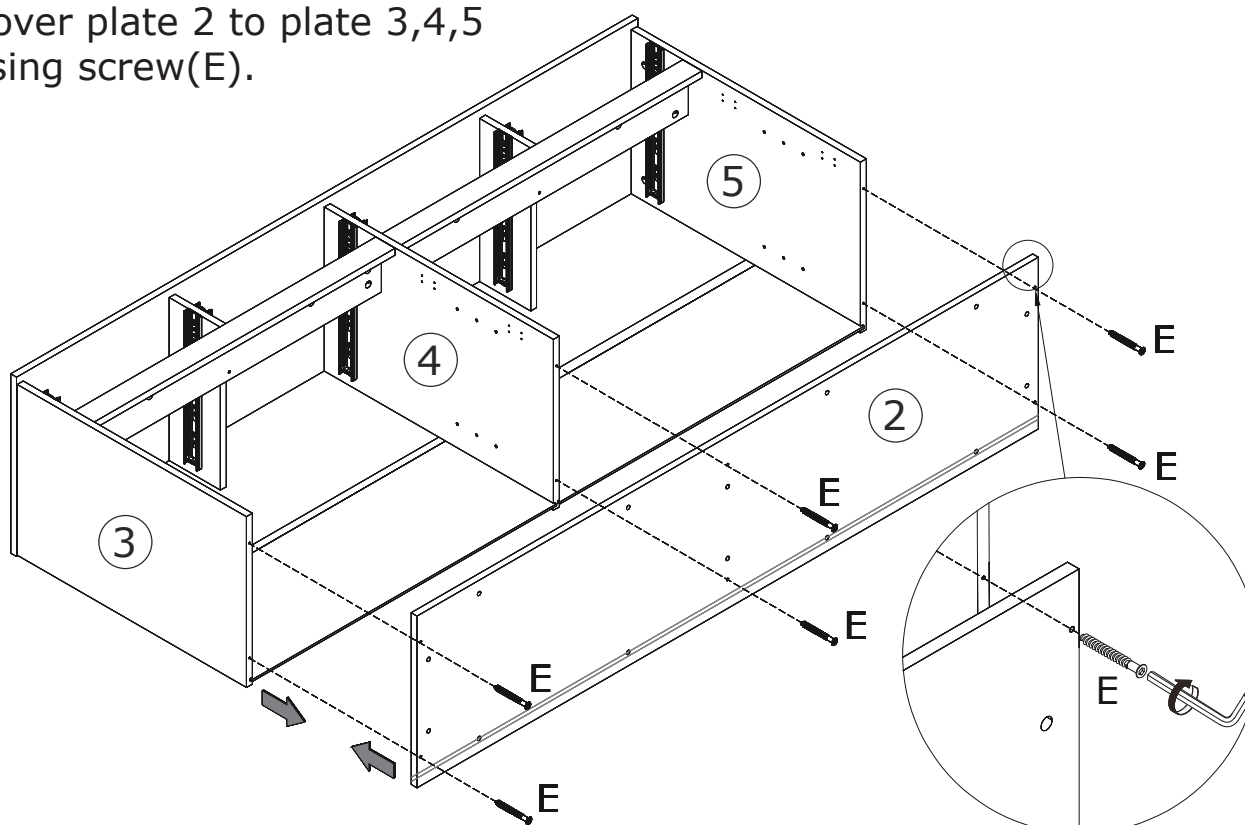

14

D x 10



M5 x 40 mm

N x 1



M6xH7mm

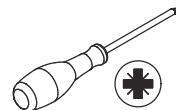

Rotate foot peg(N) into plate 33 at first.

Fix leg support 33 to plate 29 using screw(D) as shown.

Assemble leg 17 to plate 30 and 31 respectively using screw(D) as shown.

Pay attention to the direction of legs.

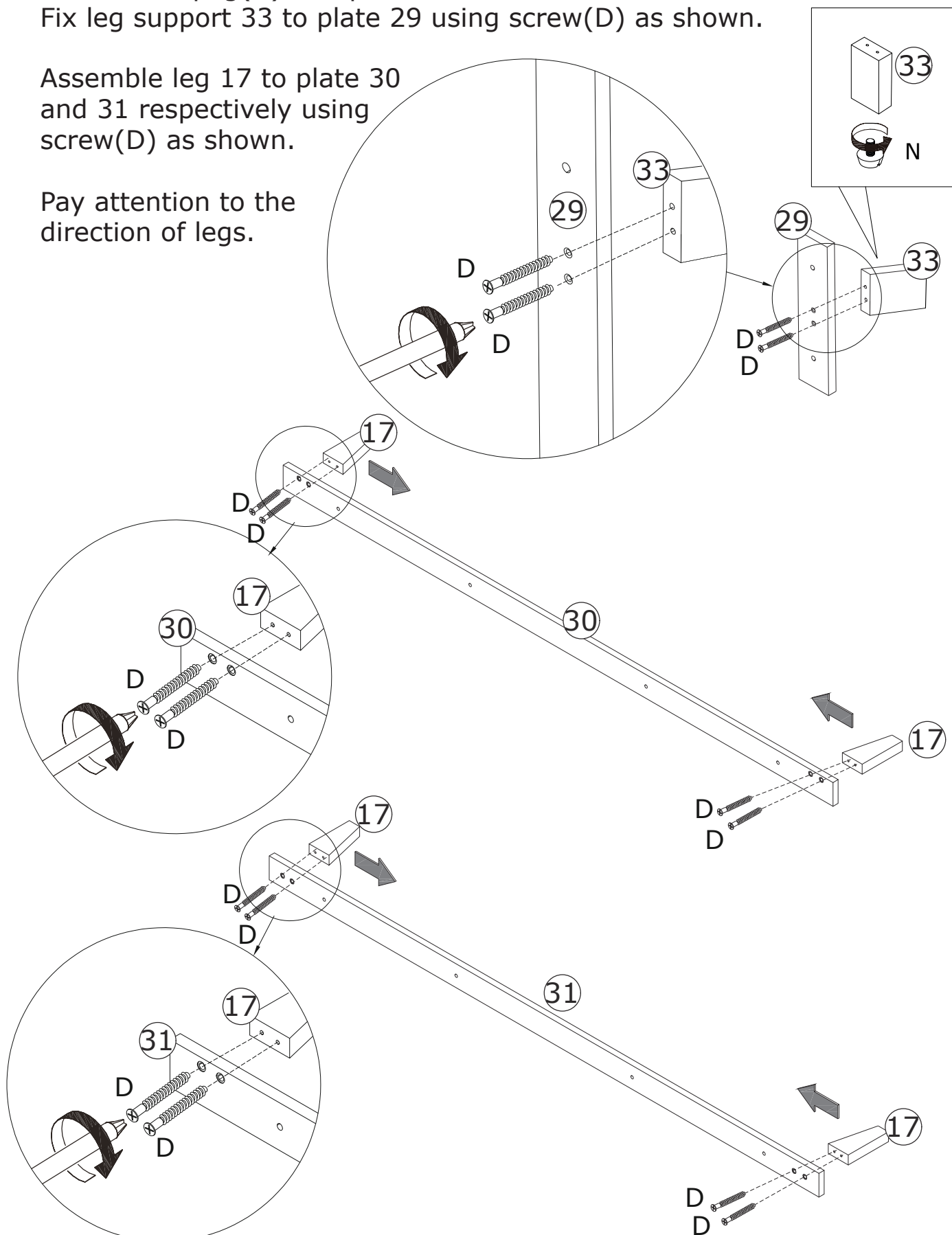

15

G x 14



M6 x 25 mm

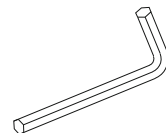

Fix the leg components and two plate 16 to plate 2 using screw(G) as shown.

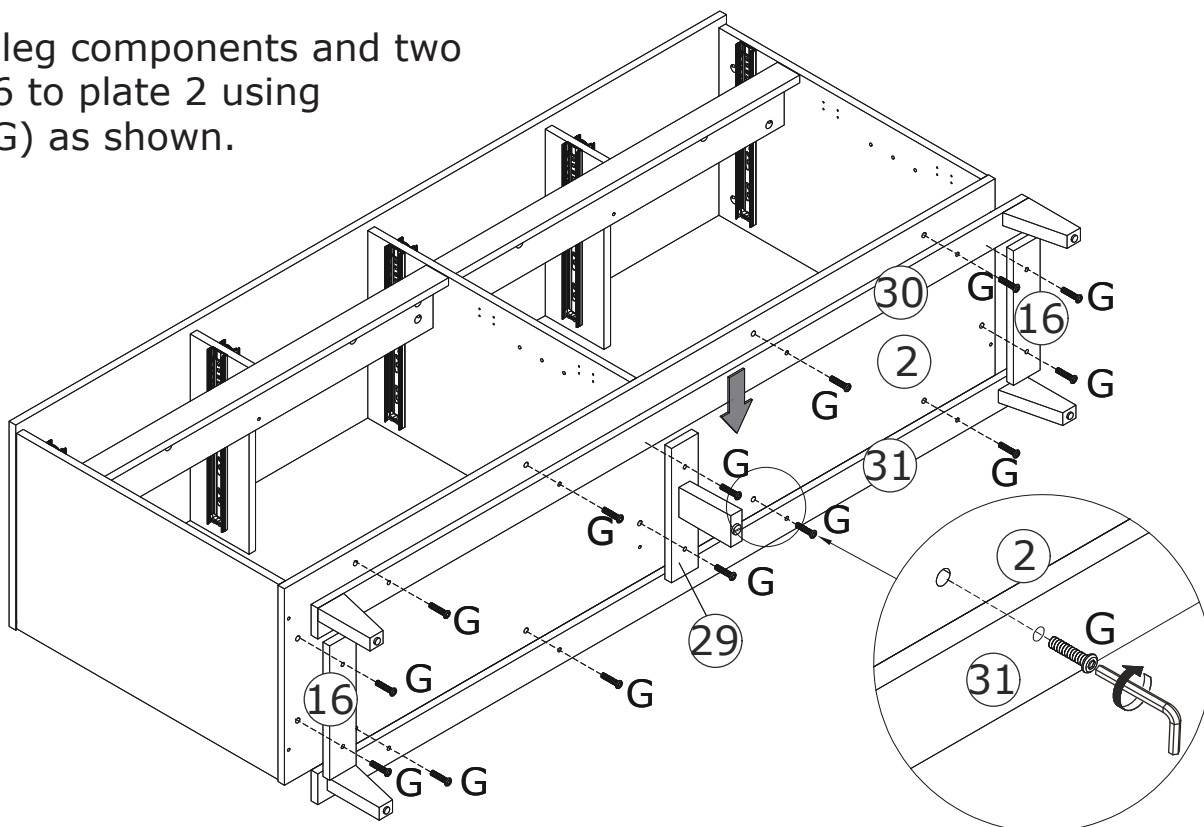

16

H x 8



Ø5 mm

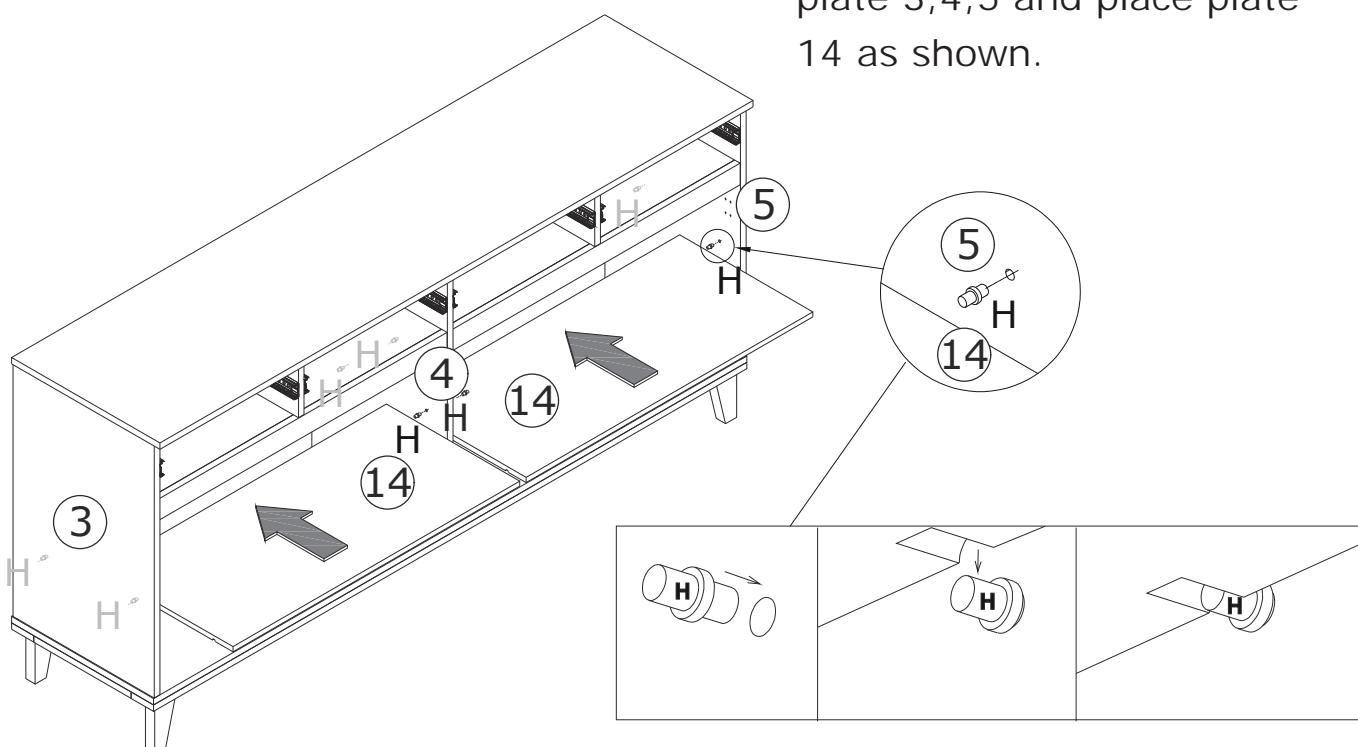

Insert part(H) to side of plate 3,4,5 and place plate 14 as shown.



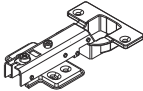
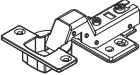
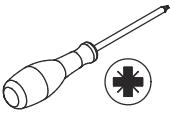

17

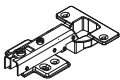
<p>C x 8</p>  <p>M3.5 x 14 mm</p>	<p>I x 2</p>  <p>QG</p>	<p>J x 2</p>  <p>BG</p>	
--	--	--	---

Fix hinge(I) to plate 7 using screw(C).

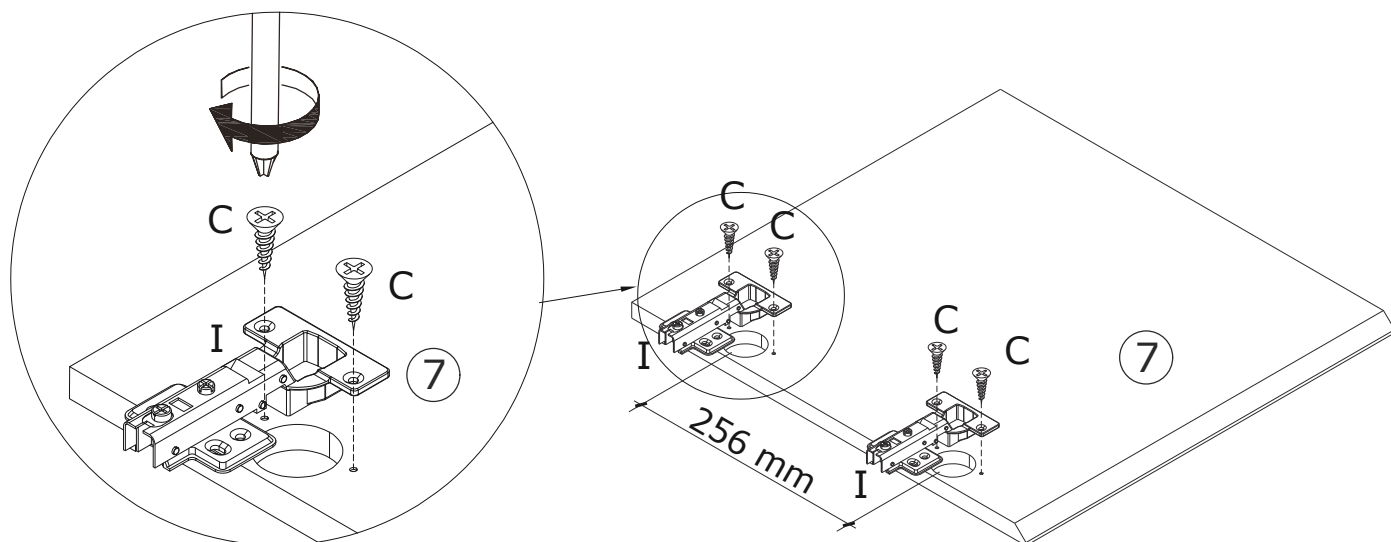
	I	J
	 <p>QG</p>	 <p>BG</p>

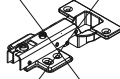
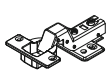

	I	J
	 <p>QG</p>	 <p>BG</p>

Fix hinge(J) to plate 8 using screw(C).

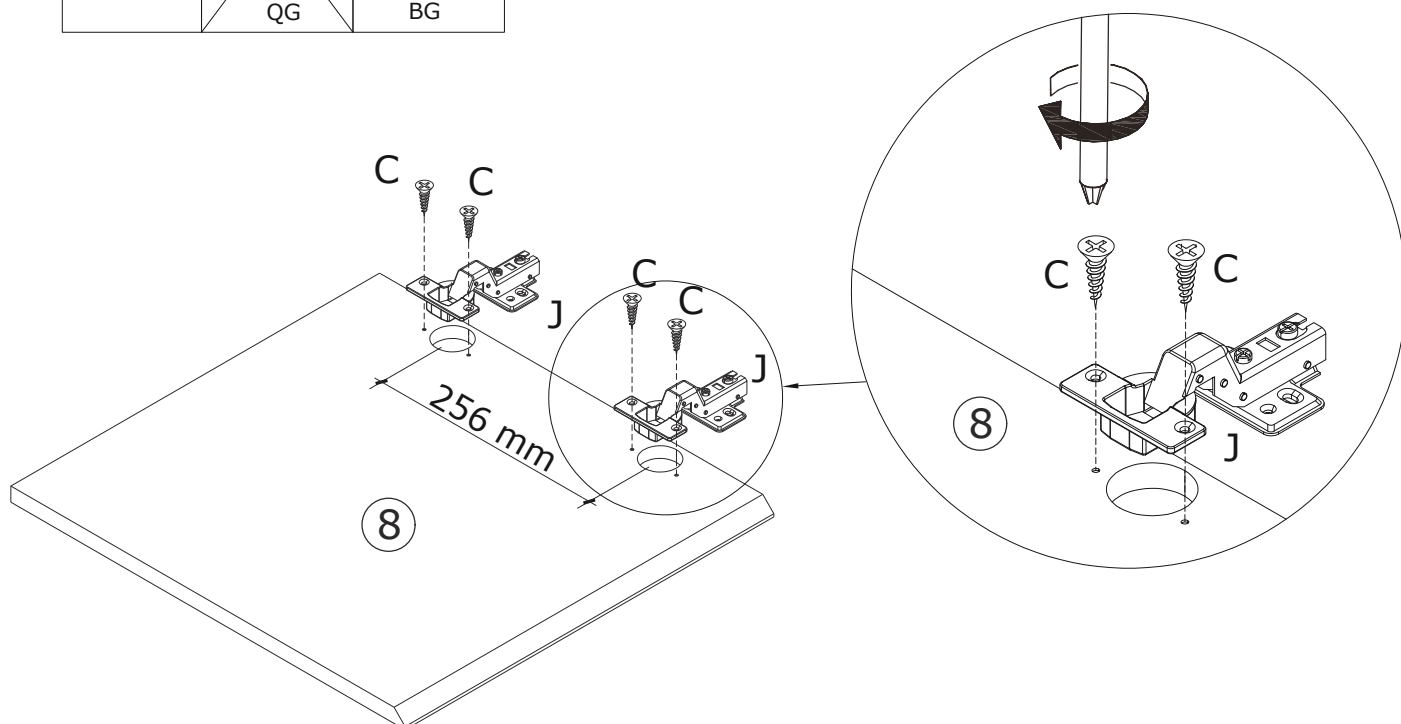

18

C x 16



M3.5 x 14 mm

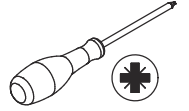

Assemble door 7 to plate 3, door 8 to plate 4 by fixing hinge using screw(C) as shown.

Please don't use an electric screwdriver which may cause boards crack.

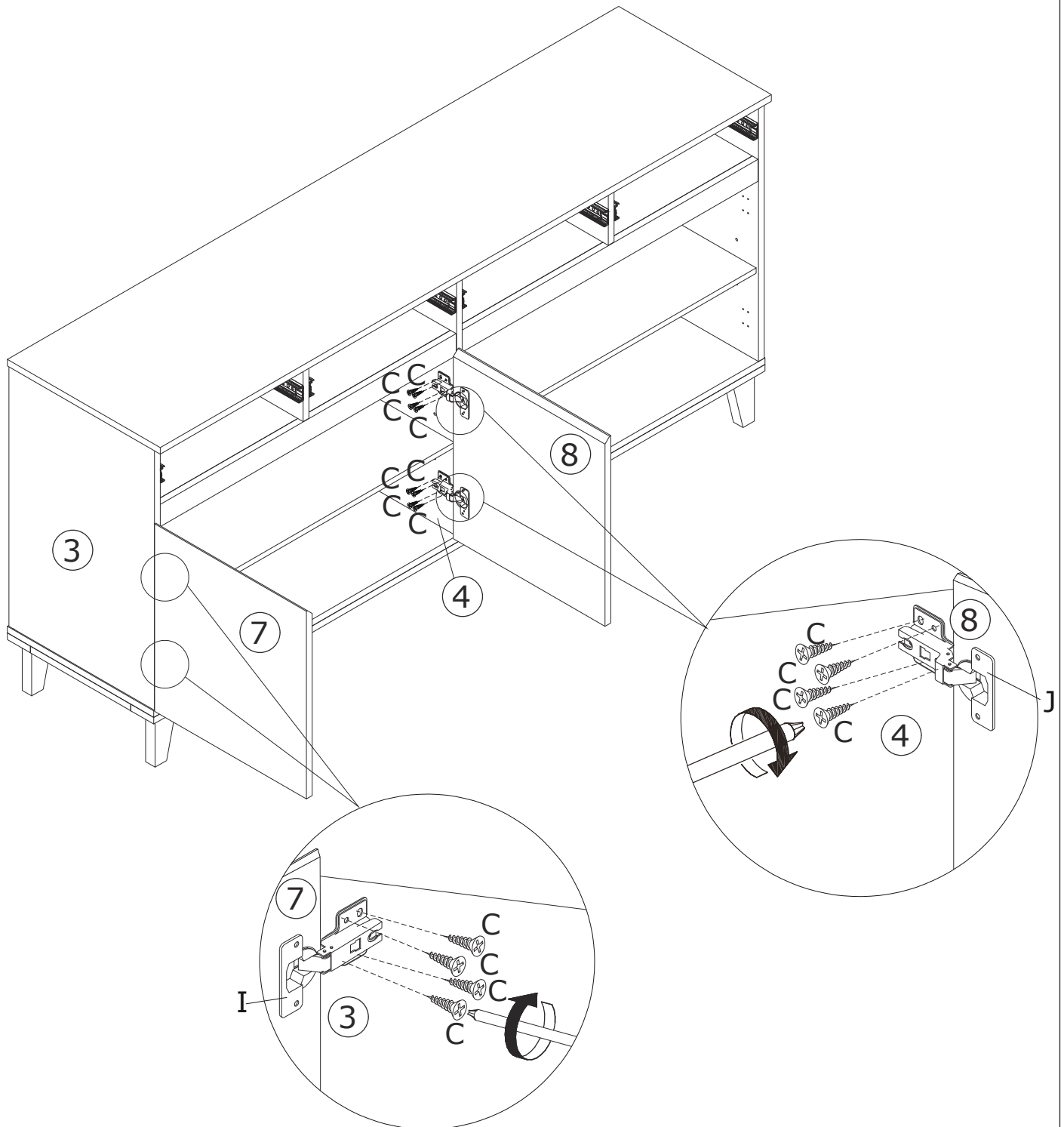

19

C x 8



M3.5 x 14 mm

I x 2

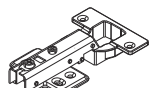

QG

J x 2

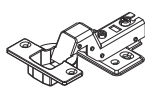

BG

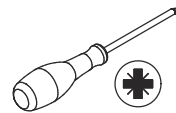

Fix hinge(J) to plate 9 using screw(C).

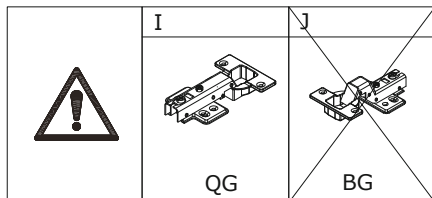
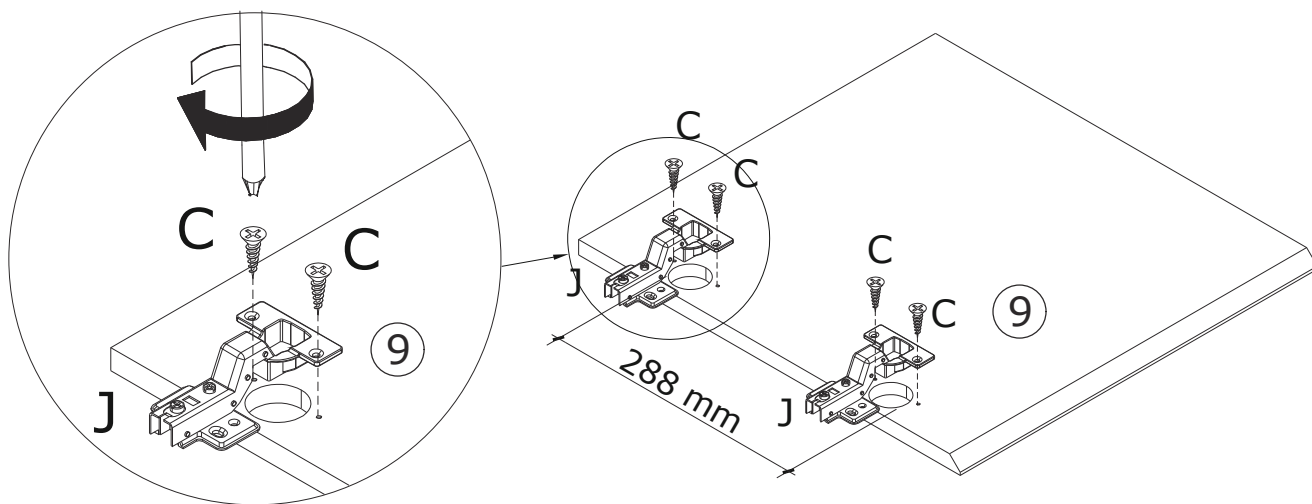
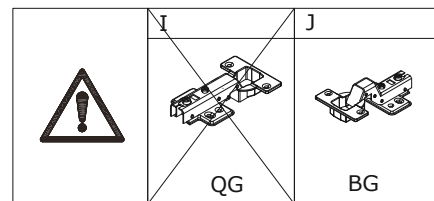

Fix hinge(I) to plate 10 using screw(C).

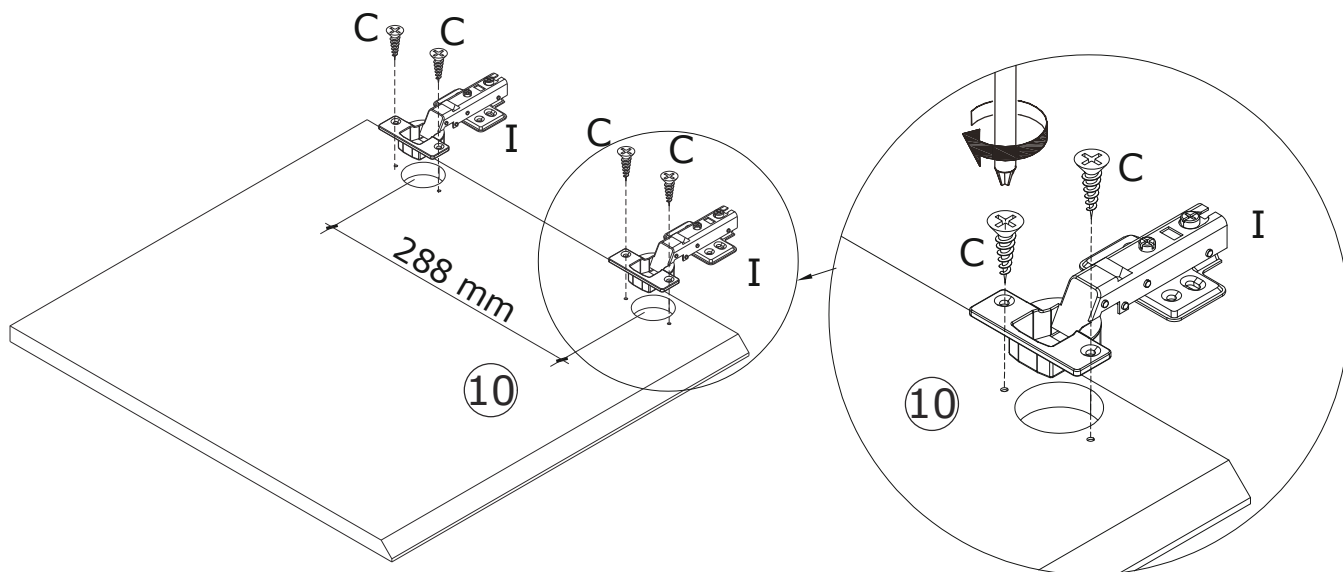

20

C x 16



M3.5 x 14 mm

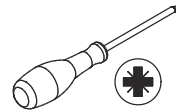

Assemble door 9 to plate 4 , door 10 to plate 5 by fixing hinge using screw(C) as shown.

Please don't use an electric screwdriver which may cause boards crack.

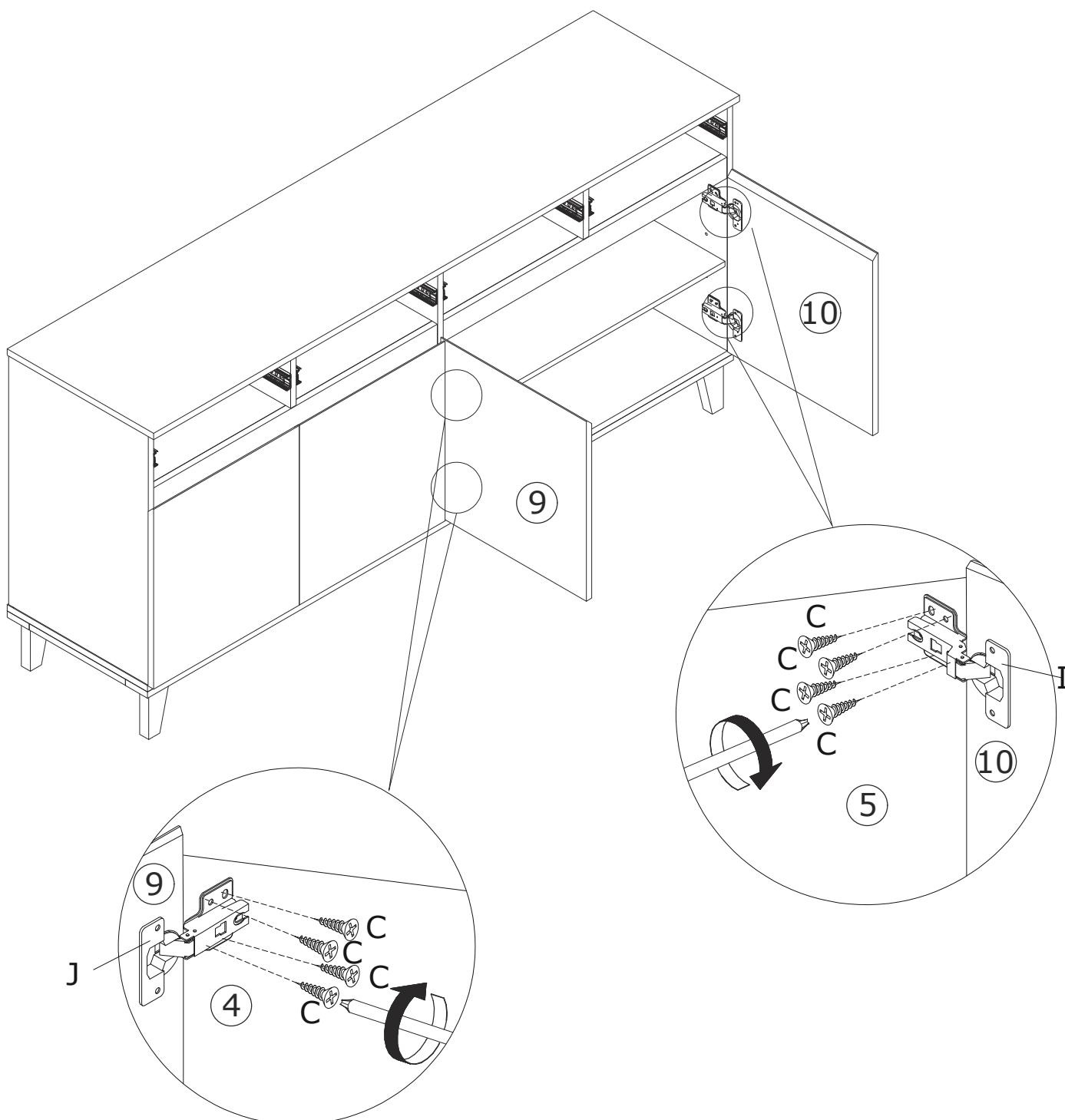

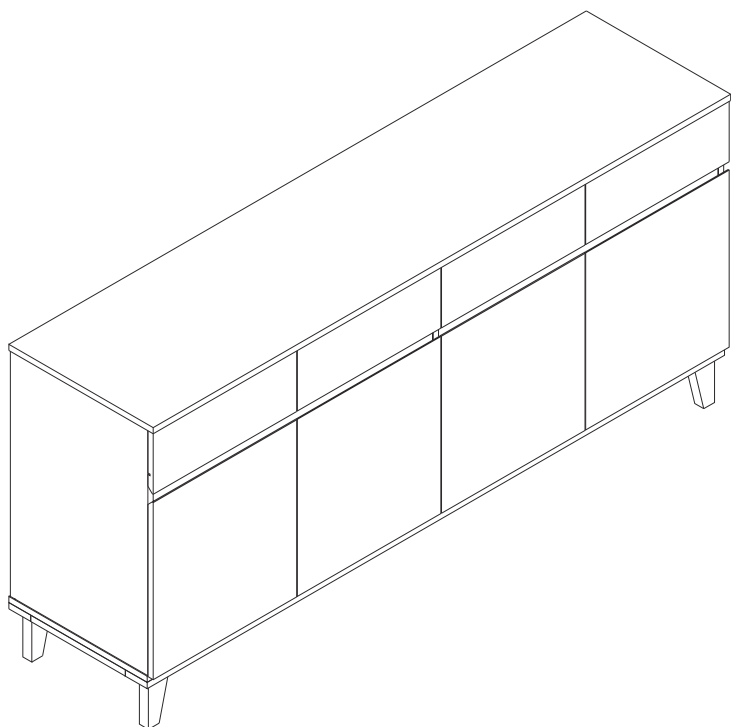

If there is misalignment after you install,
adjust the screw to the best condition

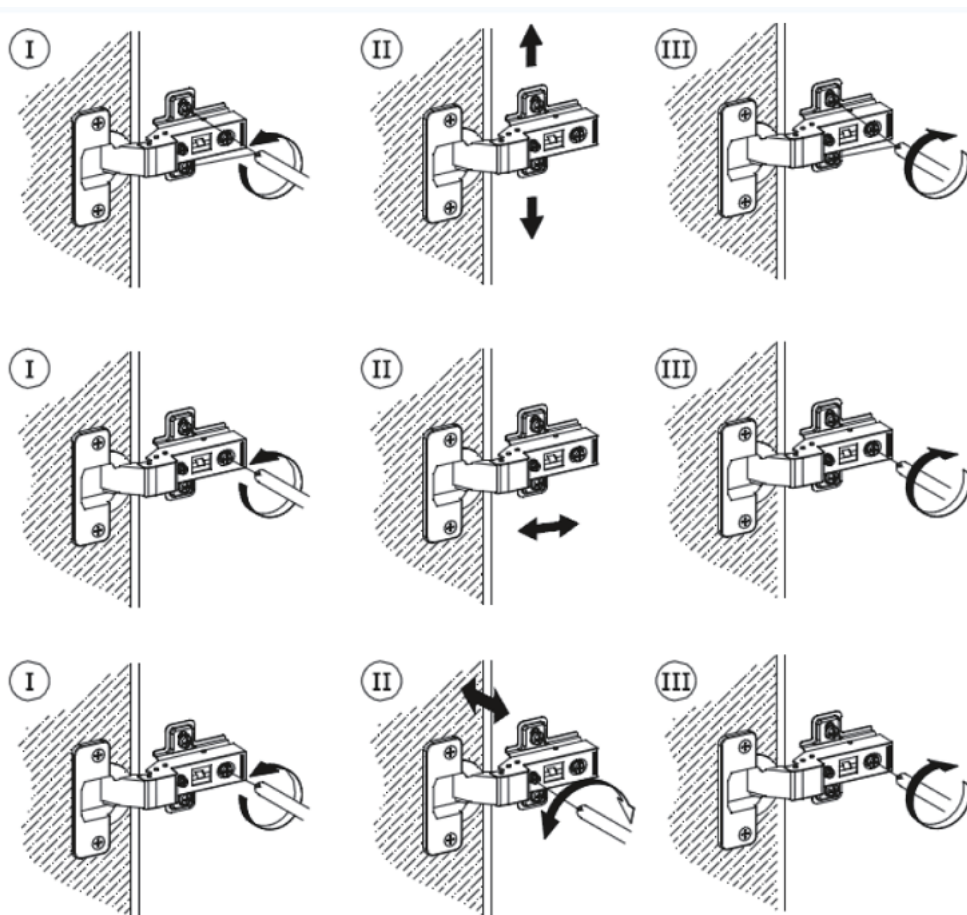
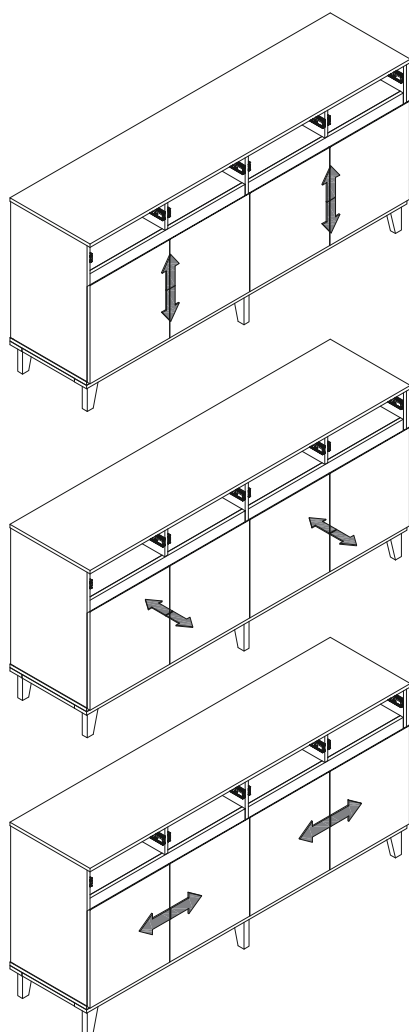

21

D x 16



M5 x 40 mm

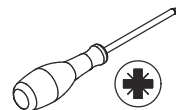

Assemble plate 22,23 to plate 24 and plate 25 respectively using screw(D) as shown.

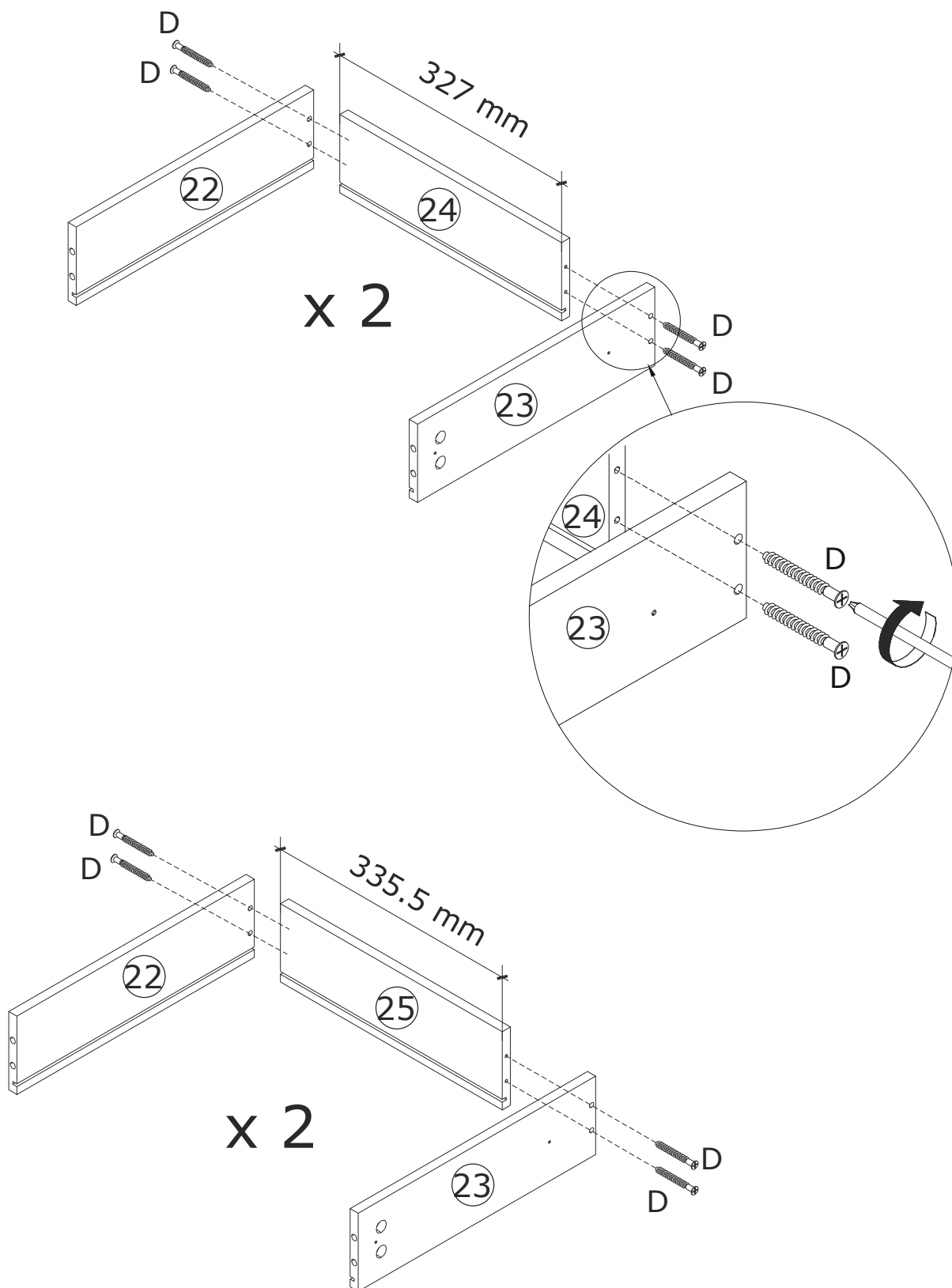

22

Insert the plate 26 27 along the grooves as shown.

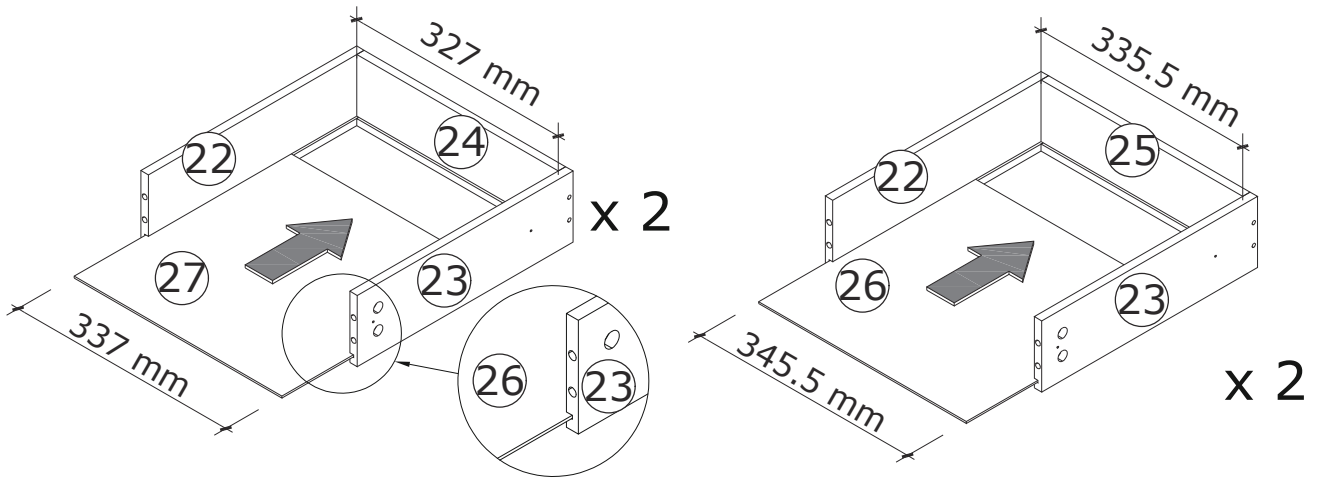

23

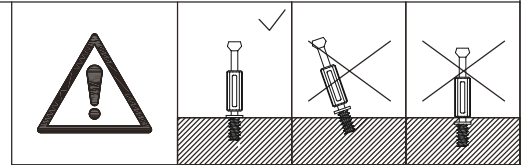
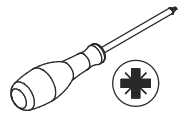
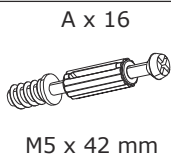

Insert quickfit screw(A) into plate 19, 21, 20(x2) as shown.

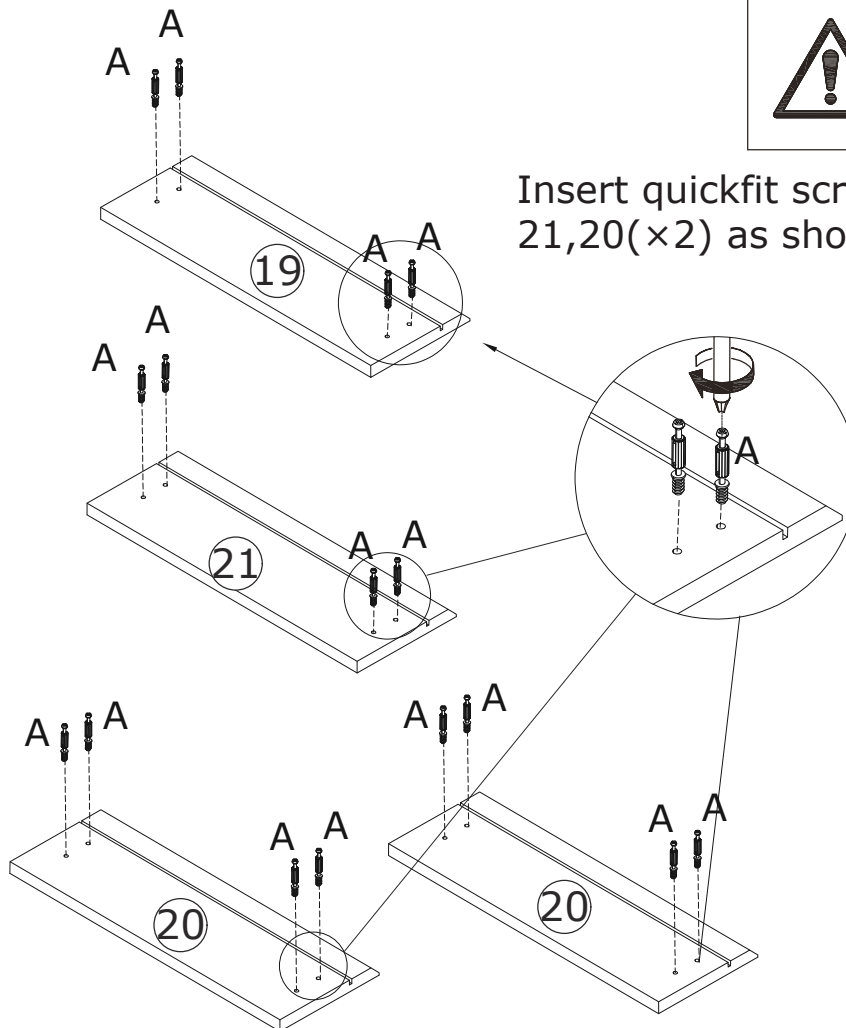

24

B x 16



Ø 15 x 10 mm



Assemble 4 drawers and turn cam lock(B) clockwise to tighten as shown.

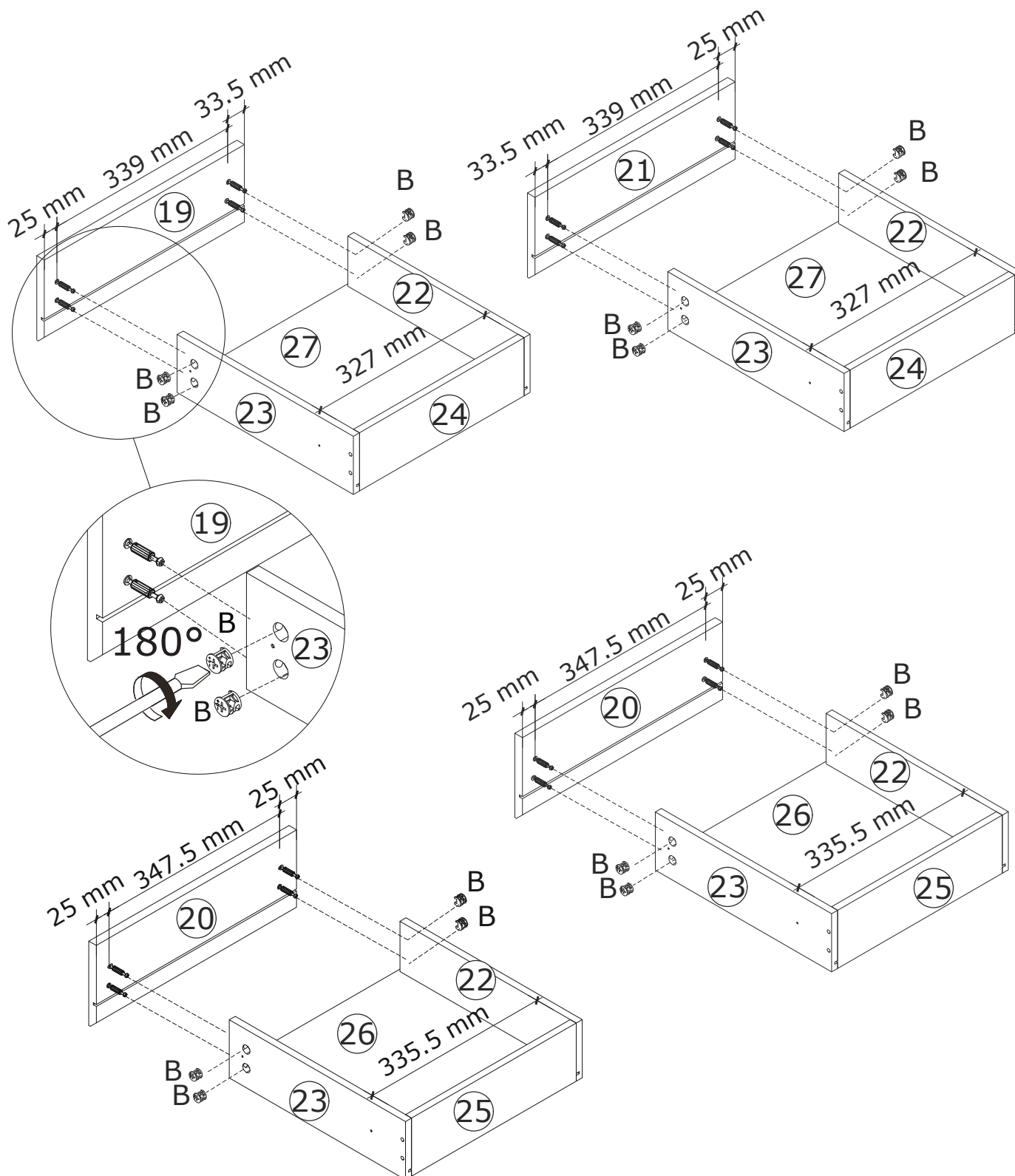
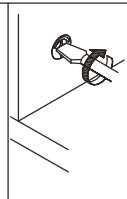
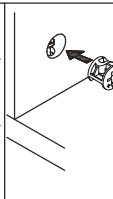
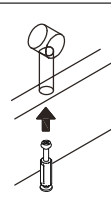

25

L x 16
M3.5 x 12 mm

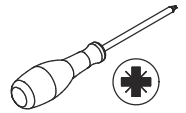

Fix runner 28 to plate 22 and 23 using screw(L) as shown.

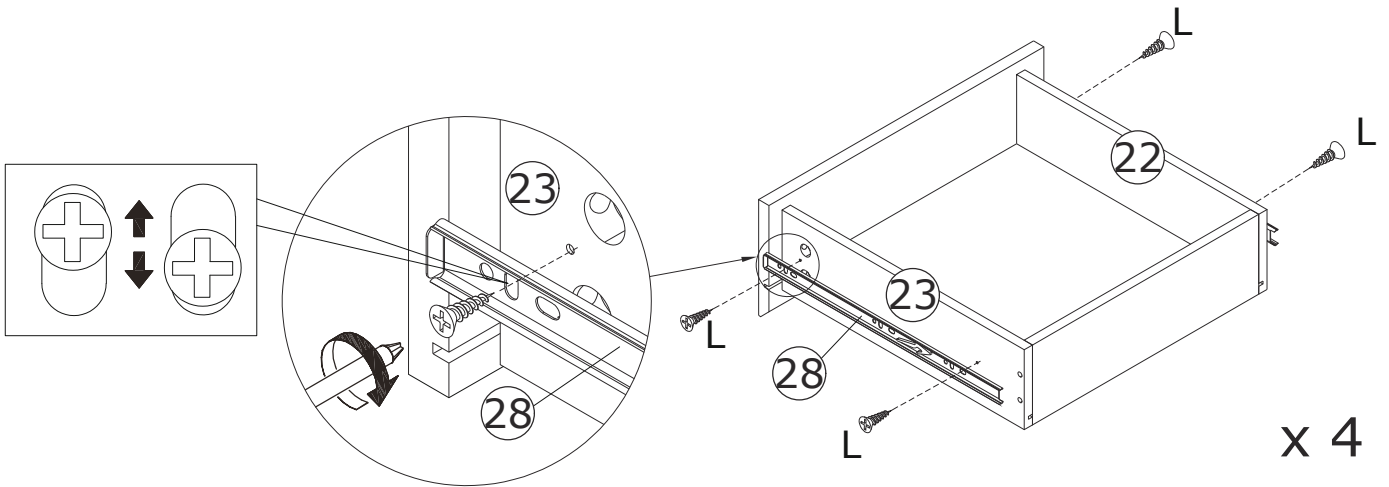

26

Align rails and slide slightly.

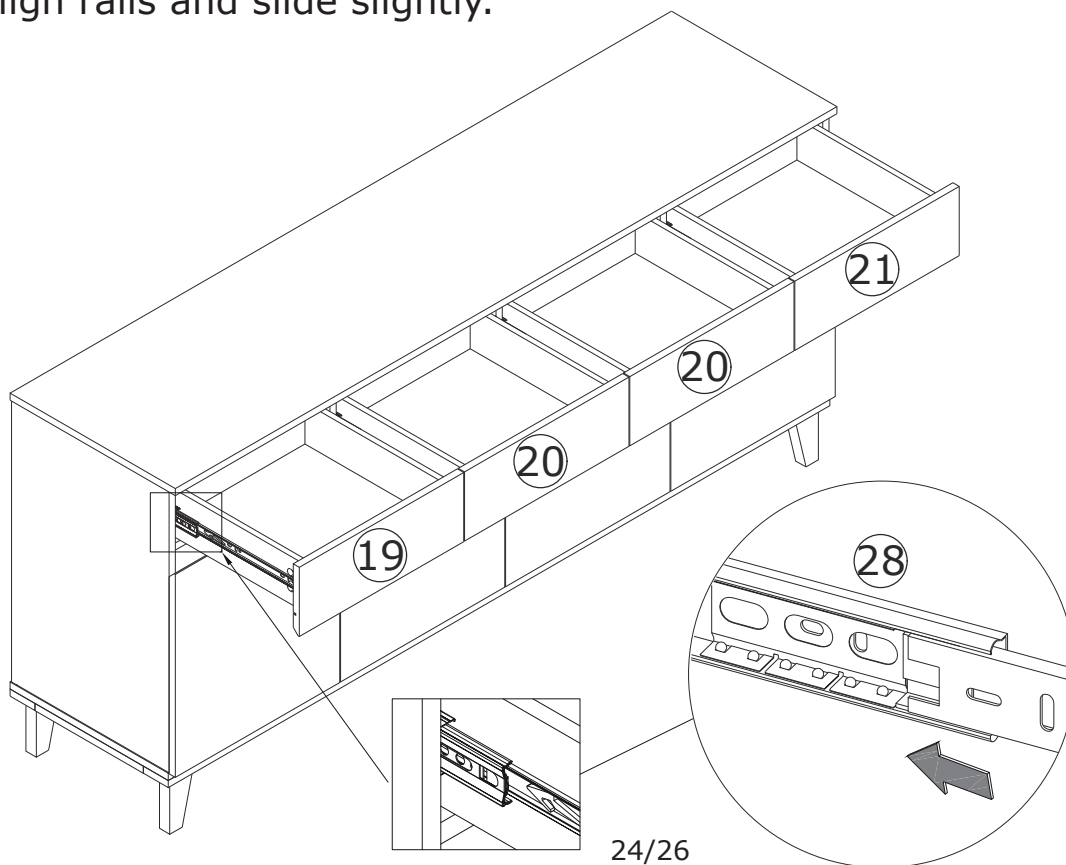

27



Reinforce back plate using part(M) and screw(C) as shown.

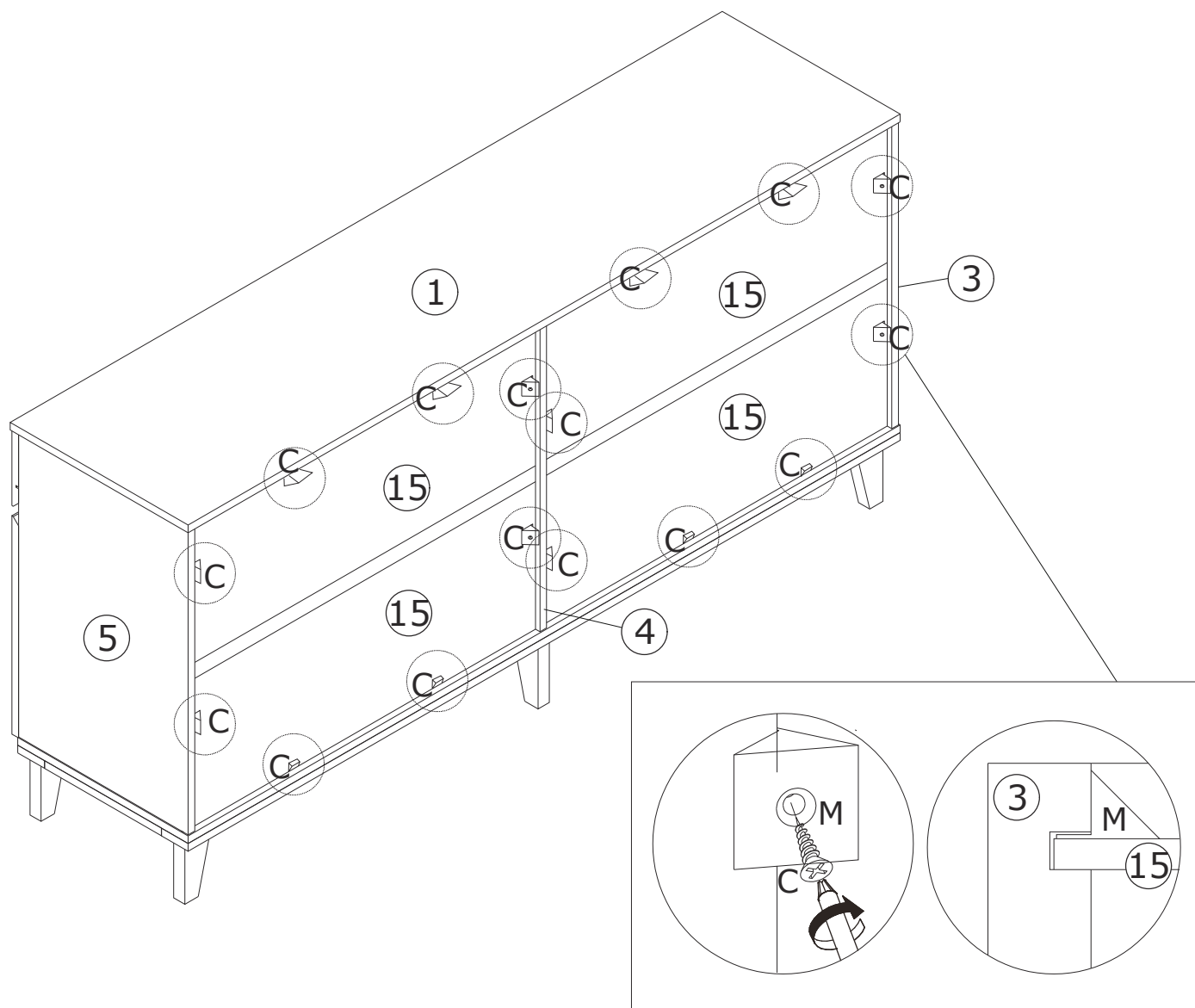

28

C x 4



M3.5 x 14 mm

K x 2 SETS

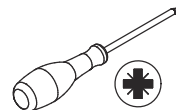

Install anti-tipping device as your required.

WALL

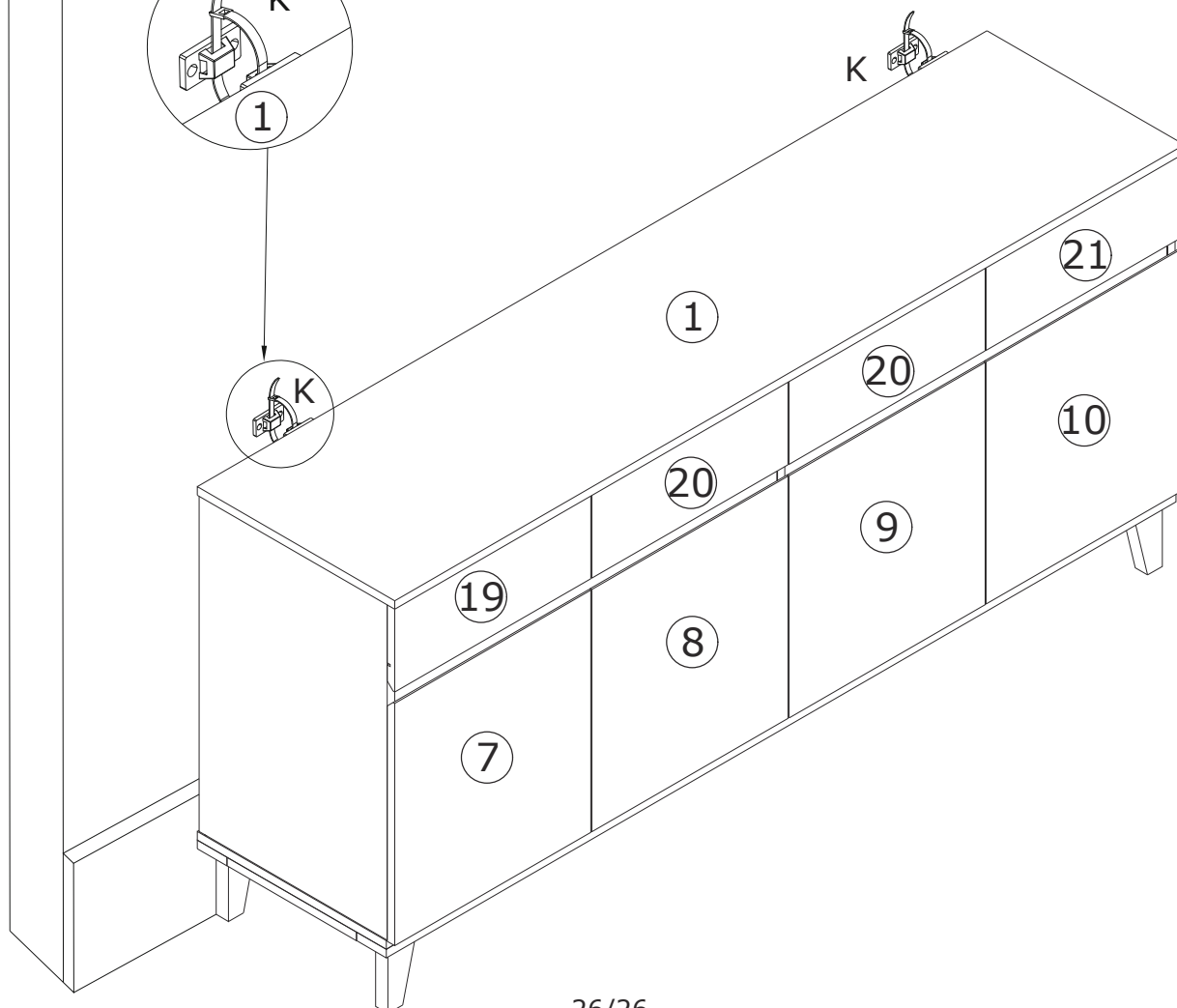
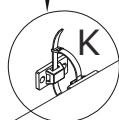
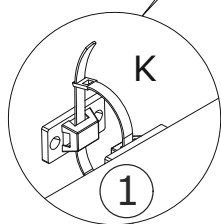
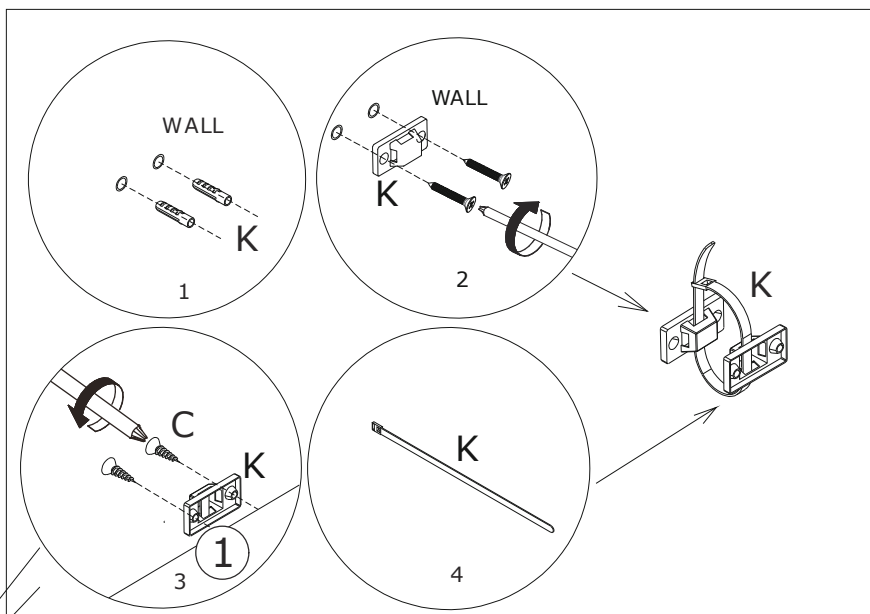

WARRANTY

WARRANTY CLAIMS

- There is a 30-day warranty for broken furniture or any other problems that do not work properly. The warranty will start from the date of purchase which must be verified by proof of purchase.
- Before making a claim, we may be able to answer your query, simply call us. Please leave your purchase order number, along with some details of the problem, if you want a replacement part. We will arrange within 48 hours. If there is out of stock, we will reply with a shipping date.
- The product must be used in accordance with the instructions provided. For health reasons.
- For other reasons, if the furniture needs to be returned, it must be cleaned and dried and operated within 30 days of receipt.

Type of Warranty Claim

- Failure to follow the furniture instructions will invalidate the warranty. Attention please.
- Does not include damage during installation, but includes damage during transportation.

Scope of responsibility

- Shall not bear any responsibility for misuse or user damage and / or loss of parts during the installation of furniture.
- After using, the damage and scratches of the furniture are not covered by the warranty.

The Warranty Relates to All Bought in The Us and Covers The Following Areas

- Sheet parts: 1 month from the date of purchase.
- Electrical parts: 1 month from the date of purchase.

RETURNS

CHANGED YOUR MIND AND NEED TO RETURN YOUR ITEM?

PLEASE FOLLOW THE BELOW INSTRUCTIONS:

- If you have purchased and have simply changed your mind, follow the retailer's instructions for returns.

DEFECTIVE ITEMS

- If your item is defective in any way, i.e. it doesn't work but you can't identify why, in the first instance, please call us.

DAMAGED ITEMS

- If you receive an order with obvious shipping damage from the retailer, then we suggest the delivery is refused. If the delivery has been accepted and then shipping damage is found, please follow the specific instructions advised by the retailer.
In all circumstances please save all packaging material and paperwork for the order. Please be aware that if you dispose of packaging material or attempt to return the merchandise without contacting the fulfiller, you jeopardise your chances of making a claim, and you may not receive a credit for the return.