

# COFFEE MAKER

# INSTRUCTION MANUAL

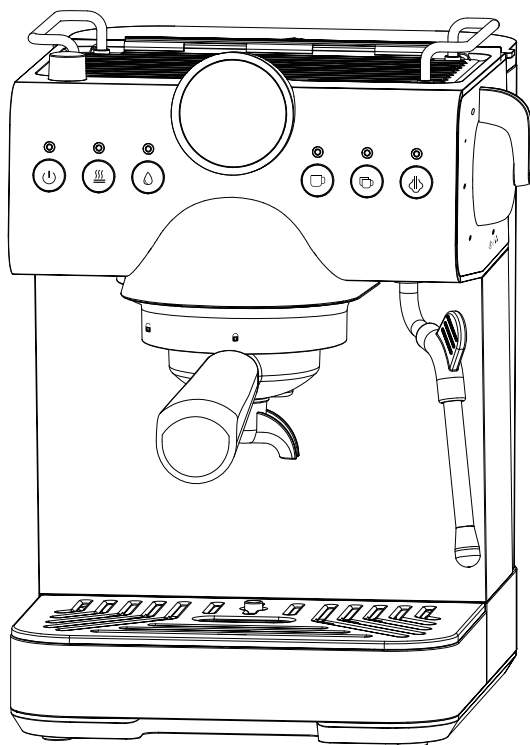

MODEL NO.: CM5712-UL  
ITEM NO.: CM8057-SILVER

**Thank you for purchasing this product! Please read this manual thoroughly before using and save it for future reference. If you have any question about the product, please contact us via our customer service number:  
661-435-8826.**



# IMPORTANT SAFEGUARDS

Before using the electrical appliance, the following basic precautions should always be followed including the following:

1. Read all instructions.
2. Before using, check that the voltage of wall outlet corresponds to rated voltage marked on the rating plate.
3. This appliance has been incorporated with a grounded plug. Please ensure the wall outlet in your house is well earthed.
4. To protect against fire, electric shock and injury to persons, do not immerse cord or plug in water or other liquid.
5. Remove plug from wall outlet before cleaning and when not in use. Allow appliance cool down completely before taking off, attaching components or before cleaning.
6. Do not operate any appliance with a damaged cord or plug or after the appliance malfunctions, or is dropped or damaged in any manner. Return appliance to the nearest authorized service facility for examination, repair or electrical or mechanical adjustment.
7. The use of accessory attachments not recommended by the appliance manufacturer may result in fire, electric shock or injury to persons.
8. Place appliance on flat surface or table, do not hang power cord over the edge of table or counter.
9. Ensure the power cord do not touch hot surface of appliance.
10. Do not place the coffee maker on hot surface or beside fire in order to avoid to being damaged.
11. To disconnect, remove plug from wall outlet. Always hold the plug. But never pull the cord.
12. Do not use appliance for other than intended use and place it in a dry environment.
13. Close supervision is necessary when your appliance is being used near children.
14. Be careful not to get scalded by the steam.
15. Do not touch the hot surface of appliance (such as steam wand, and the filter just boiling). Use handle or knobs.
16. Do not let the coffee maker operate without water.
17. Do not use the water tank at temperatures higher than 158°F or use the tank to store food.
18. Do not remove the metal funnel when appliance is brewing coffee or making steam.
19. Connect plug to wall outlet before using and turn any switch off before plug is removed from wall outlet.
20. This appliance is not intended for use by persons (including children) with reduced physical, sensory or mental capabilities, or lack of experience and knowledge, unless they have been given supervision or instruction concerning use of the appliances by a person responsible for their safety.
21. Children should be supervised to ensure that they do not play with the appliance.
22. This appliance is intended to be used in household and similar applications such as:
  - staff kitchen areas in shops, offices and other working environments;
  - farm houses;
  - by clients in hotels, motels and other residential type environments;
  - bed and breakfast type environments.

23. Do not use outdoors.
24. Save these instructions.
25. If you do not use the product for a long time, you need to turn on the power and then release steam for 3 minutes before leaving this product.
26. If you cut off power during steam release, residual heat will make product continue to release steam for a length of time, the product will stop releasing steam immediately once you turn off steam knob.

# SAVE THESE INSTRUCTIONS

## KNOW YOUR COFFEE MAKER (The product is subject to change without prior notice)

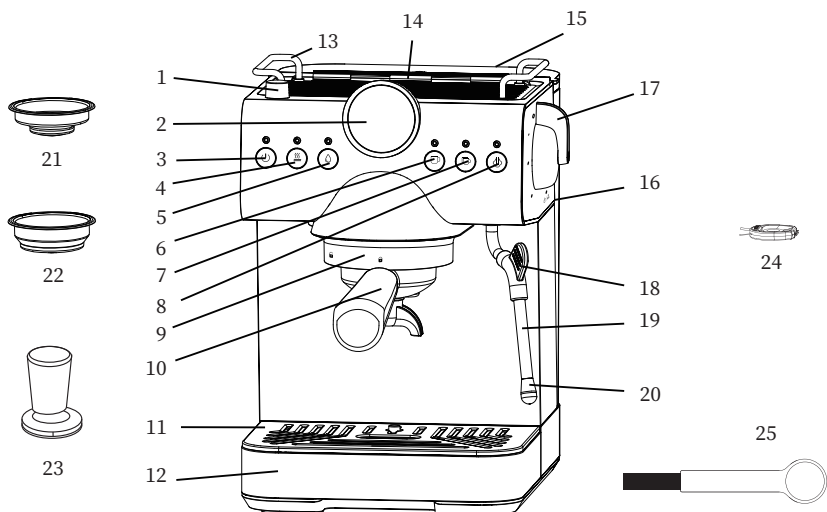

- |                         |                                        |
|-------------------------|----------------------------------------|
| 1.Indicator light       | 2.Digital tube display                 |
| 3.Power button          | 4.Coffee button                        |
| 5.Cold brew button      | 6.Single cup button                    |
| 7.Double cup button     | 8.Steam button                         |
| 9.Funnel bracket        | 10.Funnel                              |
| 11.Drip plate           | 12.Drip tray                           |
| 13.Handle               | 14.Top tray (warm and place the parts) |
| 15.Water tank cover     | 16.Water tank                          |
| 17.Steam/Hot water knob | 18.Steam tube handle                   |
| 19.Steam tube           | 20.Steam tube nozzle                   |
| 21.Single cup filter    | 22.Double cup filter                   |
| 23.Tamper               | 24.Cleaning probe                      |
| 25.Cleaning brush       |                                        |

## Digital Tube Display Instructions

- Brew coffee time
- System pressure (pressure value flashes when water shortage occurs)
- Brew coffee volume
- System temperature
- Single-cup coffee
- Double-cup coffee
- Brewing coffee process

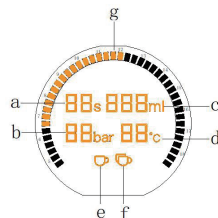

## BEFORE THE FIRST USE

To ensure the first cup of coffee tastes excellent, you should rinse the coffee maker with warm water as follows:

- Remove the rubber plug from the bottom of the water tank.
- Pour water into water tank, the water level should not exceed the “MAX” mark in the tank.  
**NOTE:** The appliance is supplied with a detachable tank for easy cleaning, you can fill the tank with water firstly, and then put the tank back into the appliance.
- Put the single or double cup filter into the funnel (no coffee contained). According to the corresponding grooves of the funnel bracket, insert the funnel into it at the unlocking icon position, then fix it into coffee maker firmly through turn it anticlockwise until it is at the locking icon position.
- Place a jug on the drip plate. Make sure the knob is at the “OFF” position.
- Connect to power supply, press the power button once, the power indicator illuminates and the machine turns on and enters standby mode.
- Press the coffee button once, the coffee indicator flashes, the indicator light on the top of the appliance illuminates orange and the appliance enters preheat mode. The preheating is finished when the coffee indicator turns solid.
- Press the double cup button once, the double cup indicator lights on and water flows out from the funnel outlet after a while. When the appliance automatically stops pumping water and the double cup indicator lights off, you can clean the accessories and then pour out the wastewater.

## MAKE COFFEE INSTRUCTIONS

### 1. Preparation

- Remove the detachable tank to fill it with desired water volume, the water level should not exceed the “MAX” mark in the tank. Then place the tank into the appliance properly.
- Put the desired filter into the funnel (no coffee contained), insert the funnel into the funnel bracket and fix it.

### 2. Preheating & Cup-Warming

To make a cup of good hot Espresso coffee, we recommend you to preheat the appliance before making coffee, including the filter, funnel and cup, so that the coffee flavour can not be influenced by the cold parts.

- Plug the machine and press the power button once to turn on and enter standby mode. Make sure the knob is at the “OFF” position.
- Press the coffee button once to enter preheat mode. You can place the cup on the machine top to warm it when the machine is in preheat mode. When the coffee indicator stays solid, the preheating is finished.

- For the better extraction effect, put the cup under the brewing head, then press the single or double cup button to brew hot water.
- After about 10 seconds, press the single or double cup button again to terminate the brewing. Pour the water out and place the warmed espresso cup back on the drip plate for the followed coffee extraction.
- Turn the funnel clockwise to remove it from the appliance. Use a clean cloth to dry the filter.

### 3. Espresso Extraction

A cup of good coffee should keep the balance of acidity, aroma, concentration, and bitterness. And a cup of quality espresso requires appropriate coffee powder coarseness and tampering force.

- After drying the filter, you can pour the freshly ground coffee powder into the filter and use the tamper to tamp the powder gently to make it flat.

**NOTE:** It is recommended to add 12g powder for single-cup coffee, and 16g for double-cup coffee. The funnel filled with excessive powder will fail to be installed to the appliance, and the coffee flow rate will be slowed, affecting coffee taste and causing large water content in the coffee grounds.

- Wipe off the excess coffee powder from the edges of the funnel and filter, then insert the funnel into the funnel bracket and fix it.

### 4. Brewing

- After preheating, press single-cup or double-cup button once, coffee will flow out from the outlet. The digital tube display will show brewing time, set brewing volume (The set outflow in single cup mode is 40ml, and the set outflow in double cup mode is 80ml. But the actual volume of coffee may vary.), system pressure, brewing time (in the form of a circular indicator bar) and water temperature.

**NOTE:** That turning the knob when the machine is brewing or preheating will cause the pump to stop working, and the steam indicator will quickly flash for alarm.

- When the machine is brewing, you can press single-cup or double-cup button to stop the brewing any time.

**WARNING:** Do not leave the coffee maker unattended during the coffee brewing, as you need to operate manually sometimes.

- When the set coffee volume is reached, the appliance stops automatically and the coffee production is finished.

**NOTE:** The optimal brewing pressure for espresso is 8-13 bar. A cup of good coffee can be made when the digital tube display shows the optimal pressure range. If the current pressure is above or below the standard, please adjust the powder coarseness or powder tampering pressure.

**NOTE:** When water shortage occurs, the system pressure value flashes after one brewing cycle. Refill the tank and press the single-cup or double-cup button to restart the brewing.

- Wait for a moment after coffee production, and turn the funnel clockwise to remove it from the appliance, pour out the coffee grounds.
- Allow the funnel and filter to cool sufficiently, then rinse thoroughly with clean water.

**WARNING: Remember to cool down the heated filter to avoid scalds.**

**NOTE:** If you want to make cold drinks only, notice that cold water of about 50-59°F needs to be added to the tank. The cold brew mode does not require preheating or cup-warming. Press the cold brew button directly after turning on the machine, the cold brew indicator stays solid and the indicator light on the top turns to be blue. Then press the single-cup or double-cup button to brew cold water.

## MAKE CAPPUCCINO / FROTH MILK INSTRUCTIONS

You will get a cup of cappuccino when you top up a cup of espresso with frothed milk.

1. Prepare a milk cup.
  2. When the machine is in standby mode, press the steam button once to start the steam preheat, the steam and coffee indicators start to flash. After a while, the coffee indicator will stay solid and the steam indicator keeps flashing. When the steam indicator stays solid, the coffee indicator will go out, meaning that the steam preheat is completed.
  3. Before milk frothing, use an extra empty cup and turn the knob to “☉/▲” to collect the steam for 10s until the steam dispensing becomes stable.
  4. Prepare about 150ml refrigerated whole milk (temperature of 5-10℃ recommended) and add in the latte art pitcher.
  5. Extend the steam tube into milk. Turn the knob to “☉/▲”, and the steam is emitted from the steam tube. Move the steam tube to the position close to the surface of the milk, and tilt the steam tube at a certain angle with the milk to allow air enter to the liquid and start frothing.
- NOTE :** In the process, when water shortage occurs, the other 5 indicators except the power indicator will flash quickly for alarm. When the knob is turned off, the alarm is canceled and the machine return to standby mode.
6. Notice that the maximum steam release time is 180 seconds, otherwise the steam indicator will flash quickly for alarm. When you get the desired foam, turn the knob back to “OFF” position.
- WARNING:** Clean the steam tube nozzle in time with a damp cloth after steam dispensing, be careful of scalds!
7. Pour the milk and foam into the prepared espresso to make a Cappuccino. You can also add an appropriate amount of sugar or sprinkle some cocoa powder on top according to your taste.

## HOT/ COLD WATER FUNCTION

After preheating, turn the knob to “☉/▲” position, the coffee indicator and the indicator light on the top of the machine are off and the steam indicator flashes, the hot water will dispense from steam tube. As for cold water, directly turn the knob to “☉/▲” position in the cold brew mode, the cold water will dispense from steam tube.

When desired amount of water is got, turn the knob off. Notice that when hot/cold water release for over 60 seconds, the steam tube will automatically stop dispensing and the steam indicator will flash quickly for alarm.

**NOTE:** When the steam tube is brewing (including in the cold brew mode), if the water shortage occurs, the other 5 indicators except the power indicator quickly flash for alarm. After resetting the knob, the unit will return to the standby mode and the alarm canceled.

## STOP / SLEEP FUNCTION

1. In any state after the machine is powered on, if there is no operation within 25 minutes, the machine will enter sleep mode. At this time, all indicators will be extinguished, the heating element will not be heated, and the whole machine will be powered off. Press any button to exit the sleep mode and restart the machine.

## CLEANING AND MAINTENANCE

1. Unplug and cool down the machine completely before cleaning.
2. Wash the body of the coffee maker with a moisture-proof sponge, and regularly clean and dry the water tank, drip tray, and drip plate.

**NOTE:** Do not use alcohol-based or solvent-based cleaners for cleaning. Do not immerse the main unit in water.

3. Remove the funnel and pour out the coffee grounds. Clean the funnel and filter with cleaning solution and cotton cloth, and rinse the parts.
4. Use the cleaning brush to clean the inside of the funnel bracket.
5. Clean the steam tube nozzle and the hole of filter with cleaning probe on a regular base.
6. Rinse all the accessories under water and dry thoroughly.

## DESCALING - CLEANING MINERAL DEPOSITS

### • Descaling Reminder

1. When the cumulative water consumption of coffee, steam, and hot water functions exceeds 30L, all indicators will flash 5 times at the same time after each power on to indicate the need for descaling, and then return to normal.
2. If you do not manually cancel the reminder after it appearing 3 times, the reminder will be automatically removed.
3. To manually cancel the descaling reminder and clear the cumulative water consumption, please long press the power button and steam button at the same time for 3s, all indicators quickly flash for 3 times.

### • Manual Descaling

1. Add an appropriate amount of descaling agent to the water tank, and long press the steam button and double cup button at the same time for 3s after each power on. The power, steam and double cup indicators light up and the unit enters descaling mode.
2. If the preheating has been completed, the machine starts pumping water. After about 13 minutes, the water pump completes totally 3 rounds of brewing hot water (each lasting 45 seconds) and 2 rounds of shutdown (each lasting 5 minutes).
3. During the descaling process, it is ineffective pressing the steam or double cup buttons, you can press the power button to stop descaling. But the descaling reminder will occur again the next time you turn the machine on.
4. If you turn the knob to “☉/☼” during the process, all indicators alert and the descaling process stops. After the knob is reset, the descaling process continues.
5. At the end of the process, the double cup and single cup indicators flash quickly. Please turn the knob to “☉/☼”, the two indicators flash slowly, the steam tube starts dispensing hot water.
6. Turn off the knob within 1 minute, otherwise all the indicators will flash quickly. The indicators flash for 5 times, indicating that the descaling is completed, the cumulative water consumption is cleared, and return to standby mode.
7. It is recommended to fill the water tank with clean water to the MAX level and repeat the above steps twice to remove residual detergent and odors.

## TROUBLE SHOOTING

Symptom	Cause	Corrections
The metal parts in the tank have rust.	The detergent is not recommended type. It may corrode the metal parts in the tank.	Use the detergent recommended by manufacturer.
Water leaks from the bottom of coffee maker.	There is much water in the drip tray.	Please clean the drip tray.
	The coffee maker is malfunction.	Please contact with the authorized service facility for repairing.
Water leaks out of outer side of filter.	There is some coffee powder on filter edge.	Get rid of them.
Acid (vinegar) taste exists in Espresso coffee.	No clean correctly after cleaning mineral deposits.	Clean coffee maker as "BEFORE THE FIRST USE" for several times.
	The coffee powder is stored in a hot, wet place for a long time. The coffee powder turns bad.	Please use fresh coffee powder, or store unused coffee powder in a cool, dry place. After opening a package of coffee powder, reseal it tightly and store it in a refrigerator to maintain its freshness.
The coffee maker cannot work any more.	The power outlet is not plugged well.	Plug the power cord into a wall outlet correctly, if the appliance still does not work, please contact with the authorized service facility for repairing.
The steam cannot froth.	The steam ready indicator is not illuminated.	Only after the steam ready indicator is illuminated, the steam can be used to froth.
	The container is too big or the shape is not fit.	Use high and narrow cup.
	You have used skimmed milk.	Use whole milk or half-skimmed milk

***Do not take apart the appliance by yourself if the cause of failure is not found, you had better contact certified serving center.***

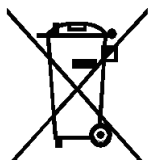

## Environment friendly disposal

You can help protect the environment!  
Please remember to respect the local regulations: hand in the non-working electrical equipment to an appropriate waste disposal center.

Thank you for purchasing this product! If you have any question about the product, such as missing parts, damaged products, product assembling, and operation, please contact us via customer service number: **661-435-8826**.

**IMPORTANT**

Please call our customer service department for any consulting:

**661-435-8826**

(8:30am - 5:30pm P.S.T.)

DATED PROOF OF PURCHASE IS REQUIRED FOR WARRANTY SERVICE.

**AVIS**

Veuillez appeler le service à la clientèle pour toutes questions au:

**661-435-8826**

(8:30am - 5:30pm P.S.T.)

PREUVE D'ACHAT ORIGINALE REQUISE POUR SERVICE DE GARANTIE.

**IMPORTANTE**

Sólo hay que llamar nuestro departamento de servicio al cliente en caso de tener preguntas o inquietudes:

**661-435-8826**

(8:30am - 5:30pm P.S.T.)

SE REQUIERE PRUEBA DE COMPRA CON FECHA PARA SERVICIO BAJO GARANTÍA.

**ROWAN ELECTRIC APPLIANCE LLC**

**Phone: 661-435-8826**

