



INSTALLATION MANUAL



Thermostatic Faucet

8074-1461000-769
20210615

1、New installations

- NOTE!!!
- 1. Supply lines should be purged to clean impurities before connecting the unit.
 - 2. The hot water supply should be connected to the left and the cold water supply to the right, when viewed from the operating position. If this is not taken into account can cause permanent damage to the cartridge.
 - 3. Screw connections and test for leaks.
 - 4. Using a spirit level on the cams, the mixer align horizontally, vertically and parallel to the wall.
 - 5. Warm reminder:
In the cold areas or the indoor temperature is less than 39°F in Winter, if no using the faucets for a long time, please turn off the inlet water valve and drain the remaining water inside the supply pipe, which can avoid the faucet damage caused by the expansion of the frozen water.

2、Installation Preparation

- 1. Read the instructions carefully before installing.
- 2. The installation must be performed by a qualified person.
- 3. Installation tools:

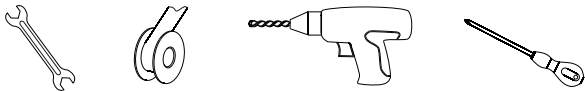

1

3、Accessory Drawing

No.	Description	Qty.
1	Thermostatic valve	1
2	Cover board	1
3	Diverter handle	1
4	Thermostatic bath	1
5	Elbow with hook	1
6	Shower hose	1
7	Handle shower	1
8	Shower head	1
9	Shower arm	1
10	Cover board	1
11	Allen-key	1
12	Nails bag	1
13	Elbow with hook	1
14	Ptfe tape	1
15	Water limited gasket	2

Optional

2

4、Dimentional drawing (1)

Unit: inch

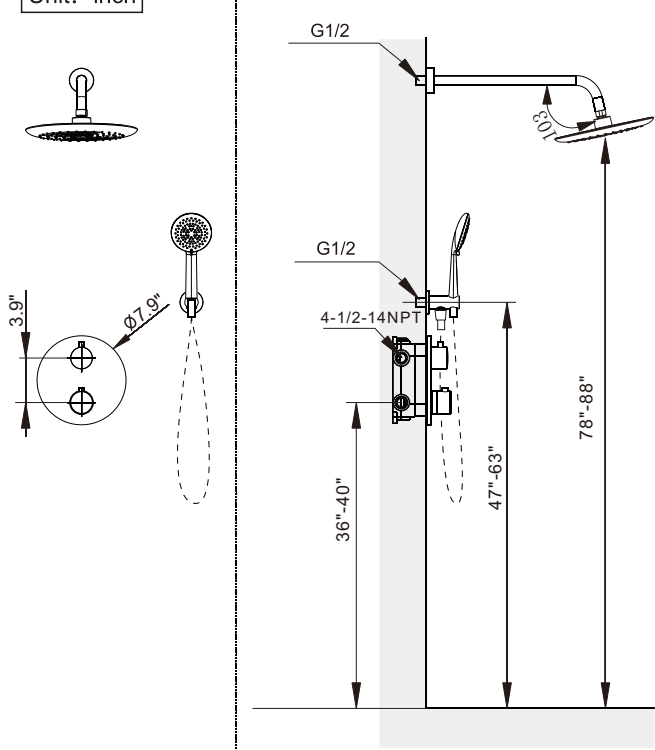

3

4、Dimentional drawing (2)

Unit: inch

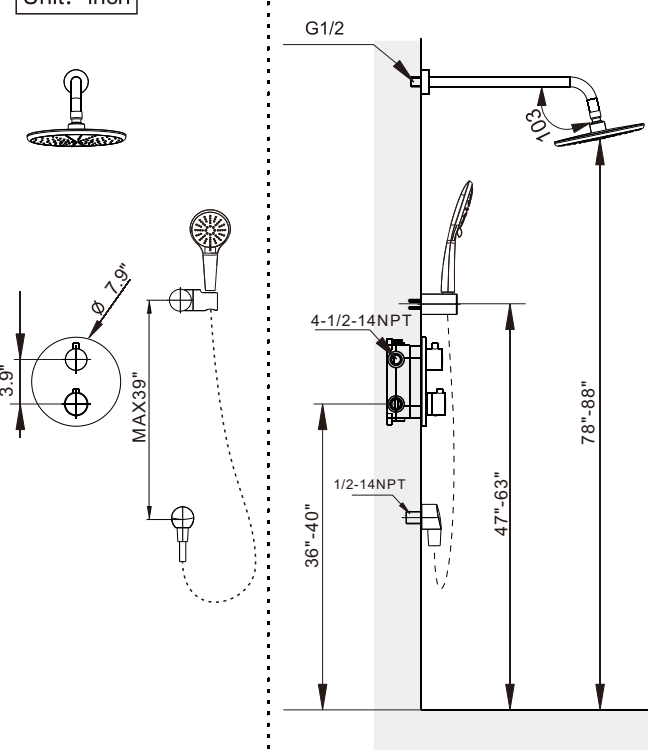

4

5、Chiseling wall diagram

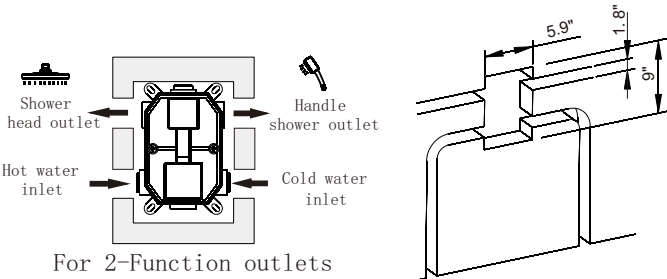

6、Pipe-connection diagram

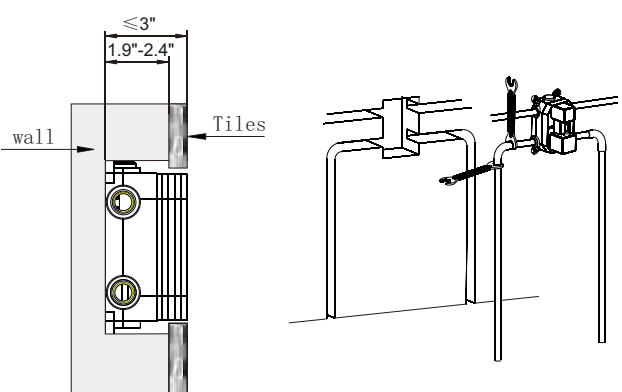

5

7、Water test and leak detection

- 1. After connecting all pipes, please dis-assembling the plastic protection cover, and switch on/off the cartridge, check all connections without any leakage, and all connections connecting to the required functional outlets.
- 2. Re-install the plastic protection cover to the valve.

Notice : the lines on thermostatic cartridge handle bar and gears must be at the same level.

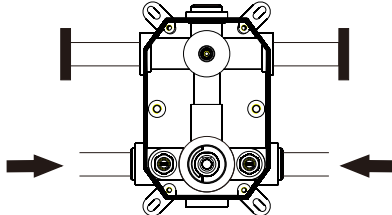
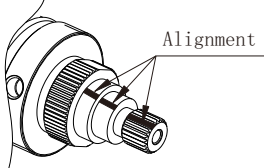

6

8、Wall tiling program

- 1. Use a parallel ruler to make sure the wall and valve being parallel.
- 2. Use a knife to cut the rest of plastic edge above the tiles.

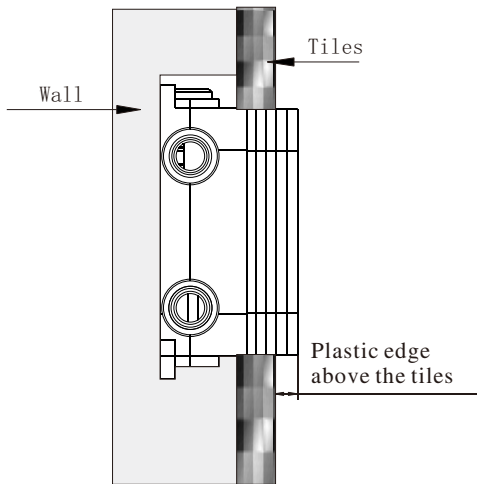

7

9、Cover and handle installation

- 1.Take off the plastic protection cover.
- 2.Put the cover board on the valve and tight the handle firmly.

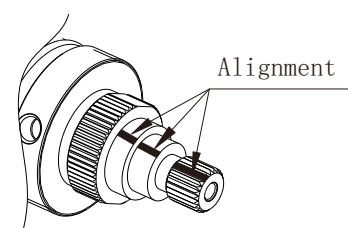
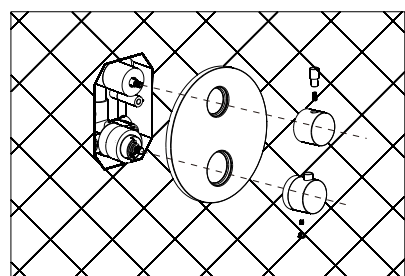

Notice :
The lines on thermostatic cartridge handle bar and gears must be at the same level.

8

10、Shower sets installation

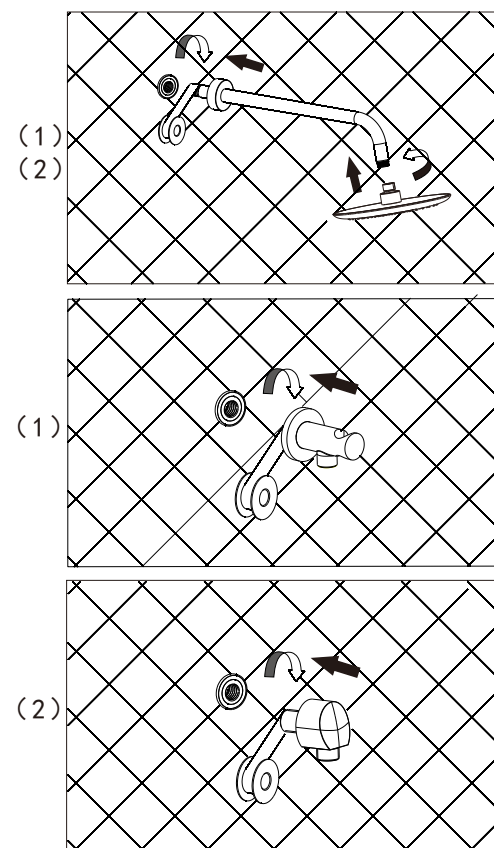

9

11、Handle shower installation

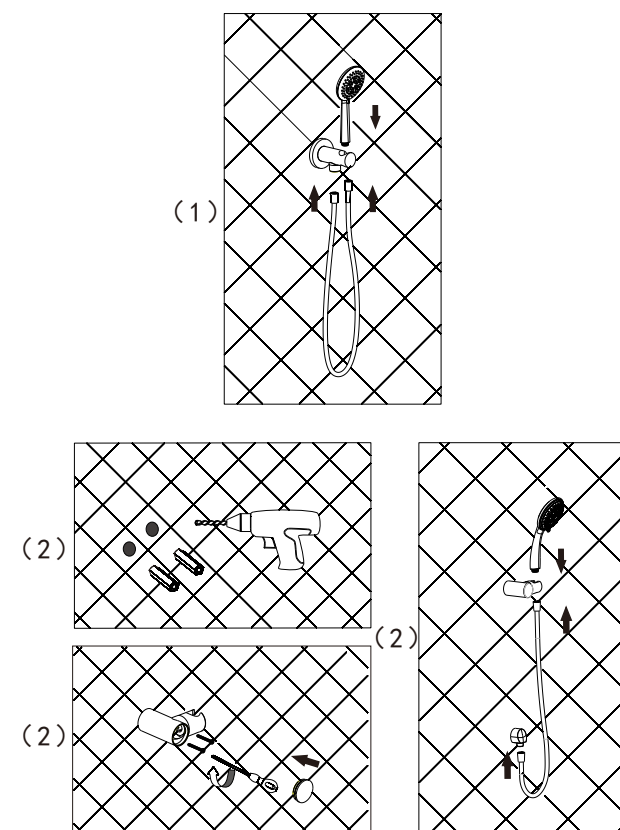

10

12、Temperature setting

The actual conditions, will have a significant impact on the temperature measured at the point of discharge.
In the event that the safety stop at 100°F does not establish the precise temperature, follow the instructions below

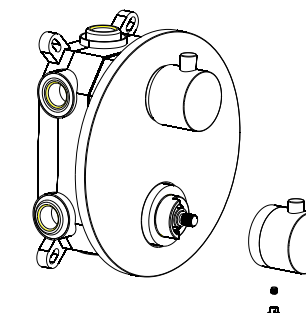

- 1.Remove the cover and loosen the allen screw.
2. Lower the temperature to 86°F position, opening the check valve and verify the water temperature using a thermometer.
- 3.Turn the thermostat knob and gradually raise the temperature of 86°F to 100°F , pull the plastic handle to the right and push it back towards the center position of 100°F .
- 4.Replace the screw, and then tighten the cap.

11

13、Temperature Limitation

- 1.The safety stop limits the temperature range of 100°F, by pressing the button on the thermostatic handle, the temperature limit can be canceled and get a higher temperature.

14、Operation

- 1.Adjust the temperature to the desired position by adjusting the thermostat knob on the left side (or down side) of the mixer valve as shown in detail below.
- 2.Open the valve on the right side (or top side) of the mixing valve, indicated in the detail below as flow handle . The flow can be increased by fully opening the valve, according to the instructions below.

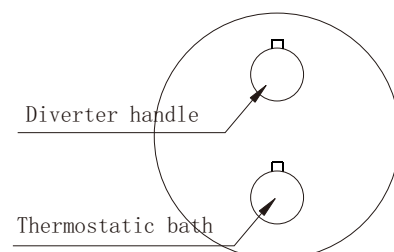

12

15、Thermostatic Cartridge

- 1.To ensure long-lasting functionality of this product, we recommend regular maintenance and care.
- 2.To get the thermostatic cartridge, inserted under pressure, loosen the screws on the underside of the body ,as shown in the image.
3. Impurities and lime must be cleaned with vinegar or softener, and lubricate the join with thermo-resistant grease or oils.
4. Proceed to re-install the cartridge making operation in reverse order

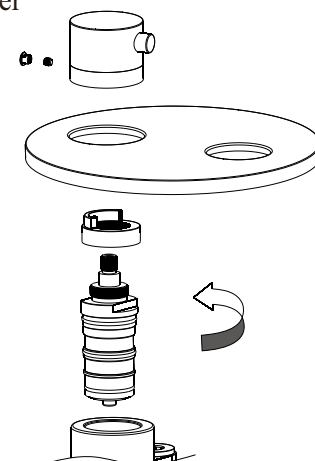

13

16、Cleaning & Maintenance

To keep the product clean & shining, follow the steps as follows:

- 1、 Flush with clean water & dry with soft cloth only;
- 2、 If any dirt, clean with soft liquid or transparent glass detergent.
- 3、 Do not use any scrubbing detergent, polisher, sand -cloth, paper tissue or scraper.
- 4、 Do not use acid detergent, insoluble & grain-like detergent or soap.

17、 Important notice

- 1.Users under age 14 must be accompanied by an adult otherwise young users may be scalded by hot water.
- 2.All users need to be careful when you turn cold water to hot water.

14

18、 Problems and Solutions

1. If there is no hot or cold water

Checking the pipes or filters are not clogged, that the pressures are balanced and that the thermostatic cartridge has no impurities.

2. If the thermostatic mixer does not generate the temperature of 100°F

Check that the conditions are correct, as described in section 2.TECHNICAL DATA.

Regulate again the thermostatic cartridge following the instructions in paragraph 5.TEMPERATURE SETTING.

3. If the movement of the thermostatic cartridge is hard/difficult

Leaving the water running, move the handle thermostatic repeatedly until the movement is smoother.

15