

DINGLILIGHTING

Depuley

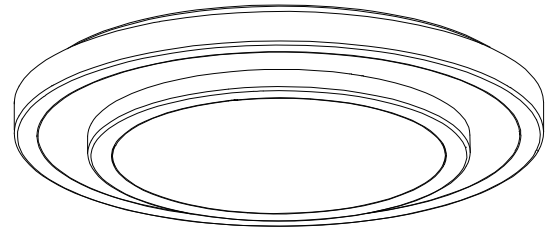



Product Instruction



Current range of telephone after-sales service
Language: English only Country: USA and Canada
Customers from other countries are advised to contact us via email.
AFTER-SALES SERVICE Email: all-support@depuley.com
AFTER-SALES SERVICE TEL: (888) 985-3006 Depuley
(888) 986-0020 DLLT
Mon-Fri 9am - 5pm (PST)

This Instruction Mainly Suitable for All Our Ceiling Light!!!

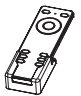
Part list:

		
[01]	[A]	[B]
 Optional		
[C]	[D]	[E]

You will need:

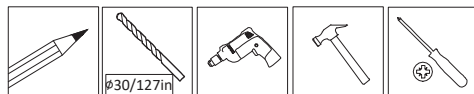

Installation Steps:

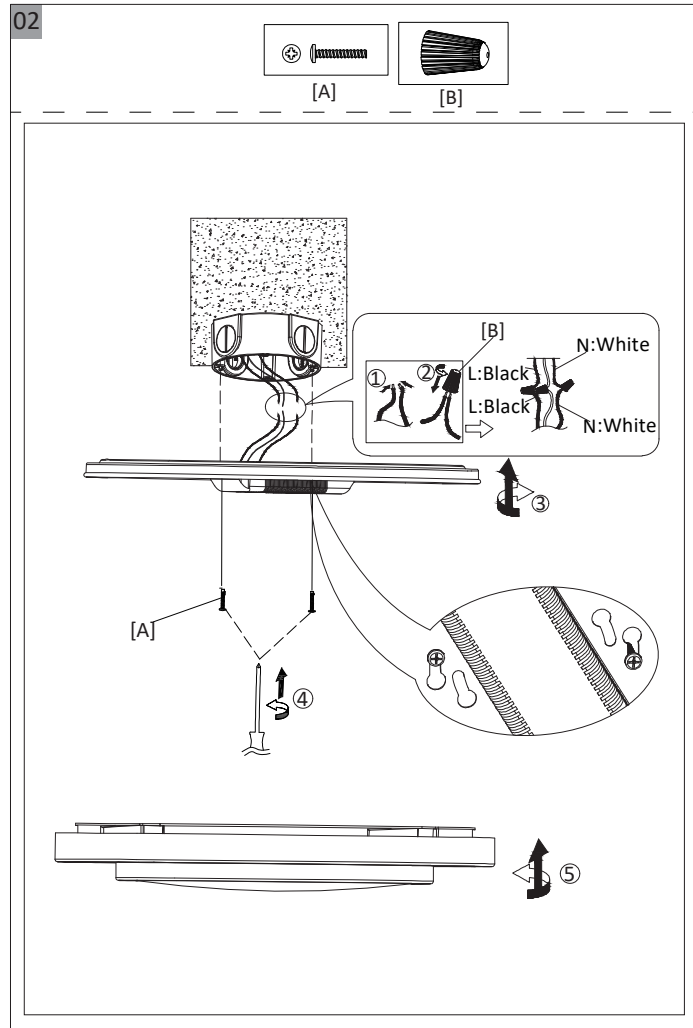
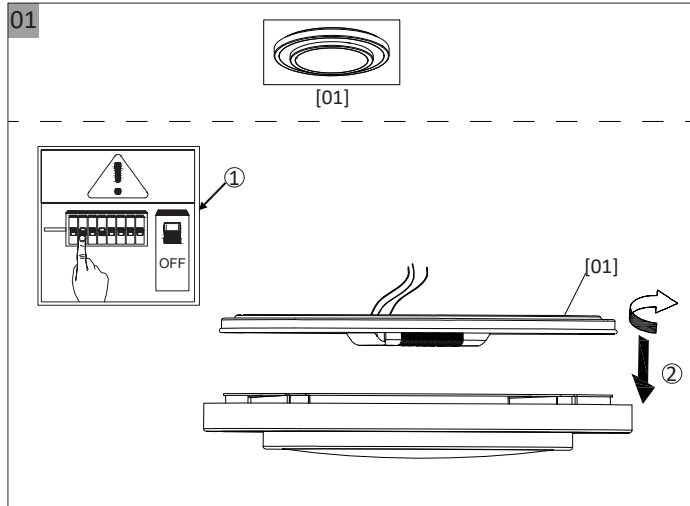



[C]

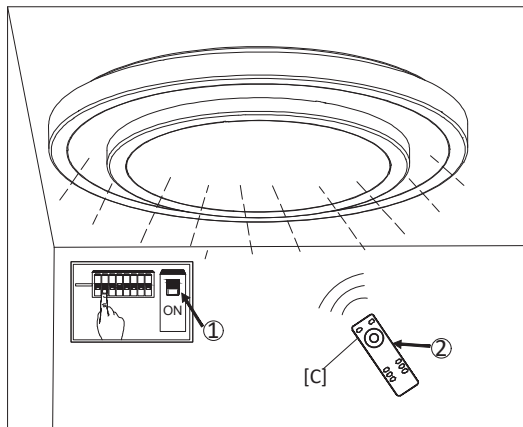

Remote Instruction:

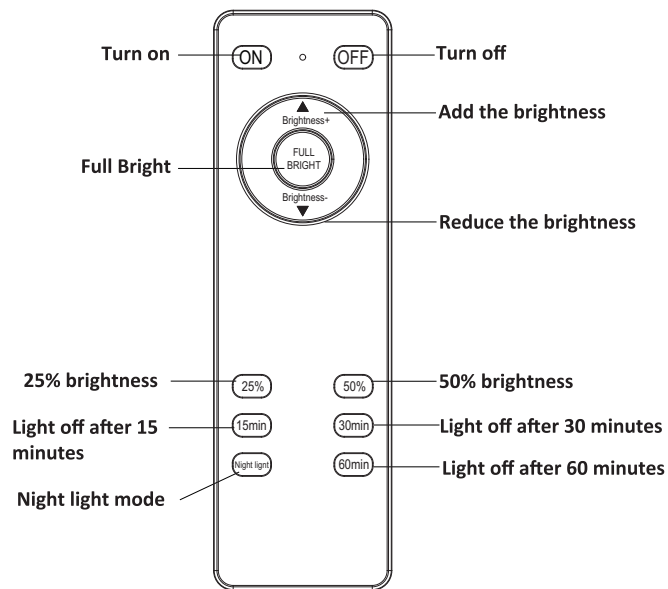

Note: This Remote Instruction Mainly Suitable for DingLi Power Adjustable Ceiling Light!!!

Romote Instruction:

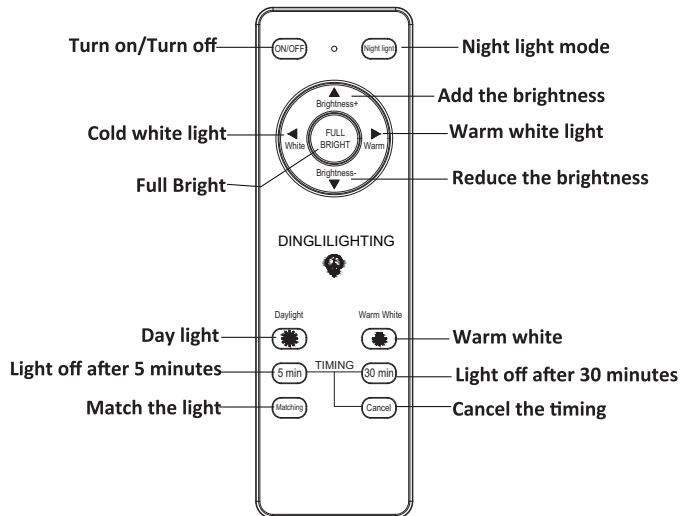

1. The remote control is mainly for the ceiling lights and panel lights currently on sale which are dimmable and color changeable.

2. It has the function of timing, the color temperature and brightness of the light can be adjusted, and the night light mode is also supported.

3. Matching method: first power off, then power on through the wall switch, and be sure to quickly press the matching button within 3 seconds during power on, and wait until the light flashes 3 times then the pairing is successful

4. Cancellation of pairing method: With the power on and the lights on, turn off the lights through the wall switch and keep pressing the match button after turning off the lights, then turn on the lights through the wall switch again until the lights flash 5 times before releasing the match button, then the pairing is cancelled successfully.

Note: This Remote Instruction Mainly Suitable for DingLi Power & Color Temperature Adjustable Ceiling Light!!!

Note:

1. The lamps may only be installed by authorized and qualified technicians according to the valid regulations for electrical installation.

2. The manufacturer does not accept any responsibility for injuries or damage resulting from improper use of the light.

3. Attention! Before starting the installation work, make sure that the mains power line is voltage-free—turn off safety cutout or unscrew the protection fuse. The switch must be “OFF”.

4. Warning! Before drilling the mounting holes, make sure that no gas, water or electricity pipes and wires can be drilled through or damaged in your chosen mounting location.

5. Description of the supply terminals: L = Phase N = Neutral conductor  = Earthed conductor.