

SharkBite

Washing Machine Boxes

One-piece recessed box design provides quick quarter-turn shut-offs to water supply for washing machines. Mounting brackets allow box to be mounted to left, right or center of stud bay and do not require additional support framing, providing a solid installation. Left, right or center drain compatible. Available with optional water hammer arrestor to reduce noisy pipes.

Features and Benefits

- Available with or without water hammer arrestors.
- Quarter-turn shut-off with 3/4 in. washing machine hose outlet.
- Snap-on faceplate accommodates up to 3/4 in. drywall.
- Left, right or center drain compatible.
- Compatible with PEX and PE-RT pipe.

Applications

- Potable water

Specification

Using the PEX plastic pipe cutters to cut the pipe to length, making sure that you have a good square cut. Slide the correct size Sharkbite clamp or crimp ring over the pipe approximately 2" past the end of the pipe. Push the pipe onto the Sharkbite barbed fitting until it touches the fitting shoulder. Position the clamp or crimp ring 1/8"-1/4" from the end of the tube. When making clamp connections, position the open jaws of the clamp tool over the raised tabs of the clamp ring and squeeze. Verify the connection is secure by visually checking the clamp tab. Make crimp connections by placing the jaws of the crimp tool over the copper crimp ring and squeezing until the jaws close completely. Verify that the connection is secure using the go / no-go gauge.



side view



#25739

Specification Data

Performance

Minimum working temperature	33°F
Maximum working temperature	160°F
Maximum working pressure	125 psi

Material

1 Outlet box	ABS
2 Valve Screw	SST
3 Valve Spindle	DZR LF Brass ¹
4 Valve Handle	Zinc
5 Valve O-ring	EPDM
6 Valve Body	DZR LF Brass ¹
7 Valve Seat	PTFE
8 Valve Ball	DZR LF Brass ¹
9 Valve Lock Nut	ABS
10 Valve End Plug	

¹ Lead Free for all models, surfaces that are in contact with consumable water contain less than 0.25% lead by weight

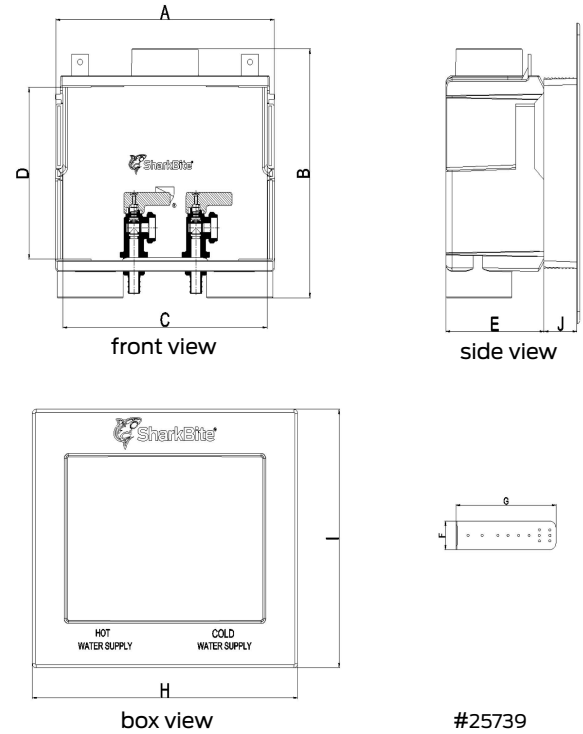

Dimensions

Description	Part #	A	B	C	D	E	F	G	H	I	J
1/2 in. Crimp x 3/4 in. GHT	25739	8.38	8.46	7.81	5.83	3.75	1.95	7.67	10.15	8.79	1.21
Washing Machine Box Replacement Faceplate	25464								10.15	8.79	1.21

All measurements are displayed in inches

Installation Requirements

- Turn off and fully drain water supply to involved piping.
- Nail the outlet box to the wall stud using the molded-in support flanges. For mounting to metal studs, use sheet metal screws (Figure A).
- Connect 1/2" water distribution lines (FigureB) to the SharkBite PEX Barb Fitting and secure using Stainless Steel Oetiker PEX Clamps or Copper Crimp Rings.
- Secure or brace supply line into place to prevent movement.
- After sheetrock is installed, press faceplate into place (Figure C).
- Secure the water supply line to the valve and attach to appliance (FigureD).
- When ready for use, turn on the water supply. Check for hose leaks at valve.

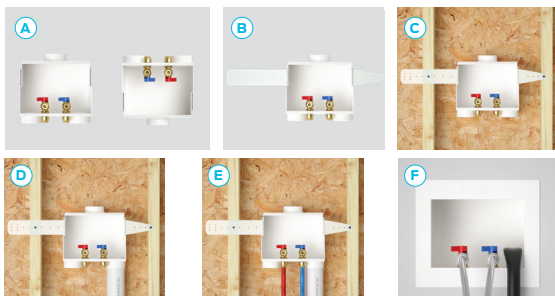

Insertion Depth

Fitting Size	Nominal Pipe Size	Pipe OD	Insertion Depth(in)
1/2 in.	1/2 in. CTS	5/8 in.	0.95

Multiple Installation Options

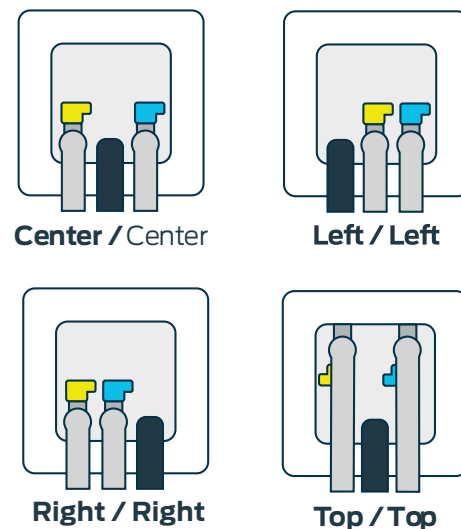

Pipe Type

PEX tubing complying with ASTM F 876 or CSA B137.5 and
PE-RT tubing complying with ASTM F2769 or CSA B137.18.

Codes and Standards

ASME A112.18.6

CSA B125.6

NSF/ANSI/CAN 61

NSF/ANSI 372

