

FRAMED MIRROR

SKU: R1MR2424MB/WT/BG R1MR2828MB/WT/BG
R1MR3232MB/WT/BG R1MR3636MB/WT/BG

Colors/Finishes: Matte Black(MB),White(WT), Brushed Gold(BG)

Nominal Dimension:24W*1.5D*24H inches 28W*1.5D*28H inches
32W*1.5D*32H inches 36W*1.5D*36H inches

FEATURES:

- Durable aluminum frame
- Modern sloping edge design
- Eco-friendly coating mirror glass
- Long lasting color finish

PRODUCT DIAGRAMS:

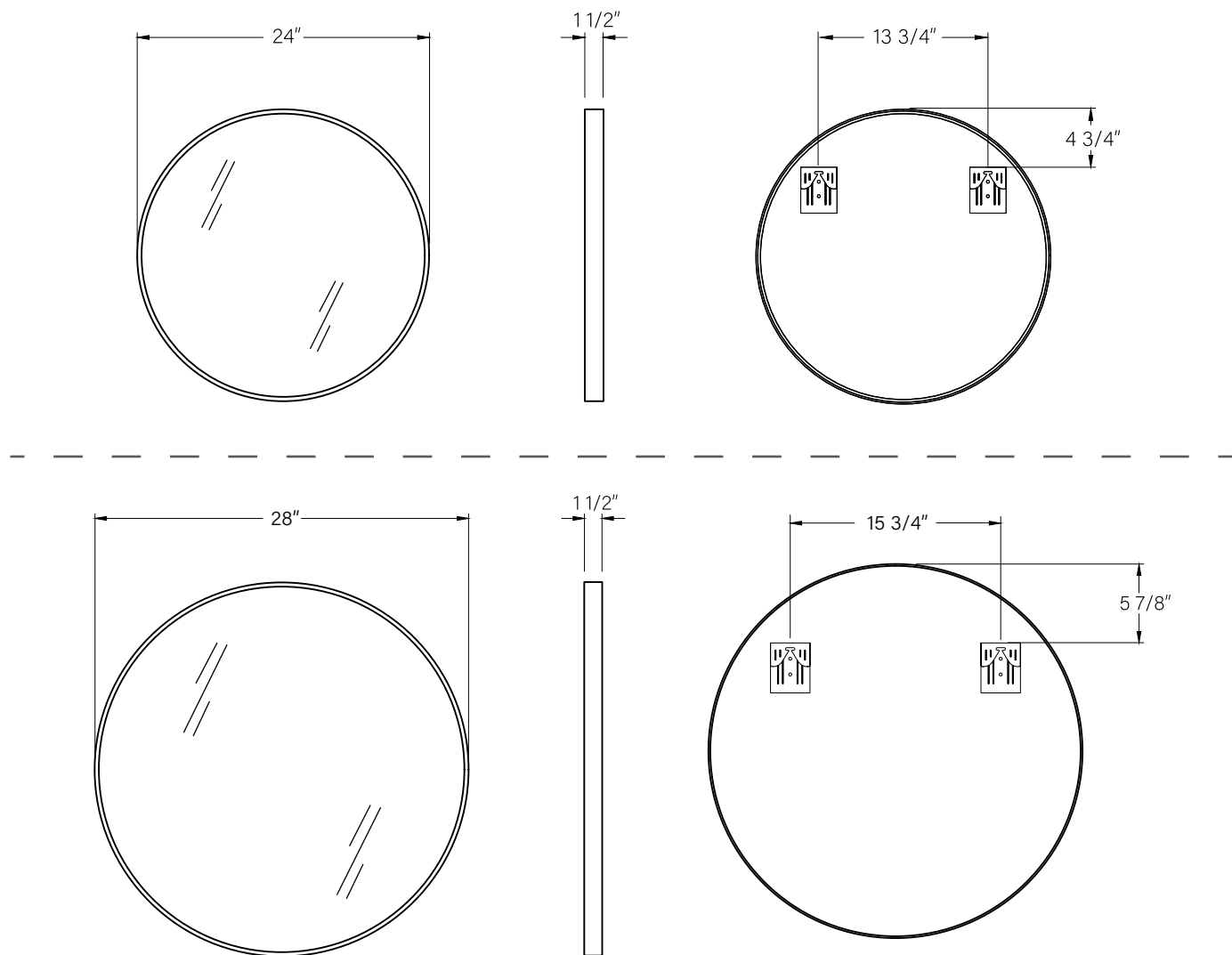

All dimensions and specifications are nominal and may vary.Use actual products for accuracy in critical situations.

FRAMED MIRROR

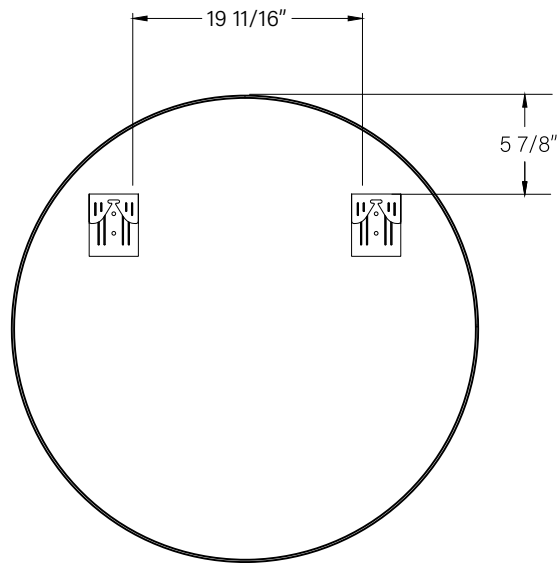
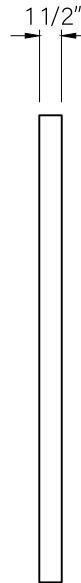
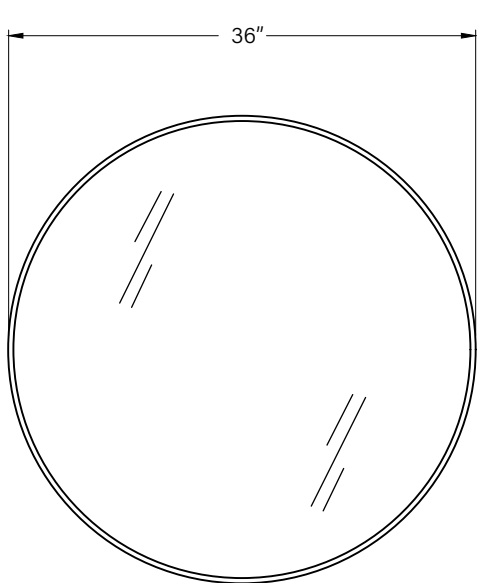
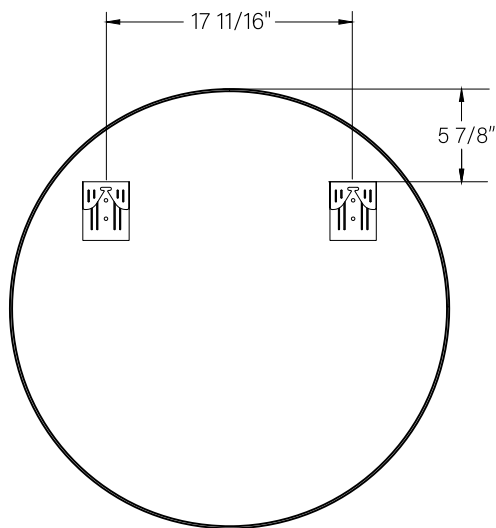
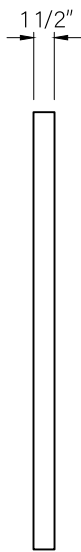
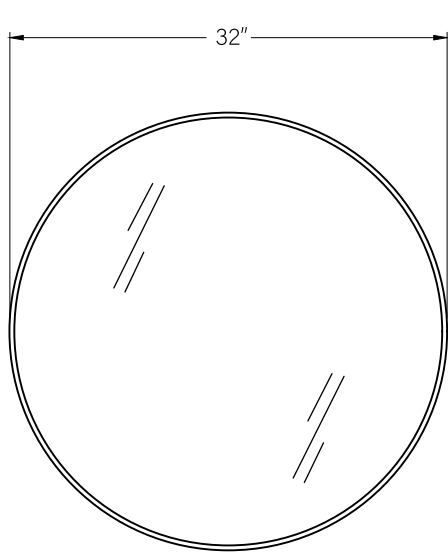

Mirror Installation

SUGGESTED TOOLS AND MATERIALS

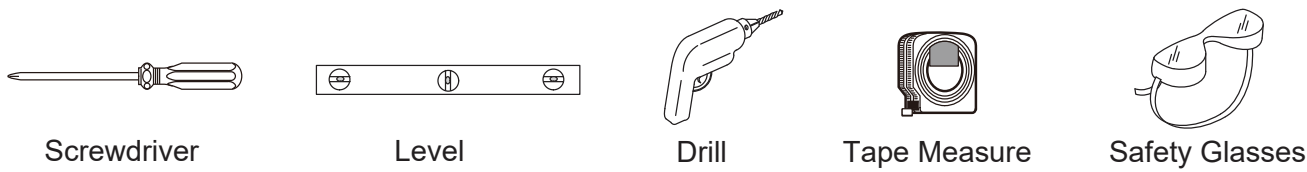

PARTS

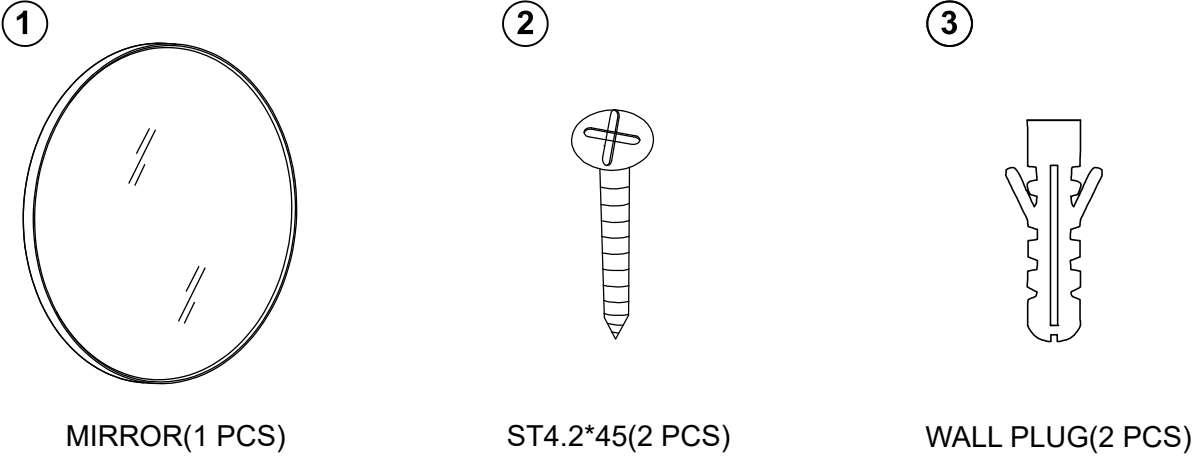

INSTALLATION INSTRUCTIONS

STEP 1

Select the desired position of the mirror. Level and mark the mounting holes on the wall.

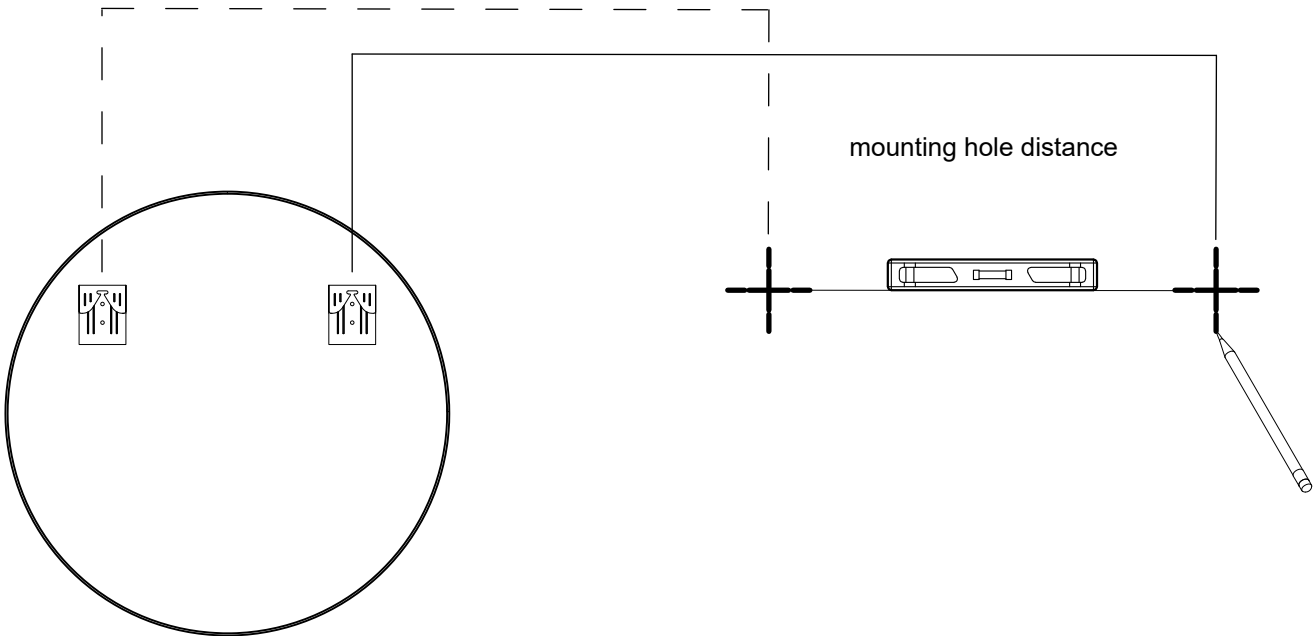

* Note:mirror style, shape may vary from the picture above. Instructional purpose only *

Mirror Installation

STEP 2

2.1 Drill holes about 2" deep at each of the marked locations.

2.2 Insert wall plugs ③.

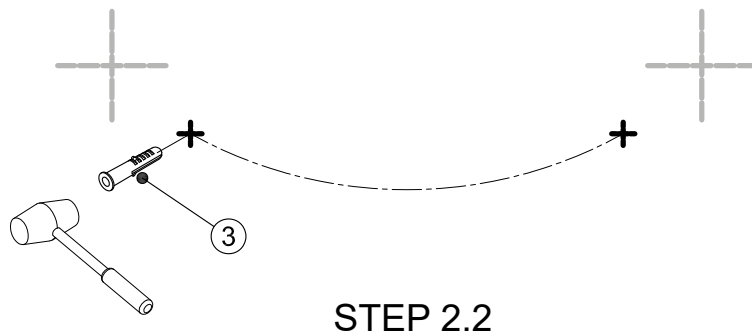
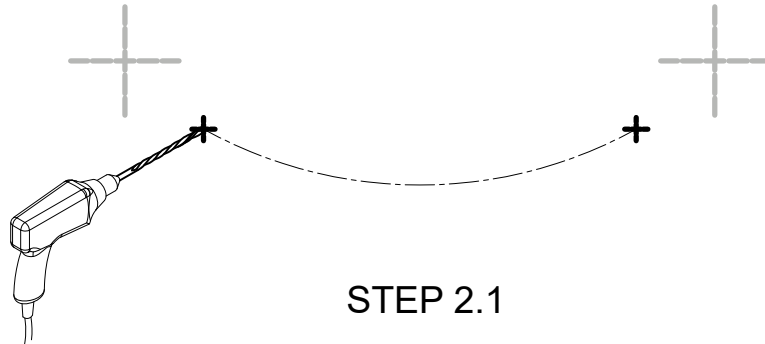

STEP 3

Install Screw ②. Leave a gap of 1/4" between the head of the screw and the wall.

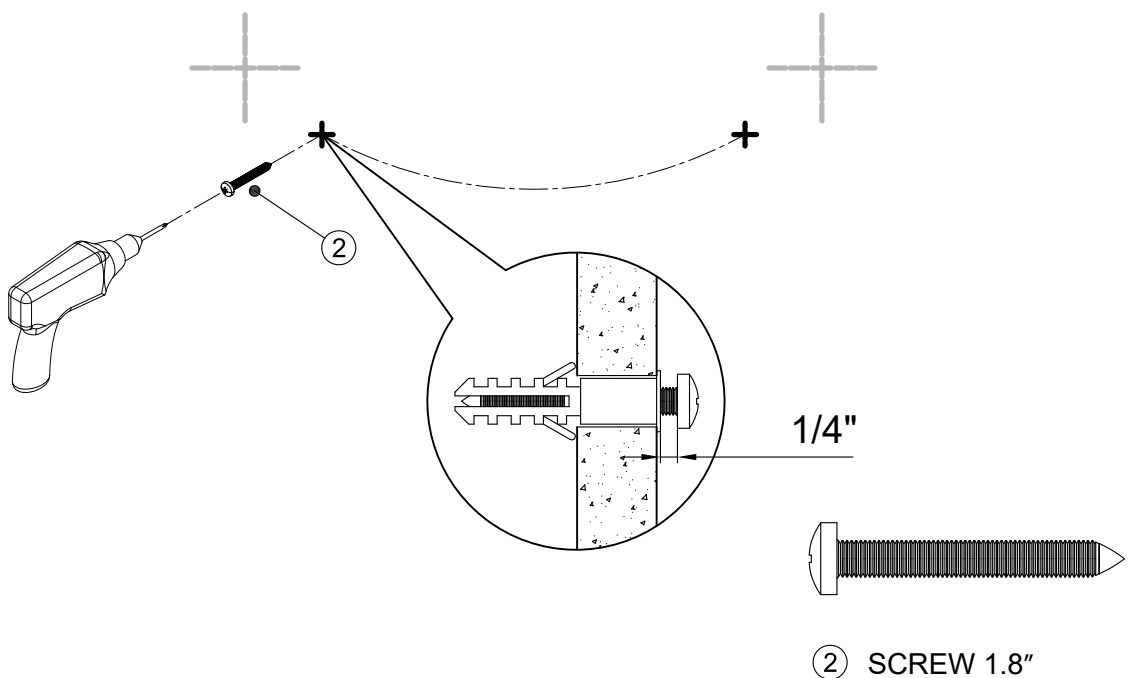

Mirror Installation

STEP 4

Place the mirror against the wall and slide it down, as shown in Figure 2.

