



HARBOR BREEZE and logo design are trademarks or registered trademarks of LF, LLC. All rights reserved.

ITEM #5303206

MODEL #42955

GARAGE FAN

Español p. 12

ATTACH YOUR RECEIPT HERE

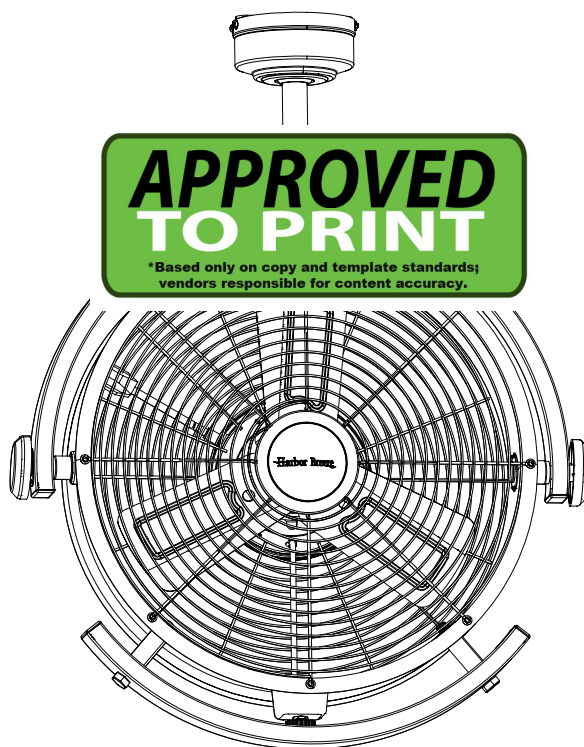

Intertek

Purchase Date _____

Thank you for purchasing this HARBOR BREEZE product.

Questions, problems, or missing parts?

Before returning, contact us at:

888-251-1003, 8 a.m. - 8 p.m., EST, Monday - Sunday or at **ascs@lowes.com**.

SG241201

TABLE OF CONTENTS

Package Contents 3

Hardware Contents 4

Safety Information 4

Preparation 4

Assembly Instructions 5

Replace Downrod 9

Operating Instructions 10

Care and Maintenance 11

Troubleshooting 11

Limited Lifetime Warranty 11

Replacement Parts 12

PACKAGE CONTENTS

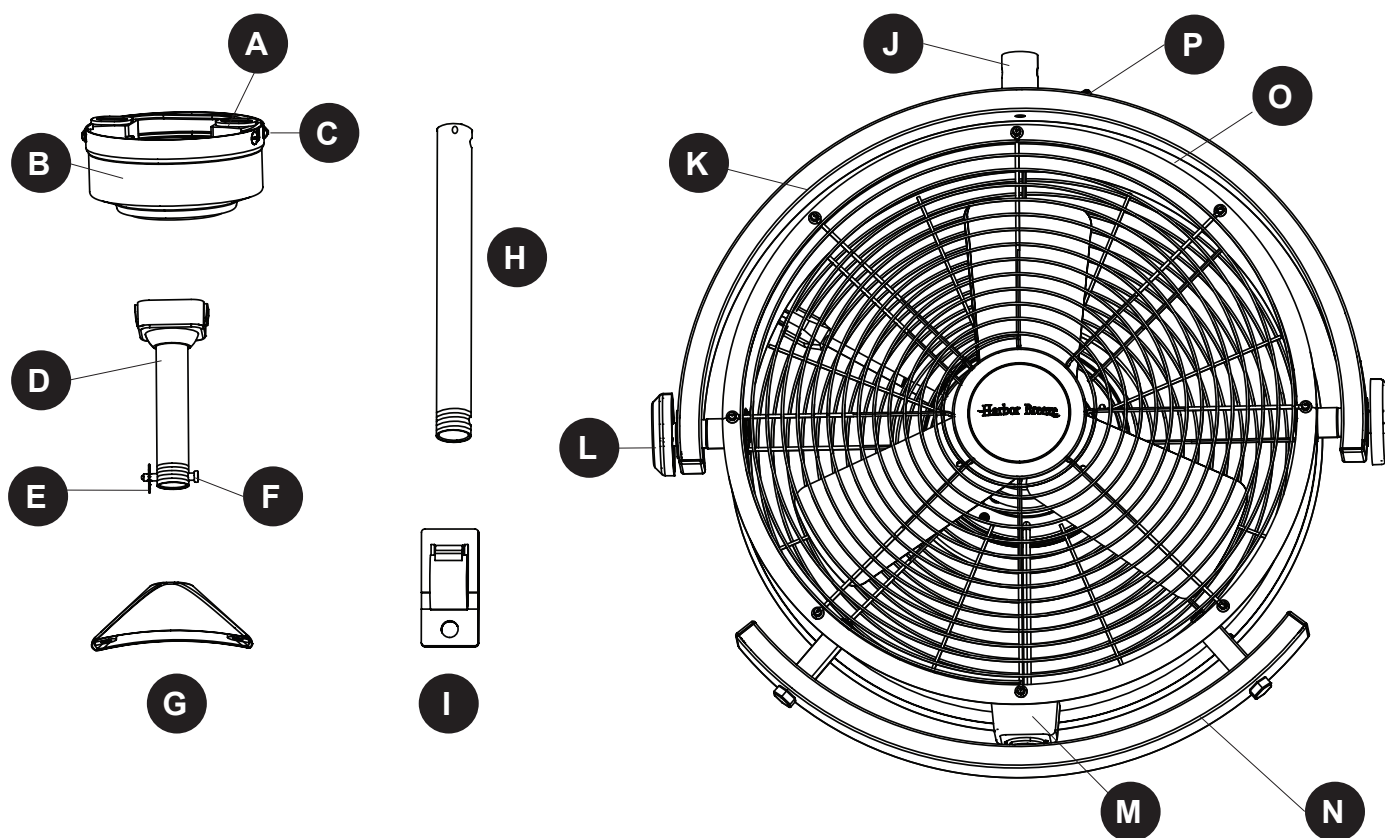

PART	DESCRIPTION	QUANTITY
A	Mounting Bracket (preassembled to Canopy [B])	1
B	Canopy	1
C	Mounting Bracket Screw (preassembled to Mounting Bracket [A])	4
D	Downrod	1
E	Downrod Clip (preassembled to Downrod [D])	1
F	Downrod Pin (preassembled to Downrod [D])	1
G	Yoke Cover	1
H	12-Inch Downrod (optional)	1
I	Cord Clip	6
J	Yoke (preassembled to Fan Assembly [K])	1
K	Fan Assembly	1
L	Tilt Knob (preassembled to Fan Assembly [K])	2
M	Speed Control (preassembled to Fan Assembly [K])	1
N	Adjustment Handle (preassembled to Fan Assembly [K])	1
O	Cord Bracket (preassembled to Fan Assembly [K])	2
P	Yoke Cover Screw (preassembled to Fan Assembly [K])	2

HARDWARE CONTENTS

HH



Lock Washer
Qty. 2

RR

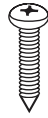

Wood Screw
Qty. 2

UU



Washer
Qty. 2

PREPARATION

Before beginning the assembly of this product, ensure that all parts are present. Compare all parts with the package contents list and hardware contents list. If any part is missing or damaged, do not attempt to assemble the product.

Estimated Assembly Time: 30 minutes

Tools Required for Assembly (not included): Step Ladder and Phillips Screwdriver.



SAFETY INFORMATION

CAUTION:

- Read and follow all instructions before operating fan.
- Do not use fan if any part is damaged or missing.
- This garage fan is rated for indoor and damp locations.
- Connect to properly grounded outlets only.
- Do not insert fingers or any other objects through the grill guard when fan is in operation.
- Disconnect the fan when moving from one location to another.
- When the fan is not in use or before cleaning, unplug the fan from the outlet.
- Do not use fan near windows. Rain and water may create an electrical hazard.
- Do not alter the fan's assembly.

WARNING:

- To reduce the risk of fire or electrical shock, do not use this fan with any solid state speed control device. This appliance has a 3-prong plug. To reduce the risk of electrical shock, this plug is intended to fit in an outlet only one way. If this does not fit the outlet, contact a qualified electrician. Do not attempt to bypass this procedure.
- Failure to secure set screws on sides of the mounting bracket may result in fan falling causing serious injury or death.
- To protect against the risk of electrical shock, do not immerse the unit, cord or plug in water or other liquid.
- Do not plug/unplug the fan into/from the electrical outlet with wet hand.

ASSEMBLY INSTRUCTIONS

1. Loosen all four mounting bracket screws (C) and completely remove the two screws from the round holes in the canopy (B). Save the screws for later. Remove the canopy (B) from the mounting bracket (A).

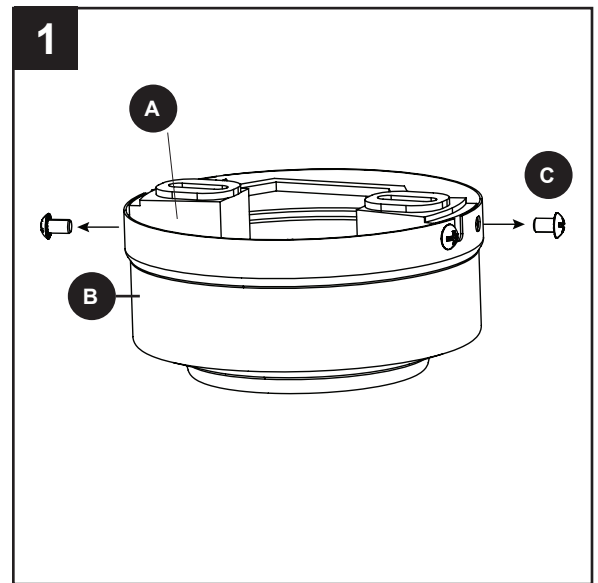

2. Determine the mounting method to use.

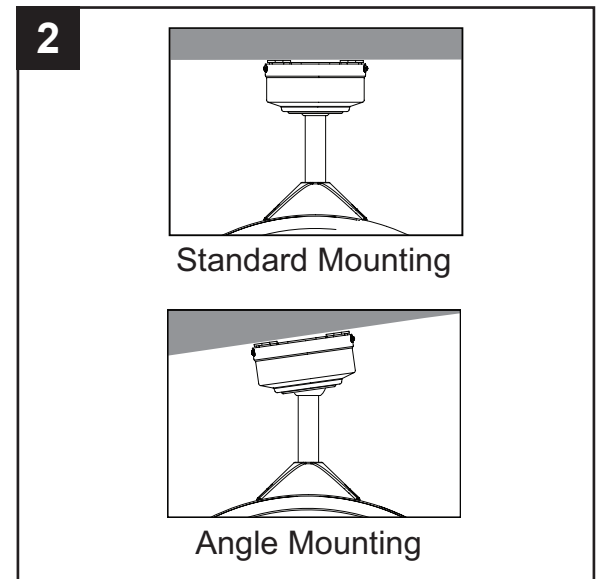

Standard Mounting is best suited for ceilings 8 ft. or higher. For taller ceilings you may want to use a longer downrod (not included).

Angle Mounting is best suited for angled or vaulted ceilings. **Important:** If using the angle mount, check to ensure the ceiling angle is not steeper than 12°.

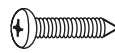

3. Use 2 wood screws (RR) along with washer (UU) and lock washer (HH) to secure the mounting bracket (A) to ceiling joists. Then, loosen but do not remove two set screws on each side of the mounting bracket (A).

Hardware Used

HH	Lock Washer		x 2
RR	Wood Screw		x 2
UU	Washer		x 2

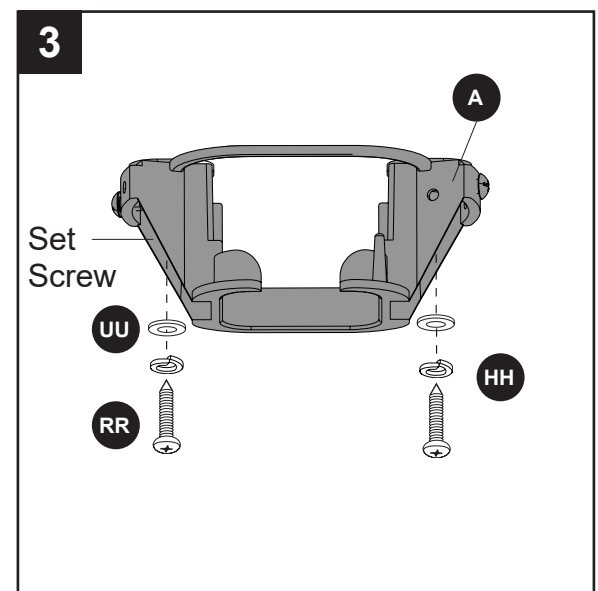

ASSEMBLY INSTRUCTIONS

4. The fan includes an optional 12-inch downrod (H). The 6-inch downrod is preassembled to the square bracket. If longer downrod is needed, see **REPLACE DOWNROD**, page 9. Then, remove the downrod clip (E) and downrod pin (F) from the downrod (D). Insert the downrod (D or H) through the canopy (B) and yoke cover (G).

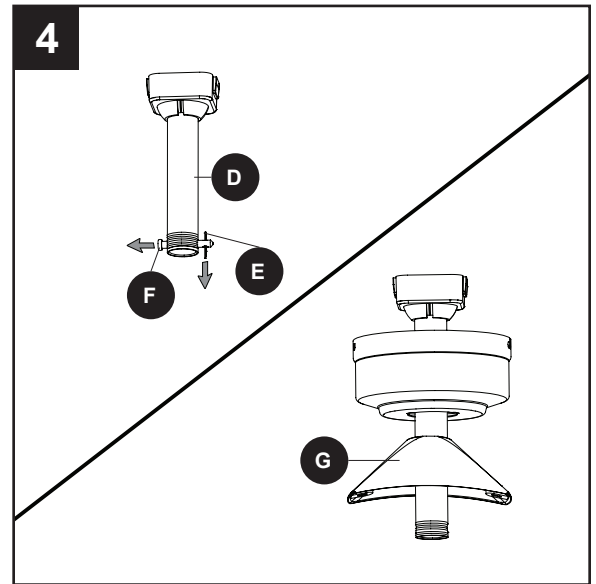

5. Slide the downrod (D or H) into the yoke at the top of the fan assembly (K) and turn clockwise to tighten. Align the holes, then reinstall the downrod pin (F) and downrod clip (E) to secure.

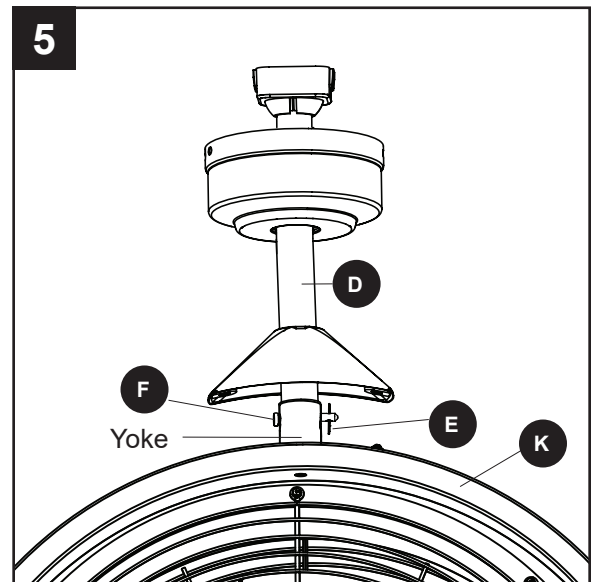

6. Remove the two yoke cover screws (P) preassembled to the top of the fan assembly (K). Use the two yoke cover screws (P) to secure the yoke cover (G) to the top of the fan assembly (K). Then, lower the yoke cover (G) to rest on top of fan assembly (K).

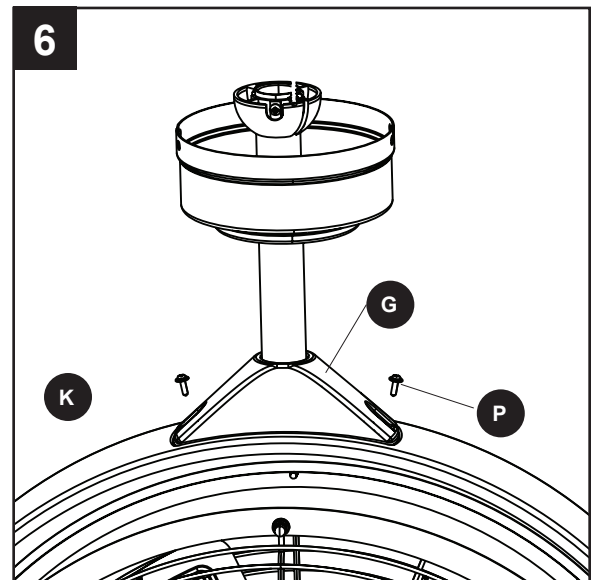

ASSEMBLY INSTRUCTIONS

7. Install the square bracket into the opening of the mounting bracket (A). Tabs on square bracket should face the sides of the mounting bracket (A) to engage the slots inside the mounting bracket (A). Retighten the two set screws to secure.

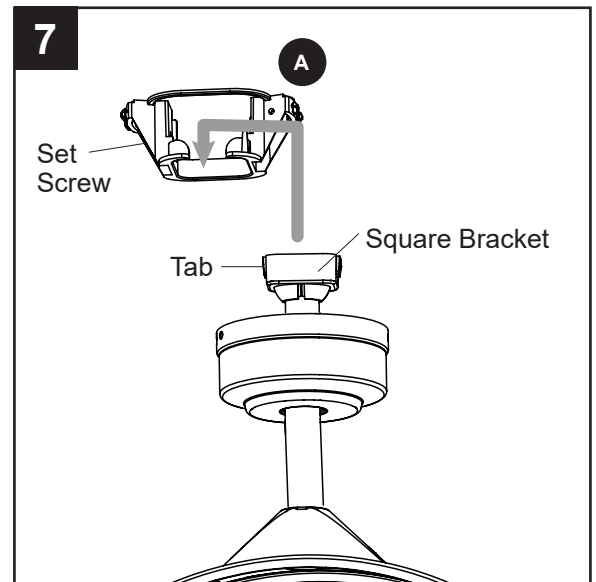

8. Raise the canopy (B), ensure the two mounting bracket screws (C) are aligned with the J-shaped slots in the canopy (B). Then turn the canopy (B) in a clockwise direction until the mounting bracket screws (C) are completely engaged in the J-shaped slots.

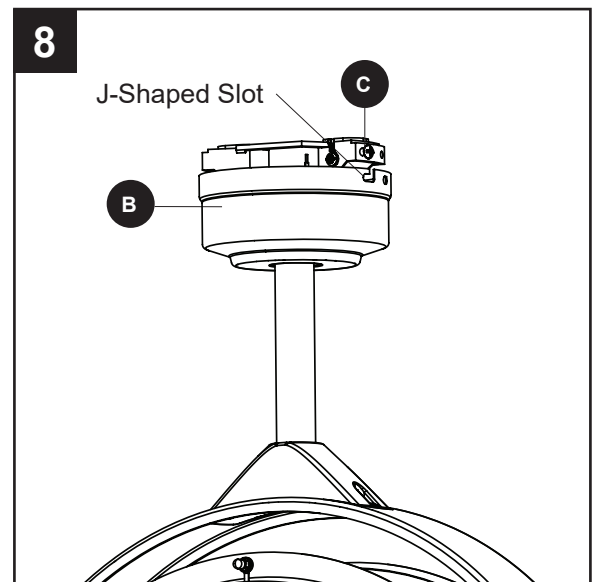

9. Install the two previously removed mounting bracket screws (C) in the round holes. Securely tighten all mounting bracket screws (C).

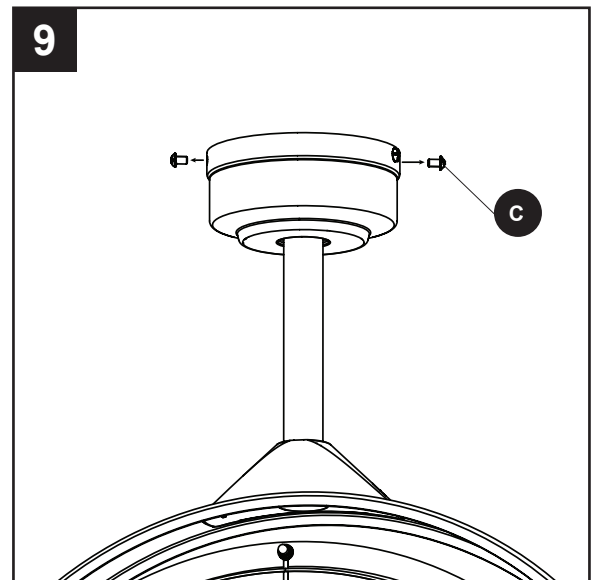

ASSEMBLY INSTRUCTIONS

10. Use cord clips (I) to secure the fan's power cord to ceiling in a path toward the power outlet.

Peel the backing off of the double-sided tape preassembled to back side of each cord clip (I). **Note:** Cord clips have a round hole to accommodate a wood screw (sold separately) as an option to the taping method.

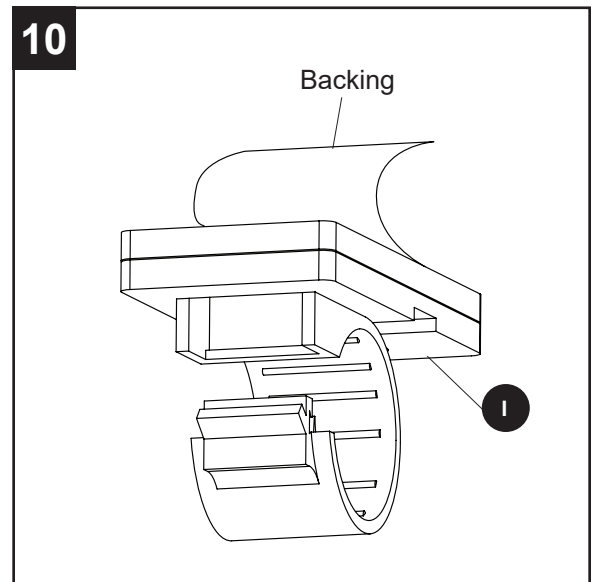

11. Secure each cord clip (I) to the ceiling. Then insert the cord into each clip and press the clip closed to secure the cord. **Note:** Leave adequate slack near the fan to allow fan to swivel and/or tilt.

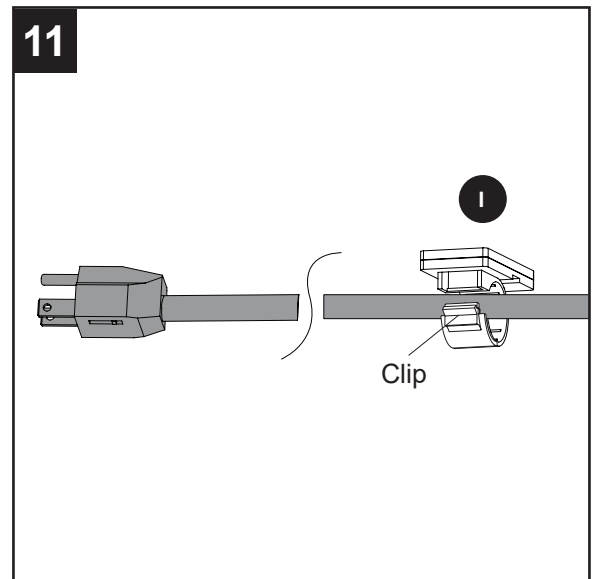

12. Plug power cord into a grounded 120v outlet.

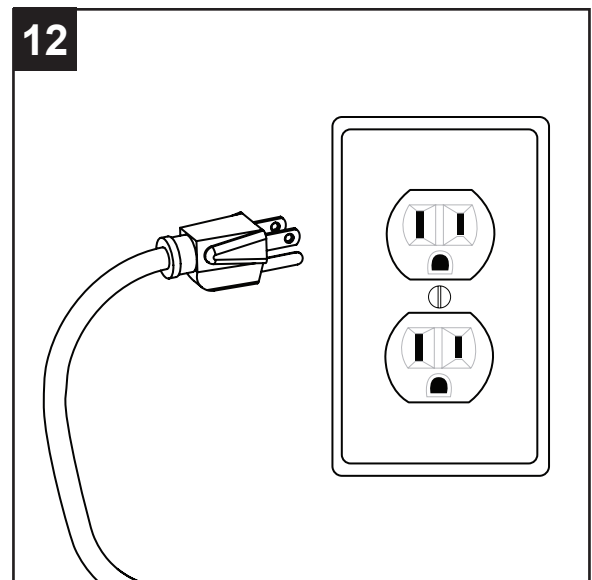

REPLACE DOWNROD (OPTIONAL)

1. Tilt the downrod ball in the square bracket to access and remove the set screw with Phillips screwdriver.

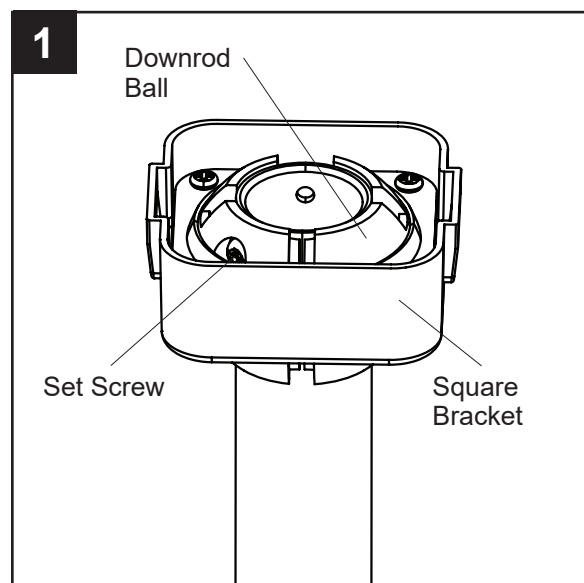

2. Lower the downrod ball and square bracket to access and remove the pin.

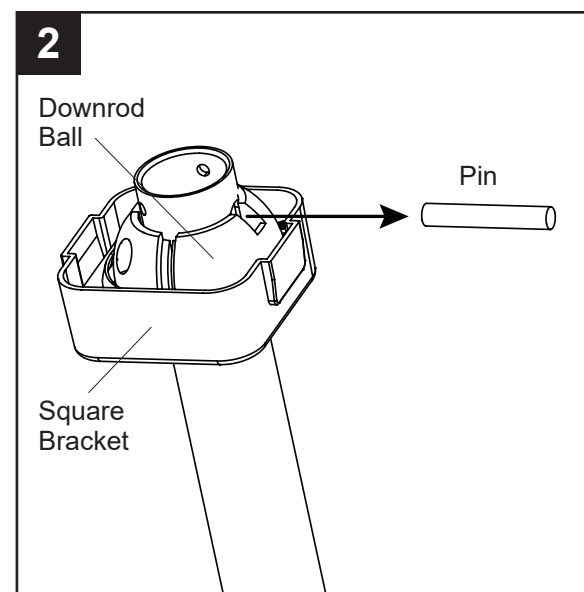

3. Remove the downrod (D) and exchange with the 12-inch downrod (H). Slide extra downrod into downrod ball. Replace the pin and set screw as shown in previous steps.

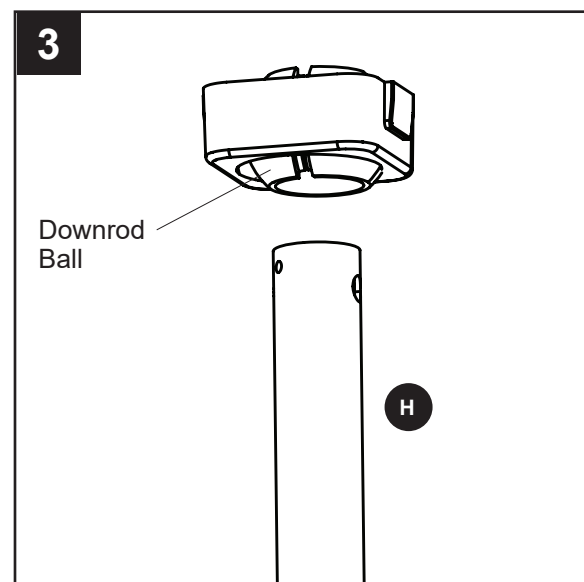

OPERATING INSTRUCTIONS

1. Fan Control is located on the bottom side of the fan.
The fan has four settings:

0 - Off
1 - Low Speed
2 - Medium Speed
3 - High Speed

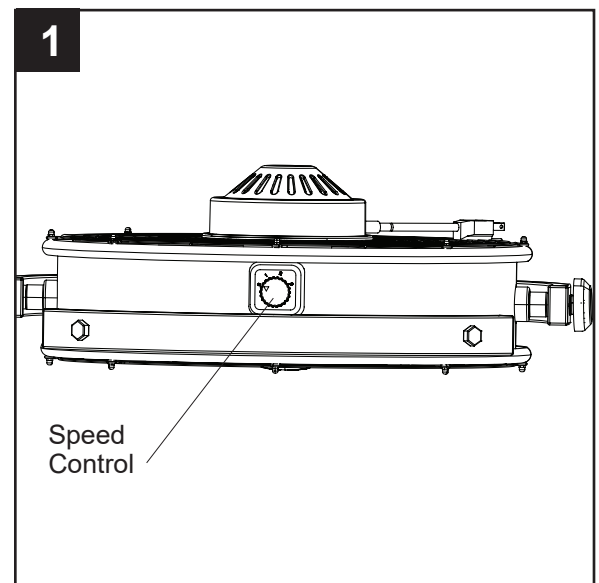

2. Use tilt knobs on sides of fan to adjust airflow up or down. Loosen tilt knobs by turning counterclockwise, adjust fan, and retighten tilt knobs.

Use adjustment handle located on bottom of fan to change the direction of airflow from left to right.

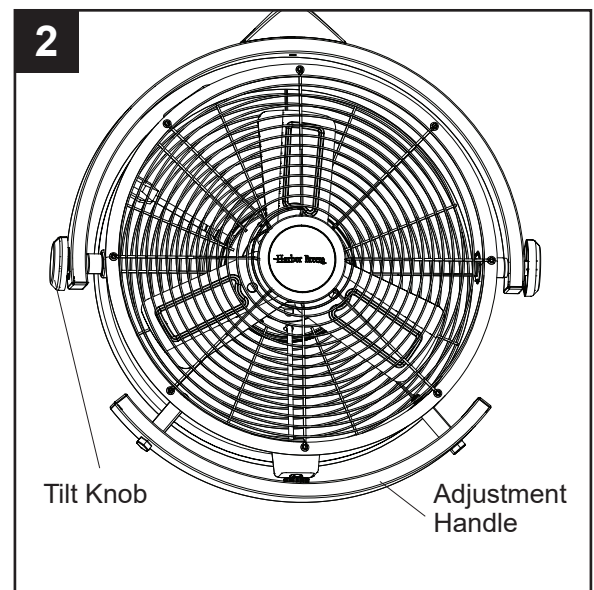

3. Cord brackets are located on top of fan assembly (K).
When not in use, wrap power cord around the two cord brackets.

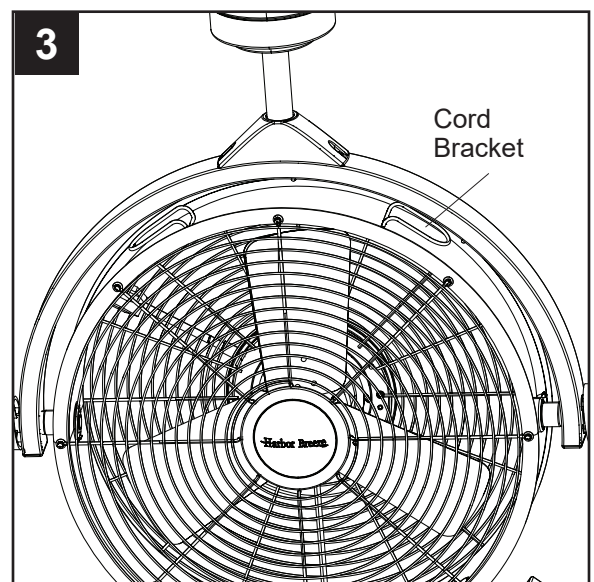

CARE AND MAINTENANCE

At least twice each year, tighten all screws on the fan. Clean the fan assembly with only a soft brush or lint-free cloth to avoid scratching the finish.

Important: Unplug the fan from outlet before you begin any maintenance tasks. Do not use water or a damp cloth to clean the ceiling fan.

TROUBLESHOOTING

PROBLEM	POSSIBLE CAUSE	CORRECTIVE ACTION
The fan does not move.	The power is off, fuse is blown, or breaker is tripped.	Turn the power on or check the fuse or breaker.

LIMITED LIFETIME WARRANTY

Set forth below, the manufacturer warrants the fan motor for this ceiling fan to be free from defects in workmanship and material for the life of the product. Also, subject to the limitations below, the manufacturer warrants all ceiling fan parts ("ceiling fan parts" excludes the motor and parts made in whole or in part with glass) to be free from defects in workmanship and material for a period of one year after the date of purchase by the original purchaser at retail.

All claims must be made by the original purchaser from an authorized dealer, whether such purchaser purchased the product through a store or contractor. Ceiling fan part defects must be reported within the first year from the date of purchase. Parts made in whole or in part with glass and the finishes of metal and other surfaces are not warranted.

Purchasers are responsible for all costs of removing and reinstalling the product. Any damage to any part caused by ordinary wear and tear, accident, misuse, or improper installation, is not covered by this warranty. The manufacturer assumes no responsibility whatsoever for fan installation. Any service performed by a non-licensed electrician will render the warranty invalid.

The manufacturer's sole responsibility shall be to repair or replace the motor, parts, or product within the terms stated above. The manufacturer shall not be liable for any loss or damage of any kind, including any incidental or consequential damages resulting directly or indirectly, from any breach of warranty, express or implied, or any other failure of this product. Some states do not allow the exclusion or limitation of incidental or consequential damages so this limitation may not apply to you.

If the original purchaser ceases to own the fan, this warranty is voided.

Should the purchaser encounter a problem with your fan related to defects in workmanship or materials within the warranty period associated with the defective part, the manufacturer agrees to replace the defective part without charge, or at its option, to replace the ceiling fan with a comparable or superior model.

The manufacturer's warranties are limited to the written warranties set out in this ceiling fan limited lifetime warranty. All other express and implied warranties, including, without limitation, the implied warranty of fitness for a particular purpose and the implied warranty of merchantability is disclaimed. Some states do not allow the disclaimer of implied warranties, so this disclaimer may not apply to you.

REPLACEMENT PARTS LIST

For replacement parts, call the customer service department at **888-251-1003**, 8 a.m. - 8 p.m., EST, Monday - Sunday. You could also contact us at **ascs@lowes.com**.

PART	DESCRIPTION	PART#	COVERED UNDER WARRANTY
G	Yoke Cover	4A000024960	YES - 1 year
I	Cord Clip	4A000025310	YES - 1 year
L	Tilt Knob	4A000025320	YES - 1 year
P	Yoke Cover Screw (x2)	4A000025330	YES - 1 year
HW	Hardware Bag	4A000025340	NO



G

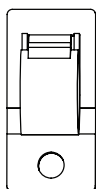

I

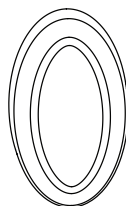

L



P



HW