

**Roku™**

Indoor  
Smart Plug  
SE



**Quick Start  
Guide**

# What's included

- Roku Indoor Smart Plug SE\*

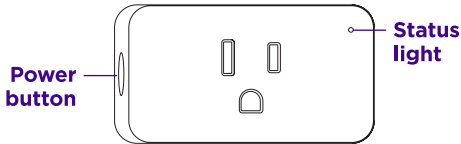

# What you'll need

- Your smartphone

\* For indoor use only.

# Let's get started

---

## STEP 1: Download the Roku Smart Home app

Scan the QR code below to download the Roku Smart Home app on your smartphone. Sign in with your Roku account or create one.

### You'll need



Smartphone & app



Messaging and data rates may apply.

[Continue on back](#) ↗

## STEP 2: Insert plug

Insert your smart plug into a power outlet. The status light will begin flashing **BLUE** to show it's in pairing mode.

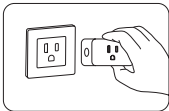

If it's not flashing **BLUE**, press and hold the Power button until it begins to flash.

## STEP 3: Pair to app

In the Roku Smart Home app, tap the “+” button, then “**Add Device**” to find “**Indoor Smart Plug.**” Follow the instructions to finish setup.

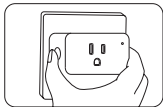

Control your plugs with your voice by pairing with your Alexa or Google Assistant-enabled device. For instructions, visit [go.roku.com/plugs](https://go.roku.com/plugs)

# What's that light mean?

Status Light	State
<b>BLUE</b> - Solid	Connected
<b>BLUE</b> - Slowly flashing	Connecting to Wi-Fi®
<b>BLUE</b> - Quickly flashing	In pairing mode
<b>NO LIGHT</b>	Socket power off



Use the **Roku Smart Home app** to control your smart plug from anywhere.

# Need help?



Setup  
videos



Common  
questions



Tips and  
tricks

Visit [go.roku.com/plugs](https://go.roku.com/plugs)

# ROKU

© 2023 Roku, Inc. All rights reserved. Roku, the Roku logo, Roku Smart Home, and the Roku Smart Home logo are the trademarks or registered trademarks of Roku, Inc.



4100000871\_04