

INSTALLATION

Product Manual

Version: 260127-01-24A-YQ

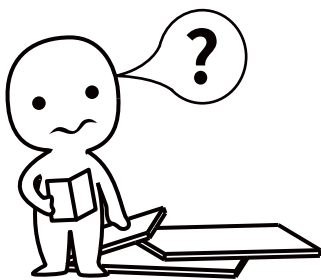

IMPORTANT INFORMATION!

please read the entire manual before starting to assemble and/or using this product. follow the manual thoroughly and keep it for further reference.

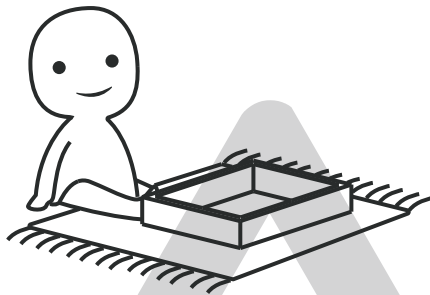
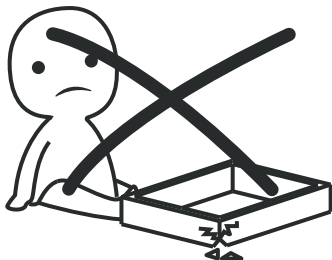

AVOID SCRATCHES!

In order to avoid scratching this furniture should be assembled on a soft layer-could be a rug.

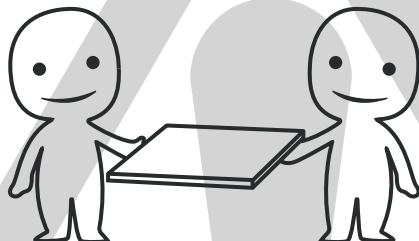

IMPROVE EFFICIENCY !

Try to find a partner to install with you, which can speed up the installation efficiency and shorten the time.

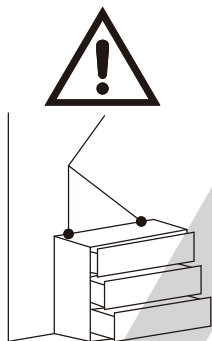

ANTI-TOPPLE WARNING !

Overturned furniture can cause serious or fatal crush injuries. To prevent tipping over, be sure to use the wall attachment, if not included with this product. Please purchase the wall attachment that fit your wall. If unsure, seek professional advice. Please read and follow each step of the instructions carefully.

IMPORTANT !

It is important that any product which is assembled using any kind of screw is re-tightened 2 weeks after assembly, and once every 3 months - in order to assure stability through-out the lifespan of the product.

For regular maintenance and cleaning of the product, for the frame, please use a rag dipped in neutral detergent to fully wipe it, and then dry it with a clean rag. For glass materials, wipe with a rag dampened with water glass cleaner, and then dry with a dry rag.

Do not use an electric screwdriver, and do not use too much force when installing, because the board is easy to break.

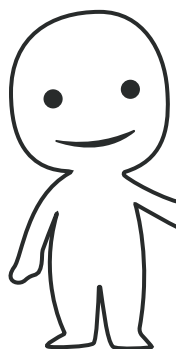

Please prepare the following tools

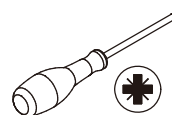
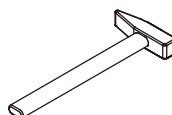
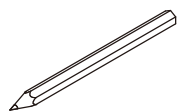

When installing, please carefully confirm whether each screw corresponds to the manual, accessories with similar shapes can be distinguished by size

<p>A x 15</p>  <p>Ø4 x 35 mm</p>	<p>B x 47</p>  <p>Ø6 x 35 mm</p>	<p>C x 47</p>  <p>Ø15 x 9 mm</p>	<p>D x 54</p>  <p>Ø6 x 30 mm</p>	<p>E x 69</p>  <p>Ø3 x 12 mm</p>
<p>F x 2</p>  <p>Ø4 x 14 mm</p>	<p>G x 84</p>  <p>Ø3.5 x 12 mm</p>	<p>H x 2</p> 	<p>J x 2</p> 	<p>K x 24</p>  <p>Ø3.5 x 14 mm</p>
<p>L x 2</p> 	<p>M x 14</p> 	<p>N x 9</p>  <p>Ø4 x 14 mm</p>	<p>P x 9</p> 	<p>Q x 20</p> 
<p>R x 2</p> 	<p>S x 4</p> 	<p>T x 4</p> 	<p>U x 4</p> 	<p>V x 22</p> 
<p>X x 2</p> 	<p>Y x 4</p>  <p>Ø4 x 12 mm</p>	<p>Z x 4</p>  <p>Ø3 x 16 mm</p>		

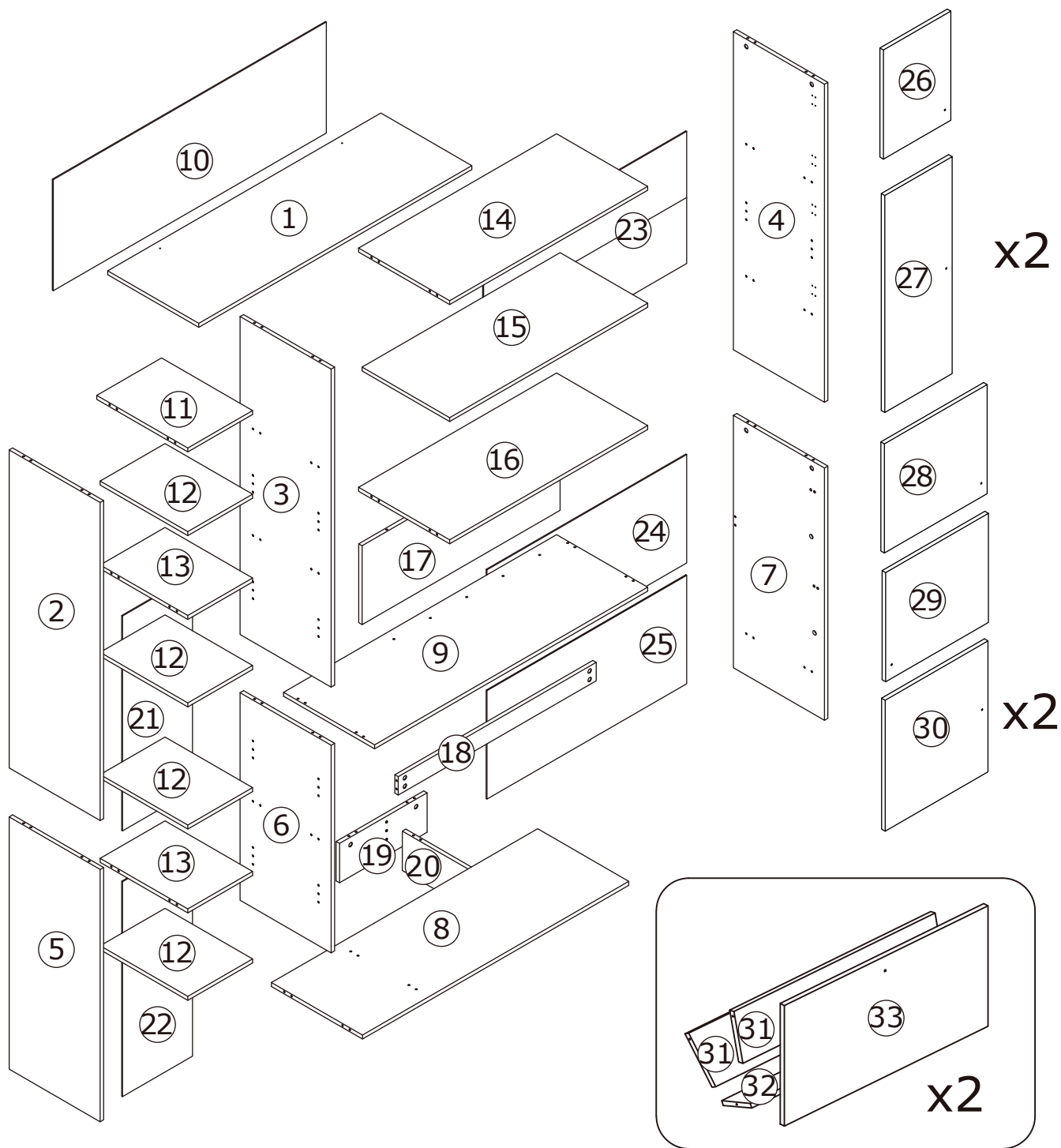

⚠ WARNING

Children have died from furniture tipover. To reduce the risk of furniture tipover:

- ALWAYS install Anti-tip device provided.
- NEVER put a TV on this product.
- NEVER allow children to stand, climb or hang on drawers, doors, or shelves.
- NEVER open more than one drawer at a time.
- Place heaviest items in the lowest drawers.

*This is a permanent label.
Do not remove!*

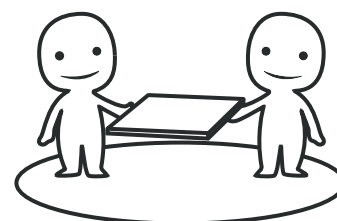

ASSEMBLED BY 2 ADULTS

1



Attach plate 20 to plate 19 using wooden dowel(D), and fix with screw(A) as shown.

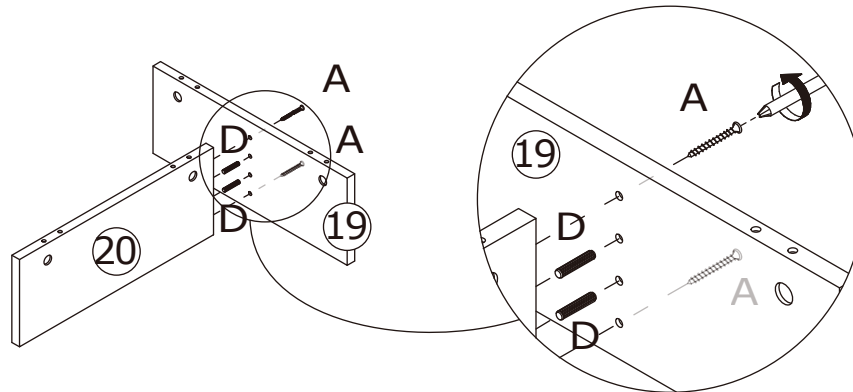

2

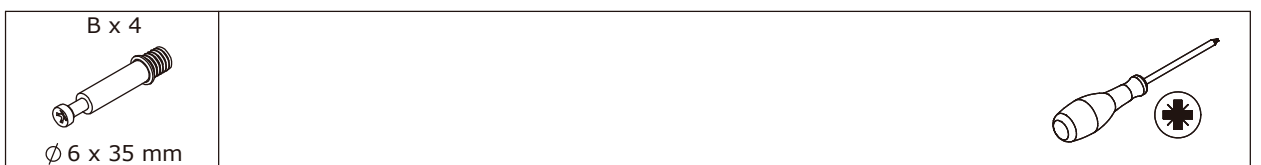

Screw eccentric rod(B) into plate 8 at first.

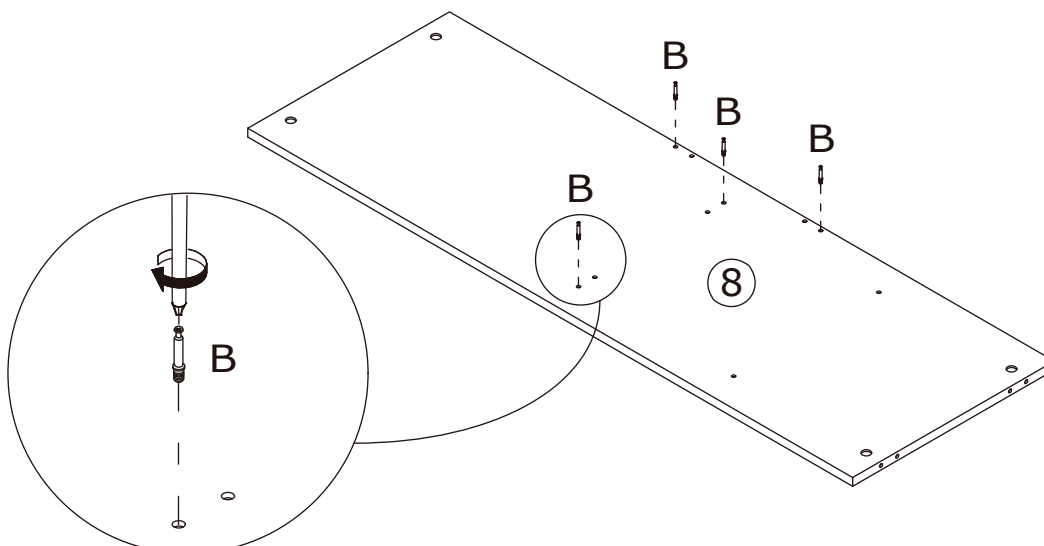
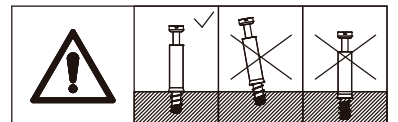

3

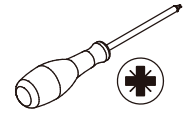
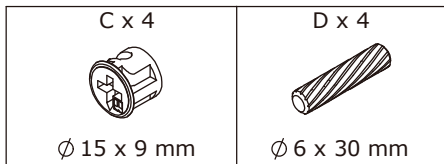

Attach plate 19 and 20 to plate 8 using wooden dowel(D), add cam lock(C) into plate 19,20 and turn clockwise to tighten as shown.

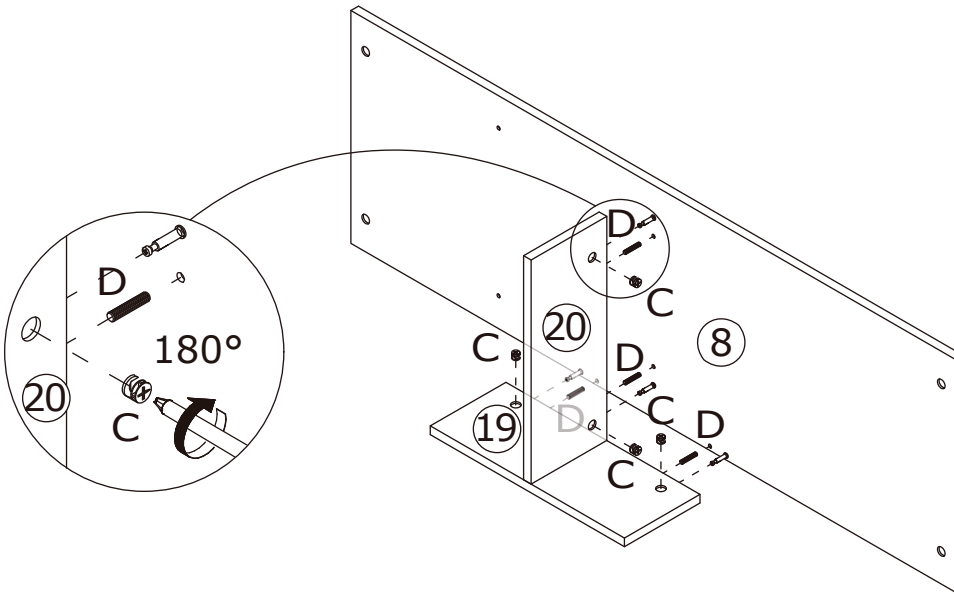
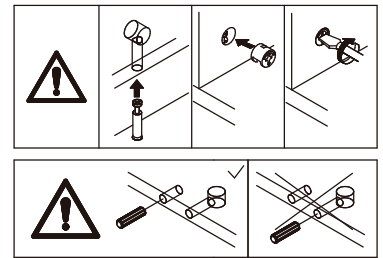

4

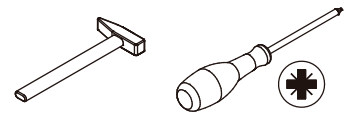
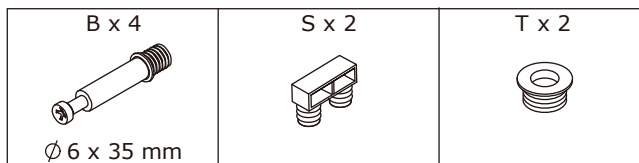

Insert part(S) and (T) into plate 6, screw eccentric rod(B) into at first.

Flip to back, screw eccentric rod(B) into as shown.

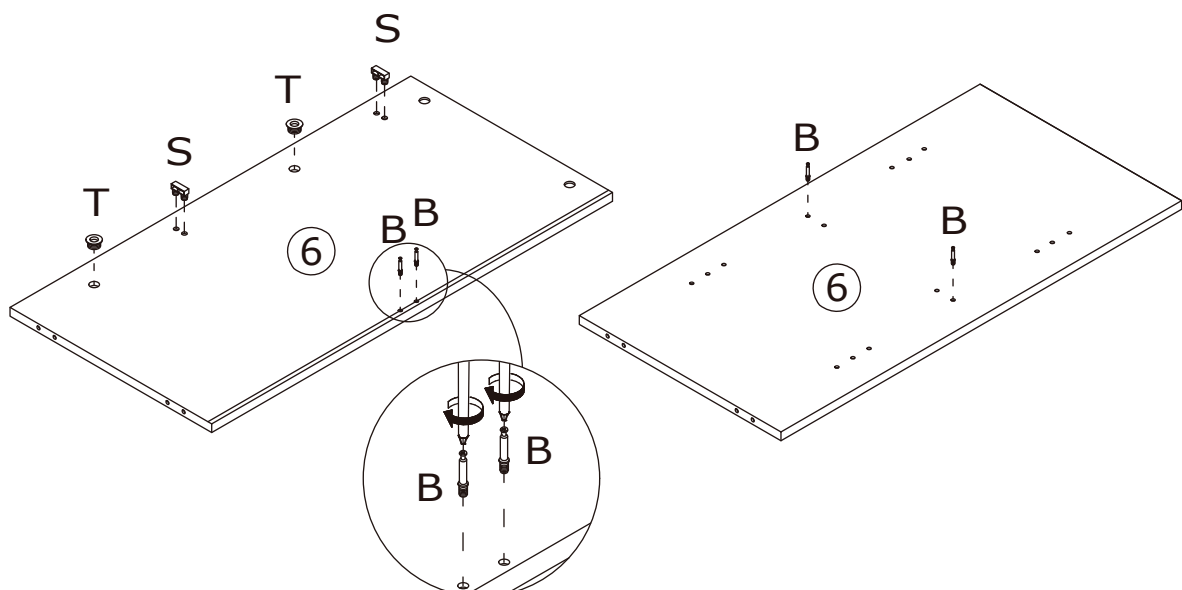
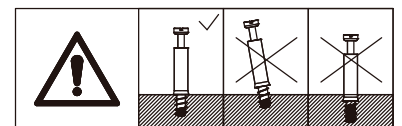

5



Attach plate 13 to plate 6 using wooden dowel(D), add cam lock(C) into plate 13 and turn clockwise to tighten as shown.

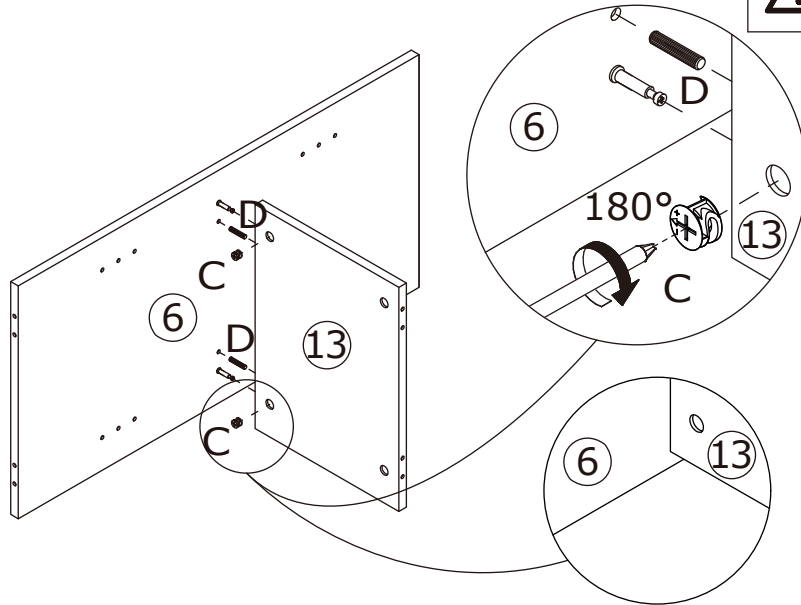
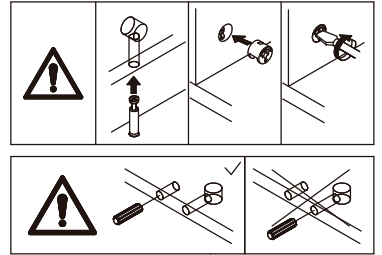

6

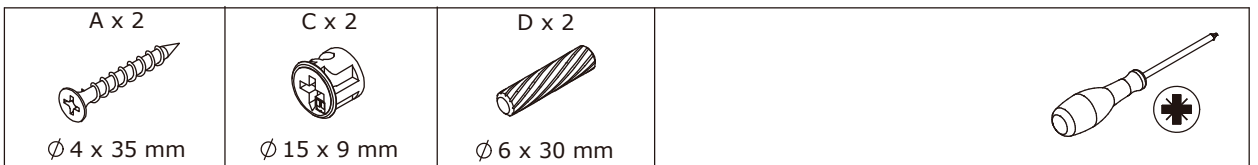

Attach plate 6 to plate 8 using wooden dowel(D), and fix with screw(A) as shown.

Attach plate 18 to plate 6, add cam lock(C) into plate 18 and turn clockwise to tighten as shown.

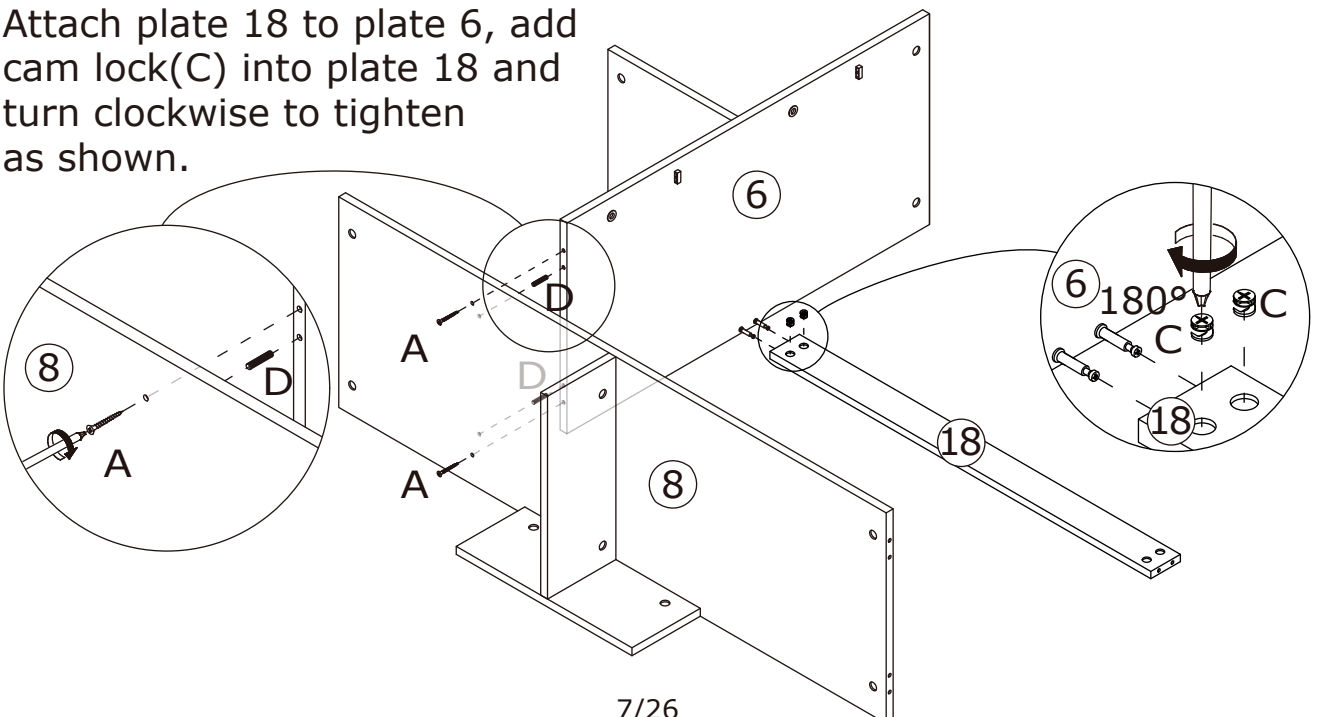

7

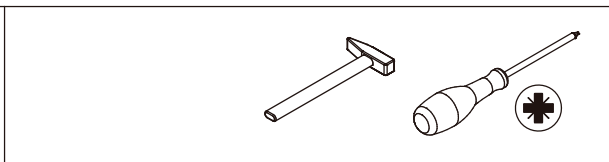
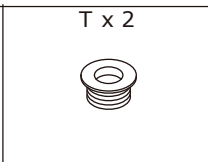
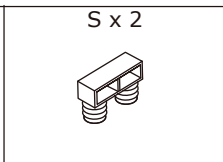
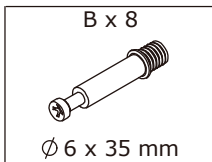

Screw eccentric rod(B) into plate 5 and 7 at first.
 Insert part(S) and (T) into plate 7 as shown.

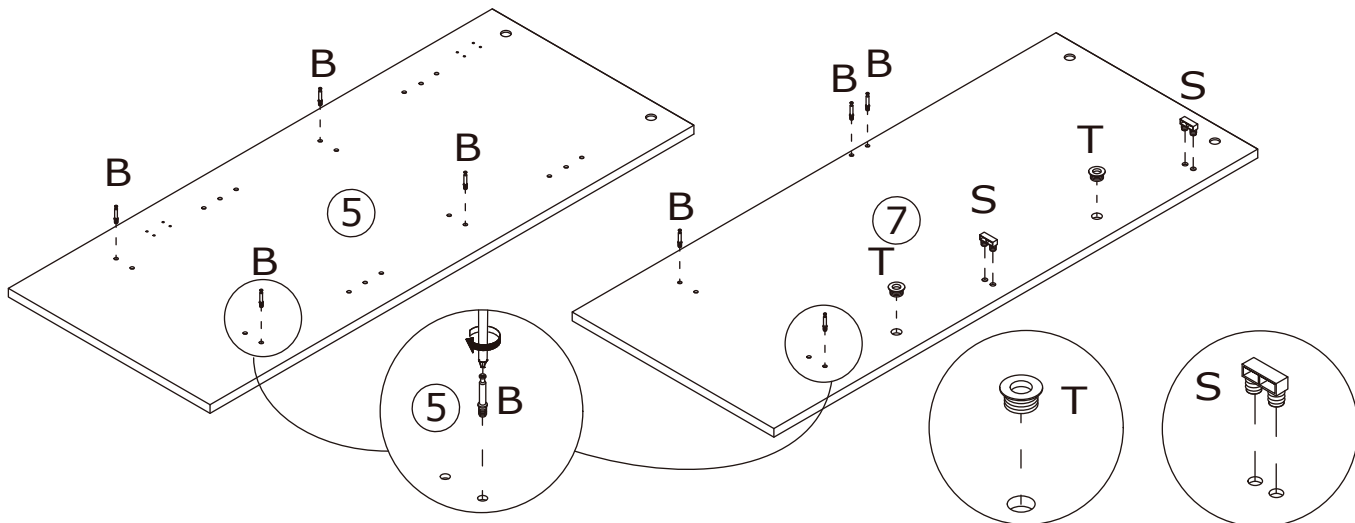
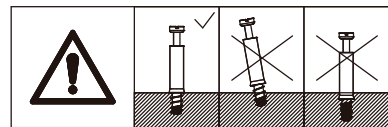

8

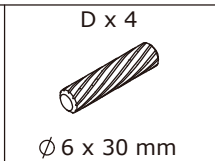
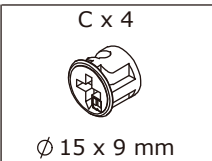

Attach plate 5 to plate 8 and 13 using wooden dowel(D), add cam lock(C) into plate 8,13 and turn clockwise to tighten as shown.

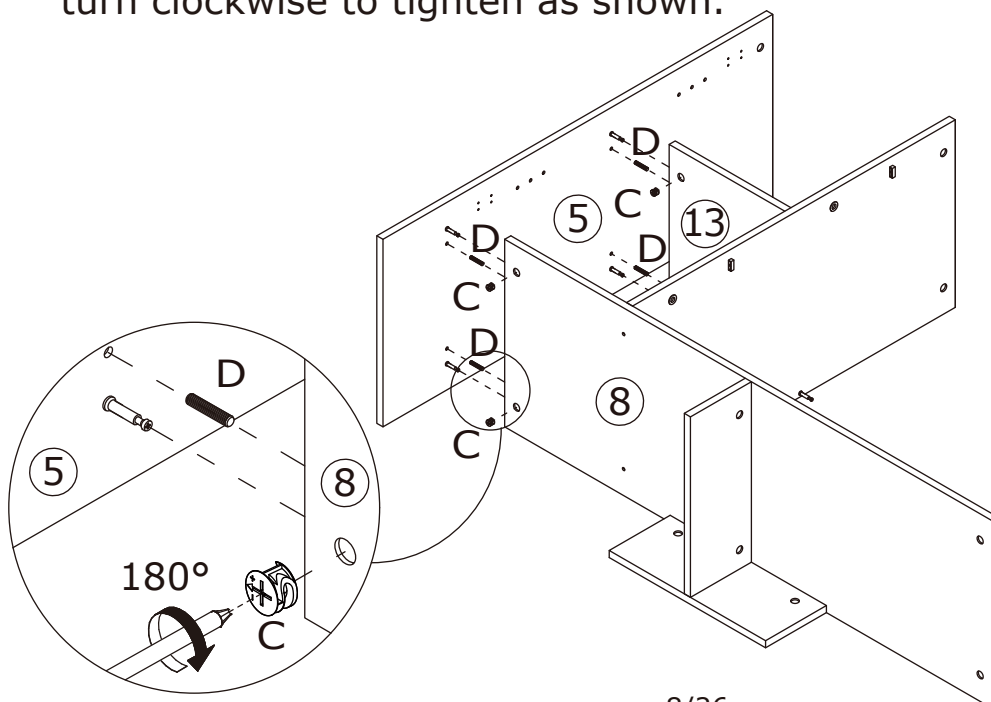
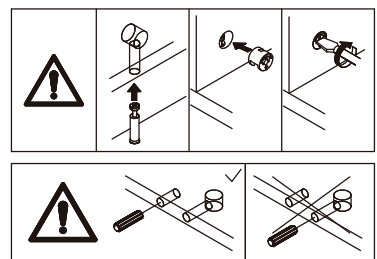

9

C x 4



Ø 15 x 9 mm

D x 2



Ø 6 x 30 mm



Attach plate 7 to plate 8 and 18 using wooden dowel(D), add cam lock(C) into plate 8,18 and turn clockwise to tighten as shown.

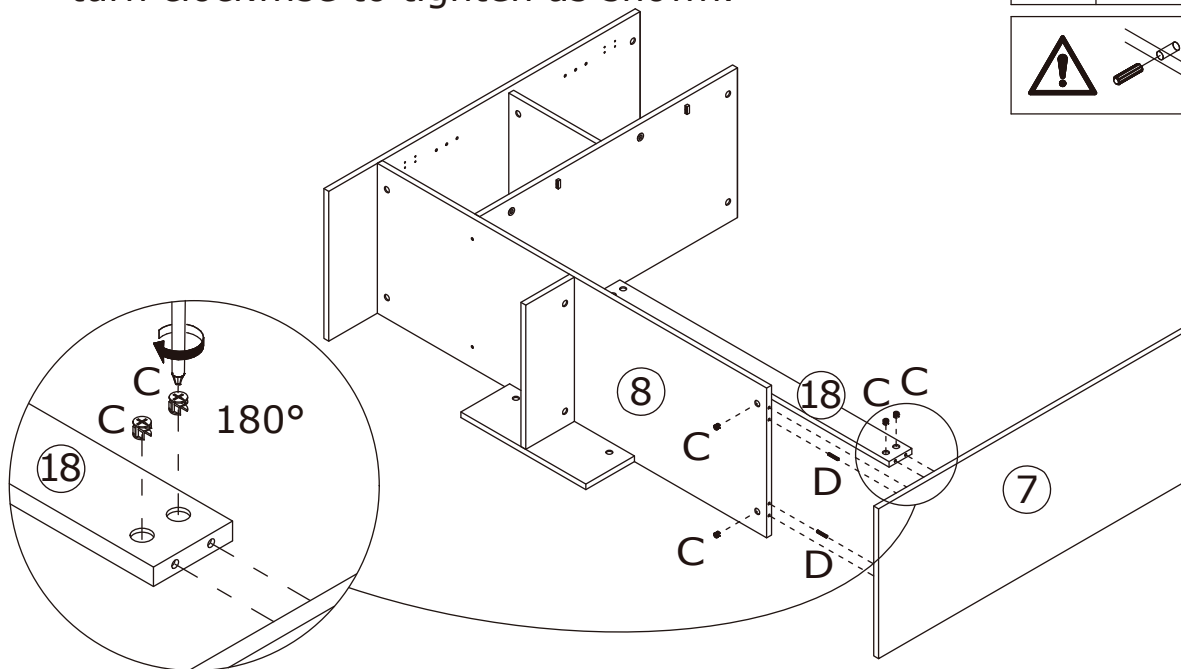
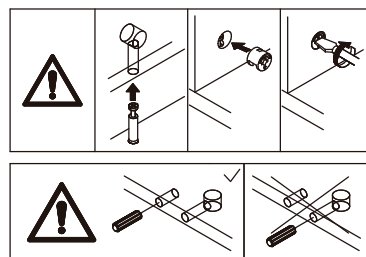

10

B x 12

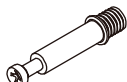

Ø 6 x 35 mm

X x 2

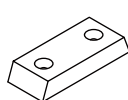

Z x 4



Ø 3 x 16 mm



Screw eccentric rod(B) into plate 1 and 9 at first. Fix part(X) to plate 1 with screw(Z) as shown.

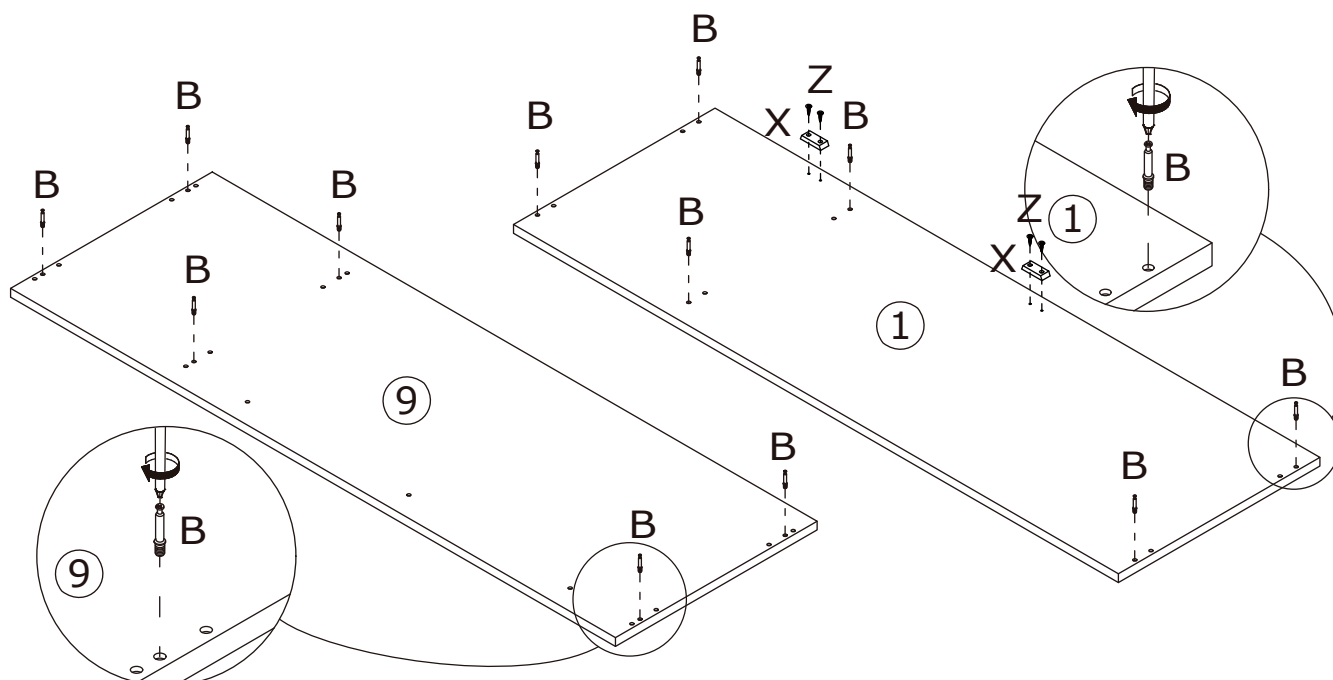
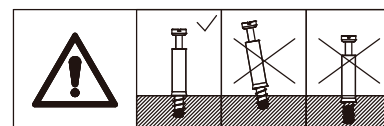

11

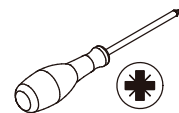
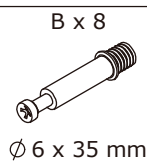

Screw eccentric rod(B) into plate 2 and 4 at first.

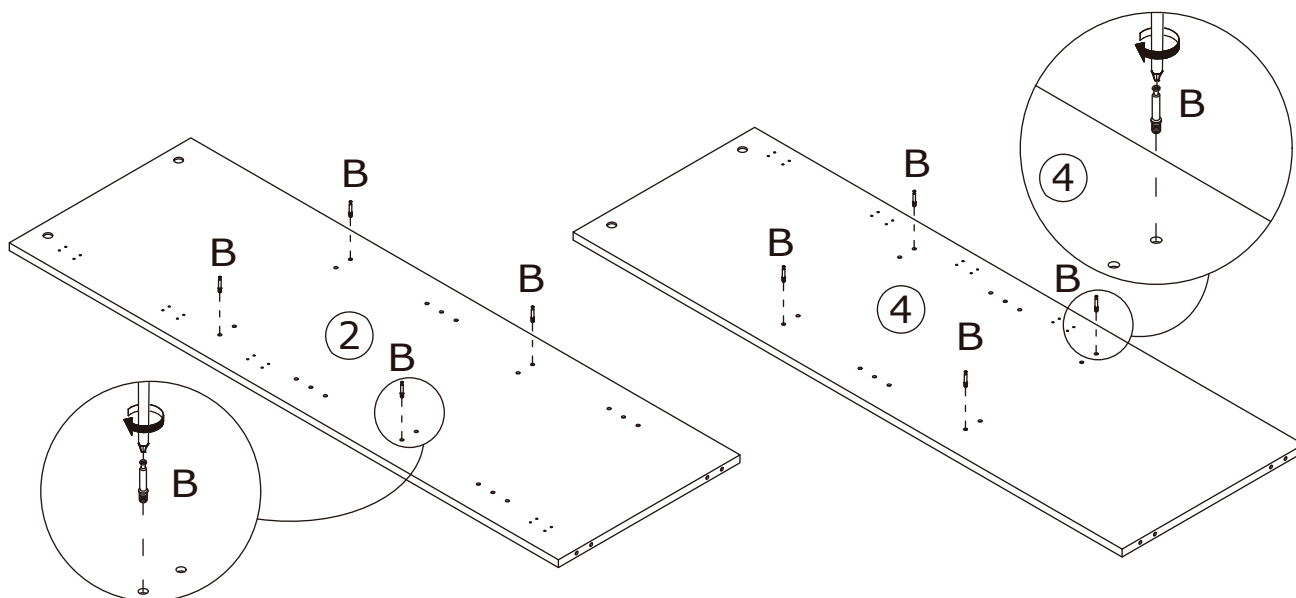
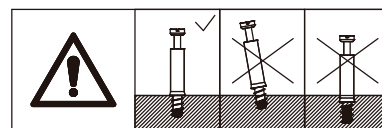

12

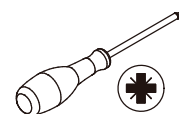
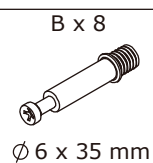

Screw eccentric rod(B) into plate 3 at first.
Flip to back, screw eccentric rod(B) into as shown.

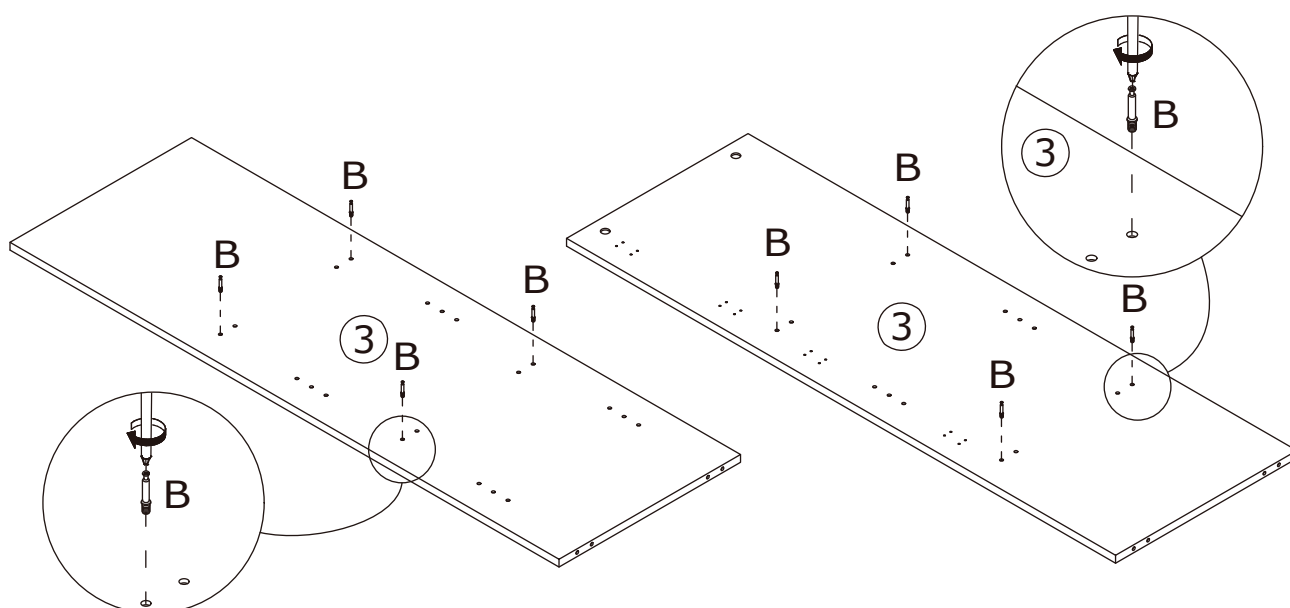
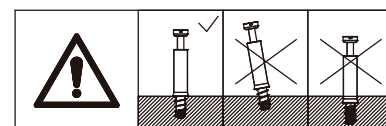

13

C x 4



Ø 15 x 9 mm

D x 4



Ø 6 x 30 mm

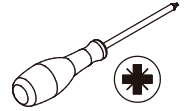

Attach plate 3 to plate 11 and 13 using wooden dowel(D), add cam lock(C) into plate 11,13 and turn clockwise to tighten as shown.

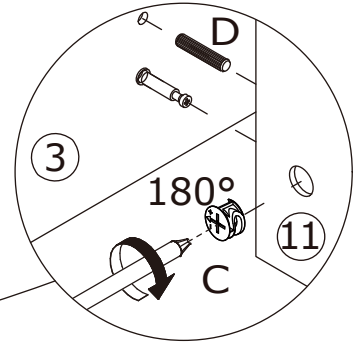
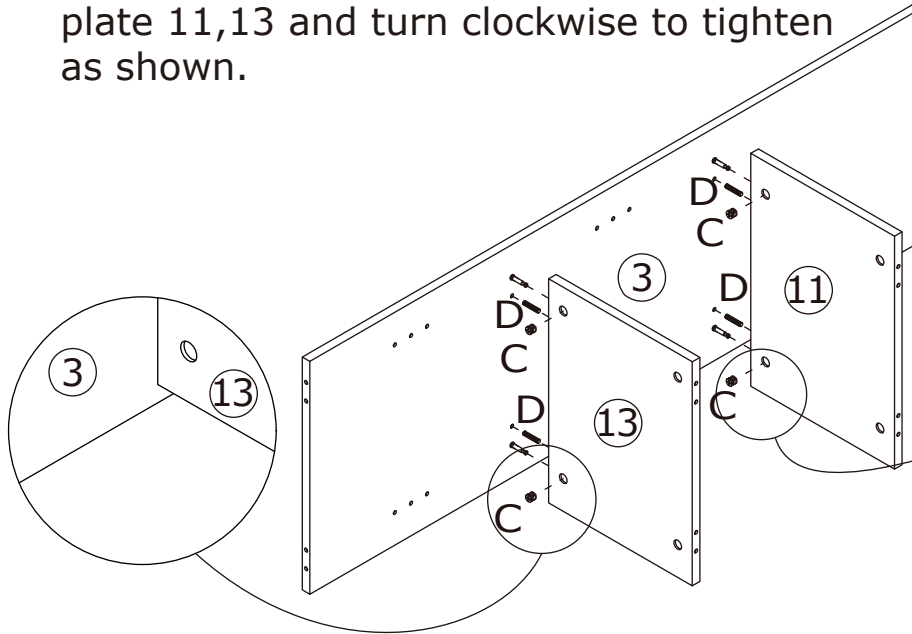
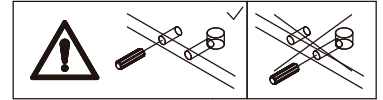
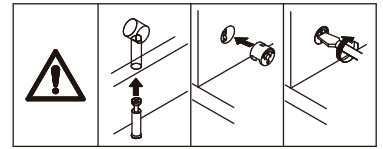

14

C x 4



Ø 15 x 9 mm

D x 4

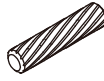

Ø 6 x 30 mm

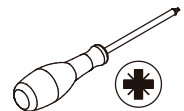

Attach plate 2 to plate 11 and 13 using wooden dowel(D), add cam lock(C) into plate 11,13 and turn clockwise to tighten as shown.

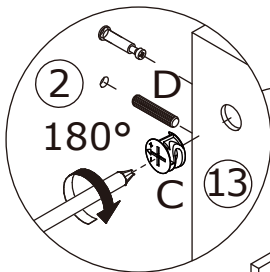
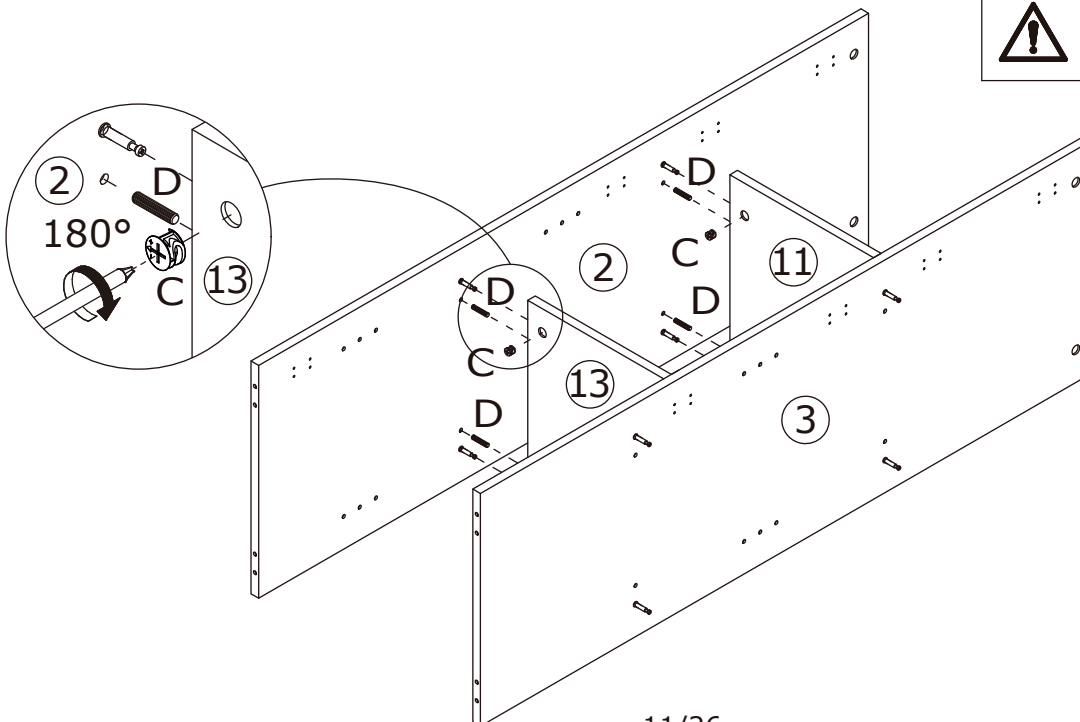
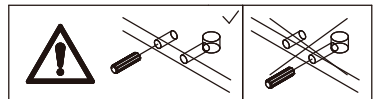
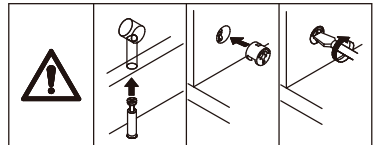

15

B x 3



Ø 6 x 35 mm

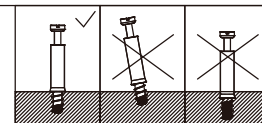
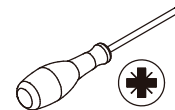

Screw eccentric rod(B) into plate 16 at first.

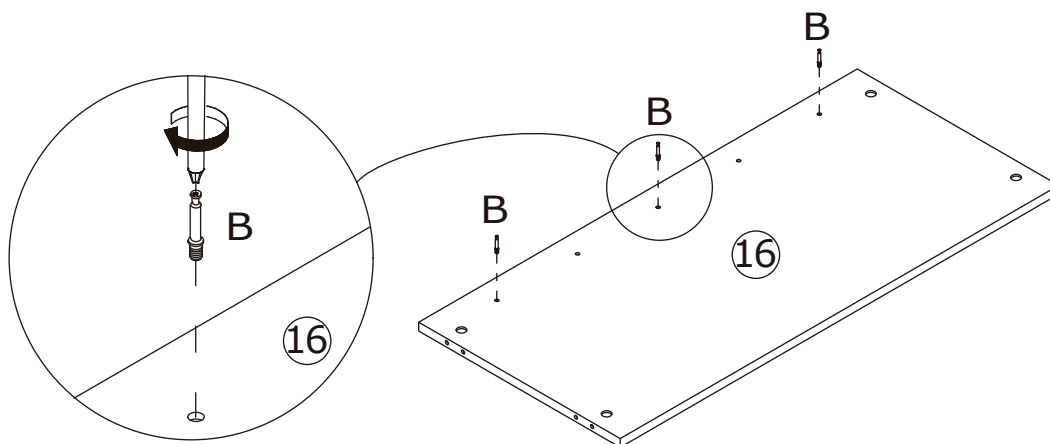

16

C x 4



Ø 15 x 9 mm

D x 4



Ø 6 x 30 mm

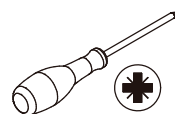

Attach plate 14 and 16 to plate 3 using wooden dowel(D), add cam lock(C) into plate 14,16 and turn clockwise to tighten as shown.

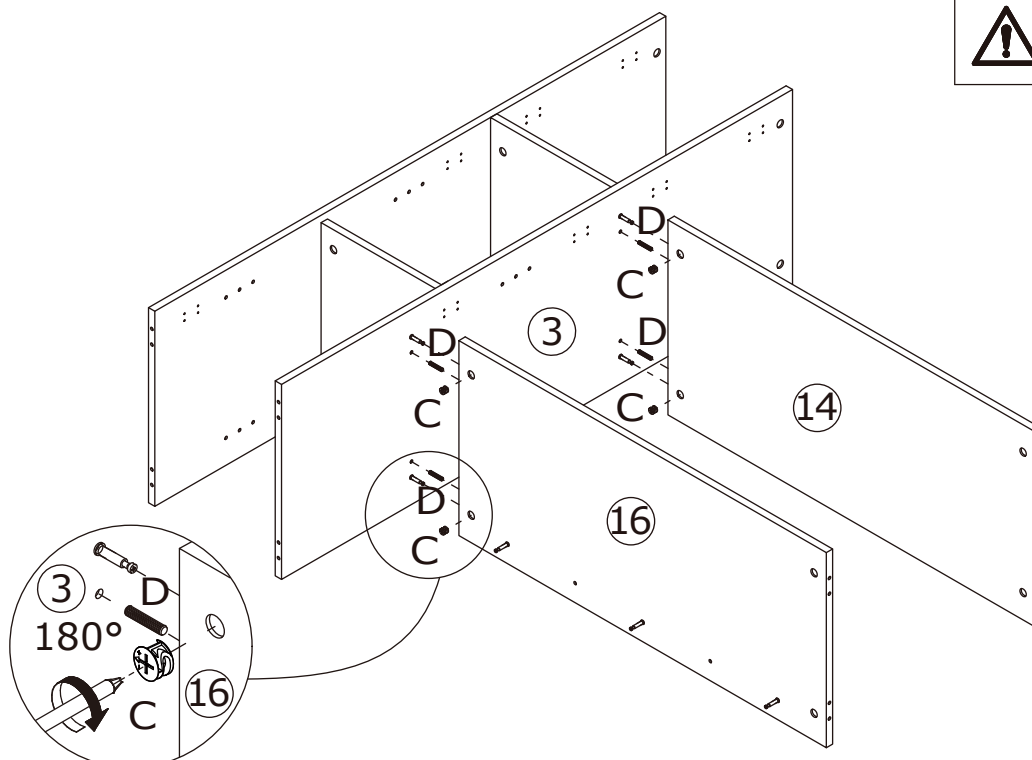
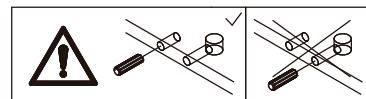
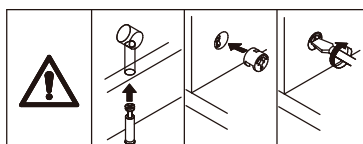

17

C x 4



Ø 15 x 9 mm

D x 4



Ø 6 x 30 mm

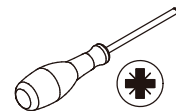

Attach plate 4 to plate 14 and 16 using wooden dowel(D), add cam lock(C) into plate 14,16 and turn clockwise to tighten as shown.

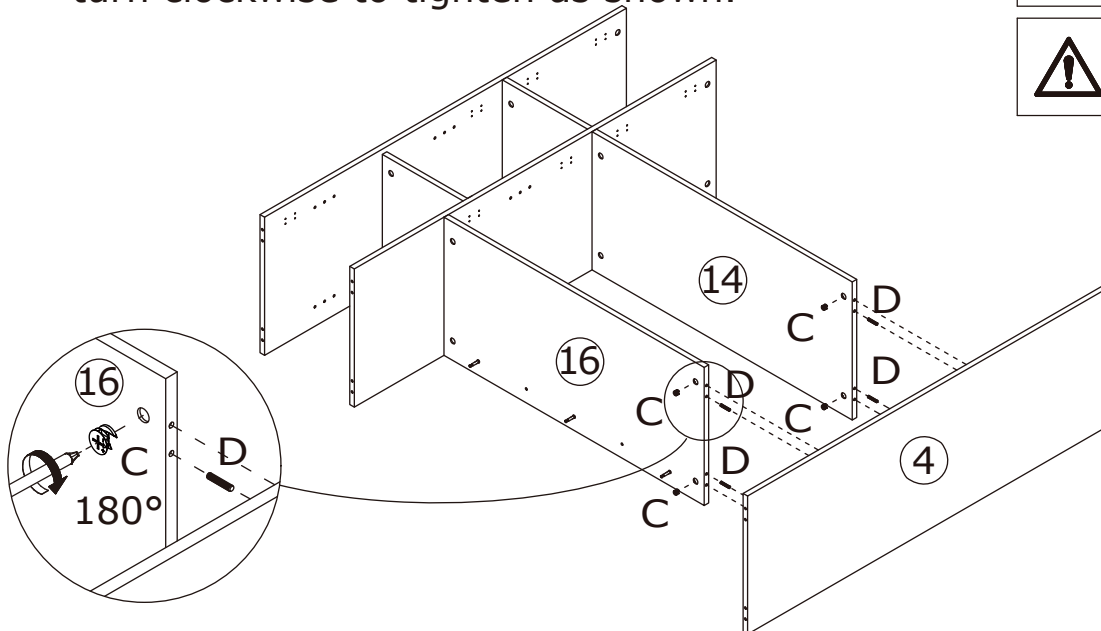
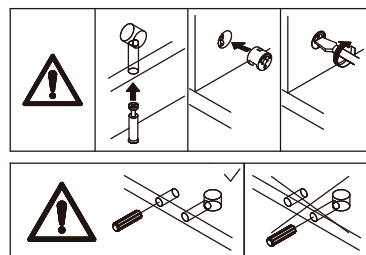

18

C x 6



Ø 15 x 9 mm

D x 6



Ø 6 x 30 mm



Attach plate 1 to plate 2, 3 and 4 using wooden dowel(D), add cam lock(C) into plate 2,3,4 and turn clockwise to tighten as shown.

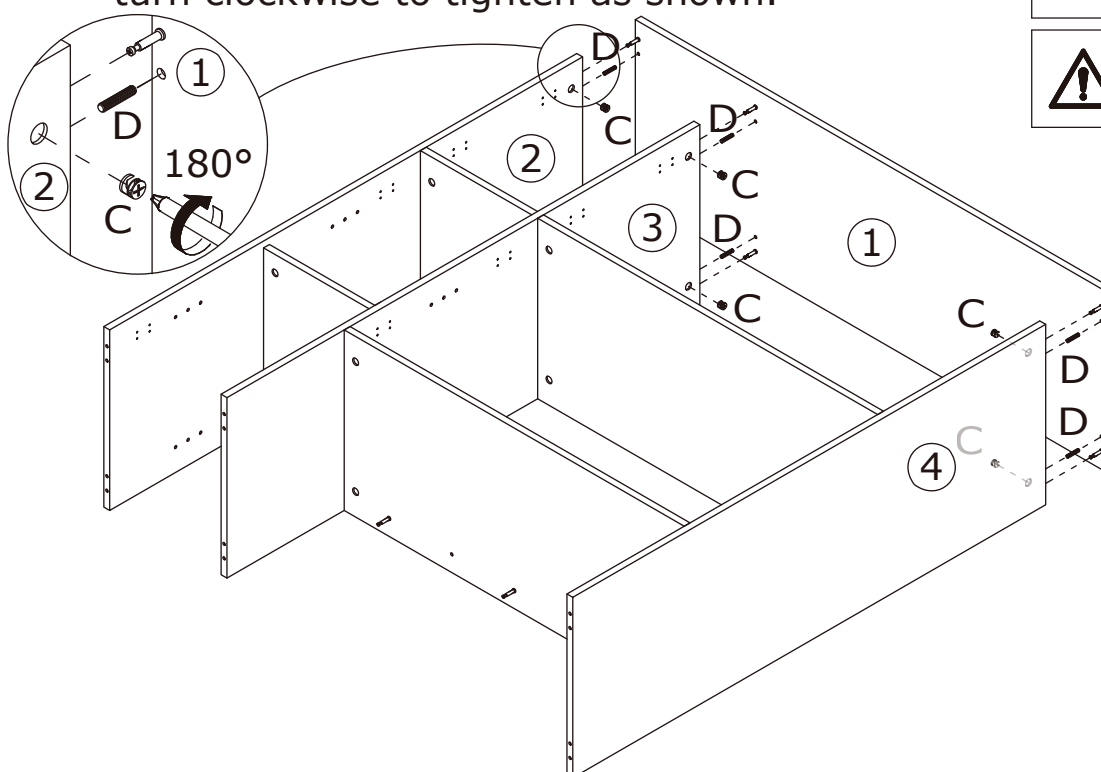
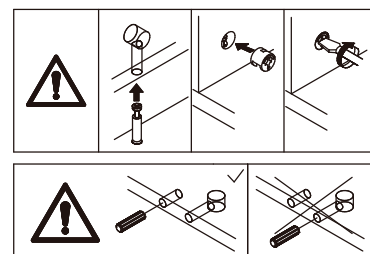

19

C x 3



Ø 15 x 9 mm

D x 2



Ø 6 x 30 mm

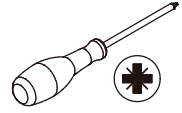

Attach plate 17 to plate 16 using wooden dowel(D), add cam lock(C) into plate 17 and turn clockwise to tighten as shown.

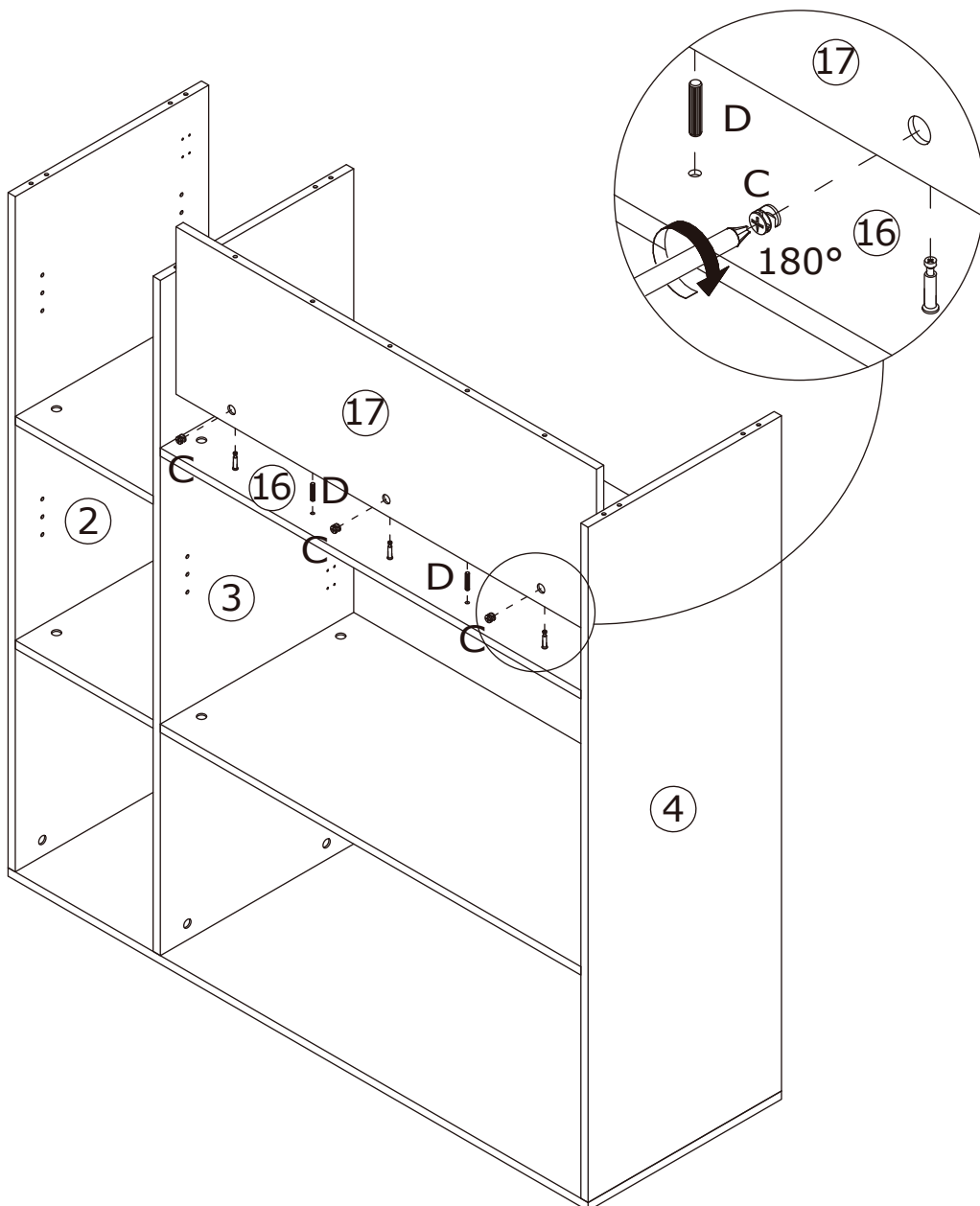
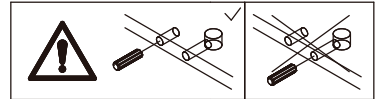
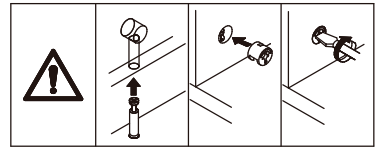

20

A x 9

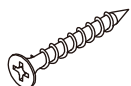

Ø 4 x 35 mm

D x 8



Ø 6 x 30 mm



Attach plate 9 to plate 2, 3, 17 and 4 using wooden dowel(D), and fix with screw(A) as shown.

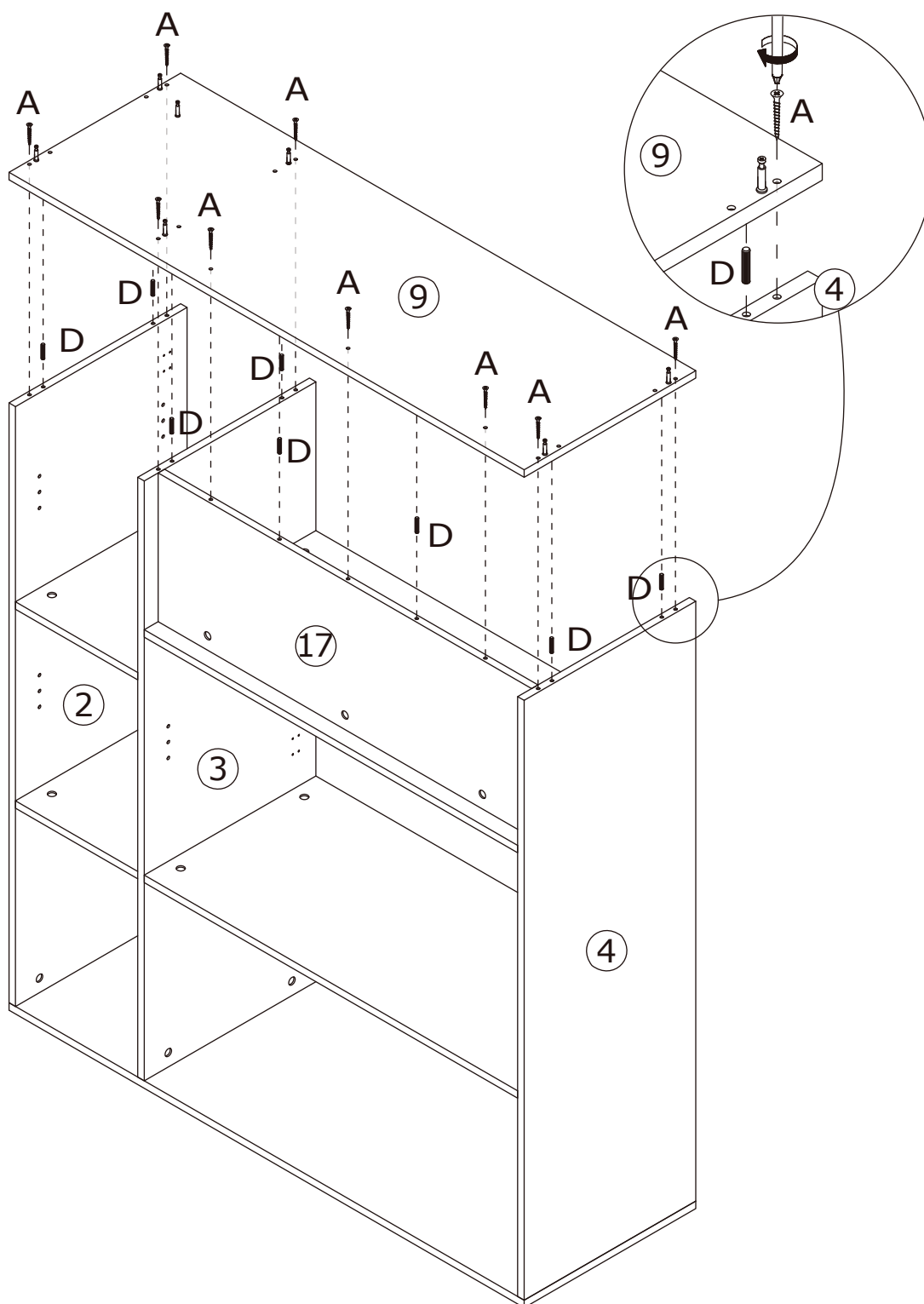

21

C x 6



Ø 15 x 9 mm

D x 6



Ø 6 x 30 mm

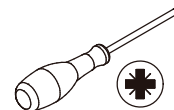

Connect the two components using wooden dowel(D), add cam lock(C) into plate 5,6,7 and turn clockwise to tighten as shown.

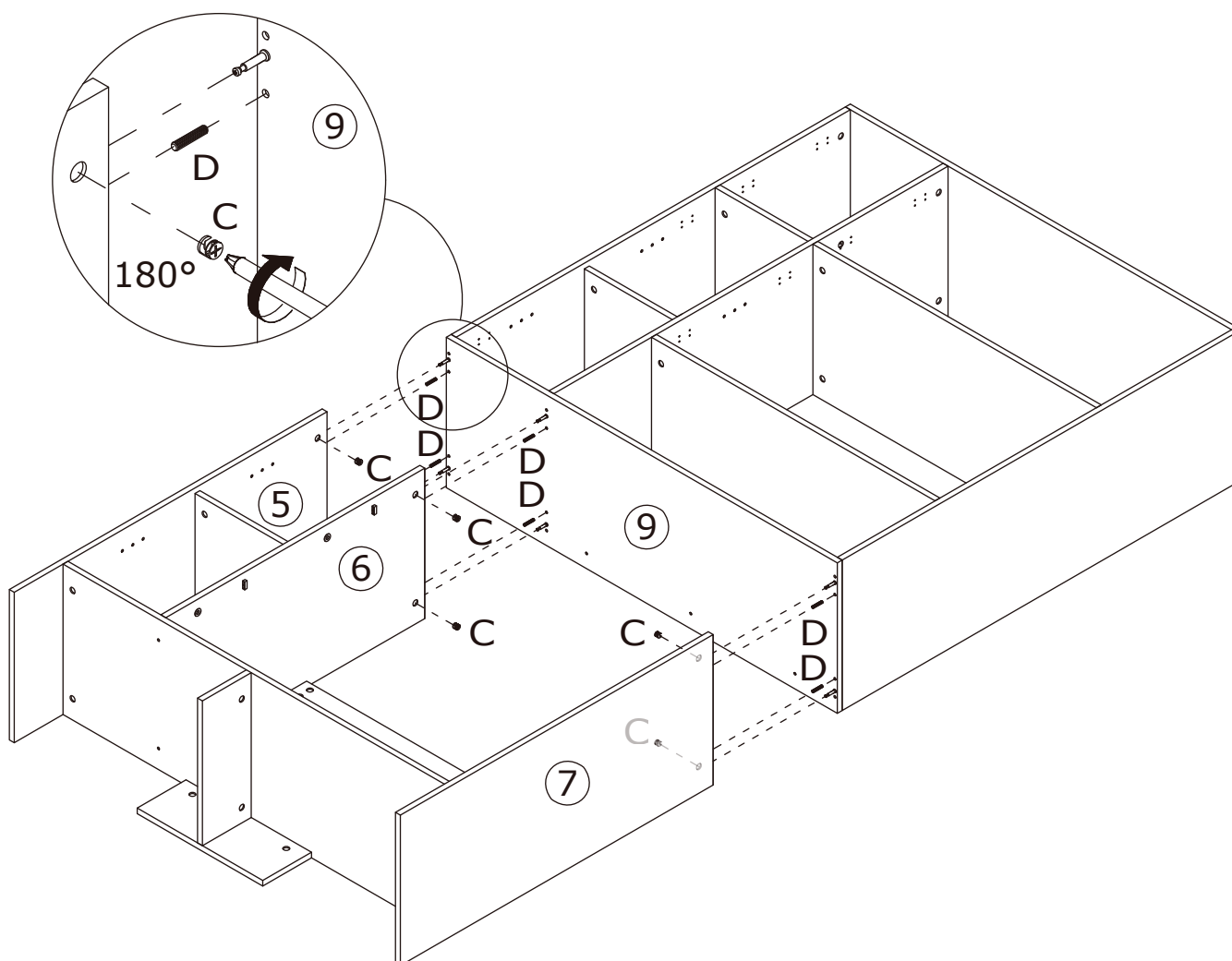
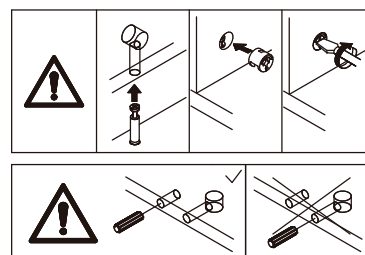

22

E x 69



Ø3 x 12 mm

V x 22

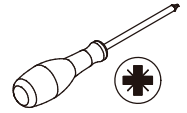

Fix back plate 10, 21, 22, 23 and 24 to the cabinet using screw(E) at first.

Use iron sheet(V) to connect each back plates together with screw(E) as shown.

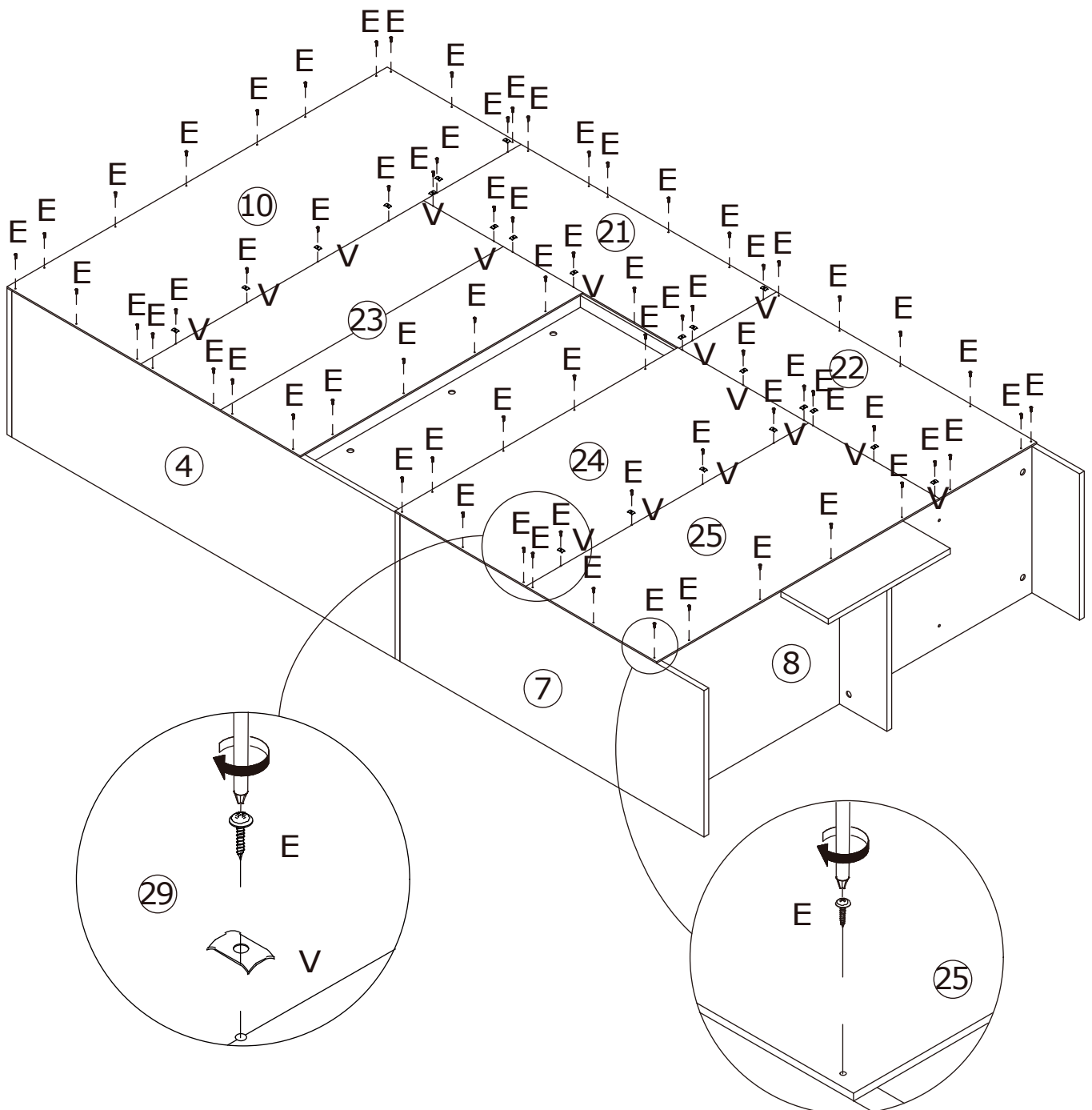

23

K x 16



Ø3.5 x 14 mm

L x 2

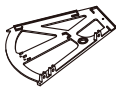

R x 2

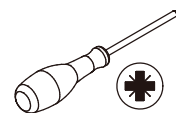
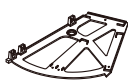

Fix plastic hinge(L) and (R) to plate 32 with screw(K) as shown.

Fix plate 33 to plastic hinges with screw(K) as shown.

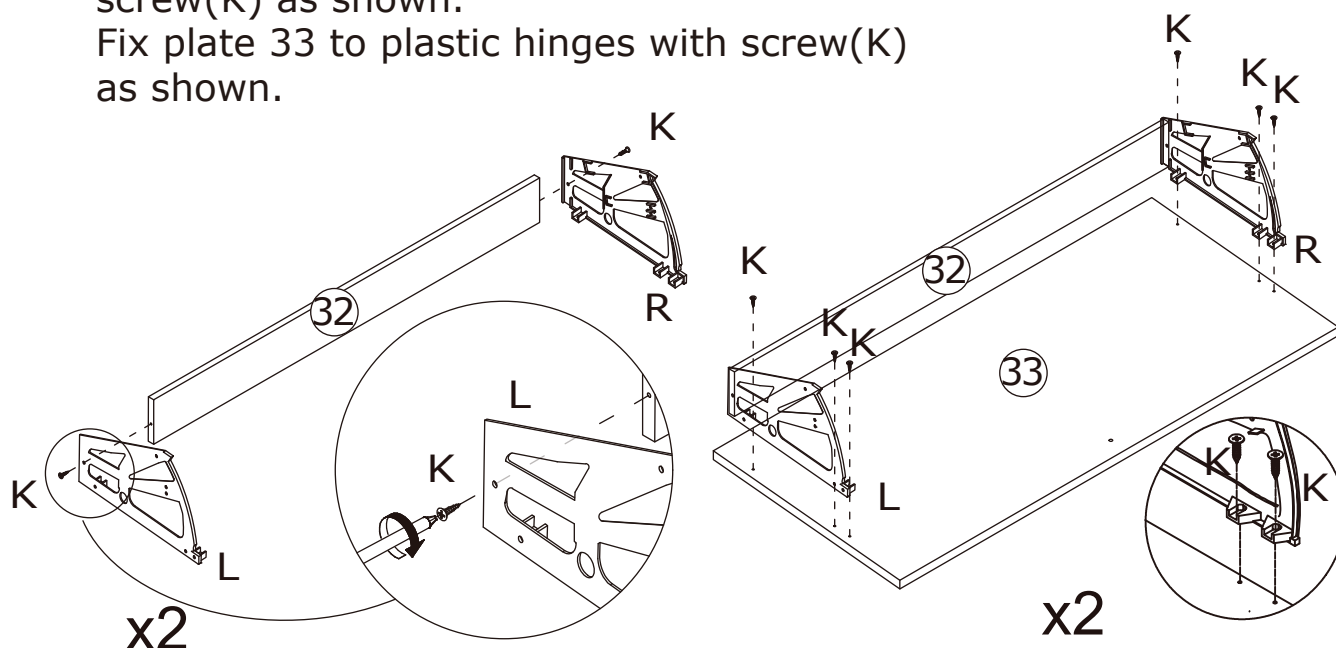

24

K x 4



Ø3.5 x 14 mm

N x 2



Ø4 x 14 mm

P x 2

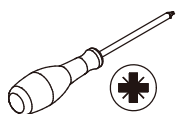

Fix plate 31 to plastic hinges with screw(K) as shown.

Fix knob(P) with screw(N).

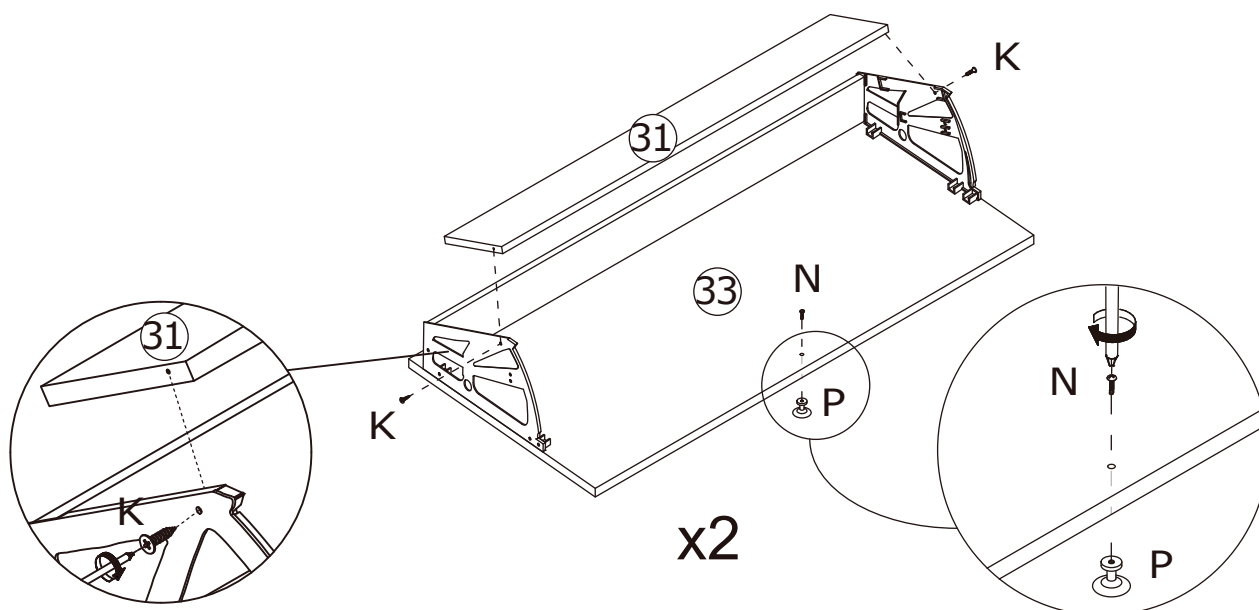

25

Y x 4



Ø4 x 12 mm

U x 4



Assemble the drawers to side plates through part(U) and fix with screw(Y) as shown.

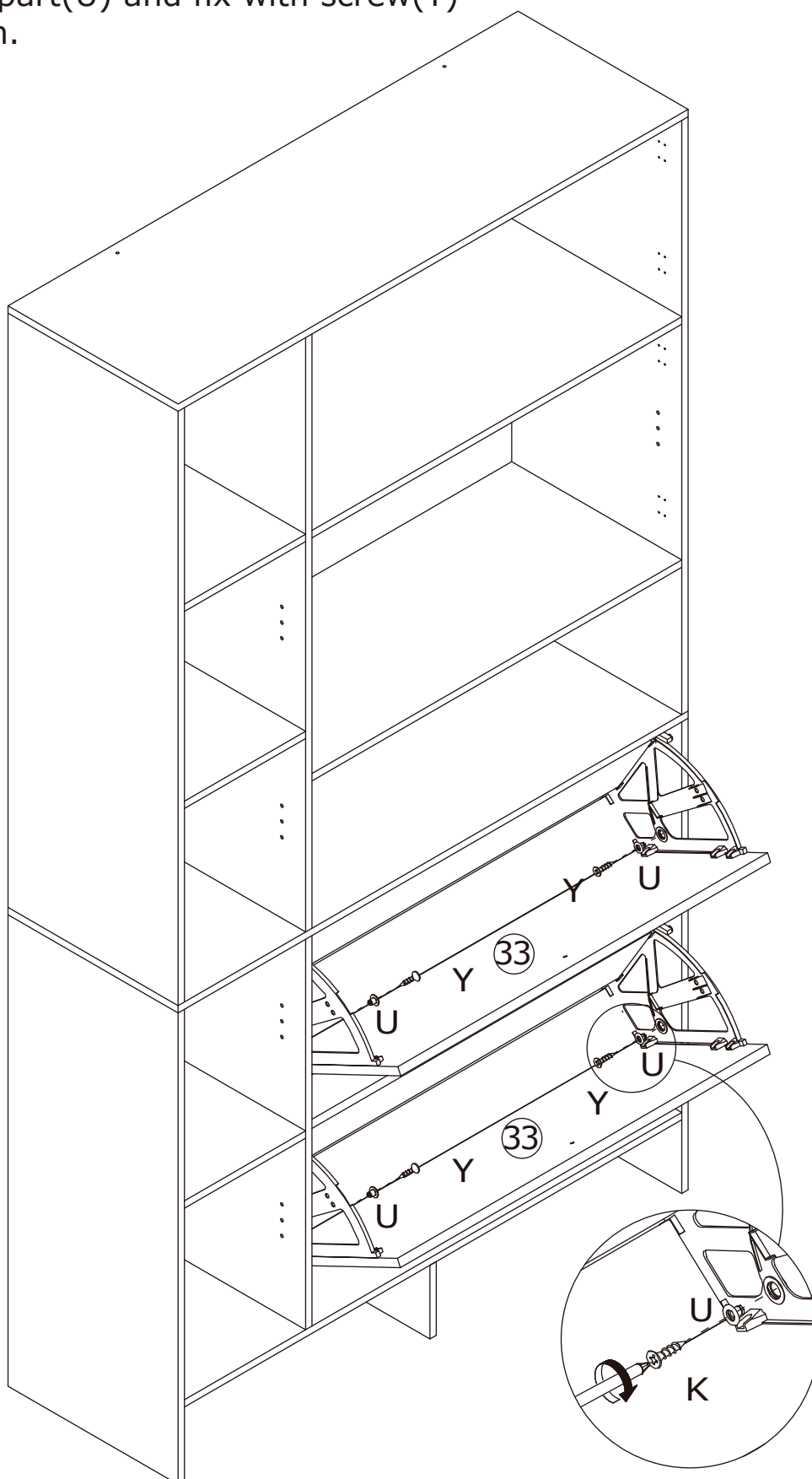

26

K x 4



Ø 3.5 x 14 mm

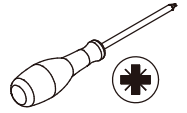

Fix plate 31 to plastic hinges
with screw(K) as shown.

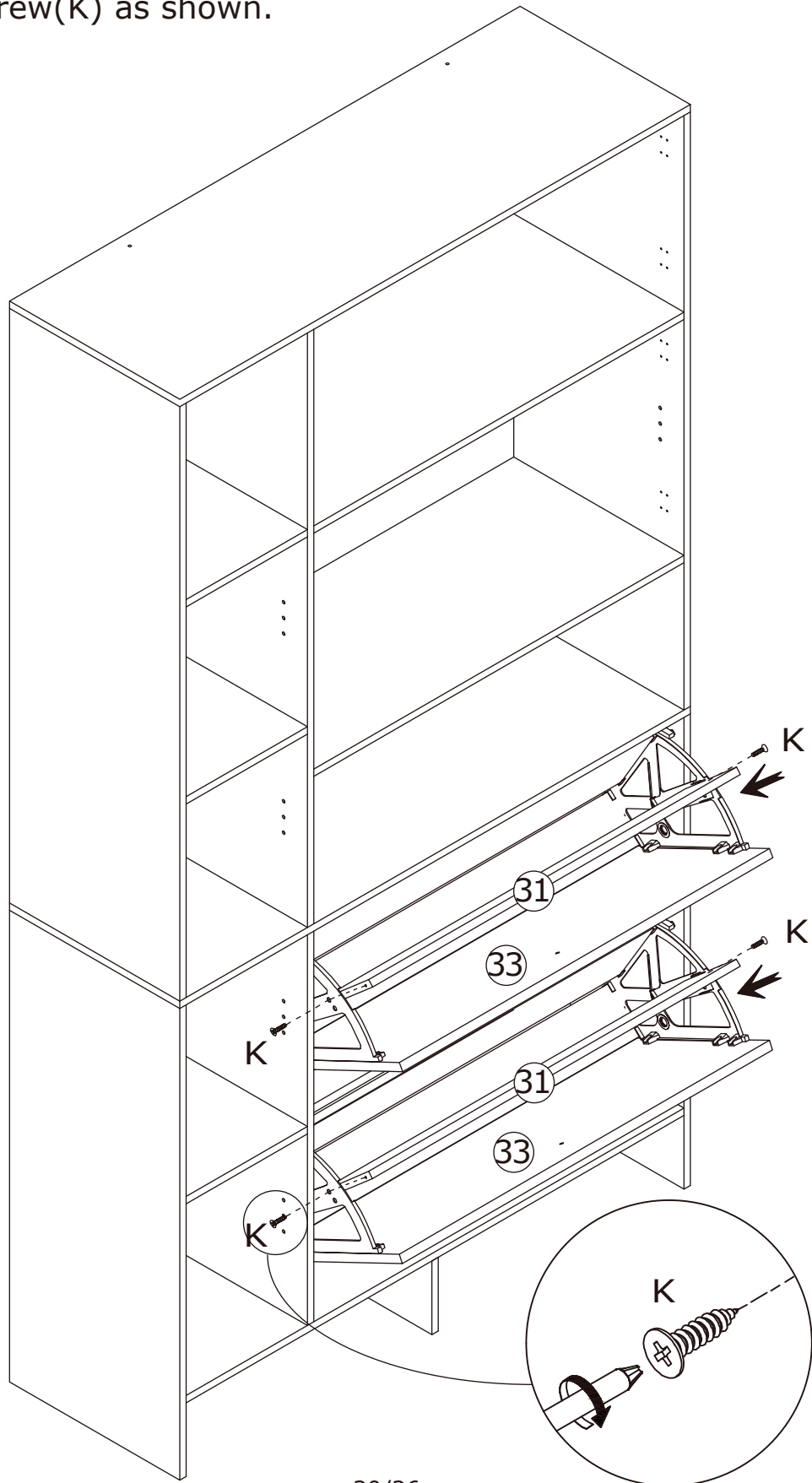

27

Q x 20



Insert layer pin(Q) into plate 2, 3, 4, 5 and 6,
then place shelf plate 12 and 15 on.

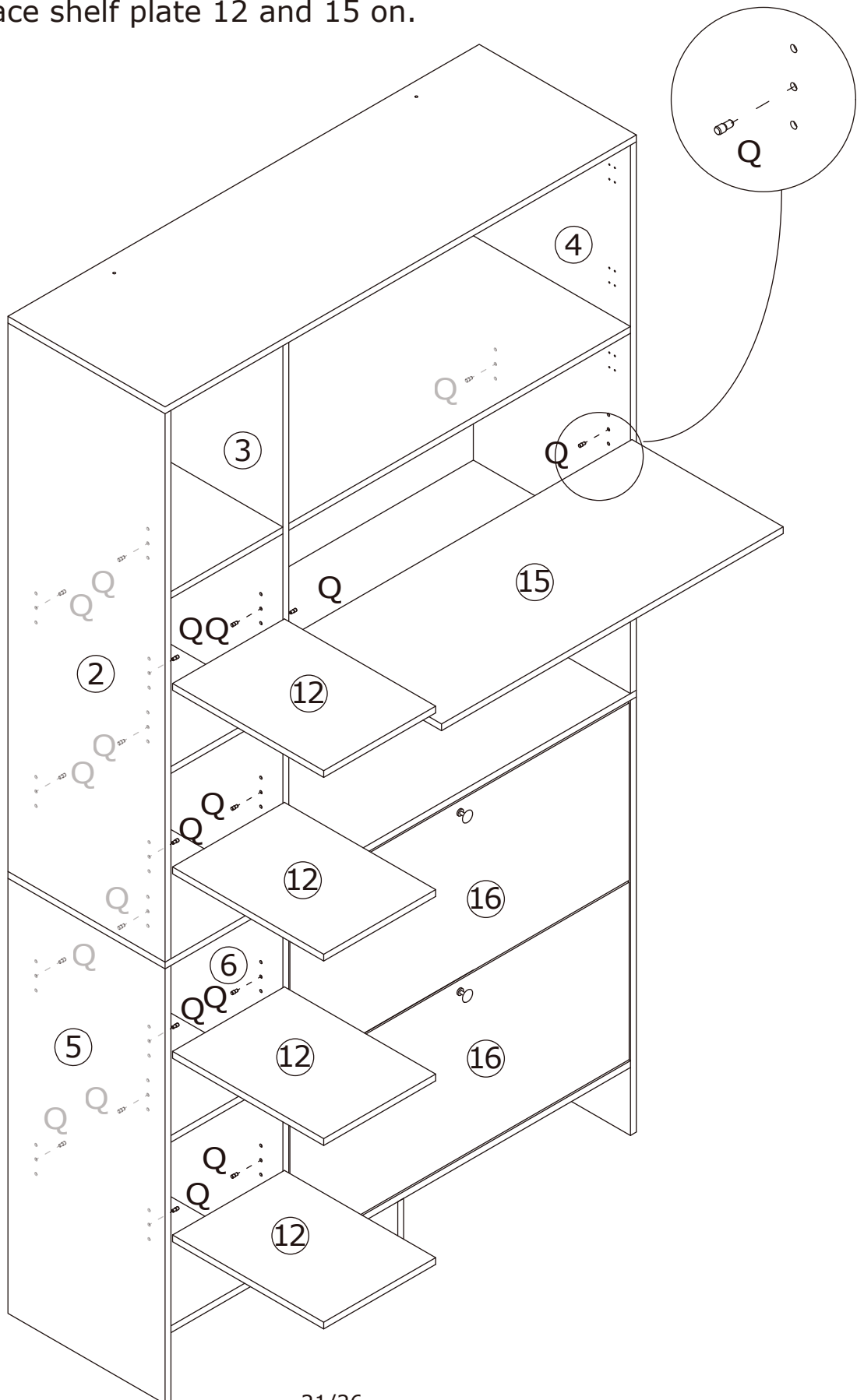

28

G x 8



Ø 3.5 x 12 mm

M x 4

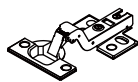

N x 2



Ø 4 x 14 mm

P x 2

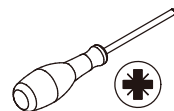

Fix hinge(M) to plate 27 with screw(G),
fix knob(P) with screw(N) as shown.

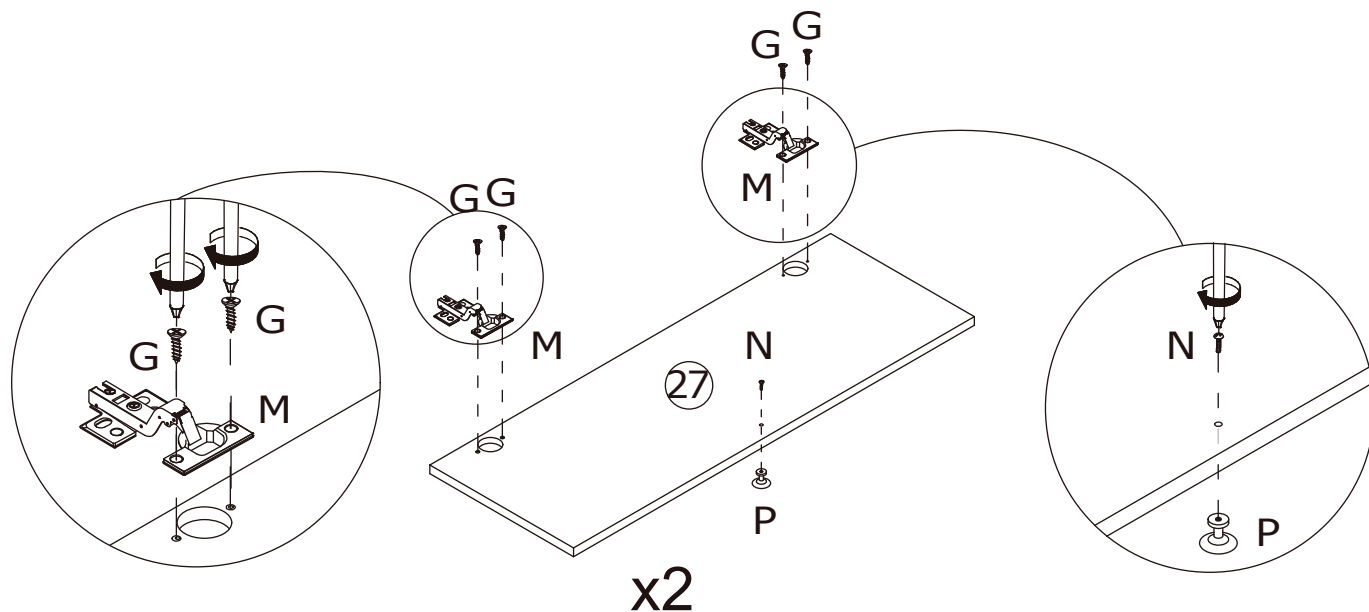

29

G x 4



Ø 3.5 x 12 mm

M x 2

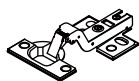

N x 1



Ø 4 x 14 mm

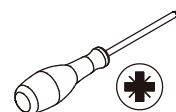

P x 1

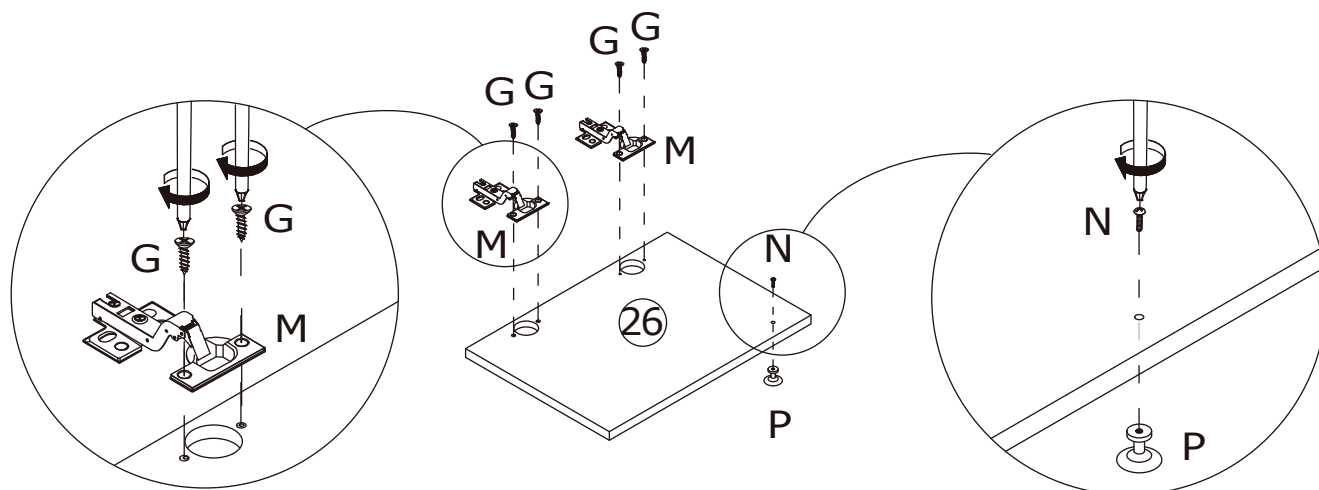

Fix hinge(M) to plate 26 with screw(G),
fix knob(P) with screw(N) as shown.



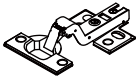

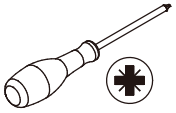

30

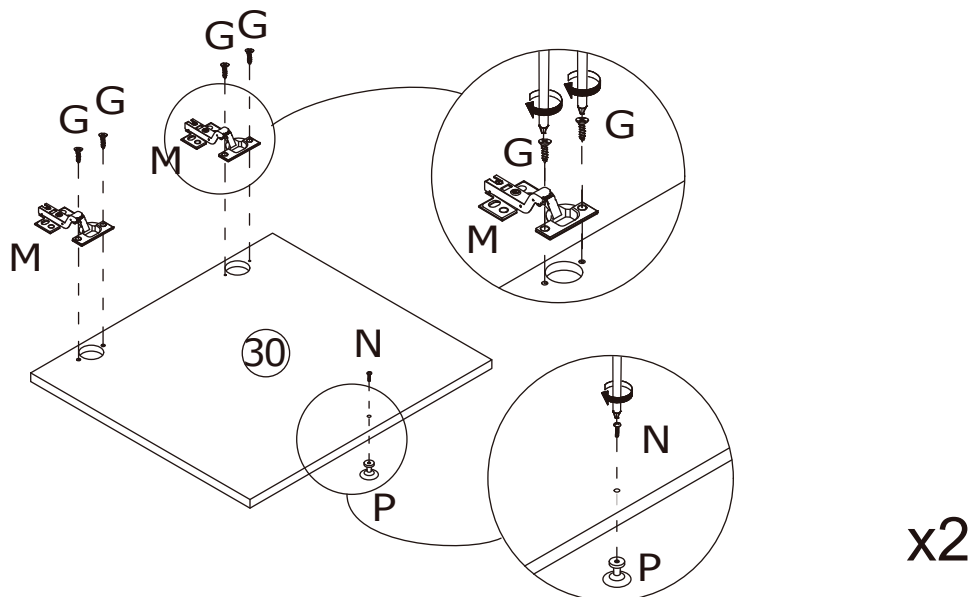
<p>G x 8</p>  <p>Ø 3.5 x 12 mm</p>	<p>M x 4</p> 	<p>N x 2</p>  <p>Ø 4 x 14 mm</p>	<p>P x 2</p> 	
---	--	---	---	---

Fix hinge(M) to plate 30 with screw(G),
fix knob(P) with screw(N) as shown.

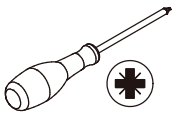

31

<p>G x 8</p>  <p>Ø 3.5 x 12 mm</p>	<p>M x 4</p> 	<p>N x 2</p>  <p>Ø 4 x 14 mm</p>	<p>P x 2</p> 	
---	--	---	---	---

Fix hinge(M) to plate 28 and 29 with screw(G),
fix knob(P) with screw(N) as shown.

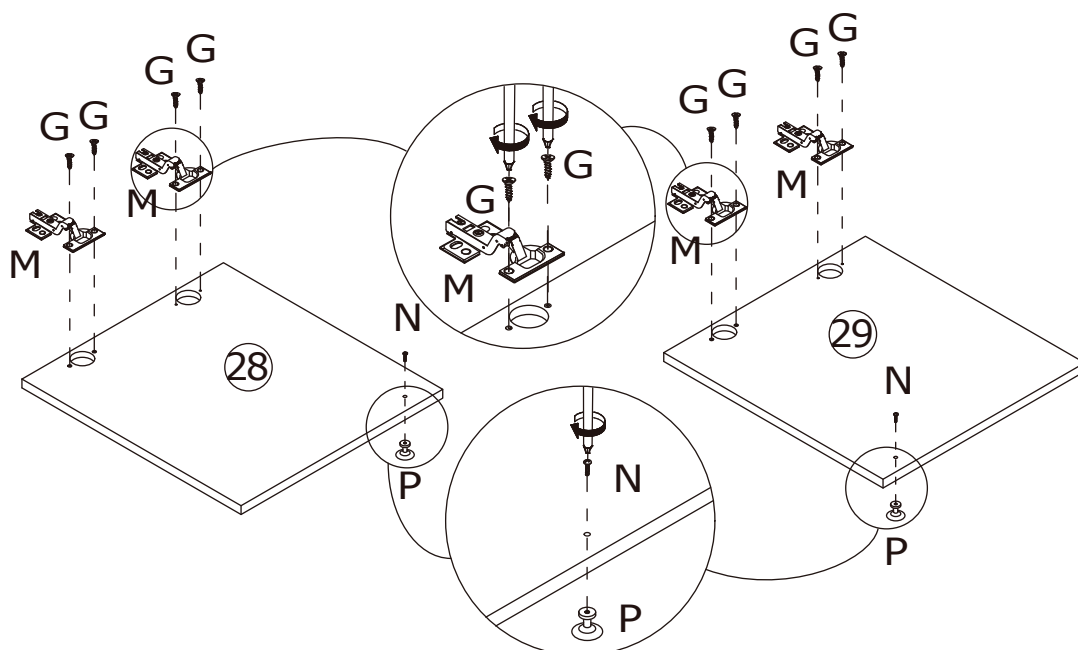

32

G x 56



Ø 3.5 x 12 mm

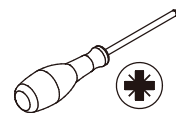

Assemble door plates to the item by fixing hinge with screw(G) as shown.

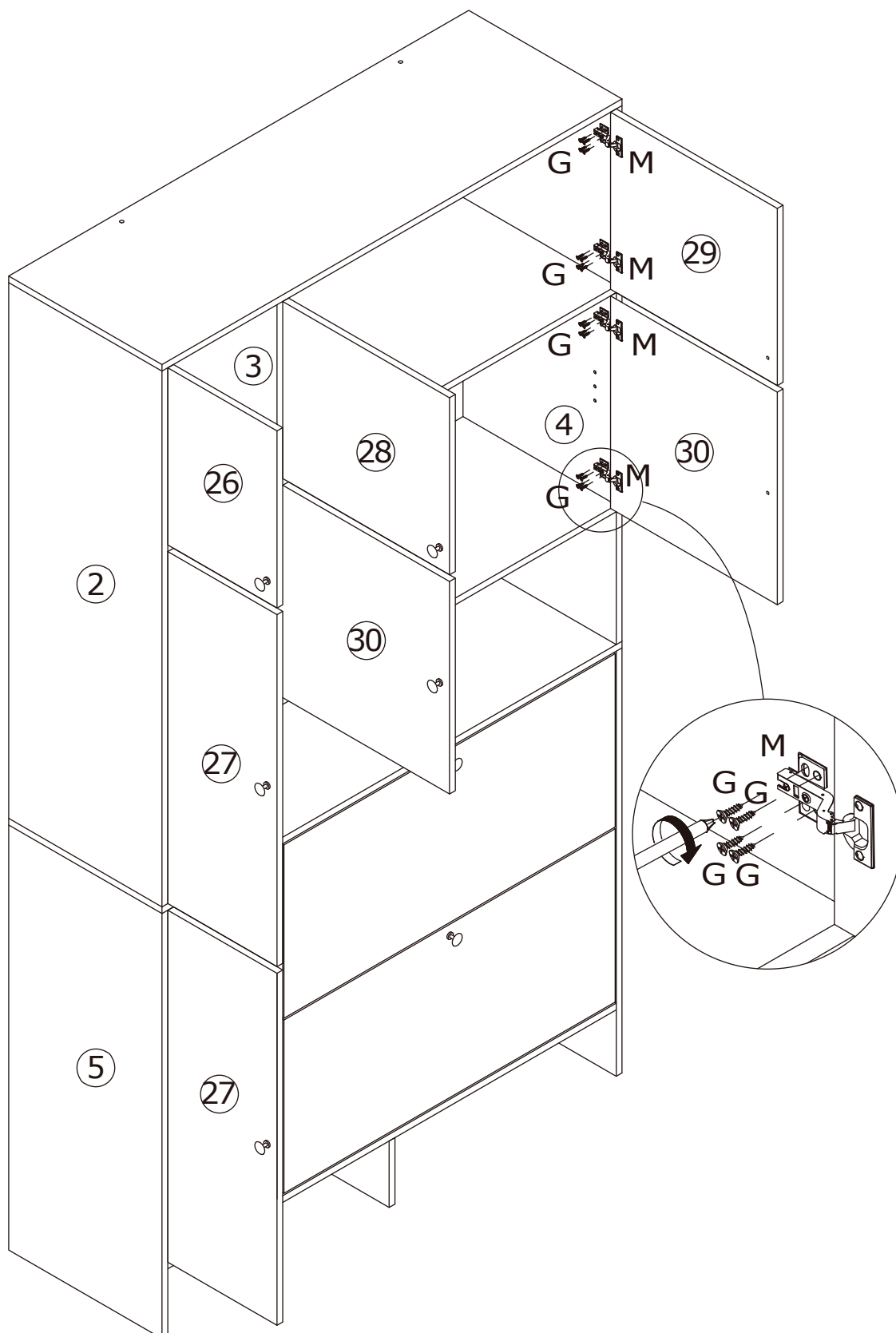

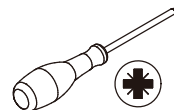

If doors are still not aligned if the hinges are properly correctly, please watch the video.

<https://youtu.be/n0Lb36SoODM>

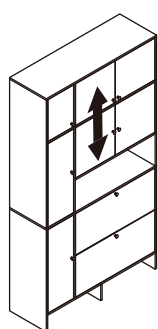
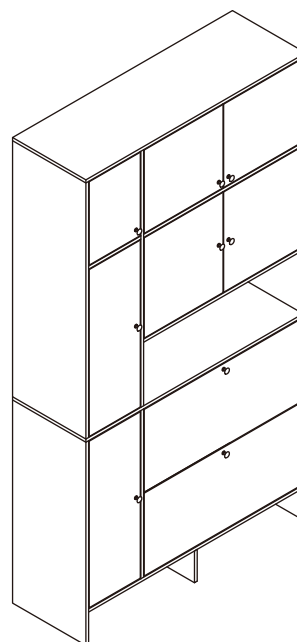

I

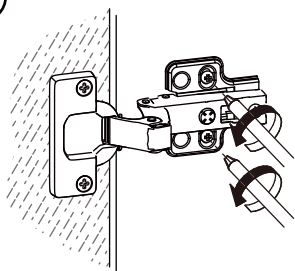

II

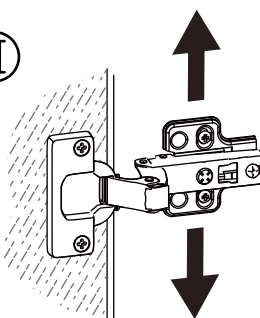

III

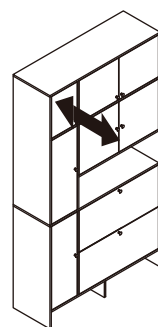
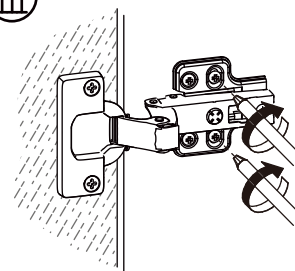

I

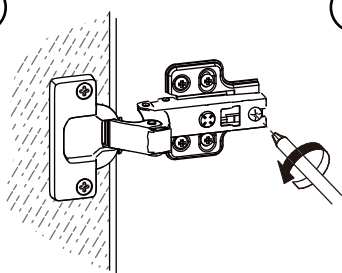

II

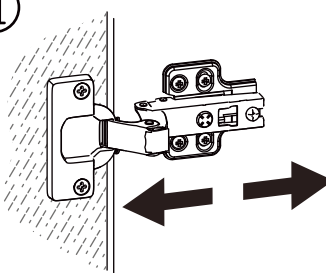

III

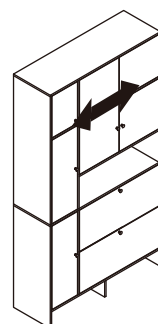
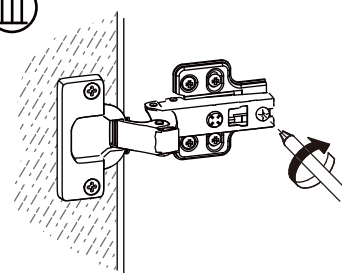



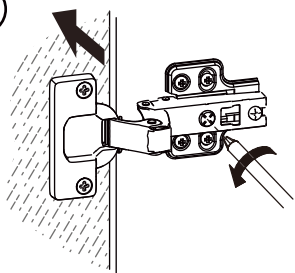

I

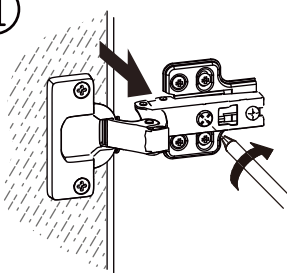

II

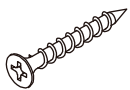

34

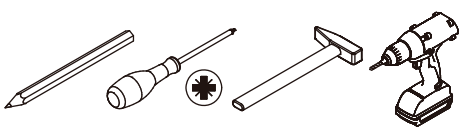
<p>A x 2</p>  <p>Ø4 x 35 mm</p>	<p>F x 2</p>  <p>Ø4 x 14 mm</p>	<p>H x 2</p> 	<p>J x 2</p> 	
--	--	--	--	---

Install anti-tipping device as shown.

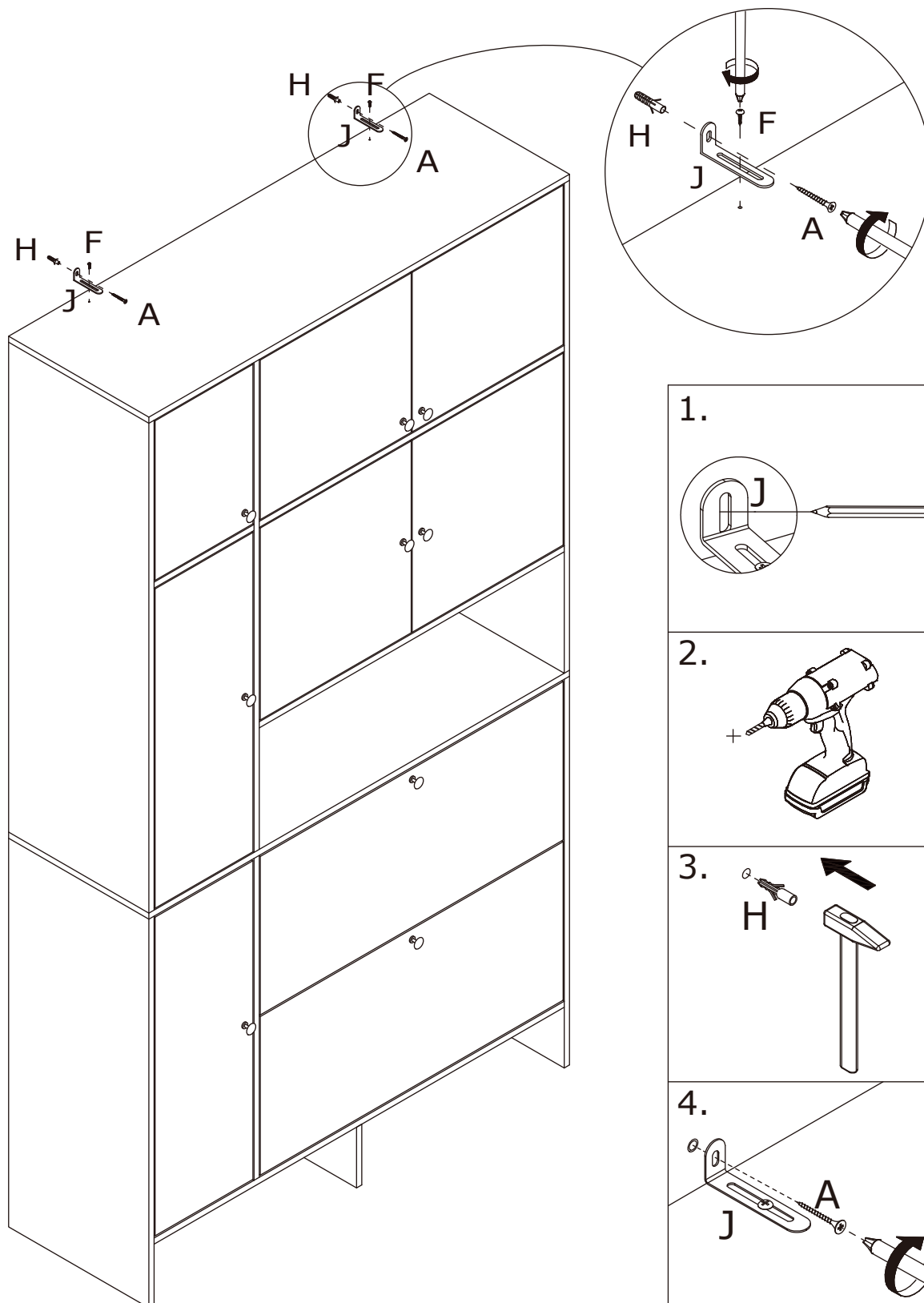

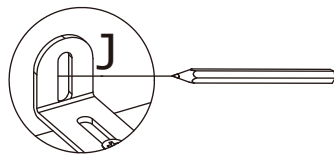
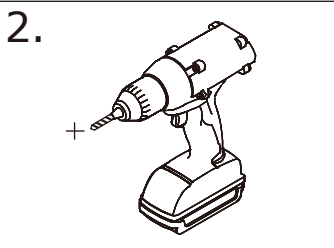
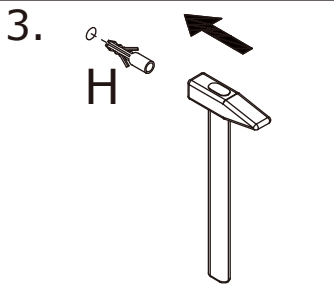
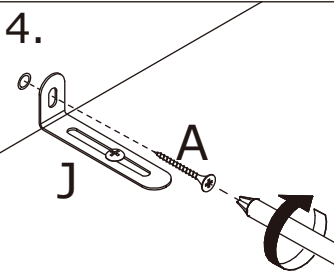
- 
- 
- 
- 

WARRANTY

WARRANTY CLAIMS

- There is a 30-day warranty for broken furniture or any other problems that do not work properly. The warranty will start from the date of purchase which must be verified by proof of purchase.
- Before making a claim, we may be able to answer your query, simply call us. Please leave your purchase order number, along with some details of the problem, if you want a replacement part. We will arrange within 48 hours. If there is out of stock, we will reply with a shipping date.
- The product must be used in accordance with the instructions provided. For health reasons.
- For other reasons, if the furniture needs to be returned, it must be cleaned and dried and operated within 30 days of receipt.

Type of Warranty Claim

- Failure to follow the furniture instructions will invalidate the warranty. Attention please.
- Does not include damage during installation, but includes damage during transportation.

Scope of responsibility

- Shall not bear any responsibility for misuse or user damage and / or loss of parts during the installation of furniture.
- After using, the damage and scratches of the furniture are not covered by the warranty.

The Warranty Relates to All Bought in The Us and Covers The Following Areas

- Sheet parts: 1 month from the date of purchase.
- Electrical parts: 1 month from the date of purchase.

RETURNS

CHANGED YOUR MIND AND NEED TO RETURN YOUR ITEM?

PLEASE FOLLOW THE BELOW INSTRUCTIONS:

- If you have purchased and have simply changed your mind, follow the retailer's instructions for returns.

DEFECTIVE ITEMS

- If your item is defective in any way, i.e. it doesn't work but you can't identify why, in the first instance, please call us.

DAMAGED ITEMS

- If you receive an order with obvious shipping damage from the retailer, then we suggest the delivery is refused. If the delivery has been accepted and then shipping damage is found, please follow the specific instructions advised by the retailer.
In all circumstances please save all packaging material and paperwork for the order. Please be aware that if you dispose of packaging material or attempt to return the merchandise without contacting the fulfiller, you jeopardise your chances of making a claim, and you may not receive a credit for the return.

AFTER-SALES CONTACT



feedbackstation@163.com



(303)800-6387