



PARKER 20

60" x 30" Skirted Acrylic Whirlpool

Model Number
6030PWSR064
Right Hand Drain Whirlpool in White
6030PWSL064
Left Hand Drain Whirlpool in White

Features

- Color-matched jet trim included
- 10 Self draining, adjustable hydrotherapy jets
- 3-Speed control for the 9 Amp pump
- AFR – Extended Skirt
- Constructed of high-gloss durable acrylic
- Textured floor
- Made in the USA



All dimensions are +/- 1/2" and subject to change without notice



***Standard Pump
Location**

This unit **DOES NOT** have removable access panels on the skirt.

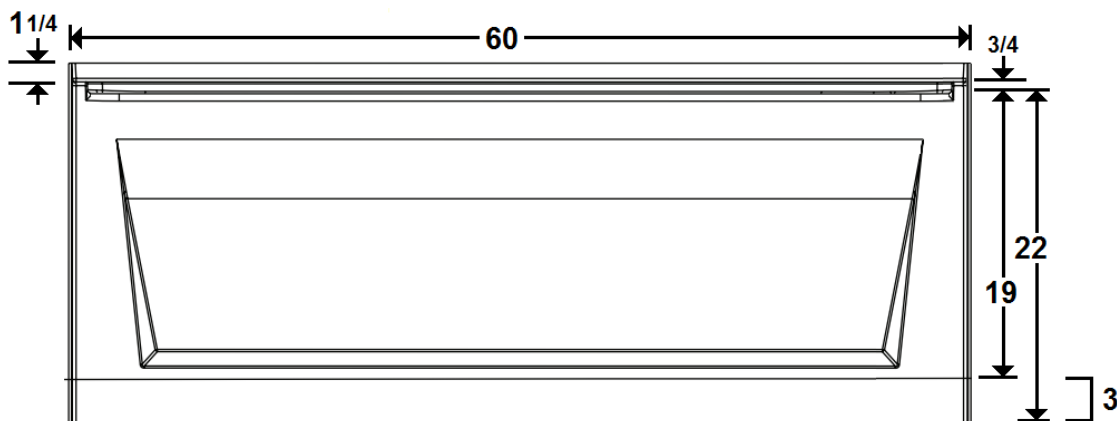
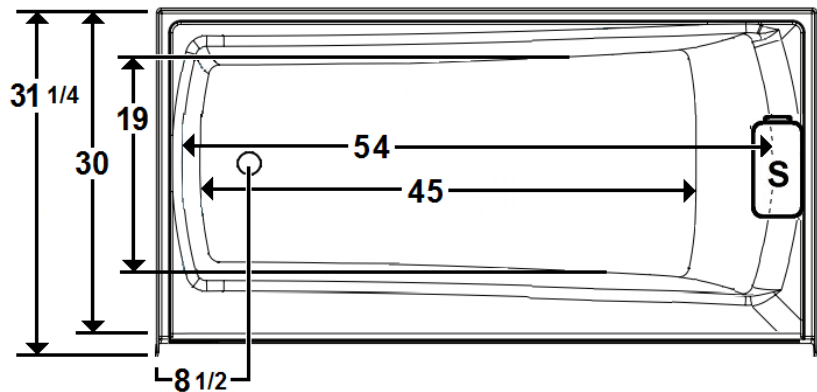

Technical Information

- Weight: 153 lbs.
- Water Depth to Overflow: 14"
- Water Operating Level:
- Water Capacity: 55 gal.
- Sump Dimension: 45" x 19"

Electrical Requirements

- Standard Pump: 9 Amps
- 20amp Dedicated GFCI's required