

Mounting instruction

Mirror Back View

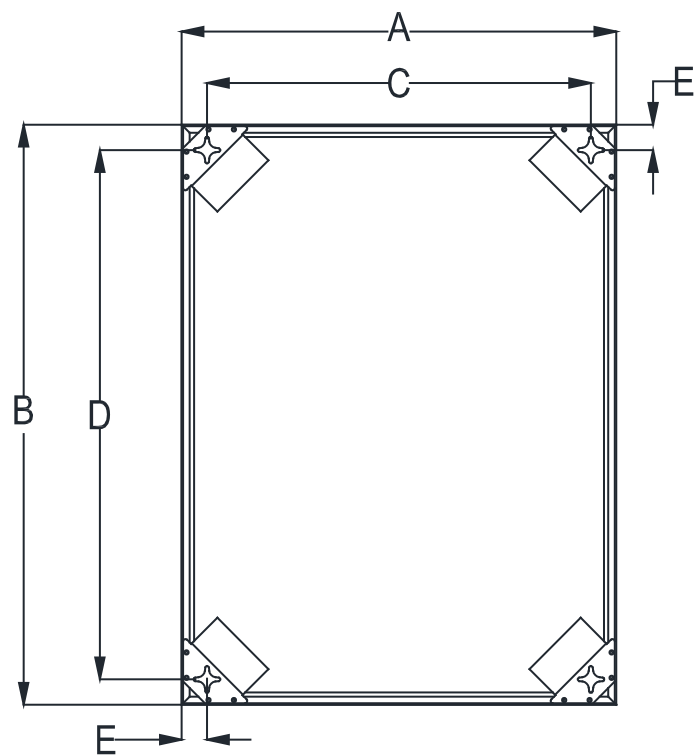

Size & Distance Chart

A	B	C	D	E
20"	40"	17"	37"	1.5"
24"	32"	21"	29"	1.5"
24"	36"	21"	33"	1.5"
24"	40"	21"	37"	1.5"
27"	40"	24"	37"	1.5"
30"	30"	27"	27"	1.5"
30"	36"	27"	33"	1.5"
30"	40"	27"	37"	1.5"
30"	48"	27"	45"	1.5"
36"	36"	33"	33"	1.5"

Accessory include
4pcs Anchors
4pcs Screws
1pc Mounting Template

Distance A is the mirror width
Distance B is the mirror height
Distance C is screws holes length for vertical mounting.
Distance D is screws holes length for horizontal mounting.

1

Select a disired position to mount the mirror.
Put the mounting template paper on wall.

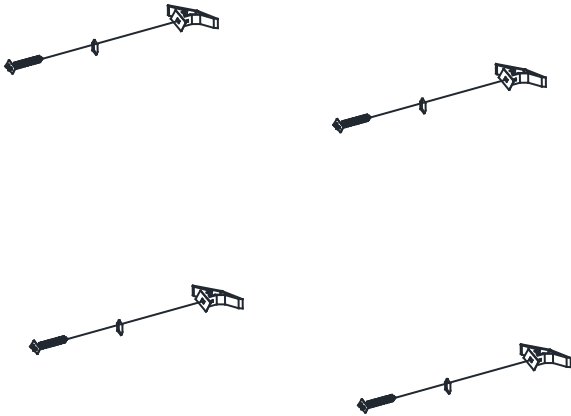
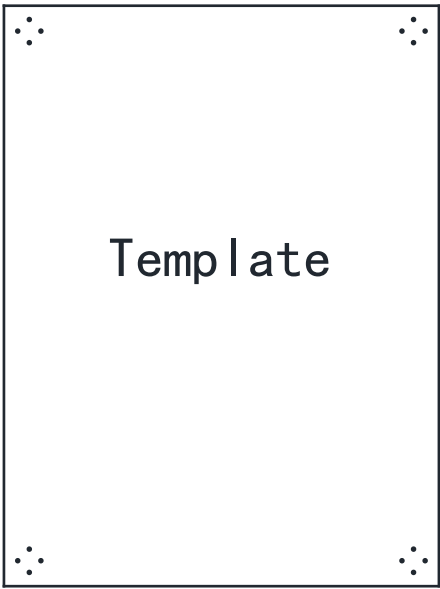

2

Drill holes, insert wall anchors into the holes,
then insert screws into anchors.

3

Hang mirror onto screws.

