

HISENSE REFRIGERATOR



HRB171N6ASE

Counter Depth Bottom-Freezer Refrigerator

KEY FEATURES

- Counter Depth Design
- Full-Width Crisper Drawer
- Bright LED Lighting
- ENERGY STAR® Certified
- Metal Slide Drawers
- Gallon Door Storage

AVAILABLE COLORS



White



Black



Fingerprint-Resistant Stainless Steel



TECHNICAL SPECIFICATIONS

PERFORMANCE		REFRIGERATOR		INSTALLATION DIMENSION	
Refrigerator (cu. ft.)	12.1	Product Type	Bottom Mount	Product (W x H x D)	31.1*69.1*26.6"
Freezer (cu. ft.)	5.1	Temperature Range (°F)	34°F~44°F	Width (Excluding Door)	31.1"
Total Capacity (cu. ft.)	17.2	Door Type	Side Swing	Width (Including Door)	31.1"
ENERGY STAR® Certified	Yes	No. of Shelves	3 Adjustable Glass	Common Width	33.0"
Energy Consumption (kWh/Year)	453	Shelf Construction	Tempered Glass	Width (Door Open 90° Excluding Handle)	32.1"
Safety Listing	UL Safety Listing	Shelf Trim	Chrome Décor	Width (Door Open 90° Including Handle)	34.6"
ICE & WATER SYSTEM		No. of Crisper Drawers	1 Full-Width	Width (Door Fully Open Excluding Handle)	52.0"
Ice and Water Dispenser Type	None	LED Lighting	Yes (Ceiling LED)	Depth (Excluding Handles)	26.6"
Ice Maker	None	No. of Door Bins	5 (1 Gallon, 4 Half)	Depth (Including Handles)	29.1"
COOLING SYSTEM		Door Bin Construction	1 Piece (Clear)	Depth (Less Door)	23.6"
Temperature Sensors	2	FREEZER		Depth (to Hinge Cover)	21.7"
Compressor Type	Fixed-Frequency	Temperature Range (°F)	-11°F~7°F	Depth (Door Open 90°)	56.3"
Refrigerant (Type and Volume)	R600a/1.76oz(50g)	Door Type	Pull-Out Drawer	Depth Type	Counter Depth
Multi Air Flow Cooling	Yes	Drawers	2-Tier Organization	Height (to Top of Hinge)	69.1"
Evaporator	1	Drawer Divider	None	Height (to Top of Door)	69.1"
CONVENIENCE		LED Lighting	None	Height (to Top of Case)	68.5"
Display Type	Internal/ Smooth Touch / Blue LED	MATERIALS AND FINISHES		Installation Clearance	Sides 1", Top 1", Back 2"
Temperature Controls	Electronic/ Digital	Fingerprint-Resistant Door	Yes	Carton (W x H x D)	33.0*71.6*28.6"
Door Alarm	Yes	Door Style	Flat	Weight (Unit/ Carton)	192lbs./ 211lbs.
Auto Closing Door Hinge	Yes	Door Texture	Smooth	INSTLIMITED WARRANTY	
Leveling Legs	Yes	Handle Type	Grip	Warranty	2-year limited
Demo Mode	Yes	Hidden Hinges	Yes	Parts & Labor	2 Years
Gallon Door Storage	Yes	Toe Grille	No	Sealed System (Parts & Labor)	5 Years
Noise Level (dB)	41	Reversible Door	Yes	Accessories	90 Days for Parts
		Cabinet Color	Grey	UPC CODES	
		Inner Liner Color	White	HRB171N6ASE (Fingerprint-Resistant Stainless Steel)	819130028958
				HRB171N6AWE (White)	819130028965
				HRB171N6ABE (Black)	819130028972

HISENSE REFRIGERATOR

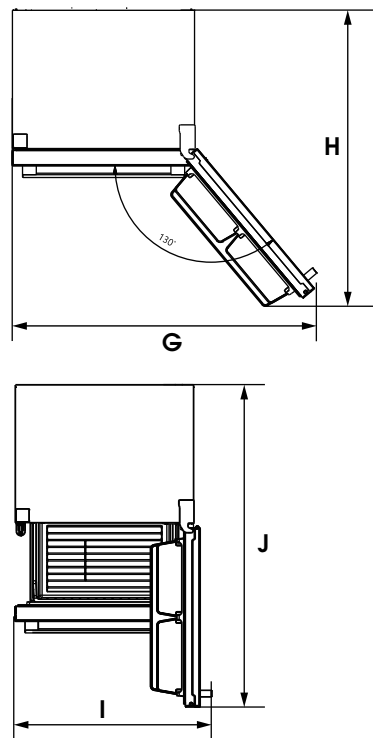
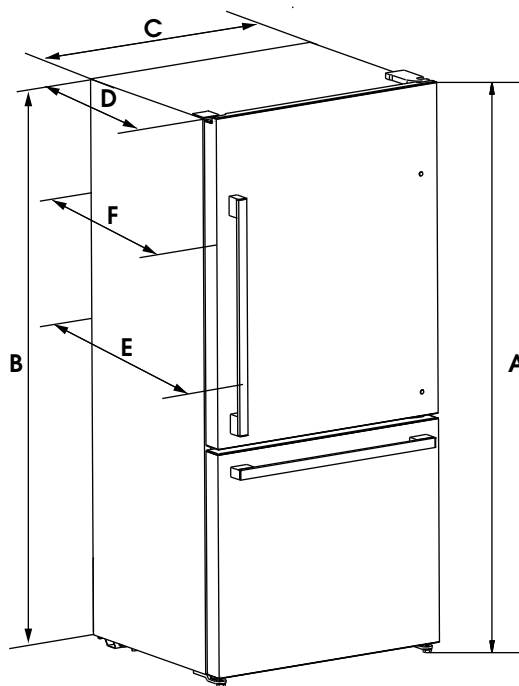

Model	Capacity	Height-Overall "A"	Height-Top of Cabinet "B"	Width-Cabinet "C"	Depth-with Cabinet "D"	Depth-with Door "E"	Depth-with Handle "F"	Width-Doors Open 130° "G"	Depth-Doors Open 130° "H"	Width-Doors Open 90° "I"	Depth-Doors Open 90° "J"
HRB17IN6ASE	17.2 cu.ft	69.1" (1756mm)	68.5" (1740mm)	31.1" (790mm)	23.6" (600mm)	26.6" (675.5mm)	29.1" (740mm)	52" (1321mm)	50.6" (1286mm)	34.6" (879mm)	56.3" (1430mm)
HRB17IN6AWE	17.2 cu.ft	69.1" (1756mm)	68.5" (1740mm)	31.1" (790mm)	23.6" (600mm)	26.6" (675.5mm)	29.1" (740mm)	52" (1321mm)	50.6" (1286mm)	34.6" (879mm)	56.3" (1430mm)
HRB17IN6ABE	17.2 cu.ft	69.1" (1756mm)	68.5" (1740mm)	31.1" (790mm)	23.6" (600mm)	26.6" (675.5mm)	29.1" (740mm)	52" (1321mm)	50.6" (1286mm)	34.6" (879mm)	56.3" (1430mm)
HRB17IN6BSE	17.2 cu.ft	69.1" (1756mm)	68.5" (1740mm)	31.1" (790mm)	23.6" (600mm)	26.6" (675.5mm)	29.1" (740mm)	52" (1321mm)	50.6" (1286mm)	34.6" (879mm)	56.3" (1430mm)

LOCATION REQUIREMENTS

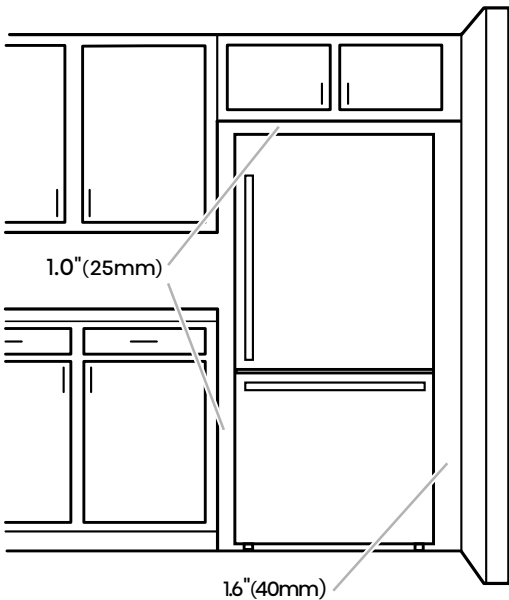

To ensure proper ventilation for your refrigerator, allow for a 1.0" (25mm) space on each side and at the top.
Allow at least 2.0" (51mm) between back of cabinet and the wall.
If your refrigerator has an ice maker, allow extra space at the back for the water line connections.

If you are installing your refrigerator next to a fixed wall, leave 1.6" (40mm) minimum on the hinge side (some models require more) to allow for the door to swing open.

NOTE: This refrigerator is intended for use in a location where the temperature ranges from a minimum of 55F(13°C) to a maximum of 110°F(43°C).