

# Instruction Manual

## Tower Fan

---

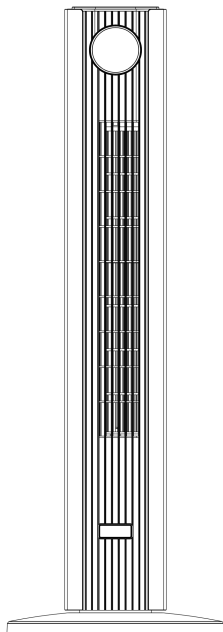

MODEL NO: NDTFT23R

---

Thank you for purchasing this product! Please read this manual carefully before operating this product. If you have any questions about the product, such as missing parts, product damage, product assembly and operation, please contact us via customer service phone:

213-446-7172.



# Part 1 - IMPORTANT SAFEGUARDS

When using an electrical appliance, basic safety precautions should always be obeyed, including the following:

## **READ ALL INSTRUCTIONS BEFORE USING**

**WARNING: To reduce the risk of fire, electric shock, or personal injuries:**

1. This fan is for household use only.
2. Before first use, check whether your voltage corresponds to the product nameplate requirements.
3. For safety reasons, please check the status of the power cord and plug before use.
4. When not in use, be sure to turn off the fan and unplug it from the power socket.
5. Be careful when using this equipment near children.
6. Do not run the power cord under carpeting and do not cover the cord with throw rugs, runners or similar coverings. Do not route cord under furniture or appliances. Arrange cord away from traffic areas so that it will not be tripped over.
7. Do not operate any fan with a damaged cord or plug. Discard fan or return to an authorized service facility for examination and/or repair.
8. If the fan's power supply cord is damaged, it must be replaced by the manufacturer or its service agent to avoid potential safety hazards.
9. Use the fan in well-ventilated areas. Place the fan at least 8 inches from any walls to ensure the proper airflow during use. The fan cannot be located directly under or close to the curtain.
10. Do not obstruct the airflow with any objects or place anything in the opening of the fan.
11. Do not use the fan in areas where curtains may be sucked in.
12. Only place the fan on a hard, flat, dry floor.
13. Do not use the product in extreme temperatures, humidity, or dusty environments.
14. Do not put heavy objects on the fan.

15. Do not place the fan below the power outlet that will suck the cord inside to cause damage.
16. When the fan is oscillating, do not touch the fan manually to avoid damage.
17. Be sure to turn off the power supply before unplugging the power cord from the power outlet to avoid a short circuit, fire, or electric shock.
18. Do not twist or pull the power cord out.
19. In order to avoid the danger of electric shock, do not unplug the fan when your hands are wet.
20. Children under 8 years old should not operate the fan.
21. This appliance is not suitable for people (including children) with reduced physical/sensory/mental abilities or people who lack experience and knowledge. Unless the above-mentioned people are supervised or instructed by a person who is responsible for their safety.
22. Children should be supervised to ensure that they do not play with the appliance.
23. Ensure that the fan is switched off and unplugged from the power supply before removing the guard.
24. **WARNING:** To reduce the risk of fire or electric shock, do not use this fan with any solid-state speed control device.
25. Please unplug or disconnect the appliance from the power supply before the repair work is carried out.
26. This product employs overload protection (fuse). A blown fuse indicates an overload or short-circuit situation. If the fuse blows, unplug the product from the outlet. Replace the fuse as per the user servicing instructions (follow product marking for proper fuse rating) and check the product. If the replacement fuse blows, a short-circuit may be present and the product should be discarded or returned to an authorized service facility for examination and/or repair.

**Warning:**

This appliance has a polarized plug (one blade is wider than the other). To reduce the risk of electric shock, this plug is intended to fit in a polarized outlet only one way. If the plug does not fit fully in the

outlet, reverse the plug. If it still does not fit, contact a qualified electrician. Do not attempt to defeat this safety feature.

## To Change the fuse

**The following should ONLY be conducted by qualified professionals:**

1. Grasp the plug and remove it from the electric receptacle. Do not unplug by pulling on the cord.
2. As shown in the figure below, slide the fuse access cover on the top of the plug towards the blades and open the fuse cover.
3. Remove the fuse carefully. Push the fuse from the other side or turn the fuse holder upside down to remove the fuse.

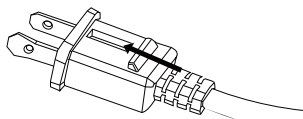

4. Fire risk. Replace the fuse only with a 5 Amp 125 Volt fuse.
5. Close the fuse cover by sliding the fuse access cover on the top of the plug away from the blades.
6. Fire risk. Do not replace the polarized plug as it has a safety device that should not be removed.

Discard the product if its polarized plug is damaged.

# **WARNING**

- **INGESTION HAZARD:** This product contains a button cell or coin battery.
- **DEATH** or serious injury can occur if ingested.
- A swallowed button cell or coin battery can cause **Internal Chemical Burns** in as little as **2 hours**.
- **KEEP** new and used batteries **OUT OF REACH** of **CHILDREN**
- **Seek immediate medical attention** if a battery is suspected to be swallowed or inserted inside any part of the body.



- a) Remove and immediately recycle or dispose of used batteries according to local regulations and keep them away from children. **DO NOT** dispose of batteries in household trash or incinerate.
- b) Even used batteries may cause severe injury or death.
- c) Call a local poison control center for treatment information.
- d) Compatible battery type: CR2025.
- e) Battery nominal voltage: 3.0 Vdc.
- f) Non-rechargeable batteries are not to be recharged.
- g) Do not force discharge, recharge, disassemble, heat above (rated temperature: 140 °F ), or incinerate. Doing so may result in injury due to venting, leakage, or explosion resulting in chemical burns.
- h) Ensure the batteries are installed correctly according to polarity + and -.
- i) Do not mix old and new batteries, different brands, or types of batteries, such as alkaline, carbon-zinc, or rechargeable batteries.
- j) Remove and immediately recycle or dispose of batteries from equipment not used in an extended period according to local regulations.
- k) Always completely secure the battery compartment. If the battery compartment does not close securely, stop using the product, remove the batteries, and keep them away from children.

**SAVE THESE INSTRUCTION**

## Part 2 - BRIEF INTRODUCTION

This tower fan is equipped with multiple functions, such as 3 speeds, 4 modes, 85 degrees oscillation, 12 hours timer, remote control. With the above functions, the tower fan can provide a cool, healthy, and luxurious lifestyle.

## Part 3 - PECIFICATION

MODEL NO.	RATED	POWER
NDTFT23R	120V, 60Hz	50W

## Part 4 - STRUCTURE AND PARTS

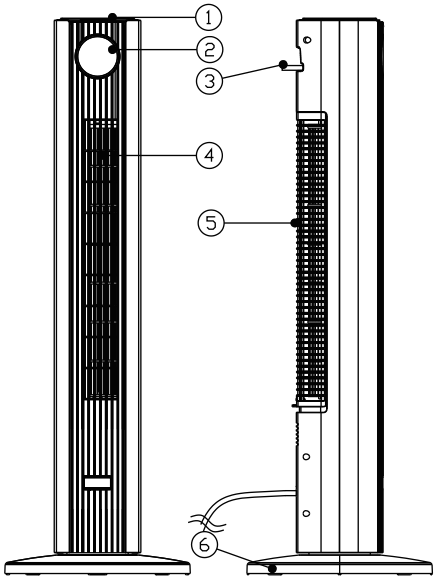

Parts list	
Description	Quantity
Remote control	1
Instruction Manual	1
Base	2

1. Head
2. Display
3. Remote control
4. Air outlet
5. Air inlet
6. Base

## Part 5 - INSTALLATION

1. Take out the two bases from the package. Connect them together as shown below.

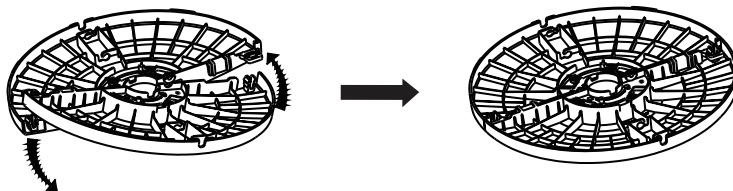

2. Fit the base onto the bottom of the fan, then rotate the base anticlockwise to lock in place. (As shown below)

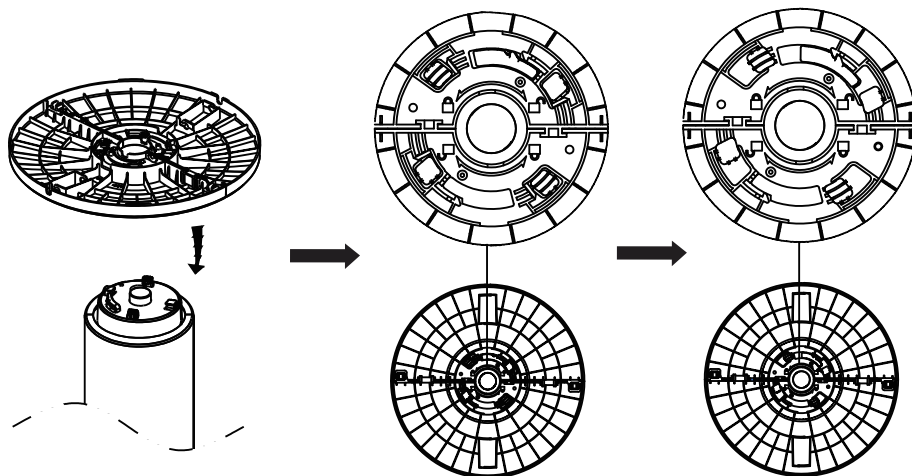



## Part 6 - FUNCTION

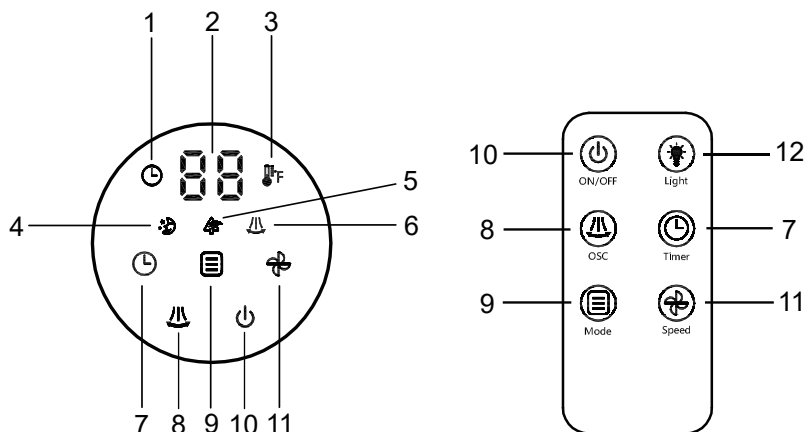

1. Timer indicator	2. Display ambient temp. / timer hours / fan speed / auto mode
3. Temperature indicator	4. Sleep mode indicator
5. Natural mode indicator	6. Oscillation indicator
7. Timer button	8. Oscillation button
9. Mode button	10. Power button
11. Fan speed button	12. Light button

### 1. ON/OFF

Press power button to turn the fan on/off.

### 2. Mode

The fan has four modes: Normal / Sleep / Natural / Auto.

#### Normal mode:

When you turn on the fan, the default mode is Normal wind mode. Press the mode button to change the mode.

#### Sleep mode:

The Sleep light indicator will display when this mode is selected. The buzzer will be turned off immediately. 5 seconds after the cessation of the manual operation, the light will dim and then go out except the light of button. If you want to change the wind speed, just press the fan speed button to choose the wind speed ranging from 1-3. In this mode, the wind speed will be reduced by one level every half an hour, and will remain at level 1 until it is turned off.

### **Natural mode:**

The Natural light indicator  will display when this mode is selected. The fan will run cyclically as shown below:

- Natural mode of level 3 wind speed: 5s level 3 speed normal wind – 10s level 2 speed normal wind – 15s level 1 speed normal wind – 10s level 2 speed normal wind – cycle
- Natural mode of level 2 wind speed: 10s level 2 speed normal wind – 15s level 1 speed normal wind – cycle
- Natural mode of level 1 wind speed: 5s level 2 speed normal wind – 10s level 1 speed normal wind – stop 5s – 10s level 1 speed normal wind – cycle

### **Auto mode:**

In this mode, the tower fan will run in level 1 speed normal wind when the temperature  $\leq 72^{\circ}\text{F}$ . The tower fan will run in level 2 speed normal wind when the temperature is between  $73^{\circ}\text{F}$  and  $82^{\circ}\text{F}$ . The tower fan will run in level 3 speed normal wind when the temperature  $\geq 83^{\circ}\text{F}$ .

## **3. Oscillation**

Press the oscillation button , the fan will oscillate from the left to the right automatically.

## **4. Timer**

Press the timer button  and then keep pressing to choose the duration of time. The timer is 12 hours. To cancel the setting, press the button to set it as 00 Hr.

## **5. Wind Speed**

Press the fan speed button  to choose the wind speed ranging from 1-3.

## **6. Light**

When the light is on, you can press the light button  on the remote control to turn off the light on the screen. If you want to turn on the light on the screen, press any button except the power button.

## Part 7 - MAINTENANCE AND STORAGE

1. Always remove the plug from the socket-outlet and allow the fan to stop before cleaning it.
2. Clean the external surfaces of the fan with a soft damp cloth (not dripping wet cloth).

### **WARNING:**

**Do not immerse the fan into the water.**

**Do not use any cleaning chemicals such as detergent or abrasive. Do not allow the interior to get wet as this could cause dangerous consequences.**

3. When the unit is not in use, make sure that it is unplugged from the wall socket. To store the fan, you may pack it in the original carton and store it in a cool and dry place.
4. In case of malfunction or doubt, do not try to repair the fan by yourself; otherwise it may result in a fire hazard or electric shock.

Thank you for purchasing this product! If you have any questions about the product, such as missing parts, product damage, product assembly and operation, please contact us via customer service phone: **213-446-7172**.

**IMPORTANT**

Please call our customer service department for any consulting:

**213-4467172**

(8:30am - 5:30pm P.S.T.)

DATED PROOF OF PURCHASE IS REQUIRED FOR WARRANTY  
SERVICE.

**AVIS**

Veuillez appeler le service à la clientèle pour toutes questions au:

**213-4467172**

(8:30am - 5:30pm P.S.T.)

PREUVE D'ACHAT ORIGINALE REQUISE POUR SERVICE DE  
GARANTIE.

**IMPORTANTE**

Sólo hay que llamar nuestro departamento de servicio  
al cliente en caso de tener preguntas o inquietudes:

**213-4467172**

(8:30am - 5:30pm P.S.T.)

SE REQUIERE PRUEBA DE COMPRA CON FECHA PARA  
SERVICIO BAJO GARANTÍA.

**ROWAN ELECTRIC APPLIANCE LLC**

**Phone: 213-4467172**