

This exploded view diagram illustrates the components of the bed assembly. At the top is the headboard, which is a rectangular panel with a vertical support on the left. Below it is the footboard, a similar rectangular panel. To the left of the footboard is the side rail assembly, which includes a vertical support and a horizontal rail. To the right of the footboard is the side rail assembly, which includes a vertical support and a horizontal rail. Below the side rail assembly is the slat assembly, which consists of a vertical support and a horizontal slat. The diagram shows how these components are assembled together to form the bed frame.

This listing period is based upon the last date of the month indicated on the Effective Date and Void After Date shown above. Any change in material, manufacturing process, marking or design without having first obtained the approval of the Product Certification Committee, or any evidence of non-compliance with applicable codes and standards or of inferior workmanship, may be deemed sufficient cause for revocation of this listing. Production of or reference to this form for advertising purposes may be made only by specific written permission of IAPSD Research and Testing, Inc. Absorption of this certificate shall be automatic for suspension of its listing. This document shall be surrendered to its holder.

NO.	Item	Qty
1	Mixer Body	1
2	Plate	2
3	Hand Held Shower	1
4	Shower Hose	1
5	Shower Seat	1
6	Diverter Cap	1
7	Grub Screw	2
8	Screw Cap	2
9	Switch Handle	1
10	Waterfall Preburied Box	1
11	Water Inlet	3
12	Waterfall Top Shower	1
13	Nozzle	4
14	Accessory bag	1
15	Accessories	1

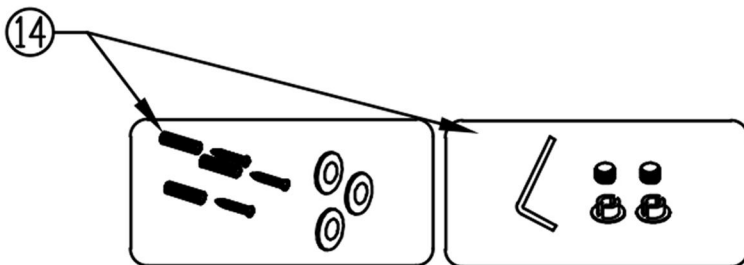
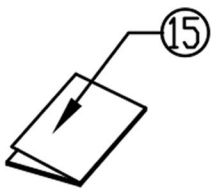
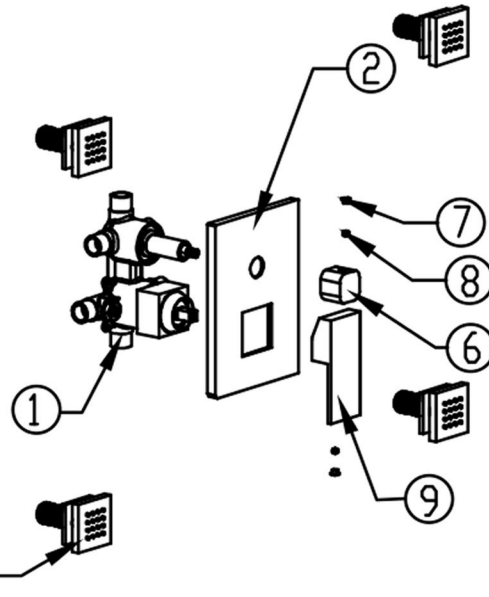
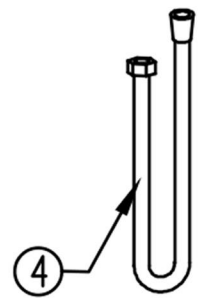
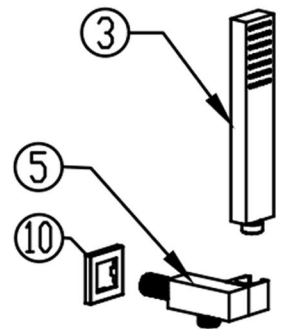
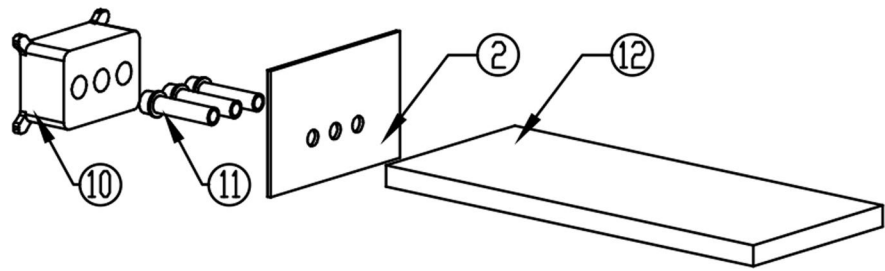

Check accessories

Standard List of Accessories:

When you open the product packaing, please check whether the objects in it are consistent with the main body and accessories you purchased. If there is any inconsistency, please contact our company or our distributor.

Note: 1.Accessories are subject to change without prior notice if the change does not affect usage;

2.The appearance of the product is subject to the physical objects you receive, and the schematic diagram is only for reference.

This product has been inspected and debugged by the factory to the best condition. Please do not disassemble and assemble it yourself.



Before installing the faucet, please be sure to remove sundries and sludge from the water pipe to prevent sundries from blocking the faucet.

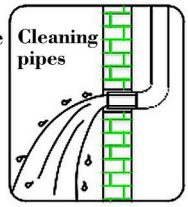

1.1 Open [(6.49"-6.69") x (4.53"-4.72") x (2.56"min) inch (L×W×D)], Bury water mains as required; Fix the embedded box in the embedded hole (keep it horizontal and vertical) and connect the pipe.

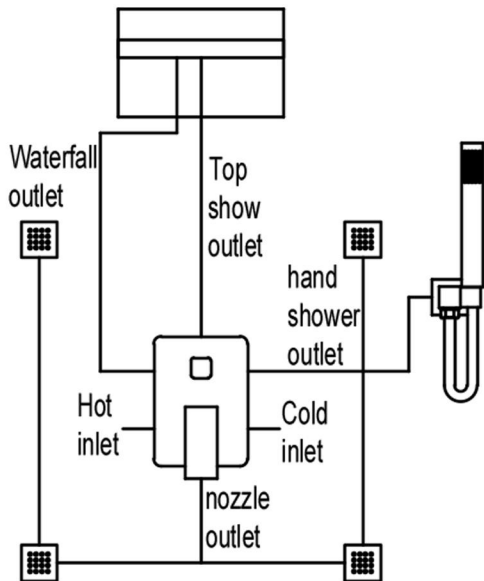

1.2 Open [open size (5.12"-5.31") x (6.49"-6.69") x (2.24"min) inch (L×W×D)], entombed pipe as required; Fix the balance valve body in the embedded hole (keep it horizontal and vertical) and connect the pipe.

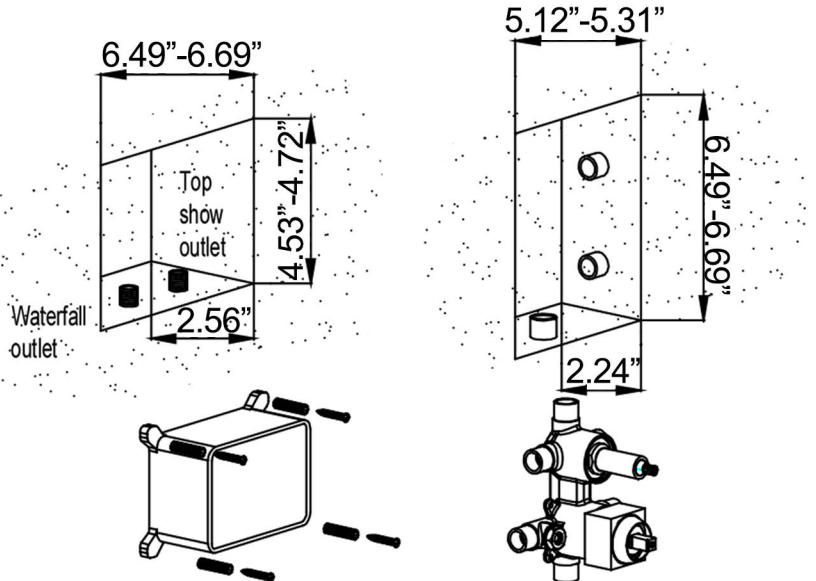

2. Fill in the embedded hole after no water leaks. Screw the water intake on the embedded box after removing the shield and press the panel to the wall. Install the waterfall top spray on the inlet part and lock with a hex key.

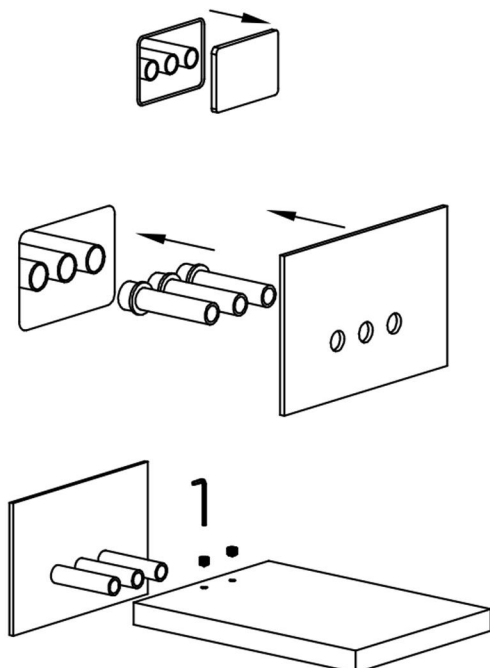

3. After no water leaks fill in the embedded holes and press the panel to the wall. Use the hex spoon to mount the switch handle and the water release handle, and mount the color on.

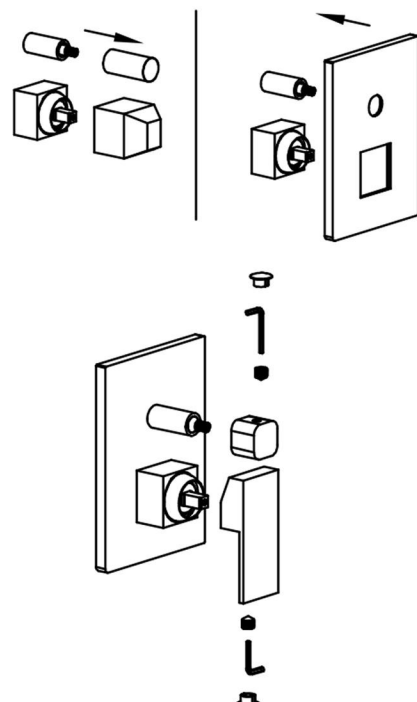

4. Insert the decorative seat cover into the shower seat and screw into the mounting hole of the main body (pay attention to keeping level); Use a hose to screw the showerhead seat and handheld together.

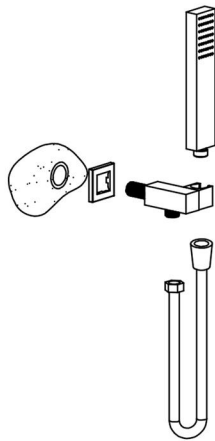

5. Screw the nozzle to the mounting hole in the wall (keep it level) to the wall.

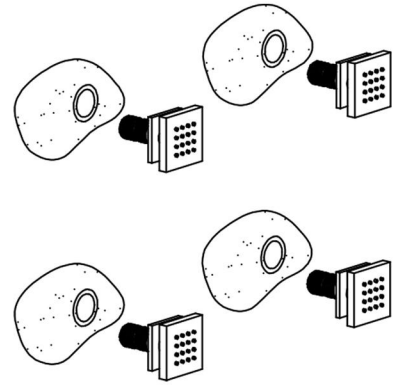

INSTALLATION DIMENSION

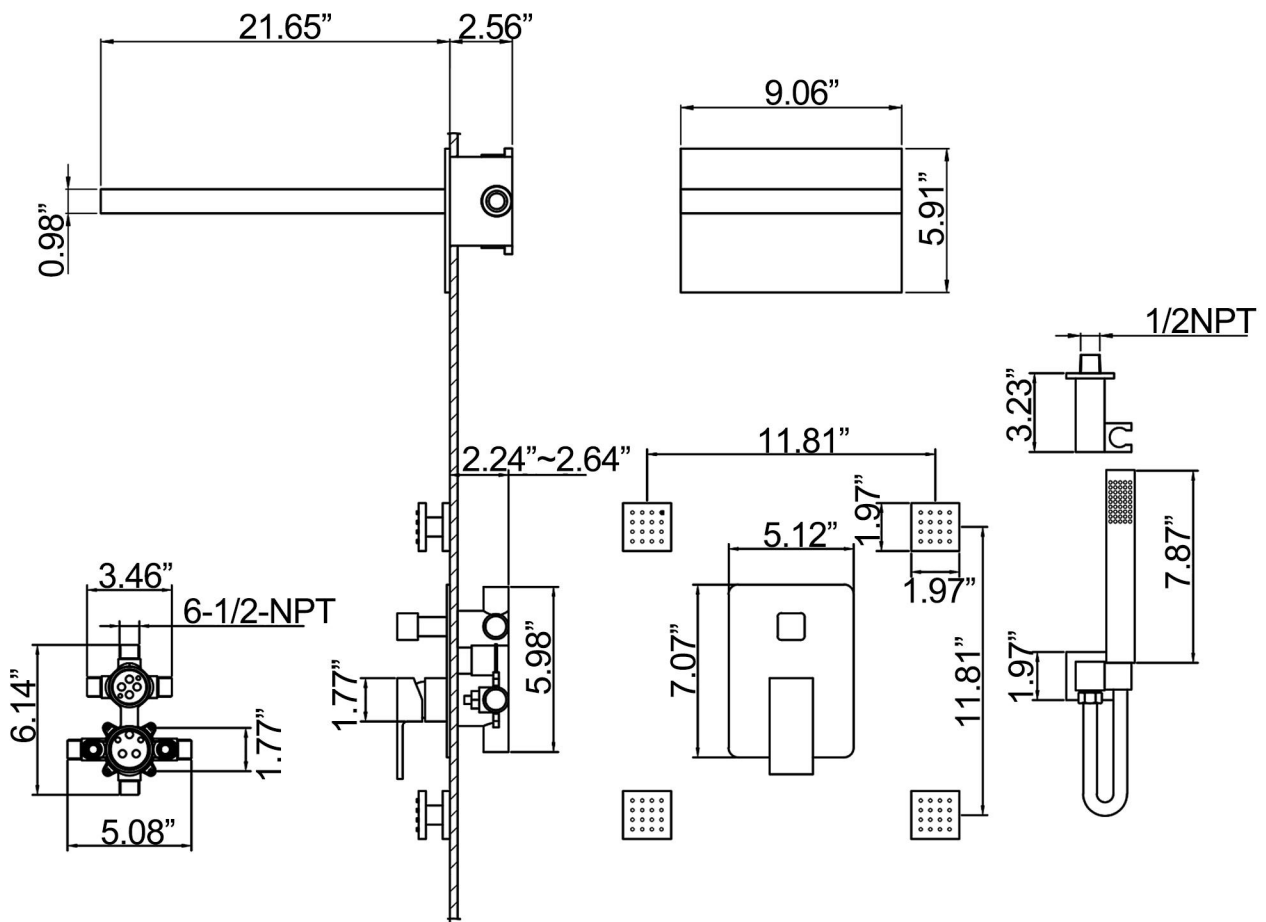

CLEANING CARE

In order to keep the appearance of faucet clean, bright and good performance, please take care of the faucet as follows;

1. Rinse with water only and dry with soft cotton cloth;
2. Use mild liquid and colorless glass cleaner to remove surface dirt and scale film, or use polish without abrasive effect;
3. Do not use abrasive detergent, polish, emery cloth, paper towel or scraper, etc.;
4. Do not use acid cleaner, or cleaner and soap with insoluble gran etc.;
5. In the process of use, mud may accumulate in the bubbler and make the water flow slow, The bubbler can be unscrewed, rinsed with water, and then installed back in place.

