

Smart WiFi Plug Kit

PK4 User Manual

Read before installing or using this product. Keep this guide for future reference.
Visit Contixo.com for literature updates!

Download and Install the Xodo Smart APP

Download and install the APP. It can be also be found by searching "Xodo Smart" by Contixo Inc. in the App Store (for IOS) or Google Play Store (for Android).



Xodo Smart

Connect

The welcome screen will appear and then you will be asked to login or register a profile. Register an account by entering your email address and setting up a profile or logging in with an existing account.

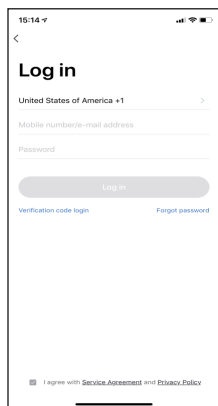
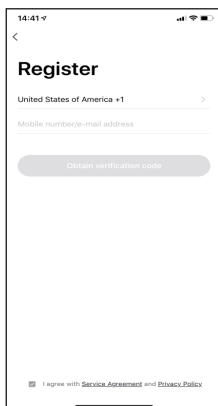

Adding Devices

You will be able to manually add a device. Select Plug(WP1)/Socket(WP3) to continue.

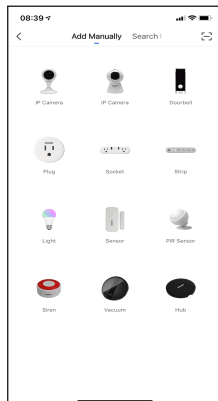
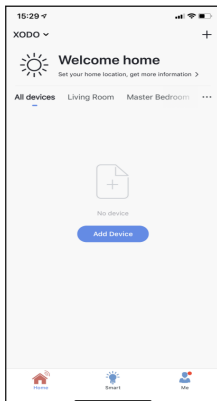

Detecting Device

When detecting devices manually, power on the device and confirm the indicator light is blinking rapidly (Hold the reset button for 5 seconds). Once you confirm the smart device is ready, press the “Confirm indicator rapidly blink” button. Continue on to the next step. Pressing the “Help” button will offer some troubleshooting guidelines to follow.

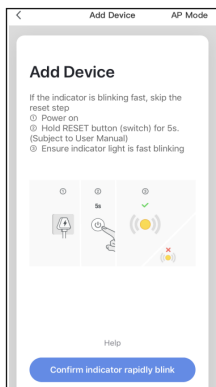

WP1

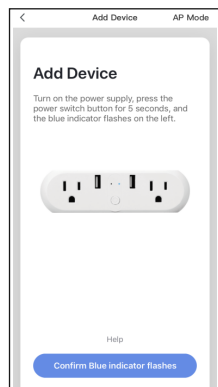

WP3

Connect to a WiFi network

The next step to connect the smart device is to connect to a WiFi network. If the proper network is not listed on this page, select the “Change Network” link to see a list of available networks. Enter the password next to the lock icon. Press “Confirm” to continue.

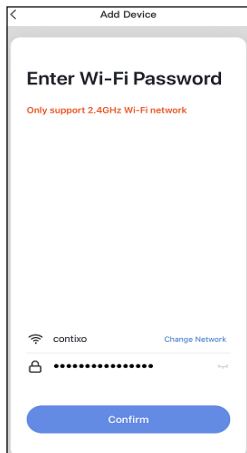

Connecting

The “Connecting” screen will appear. It will usually register within by approximately 30% range. The Device found will checkmark green, then Initializing device will complete. After connecting process completes it will continue on toward the next screen.

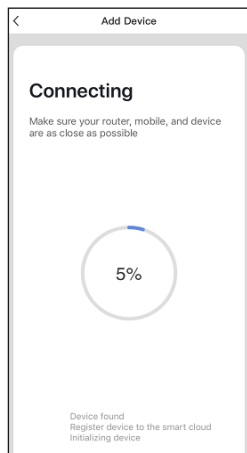

Confirmation Screen

The smart device is added once they are communicating on the same network. You can rename the smart device by clicking on the pencil icon. You can specify the location. Press the Completed button at the bottom of screen to continue to next step.

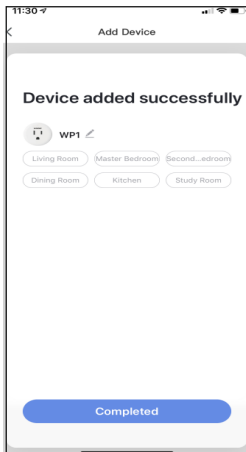

WP1

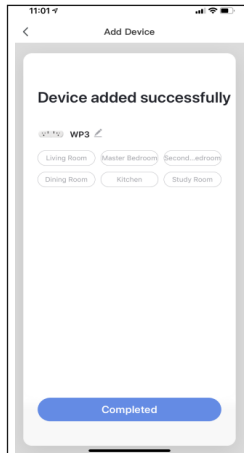

WP3

Home Screen Updated (WP3)

Now that your device has been added, it will show on the home screen along with all other paired Xodo Smart Products. Now you are all set.

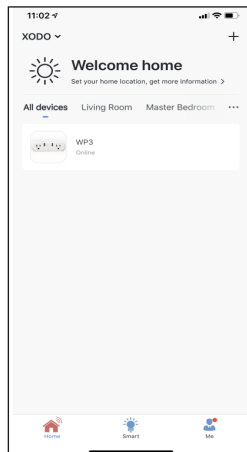

Smart Socket Home Screen (WP3)

The home screen will show the live plug status.

1. Press the "All open"/"All close" button to turn off/on the smart plug.
2. Press the big round power button to turn off/on the Switch 1 or Switch 2 separately.
3. Press the "Timer" button to set a schedule.

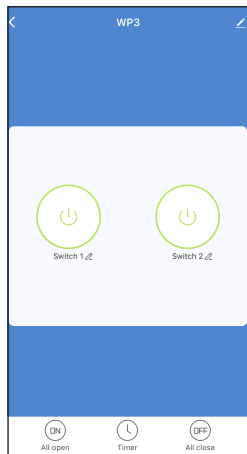

Timer function (WP3)

This will keep the sock in ON position for a specific duration of time.

1. Click on "Alarm".
2. Select the switch that needs to be set.
3. Click "Add Schedule".
4. First configure the hours (left)
5. Next configure minutes (middle)
6. Select AM or PM on the right.
7. Click "Repeat" and choose the day of the week.
8. Click "Save" to save the settings.

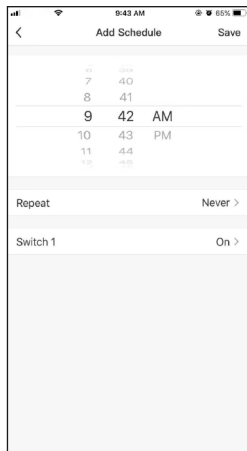

Configure the Smart Socket Settings (WP3)

Different features can be adjusted from the menu button on the upper right hand button “” on the APP.

1. Device Name can be changed as desired.
2. Device Location can set the location of the smart socket in your home.
3. Check Device Network allows to check the network connection status.
4. Add Members to be able to control the device in the Share Device setting.
5. Create Group to control other smart device at the same time.
6. Device Information provide network configuration information.
7. Add to Home Screen allows to add the socket to the home screen of your smartphone.
8. Firmware Information allows to check software or install updates to device.
9. Remove device will remove the smart socket from the Xodo Smart app and remove pairing. This is necessary if pairing with a new device.
10. Restore Factory Setting allows to reset the Surge Protector to factory setting.

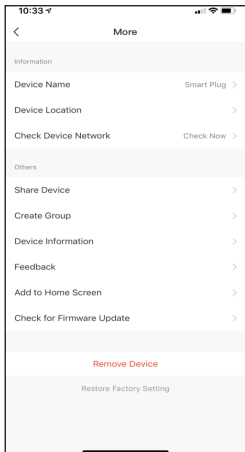

Home Screen Updated (WP1)

Now that your device has been added, it will show on the home screen along with all other paired Xodo Smart Products. Now you are all set.

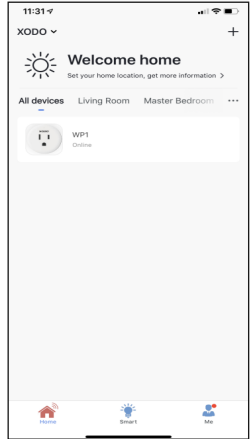

Smart Plug Home Screen (WP1)

The home screen will show the live plug status.

1. Press the “OFF”/”ON” button to turn off/on the smart plug.
2. Press the “Countdown” button to set countdown on or off.

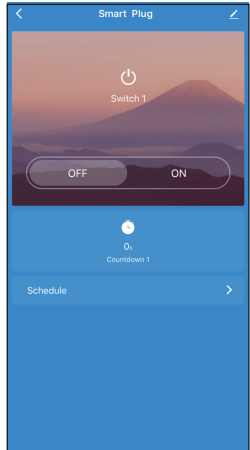

Countdown function (WP1)

This will keep the sock in ON position for a specific duration of time.

1. Click "Countdown".
2. Select the switch that needs to be set.
3. First configure the hours (left)
4. Next configure minutes (right)
5. Click "OK" to save the settings.

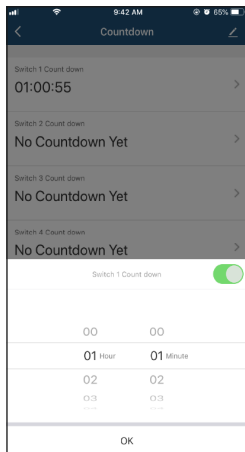

Timer function (WP1)

This will keep the sock in ON position for a specific duration of time.

1. Click on "Alarm".
2. Select the switch that needs to be set.
3. Click "Add Schedule".
4. First configure the hours (left)
5. Next configure minutes (middle)
6. Select AM or PM on the right.
7. Click "Repeat" and choose the day of the week.
8. Click "Save" to save the settings.

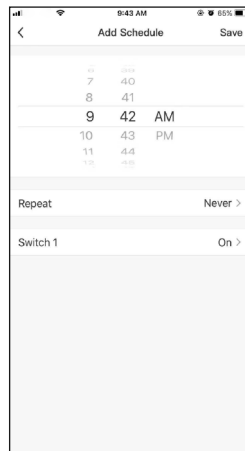

Configure the Smart Plug Settings (WP1)

Different features can be adjusted from the menu button on the upper right hand button “” on the APP.

1. Device Name can be changed as desired.
2. Device Location can set the location of the plug in your home.
3. supported Third-Party Control provide the information about how to connect your device to Amazon Alexa and Google Assistant.
4. Add Members to be able to control the device in the Share Device setting.
5. Create Group to control other smart device at the same time.
6. Device Information provide network configuration information.
7. Add to Home Screen allows to add the plug to the home screen of your smartphone.
8. Firmware Information allows to check software or install updates to device.
9. Remove device will remove the smart plug from the Xodo Smart app and remove pairing. This is necessary if pairing with a new device.
10. Restore Factory Setting allows to reset the Surge Protector to factory setting.

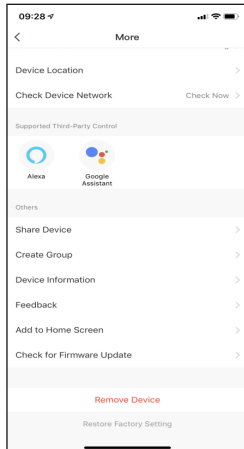

My Home Page

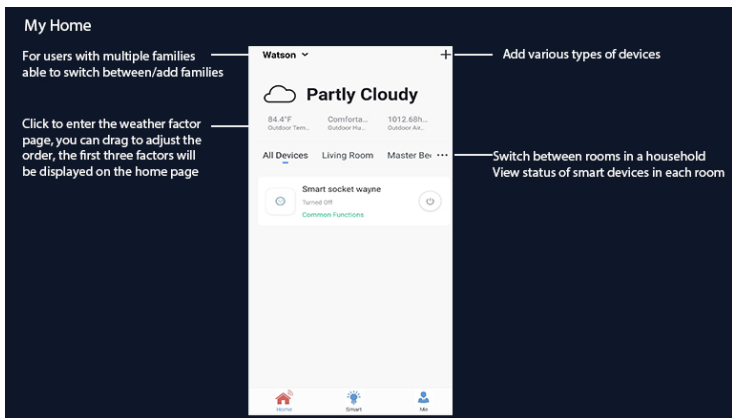

Device Controls

1. Some devices can set group control. Click " in the upper right corner
2. Click "Create Group".
3. The page displays all devices with the same model number and available to be added as a group. Select the device and click "Confirm".

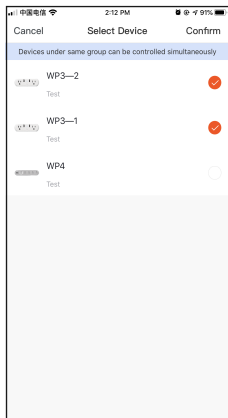
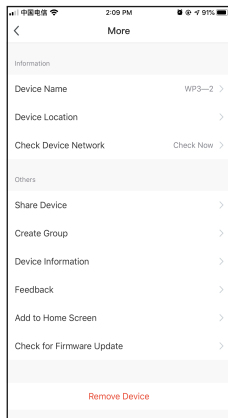
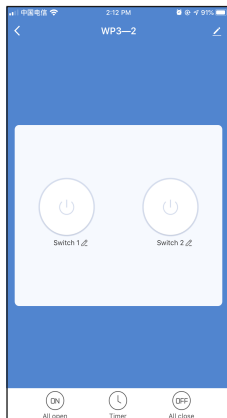

4. Enter group name and click "Save" to finish.

5. When a group has been created successfully, the page will be automatically redirected to the group control panel, where grouped devices can be managed.

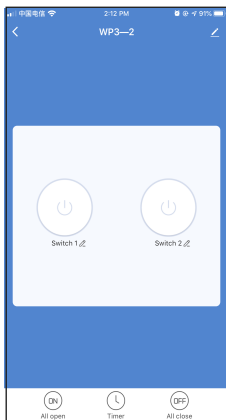
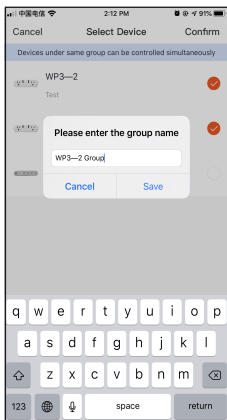

Smart Features

1 Click "Automation" on the "Smart" page.

2 Click "Add Automation" or "+" to go to the smart configuration page.

3 Click "Add conditions" or "+" to select trigger condition.

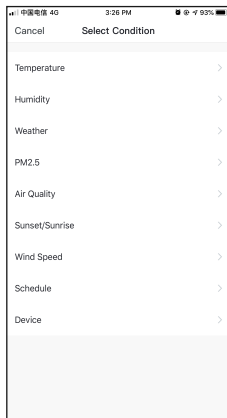
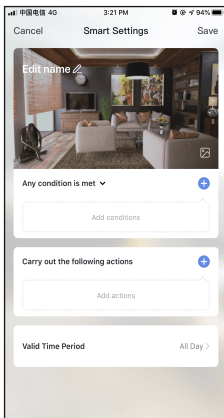
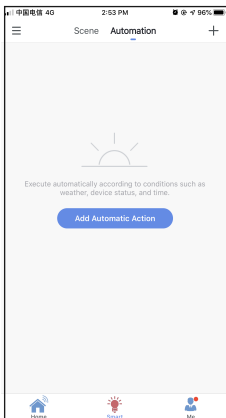

4 Click “Add actions” or “+” to select the action to occur.

5 Click “Valid Time Period” to set a valid time period for automation.

6 Click “Next” to go to the smart configuration page.

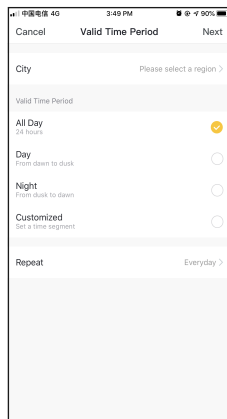
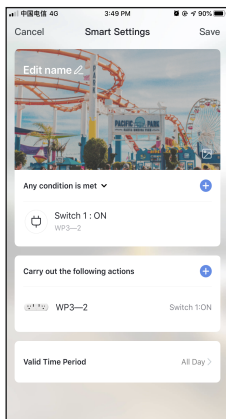
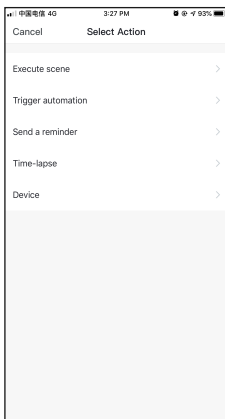

7, Enter the automation name click “Confirm” to finish.

8. Click the switch in the lower left corner to select to execute or turn off the automation.

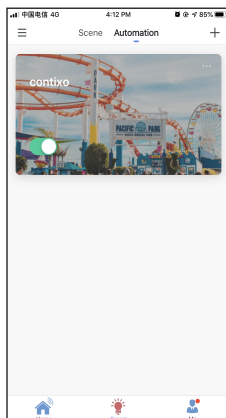
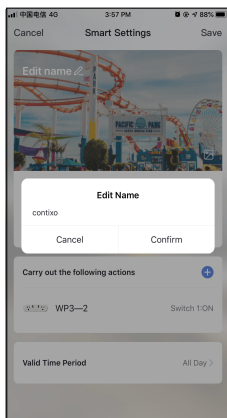

Smart Features - Scene

To configure a scene with "Trigger automation", you must set up an automated scene in advance.

- 1 Click "Scene" on the "Smart" page.
- 2 Click "Add Scenario" or "+" to go to the smart settings page.
- 3 Click "Add action" or "+" to add set automation or equipment.

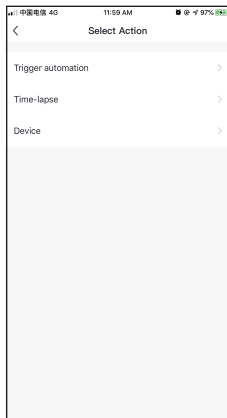
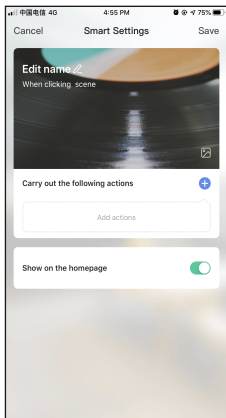
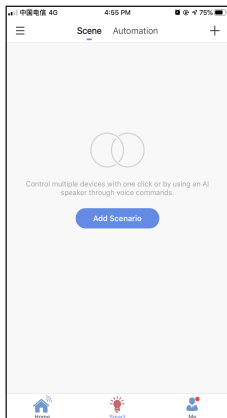

- 4 Click "Save".

- 5 Enter the automation name click "Confirm" to finish.

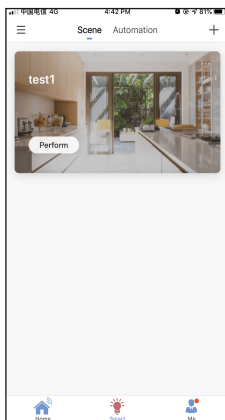
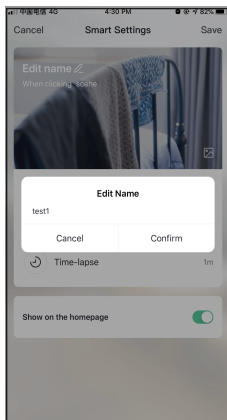

Link Xodo Smart account to Google Home Screen

1. Open Google Play Store or Apple Store and download Google Home
2. Open the Google Home app. Click on Get Started.
3. Login with a Google Account or create a new account.

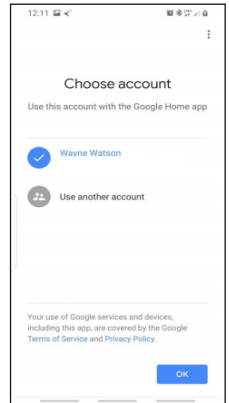
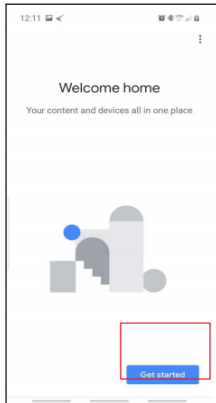
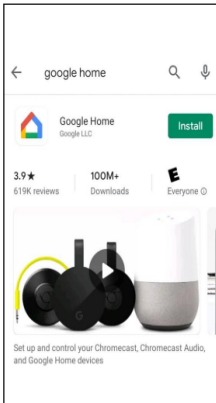

4. Use Location access to find devices on the same wifi network.
5. You will need to permission so Google Home can access device.
6. The app will search for devices to connect.

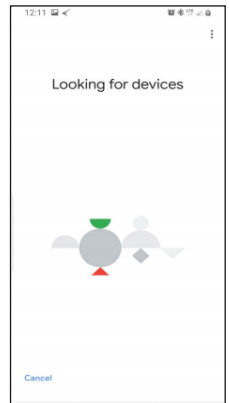
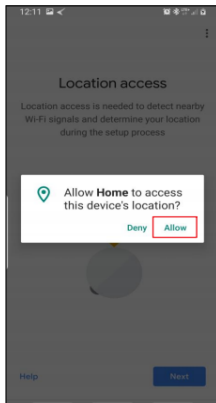
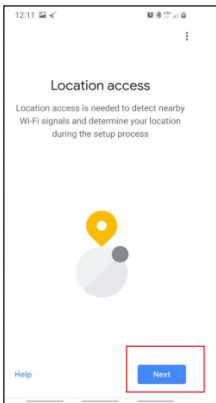

7. If no devices can be found that are already setup, select NO.
8. A youtube video is available to help instruct how to use smart devices.
9. The app will show settings to add devices, setup routines, and adjust settings.

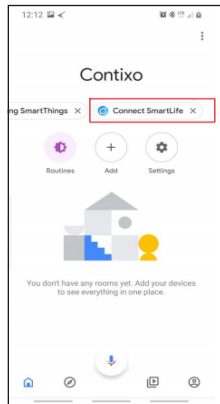
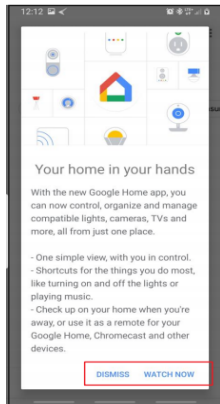
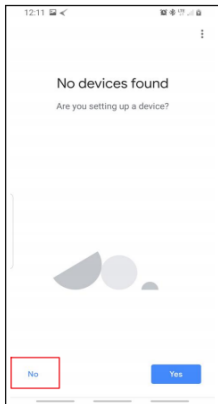

10. If the devices are already installed and setup through the Xodo app, you can select the "Works with Google" setup option to continue.
11. Configure the home settings by adding address and name to a "Home" group.

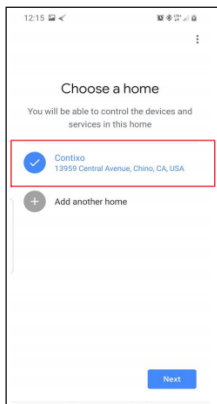
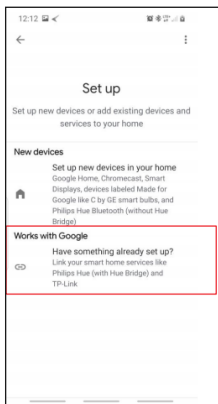

Control your smart devices through Google Home

Now you can control your smart devices through Google Home. Take bedroom light as the example, the supported voice commands are as below:

1. Ok Google, turn on/off bedroom light.
2. Ok Google, set bedroom light to 50 percent.
3. Ok Google, brighten bedroom light.
4. Ok Google, dim bedroom light.
5. Ok Google, set bedroom light to red.

Link Xodo Smart account to Alexa

1. Download the free Alexa app from the Amazon Appstore, Google Play, or the Apple App Store.
2. Open Alexa app to home screen
3. In upper left hand corner open the menu.
4. Next click on "Skills & Games"
5. In top of app you can now search for "Smart Life"
6. Smart Life App will appear.

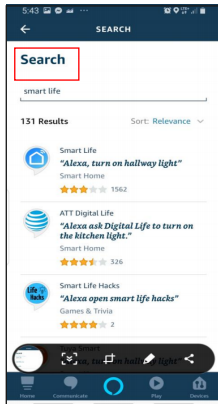
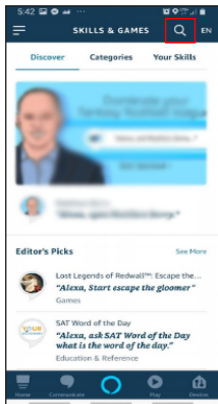
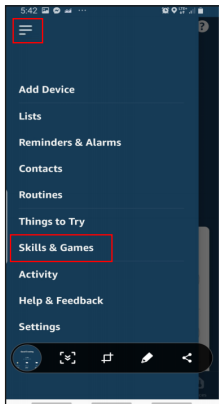

7. Open the smart life app to add
8. Click Settings
9. Manage Smart Home Devices to verify Smart Life has been added.

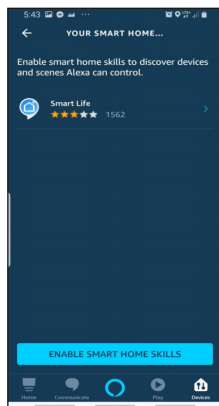
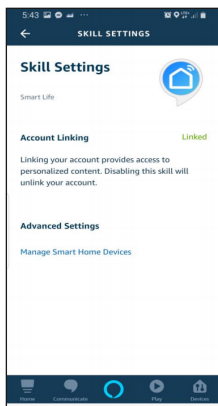
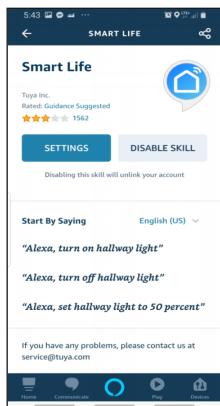

10. You will be redirected to the account link page. Type in your Xodo Smart account and password, don't forget to select the country/region where your account belongs to. Then tap "Link Now" to link your Xodo Smart account. The country/region, the account, and the password must match.

