

# ACCORDION DOOR

## INSTALLATION MANUAL

In case of questions or missing parts, please contact

 [aftersaledoor@outlook.com](mailto:aftersaledoor@outlook.com)

If you have purchased a 48"-72" accordion door, you should first refer to page 2 and page 6.

### Hardware Included

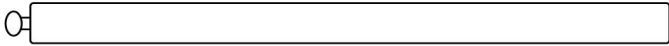
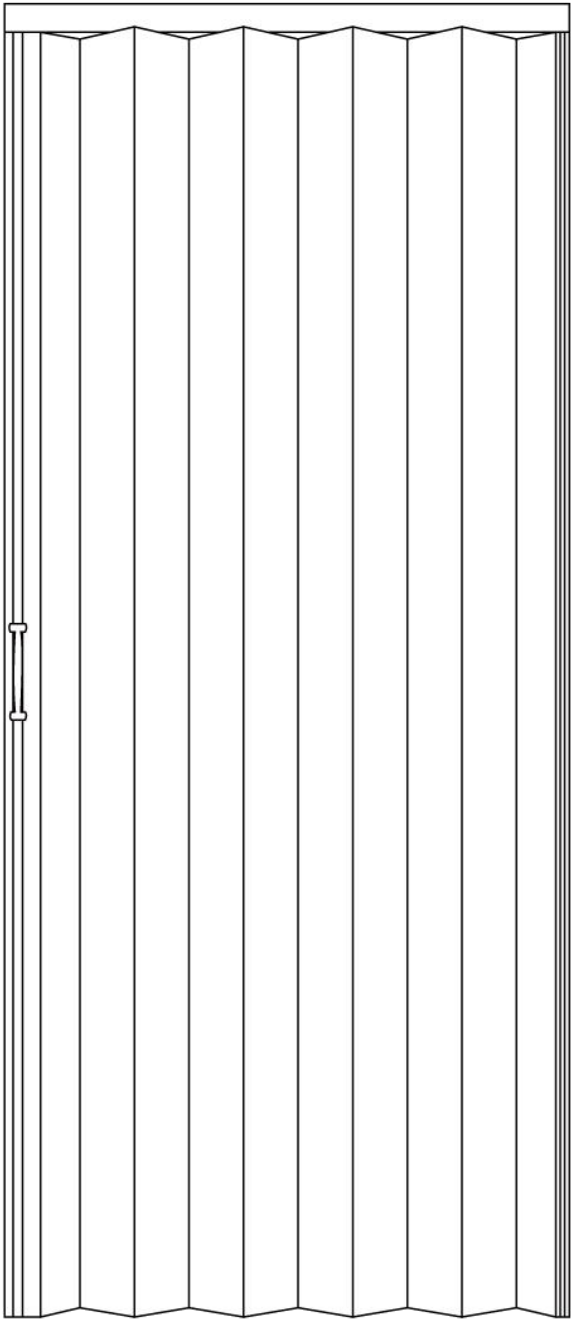

A. Accordion Door



B. Magnetic Panel

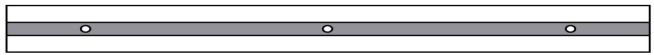

C. Top Track



D. Handle



E. Anchor Channel



F. Lubricating Paste



G. TA Screw



H. FA Screw

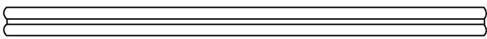

I. Bolt

# Pre-Installation

## To adjust the door to fit your doorway:

**1.** For width adjustments: If the doorway width is less than 36 inches, reduce the door's width by removing panels. Each panel measures 5 inches in width. Start by unscrewing the bottom hinge screws, then remove the necessary number of panels to achieve the desired width.

**2.** For height adjustments: If the doorway height is less than 80 inches, you can shorten the door by cutting off the extra length at the bottom. Stack the door panels together and secure them with masking tape. Remove the bottom hinge screws and use a hacksaw or fine-tooth saw to trim the excess. Smooth the edges with fine sandpaper and reinsert the hinge screws.

2.1 First, loosen the screws securing the edge sealing strip at the bottom of the door. Carefully remove the strip and set it aside for later use.

(If you have purchased pure PVC material, you can proceed to cut the height right after the first step.)

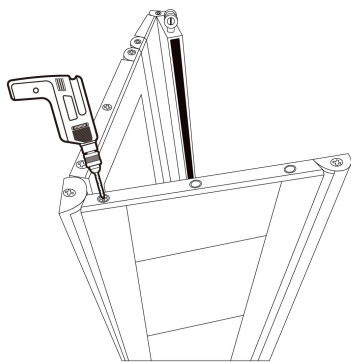

2.1(1)

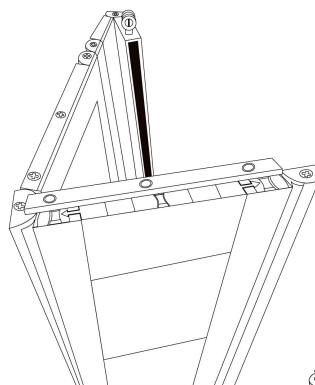

2.1(2)

2.2 Second, remove the seal plate and set it aside for subsequent use.

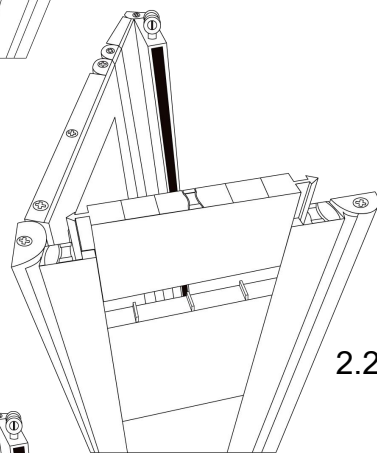

2.2(1)

2.3 Remove the glass. Carefully trim the glass panel and cut the door frame strips along the line indicated. Note that the width of the glass panel cut needs to be the same as the width of the door frame strips cut. After cutting, reassemble by reinstalling the sealing plate and sealing strip.

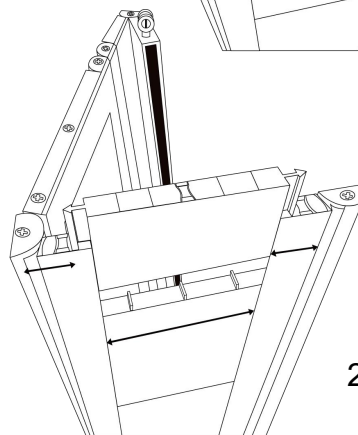

2.3(1)

## 1 Install the Top Track

Position the top track on the top of the door opening so that it is straight and centered. After making a pilot-hole (with a nail or 3/32" drill bit), drive a 1" track screw through the screw hole nearest the center of the track. Do not tighten. (Tape may be used to hold the track in place while you mark and drill.)

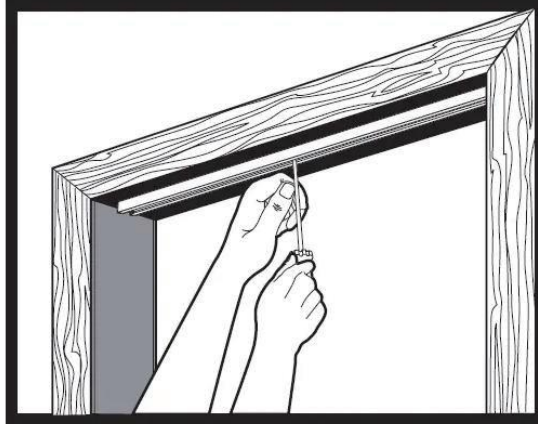

## 2 Install the Top Track

Apply lubricant to each top glide. It is not required but you can also lubricate the top track.

Handle is facing towards the opening side.

Pivot one end of the top track outward. Slide all of the top glides onto the top track. Stack the panels together near the center screw and pivot the top track back into place.

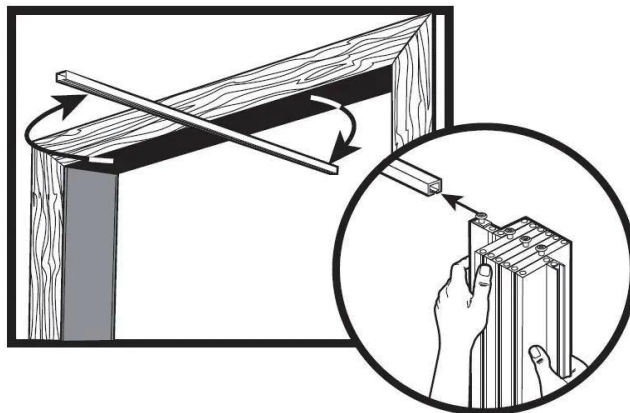

## 3 Secure the Top Track

Make sure the track is straight. Drill pilot holes through the remaining pre drilled holes in the top track and secure the track with the track screws provided. Set all screws as straight and tight as possible to ensure the smooth operation of the door. Be sure to fully tighten the first screw you installed in the track.

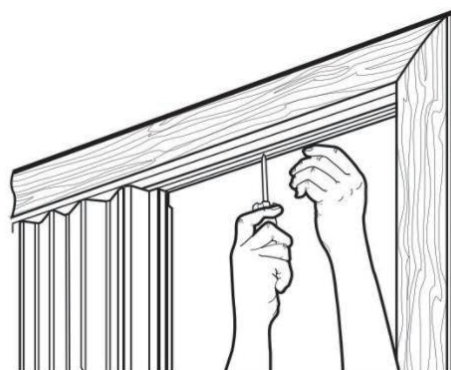

## 4 Install the Anchor Channel

Place the anchor channel on the non-opening side of the door jamb. Use a level to make sure the channel is centered and plumb. Mark the predrilled holes in the channel. Remove the channel and drill pilot holes where you marked the jamb. Secure the anchor channel to the jamb using the flathead screws provided. Press the anchor panel into the channel.

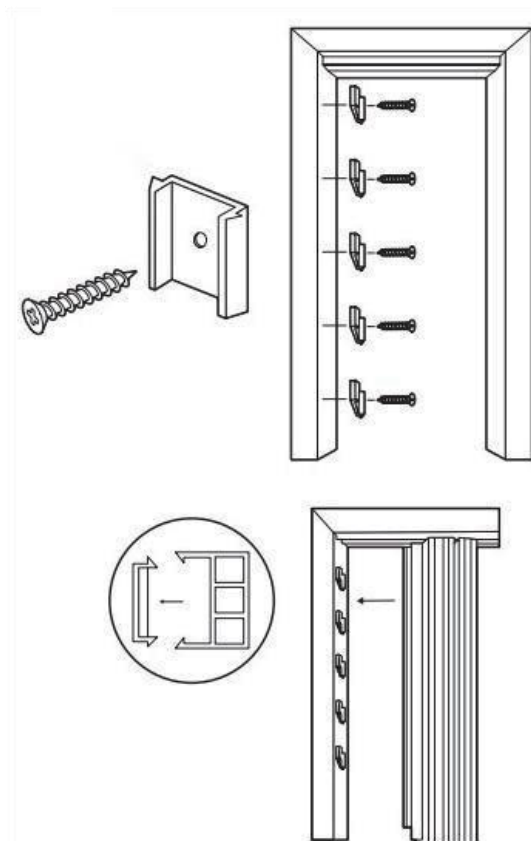

## 5 Install Handles

To fit the handles insert the two stainless steel pins into the two holes of the door jamb and then fix the pair of handles by pushing the handles onto each relative end of the pins until the handles press firmly against the door.

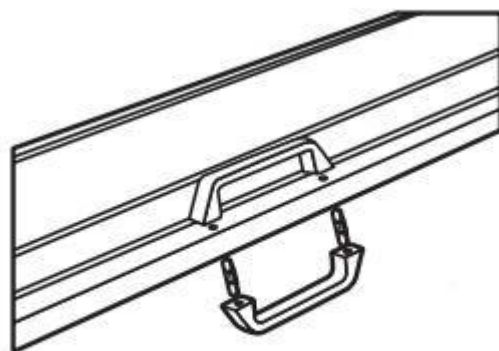

## 6 Install Magnetic Panel

Install a Magnetic Panel on the wall near the opening (on the side with the handle).

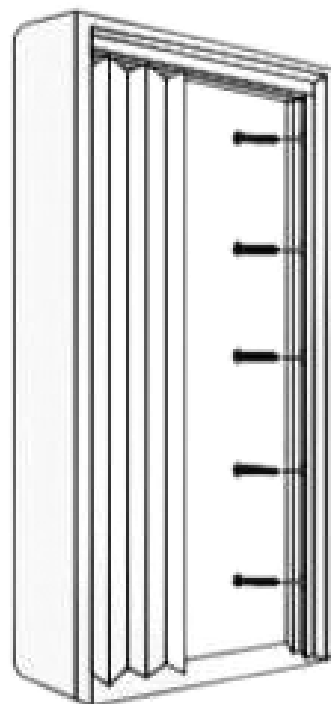

# DOUBLE ACCORDION DOOR

## Install DOUBLE ACCORDION DOOR

### 1 Install the First Panel

Follow the single door installation guide from Step 1 to Step 5 to install one side of the door.

Ensure the panel is securely mounted and operates smoothly. Handle is facing towards the opening side.

### 2 Install the Second Panel

Repeat the same installation process (Steps 1 to 5) for the second panel on the opposite side.

### 3 Align and Close

Once both panels are installed, align them so that they meet at the center. The doors will close securely using the magnetic switch located on the handle side of each panel.

